

SCHEMATIC

SPECIFICATIONS

FUNCTION:  
2P2T (ON)–OFF–(ON)

RATINGS:  
ANSI/UL 1054 and CN/CSA C22.2 No. 55 (E194579):  
20A 125VAC 1.5HP 60Hz [cURus]  
20A 250VAC 1.5HP 60Hz [cURus]

CONTACT RESISTANCE:  
Initial: 50mΩ Max.

INSULATION RESISTANCE:  
500MΩ Min. at 500VDC

DIELECTRIC STRENGTH:  
1,500VAC For 1 Minute

TEMPERATURE:  
Operating: –20°C to 85°C [cURus]

INGRESS PROTECTION:  
IP55

APPROVALS:

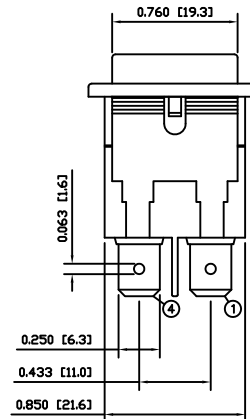
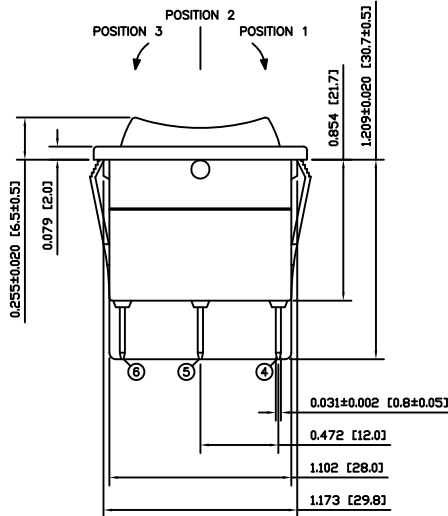
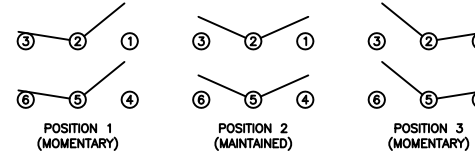
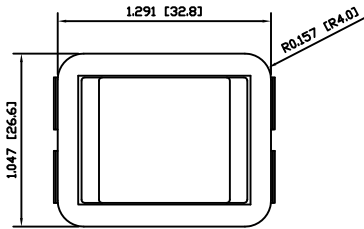

COLORS AND MARKINGS

BODY:  
Black  
ACTUATOR:  
Black  
MOUNTING EARS:  
White  
MARKINGS:  
None  
MARKING COLOR:  
None

MATERIALS

BODY:  
Polyamide 6/6 (PA66), UL94 V–0  
ACTUATOR:  
Polyamide 6/6 (PA66), UL94 V–2  
MOUNTING EARS:  
Polyamide 6/6 (PA66), UL94 V–2  
CONTACTS:  
Silver Alloy  
TERMINALS:  
Silver Plated Copper  
RUBBER SEAL:  
Ethylene Propylene Thermoplastic Rubber (EPT)

SUGGESTED PANEL CUTOUT

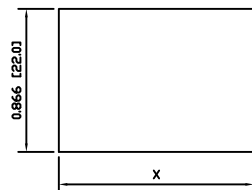

ACTUATOR	A	08/07/21	CAB
BODY	A	08/07/21	CAB
COLORS	A	08/07/21	CAB
MATERIALS	B	10/12/10	CAB
SPECIFICATIONS	B	11/01/17	CAB
REFERENCE	REV.	DATE	

THE INFORMATION CONTAINED IN THIS DOCUMENT IS PROPRIETARY TO E-SWITCH AND IS NOT TO BE COPIED OR TRANSFERRED

B	CORRECTED SCHEMATIC TO INCLUDE MOMENTARY POSITIONS	18593	11/01/17	CAB
A	INITIAL RELEASE	19561	11/01/05	CAB
REV.	DESCRIPTION	PCR	DATE	DRAWN BY

DIMENSIONS	INCHES [MILLIMETERS]
GENERAL TOLERANCES	±0.008 [±0.2] / ±1°
SCALE	DRAWING NOT TO SCALE

TITLE WB24KD1100	
ITEM NUMBER 34–WB24KD1100	DATE JANUARY 17, 2011
REVISION B	

# Mouser Electronics

Authorized Distributor

Click to View Pricing, Inventory, Delivery & Lifecycle Information:

[E-Switch:](#)

[WB24KD1100](#)