

P.C. MOUNTING

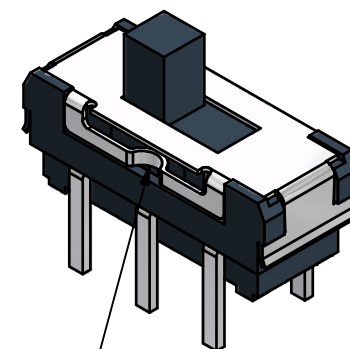

DETENT SPRING PLATE
WILL DEFORM OUTWARD
DURING SWITCH TRAVEL
UP TO .30 [.012 in]

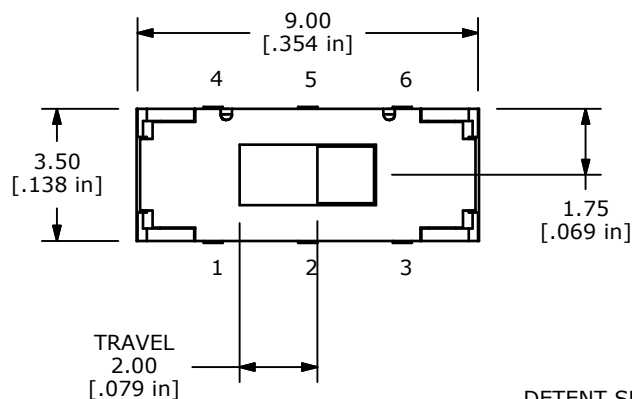
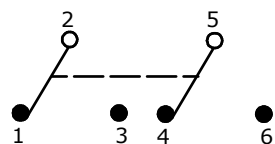

▲ CIRCUIT: DPDT

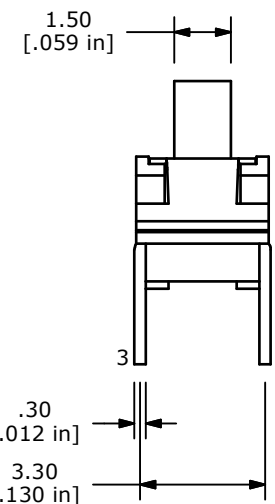
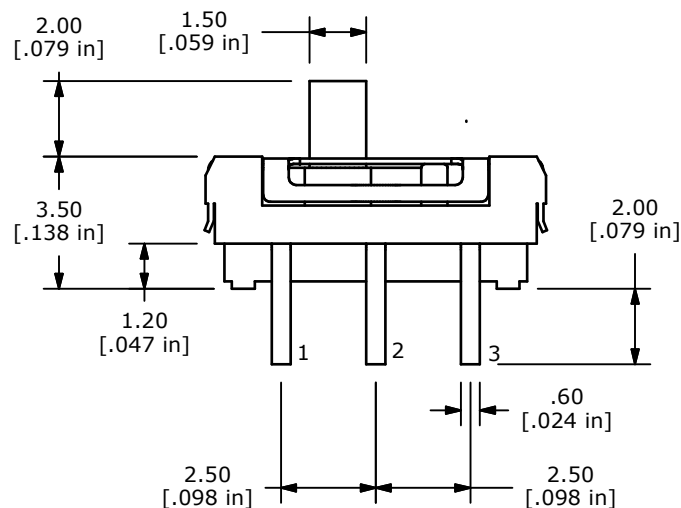

NOTES:

1. ALL DIMENSIONS IN MM[INCH]
2. GENERAL TOLERANCE:
X.X= ± 0.4 X.XX= ± 0.25
3. DENOTES CRITICAL PARAMETER
4. ▲ TERM NOS. FOR REF ONLY
- 5 RATING: 6VDC .3A
- ▲ 6. OPERATING FORCE: 200 ± 150 GRAMS
7. LIFE CYCLES: 10,000 CYCLES
8. CONTACT RESISTANCE (INITIAL): 70 mΩ MAX.
9. 2002/95/EC (ROHS) COMPLIANT
10. DIELECTIC STRENGTH: 500VAC FOR 1 MINUTE
11. INSULATION RESISTANCE: 500VDC, 100 mΩ MIN
- ▲ 12. TIMING: NON-SHORTING
13. PLATING: SILVER

**E-SWITCH®**

A	21136	NEW RELEASE	5/22/13	EBP
REV	PCR NO	DESCRIPTION	DATE	BY

THE INFORMATION CONTAINED IN THIS DOCUMENT IS PROPRIETARY
TO E-SWITCH AND IS NOT TO BE COPIED OR TRANSFERRED

TITLE EG2273

SCALE

DATE

5/22/2013

DR

EBP

DWG

P112714

REV

A

Mouser Electronics

Authorized Distributor

Click to View Pricing, Inventory, Delivery & Lifecycle Information:

[E-Switch:](#)

[EG2273](#)