

NOTES:

1. ALL DIMENSION IN MM [INCH]
2. GENERAL TOLERANCE: $X.X=\pm 0.4$
 $X.XX=\pm 0.25$
3. TERM. NOS. FOR REF. ONLY
4. CONTACT RATING SWITCHING: 150mA, 250V AC/DC
350mA, 110V AC/DC
5. CONTACT RATING (NON-SWITCHING): 5A
6. OPERATING FORCE: 425 \pm 100 CM/STANDARD
7. CONTACT MATERIAL: SILVER OVER COPPER ALLOY
8. OPERATING TEMP: -30° to 85°C
9. CIRCUIT SP: 6 POSITIONS, 30° INDEX.
10. DIELECTRIC STRENGTH: 1000V RMS min. @SEA LEVEL.
11. DESIGNATE MAJOR DIMENSIONS
12. HARDWARE SUPPLIED ON SWITCH - SEE BELOW
STOP RING, LOCKWASHER, & HEXNUT

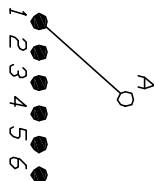

CONTACT CONFIGURATION
Timing: Non Shorting (BBW)

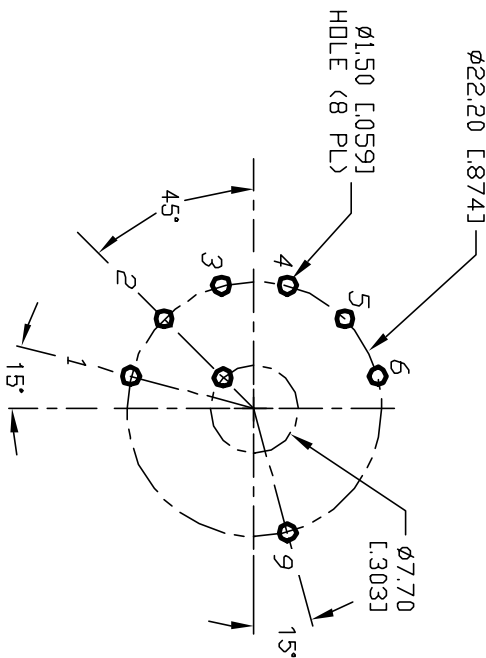

RECOMMENDED P.C.B. LAYOUT

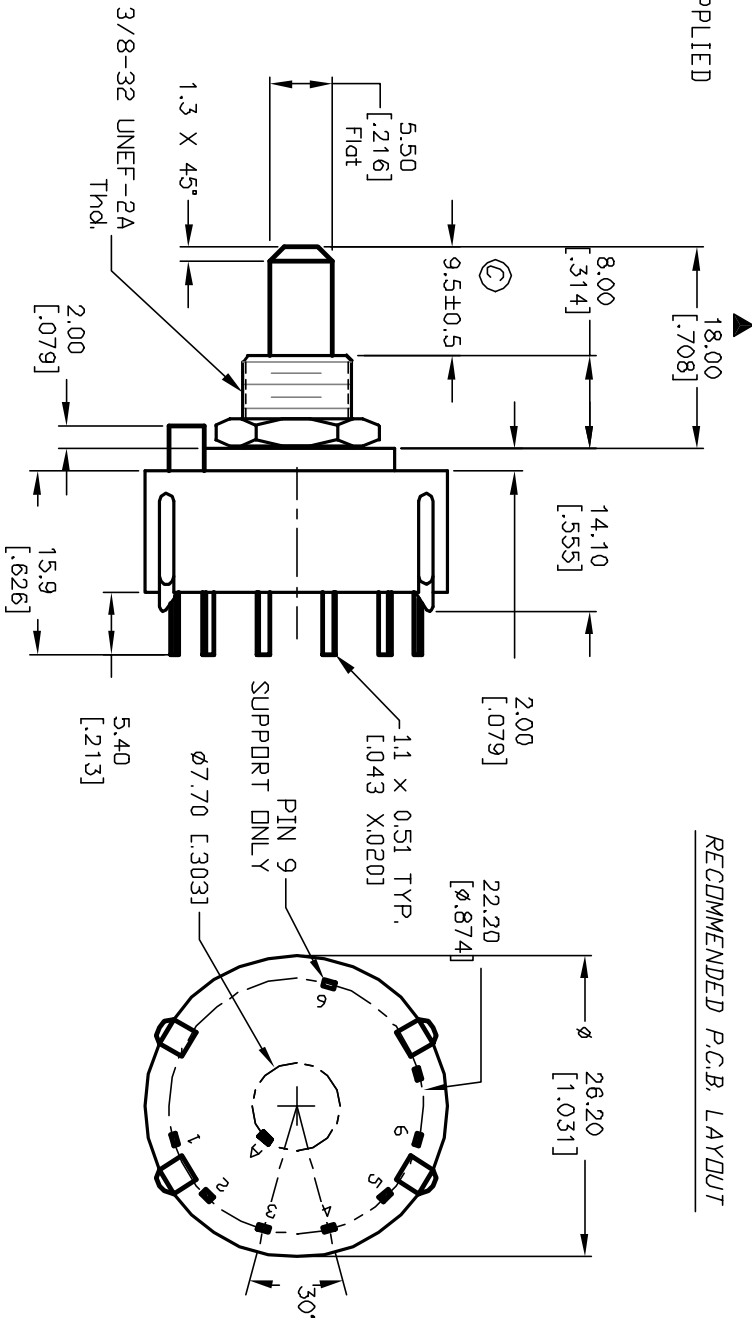
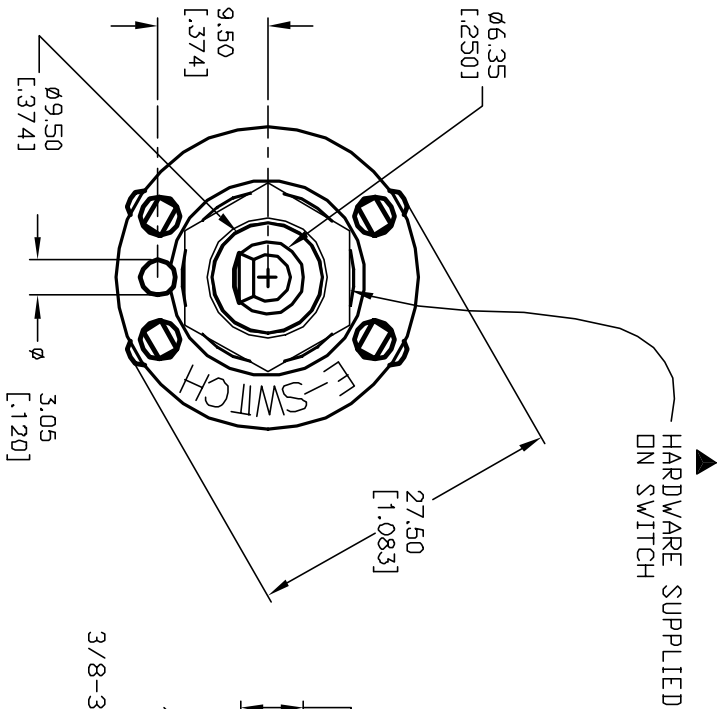

E-SWITCH®				TITLE			
C	12821	REVISED	CJB	2/27/03	SCALE	DATE	DR
B	12668	REV DESC/ PER CATALOG	CJB	12/26/02	1.5:1	8/8/01	CJB
A	12068	RELEASED FOR PRODUCTION	CJB	4/15/02			DWG
REV.	ECN No.	DESCRIPTION	DATE	CHKD			REV
THE INFORMATION CONTAINED IN THIS DOCUMENT IS PROPRIETARY TO E-SWITCH AND IS NOT TO BE COPIED OR TRANSFERRED							C

Mouser Electronics

Authorized Distributor

Click to View Pricing, Inventory, Delivery & Lifecycle Information:

[E-Switch:](#)

[KC16A9.501NPS](#)