

SPECIFICATIONS

FITS:
RA1 Series
RA8 Series

APPROVALS:

RoHS
COMPLIANT

MATERIALS

CAP:
Polyvinyl Chloride (PVC)

COLORS

CAP:
Clear

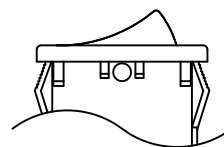
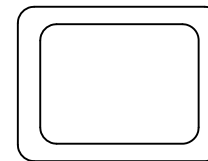
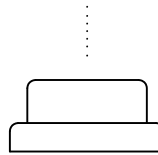
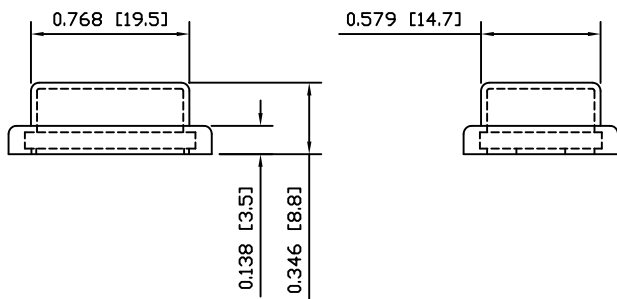
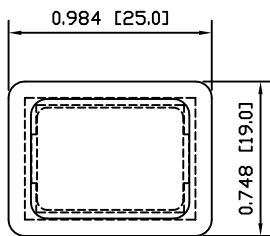

EXPLODED VIEW

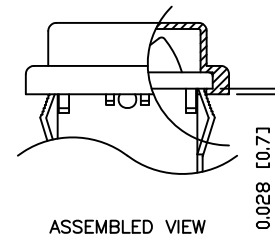

ASSEMBLED VIEW

THE INFORMATION CONTAINED IN THIS DOCUMENT IS PROPRIETARY TO E-SWITCH AND IS NOT TO BE COPIED OR TRANSFERRED

A
REV.

INITIAL RELEASE
DESCRIPTION

18778
PCR

10/01/14
DATE

CAB
DRAWN BY

DIMENSIONS
INCHES [MILLIMETERS]
GENERAL TOLERANCES
 ± 0.008 [± 0.2] / $\pm 1^\circ$
SCALE
DRAWING NOT TO SCALE

PROJECTION
FIRST ANGLE

E-SWITCH

LAMB
INDUSTRIES

ACC-P01

DRAWING NUMBER
38-ACCP01

DATE
JANUARY 14, 2010

REVISION
A

Mouser Electronics

Authorized Distributor

Click to View Pricing, Inventory, Delivery & Lifecycle Information:

E-Switch:

[ACC-C17-2](#) [ACC-P01](#) [ACC-F02-1](#) [ACC-C23-2](#) [ACC-E03-23](#)