

THIS IS A C.A.D. GENERATED DRAWING
DO NOT MAKE MANUAL REVISIONS TO MASTER.

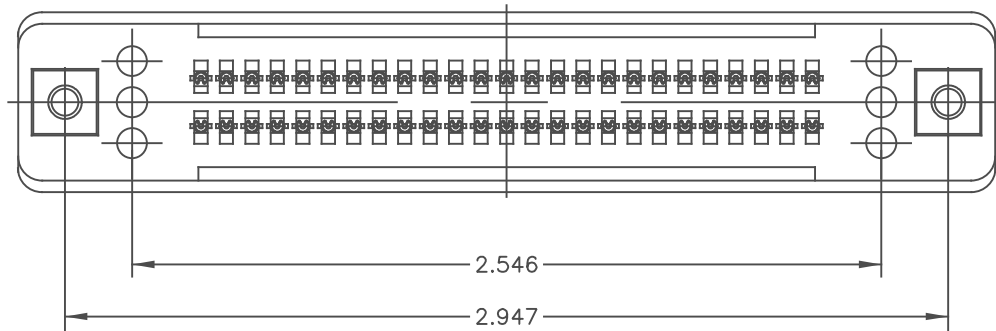

ISSUE NUMBER

ORIGINAL	①
DIM. 3.328 WAS 3.262 AND LEAD IS REMOVED FROM TIN/LEAD PLATING F.BRIONES AUG.10/05	②
TIN/LEAD PLATING WAS TIN PLATING; REF TO RoHS EXEMPT ADDED. R.BLAKEY FEB.8/06	③
DIM.165 WAS.170 F.BRIONES MAR.6/06	④
PAGE 2 ADDED R.Esmoeli MAY.1/19	⑤

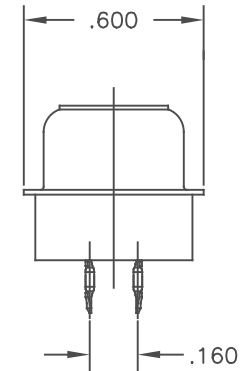
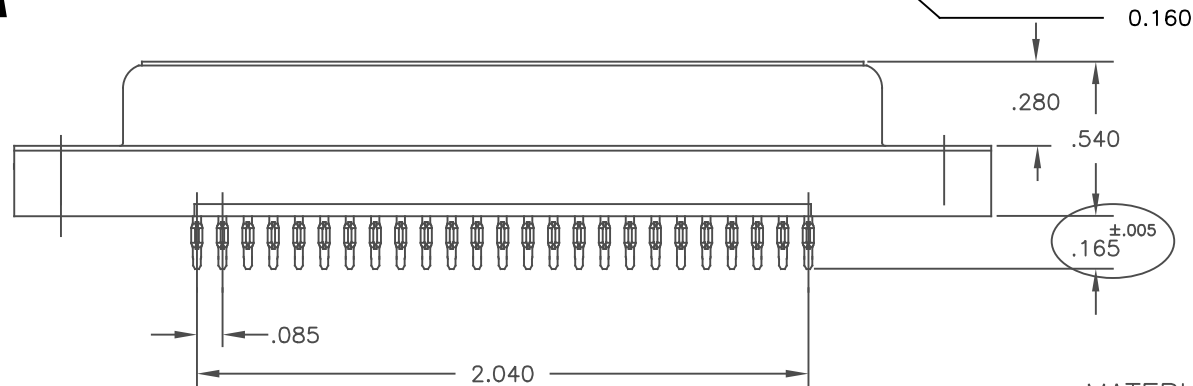
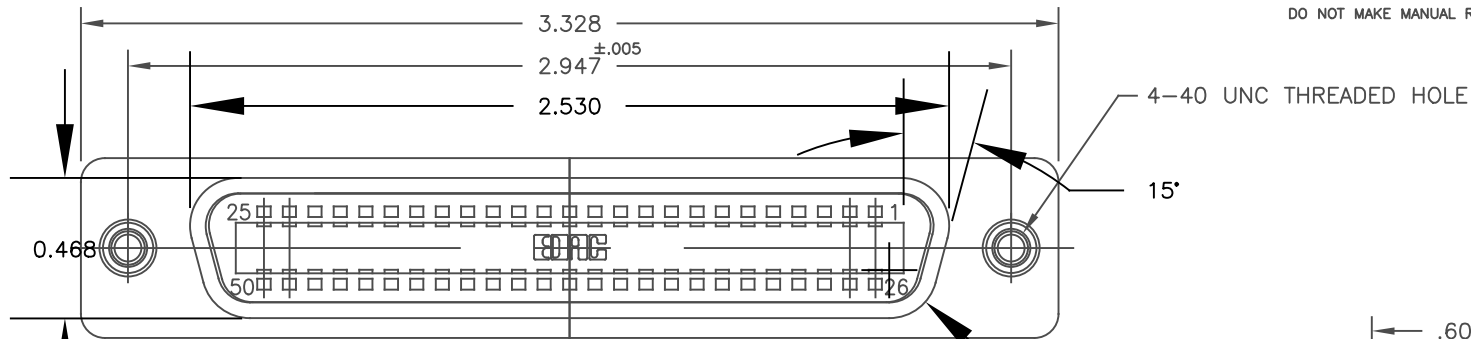

MATERIALS:

INSULATOR : THERMOPLASTIC POLYESTER COLOR BLUE
SHELL: STEEL, NICKEL PLATED
CONTACTS: PHOSPHOR BRONZE 30 MICROINCHES OF GOLD ON
ON CONTACT AREA TIN ON COMPLIANT SECTION OVER NICKEL
THREADED INSERTS: BRASS, NICKEL PLATED

CONNECTOR PART NO. B57-050-620-202



THIS PRODUCT CONFORMS TO THE EUROPEAN
UNION DIRECTIVES 2002/95/EC AND 2002/96/EC
FOR RoHS COMPLIANCY WITH EXEMPTION #11:
LEAD USED IN COMPLIANT PIN CONNECTOR SYSTEMS.

50 POSITION MINIATURE RIBBON RECEPTACLE
COMPLIANT PIN (PRESS FIT)



EDAC INC
TORONTO, ONTARIO
CANADA
YOUR CONNECTION TO QUALITY & SERVICE

THESE DRAWINGS AND SPECIFICATIONS
ARE THE PROPERTY OF EDAC INC., AND
SHALL NOT BE REPRODUCED, OR COPIED
OR USED AS THE BASIS FOR THE
MANUFACTURE OR SALE OF APPARATUS
WITHOUT WRITTEN PERMISSION.

ACAD REFERENCE NO. B57-050-620-202

DRAWN: F.BRIONES DATE: AUG.28/00

CHECKED: DATE:

SCALE: IN C.A.D. 1:1 SHEET 1 OF 2

DRAWING NUMBER B57-050-620-202 ISSUE 5

THIS IS A C.A.D. GENERATED DRAWING
DO NOT MAKE MANUAL REVISIONS TO MASTER.



ISSUE NUMBER

ORIGINAL	①
DIM. 3.328 WAS 3.262 AND LEAD IS REMOVED FROM TIN/LEAD PLATING F.BRIONES AUG.10/05	②
TIN/LEAD PLATING WAS TIN PLATING; REF TO RoHS EXEMPT ADDED. R.BLAKEY FEB.8/06	③
DIM.165 WAS.170 F.BRIONES MAR.6/06	④
PAGE 2 ADDED R.Esmaeili MAY.1/19	⑤

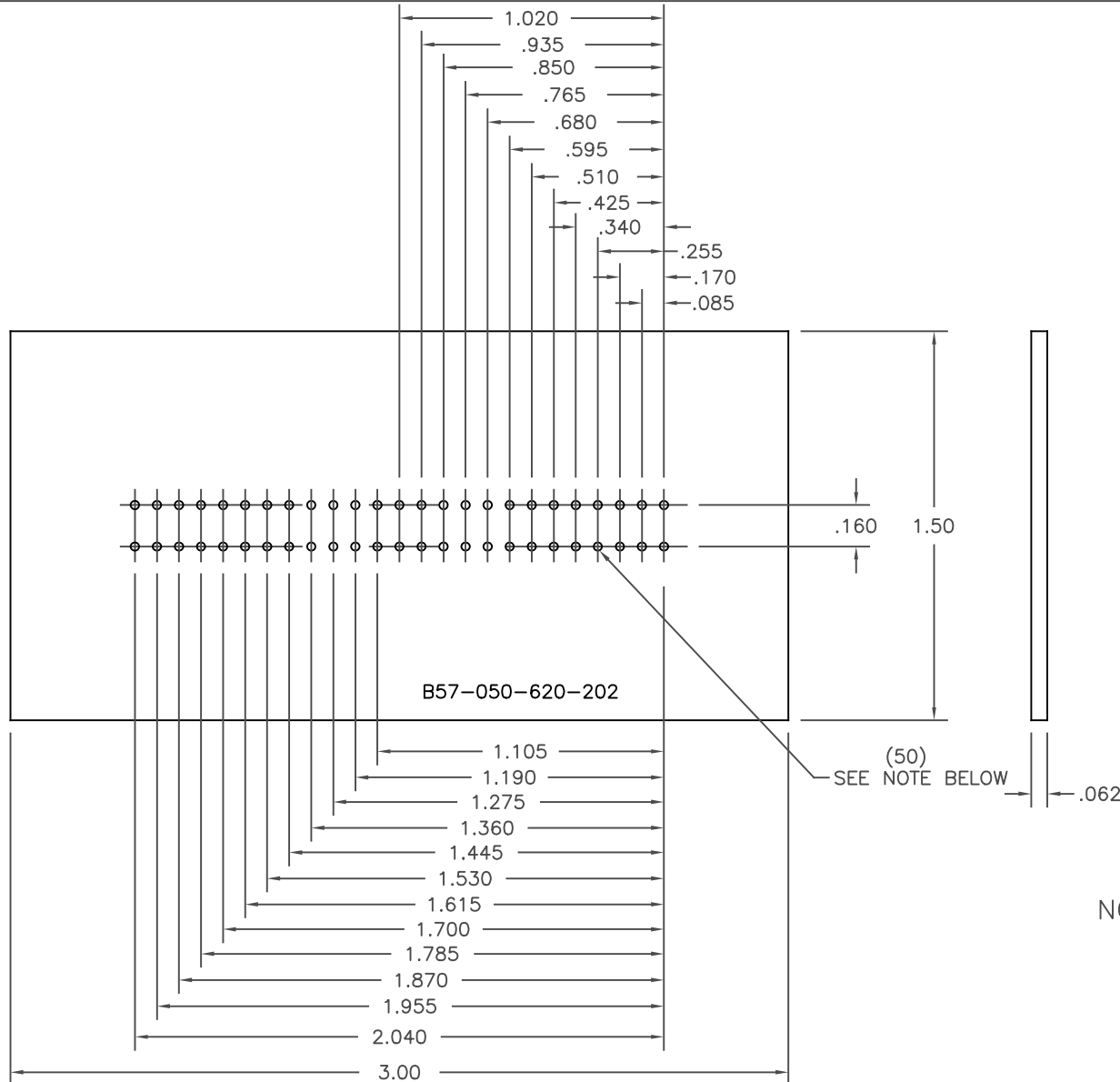

NOTE:

TO OBTAIN OPTIMUM COMPLIANT SECTION PERFORMANCE,
DRILL HOLES $.038 \pm .001$ DIAMETER
COPPER PLATE, .001 MINIMUM THICKNESS FOLLOWED BY
TIN PLATE TO PROVIDE FINISHED HOLES $.030/.035$ DIAMETER



THIS PRODUCT CONFORMS TO THE EUROPEAN
UNION DIRECTIVES 2002/95/EC AND 2002/96/EC
FOR RoHS COMPLIANCY WITH EXEMPTION #11:
LEAD USED IN COMPLIANT PIN CONNECTOR SYSTEMS.

CONNECTOR PART NO. B57-050-620-202

50 POSITION MINIATURE RIBBON RECEPTACLE
COMPLIANT PIN (PRESS FIT)



EDAC INC
TORONTO, ONTARIO
CANADA
YOUR CONNECTION TO QUALITY & SERVICE

THESE DRAWINGS AND SPECIFICATIONS
ARE THE PROPERTY OF EDAC INC., AND
SHALL NOT BE REPRODUCED, OR COPIED
OR USED AS THE BASIS FOR THE
MANUFACTURE OR SALE OF APPARATUS
WITHOUT WRITTEN PERMISSION.

ACAD REFERENCE NO. B57-050-620-202	
DRAWN: F.BRIONES	DATE: AUG.28/00
CHECKED:	DATE:
SCALE: IN C.A.D. 1:1	SHEET 2 OF 2
DRAWING NUMBER B57-050-620-202	ISSUE 5

Mouser Electronics

Authorized Distributor

Click to View Pricing, Inventory, Delivery & Lifecycle Information:

EDAC:

B57-050-620-202