

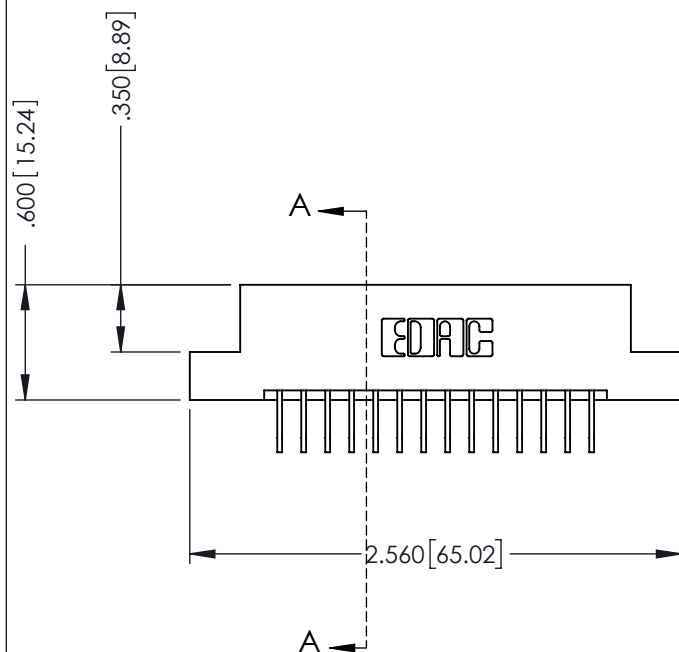

ISSUE NUMBER

ORIGINAL

①

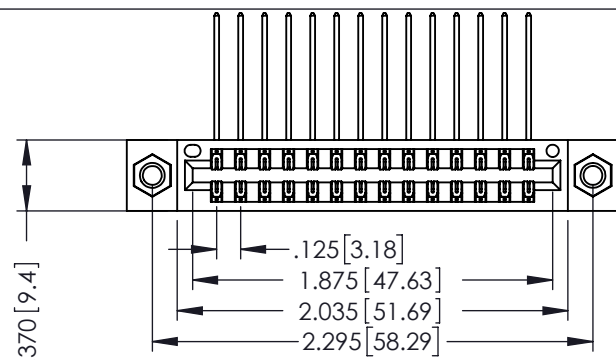

- INSULATOR MATERIAL: THERMOPLASTIC POLYESTER, UL 94V-0
- CONTACT MATERIAL: COPPER, NICKEL, TIN ALLOY CA-725
- CONTACT PLATING: GOLD ON THE MATING AREA, TIN-LEAD ON THE CONTACT TAILS, NICKEL UNDERPLATE

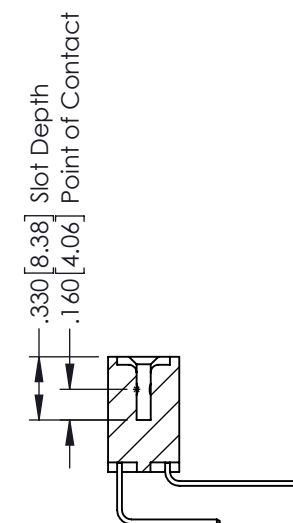

SECTION A-A

# 346/396 SERIES CARD EDGE CONNECTOR PART NUMBER: 396-028-558-207



YOUR CONNECTION TO QUALITY & SERVICE

EDAC INC  
TORONTO, ONTARIO  
CANADA

THESE DRAWINGS AND SPECIFICATIONS  
ARE THE PROPERTY OF EDAC INC. AND  
SHALL NOT BE REPRODUCED, OR COPIED  
OR USED AS THE BASIS FOR THE  
MANUFACTURE OR SALE OF APPARATUS  
WITHOUT WRITTEN PERMISSION.

ACAD REFERENCE NO. 346-ENG-MASTER

DRAWN: J.LEE DATE: APR. 22/09

CHECKED: DATE:

SCALE: 1:1 SHEET 1 OF 2

DRAWING NUMBER  
346-ENG-MASTER

ISSUE  
1

**Contact Description:**  
**555-Extender Board Bend (Code 500 Contacts)**

.120 3.05

.095 2.41

.245 6.22

.170 4.33

.125(3.18) to .210(5.33)  
Outside Tails  
.045(1.14) to .060(1.52)  
Between Tails

.125(3.18) to .210(5.33)  
Outside Tails  
.125(3.18) to .210(5.33)  
Outside Tails

**Contact Code 555**

**Contact Code 556**

.060 1.52

.060 1.52

.165 4.19

.200 5.08

.150 3.81

.375 9.54

.210 5.33

.260 6.6

.125(3.18) to .210(5.33)  
Outside Tails

.660 16.76

.660 16.76

.125(3.18) to .210(5.33)  
Outside Tails

**Contact Code 558**

**Contact Code 559**

**Contact Code 560**

ACAD REFERENCE NO.

- INSULATOR MATERIAL: THERMOPLASTIC POLYESTER, UL 94V-0
- CONTACT MATERIAL; COPPER, NICKEL, TIN ALLOY CA-725
- CONTACT PLATING: GOLD ON THE MATING AREA, TIN-LEAD ON THE CONTACT TAILS, NICKEL UNDERPLATE

EDAC INC  
TORONTO, ONTARIO  
CANADA

THESE DRAWINGS AND SPECIFICATIONS  
ARE THE PROPERTY OF EDAC INC. AND  
SHALL NOT BE REPRODUCED,OR COPIED

CHECKED:

YOUR CONNECTION TO QUALITY & SERVICE

# Mouser Electronics

Authorized Distributor

Click to View Pricing, Inventory, Delivery & Lifecycle Information:

EDAC:

[396-028-558-207](tel:396-028-558-207)