

PPC-A9-121-U-C

User Manual

Release 1.0



Chipsee Products Naming Rules

CS10768F121P-U-C111	
CS	Chipsee Product Abbreviate
10	Horizontal Resolution 80 Means 800 Pixel 10 Means 1024 Pixel 12 Means 1280 Pixel 14 Means 1440 Pixel 19 Means 1920 Pixel
768	Vertical Resolution 480 Means 480 Pixel 600 Means 600 Pixel 768 Means 768 Pixel 800 Means 800 Pixel 900 Means 900 Pixel 102 Means 1024 Pixel 108 Means 1080 Pixel
F(T)	Product based on Freescale (TI) CPU
121	LCD Dimension 050 Means 5.0 Inch 070 Means 7.0 Inch 080 Means 8.0 Inch 097 Means 9.7 Inch 101 Means 10.1 Inch 104 Means 10.4 Inch 120 Means 12.0 Inch 121 Means 12.1 Inch 150 Means 15.0 Inch 170 Means 17.0 Inch 190 Means 19.0 Inch 215 Means 21.5 Inch
P	Means Embedded PC or Panel PC E Means Embedded PC without Case P Means Panel PC with Case

C	Means Touch Type R Means Resistive Touch C Means Capacitive Touch
1	Means LCD Brightness 1 Means Common Brightness 2 Means High Brightness
2	PCB Version Baseboard PCB Version Number
1	PCB Version SOM Module PCB Version Number

Hardware Features

Key Features:	
CPU	iMX6Q,Quad-A9, Dual-core 1GHz, brightness 350cd
RAM	2GB DDR3
eMMC	8GB
Storage	TF card, supports up to 32GB SDHC
Display	12.1 Inch LCD,1024*768 Pixel Resolution,4:3
Touch	Ten-Point Capacitive Touch
USB	2 x USB 2.0 Host,1 USB OTG
LAN	1 Channel 1000M LAN
Audio	MIC audio input □3.5mm Audio Out Connector,2W Speaker Internal
Buzzer	1
Camera	1□Front USB -500 ten thousand pixel
Fingerprint module	Zaz-070S

RTC	Yes
RS232	4 RS232 connectors by default (can be customized to 2*RS232+2*RS485)
RS485	2 Channels (Optional)
CAN	2 Channels (Optional)
GPIO	8 Channels (Optional)
WiFi/BT	On Board WIFI/BT
HDMI	1 Channel
SATA II	1 Channel
4G/LTE	Optional
Power Input	12~36V DC
Current @ 15V	2000 mA max
Power Consumption	10W Typical
Working Temperature	-20°C to +70°C
OS	Android, Ubuntu, Linux
Dimension	359*274*23mm
Weight	4000g

* This product has 5 channels of UART in total. The Bluetooth used one channel UART by default, the default setting is 2*RS232+2*RS485+Bluetooth. The UART can be changed between RS232 and RS485 easily. If you want different RS232 and RS485 setting, please [contact us](#).

CS10768F121P-U-C111



Figure 1 Front View

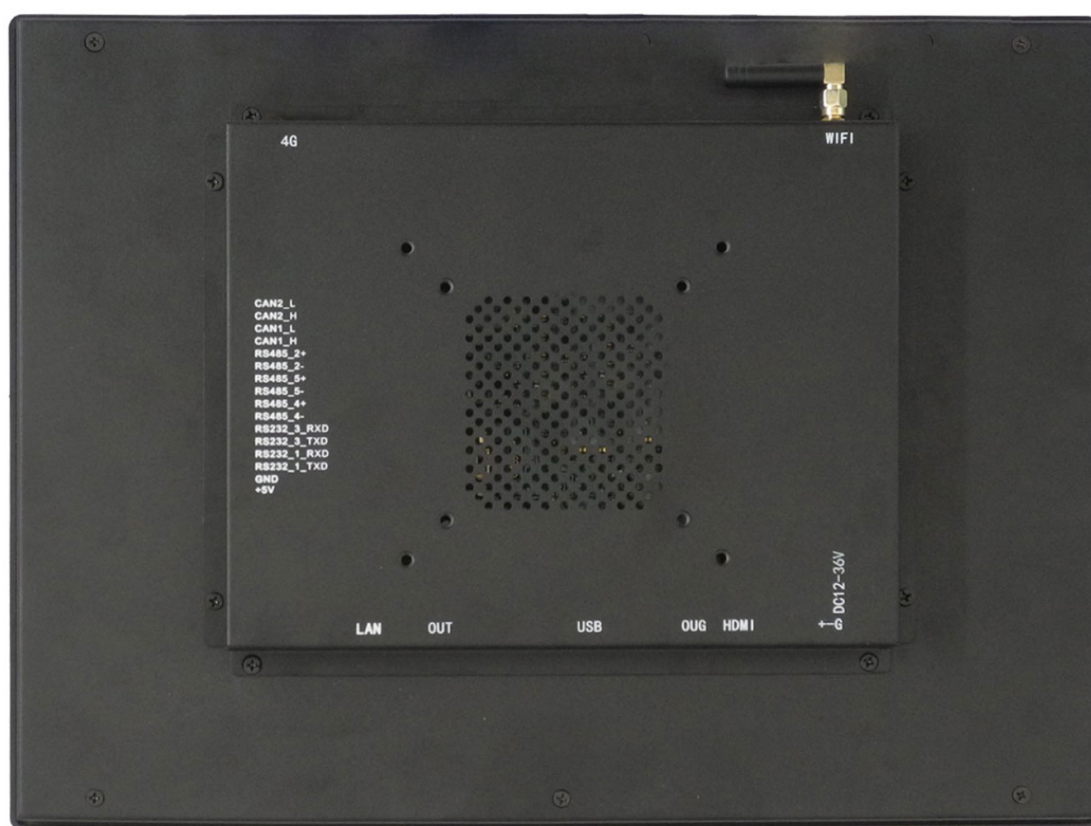

Figure 2 Back View



Figure 3 Side View



Figure 4 Side View

Measurements and Mounting

Measurements

The measurement of CS10768F121P-U-C111 is 359*274*23mm.



Mounting Method

This product CS10768F121P-U-C111 can be mounted using the mounting set, as Figure 5 shows. Or it can be mounted using Panel set, as Figure 6 shows. Please make sure the display is not exposed to high pressure when mounting into an enclosure.

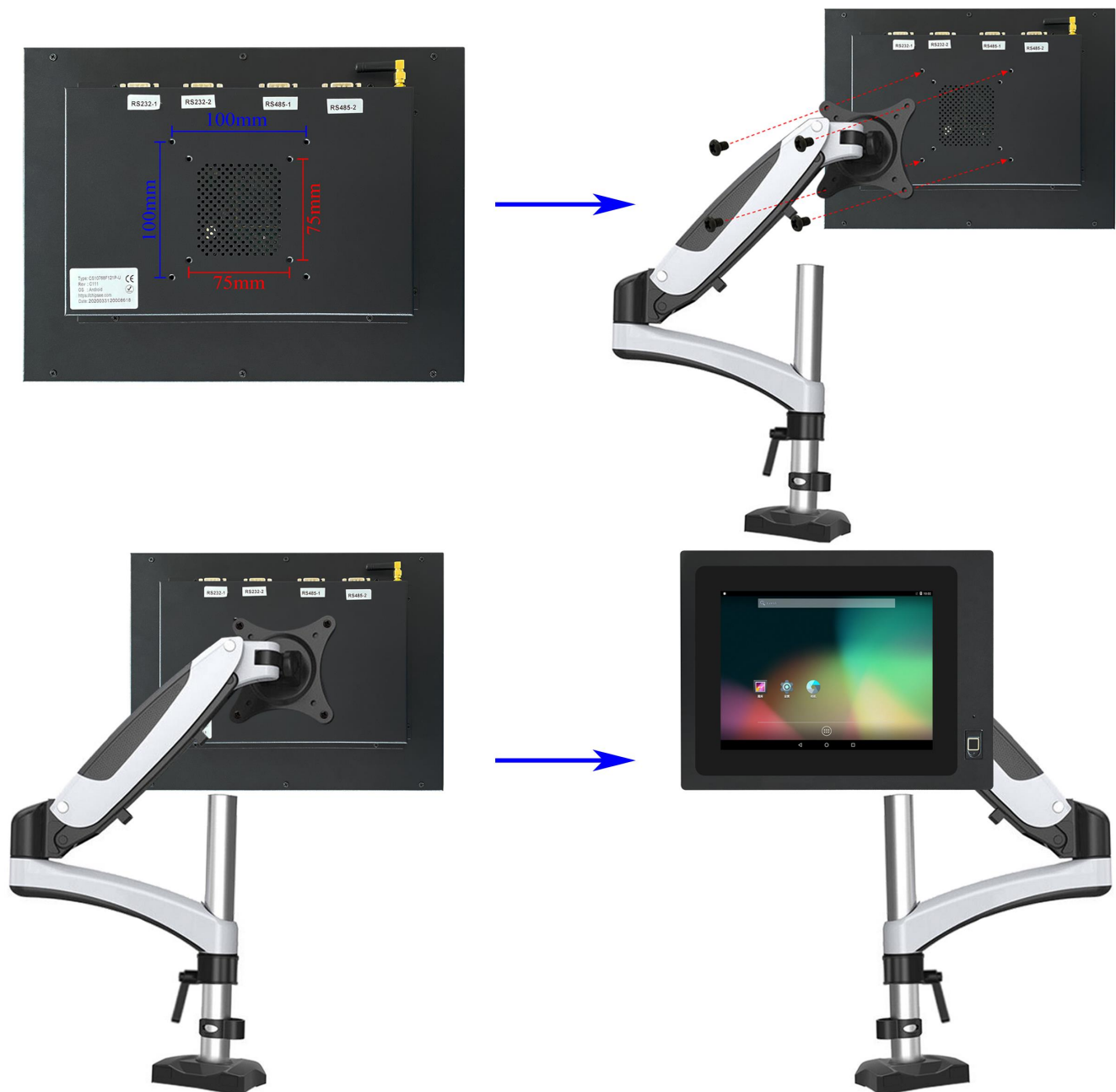

Figure 5 VESA Mounting Method

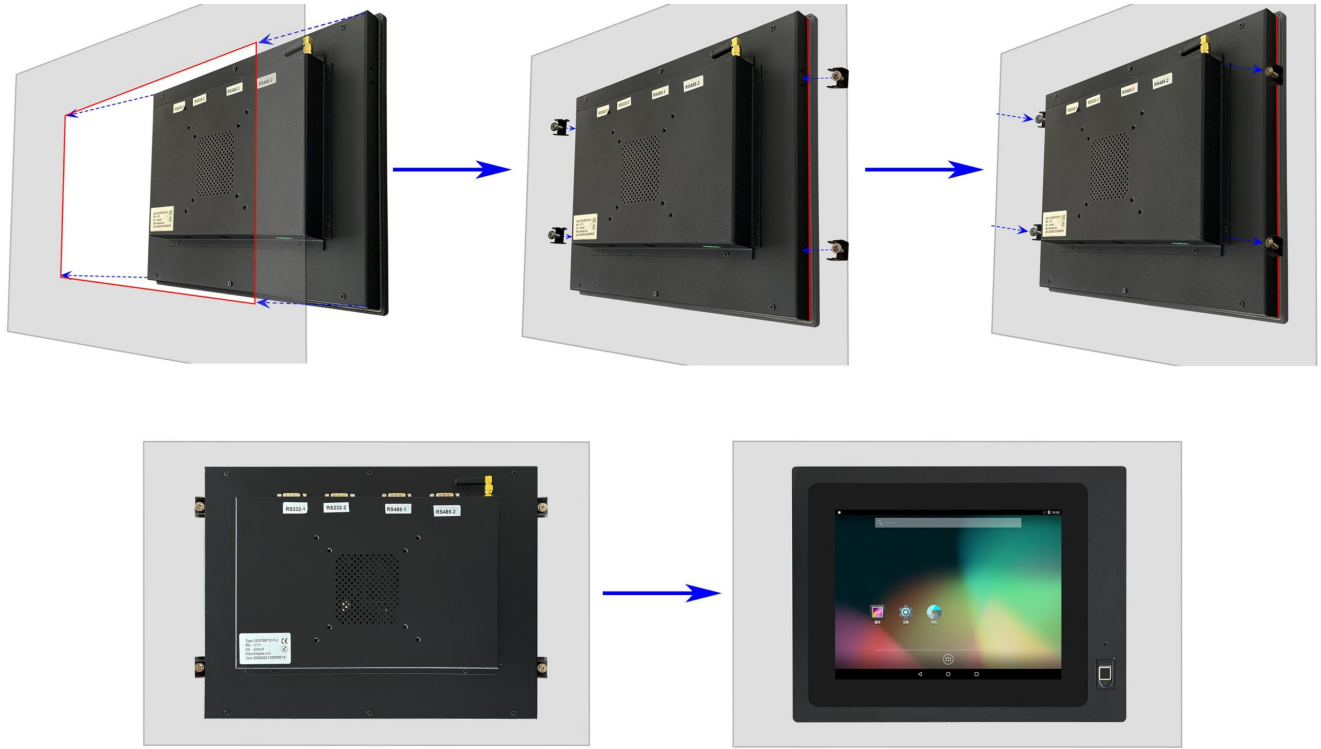

Figure 6 Panel Mounting Method

How to Get Support

Please feel free to contact us with any questions, queries or suggestions.

If your question is about technical support or troubleshooting for one of our products, we kindly ask you to first check our documentation for a possible solution.

If you cannot find the solution you are looking for then please write to contact@chipsee.com providing all possible details.

Mouser Electronics

Authorized Distributor

Click to View Pricing, Inventory, Delivery & Lifecycle Information:

[Chipsee:](#)

[CS10768F121P-U-C](#)