

# Calculator

SKU:A005



## Description

**Calculator** is a complete featured calculator panel adapted to the FACE\_BOTTOM product which can be used for mathematical calculations or custom key operations.

The panel based upon a 4 \* 5 button layout design, which covers the basic function buttons required for mathematical calculations. You can also remap them to custom function buttons by modifying the firmware. The panel integrates **MEGA328** processor and communicates via I2C protocol (with default address: 0x08), by default it works in slave mode.

## Product Features

- I2C communication(0X08)
- Numeric keyboard input
- Development Platform [UIFlow](#), [MicroPython](#), [Arduino](#)

## Include

- 1x Calculator panel

## Applications

- Data Entry
- Calculator
- Human-computer interaction

## Specification

Communication	I2C(0X08)
Button	20 button
Net weight	20g
Gross weight	40g
Product Size	58.2mm x 54.2mm x 10.4mm
Package Size	95mm x 65mm x 25mm
Case Material	Plastic ( PC )

## EasyLoader

EasyLoader is a concise and fast program writer, which has a built-in case program related to the product. It can be burned to the main control by simple steps to perform a series of function verification. Please install the corresponding driver according to the device type. M5Core host [Please click here to view the CP210X driver installation tutorial](#), M5StickC/V/T/ATOM series can be used without driver)

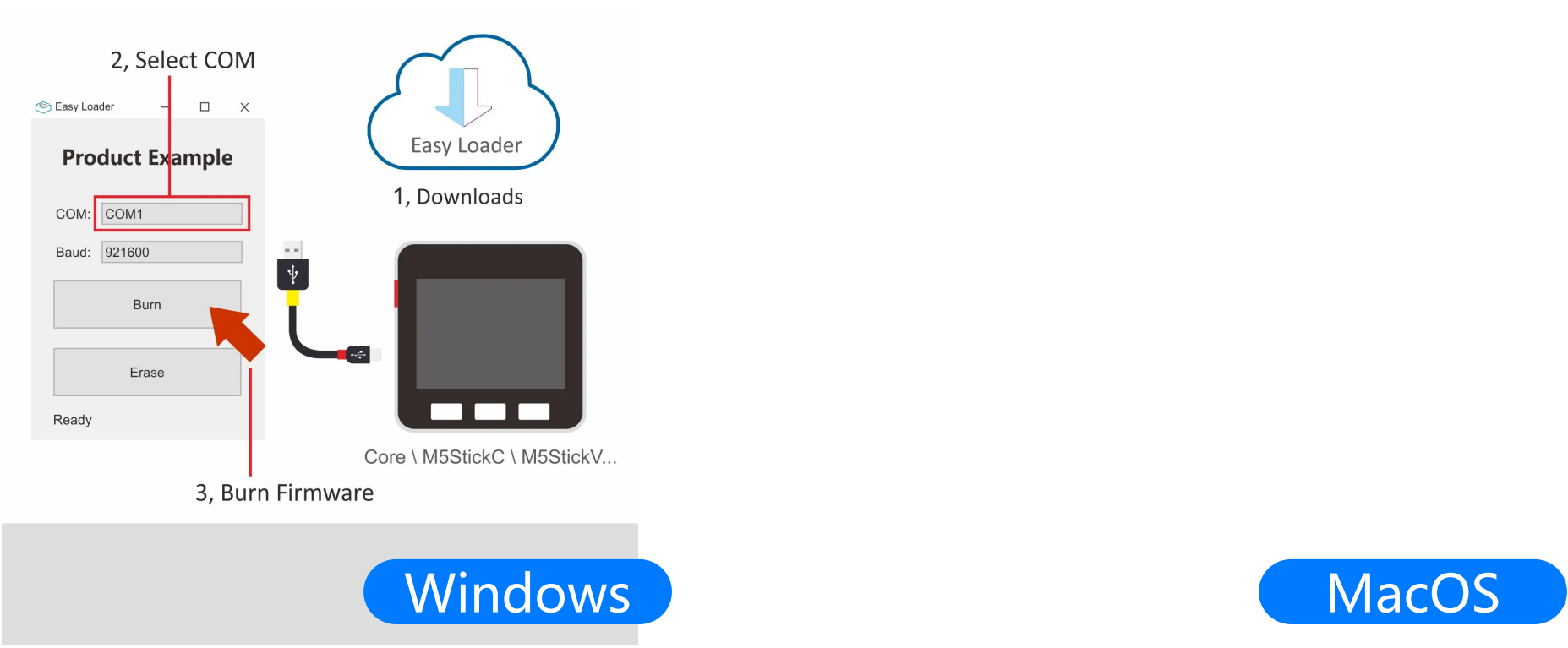

## PinMap

Mega328 ISP Download interface pin definition

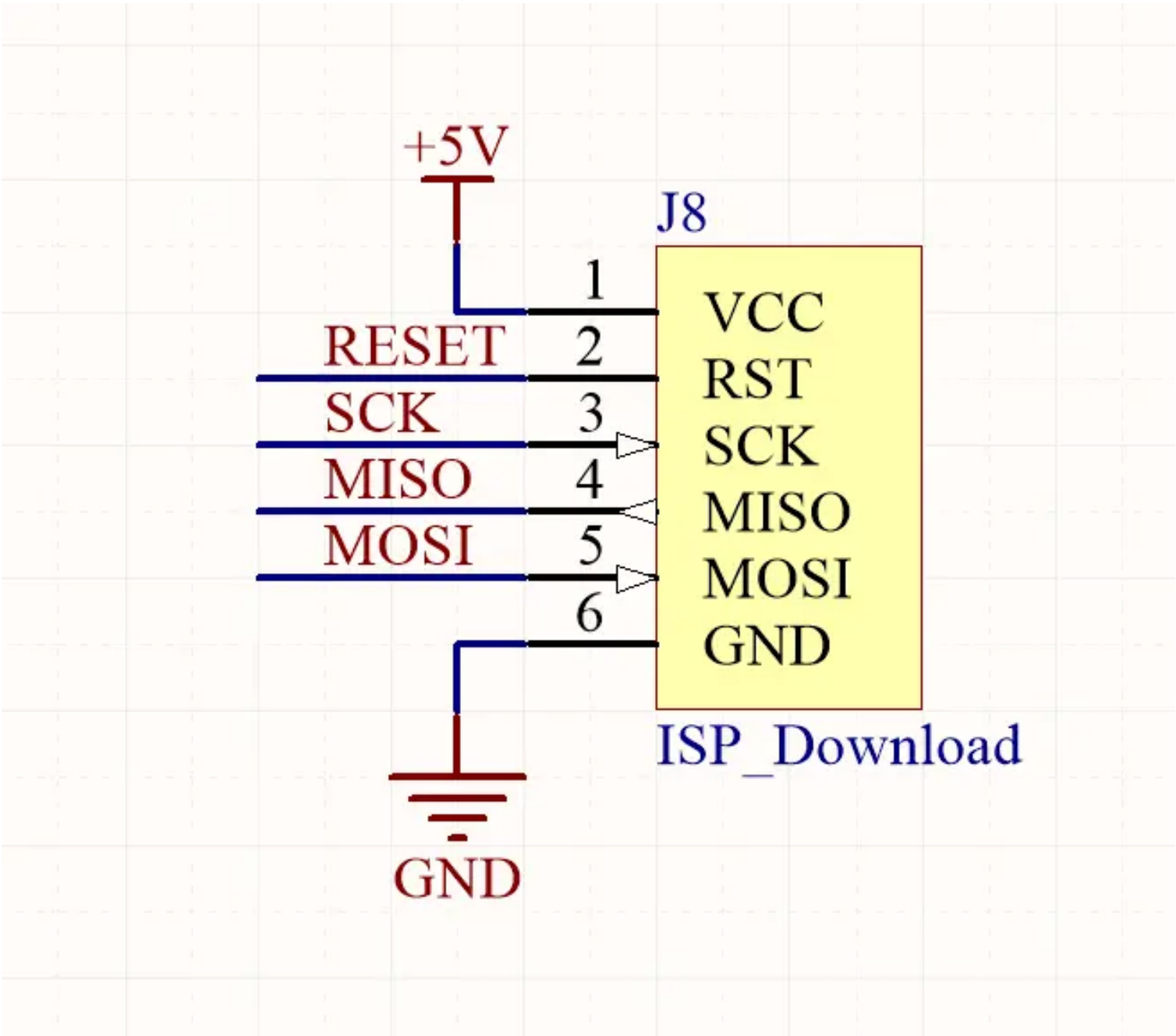

## Related Link

- [Ateml328P firmware](#)

## Schematic

# Calculator

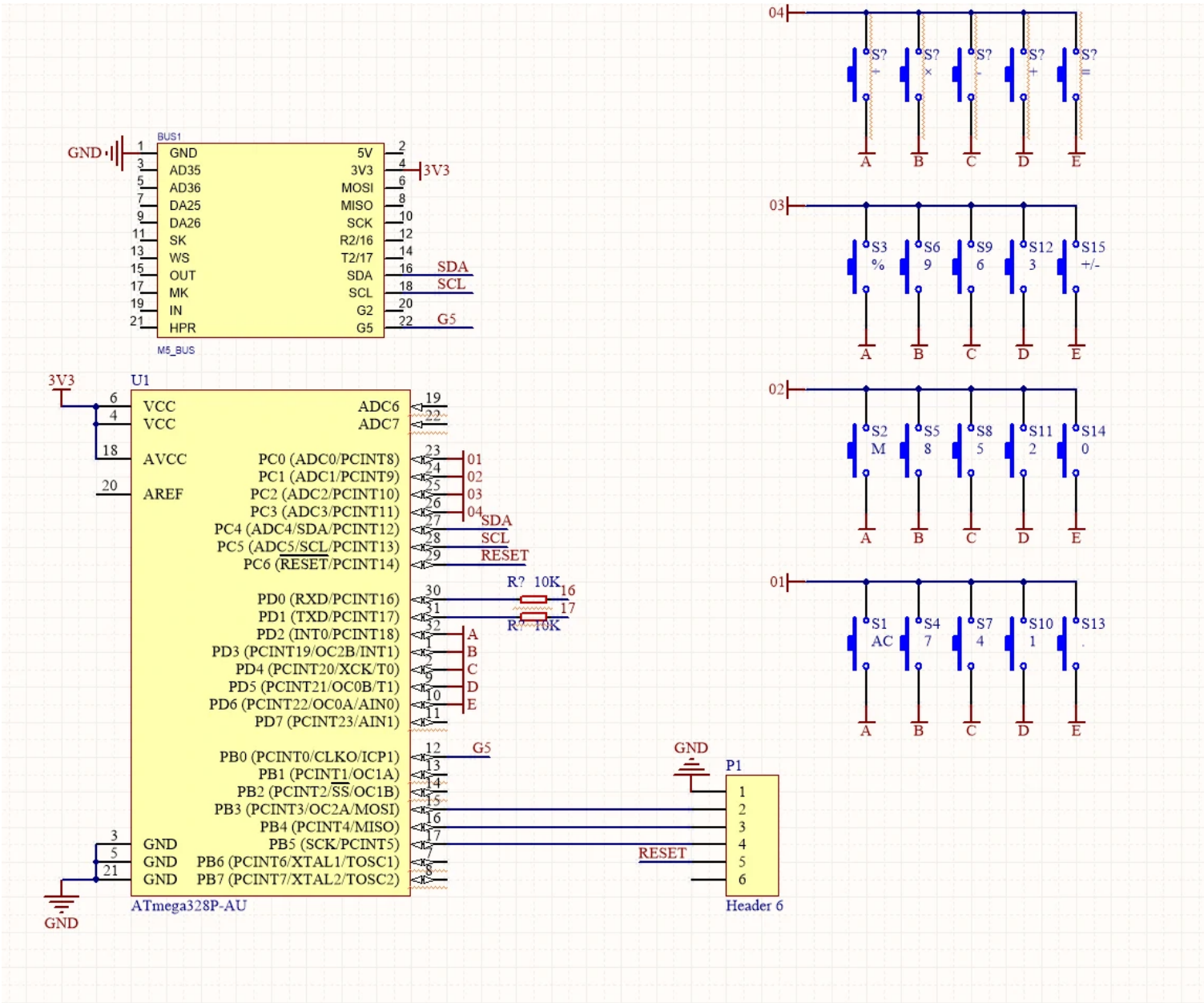

# Example

## ArduinoIDE

- Click [Here](#) to get Arduino example

Last updated: 2020-12-28



# Mouser Electronics

Authorized Distributor

Click to View Pricing, Inventory, Delivery & Lifecycle Information:

[M5Stack:](#)

[A005](#)