

## Peak Emission Wavelength: 660nm

The MTSM3466SMR2-UR is a Red Emitter in a Seam Welded Surface Mount package for applications requiring high output power and efficiency.

### FEATURES

- > 5mm x 5mm Seam Welded Surface Mount Package
- > High Reliability
- > High Output Power
- > Hermetically Sealed Package

### APPLICATIONS

- > Bio Medical Applications
- > Optical Sensors
- > Aerospace
- > Industrial Controls

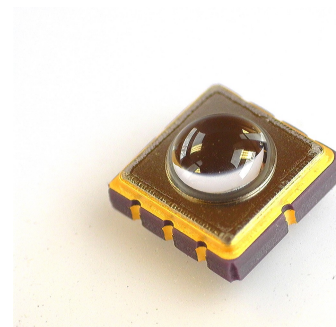

## Absolute Maximum Ratings (Ta=25°C)



ITEMS	SYMBOL	RATINGS	UNIT
Forward Current (DC)	IF	50	mA
Forward Current (Pulse)*1	IFP	0.5	A
Reverse Voltage	VR	5	V
Power Dissipation	PD	--	mW
Operating Temperature Range	Topr	-20 ~ +85	°C
Storage Temperature Range	Tstg	-30 ~ +100	°C

\*1: Tw=10μsec, T=10msec

## Electrical & Optical Characteristics (Ta = 25°C)

ITEMS	SYMBOL	CONDITIONS	MIN	TYP	MAX	UNIT
Forward Voltage	VF	IF=20mA	--	1.7	--	V
Power Output	PO	IF=20mA	--	8	--	mW
Reverse Current	IR	VR=5V	--	--	--	μA
Peak Emission Wavelength	λp	IF=20mA	--	660	--	nm
Dominant Emission Wavelength	λd	IF=20mA	--	648	--	nm
Spectral Line Half Width	Δλ	IF=20mA	--	16	--	nm
Half Intensity Beam Angle	Θ	IF=20mA	--	40	--	deg

## Package Dimensions

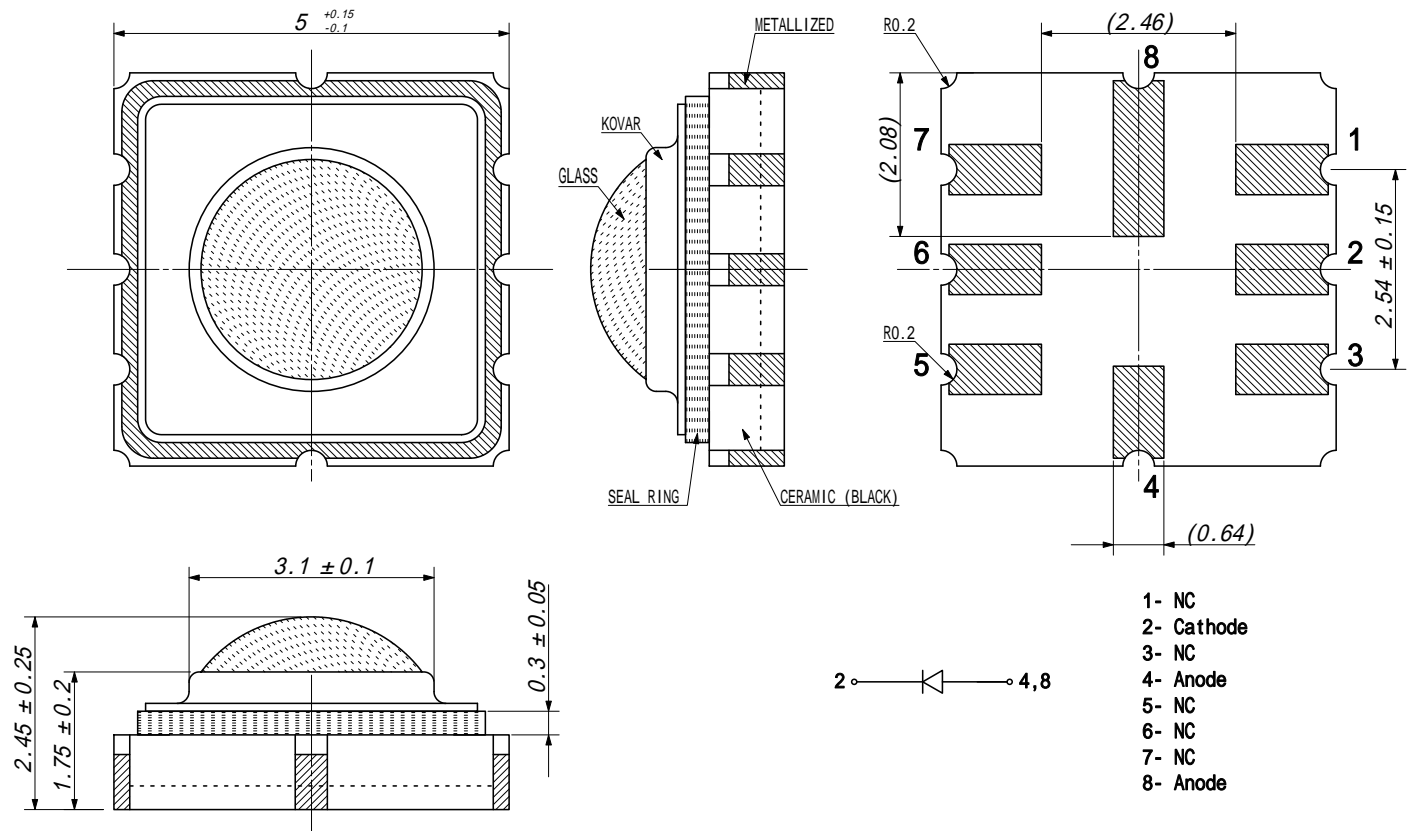

## Recommended Soldering Pattern [mm]

Reflow Soldering Temperature-Profile [Pb free Soldering] (Recommend condition)

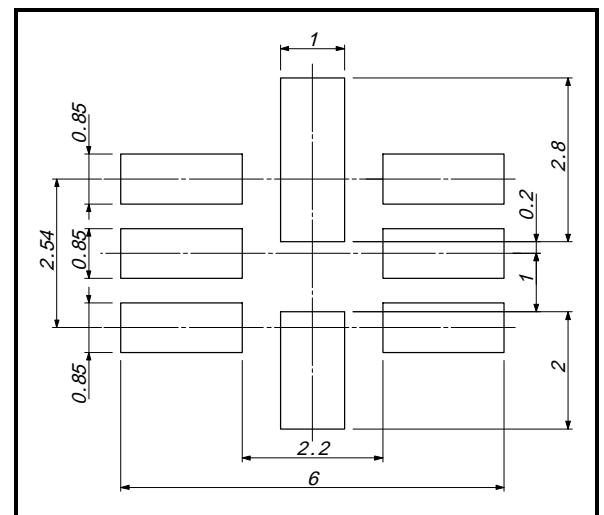
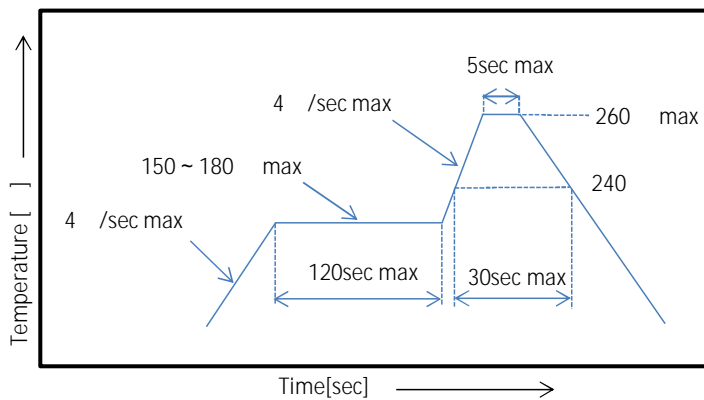

### SPECTRAL RESPONSE

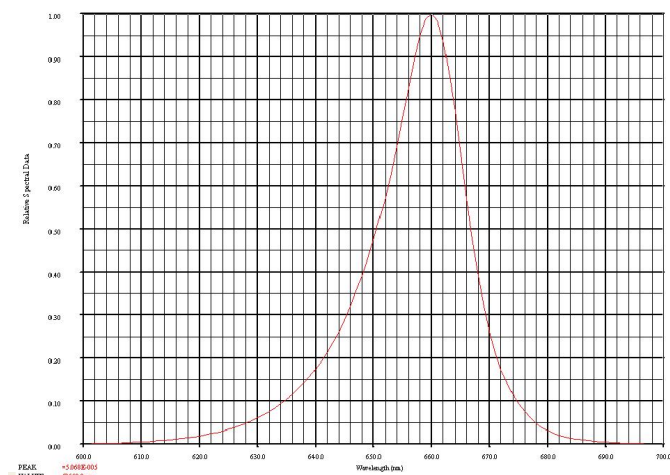

### RADIATION DISTRIBUTION

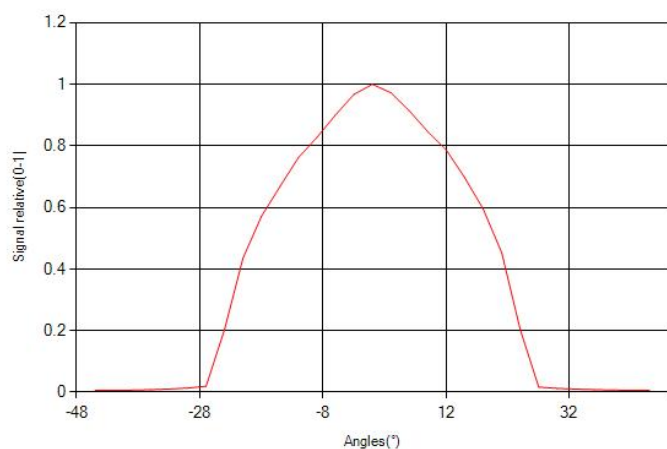

### VIEW ANGLE

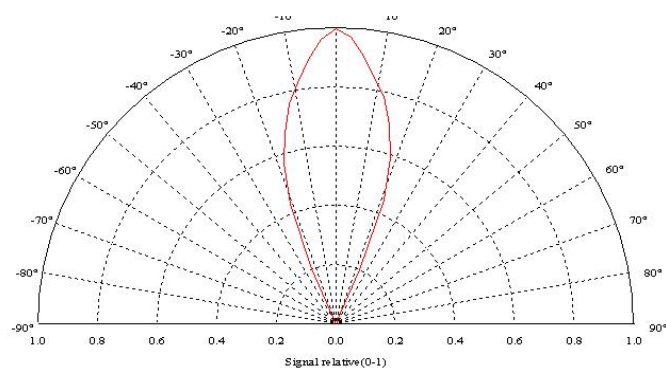

The information contained herein is subject to change without notice.

2023-09-05

Global Headquarters, 3 Northway Lane North, Latham, NY 12110, USA [www.marktechopto.com](http://www.marktechopto.com)

TOLL FREE: 1-800-984-5337 • PHONE: 518-956-2980 • FAX: 518-785-4725 • EMAIL: [info@marktechopto.com](mailto:info@marktechopto.com)

# Mouser Electronics

Authorized Distributor

Click to View Pricing, Inventory, Delivery & Lifecycle Information:

[Marktech Optoelectronics:](#)

[MTSM3466SMR2-UR](#)