

DIALIGHT PART NO.	LED COLOR
598-2M00-107F	WHITE (X=0.24,Y=0.21)
598-2M00-102F	

- NOTES:
- PIN NUMBERS ARE FOR REFERENCE ONLY, DESIGNATION NON-EXISTENT ON PART.
 - LABELING FOR REEL AND OUTSIDE OF ALUMINUM BAG, DIALIGHT P/N, QUANTITY PER REEL, DATE CODE, INTENSITY BIN CODE, LOT NUMBER AND COUNTRY OF ORIGIN.
 - THIS PRODUCT IS RoHS COMPLIANT. EACH BAG IS TO BE MARKED WITH RoHS COMPLIANT LABEL OR EQUIVALENT MARKINGS. LED MUST BE Pb FREE.
 - MOISTURE SENSITIVITY LEVEL 3.
 - QUANTITY : PART NUMBERS END WITH 107F REFER AS 2000 PCS/ REEL
PART NUMBERS END WITH 102F REFER AS 20 PCS/ STRIP

REV	ECN NO	REVISIONS	DRN	CKD	APP	DATE
A	106183	NEW RELEASE	JSG	CS	NO	31MAY23

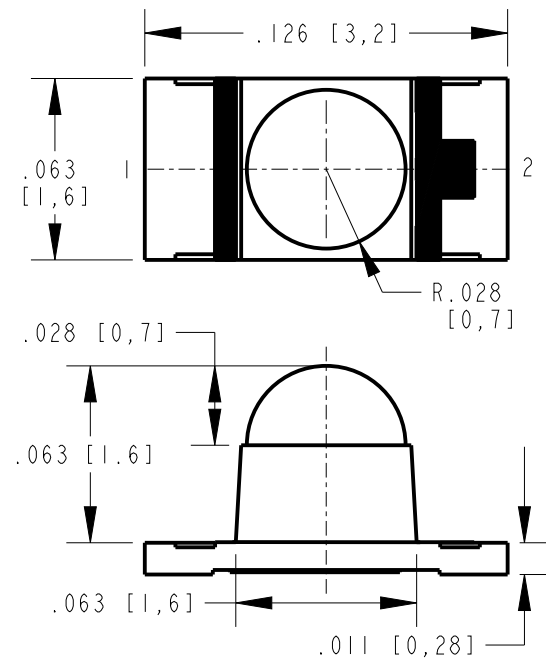

Carrier Tape Dimension

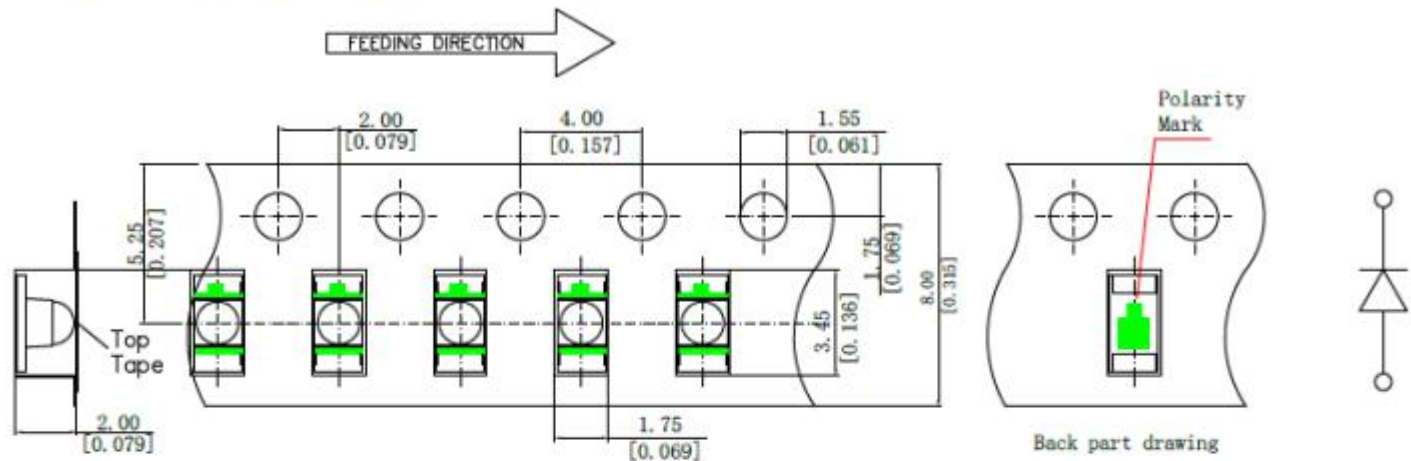

TAPING SPECIFICATIONS

RECOMMENDED RoHS SOLDER PROFILE

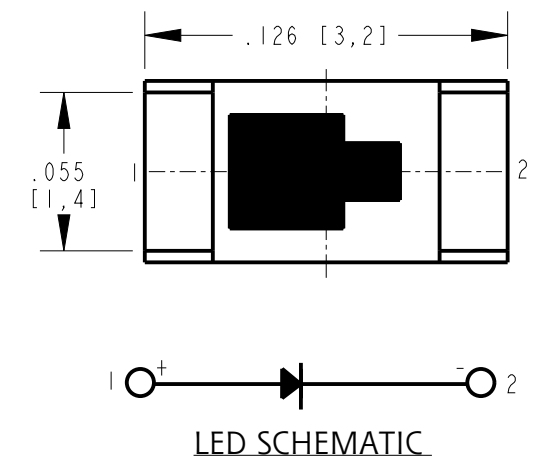
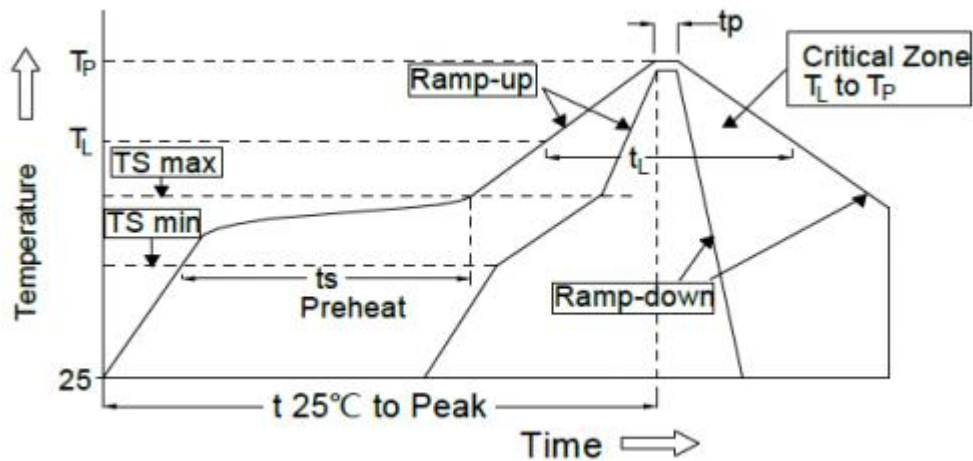

Reel Dimension

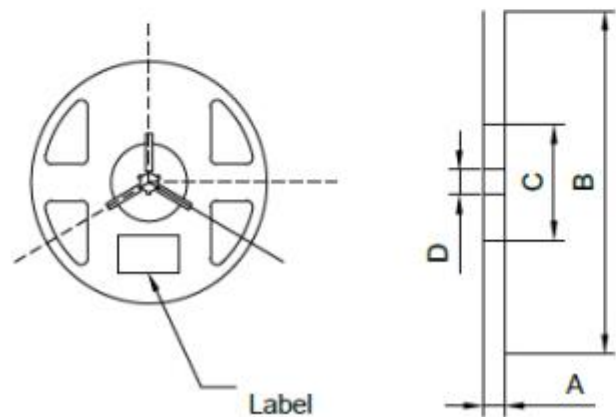

A	8.0±0.1mm
B	178±1mm
C	60±1mm
D	13.0±0.5mm

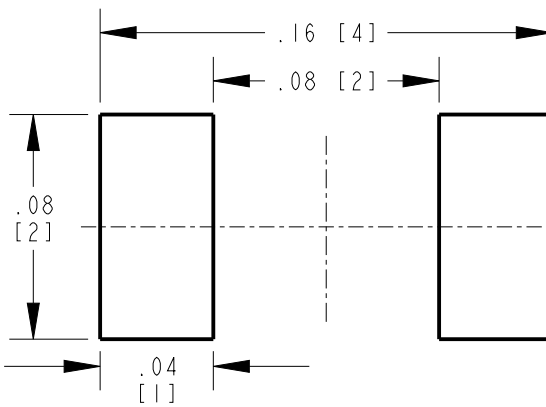

RECOMMENDED SOLDER PAD LAYOUT

TOLERANCE (UNLESS OTHERWISE SPECIFIED): ±0.003(±0.1mm)

ABSOLUTE MAXIMUM RATINGS AT 25°C							
LED COLOR	POWER DISSIPATION (mW)	FORWARD CURRENT (mA)	PEAK FORWARD CURRENT (mA)	OPERATING TEMPERATURE (°C)	STORAGE TEMPERATURE (°C)	DERATING CURVE FROM 25°C (mA/°C)	ELECTROSTATIC DISCHARGE (V)
WHITE	108	30	60	-40°C TO +85°C	-40°C TO +85°C	0.417	1000

OPERATING CHARACTERISTICS AT 25°C AMBIENT									
LED COLOR	TEST CONDITION (mA)	LUMINOUS INTENSITY (mcd)		FORWARD VOLTAGE (V)		CHROMATICITY COORDINATES (CALCULATED)	REVERSE CURRENT (uA)	VIEWING ANGLE (DEGREES)	THERMAL RESISTANCE °C/W
		TYP	MIN	MAX	MIN	MAX	TYP	MAX	MAX
WHITE	20mA	280	280	650	2.8	3.6	X=0.287 Y=0.286	10µA @ VR=5V/10ms	140 450

MARK	DEFINITION	CONDITION
TS_{max}	MAXIMUM OF PRE-HEATING TEMPERATURE	200°C
TS_{min}	MINIMUM OF PRE-HEATING TEMPERATURE	150°C
T_s	TIME FORM TS_{min} To TS_{max}	60s-120s
T_L	REFERENCE TEMPERATURE	217°C
t_L	RETENTION TIME FOR T_L	60s-150s
T_p	PEAK TEMPERATURE	260°C
t_p	TIME FOR PEAK TEMPERATURE	WITHIN 10s
DTr/Dt	TEMPERATURE RISING RATE	WITHIN 3°C/sec
DTd/Dt	TEMPERATURE DECREASING RATE	WITHIN 6°C/sec



ATTENTION:
OBSERVE PRECAUTIONS FOR
HANDLING ELECTROSTATIC
SENSITIVE DEVICES

THIS DRAWING AND THE CONTENTS HEREIN ARE CONFIDENTIAL AND THE SOLE PROPERTY OF DIALIGHT CORP. REPRODUCTION OF THIS DRAWING OR CONSTRUCTION OF ANY PARTS WITHIN THIS DRAWING ARE FORBIDDEN WITHOUT THE WRITTEN CONSENT OF DIALIGHT CORP.			
DIALIGHT CORP. INTERNAL REFERENCE ONLY = 3D MODEL : 4500521863023- .1			
SCALE: 21.000		DRAWING NUMBER	
ALL DIM's: INCH (mm)		REV	
TOLERANCES: UNLESS OTHERWISE SPECIFIED		C-18671	
FRACTIONS: $\pm 1/64$		TITLE	
DECIMALS (.XX): $\pm .01$		1206 SM LED WITH DOME LENS	
DECIMALS (.XXX): $\pm .005$		MATERIAL	
DECIMALS (.XXXX): $\pm .0005$			
ANGLES: $\pm 1^{\circ}$			
FINISH			
FSCM 83330			
SHEET		FAMILY TABLE:	
1		OF 1	

Mouser Electronics

Authorized Distributor

Click to View Pricing, Inventory, Delivery & Lifecycle Information:

Dialight:

[598-2M00-107F](#)