

DIALIGHT PART NUMBER	LED COLOR
521-9651F	RED/GREEN BI-COLOR
521-9724F	YELLOW/GREEN BI-COLOR

**RoHS COMPLIANT 521-9651F & 521-9724F**

Part Numbers with the "F" suffix ending are RoHS Compliant. Packaging is marked with "RoHS Compliant" label or equivalent markings. Parts can be wave soldered, dip soldered or hand soldered using typical lead-free soldering process with max 260°C temp. for 5 sec.



**ATTENTION:**  
OBSERVE PRECAUTIONS FOR  
HANDLING ELECTROSTATIC  
SENSITIVE DEVICES

REV	ECN NO	REVISIONS	DRN	CKD	APP	DATE
A		NEW RELEASE	KLJ	7.8	4/15/09	

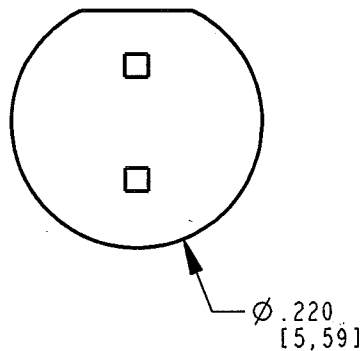
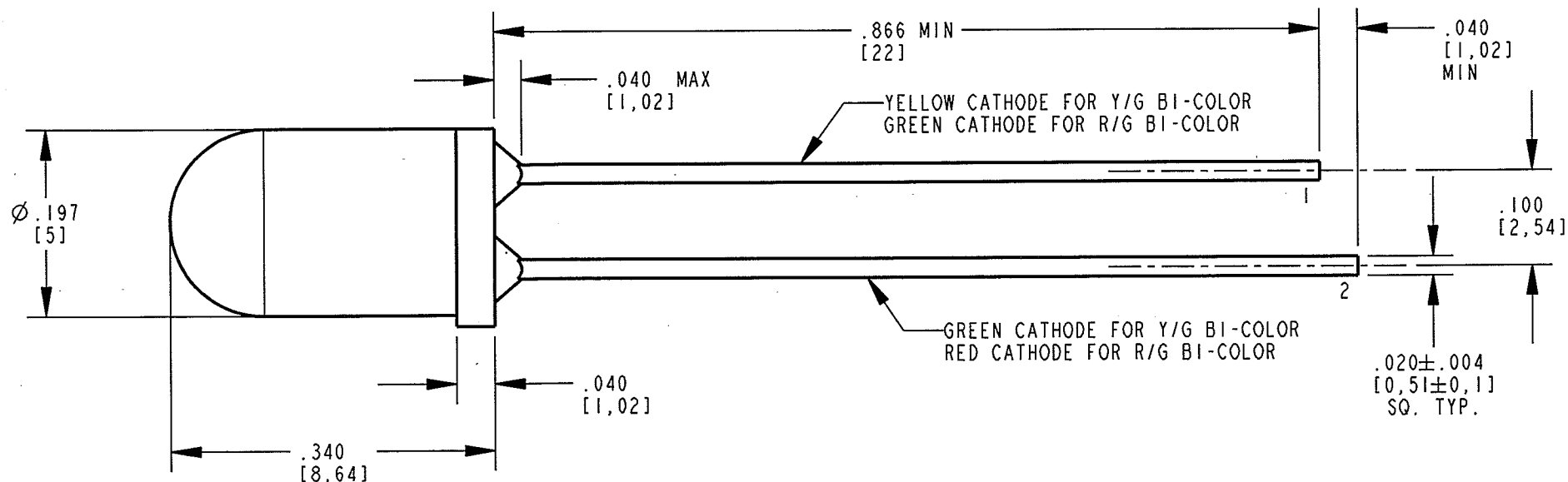

OPERATING CHARACTERISTICS AT 25°C AMBIENT								
BI-COLOR LED	COLOR	LUMINOUS INTENSITY @I <sub>F</sub> = 20 mA (mcd)		FORWARD VOLTAGE @I <sub>F</sub> = 20 mA (V)		REVERSE CURRENT (μA)	PEAK WAVELENGTH (nm)	VIEWING ANGLE (DEG)
		MIN	TYP	TYP	MAX	MAX	TYP	TYP
YELLOW/GREEN	YELLOW	2.5	8.7	2.1	2.8	100	585	50
	GREEN						565	
RED/GREEN	RED	29	90	1.8	2.4	100	660	60
	GREEN	12.6	40	2.1	2.8		565	

ABSOLUTE MAXIMUM RATINGS AT 25°C AMBIENT		UNITS	Y/G BI-COLOR		R/G BI-COLOR	
			YELLOW	GREEN	RED	GREEN
POWER DISSIPATION		mW	60	100	100	100
FORWARD DC CURRENT		mA	20	30	40	30
DERATING LINEAR FROM 50°C		mA/°C	0.25	0.40	0.50	0.40
SOLDERING TEMPERATURE, 5 SEC., 1/16" FROM BODY		°C	260			
OPERATING TEMPERATURE		°C	-55 TO +100			
STORAGE TEMPERATURE		°C	-55 TO +100			

**NOTES:**

1. DIE: GaAsP/GaP (YELLOW/GREEN)  
AlGaAs/GaP (RED/GREEN)
2. LENS COLOR: WHITE DIFFUSED
3. LEAD SPACING MEASURED NEAR EPOXY PACKAGE.
4. TERMINATION FINISH: 60-100 μin SILVER (Ag) OVER 30-50 μin COPPER (Cu) OVER 10-30 μin NICKEL (Ni) OVER 30 μin COPPER (Cu) ON MILD STEEL BASE METAL.
5. PIN NUMBERS FOR REFERENCE ONLY, DESIGNATION NON-EXISTENT ON PART.
6. DIALIGHT PART NUMBERS: 521-9651F; 521-9724F
7. PACKAGING: BULK
8. LABELING: BAGS TO BE IDENTIFIED WITH DIALIGHT P/N, QTY, DATE CODE, AND INTENSITY AND COLOR BIN CATEGORIES.
9. THIS ASSEMBLY CONTAINS ELECTROSTATIC DISCHARGE SENSITIVE DEVICES (ESDS). MAINTAIN ALL PRECAUTIONARY MEASURES DURING ASSEMBLY, HANDLING, AND STORAGE IN ACCORDANCE WITH IPC-A-610.

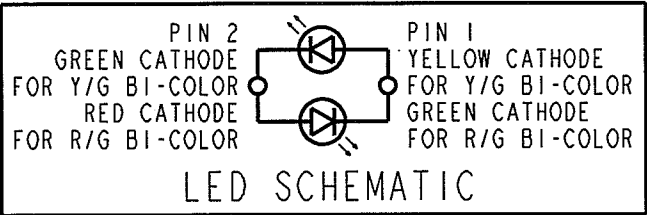

THIS DRAWING AND THE CONTENTS HEREIN ARE CONFIDENTIAL AND THE SOLE PROPERTY OF DIALIGHT. REPRODUCTION OF THIS DRAWING OR CONSTRUCTION OF ANY PARTS WITHIN THIS DRAWING ARE FORBIDDEN WITHOUT THE WRITTEN CONSENT OF DIALIGHT.		
SCALE: 4.000	DRAWING NUMBER	REV
ALL DIM'S IN: INCHES (MM)	C-17695	A
TOLERANCES: UNLESS OTHERWISE SPECIFIED	TITLE Ø5mm BI-COLOR LED RoHS COMPLIANT	
FRACTIONS: ±1/64 DECIMALS (.XX): ±.02 DECIMALS (.XXX): ±.010	MATERIAL	
ANGLES: ±3°	1501 ROUTE 34 SOUTH FARMINGDALE, NJ 07727	
FINISH:		
FSCM 83330	SHEET 1 OF 1	FAMILY TABLE:

# Mouser Electronics

Authorized Distributor

Click to View Pricing, Inventory, Delivery & Lifecycle Information:

Dialight:

521-9651F