

TYPE 104
SAME AS TYPE 101
EXCEPT AS SHOWN

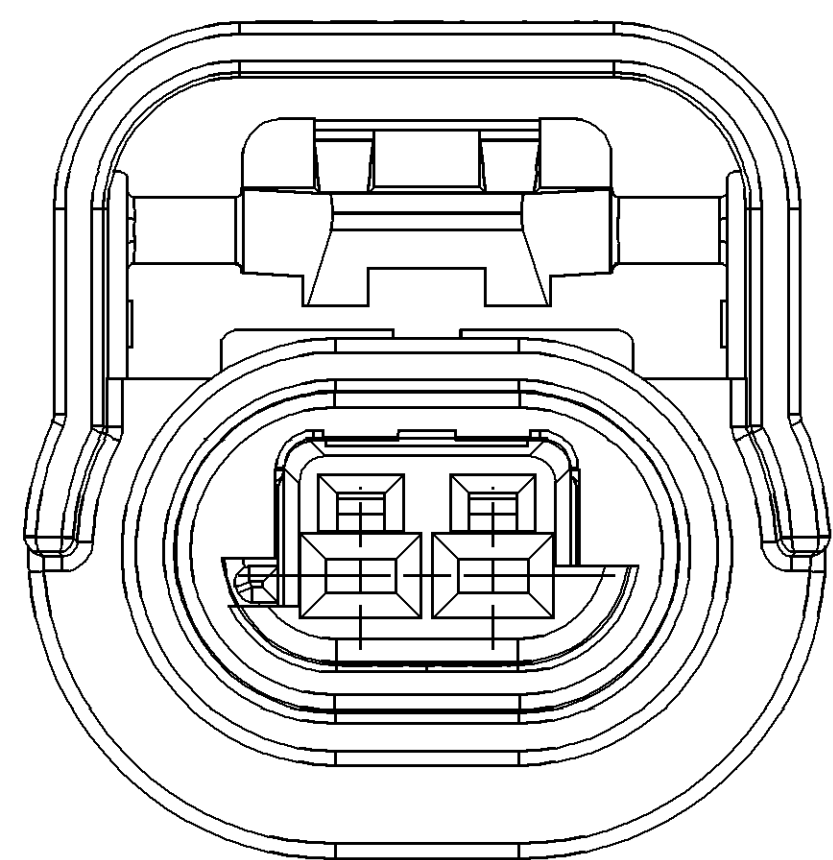

TYPE 103
SAME AS TYPE 101
EXCEPT AS SHOWN

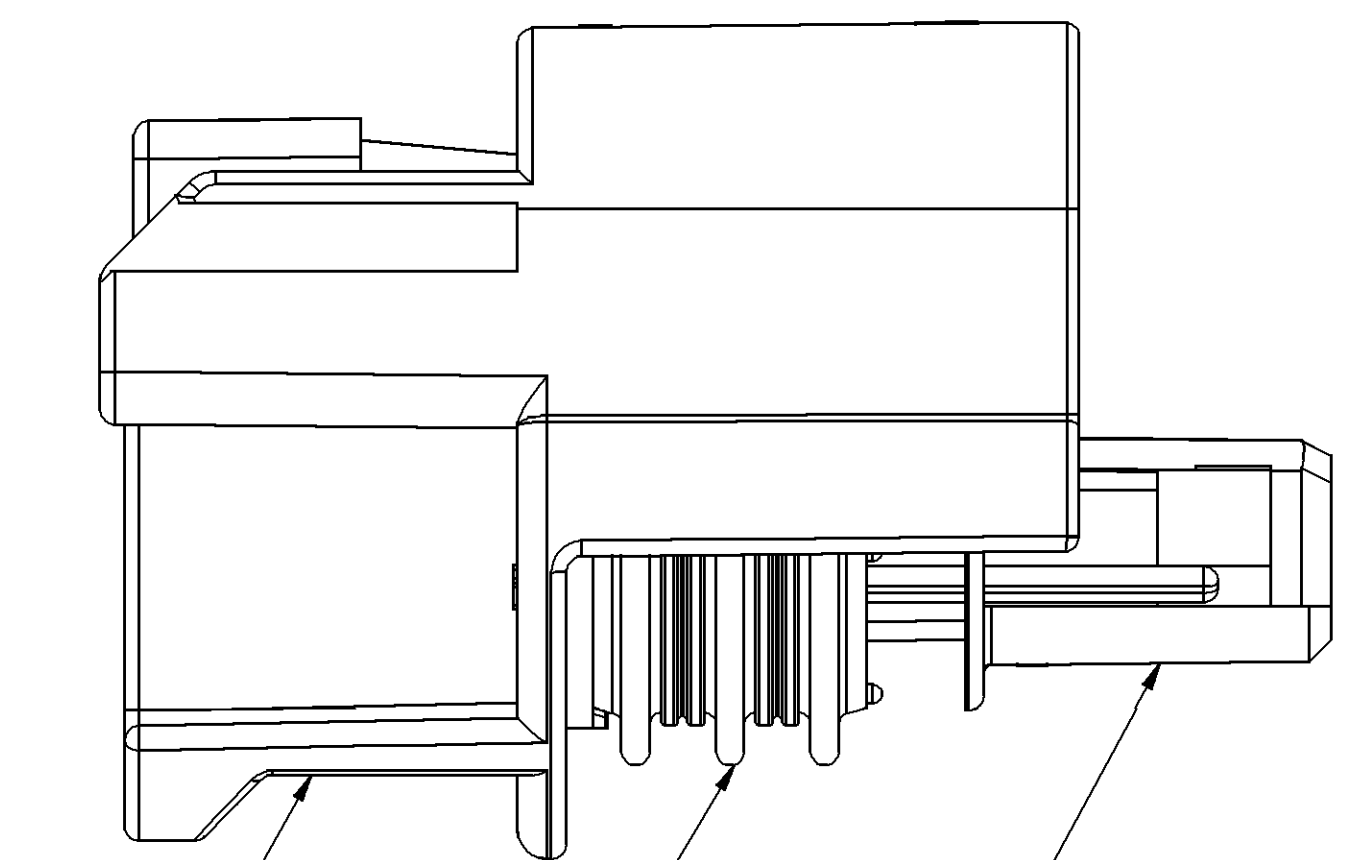
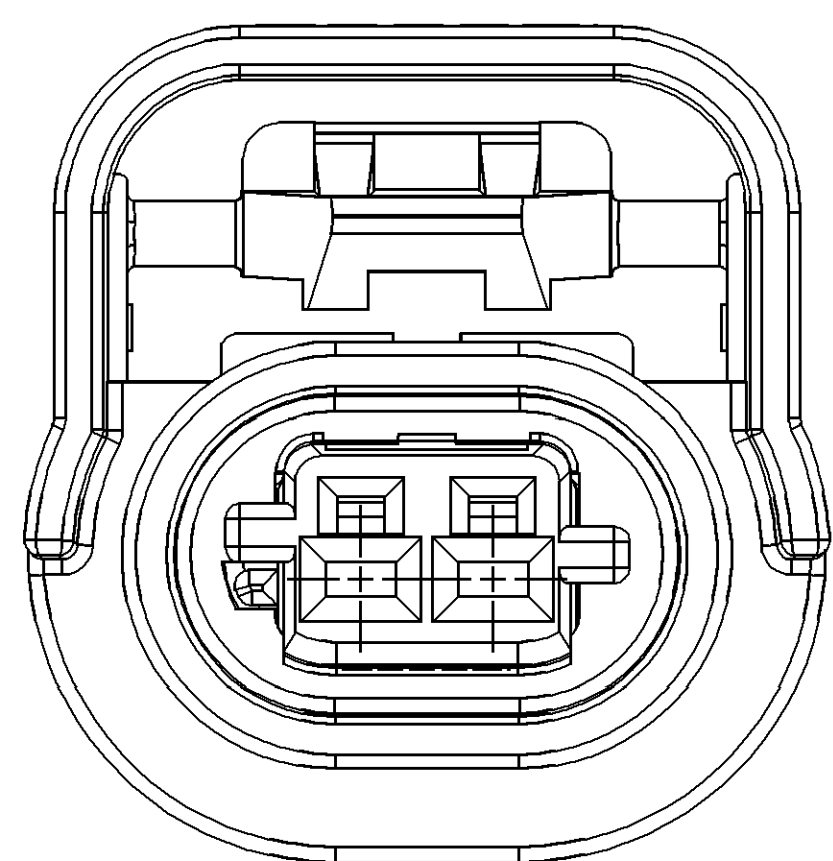
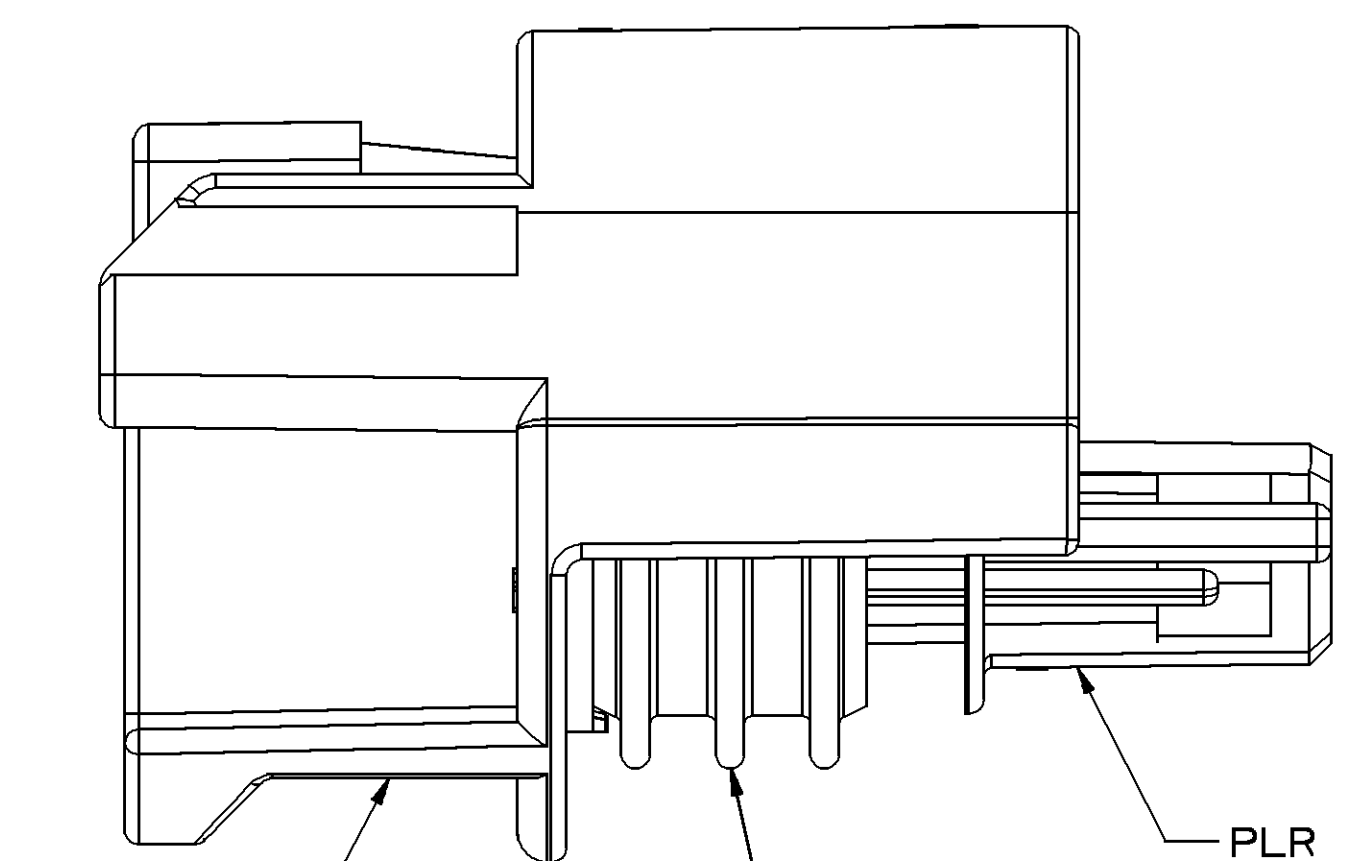

TYPE 102
SAME AS TYPE 101
EXCEPT AS SHOWN

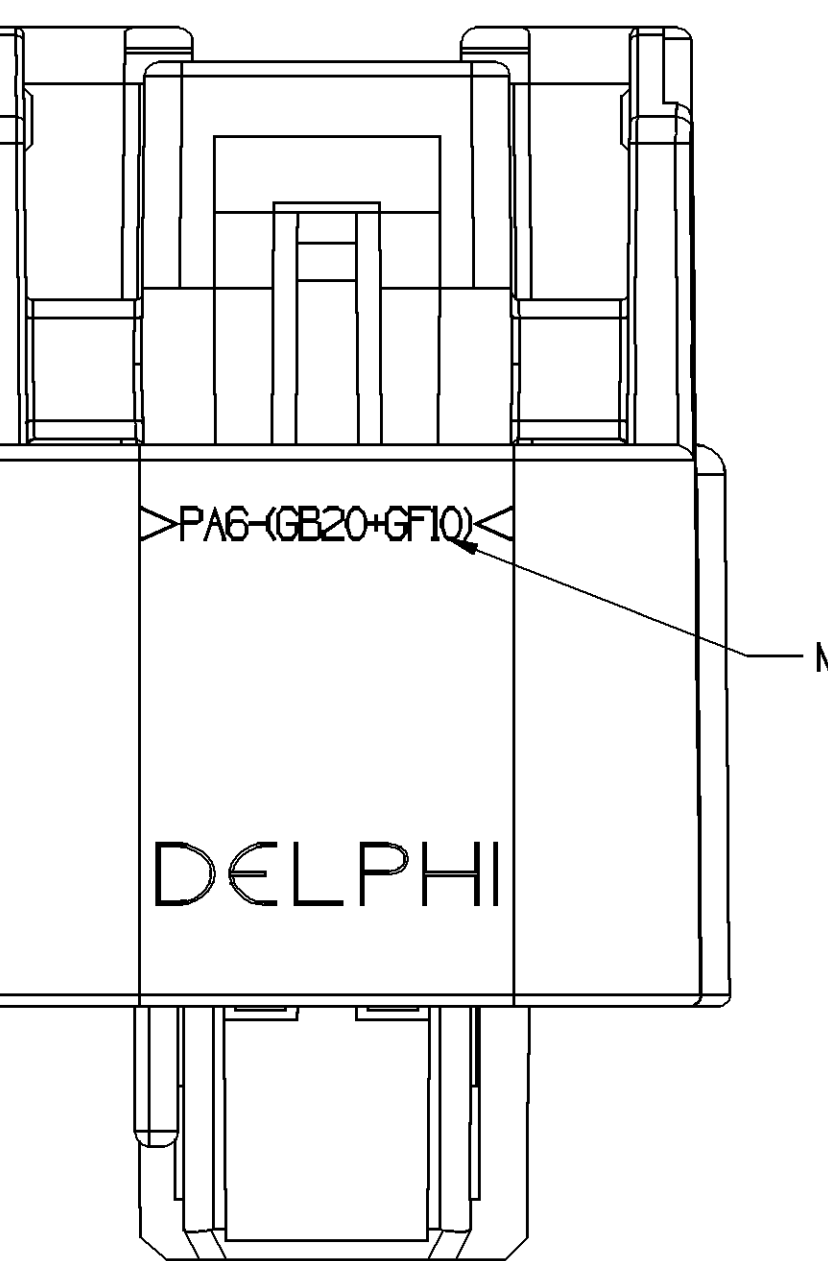
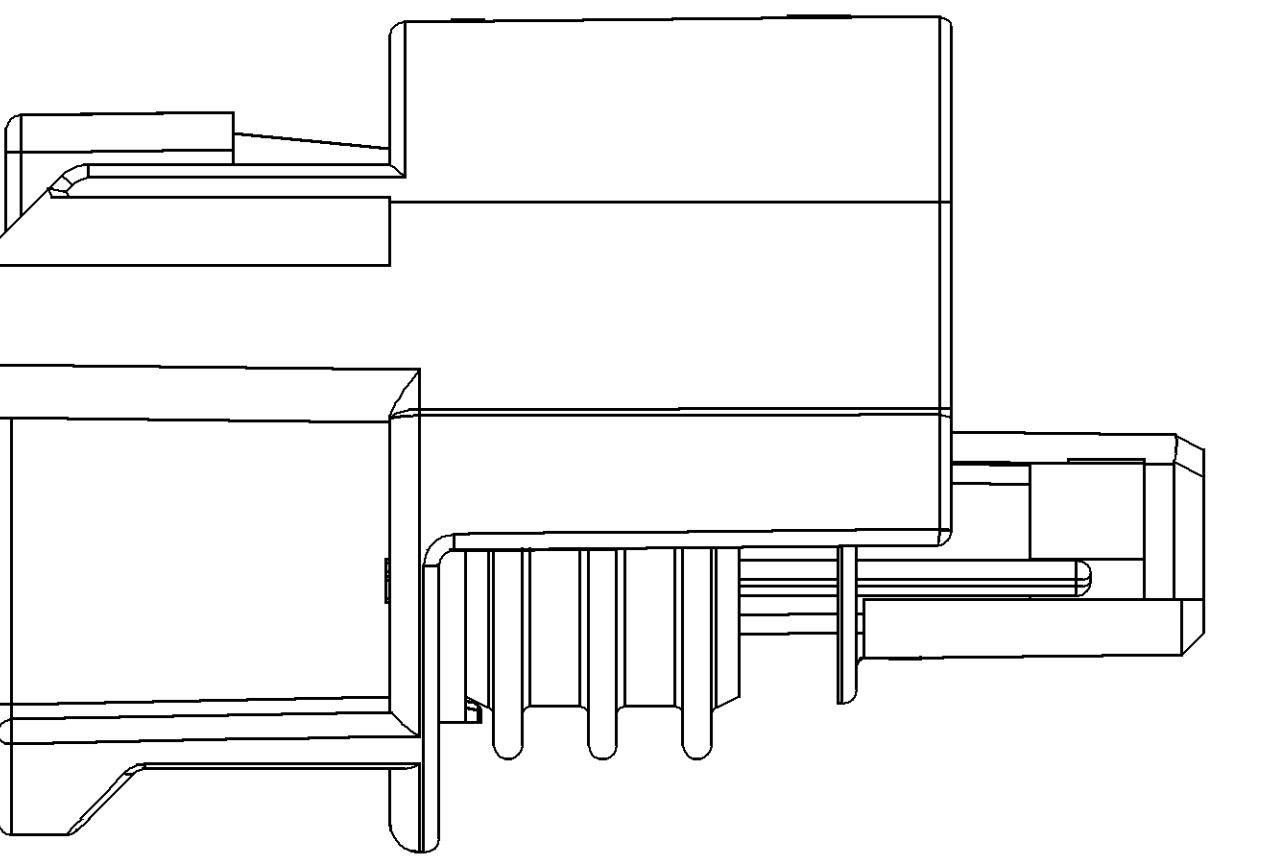

MATERIAL RECYCLING CODE - SEE CHART

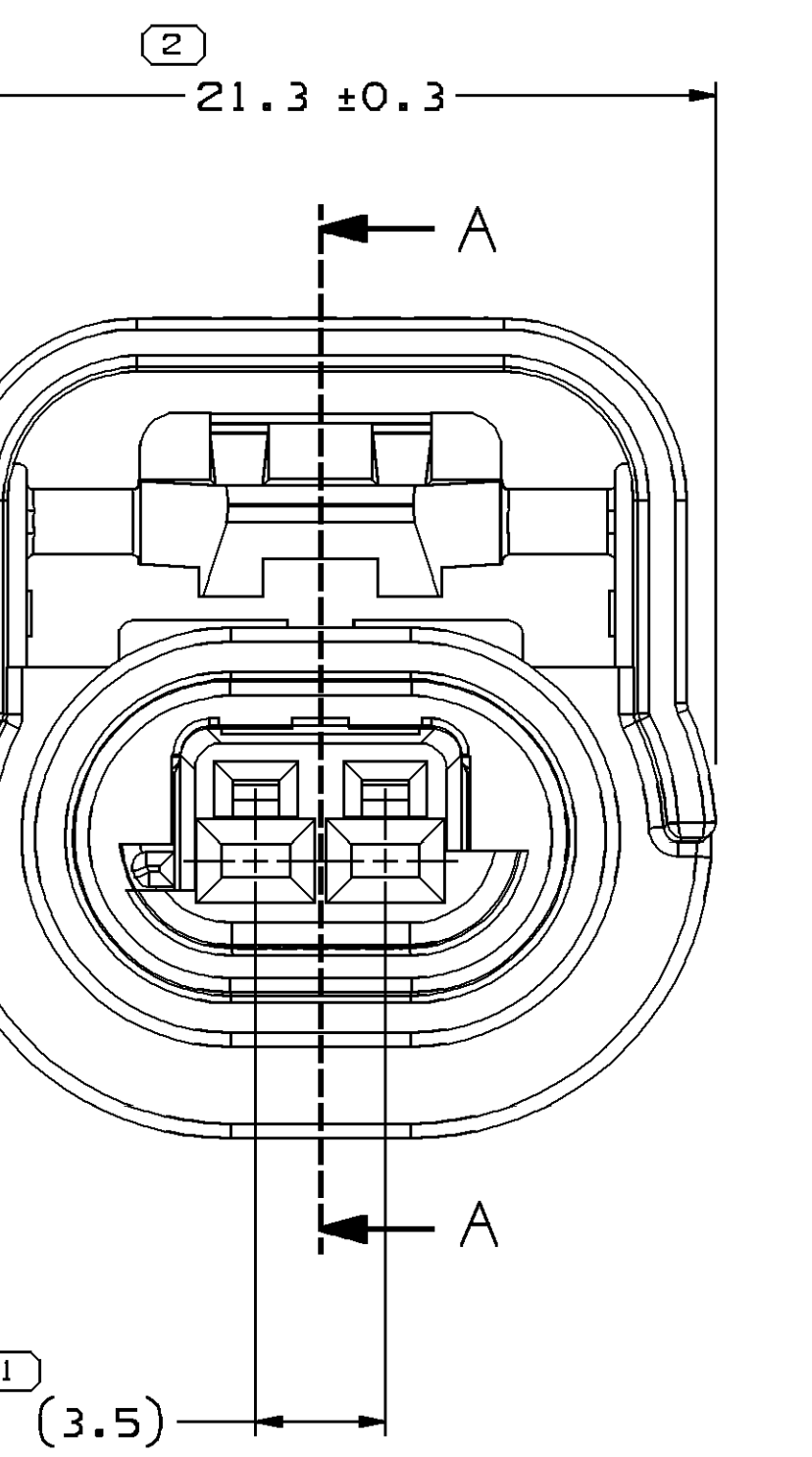

TYPE 101

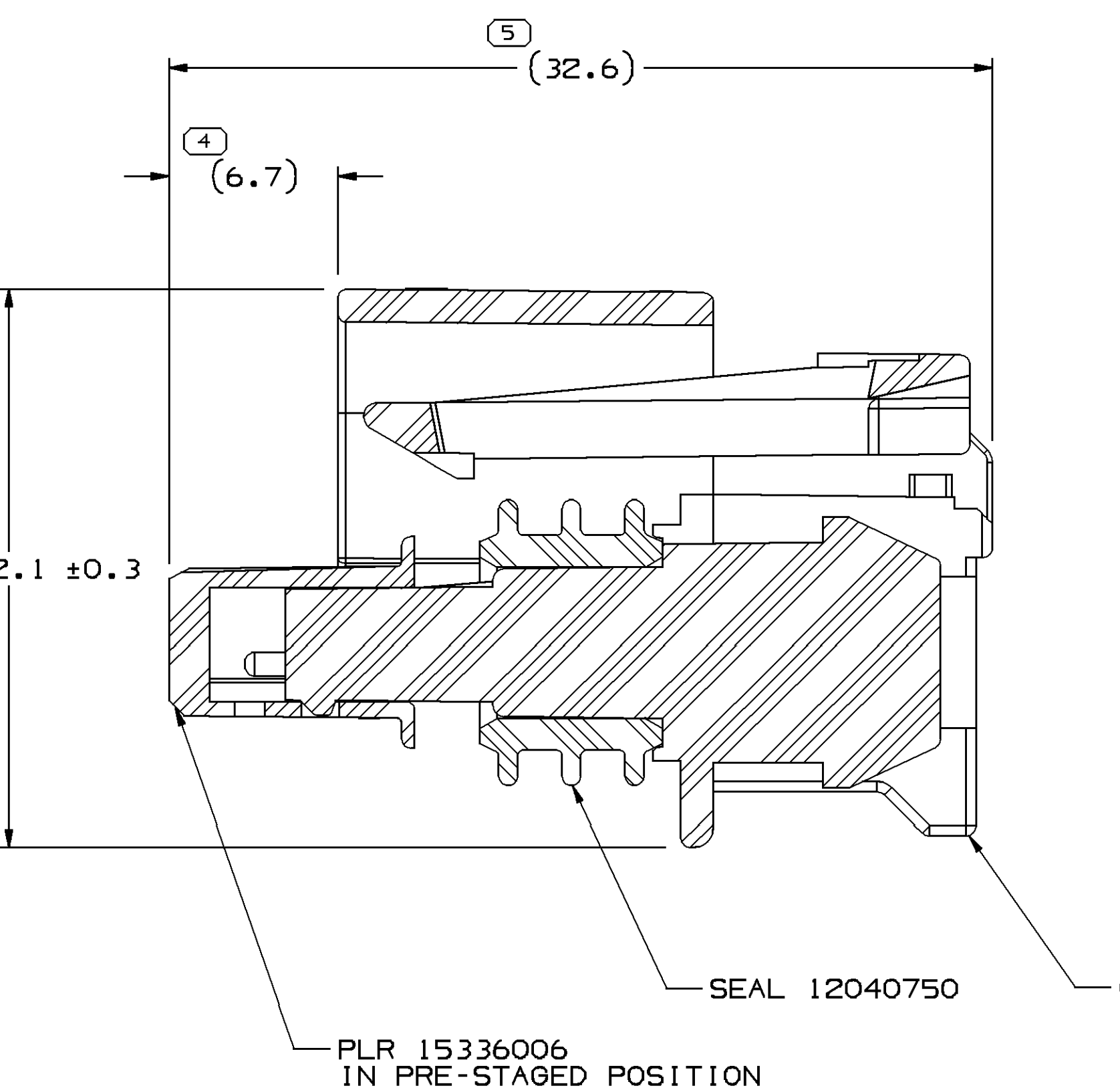
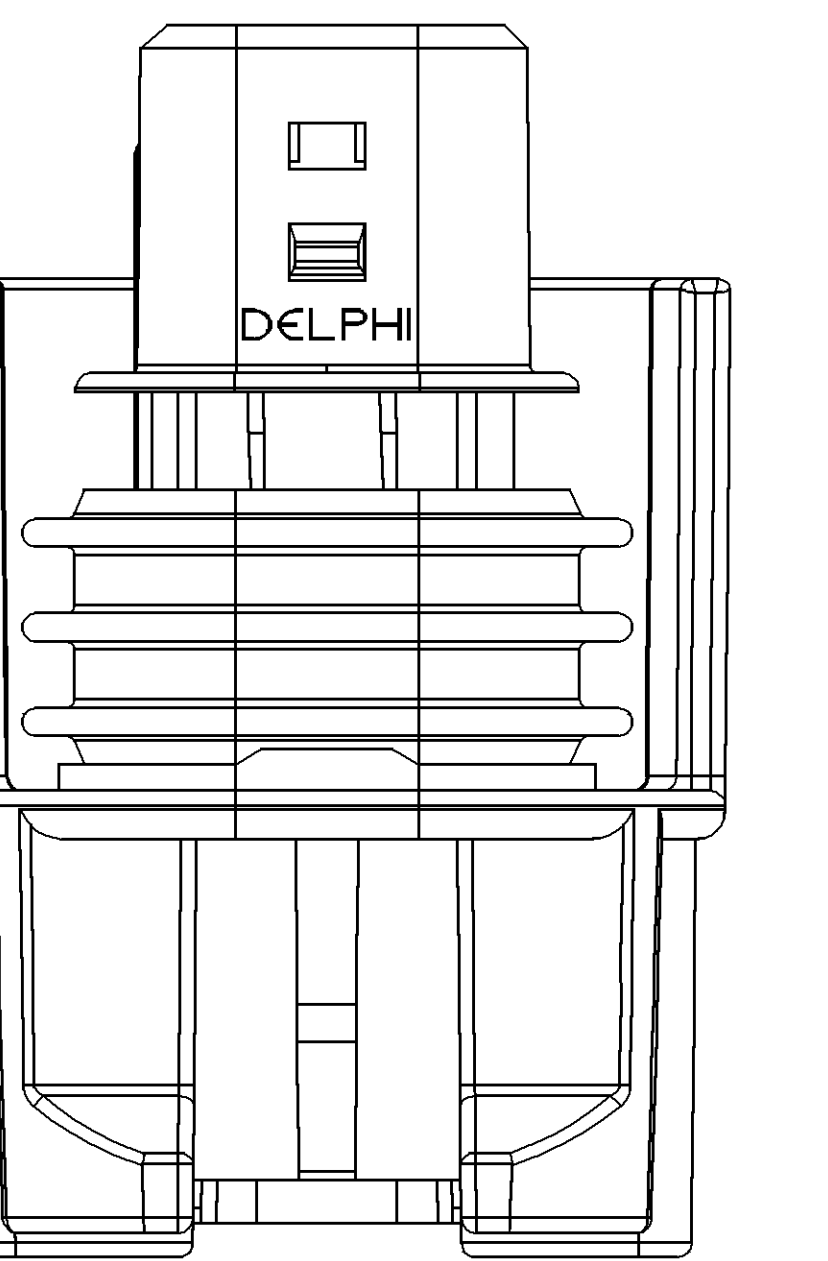

SECTION A-A

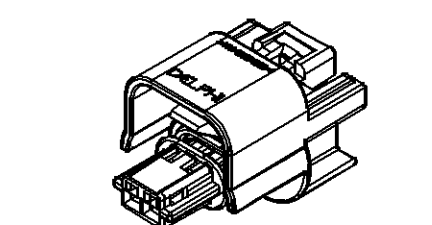
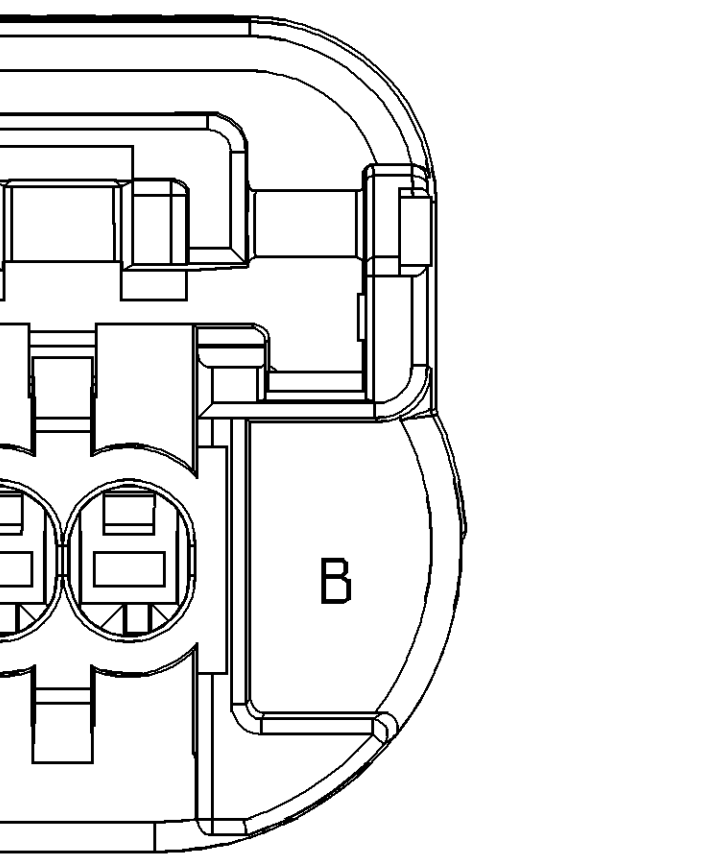

TYPE 101

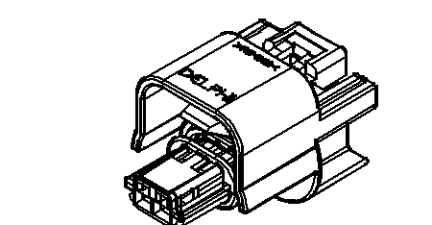

TYPE 102
SAME AS TYPE 101
EXCEPT AS SHOWN

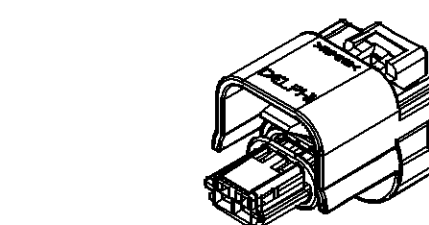

TYPE 103
SAME AS TYPE 101
EXCEPT AS SHOWN



TYPE 104
SAME AS TYPE 101
EXCEPT AS SHOWN

- NOTES
- UNLESS OTHERWISE SPECIFIED AND/OR INDICATED:
DIMENSIONS ARE TO FACE OF VIEW SHOWN AND AUTOMATICALLY ROUNDED BY COMPUTER FOR INSPECTION (SEE MATH MODEL FOR PRECISE DIMENSIONS). FOR ALL OTHER DIMENSIONS NOT SHOWN BUT REQUIRED FOR TOOL BUILD, SEE MATH MODEL FOR PRECISE TOOL PATH DATA.
 - THIS PART ACCEPTS THE FOLLOWING COMPONENTS OR EQUIVALENT:
TERMINAL 15326266
CABLE SEAL 15366022
TERMINAL POSITION ASSURANCE LOCK 15305024 OR 15358990
CAVITY PLUG 15305171
CONNECTOR POSITION ASSURANCE LOCK 15317832 OR 15496486
 - FOR MATING CONFIGURATION REQUIREMENTS SEE CHART.
 - THIS CONNECTION MEETS OR EXCEEDS SAE/USCAR-2 MAY 2004, SECTION 5.4.1.4 TERMINAL DISENGAGE CRITERIA WITH THE APPLICATION OF A TERMINAL POSITION ASSURANCE (TPA) SECONDARY LOCK.

PART NO	REV	N/P	STATUS	TYPE	CONNECTOR	CONN COLOR	MATERIAL RECYCLING CODE	PLR	CONN SEAL	USCAR MATING CONFIG
13523048	02	AA	-	104	13523049	GRA	PBT-6F20	15335989	13511248	150-S-002-1-B04
13520104	02	AA	-	104	13520102	BLK	PBT-6F20	15335989	13511248	150-S-002-1-B04
13520101	02	AA	-	103	13520102	BLK	PBT-6F20	15336006	13511248	150-S-002-1-A04
13513314	01	AD	-	102	15490465	BLK	PA6-(GB20+GF10)	15335989	12040750	150-S-002-1-B04
15490464	02	AE	-	101	15490465	BLK	PA6-(GB20+GF10)	15336006	12040750	150-S-002-1-A04

DATE	STG	REV	N/P	CHG	ZONE
190004	R	01	-	-	-
25JAO5	R	02	-	-	-

DATE	STG	REV	N/P	CHG	ZONE
190004	R	01	-	-	-
25JAO5	R	02	-	-	-

DATE	STG	REV	N/P	CHG	ZONE
190004	R	01	-	-	-
25JAO5	R	02	-	-	-

DATE	STG	REV	N/P	CHG	ZONE
190004	R	01	-	-	-
25JAO5	R	02	-	-	-

DATE	STG	REV	N/P	CHG	ZONE
190004	R	01	-	-	-
25JAO5	R	02	-	-	-

DATE	STG	REV	N/P	CHG	ZONE
190004	R	01	-	-	-
25JAO5	R	02	-	-	-

DATE	STG	REV	N/P	CHG	ZONE
190004	R	01	-	-	-
25JAO5	R	02	-	-	-

DATE	STG	REV	N/P	CHG	ZONE
190004	R	01	-	-	-
25JAO5	R	02	-	-	-

DATE	STG	REV	N/P	CHG	ZONE
190004	R	01	-	-	-
25JAO5	R	02	-	-	-

DATE	STG	REV	N/P	CHG	ZONE
190004	R	01	-	-	-
25JAO5	R	02	-	-	-

DATE	STG	REV	N/P	CHG	ZONE
190004	R	01	-	-	-
25JAO5	R	02	-	-	-

DATE	STG	REV	N/P	CHG	ZONE
190004	R	01	-	-	-
25JAO5	R	02	-	-	-

DATE	STG	REV	N/P	CHG	ZONE
190004	R	01	-	-	-
25JAO5	R	02	-	-	-

DATE	STG	REV	N/P	CHG	ZONE
190004	R	01	-	-	-
25JAO5	R	02	-	-	-

DATE	STG	REV	N/P	CHG	ZONE
190004	R	01	-	-	-
25JAO5	R	02	-	-	-

DATE	STG	REV	N/P	CHG	ZONE
190004	R	01	-	-	-
25JAO5	R	02	-	-	-

DATE	STG	REV	N/P	CHG	ZONE
190004	R	01	-	-	-
25JAO5	R	02	-	-	-

DATE	STG	REV	N/P	CHG	ZONE
190004	R	01	-	-	-
25JAO5	R	02	-	-	-

DATE	STG	REV	N/P	CHG	ZONE
190004	R	01	-	-	-
25JAO5	R	02	-	-	-

DATE	STG	REV	N/P	CHG	ZONE
190004	R	01	-	-	-
25JAO5	R	02	-	-	-

DATE	STG	REV	N/P	CHG	ZONE
190004	R	01	-	-	-
25JAO5	R	02	-	-	-

DATE	STG	REV	N/P	CHG	ZONE
190004	R	01	-	-	-
25JAO5	R	02	-	-	-

DATE	STG	REV	N/P	CHG	ZONE
190004	R	01	-	-	-
25JAO5	R	02	-	-	-

DATE	STG	REV	N/P	CHG	ZONE
190004	R	01	-	-	-
25JAO5	R	02	-	-	-

DATE	STG	REV	N/P	CHG	ZONE
190004	R	01	-	-	-
25JAO5	R	02	-	-	-

DATE	STG	REV	N/P	CHG	ZONE
190004	R	01	-	-	-
25JAO5	R	02	-	-	-

DATE	STG	REV	N/P	CHG	ZONE
190004	R	01	-	-	-
25JAO5	R	02	-	-	-

DATE	STG	REV	N/P	CHG	ZONE
190004	R	01	-	-	-
25JAO5	R	02	-	-	-

DATE	STG	REV	N/P	CHG	ZONE
190004	R	01	-	-	-
25JAO5	R	02	-	-	-

DATE	STG	REV	N/P	CHG	ZONE
190004	R	01	-	-	-
25JAO5	R	02	-	-	-

DATE	STG	REV	N/P	CHG	ZONE
190004	R	01	-	-	-
25JAO5	R	02	-	-	-

DATE	STG	REV	N/P	CHG	ZONE
190004	R	01	-	-	-
25JAO5	R	02	-	-	-

DATE	STG	REV	N/P	CHG	ZONE
190004	R	01	-	-	-
25JAO5	R	02	-	-	-

DATE	STG	REV	N/P	CHG	ZONE
190004	R	01	-	-	-
25JAO5	R	02	-	-	-

DATE	STG	REV	N/P	CHG	ZONE
190004	R	01	-	-	-
25JAO5	R	02	-	-	-

DATE	STG	REV	N/P	CHG	ZONE
190004	R	01	-	-	-
25JAO5	R	02	-	-	-

DATE	STG	REV	N/P	CHG	ZONE
190004	R	01	-	-	-
25JAO5	R	02	-	-	-

DATE	STG	REV	N/P	CHG	ZONE
190004	R	01	-	-	-
25JAO5	R	02	-	-	-

DATE	STG	REV	N/P	CHG	ZONE
190004	R	01	-	-	-
25JAO5	R	02	-	-	-

DATE	STG	REV	N/P	CHG	ZONE
190004	R	01	-	-	-
25JAO5	R	02	-	-	-

DATE	STG	REV	N/P	CHG	ZONE
190004	R	01	-	-	-
25JAO5	R	02	-	-	-

DATE	STG	REV	N/P	CHG	ZONE
190004	R	01	-	-	-
25JAO5	R	02	-	-	-

DATE	STG	REV	N/P	CHG	ZONE
190004	R	01	-	-	-
25JAO5	R	02	-	-	-

DATE	STG	REV	N/P	CHG	ZONE
190004	R	01	-	-	-
25JAO5	R	02	-	-	-

DATE	STG	REV	N/P	CHG	ZONE
190004	R	01	-	-	-
25JAO5	R	02	-	-	-

DATE	STG	REV	N/P	CHG	ZONE
190004	R	01	-	-	-
25JAO5	R	02	-	-	-

DATE	STG	REV	N/P	CHG	ZONE
190004	R	01	-	-	-
25JAO5	R	02	-	-	-

DATE	STG	REV	N/P	CHG	ZONE
190004	R	01	-	-	-
25JAO5	R	02	-	-	-

DATE	STG	REV	N/P	CHG	ZONE
190004	R	01	-	-	-
25JAO5	R	02	-	-	-

DATE	STG	REV	N/P	CHG	ZONE
190004	R	01	-	-	-
25JAO5	R	02	-	-	-

DATE	STG	REV	N/P	CHG	ZONE
190004	R	01	-	-	-
25JAO5	R	02	-	-	-

DATE	STG	REV	N/P	CHG	ZONE
190004	R	01	-	-	-
25JAO5	R	02	-	-	-

DATE	STG	REV	N/P	CHG	ZONE
190004	R	01	-	-	-
25JAO5	R	02	-	-	-

DATE	STG	REV	N/P	CHG	ZONE
190004	R	01	-	-	-
25JAO5	R	02	-	-	-

DATE	STG	REV	N/P	CHG	ZONE
190004	R	01	-	-	-
25JAO5	R	02	-	-	-

DATE	STG	REV	N/P	CHG	ZONE
190004	R	01	-	-	-
25JAO5	R	02	-	-	-

DATE	STG	REV	N/P	CHG	ZONE
190004	R	01	-	-	-
25JAO5	R	02	-	-	-

DATE	STG	REV	N/P	CHG	ZONE
190004	R	01	-	-	-
25JAO5	R	02	-	-	-

DATE	STG	REV	N/P	CHG	ZONE
190004	R	01	-	-	-
25JAO5	R	02	-	-	-

DATE	STG	REV	N/P	CHG	ZONE
190004	R	01	-	-	-
25JAO5	R	02	-	-	-

DATE	STG	REV	N/P	CHG	ZONE
190004	R	01	-	-	-
25JAO5	R	02	-	-	-

DATE	STG	REV	N/P	CHG	ZONE
190004	R	01	-	-	-
25JAO5	R	02	-	-	-

DATE	STG	REV	N/P	CHG	ZONE
190004	R	01	-	-	-
25JAO5	R	02	-	-	-

		(N/A)		PROCESS SENSITIVE DIM	
DIMENSIONS ENCLOSED IN () INDICATE REFERENCE DIMENSIONS AND NO TOLERANCE LIMITS ARE ESTABLISHED					
NGSE (MM)		CHG			
20	> 30	> 70	> 100	> 150	> 200
70	100	150	200	250	300
TOLERANCE UNLESS OTHERWISE SPECIFIED					
0.2	0.3	0.4	0.5	0.6	0.8

Mouser Electronics

Authorized Distributor

Click to View Pricing, Inventory, Delivery & Lifecycle Information:

[Aptiv:](#)
[13513314](#)