

[illegible]

POLARIZATION OPTIONS
ACTUAL SIZE VIEWS

BASIC DIMENSIONS SHOWN
ARE FOR REFERENCE ONLY

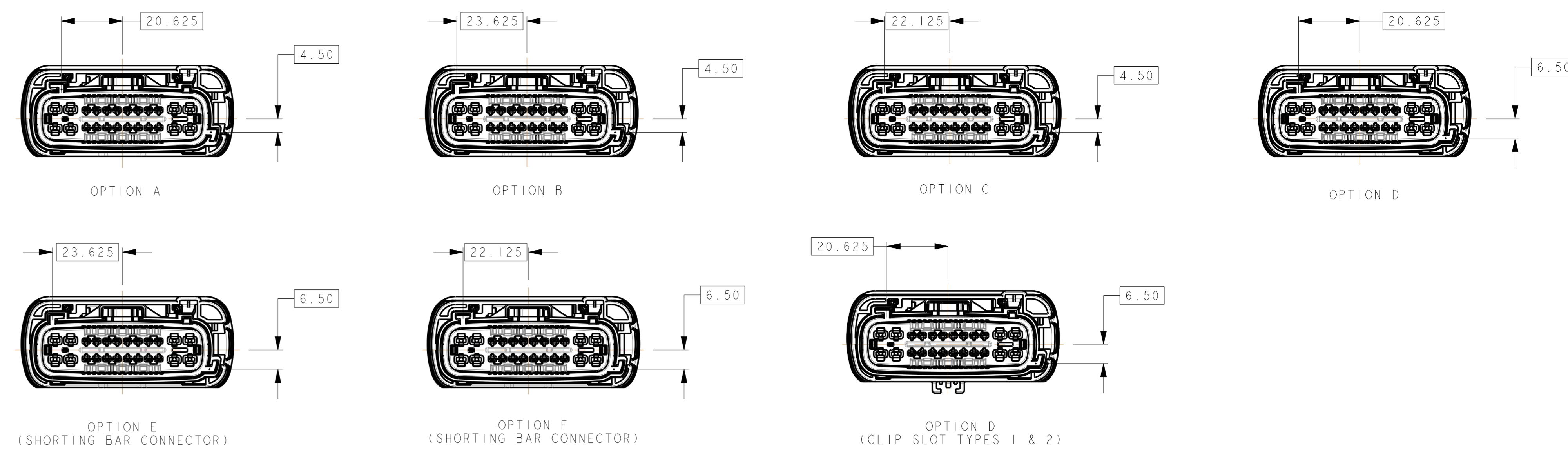

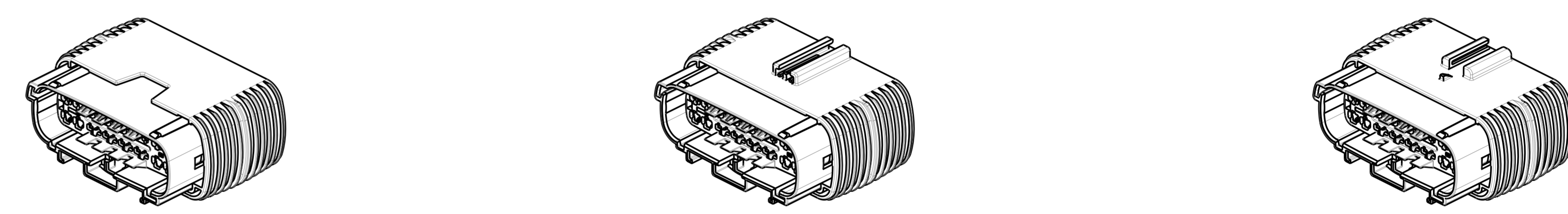

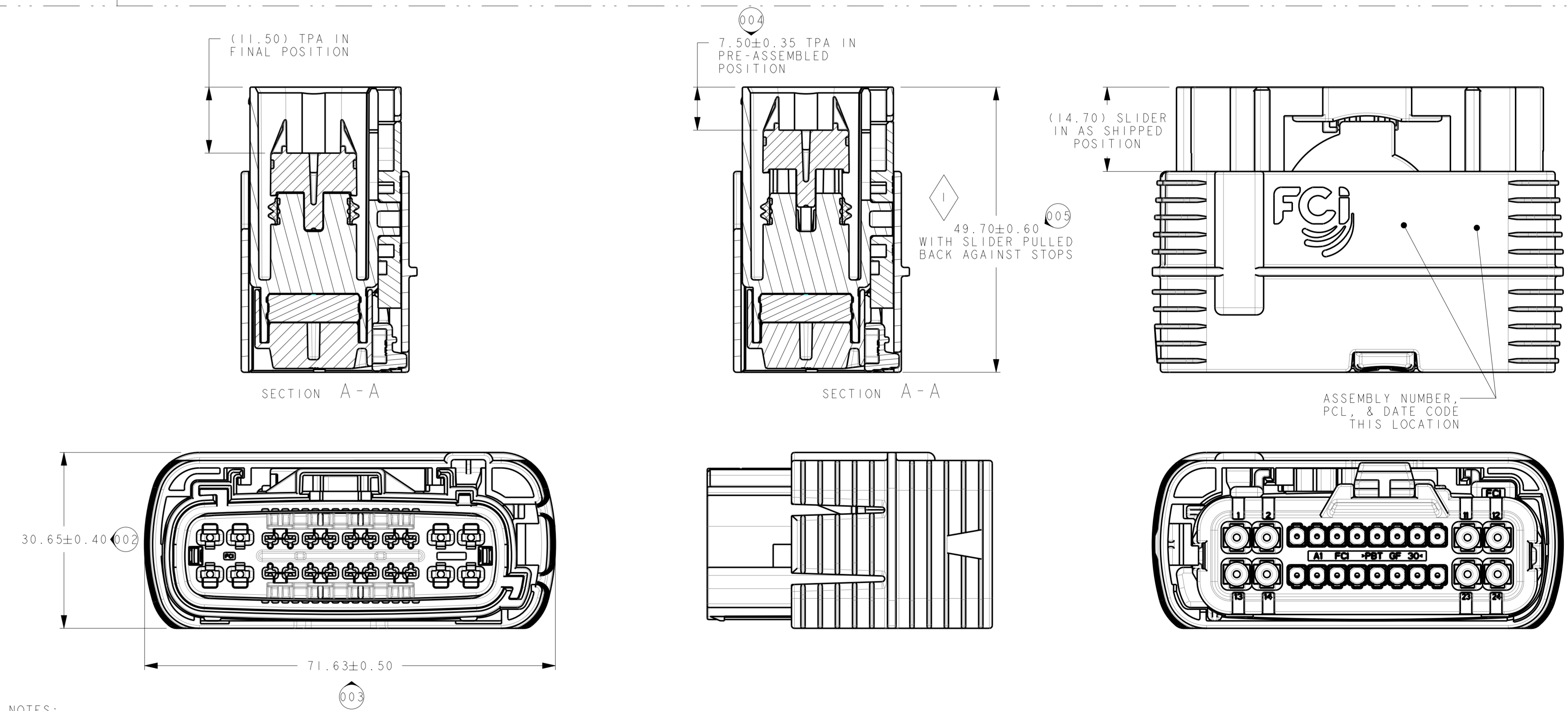
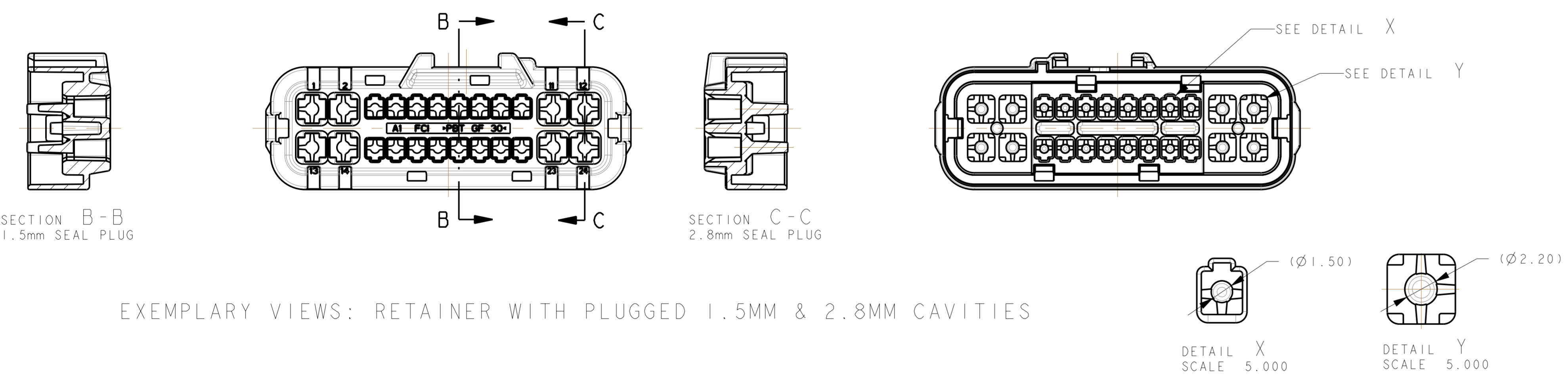
CLIP SLOT OPTIONS ON SLIDING SHROUD SCALE 1:1

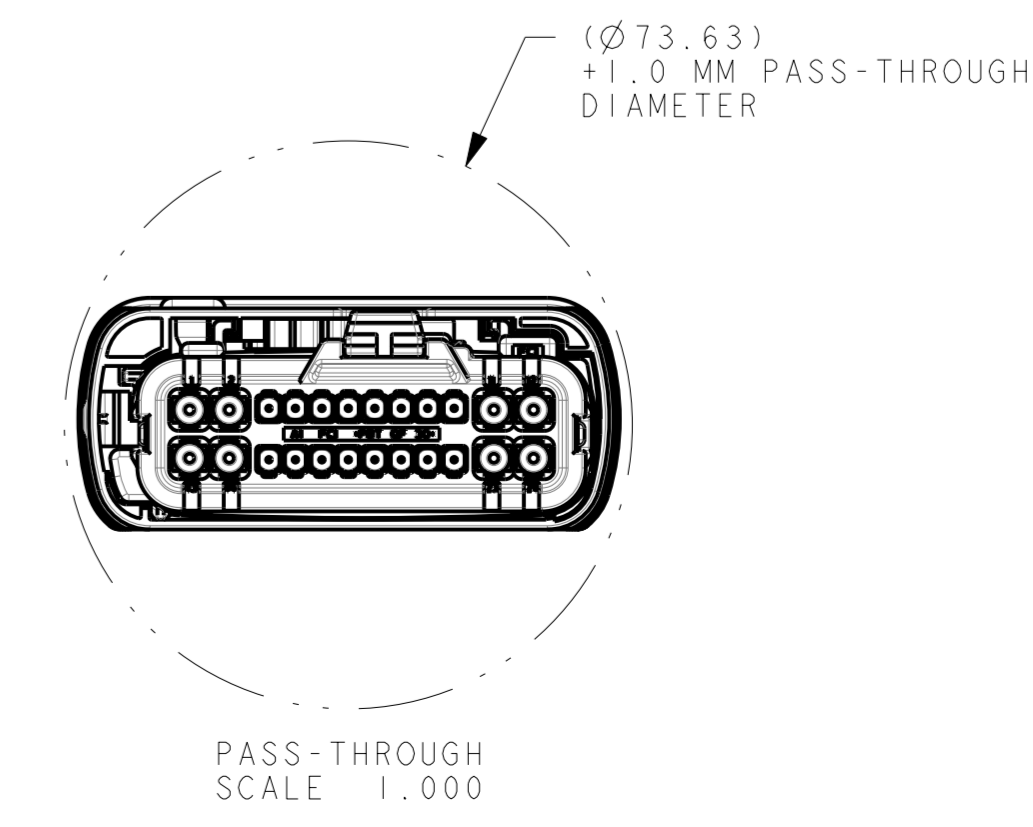

NOTES:

- 1) MAXIMUM TEMPERATURE CLASS:
CLASS III (125°C)
- 2) CONFORMS TO TEST METHOD AS SHOWN IN CHART WITH THE FOLLOWING EXCEPTION(S):
 - USCAR-2 REV 5 - SECTION 5.4.7 (AUDIBLE CLICK)
- 3) CONNECTOR MAY BE USED WITH THE FOLLOWING RANGE OF WIRE SIZES AND TYPES:
 - APEX 150 TERMINALS:
 - SIZE: 22 GAGE- 16 GAGE- 1.50mm MIN O.D. TO 2.41mm MAX O.D.
 - TYPE: TXL (MIL123-A / MS-8288)
 - ALTERNATIVELY:
 - SIZE: 0.5mm² TO 1.5mm² / 1.40mm MIN O.D. TO 2.40mm MAX O.D.
 - TYPE: FLR2X (125°C PE-X) or FLRYW (125°C PVC) (STRUCTURE & PROPERTIES ACC. IS06722)
 - APEX 2.8 TERMINALS:
 - SIZE: 18 GAGE- 12 GAGE- 1.90mm MIN O.D. TO 3.35mm MAX O.D.
 - TYPE: TXL (MIL123-A / MS-8288)
 - ALTERNATIVELY:
 - SIZE: 0.75mm² TO 3.0mm² / 1.70mm MIN O.D. TO 3.20mm MAX O.D.
 - TYPE: FLR2X (125°C PE-X) or FLRYW (125°C PVC) (STRUCTURE & PROPERTIES ACC. IS06722)
- CONTACT MVL ENGINEERING REGARDING USE OF OTHER WIRE SIZES AND/OR TYPES
- 4) CONNECTOR MAY BE USED WITH THE FOLLOWING TERMINALS:
 - MVL APEX150 AND APEX 2.8 WITH WIRE SIZES DEFINED IN NOTE 3.
 - SEE MVL DRAWINGS J54009 AND C15004 FOR SPECIFIC PART NUMBERS AND CRIMPING REQUIREMENTS
 - CONTACT MVL ENGINEERING REGARDING USE OF COMPATIBLE NON MVL TERMINALS
- 5) ANNUAL QUALITY REQUIREMENTS:
IT IS PERMISSIBLE TO PERFORM CONTINUOUS CONFORMANCE PER MVL SPECIFICATION #AQA-001 INSTEAD OF ANNUAL LAYOUT AND ANNUAL PV REQUIREMENTS OF QS-9000 SECTION 2 AND SAEUSCAR-2 REV 4.
FOR TERMINAL TO CONNECTOR AND TPA TO CONNECTOR ONLY.
- 6) FEMALE CONNECTORS EQUIPPED WITH OPTIONAL CLIPSLOT CAN BE MATED TO MALE CONNECTORS WITHOUT CLIPSLOT FEATURE. KEY OPTION D IS TO BE USED FOR FEMALE CONNECTORS WITH CLIPSLOT FEATURES AND THEIR MALE COUNTERPARTS.
 - CONTACT MVL ENGINEERING FOR SPECIFIC PACKAGING REQUIREMENTS WHEN USING THESE CONFIGURATIONS
- 7) QUALITY ASSURANCE REQUIREMENTS SPC DATA REQUIRED



APPLICABLE COMPONENTS					
SUPPLIER		DELPHI PART NO.	DESCRIPTION	PLATING/ MATERIAL	GRIP SIZE
PART NO.	NAME				
54001625	MVL	13613157	APEX 150 TERMINAL	TIN	16, 18
54002000	MVL	13624983	APEX 150 TERMINAL	TIN	20, 22
54001627	MVL	13779834	APEX 150 TERMINAL	GOLD	16, 18
54002002	MVL	13725913	APEX 150 TERMINAL	GOLD	20, 22
54001208	MVL	15422738	APEX 2.8 TERMINAL	TIN	12
54001400	MVL	10762803	APEX 2.8 TERMINAL	TIN	14, 16
54001800	MVL	10757690	APEX 2.8 TERMINAL	TIN	18
54240002	MVL	1370939	APEX 150 2.8mm SEAL PLUG - FEMALE	PA66 GF35	<div style="text-align: center;">  </div>
54241629	MVL	13613164	APEX 150 UNIVERSAL SEAL PLUG	PA66 GF35	
54002010	MVL	13768145	DOUBLE X-MAS TREE CLIP W/FORWARD STOP	PA66	
15-022075	ITW	15451401	SINGLE X-MAS TREE CLIP	PA66	
1437839	TYCO	10763674	DOUBLE X-MAS TREE CLIP (UNIVERSAL)	PA66	

COMMON PART NUMBER CHART ONE EACH INCLUDED IN ASSEMBLY			
ITEM	MVL P/N	DESCRIPTION	MATERIAL
2	PP10001319	TPA	PBT GF30
5	PP10001603	RING SEAL	SILICONE
6	PP10001599	MATT SEAL	SILICONE
7	PP10001727	GEAR CAM	PBT GF30

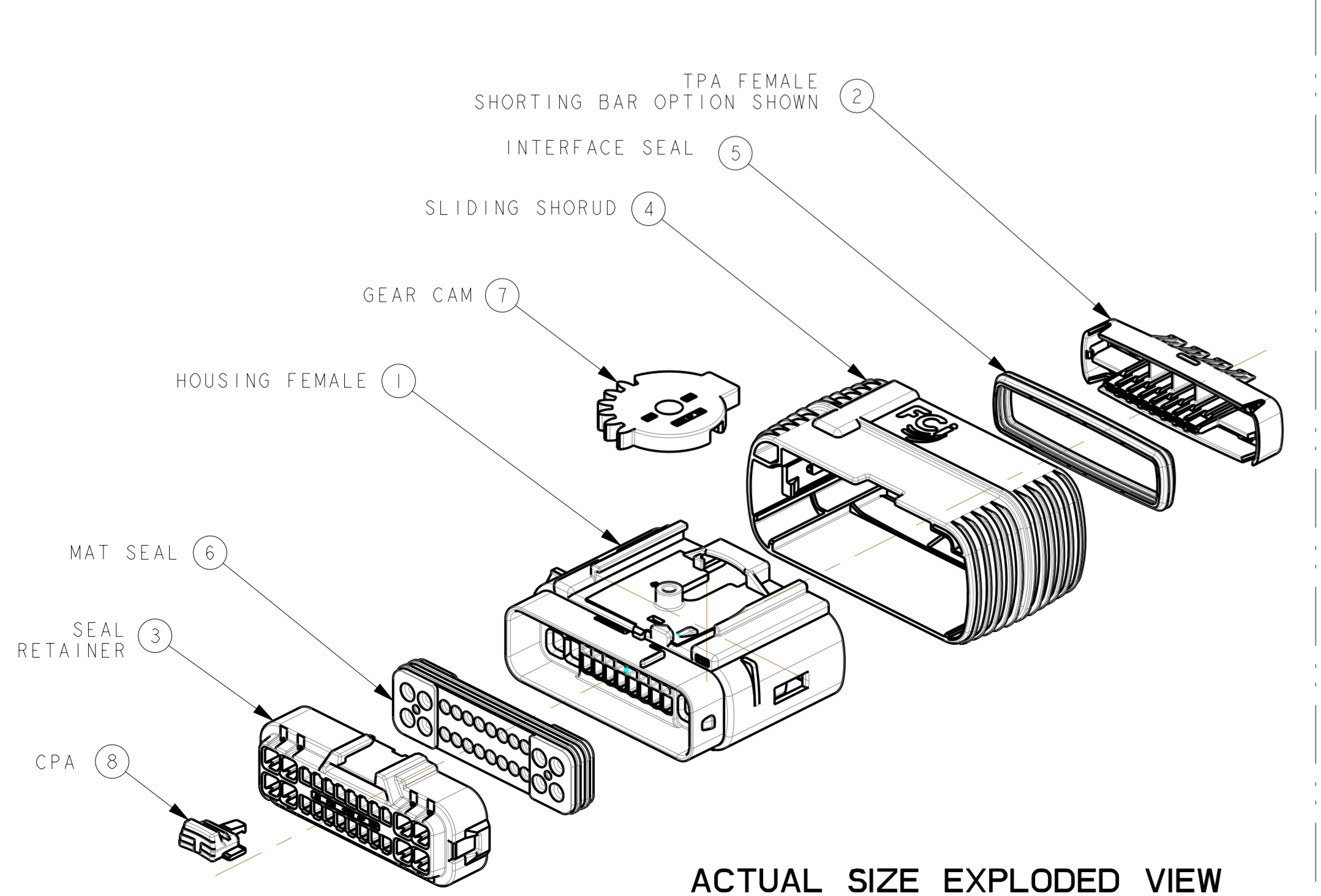
[illegible]

Mouser Electronics

Authorized Distributor

Click to View Pricing, Inventory, Delivery & Lifecycle Information:

[Aptiv:](#)

[15422738](#) [13779834](#) [F741800](#)