

Component-to-wire connectors **FCi**

HPCS

4 way sealed female housings for 2.8 mm terminals

Features

- 4 position housing
- Waterproof application with single wire seal
- Circumferential interface seal
- Lateral secondary lock for terminal position assurance (T.P.A.)
- Mechanical polarization

Performance characteristics

- Temperature range:
from -40°C to +120°C
- Contact retention force: > 80 N
- Contact insertion force: < 20 N
- Connector mating force: < 150 N

Construction

- Housing material: PBT
- Circumferential interface seal: Silicone

Tooling

- Terminal removal tool: Consult us
- Mini-applicator: Consult us

Connector compatibility

- Usable terminals:
HPCS 2.8 mm female terminals



Dimensional characteristics

4 way female housing

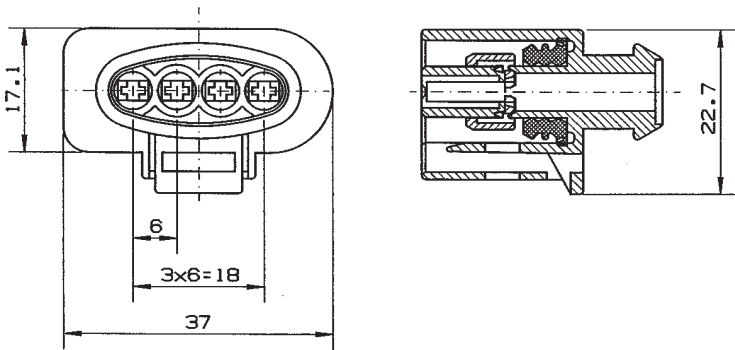

Part Numbers	No. of position	Terminal size	Colour
6 040 35 01	4	2.8 mm	Black

Direct Links

Cross Reference
RoHS/LF P/N search
Document & Drawing search
Application tooling

Services

Contact us
Distributor list
Pricing request
Order samples

Literature

Brochures & catalogs
Product documentation
Technical library

Start > Search=60403501* > 60403501

60403501



60403501

4 way component-to-wire Female housing

ACTIVE

Customer Drawing

Automotive division

Assistant Add to Favorites

Email Datasheet Print Datasheet

FCI Brings You More

Contact our sales/technical support

Sample request

Price request

Specifications

General Mechanical Physical Terminal 1 Type Environmental Other Features

General

Application	Component to Wire
Ways	4
Product Type	Housing
Coding	No
Family	Engine Compartment Connectors
Features	Mechanical Polarization Circumferential Interface Seal Waterproof Application with Single Wire Seal (S.W.S.) Lateral Secondary Lock for Terminal Position Assurance

	(T.P.A.)
Hybrid	No
Main Terminal family	HPCS
Main Terminal size	2.8 mm
Sealed	Yes
Terminal Size	2.8
Mechanical	
Connector mating force	< 150N
Physical	
Color	Black
Material	PBT
Temperature (Range)	-40°C to+120°C
Terminal 1 Type	
Terminal type 1	HPCS Female 2.8 mm Terminal
Ways for Terminal Type 1	4
Contact insertion force for Terminal Type 1	< 20N
Retention force (Contact) for Terminal Type 1	> 80N
Environmental	
IMDS	Yes
Other Features	
Type	Female
Disclaimer	Displayed data is for information purposes only. For more information, please contact your local sales office. The supply of some products might be limited to some customers.

Mouser Electronics

Authorized Distributor

Click to View Pricing, Inventory, Delivery & Lifecycle Information:

[Aptiv:](#)

[60403501](#)