

SYMBOL DEFINITION				MISSING SYMBOLS				DWS STATUS				ZONE		REVISION HISTORY				AUTH		DR		APVD											
								DATE		STG		REV		N/P		CHG																	
A DIMENSION WITHOUT AN INSPECTION REPORT SYMBOL DOES NOT REQUIRE INSPECTION. IT MAY BE CONTROLLED ON THE INDIVIDUAL COMPONENT DRAWING.				TOTAL NO OF INSPECTIONS REQUIRED		4		NO MISSING SYMBOL NUMBER				12JN08		R		08		-		-		CLEARED REV COL: 15492576 - REINSTATED				405018		F00		F00		F00	
												17AP15		R		09		-		-		15492521 & 15492576 - UPDATED MOUN WASHER				429342		JVR		JVM		J6R	
				LAST NO. USED		4																											

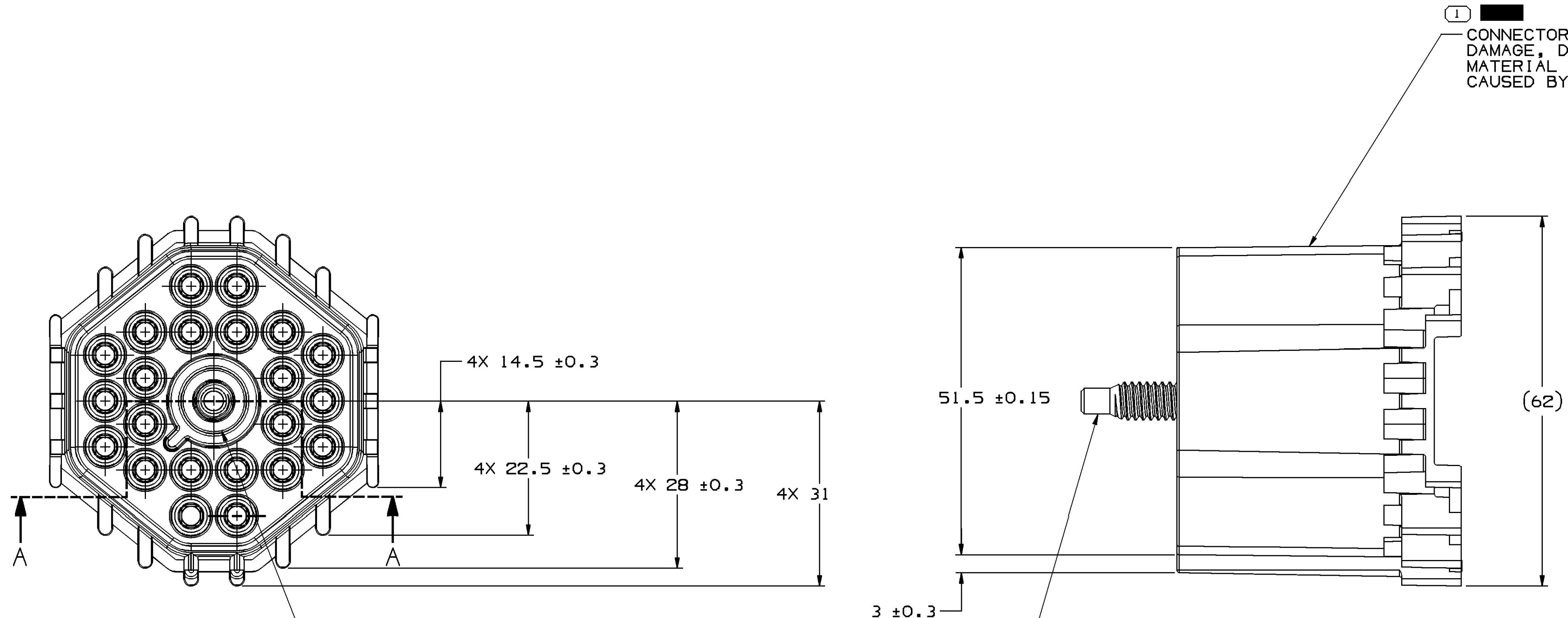

1. CONNECTOR - SEE CHART, MUST NOT SHOW ANY DAMAGE, DEFORMATION OR DISCOLORATION OF THE MATERIAL DUE TO EXCEEDING THE YIELD POINT, CAUSED BY THE ASSEMBLY OF THE COMPONENTS.

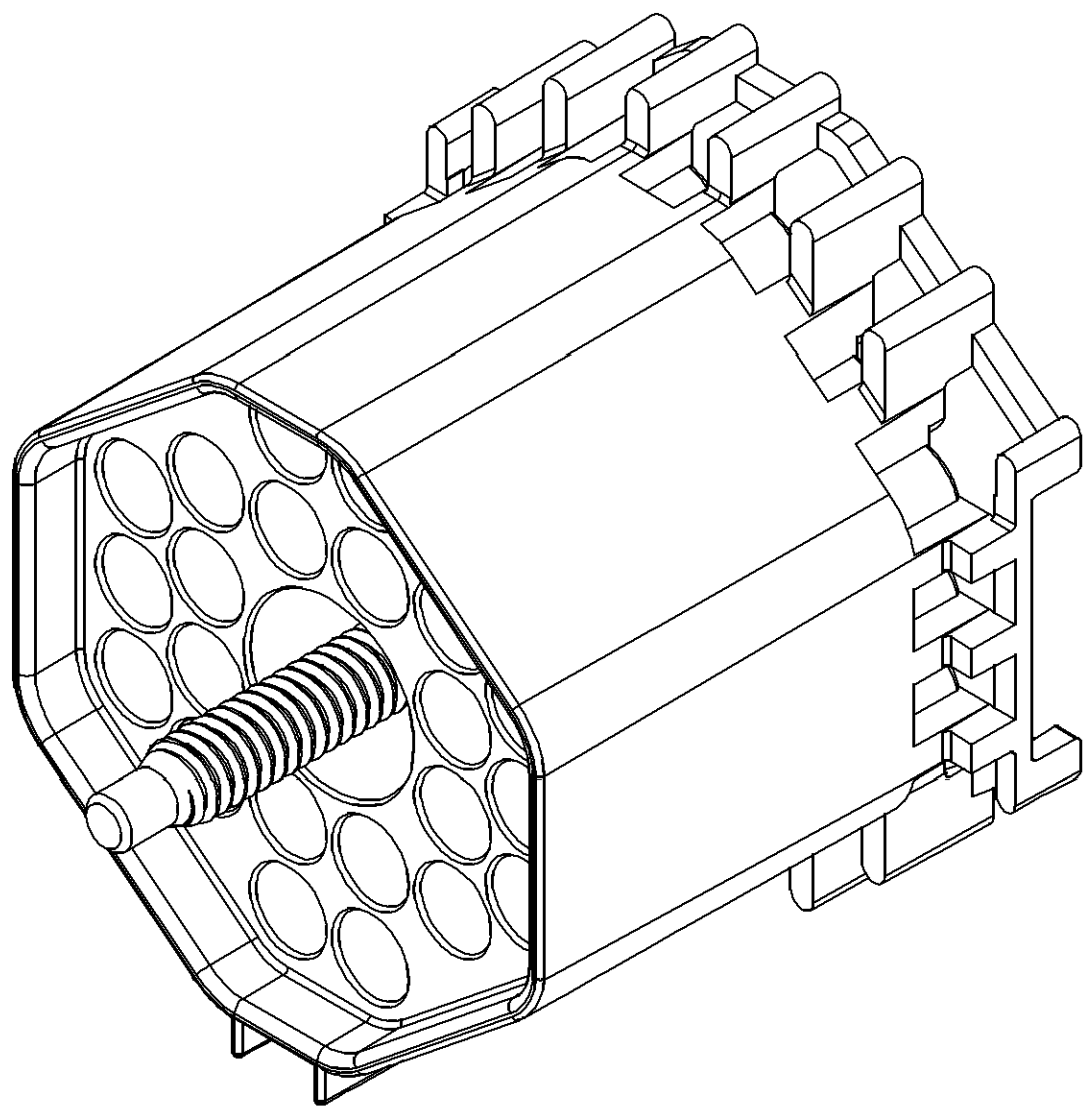
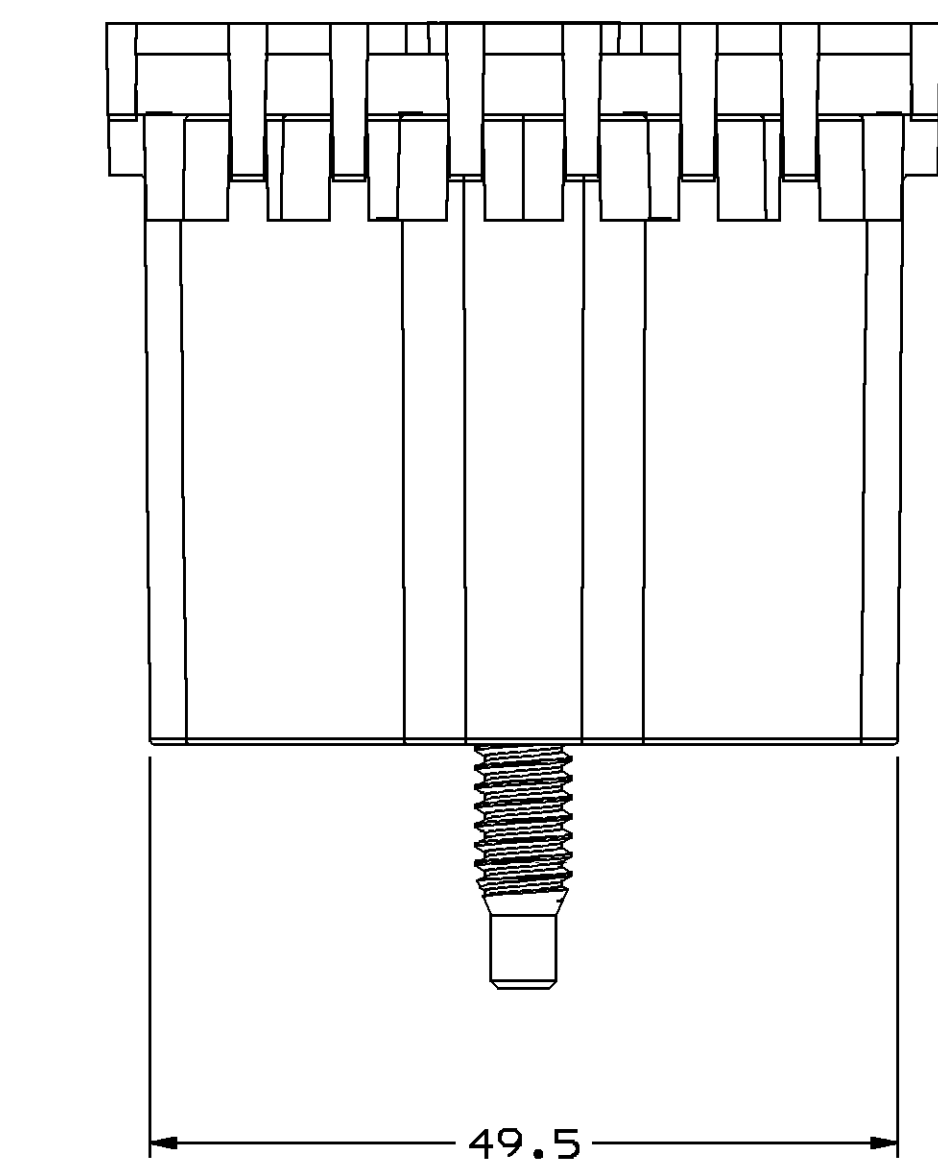
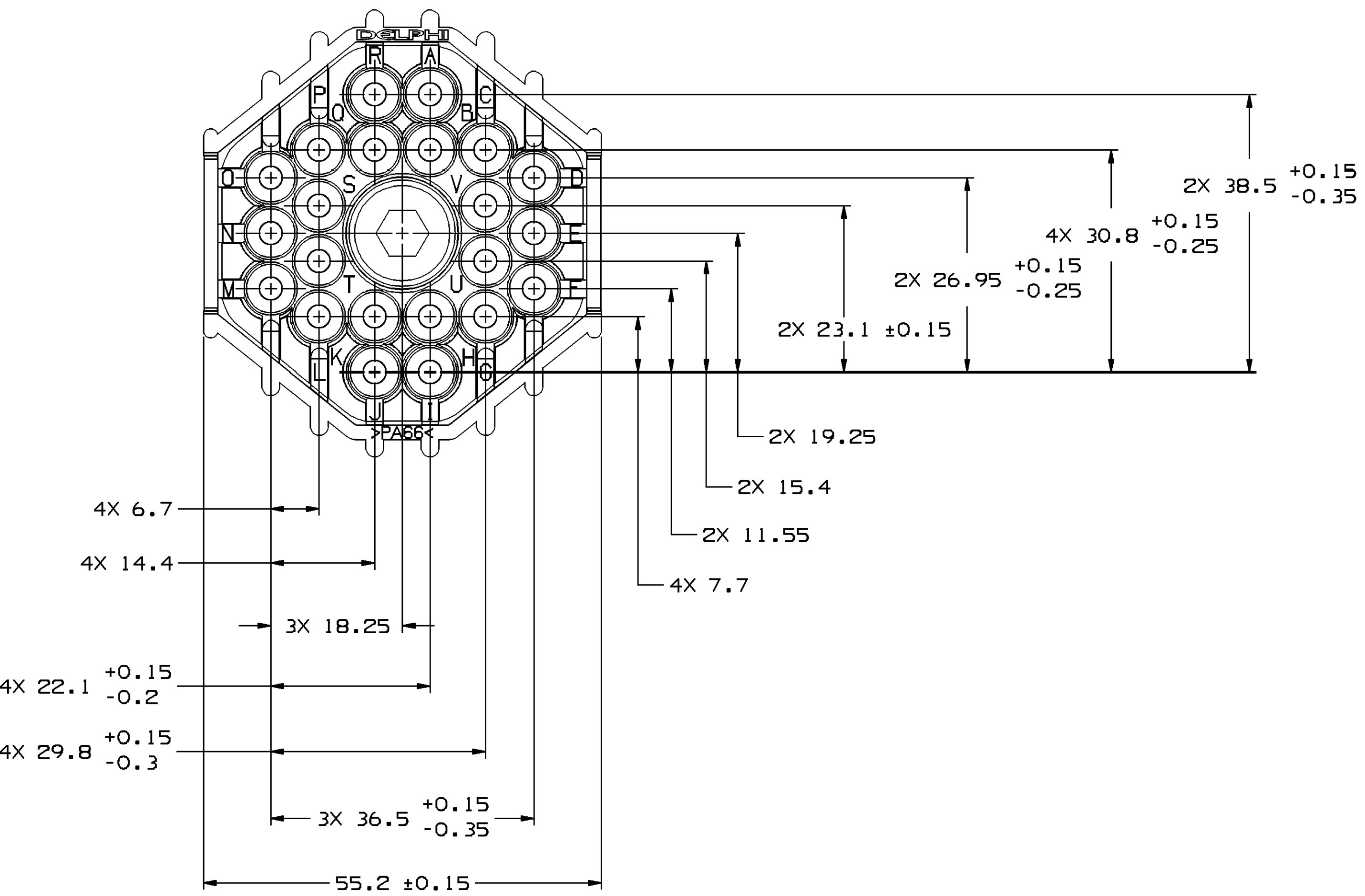

4. MOUN WASHER - SEE CHART, MUST NOT SHOWN ANY VISUAL CRACKS AFTER BEING ASSEMBLED.

2. BOLT - SEE CHART, MUST NOT SHOW ANY VISUAL CRACKS, DAMAGE, DEFORMATION OR SCORE MARKS AFTER BEING ASSEMBLED.

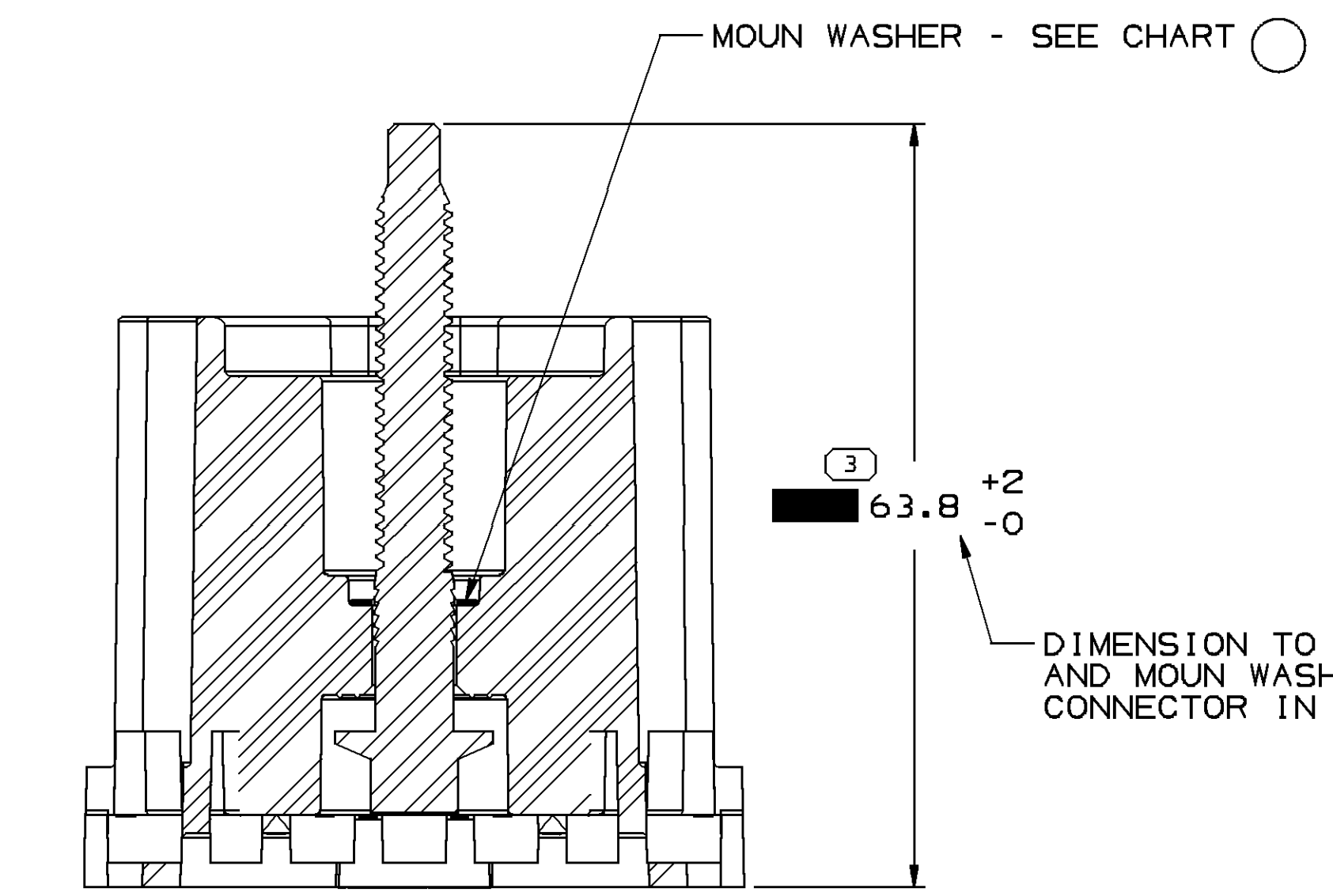

SECTION A-A

- NOTES
- UNLESS OTHERWISE SPECIFIED AND/OR INDICATED:  
DIMENSIONS ARE TO FACE OF VIEW SHOWN AND AUTOMATICALLY ROUNDED BY COMPUTER FOR INSPECTION. (SEE MATH MODEL FOR PRECISE DIMENSIONS.) FOR ALL OTHER DIMENSIONS NOT SHOWN BUT REQUIRED FOR TOOL BUILD, SEE MATH MODEL FOR PRECISE TOOL PATH DATA.
  - THIS ASSEMBLY IS TO BE BOLTED TO CONN. BODY ASM. WITH A TORQUE ON THE BOLT OF 5.65 N-M TO 7.91 N-M.
  - SEALING CODE 3 - DESIGN WILL PASS SALT FOG AND IMMERSION TEST AFTER CONDITIONING AS SPECIFIED IN ESA-644 (WEATHER-PACK), ESA-710 (METRI-PACK), ESA-650 (UNDERHOOD MICRO-PACK), C-4006 (WORLD CONNECTOR), ETC. - WHEN MATED TO MATING PART OR EQUIVALENT
  - ITEMS INDICATED BY " " ARE CONTROLLED FOR THE COMPONENT ASSEMBLY. ALL OTHER ITEMS ARE CONTROLLED BY THE INDIVIDUAL COMPONENT DRAWING.
  - THIS PRODUCT IS NOT CATEGORIZED AS AN APPEARANCE ITEM, MINOR IMPERFECTIONS INCLUDING, BUT NOT LIMITED TO, FLOW MARKS, COLOR BLEMISHES, GATE VESTIGE, AND SOFT FLASH THAT DO NOT AFFECT THE FIT, FORM, OR FUNCTION OF THE PART ARE PERMISSIBLE PER NAP 4.10-18.
  - FOR APPLICATION DATA SEE THE INDIVIDUAL APPLICATION DRAWINGS.

15492576	01	AC	12077377	15492515	15492512
15492521	01	AB	12015923	15492515	15492512
12077378	A4	-	12077377	12010853	12004737
12026191	A	-	12020181	12010853	12004737
12026905	A4	-	12015923	12010853	12004737
PART NO	REV	N/P	CONNECTOR	BOLT	MOUN WASHER

DIMENSIONAL RANGE (MM)		TOLERANCE		CHART SET	
FROM	TO	> 0	> 30	> 70	> 100
20	30	0.1	0.15	0.2	0.25
30	100	0.15	0.2	0.25	0.3
100	300	0.2	0.25	0.3	0.4
300	400	0.25	0.3	0.4	0.5
TOLERANCE UNLESS OTHERWISE SPECIFIED		ANGULAR TOLERANCE		± 1	
[±0.15] ±0.2		[±0.3] ±0.4		[±0.5] ±0.6	
[±0.75] ±0.8		[±1.0] ±1.2		[±1.5] ±1.8	

3	PROCESS SENSITIVE DIMENSION
DIMENSIONS ENCLOSED IN ( ) INDICATE REFERENCE DIMENSIONS AND NO TOLERANCE LIMITS ARE ESTABLISHED	
THIRD ANGLE PROJECTION	DO NOT SCALE
USE MATH DATA	USE MATH DATA

**DELPHI**  
DELPHI PACKARD ELECTRICAL/ELECTRONIC ARCHITECTURE  
WARREN, OH  
COPYRIGHT 2000 DELPHI CORPORATION AND/OR ITS AFFILIATES. ALL RIGHTS RESERVED.  
THIS DRAWING IS THE PROPERTY OF DELPHI CORPORATION AND CONTAINS DELPHI CONFIDENTIAL INFORMATION. THE REPRODUCTION, DISTRIBUTION AND UTILIZATION OF THIS DOCUMENT OR ITS RELATED CAD DATA, AS WELL AS COMMUNICATION OF ANY CONTENT TO OTHERS, WITHOUT EXPRESS AUTHORIZATION, IS PROHIBITED.

DATE	
DR	APVD1 R. BARBOZA
APVD2	G. MACIAS
APVD3	D. NAVARRO
APVD4	
APVD5	
SUBSTANCES OF CONCERN AND RECYCLED CONTENT PER DELPHI 13049201	
MATERIAL SEE CHART	
DRAWING NAME TAXI ASM CONN M W/P SHD SLD	
DRAWING NUMBER 12077379	
SIZE A0	SCALE 2:1
FRAME NO 1	SHEET NO 1
STG 1	REV 09

# Mouser Electronics

Authorized Distributor

Click to View Pricing, Inventory, Delivery & Lifecycle Information:

[Aptiv:](#)

[15492521-B](#) [15492521](#)