

THIS DRAWING AND DESIGN HEREON CON-
STITUTES A PROPRIETARY DESIGN OF
PACKARD ELECTRIC DIVISION AND IS NOT
TO BE DUPLICATED OR REPRODUCED WITH-
OUT AUTHORITY OF PACKARD ELECTRIC
DIVISION.

DO NOT SCALE

PACKARD ELECTRIC DIVISION
GENERAL MOTORS CORPORATION
WARREN, OHIO

-0-
1127
45A

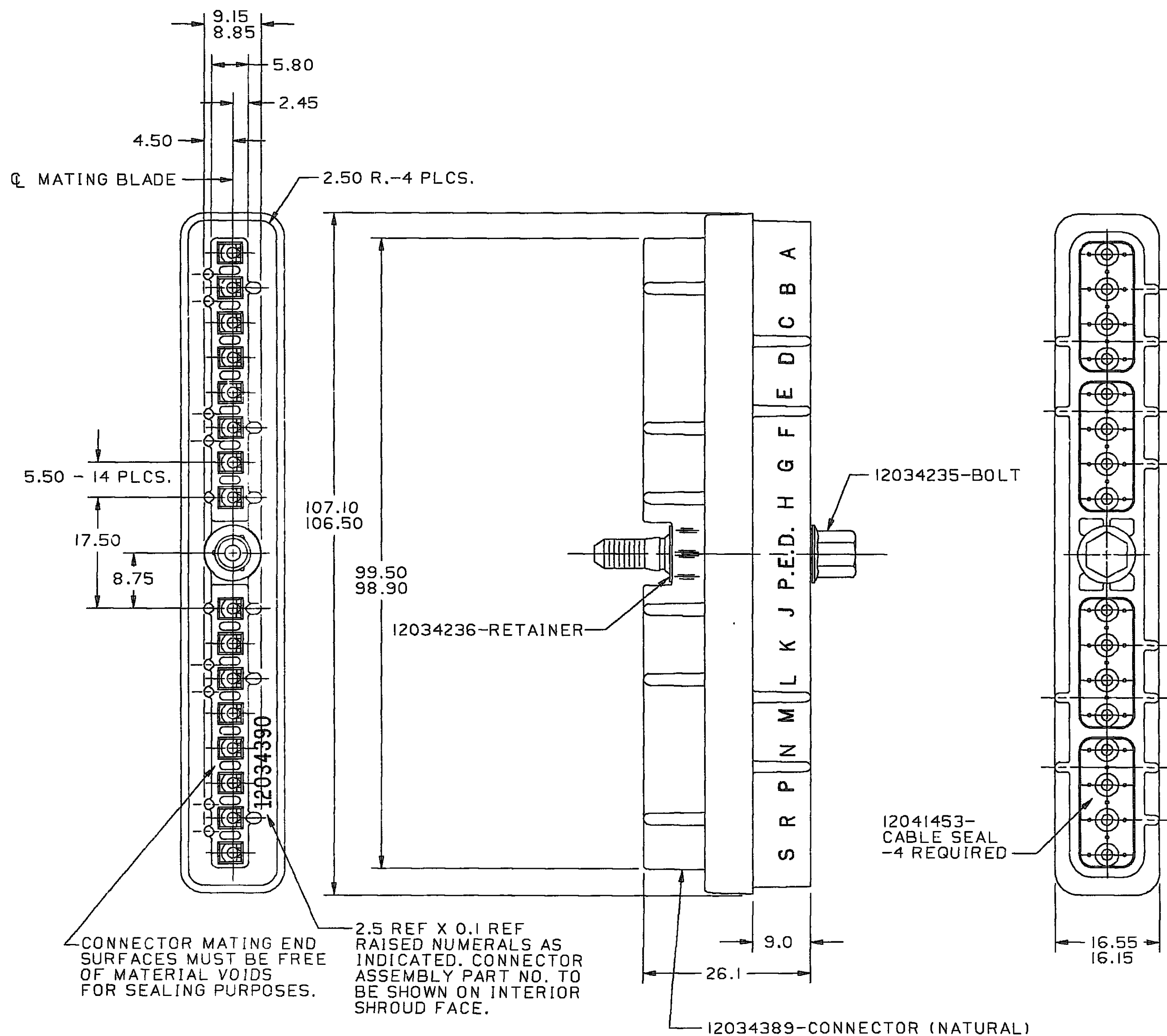

NOTES — 1. CAVITIES TO ACCEPT 12047680 TERMINAL OR EQUIVALENT.
2. MATING CONNECTOR - 12034388 OR EQUIVALENT.
3. THIS PART IS NOT CONTROLLED FOR AUTOMATIC FEEDING.
4. BOLT TO BE RETAINED IN ASSEMBLY TO A MINIMUM OF 400 N.
5. RECOMMENDED MATING TORQUE : 0.6 N-M TO 1.2 N-M.

6. BOLT MUST ROTATE IN CONNECTOR AT A TORQUE OF LESS THAN 0.60 N-M AFTER RETAINER IS ASSEMBLED.
7. SEALING CODE 3.

[illegible]

DRAWING NO.
1203 4390

OBSOLETE

PATENT PENDING

C06D2073

CAD CAM (MMC)

METRIC
DIMENSIONS ARE IN
MILLIMETERS UNLESS
OTHERWISE SPECIFIED

THIRD ANGLE PROJECTION

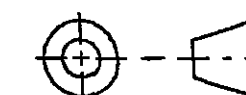

CODE NO. 6900

TOLERANCE UNLESS
OTHERWISE SPECIFIED
DECIMAL.

ANGULAR $\pm 2^\circ$

QC - C - 5 | 22

ONE PLACE	±	0.2
TWO PLACE	±	0.1

DWG. 075501

DR.	
-----	--

DATE 07 FEB 83

CD.A.12034

CK.	D.E. THIRY
-----	------------

REFERENCE NO.

APPR. G. GAMBLE

1

APPR. J.M. CHUP

	MATERIAL SPEC.
1	
2	
3	
4	
5	
6	
7	
8	
9	
10	
11	
12	
13	
14	
15	
16	
17	
18	
19	
20	
21	
22	
23	
24	
25	
26	
27	
28	
29	
30	
31	
32	
33	
34	
35	
36	
37	
38	
39	
40	
41	
42	
43	
44	
45	
46	
47	
48	
49	
50	
51	
52	
53	
54	
55	
56	
57	
58	
59	
60	
61	
62	
63	
64	
65	
66	
67	
68	
69	
70	
71	
72	
73	
74	
75	
76	
77	
78	
79	
80	
81	
82	
83	
84	
85	
86	
87	
88	
89	
90	
91	
92	
93	
94	
95	
96	
97	
98	
99	
100	

SEE DRAWING

NAME _____

ASM CONN 16F M/P 150 P2S

PART NO.

1203 4395

SIZE	
------	--

C

PACKARD ELECTRIC

Mouser Electronics

Authorized Distributor

Click to View Pricing, Inventory, Delivery & Lifecycle Information:

[Aptiv:](#)
[12034390](#)