

| SYMBOL DEFINITION   |                                 |    | MISSING NUMBERS |
|---|---------------------------------|----|-----------------|
| THE NUMBER INSIDE THE SYMBOL  CORRESPONDS TO THE NUMBER ON THE INSPECTION REPORT FOR THIS DRAWING/PART NUMBER | TOTAL NO. OF SYMBOLS ON DRAWING | 24 |                 |
|   | LAST NO. USED                   | 35 |                 |
|   |                                 |    |                 |

| DWG STATUS |     |     |     |     | ZONE | REVISION HISTORY  | AUTH   | DR  | APVD<br>1 | APVD<br>2 |
|------------|-----|-----|-----|-----|------|---|--------|-----|-----------|-----------|
| DATE       | STG | REV | N/P | CHG |      |   |        |     |           |           |
| 16DE98     | R   | 001 | -   | -   |      | CLEARED REVISION COLUMN<br>15356628 - RELEASED TO REV "001" | 980005 | DEH | DEH       | PH        |
| 06AP06     | R   | 02  | -   | -   |      | 15356628 - OBSOLETE   | 278490 | JOA | JVM       | EEM       |

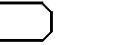
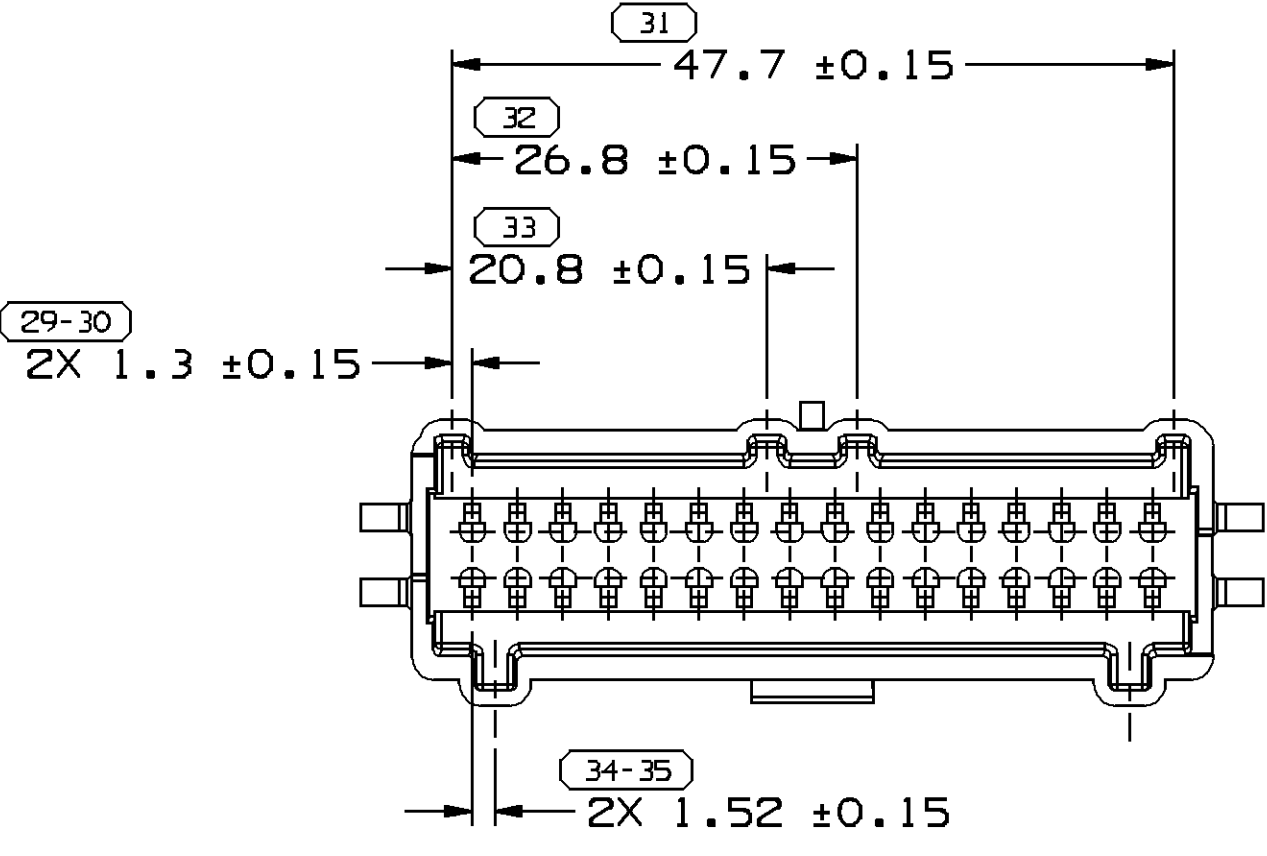
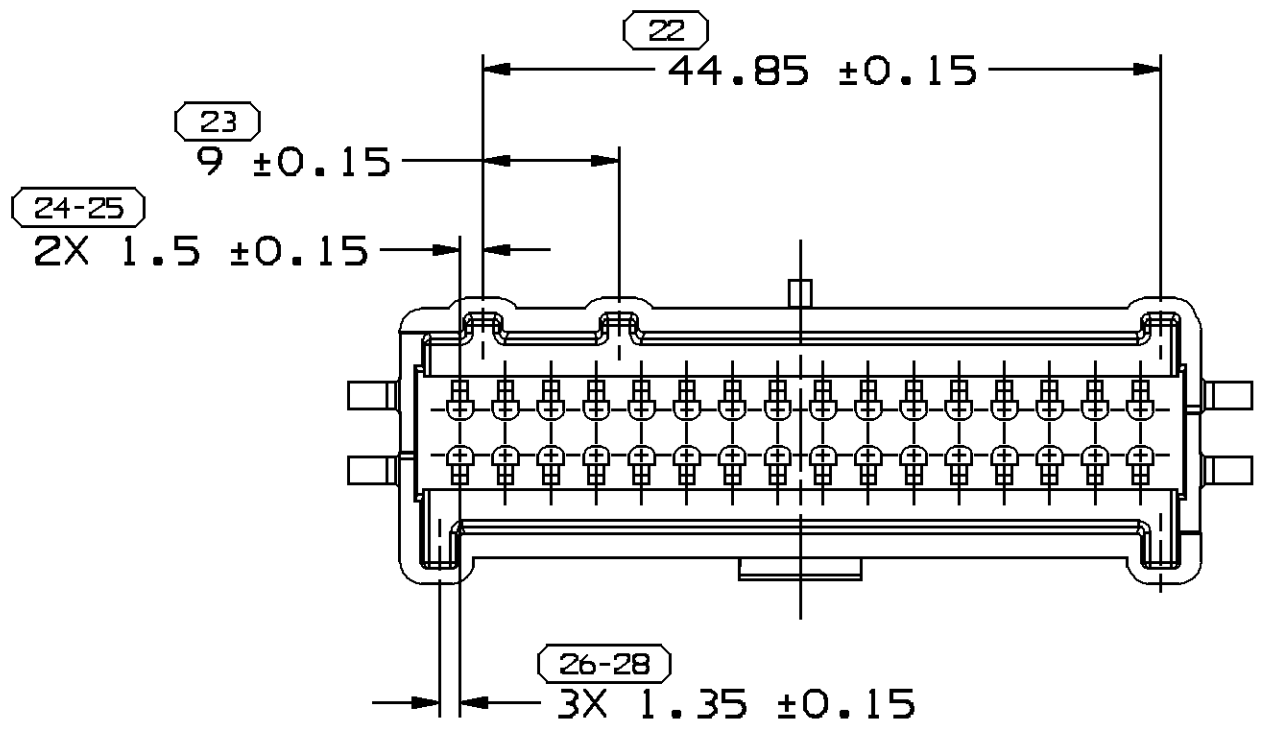
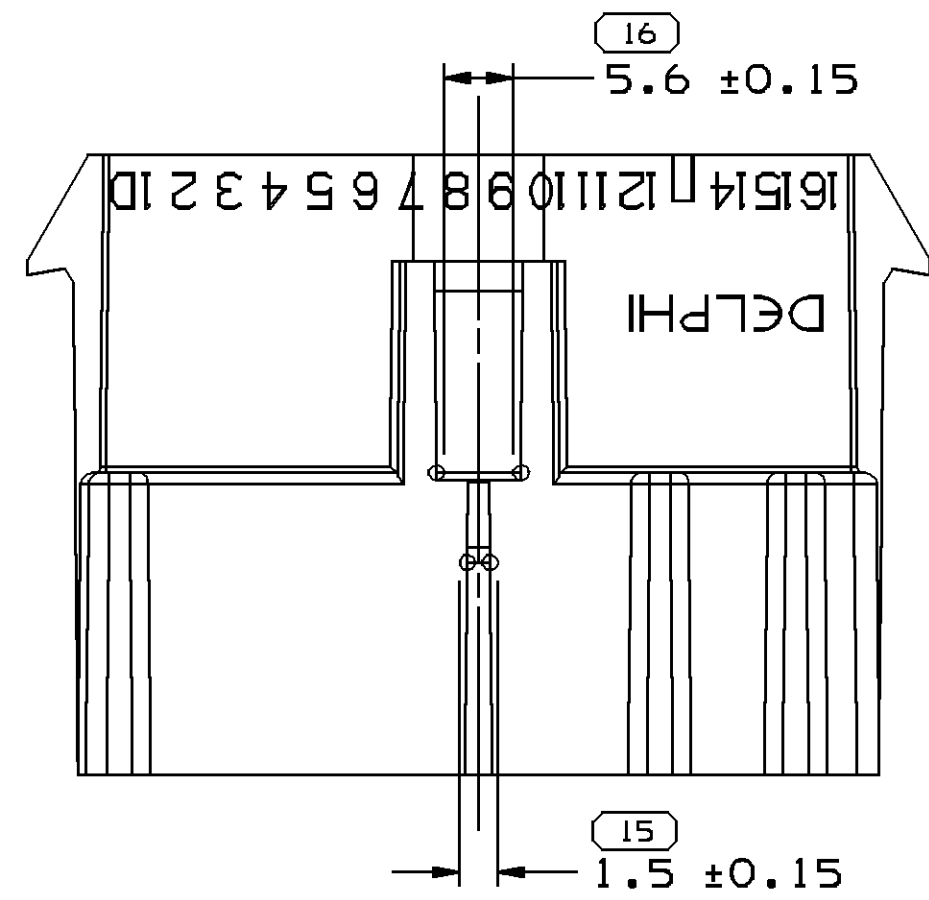

TYPE 102  
SAME AS TYPE 101  
EXCEPT AS SHOWN

TYPE 103  
SAME AS TYPE 101  
EXCEPT AS SHOWN

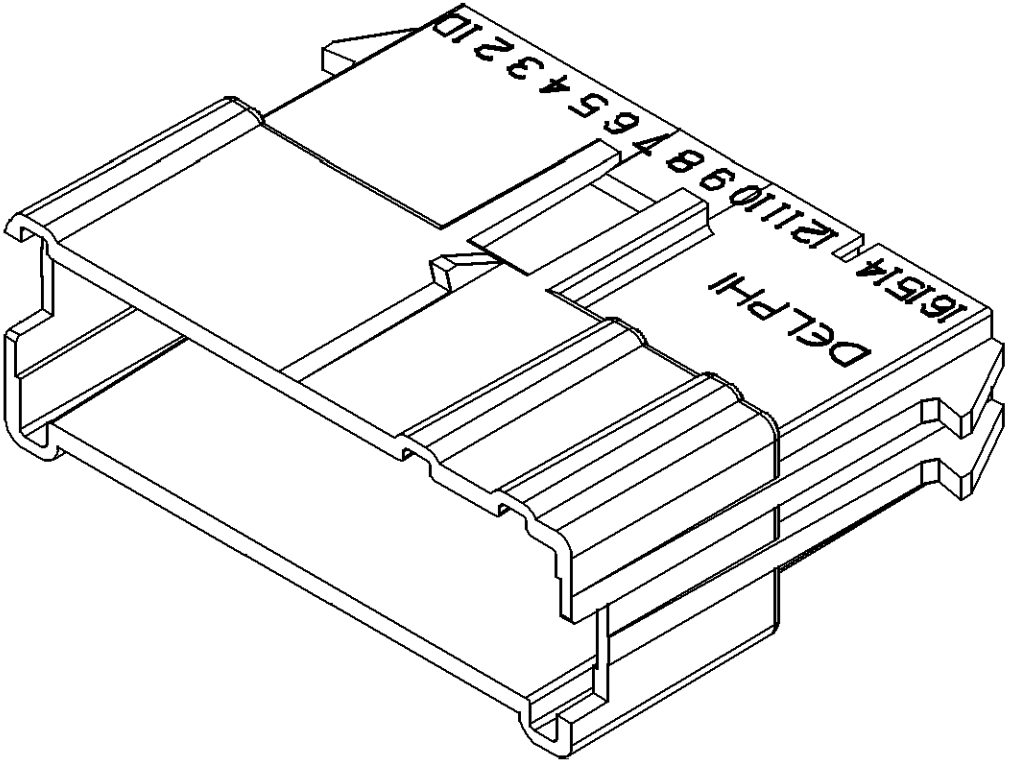
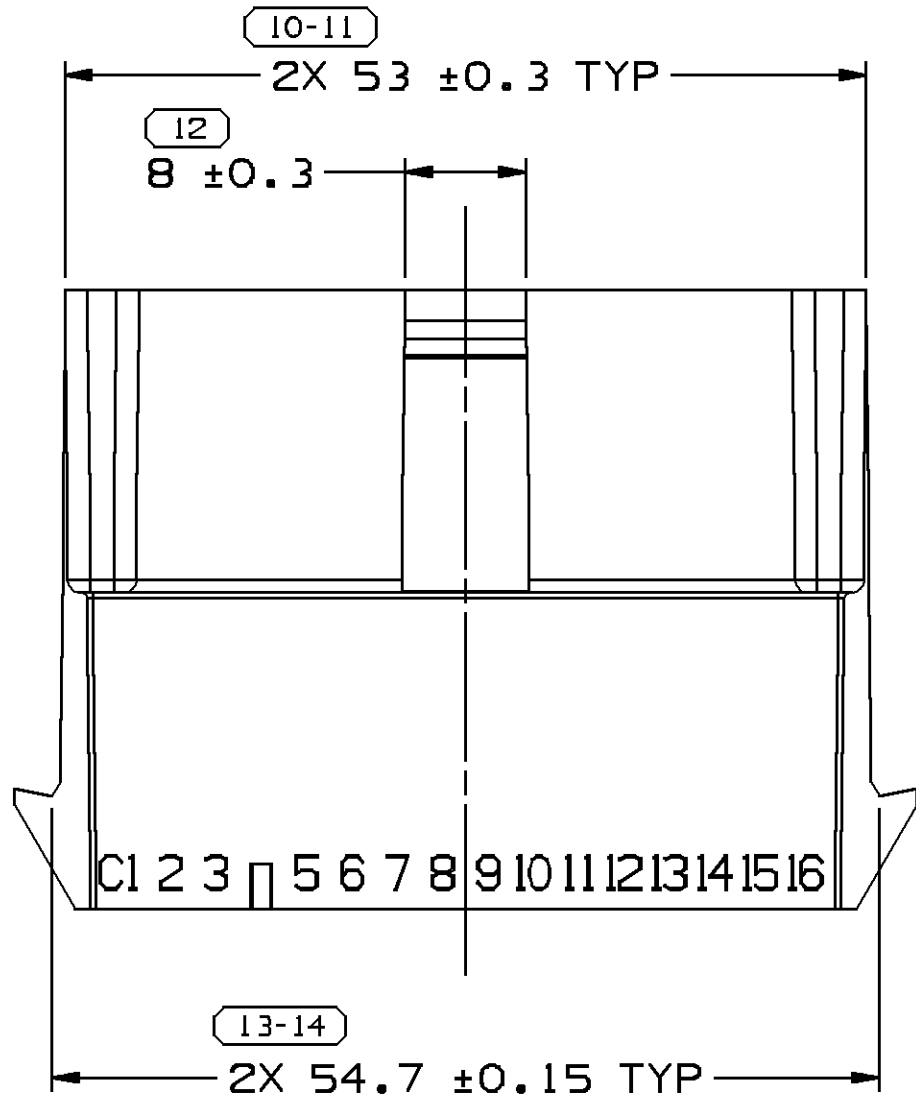
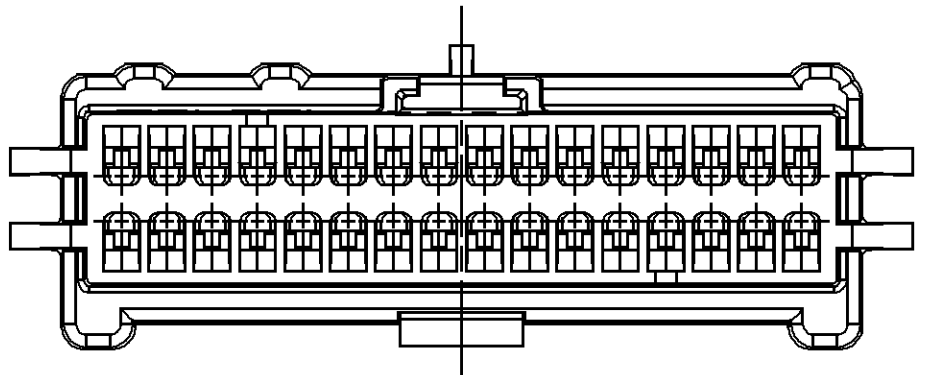
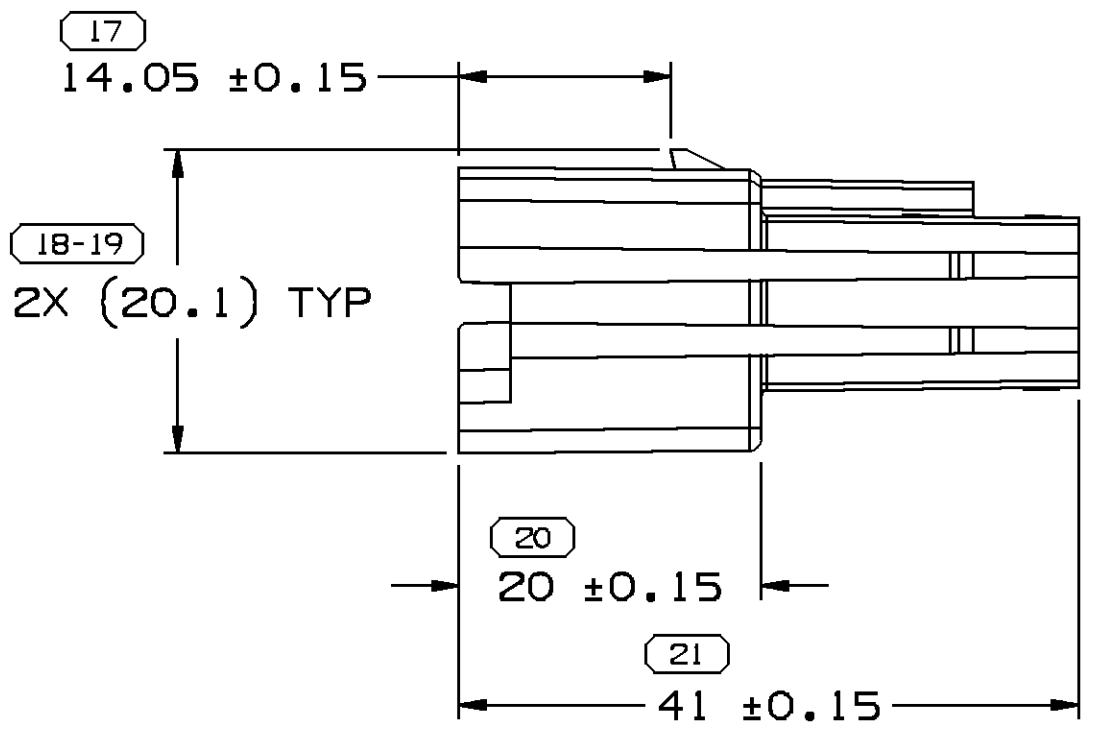
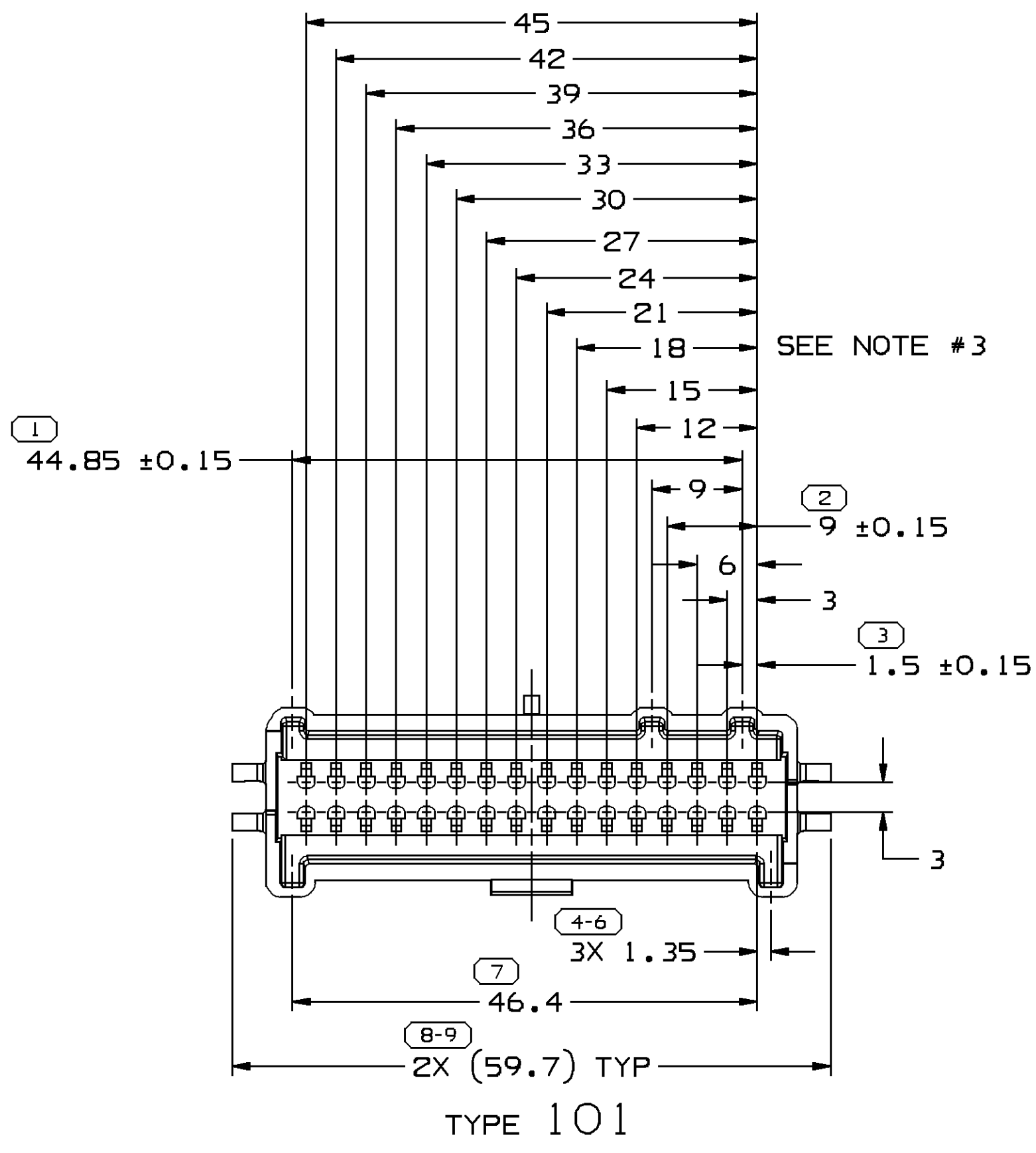

TYPE 101

- NOTES
- UNLESS OTHERWISE SPECIFIED AND/OR INDICATED:  
DIMENSIONS ARE TO FACE OF VIEW SHOWN AND AUTOMATICALLY ROUNDED BY COMPUTER FOR INSPECTION. (SEE MATH MODEL FOR PRECISE DIMENSIONS.) FOR ALL OTHER DIMENSIONS NOT SHOWN BUT REQUIRED FOR TOOL BUILD, SEE MATH MODEL FOR PRECISE TOOL PATH DATA.
  - THIS PART ACCEPTS THE FOLLOWING COMPONENTS OR EQUIVALENT:  
TERMINAL 12084449  
MAX INSULATION CRIMP MUST BE LESS THAN 2.85 HIGH AND 2.3 WIDE.  
SECONDARY TERMINAL LOCK 12160579 -2REQ'D  
MAX CABLE O.D. 18 GA THIN WALL
  - PART IS MANUFACTURED TO GEOMETRIC TOLERANCES. CENTERLINE DIMENSIONS ARE FOR REFERENCE ONLY.

|          |     |     |          |      |                                  |           |                  |
|----------|-----|-----|----------|------|----------------------------------|-----------|------------------|
| 15356628 | 01  | AA  | OBSOLETE | 103  | R0100124 PBT GF30 - RED DK       | 12.970    | 12110113         |
| 15354605 | A   |     |          | 102  | M4698013 PBT GF30 - PNK          | 13.030    | 12110245         |
| 15354604 | A   |     |          | 101  | M4698016 PBT GF30 - BLU LT       | 13.019    | 12110207         |
| PART NO  | REV | N/P | STATUS   | TYPE | MATERIAL SPECIFICATION AND COLOR | VOL (CM3) | MATING CONNECTOR |

| (21) PROCESS SENSITIVE DIMENSION   |                            |
|--|----------------------------|
| DIMENSIONS ENCLOSED IN ( ) INDICATE REFERENCE DIMENSIONS AND NO TOLERANCE LIMITS ARE ESTABLISHED |                            |
| DIMENSIONAL RANGE (MM)   | CHART E                    |
| FROM 0 TO 20   | > 20 > 30 > 70 > 100 > 100 |
| TOLERANCE UNLESS OTHERWISE SPECIFIED   |                            |
| ±0.15   ±0.2   ±0.3   ±0.4   ±0.5  |                            |
| ANGULAR TOLERANCE ±2°  |                            |

| DWG TYPE PART DRAWING  |              |
|--|--------------|
| STYLE  | SEE CHART    |
| VOLUME (CM³)   | DISTR CODE   |
| UNLESS OTHERWISE SPECIFIED   |              |
| THIS DOCUMENT IS IN ACCORDANCE WITH ASME Y14.5M-1994 AS AMENDED BY THE 3M GLOBAL DIMENSIONING AND TOLERANCING ADDENDUM-2001. SEPARATE PATTERNS OF FEATURES MAY BE BAGED SEPARATELY REGARDLESS OF DATUM REFERENCES. |              |
| ALL DIMENSIONS ARE IN MILLIMETERS  |              |
| THIRD ANGLE PROJECTION   | DO NOT SCALE |
| USE MATH DATA  | UNIGRAPHICS  |

| DELPHI   |                 |
|--|-----------------|
| DELPHI PACKARD ELECTRIC SYSTEMS<br>WARREN, OH                  |                 |
| DR   | DATE            |
| APVD1 D. HEBERLEIN   | 16DE98          |
| APVD2 D. HEBERLEIN   | 16DE98          |
| APVD3  |                 |
| APVD4  |                 |
| APVD5  |                 |
| SUBSTANCES OF CONCERN AND RECYCLED CONTENT PER DELPHI 10949001 |                 |
| MATERIAL SEE CHART   |                 |
| DRAWING NAME TAXI CONN M MIC/P 100W                            |                 |
| DRAWING NUMBER 15354603  |                 |
| SIZE A1  | SCALE 2:1       |
| FRAME NO 1 OF 1  | SHEET NO 1 OF 1 |
| STG R  | REV 02          |
| N/P  | -               |

# Mouser Electronics

Authorized Distributor

Click to View Pricing, Inventory, Delivery & Lifecycle Information:

[Aptiv:](#)  
[15354604](#)