

THIS DRAWING AND DESIGN HEREON CONSTITUTES A PROPRIETARY DESIGN OF PACKARD ELECTRIC DIVISION AND IS NOT TO BE DUPLICATED OR REPRODUCED WITHOUT AUTHORITY OF PACKARD ELECTRIC DIVISION.

DO NOT SCALE

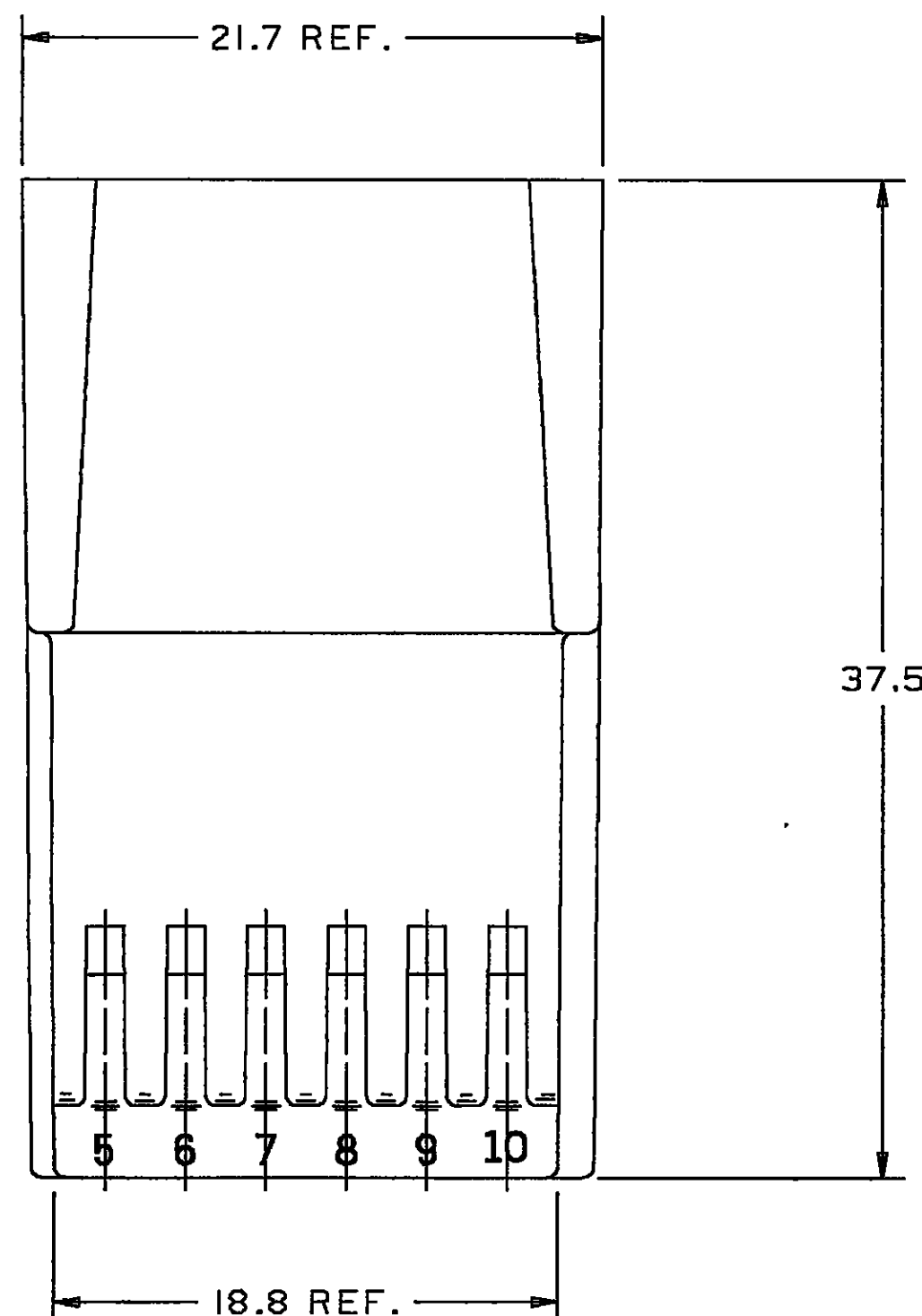
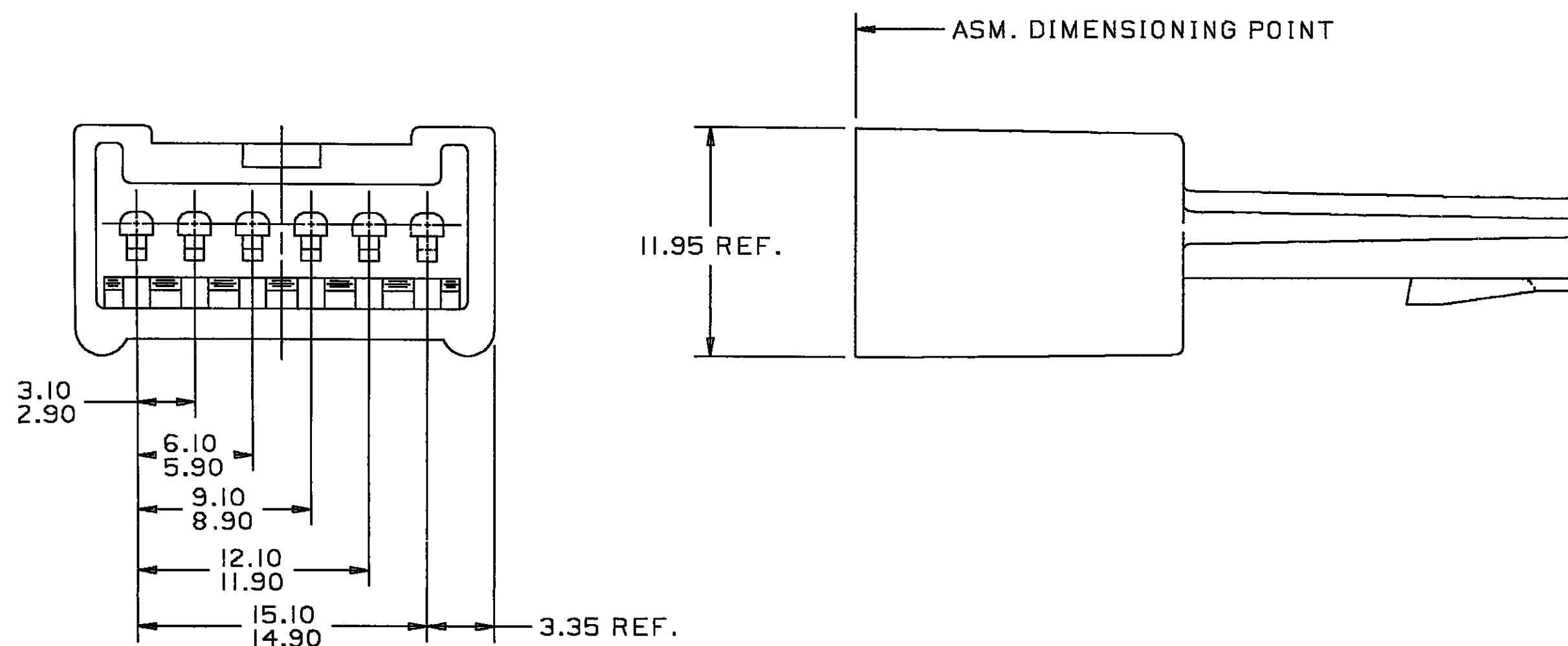

- ASM. DIMENSIONING POINT

11.95 REF.

- 3.35 REF.

- 21.7 REF.

37.5

- 18.8 REF.

NOTES — 1. CAVITIES TO ACCEPT I2040902 TERMINALS OR EQUIVALENT.
2. MATING INSULATOR I2040953 OR EQUIVALENT.
3. ALL CAVITIES ACCEPT A MAX INSULATION CRIMP OF
2.30 WIDE AND 2.85 HIGH (2.40 MAX CABLE O.D.).
REFER TO ESA-605 FOR CRIMP DIMENSIONS.
(E5) 4. BUTTON LOCKS MUST BE CLOSED (LOCKED) UPON COMPLETION
OF HARNESS BUILD SINCE THESE FUNCTION AS THE TPA
FOR THE PARTS.

As of 02AU 90 this drawing is no longer being maintained on computer vision.

[illegible]

DRAWING NO.

1204 0952

C06D2171

CAD CAM (RLH)

METRIC

DIMENSIONS ARE IN
MILLIMETERS UNLESS
OTHERWISE SPECIFIED

THIRD ANGLE PROJECTION

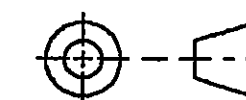

CODE NO. 6900, 6901

**TOLERANCE UNLESS
OTHERWISE SPECIFIED**

OTHERWISE SPECIFIED	
DECIMAL:	ANGULAR $\pm 2'$
ONE PLACE ± 0.3	
TWO PLACE ± 0.15	

DWG.
DATE 31MY83

3	SCALE NONE
---	---------------

	OR
--	----

CD.C.MICRO.M.6.12040952.0

D	CK. R. GLEASON
---	----------------

DATE	5JL83
------	-------

REFERENCE NO.

APPR.	GARRETSON
-------	-----------

DATE 19 11 83

12040952 'R' SIZE

APPR. F. J. TOI NAI

DATE	9 JUL 83
------	----------

MATERIAL SPEC

RO100151 PBT=BLK

NAME _____

CONN 6M MIC/P 100

PART NO.

1204 0952

SIZE	PRICE
Small	\$12.95
Medium	\$14.95
Large	\$16.95

10

OUTLINE DRAWING

PACKARD ELECTRIC

PACKARD ELECTRIC DIVISION
GENERAL MOTORS CORPORATION
WARREN, OHIO

Mouser Electronics

Authorized Distributor

Click to View Pricing, Inventory, Delivery & Lifecycle Information:

[Aptiv:](#)
[12040952](#)