

SYMBOL DEFINITION		MISSING SYMBOLS	
A DIMENSION WITHOUT AN INSPECTION REPORT SYMBOL ○ DOES NOT REQUIRE INSPECTION. IT MAY BE CONTROLLED ON THE INDIVIDUAL COMPONENT DRAWING.	TOTAL NO OF INSPECTIONS REQUIRED	16	NO MISSING SYMBOL NUMBER
	LAST NO. USED		
		13	

OWG STATUS					ZONE	REVISION HISTORY	AUTH	DR	APVD/APVD	
DATE	STR	REV	N/P	CHG					1	2
21AUI5	R	01	-	-		ALL PARTS - RELEASED PART DRAWING	430493	AGC	AGC	JDS
02N015	R	02	-	-		33268479 - UPDATED CONNECTOR & LOCK PLR; 33268776-78 - UPDATED LOCK PLR	431279	CER	CER	JDS
08MR16	R	03	-	-		ALL PARTS - UPDATED CONN TO LATEST REVISION	432261	AHG	AHG	JDS
28JUL16	R	04	-	-		ALL PARTS - UPDATED PART AVAILABILITY	433777	ORA	JDS	JDS
23JAI17	R	05	-	-		ALL PARTS - ADDED PLR ASSEMBLY NOTE	435507	BDH	JVM	JDS
11JUL17	R	06	-	-		ALL PARTS - REVISED NOTE NUMBER 7	437181	NKS	NKS	JDS

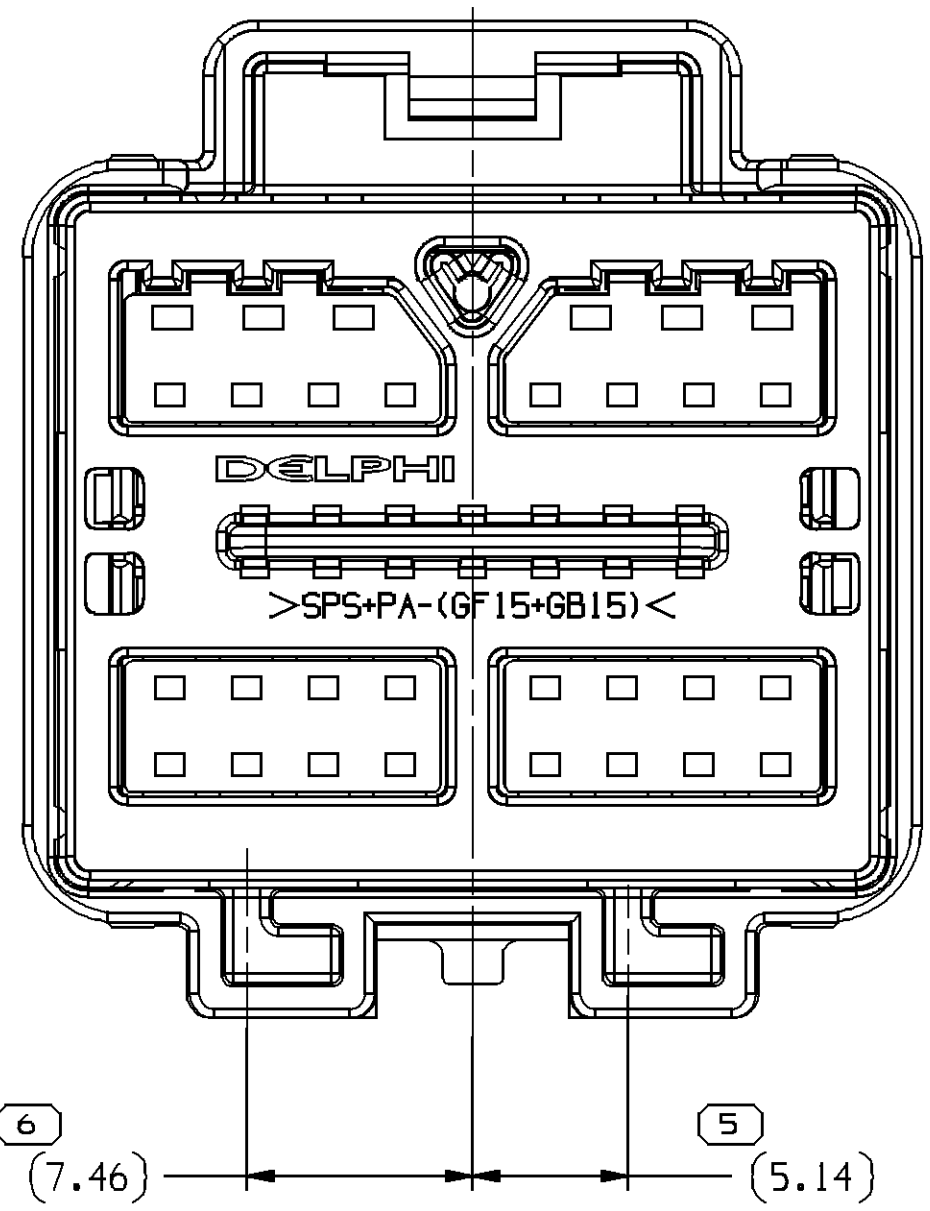

TYPE 102  
SAME AS TYPE 101  
EXCEPT AS SHOWN

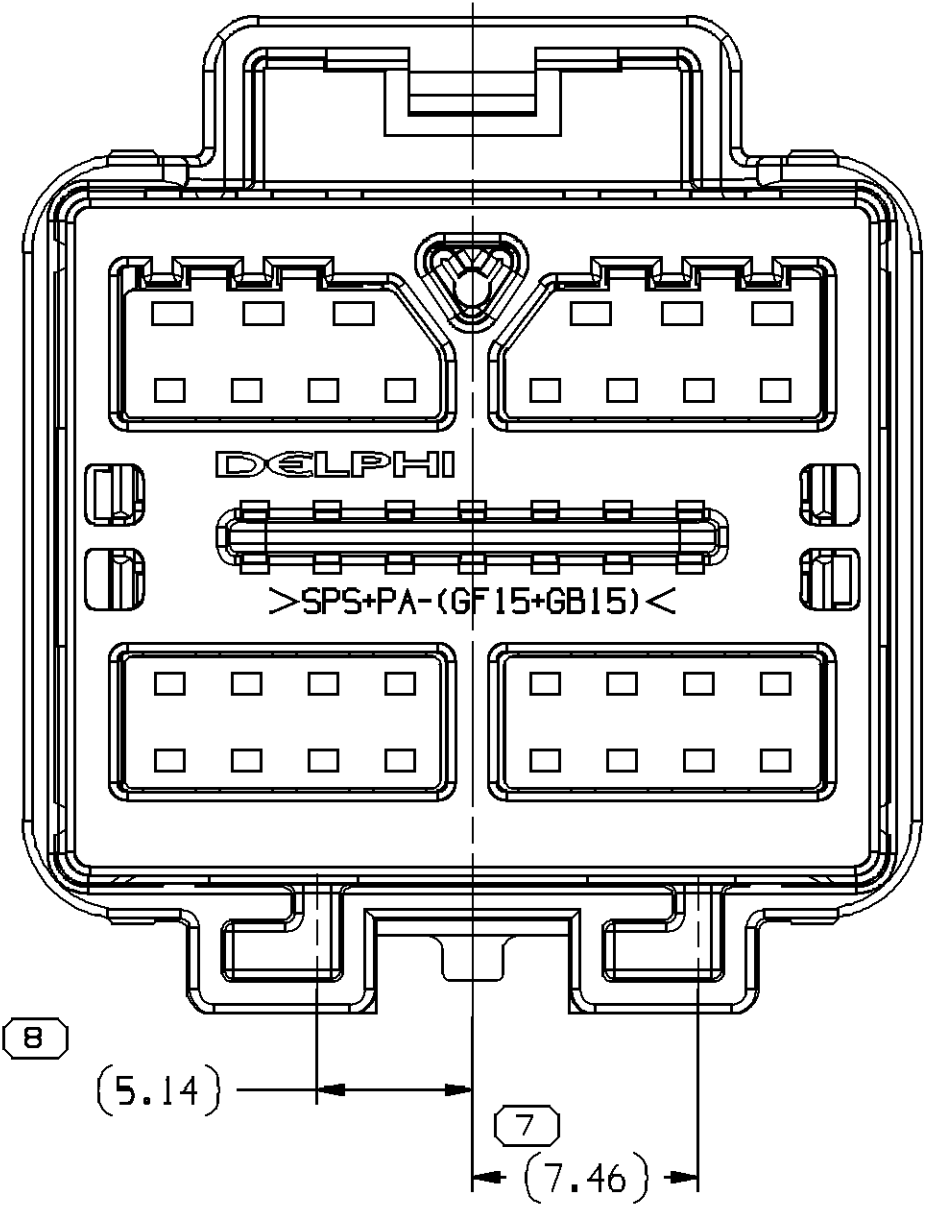
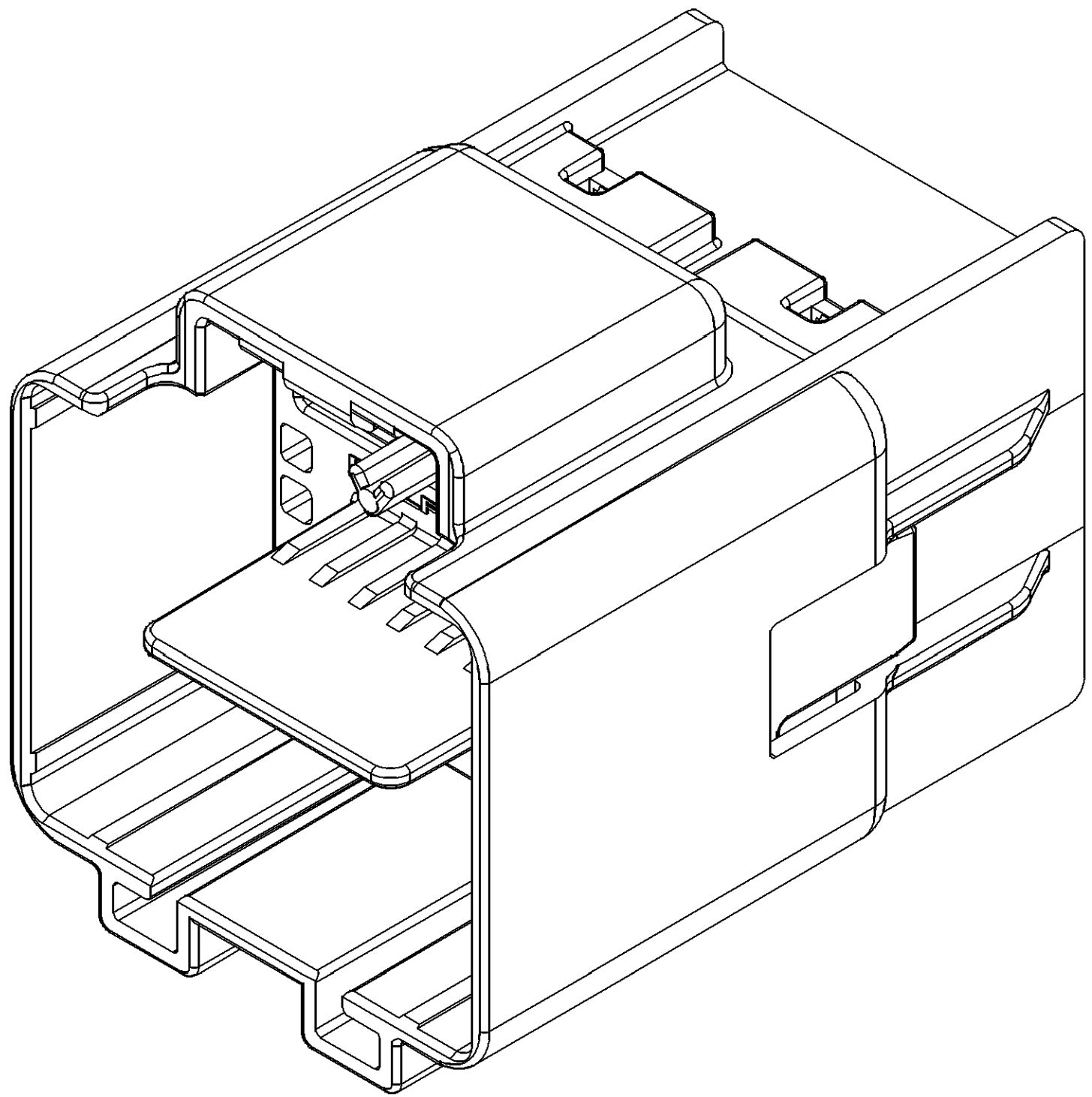
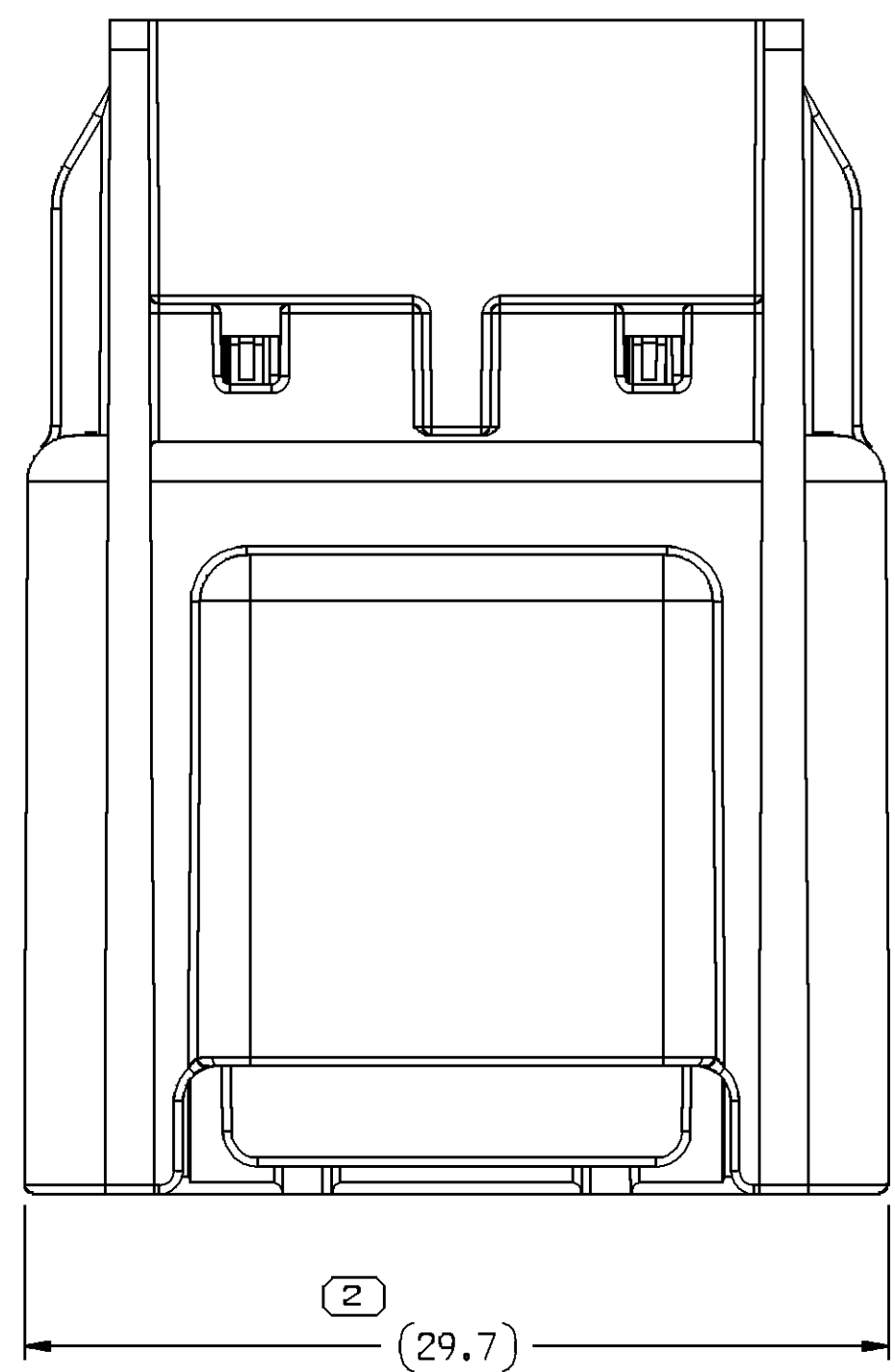

TYPE 103  
SAME AS TYPE 101  
EXCEPT AS SHOWN

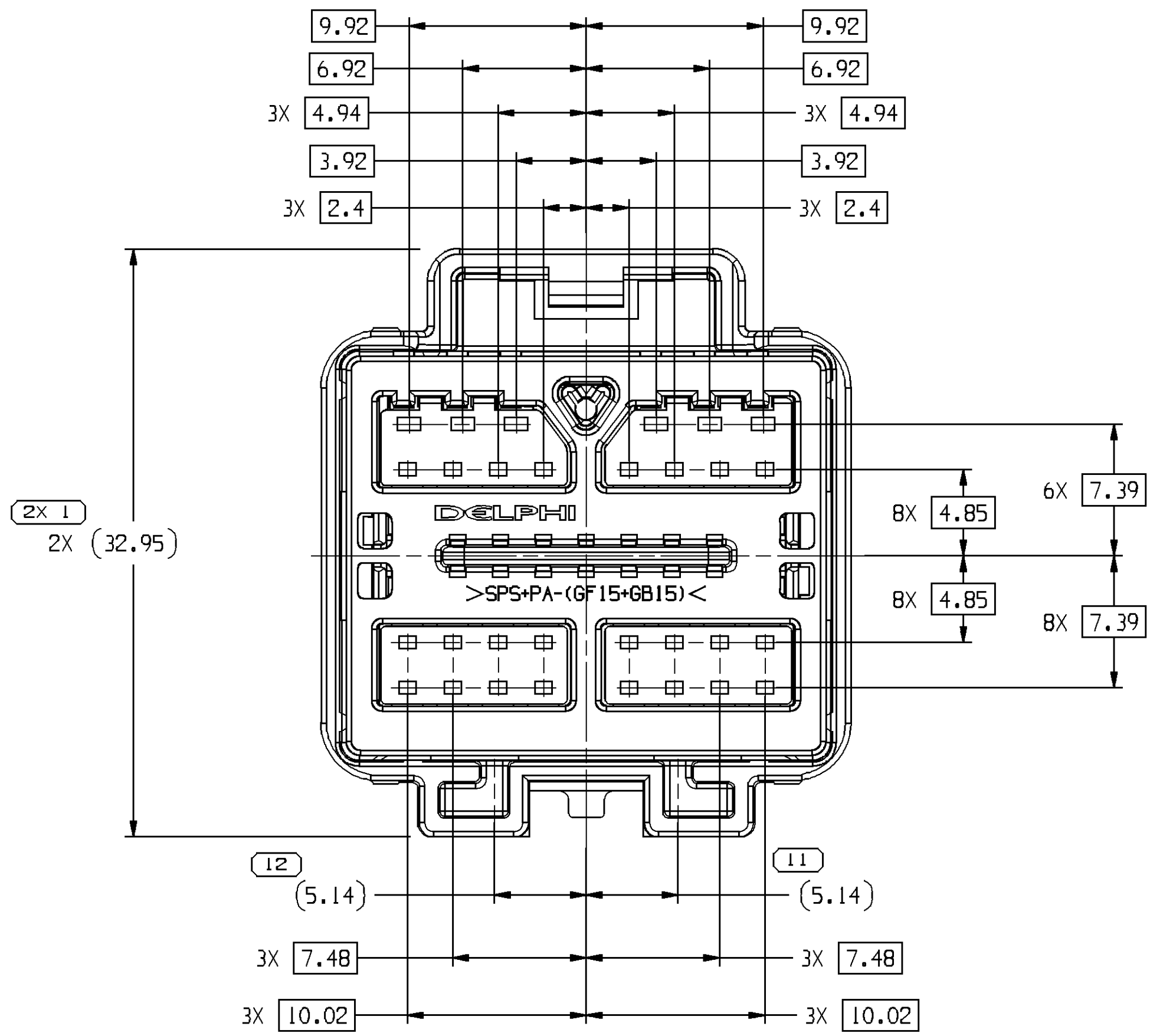

TYPE 101

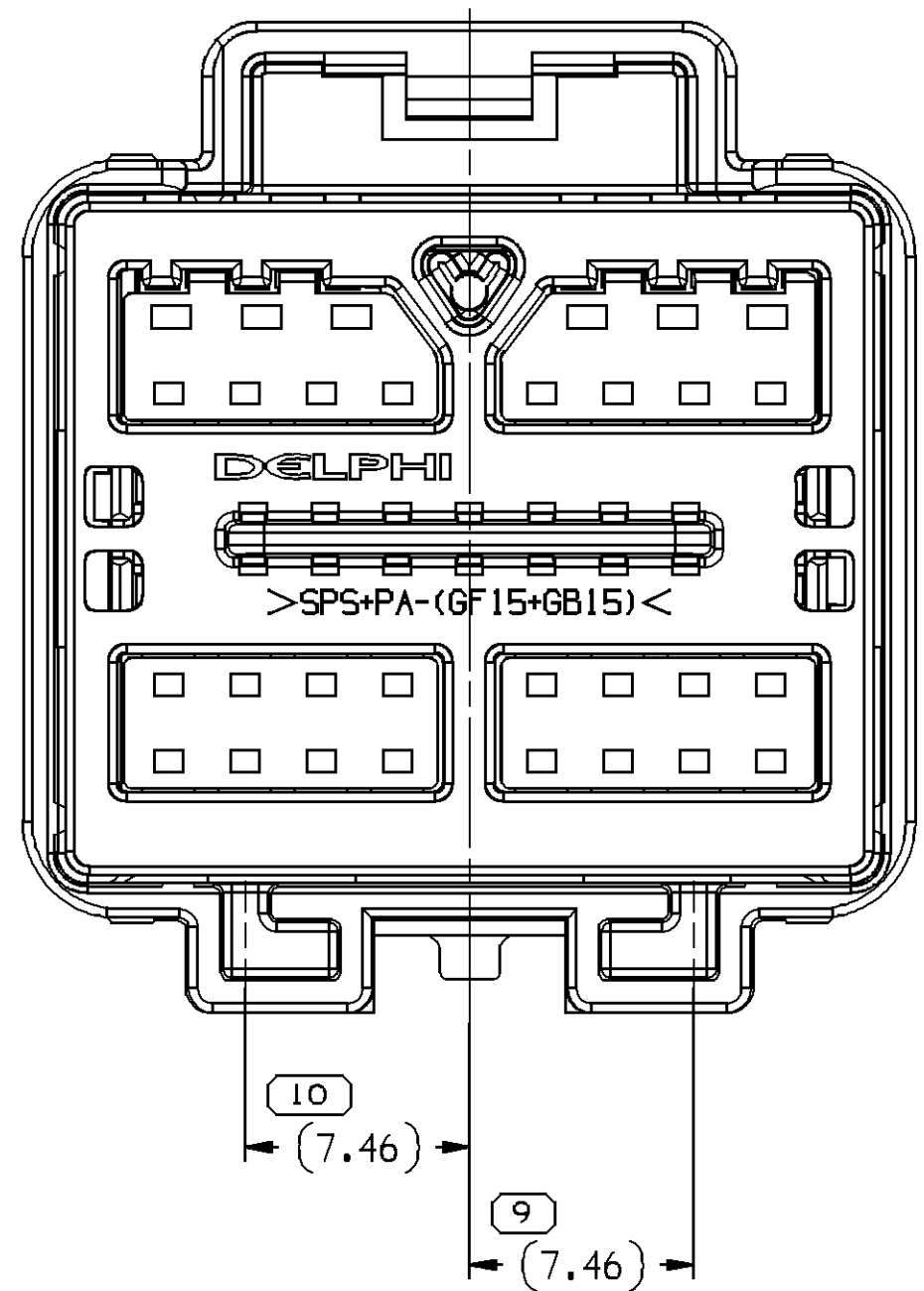
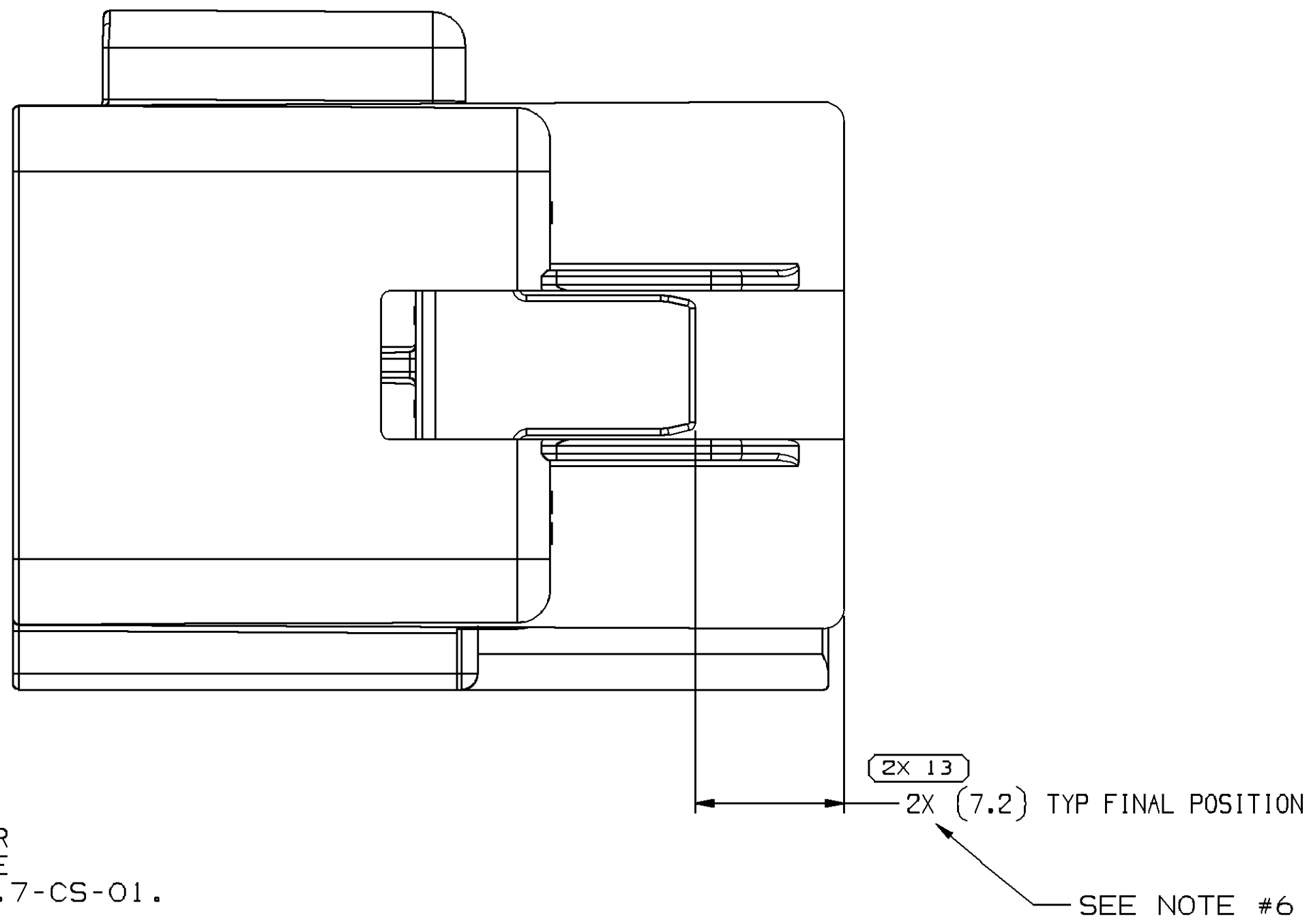
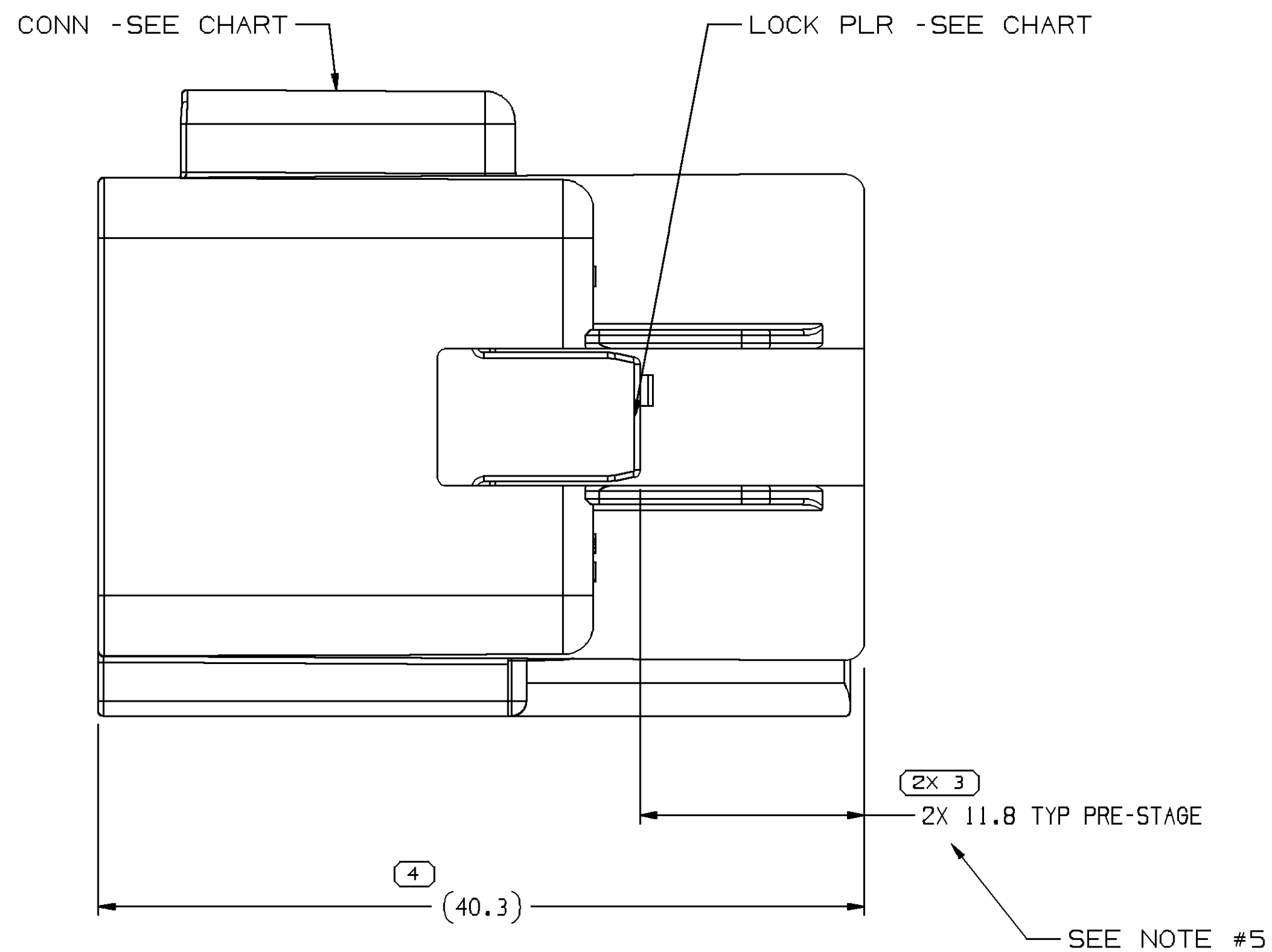

TYPE 104  
SAME AS TYPE 101  
EXCEPT AS SHOWN

33268479	02	AC	104	33268491	33268480	
33268478	02	AC	103	33268490	33268480	
33268477	02	AC	102	33268489	33268480	
33268476	02	AC	101	33268488	33268480	
PART	NO	REV	N/P	TYPE	CONNECTOR	LOCK PLR

NOTES

- UNLESS OTHERWISE SPECIFIED AND/OR INDICATED:  
DIMENSIONS ARE TO FACE OF VIEW SHOWN AND AUTOMATICALLY ROUNDED BY COMPUTER FOR INSPECTION (SEE MATH MODEL FOR PRECISE DIMENSIONS). FOR ALL OTHER DIMENSIONS NOT SHOWN BUT REQUIRED FOR TOOL BUILD, SEE MATH MODEL FOR PRECISE TOOL PATH DATA.
- THIS PRODUCT IS NOT CATEGORIZED AS AN APPEARANCE ITEM, MINOR IMPERFECTIONS INCLUDING, BUT NOT LIMITED TO, FLOW MARKS, COLOR BLEMISHES, GATE VESTIGE, AND SOFT FLASH THAT DO NOT AFFECT THE FIT, FORM, OR FUNCTION OF THE PART ARE PERMISSIBLE PER DPNP-4.7-CS-01.
- FOR APPLICATION DATA SEE THE INDIVIDUAL APPLICATION DRAWINGS.
- SEALING CODE 0 - UNSEALED
- DELIVERY CONDITION TO WIRE ASSEMBLY PLANT. PLR PRE-STAGED POSITION BEFORE TERMINALS.
- DELIVERY CONDITION TO VEHICLE ASSEMBLY PLANT. PLR FINAL POSITION AFTER TERMINALS.
- BEFORE TERMINAL ASSEMBLY, VERIFY THE PLR IS IN THE PRE-STAGE POSITION ON THE CONNECTOR. IF NOT, RETURN THE PLR TO PRE-STAGE POSITION.

DIMENSIONAL RANGE (MM)		TOLERANCE		CHART		ET	
FROM	TO	> 0	> 20	> 30	> 70	> 100	> 150
20	30	0.2	0.3	0.4	0.5	0.6	0.8
30	40	0.2	0.3	0.4	0.5	0.6	0.8
40	50	0.2	0.3	0.4	0.5	0.6	0.8
50	60	0.2	0.3	0.4	0.5	0.6	0.8
60	70	0.2	0.3	0.4	0.5	0.6	0.8
70	80	0.2	0.3	0.4	0.5	0.6	0.8
80	90	0.2	0.3	0.4	0.5	0.6	0.8
90	100	0.2	0.3	0.4	0.5	0.6	0.8
100	110	0.2	0.3	0.4	0.5	0.6	0.8
110	120	0.2	0.3	0.4	0.5	0.6	0.8
120	130	0.2	0.3	0.4	0.5	0.6	0.8
130	140	0.2	0.3	0.4	0.5	0.6	0.8
140	150	0.2	0.3	0.4	0.5	0.6	0.8
150	160	0.2	0.3	0.4	0.5	0.6	0.8
160	170	0.2	0.3	0.4	0.5	0.6	0.8
170	180	0.2	0.3	0.4	0.5	0.6	0.8
180	190	0.2	0.3	0.4	0.5	0.6	0.8
190	200	0.2	0.3	0.4	0.5	0.6	0.8
200	210	0.2	0.3	0.4	0.5	0.6	0.8
210	220	0.2	0.3	0.4	0.5	0.6	0.8
220	230	0.2	0.3	0.4	0.5	0.6	0.8
230	240	0.2	0.3	0.4	0.5	0.6	0.8
240	250	0.2	0.3	0.4	0.5	0.6	0.8
250	260	0.2	0.3	0.4	0.5	0.6	0.8
260	270	0.2	0.3	0.4	0.5	0.6	0.8
270	280	0.2	0.3	0.4	0.5	0.6	0.8
280	290	0.2	0.3	0.4	0.5	0.6	0.8
290	300	0.2	0.3	0.4	0.5	0.6	0.8
300	310	0.2	0.3	0.4	0.5	0.6	0.8
310	320	0.2	0.3	0.4	0.5	0.6	0.8
320	330	0.2	0.3	0.4	0.5	0.6	0.8
330	340	0.2	0.3	0.4	0.5	0.6	0.8
340	350	0.2	0.3	0.4	0.5	0.6	0.8
350	360	0.2	0.3	0.4	0.5	0.6	0.8
360	370	0.2	0.3	0.4	0.5	0.6	0.8
370	380	0.2	0.3	0.4	0.5	0.6	0.8
380	390	0.2	0.3	0.4	0.5	0.6	0.8
390	400	0.2	0.3	0.4	0.5	0.6	0.8
400	410	0.2	0.3	0.4	0.5	0.6	0.8
410	420	0.2	0.3	0.4	0.5	0.6	0.8
420	430	0.2	0.3	0.4	0.5	0.6	0.8
430	440	0.2	0.3	0.4	0.5	0.6	0.8
440	450	0.2	0.3	0.4	0.5	0.6	0.8
450	460	0.2	0.3	0.4	0.5	0.6	0.8
460	470	0.2	0.3	0.4	0.5	0.6	0.8
470	480	0.2	0.3	0.4	0.5	0.6	0.8
480	490	0.2	0.3	0.4	0.5	0.6	0.8
490	500	0.2	0.3	0.4	0.5	0.6	0.8
500	510	0.2	0.3	0.4	0.5	0.6	0.8
510	520	0.2	0.3	0.4	0.5	0.6	0.8
520	530	0.2	0.3	0.4	0.5	0.6	0.8
530	540	0.2	0.3	0.4	0.5	0.6	0.8
540	550	0.2	0.3	0.4	0.5	0.6	0.8
550	560	0.2	0.3	0.4	0.5	0.6	0.8
560	570	0.2	0.3	0.4	0.5	0.6	0.8
570	580	0.2	0.3	0.4	0.5	0.6	0.8
580	590	0.2	0.3	0.4	0.5	0.6	0.8
590	600	0.2	0.3	0.4	0.5	0.6	0.8
600	610	0.2	0.3	0.4	0.5	0.6	0.8
610	620	0.2	0.3	0.4	0.5	0.6	0.8
620	630	0.2	0.3	0.4	0.5	0.6	0.8
630	640	0.2	0.3	0.4	0.5	0.6	0.8
640	650	0.2	0.3	0.4	0.5	0.6	0.8
650	660	0.2	0.3	0.4	0.5	0.6	0.8
660	670	0.2	0.3	0.4	0.5	0.6	0.8
670	680	0.2	0.3	0.4	0.5	0.6	0.8
680	690	0.2	0.3	0.4	0.5	0.6	0.8
690	700	0.2	0.3	0.4	0.5	0.6	0.8
700	710	0.2	0.3	0.4	0.5	0.6	0.8
710	720	0.2	0.3	0.4	0.5	0.6	0.8
720	730	0.2	0.3	0.4	0.5	0.6	0.8
730	740	0.2	0.3	0.4	0.5	0.6	0.8
740	750	0.2	0.3	0.4	0.5	0.6	0.8
750	760	0.2	0.3	0.4	0.5	0.6	0.8
760	770	0.2	0.3	0.4	0.5	0.6	0.8
770	780	0.2	0.3	0.4	0.5	0.6	0.8
780	790	0.2	0.3	0.4	0.5	0.6	0.8
790	800	0.2	0.3	0.4	0.5	0.6	0.8
800	810	0.2	0.3	0.4	0.5	0.6	0.8
810	820	0.2	0.3	0.4	0.5	0.6	0.8
820	830	0.2	0.3	0.4	0.5	0.6	0.8
830	840	0.2	0.3	0.4	0.5	0.6	0.8
840	850	0.2	0.3	0.4	0.5	0.6	0.8
850	860	0.2	0.3	0.4	0.5	0.6	0.8
860	870	0.2	0.3	0.4	0.5	0.6	0.8
870	880	0.2	0.3	0.4	0.5	0.6	0.8
880	890	0.2	0.3	0.4	0.5	0.6	0.8
890	900	0.2	0.3	0.4	0.5	0.6	0.8
900	910	0.2	0.3	0.4	0.5	0.6	0.8
910	920	0.2	0.3	0.4	0.5	0.6	0.8
920	930	0.2	0.3	0.4	0.5	0.6	0.8
930	940	0.2	0.3	0.4	0.5	0.6	0.8
940	950	0.2	0.3	0.4	0.5	0.6	0.8
950	960	0.2	0.3	0.4	0.5	0.6	0.8
960	970	0.2	0.3	0.4	0.5	0.6	0.8
970	980	0.2	0.3	0.4	0.5	0.6	0.8
980	990	0.2	0.3	0.4	0.5	0.6	0.8
990	1000	0.2	0.3	0.4	0.5	0.6	0.8

A. LINE DRAWN THROUGH A PART NUMBER INDICATES THAT PHYSICAL PARTS ARE NOT AVAILABLE FOR ORDERING.	
PART NUMBERS THAT DO NOT HAVE A LINE PRESENT INDICATE THAT PHYSICAL PARTS ARE AVAILABLE FOR ORDERING.	
CONTACT DELPHI SALES TO ASSURE AVAILABILITY OF PARTS.	
DWG TYPE	PART DRAWING
STYLE	
VOLUME (OMP)	DISTR CODE
UNLESS OTHERWISE SPECIFIED	
THIS DOCUMENT IS IN ACCORDANCE WITH ASME Y14.5M-1994 AS MODIFIED BY THE 2003 DIMENSIONING AND TOLERANCING ADDENDUM-2003. SEPARATE PATTERNING OF FEATURES MAY BE SHOWN SEPARATELY, RESPECTIVE OF DATUM REFERENCES.	
ALL DIMENSIONS ARE IN MILLIMETERS	
REFERENCE	
THIRD ANGLE PROJECTION	
DO NOT SCALE	
USE MATH DATA	

<b>DELPHI</b>	
DELPHI PACKARD ELECTRICAL/ELECTRONIC ARCHITECTURE	
WARREN, OH	
COPYRIGHT 2015 DELPHI CORPORATION AND/OR ITS AFFILIATES. ALL RIGHTS RESERVED.	
THIS DRAWING IS THE PROPERTY OF DELPHI CORPORATION AND CONTAINS DELPHI CONFIDENTIAL INFORMATION. THE REPRODUCTION, DISTRIBUTION AND UTILIZATION OF THIS DOCUMENT OR ITS RELATED CAD DATA, AS WELL AS COMMUNICATION OF ANY CONTENT TO OTHERS, WITHOUT EXPRESS AUTHORIZATION, IS PROHIBITED.	
DATE	
DR	
APVD1 A. GARCIA CABELLO	21AUI5
APVD2 A. GARCIA CABELLO	21AUI5
APVD3 JOHN SCHNEIDER	24AUI5
APVD4	
APVD5	
SUBSTANCES OF CONCERN AND RECYCLED CONTENT PER DELPHI (2014000)	
DRAWING NAME	
TAXI ASM CONN 30 M 0.64	
GEN Y OCS 1.2	
DRAWING NUMBER	
33268475	
SIZE	A0
SCALE	4:1
FRAME NO	1 OF 2
SHEET NO	1 OF 1
STG	R
REV	06
N/P	

# Mouser Electronics

Authorized Distributor

Click to View Pricing, Inventory, Delivery & Lifecycle Information:

[Aptiv:](#)  
[33268478](#)