

VIEW SCALE DOES NOT REFLECT
ACTUAL PART SIZE

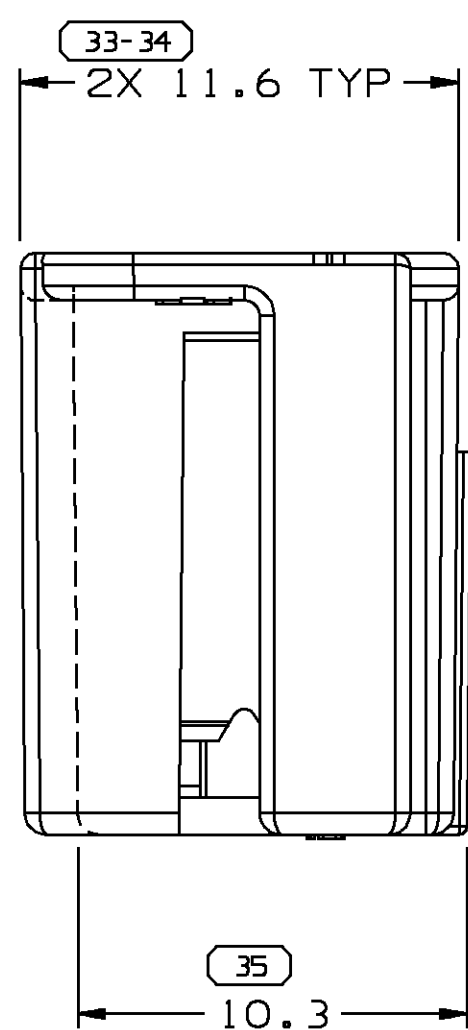

NOTES

- UNLESS OTHERWISE SPECIFIED AND/OR INDICATED:
DIMENSIONS ARE TO FACE OF VIEW SHOWN AND
AUTOMATICALLY ROUNDED BY COMPUTER FOR INSPECTION.
(SEE MATH MODEL FOR PRECISE DIMENSIONS.) FOR ALL
OTHER DIMENSIONS NOT SHOWN BUT REQUIRED FOR TOOL
BUILD, SEE MATH MODEL FOR PRECISE TOOL PATH DATA.
- MATING COMPONENTS OR EQUIVALENT:
CONNECTOR 12129025
- THIS PART ACCEPTS THE FOLLOWING COMPONENTS OR EQUIVALENT:
SEAL 12129026
STRAIN RELIEF 12129028
CAVITIES PLUGS 12129557
TERMINAL 12084912
CPA 12110299

THE FOLLOWING APPLY UNLESS OTHERWISE SPECIFIED:	
PERFECT FORM REQUIRED FOR FEATURES OF SIZE AT MMC. TRUE POSITION TOLERANCES AND RELATED DATUMS APPLY AT CONDITION OF SIZE INDICATED IN FEATURE CONTROL FRAME. OTHER GEOMETRIC TOLERANCES AND RELATED DATUMS APPLY RFS. SEPARATE TRUE POSITION CALLOUTS MAY BE GAGED SEPA- RATELY, REGARDLESS OF DATUM REFERENCE. SEE GM STAND- ARDS, AND APPLICABLE DIVISIONAL STANDARDS, FOR INTERPRETATION.	
GEOMETRIC DRAWING SYMBOLS	
FLAT — STRAIGHT ROUND — PROFILE OF A SURFACE CYLINDRICAL — ANGULAR MAXIMUM MATERIAL CONDITION (MMC) LEAST MATERIAL CONDITION (LMC) REGARDLESS OF FEATURE SIZE (RFS) PROJECTED TOL. ZONE	PARALLEL — TRUE POSITION CIRCULAR RUNOUT — DIAMETER TOTAL RUNOUT — BASIC DIMENSION

PART NO	STG	REV	N/P	STATUS	MATERIAL SPECIFICATION AND COLOR	VOLUME	A	B	MATING HEADER CONN. ASSEMBLY
12129024	R	C2	-		PM002060 003 PC-RED TRANSPARENT	2.504	43.41±0.15	39.36±0.15	12129009 OR 12129019
12129023	R	C2	-		PM002060 006 PC-BLU MD TRANSPARENT	2.504	39.2±0.15	35.15±0.15	12129008 OR 12129018
12129022	R	C2	-		PM002060 002 PC-CLR TRANSPARENT	2.504	26.55±0.15	22.5±0.15	12129007 OR 12129017
12129021	R	D2	-		PM002060 014 PC-BLK TRANSPARENT	2.504	9.69	5.64	12129006 OR 12129016

(41) PROCESS SENSITIVE DIMENSION	
DIMENSIONS ENCLOSED IN () INDICATE REFERENCE DIMENSIONS AND NO TOLERANCE LIMITS ARE ESTABLISHED	

DELPHI Automotive Systems	
MATERIAL SPEC SEE CHART	DIMENSIONAL RANGE (MM) CHART FROM 0 TO 20 20 TO 30 30 TO 70 70 TO 100 TOLERANCE UNLESS OTHERWISE SPECIFIED 10.15±0.21 0.31±0.1±0.3 ANGULAR TOLERANCE ± 2°
PART DRAWING	
CODE NUMBER 6901	DWG DATE 30SE99
QC SPEC	STYLE
SCALE 5:1 VOLUME cm³ SEE CHRT	
PART GEOMETRY 3D SOLID	
UNLESS OTHERWISE SPECIFIED: PERFECT FORM REQUIRED FOR FEATURES OF SIZE AT MMC. TRUE POSITION TOLERANCES AND RELATED DATUMS APPLY AT CONDITION OF SIZE INDICATED IN FEATURE CONTROL FRAME. ALL OTHER GEOMETRIC TOLERANCES AND RELATED DATUMS APPLY RFS. SEPARATE TRUE POSITION CALLOUTS MAY BE GAGED SEPARATELY, REGARDLESS OF DATUM REFERENCE.	
CHANGE RESTRICTED NO MANUAL CHANGES	UG
COPY OF MATH DATA DO NOT SCALE	REFERENCE 001,701
METRIC UNLESS OTHERWISE SPECIFIED, ALL DIMENSIONS ARE IN MILLIMETERS	DR APVD1 L. MACIAS APVD2 J. VILLAMIL APVD3 CHRIS REIDER APVD4 R. J. POLEHONK1 APVDS
THIRD ANGLE PROJECTION	DRAWING NAME TAX1 RETAINER F MIC/P 100W
SHEET NUMBER 1 OF 1	DRAWING NUMBER 12129020
DWG STATUS STG REV N/P R 001 -	SIZE A0

Mouser Electronics

Authorized Distributor

Click to View Pricing, Inventory, Delivery & Lifecycle Information:

[Aptiv:](#)

[12129021](#)