

		8				7				6				5				4			
Elevé Strate		CONTACT / TERMINAL																Matière Material	Classe Class	Marquage Mark	
		L-SHAPE OVERLAPING		REQUIREMENT OVERLAPING		REQUIREMENT OVERLAPING		JUF / SYS		REQUIREMENT OVERLAPING		JUF / SYS		REQUIREMENT OVERLAPING		JUF / SYS					
		P/N	Rev.	P/N	Rev.	P/N	Rev.	P/N	Rev.	P/N	Rev.	P/N	Rev.	P/N	Rev.	P/N	Rev.				
Pré-plaqué Pre-Formed Sn 1 to 3µm	MVL	/	/	2110250150P	0	2110251150P	0	/	/	2110254150P	0	/	/	2110252150P	0	/	/	Cu Zn 15	85°	NO	
	APTIV	/	/	33523642	01	13777390	01	/	/	33523694	01	/	/	13777391	01	/	/				
	MVL	/	/	2110250160P	0	2110251160P	0	2110251161P	0	2110254160P	0	2110254161P	0	2110252160P	0	2110252161P	0	Cu Fe 2P	125°	125	
	APTIV	33308333	01	13625048	01	10863984	01	13761154	01	10865152	01	13761651	01	10863985	01	13761648	01				
	MVL	/	/	/	/	2110254140P	0	/	/	2110254140P	0	/	/	2110252140P	0	/	/				
Pré-plaqué Pre-Formed Au 1.27µm min	APTIV	/	/	/	/	13602481	01	/	/	33501712	01	/	/	33511808	01	/	/	Cu Au Fe Ti Si	125°	150	
	MVL	/	/	2110250460P	0	2110251460P	0	/	/	0	2110254460P	0	/	/	2110252460P	0	/	/			
	APTIV	33308344	01	13764603	01	13764604	01	/	/	33500701	01	/	/	13764602	01	/	/	Cu Fe 2P	125°	125	
	RANGE	00		0				1						4							
	Section Gauge	0.13		0.22				0.35 to 0.70						0.75 to 1.30				1.35 to 2.00			
Ø tolérances Ø tolerances		0.95 to 1.35		1.15 to 1.35				1.25 to 2.10						1.60 to 2.60				2.10 to 2.80			
A		1.75		1.53				2.60						2.88				3.10			
Al		1.60		/				/						/				/			
B		1.70		1.87				2.20						2.86				3.50			
R=C		0.31		0.33				0.75						0.75				0.75			
D ± 0.30		2.81		2.87				4.20		4.70				4.70				5.00			
E		2.60		3.05				3.30		4.15				4.20				4.50			
R=F		0.68		0.68				1.30		1.35				1.30				1.35			
Poids sans bande porteuse Weight without carrier strip		0.00043g		0.00043g		0.00045g		0.00044g		0.00045g		0.00045g		0.00047g		0.00046g					

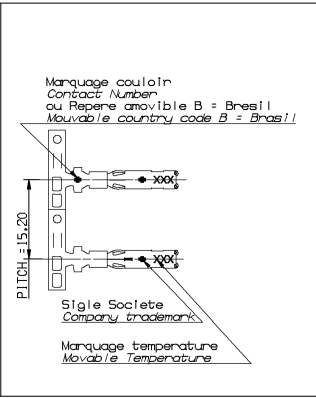
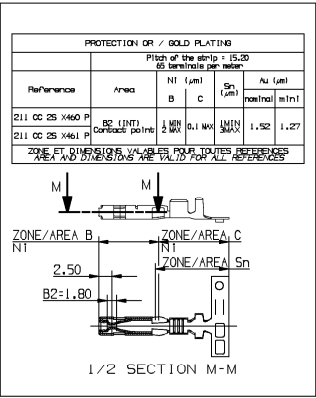
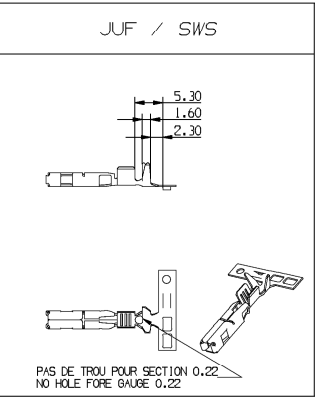
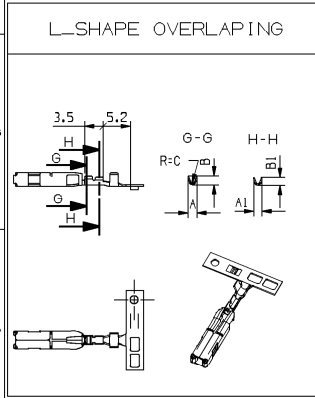
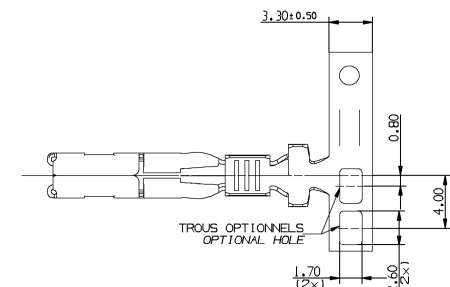
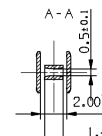
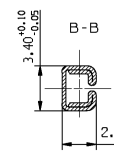
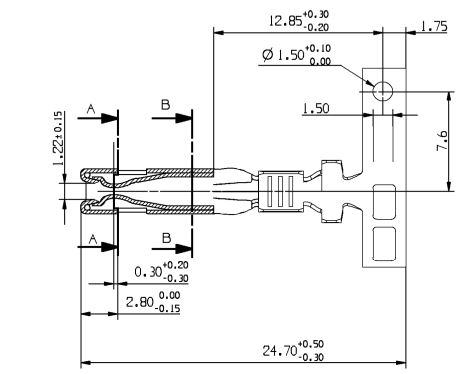
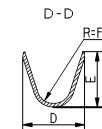
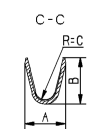
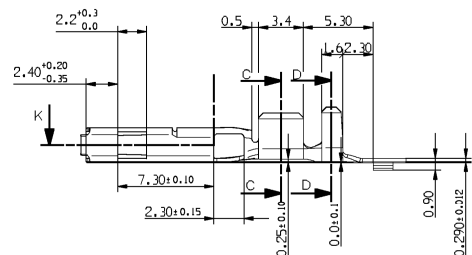
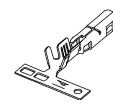

DWG TYP  
PART DRAWING  
WEIGHT (GR)  
VOLUME (CM)  
ROUTING

UNLESS OTHERWISE SPECIFIED  
GENERAL TOLERANCES  
ACCORDING TO:  
±0.2 ±2°

GO&T  
ACCORDING TO:

REFERENCE  
211F0463

FIRST ANGLE PROJECTION

DO NOT SCALE  
USE MATH DATA

# DELPHI

DELPHI PACKARD ELECTRICAL/ELECTRONIC ARCHITECTURE  
Espem, France

COPYRIGHT 2017 DELPHI CORPORATION AND/OR ITS AFFILIATES.  
ALL RIGHTS RESERVED.  
REVISED 2018

THIS DRAWING IS THE PROPERTY OF DELPHI CORPORATION  
AND CONTAINS DELPHI CONFIDENTIAL INFORMATION.  
THE REPRODUCTION, DISTRIBUTION AND UTILIZATION  
OF THIS DOCUMENT OR ITS RELATED DATA DATA,  
AS WELL AS COMMUNICATION OF ANY CONTENT TO OTHERS,  
WITHOUT EXPRESS AUTHORIZATION, IS PROHIBITED.

CE PLAN EST LA PROPRIÉTÉ DE DELPHI CORPORATION ET CONTIENT DES  
INFORMATIONS RELIÉES À LA PROPRIÉTÉ DE DELPHI CORPORATION  
ET À L'UTILISATION DE CE DOCUMENT OU DE SES DONNÉES INDIVIDUELLES CAR  
IL Y A LA COMMUNICATION DE TOUT CONTENU À AUTRUI SANS AUTORISATION  
EXPRESSE EST INTERDITE.

DR	L. DOMERGUE	DATE	28MR17
API01	LEDESCLUSE		28MR17
API02	P. CAPPE		28MR17
API03			
API04			
API05			

SUBSTANCES OF CONSERVATION AND RECYCLED CONTENT PER DELPHI 10949001  
MATERIALS PROPERTIES ET CONTENU RECYCLABLE SELON  
DELPHI 10949001

DRAWING NAME  
FEMALE TERMINAL 1.50 x 0.80

SICMA 3+

DRAWING NUMBER  
10857567

SIZE	SCALE	FRAME NO	SHEET NO	REV	N/P
A1	5:1	1 OF 1	1 OF 3	R	02 AC

# Mouser Electronics

Authorized Distributor

Click to View Pricing, Inventory, Delivery & Lifecycle Information:

[Aptiv:](#)

[211CC2S2160P](#) [211CC2S2160P-L](#)