

PART IN CLOSED POSITION

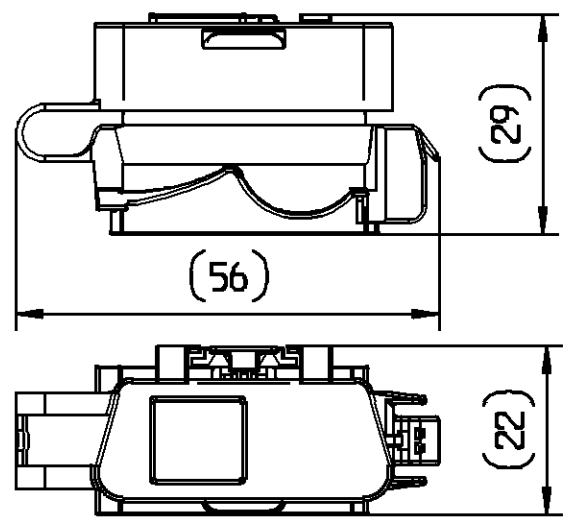

VAR B -PART-NO. 13800154

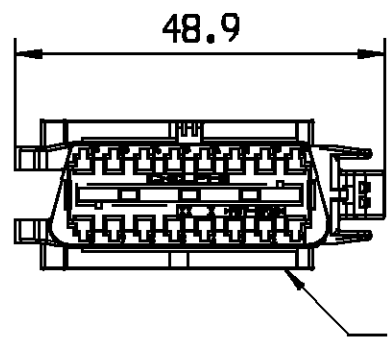

PART CAVITY NUMBER / FORMAT
ACCORDING TO DIN 1451; H=1 MM;
LETTERS 0.2 MM RECESSED

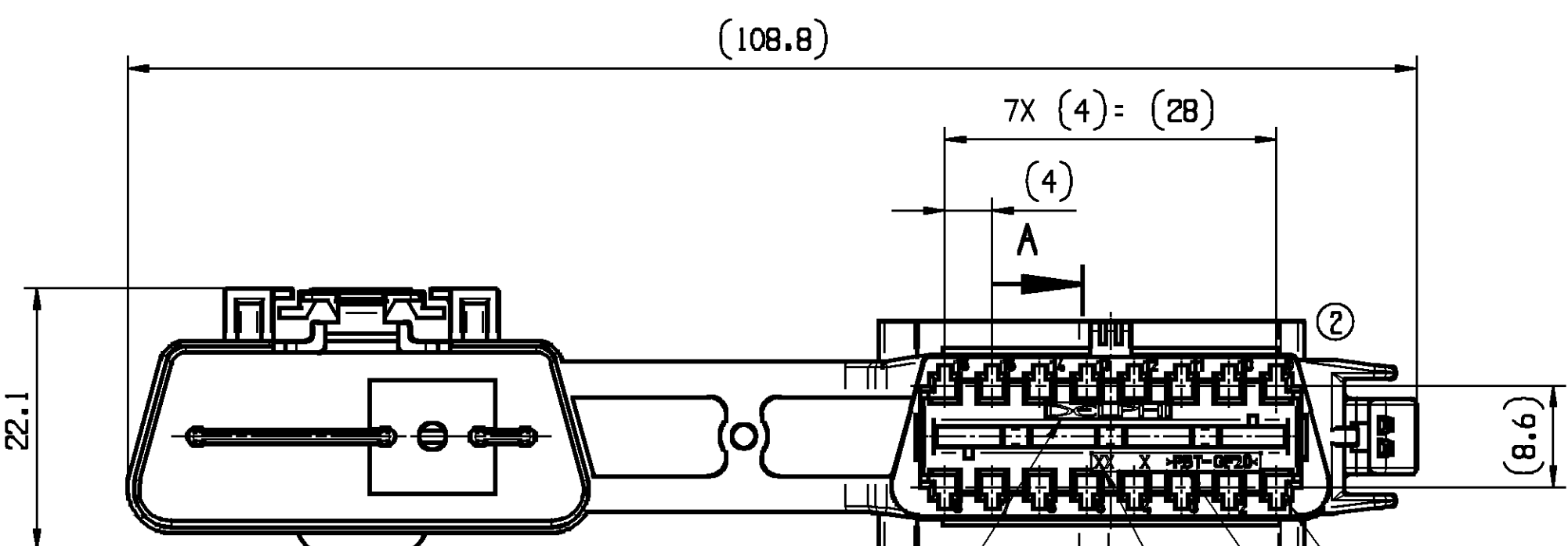
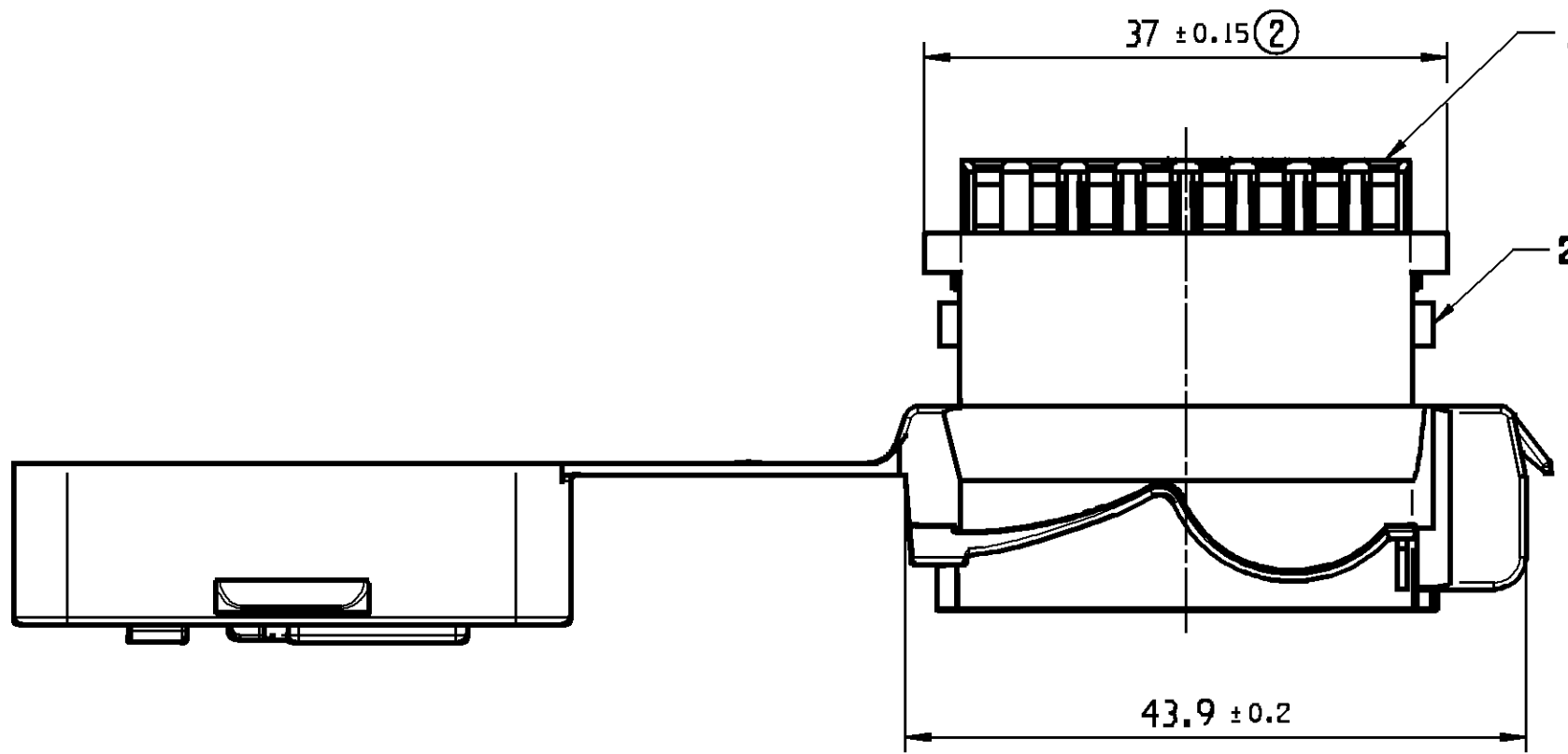
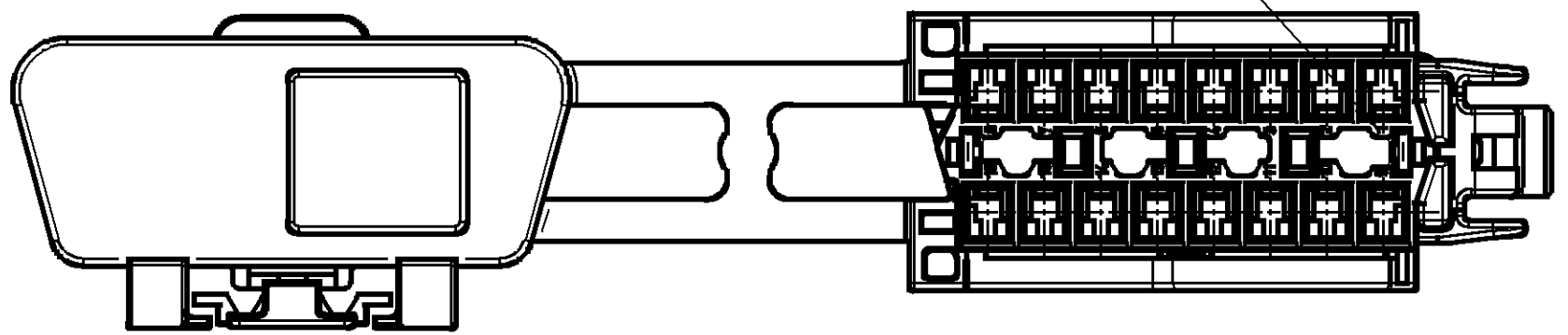

MANUFACTURER MARK A=1.0 MM
FORMAT ACCORDING TO DS 11001

PART CAVITY NUMBER / FORMAT
ACCORDING TO DIN 1451; H=1 MM;
LETTERS 0.2 MM RECESSED

MATERIAL NAME ACCORDING TO VDA 260 /
FORMAT ACCORDING TO DIN 1451; H=1.6 MM

TOOL CAVITY NUMBER / FORMAT
ACCORDING TO DIN 1451; H=1.6 MM

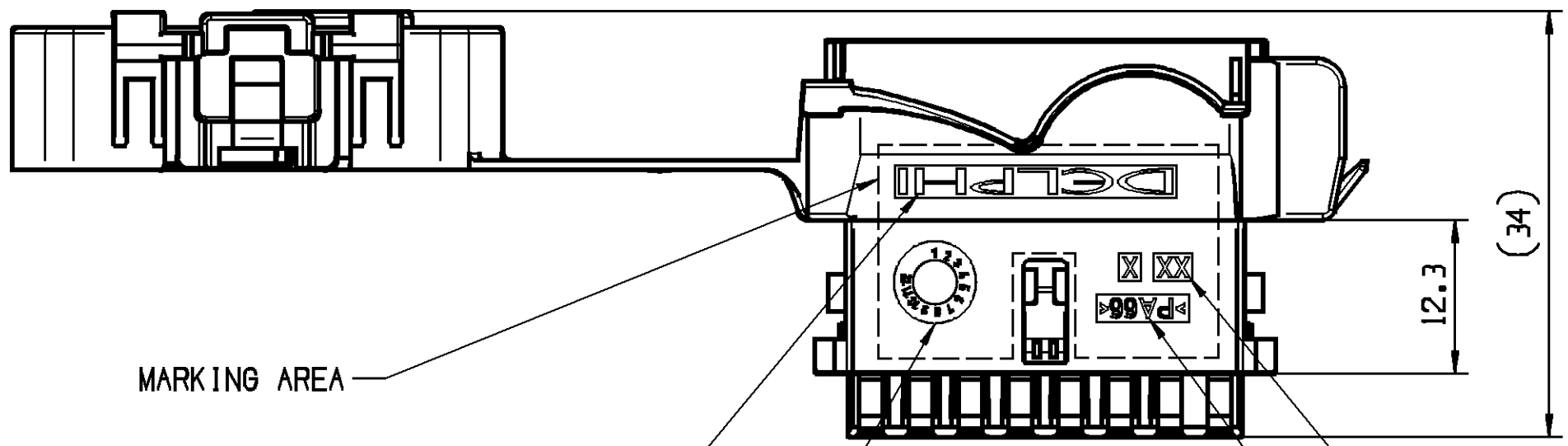

MANUFACTURER MARK A=1.6 MM
FORMAT ACCORDING TO DS 11001

TOOL CAVITY NUMBER / FORMAT
ACCORDING TO DIN 1451; H=1.6 MM

DATE INSERT SIMILAR FIRM OPITZ 06;
HAS TO BE THE MANUFACTURING DATE

MATERIAL NAME ACCORDING TO VDA 260 /
FORMAT ACCORDING TO DIN 1451; H=1.6 MM

VAR	TITLE	PART-NO.:	PART-REV	DATE	AMOUNT	MATERIAL	SIMILAR TO RAL	NOTES
A	FEMALE CONNECTOR 16 WAY WITH CAP ASS.	13800155	03	14MY13	---	---	---	CONDITION OF DELIVERY, POS. 1-2 ASSEMBLED
1	FEMALE HOUSING 16 WAY WITH CAP	13800094	---	---	1	PA66 GRA	7001	ONLY ASSEMBLED PARTS AVAILABLE
2	PLR	13800104	---	---	1	PBT-0F20 XF YEL	1021	ONLY ASSEMBLED PARTS AVAILABLE
B	FEMALE CONNECTOR 16 WAY ASSEMBLY	13800154	03	13MY13	---	---	---	CONDITION OF DELIVERY, POS. 2-3 ASSEMBLED
3	FEMALE HOUSING 16 WAY	13800089	---	---	1	PA66 BLK	7001	ONLY ASSEMBLED PARTS AVAILABLE
2	PLR	13800104	---	---	1	PBT-0F20 XF YEL	1021	ONLY ASSEMBLED PARTS AVAILABLE

③ INTERFACE CLIP HOLDER SUPPORT 'DIAGNOSTIC CONNECTOR'
CABLE SIDE VIEW F1 COCPIT SIDE VIEW F

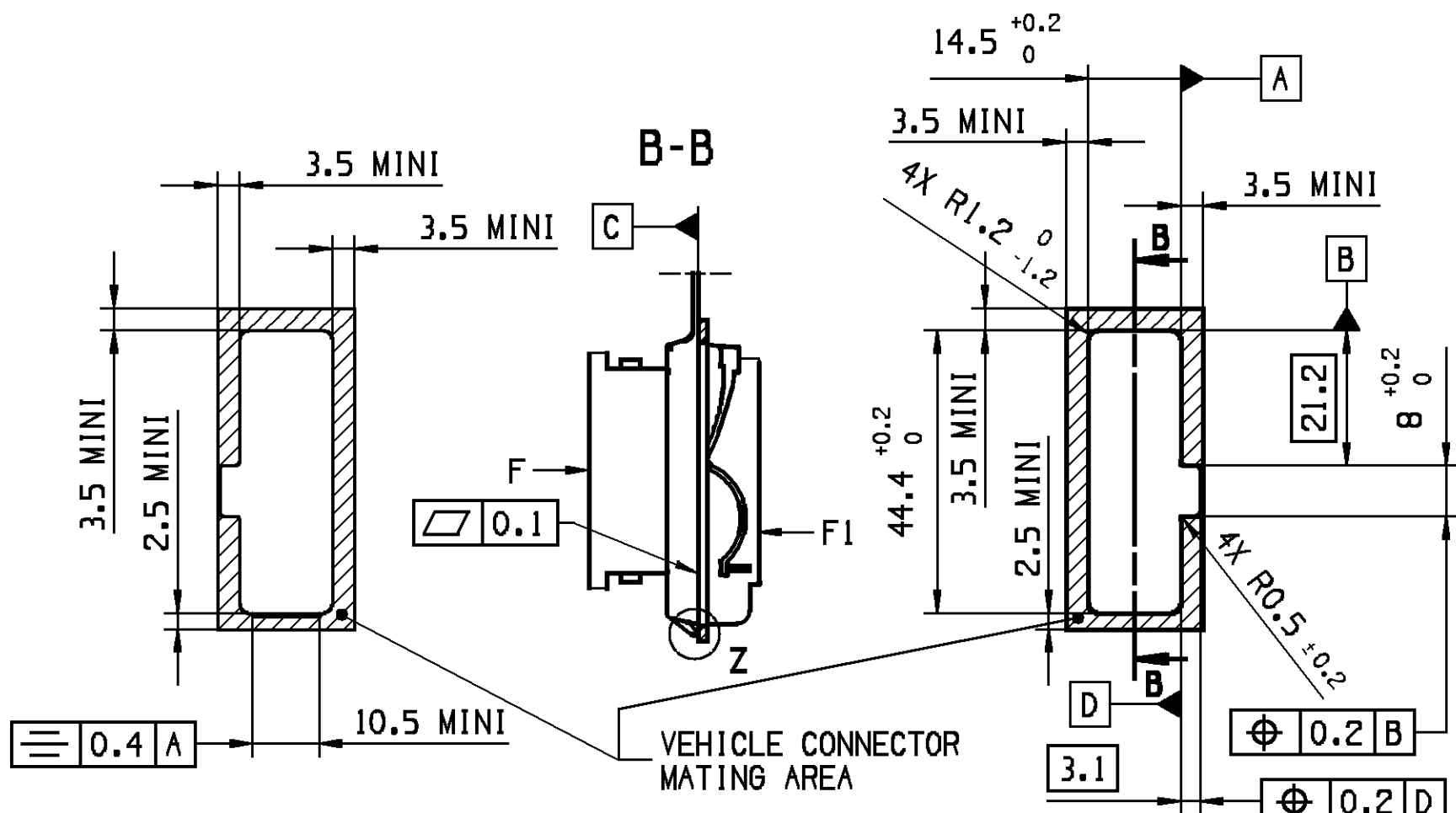

DETAIL Z EACH: 5:1

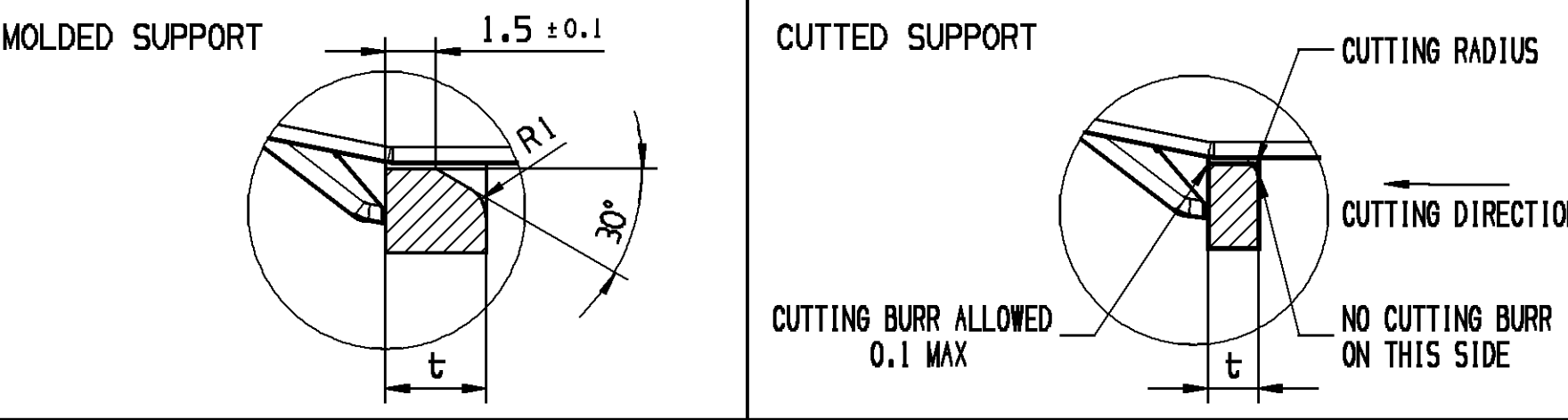

VIEW WITH PLR LOCKED
A-A

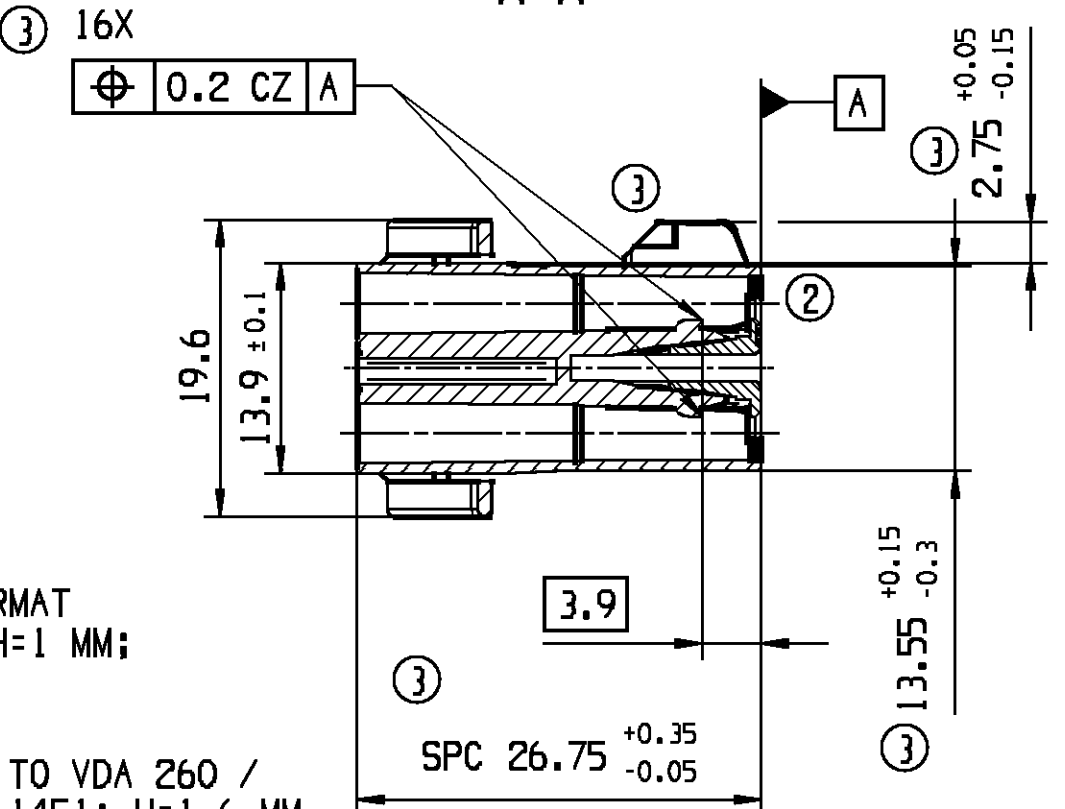

REMARKS:

- MAXIMUM DRAFT ANGLE 0°30
- LETTERS AND ENGRAVINGS 0.05/0.2 MM RAISED/RECESSED
- SPC: STATISTICAL PROCESS CONTROL
- FOR APPLICATION DATA SEE THE INDIVIDUAL APPLICATION DRAWINGS.

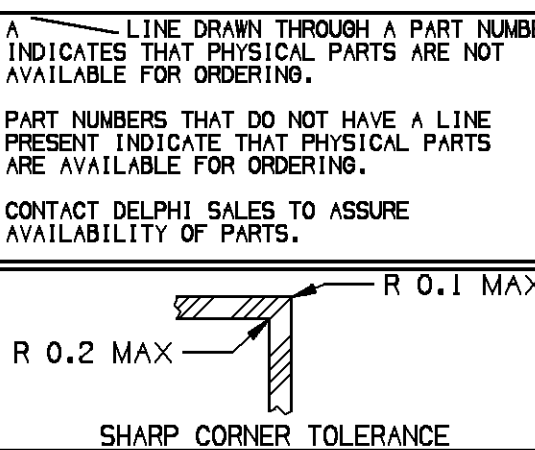

DIM TO CHECK	DIMENSIONAL RANGE (MM)	CHART E1
() DIM FOR HELP	FROM TO	
□ THEORETIC DIM		

DWG STATUS					ZONE	REVISION HISTORY	AUTH	DR	APVD 1	APVD 2											
DATE	STG	REV	N/P	CHG																	
10DE09	R	01				INITIAL RELEASE			P.LES	M.MLE	W.SKR										
28MY12	R	02	--	F8	DIN 37±0.15 WAS 37.2±0.1																
			--	D5	DIN 13.55 ADDED																
			--	D5	HOUSING GEOMETRY CHANGED																
			--	D8	PLR GEOMETRY CHANGED				P.LES	M.MLE	W.SKR										
14MY13	R	03	--	D5	LOCKING FEATURE ON HOUSING MODIFIED				P.LES	M.MLE	W.SKR										
26JN13	R	03	AA	G6	"INTERFACE CLIP HOLDER SUPPORT..." ADDED																
			AB	C6	DIN SPC 26.75±0.35/-0.05 WAS SPC 26.75				P.LES	M.MLE	W.SKR										
				C5	DIN 13.55±0.15/-0.3 WAS 13.55																
				D5	DIN 2.75±0.05/-0.15 WAS 2.75±0.05																
				D7	GD&T <table border="1"><tr><td></td><td>0.2</td><td>CZ</td><td>A</td></tr></table> WAS <table border="1"><tr><td></td><td>0.2</td><td>CZ</td><td>A</td><td>B</td><td>C</td></tr></table>		0.2	CZ	A		0.2	CZ	A	B	C						
	0.2	CZ	A																		
	0.2	CZ	A	B	C																

SCALE:
1:1

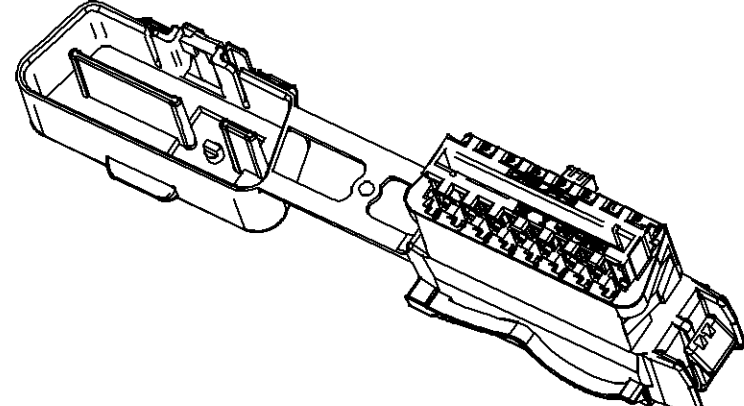

DELPHI

DELPHI PACKARD ELECTRICAL/ELECTRONIC ARCHITECTURE
KRAKOW, POLAND
COPYRIGHT 2009 DELPHI CORPORATION AND/OR ITS AFFILIATES.
ALL RIGHTS RESERVED.
REVISÉ 2013
THIS DRAWING IS THE PROPERTY OF DELPHI CORPORATION
AND CONTAINS DELPHI CONFIDENTIAL INFORMATION.
THE REPRODUCTION, DISTRIBUTION AND UTILIZATION
OF THIS DOCUMENT OR ITS RELATED CAD DATA,
AS WELL AS COMMUNICATION OF ANY CONTENT TO OTHERS,
WITHOUT EXPRESS AUTHORIZATION, IS PROHIBITED.
TEN RYSUNEK JEST WŁASNOŚCIĄ DELPHI CORPORATION I ZAWIERA POŁNE
INFORMACJE. POWIELANIE, ROZPOWISZCZANIE I WYKORZYSTYWANIE TEGO
DOKUMENTU LUB ZWIĄZANYCH Z NIM DANYCH CAD, JAK RÓWNIEŻ PRZESYŁANIE
INNYM JAKIEKOLWIEK ICH ZAWARTOŚCI, BEZ NADANIA WYRAZNYCH
UPRAWNIEN, JEST ZABRONIONE.

DR	P.LES	09DE09
APVD1	M.MLECZKO	10DE09
APVD2	M.SIKORA	03MR11
APVD3		
APVD4		
APVD5		

SUBSTANCES OF CONCERN AND RECYCLED CONTENT PER DELPHI 10949001
SUBSTANCJE NIEBEZPIECZNE I POWTÓRNIIE PRZETWORZONE OKREŚLA
DELPHI 10949001

MATERIAL
SEE CHART

DRAWING NAME
OBD-2 FEMALE CONNECTOR 16WAY
SICMA 1.5

SIZE	SCALE	FRAME NO	SHEET NO	STG	REV	N/P
A1	2:1	1 OF 1	1 OF 1	R	03	AB

Mouser Electronics

Authorized Distributor

Click to View Pricing, Inventory, Delivery & Lifecycle Information:

[Aptiv:](#)

[13800155](#)