

SYMBOL DEFINITION			MISSING SYMBOLS	
A DIMENSION WITHOUT AN INSPECTION REPORT SYMBOL  DOES NOT REQUIRE INSPECTION. IT MAY BE CONTROLLED ON THE INDIVIDUAL COMPONENT DRAWING.			17	
TOTAL NO OF INSPECTIONS REQUIRED		22		
LAST NO. USED		18		

DWS STATUS		ZONE		REVISION HISTORY		AUTH		DR	APVD	APV2
DATE	STG	REV	N/P	CHG						
19JA12	R	01	-	-	13919112 - WAS PE201747 AND RELEASED 13919113 - WAS PE201748 AND RELEASED 13919114 - WAS PE201749 AND RELEASED	416783	MAL	MAL	RBS	
02MY12	R	02	-	-	ALL PARTS - UPDATED PERFORMANCE REQUIREMENTS NOTE	417979	JEG	JEG	RBS	
04JN12	R	03	-	-	ALL PARTS - CONTACT AREA PLATING TYPE COLUMN WAS "11" ON TAXI CHART	418431	JAR	JAR	RBS	
07FE13	R	04	-	-	ALL PARTS - ADDED PLATING NOTE IV AND CRIMP AREA COLUMN IV WAS 1	421380	CGD	JVM	RBS	
11MR13	R	05	-	-	ALL PARTS - UPDATED PLATING TYPE NOTE	421590	CBG	CBG	RBS	
29JL14	R	06	-	-	ALL PARTS - 3X 2.25 ± 0.05 WAS 2.25 ± 0.05, ADDED LABEL ON DIM #4, MAX INSULATION CRIMP NOTE, REVISED NOTES* NUMBERING, PLATING TYPE & PERFORMANCE REQUIREMENT RATING NOTES AND UPDATED CRIMP AREA COLUMN CHART	426685	APB	APB	RBS	
27AU14	R	07	-	-	ALL PARTS - UPDATED PDM ATTRIBUTES	427393	APB	APB	RBS	
21OC14	R	08	-	-	ALL PARTS - UPDATED PART AVAILABILITY, REMOVED DIM #17 AND REVISED MAT'L DESCRIPTION COLUMN CHART	427975	APB	APB	RBS	
23FE15	R	09	-	-	13919113 - 13919114 - REVISED CABLE DIAMETER COLUMN CHART	428888	APB	APB	RBS	
16JL15	R	10	-	-	13919112 - CABLE SIZE WAS 0.8	430190	APB	APB	RDL	
02JL15	R	11	-	-	REVISED TERMINAL LEAD-IN FOR ALL PARTS	430058	JHG	JHG	RBS	
14OC15	R	12	-	-	ALL PARTS - UPDATED PART AVAILABILITY	431036	APB	APB	RBS	
05DE18	R	13	-	-	ALL PARTS; REVISED MATERIAL SPEC; REV LEVELS ADV TO 03	441787	CM	CM	RS	
11DE18	R	14	-	-	ALL PARTS - CORRECTED TOLERANCE FOR "B2" TO MATCH TOD (± 0.25 WAS ± 0.3)	441895	JGO	JAA	AGH	
05AP19	R	15	-	-	ALL PARTS - DIM #10 WAS 0 ± 2" AND ADDED GDSIT PROFILE OF LINE CONTROL FRAME & DATUM [A] OVERALL INFO	441273	DAV	JAA	RBS	

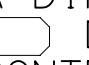

FEATURE NOT PRESENT ON 25 I.D. TERMINAL

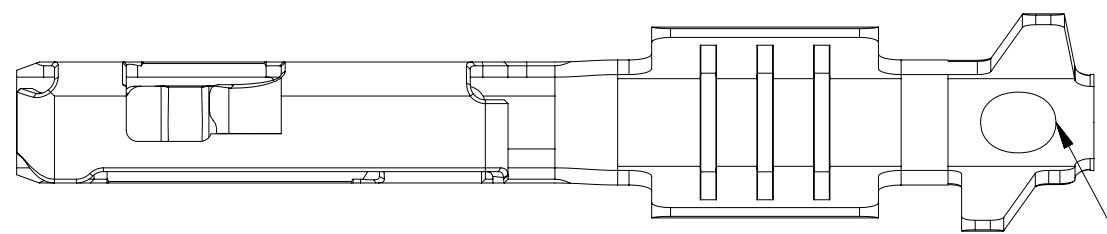
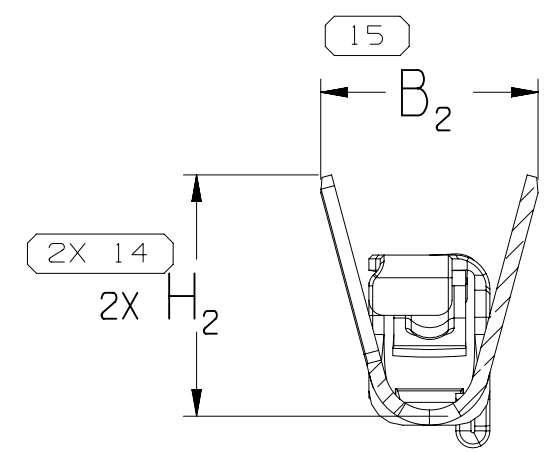
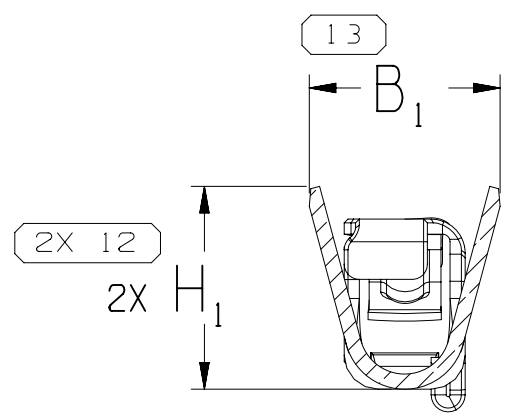
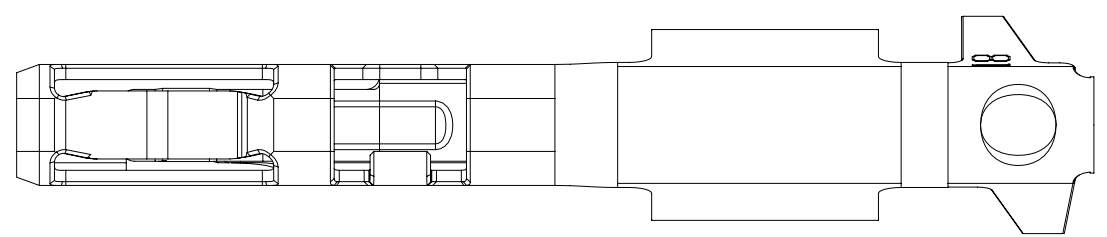
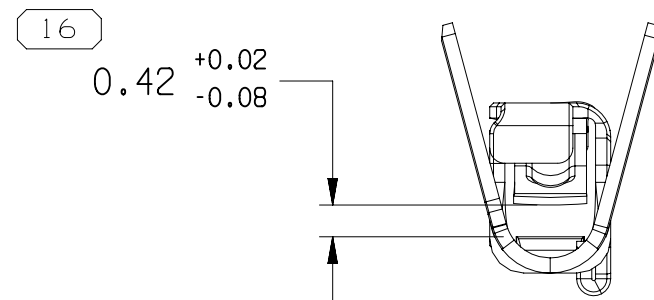
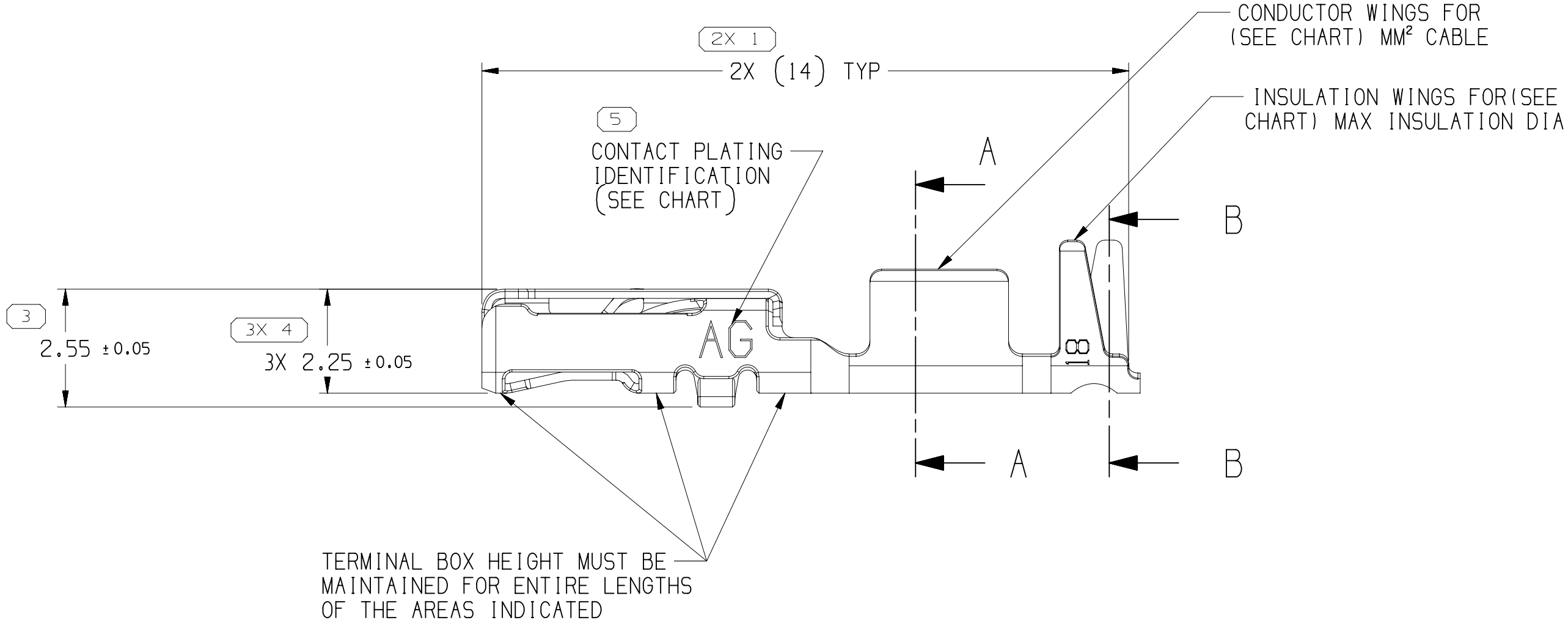
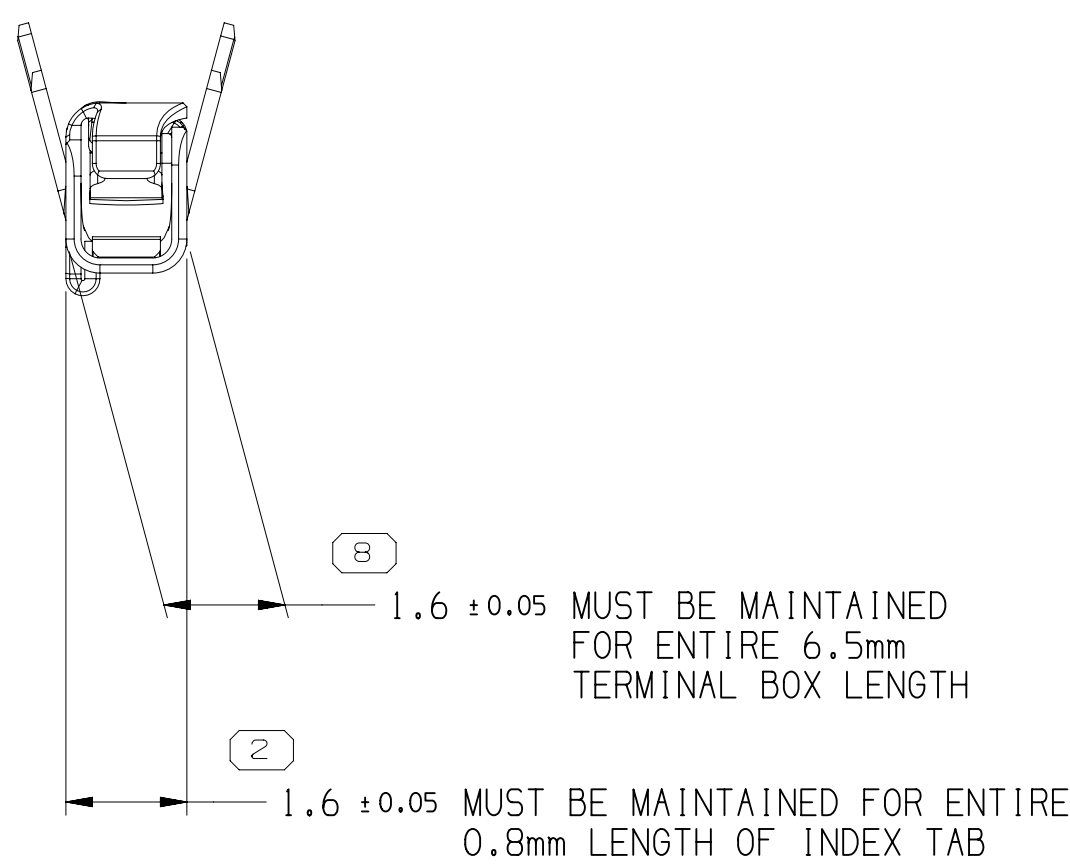
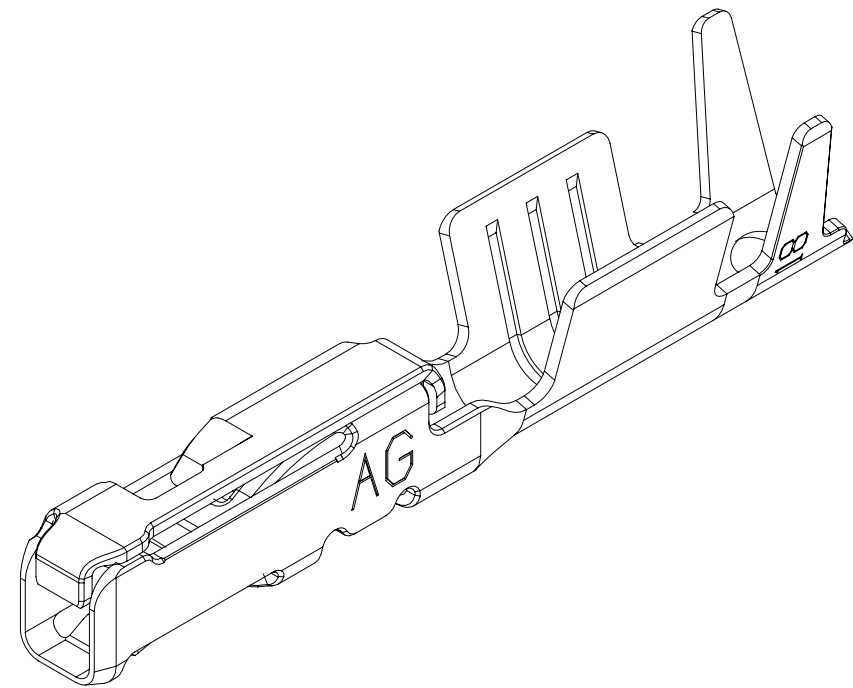

SECTION A-A

SECTION B-B

NOTES

- UNLESS OTHERWISE SPECIFIED AND/OR INDICATED:

DIMENSIONS ARE TO FACE OF VIEW SHOWN AND AUTOMATICALLY ROUNDED BY COMPUTER FOR INSPECTION (SEE MATH MODEL FOR PRECISE DIMENSIONS). FOR ALL OTHER DIMENSIONS NOT SHOWN BUT REQUIRED FOR TOOL BUILD, SEE MATH MODEL FOR PRECISE TOOL PATH DATA.

- RECOMMENDED MATING BLADE THICKNESS 0.64 ± 0.03mm
RECOMMENDED MATING BLADE WIDTH NOT TO EXCEED 1mm AND NO LESS THAN 0.6mm. SEE USCAR EWCAP-001 DRAWING (0.64 PIN) FOR OTHER MATING BLADE REQUIREMENTS.

- MAX INSULATION CRIMP WIDTH 1.77mm AND HEIGHT 2.3mm FOR CABLE SIZE UP TO 1.9mm O.D.
MAX CORE CRIMP WIDTH 1.67mm

- MAXIMUM CURRENT CAPACITY IS 7.5 AMPS WITH 0.8mm² COPPER CABLE.

- * DENOTES DIMENSIONS MADE AT CUT-OFF AND CRIMP DIE

- PARTS MEET THE PERFORMANCE REQUIREMENTS OF 6MW3191 DEC 2007 AND SAE/USCAR-2 R5 REVISION FOR THE FOLLOWING CLASSIFICATIONS:

TEMPERATURE CLASS 3 (-40° C TO +125° C)
VIBRATION CLASS 1 (ON BODY OR CHASSIS)
VIBRATION CLASS 2 (ON ENGINE) FOR SAE/USCAR-2 ONLY
SEALING CLASS 2 OR 3 (SEALED - CONNECTOR & CABLE SEAL DEPENDENT)

- DO NOT PROBE, TEST OR OTHERWISE CONTACT THE INTERIOR REGION (THE SPRING OR ANY MOVING PART) OF THIS TERMINAL. SEVERE DAMAGE CAN OCCUR, COMPROMISING THE PERFORMANCE OF THE ELECTRICAL INTERFACE.

- PLATING TYPE:

- I. REFLOW TIN 1.9-3.3 MICROMETERS THICK OVER NICKEL UNDERPLATE 0.13-0.5 MICROMETERS THICK

- II. GOLD 0.075-0.127 MICROMETERS THICK OVER PALLADIUM 0.510 - 0.635 MICROMETERS, OVER NICKEL UNDERPLATE 0.127-0.254 MICROMETERS THICK

- III. SILVER 2.0 - 3.0 MICROMETERS THICK OVER NICKEL UNDERPLATE 0.13 - 0.51 MICROMETERS THICK.

- IV. MATTE TIN 1.9-7.0 MICROMETERS THICK OVER NICKEL UNDERPLATING 0.13-0.51 MICROMETERS THICK (FOR USE WITH SELECTIVE SILVER PLATING SPECIFICATION)

- V. MATTE TIN 1.9 - 3.75 MICROMETERS THICK OVER NICKEL UNDERPLATING 0.127 - 0.254 MICROMETERS THICK (FOR USE WITH SELECTIVE GOLD PLATING SPECIFICATION)

PLATING TYPE INFORMATION SHOWN ABOVE IS REFERENCE ONLY; PLATING REQUIREMENTS ARE CONTAINED IN APPLICABLE MATERIAL SPECIFICATION

- SEE TAXI P/N 13767042 FOR SIMILAR TERMINALS WITH DIFFERENT CONNECTOR CAVITY INDEX.

PROCESS SENSITIVE DIMENSION	
DIMENSIONS ENCLOSED IN () INDICATE REFERENCE DIMENSIONS AND NO TOLERANCE LIMITS ARE ESTABLISHED	CHART D
FROM 0 TO 12	> 12
TOLERANCE UNLESS OTHERWISE SPECIFIED	± 0.1
ANGULAR TOLERANCE	± 2°

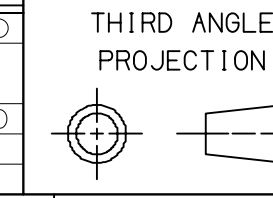

DO NOT SCALE
USE MATH DATA

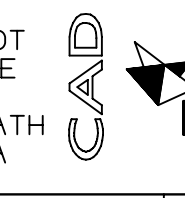

A LINE DRAWN THROUGH A PART NUMBER INDICATES THAT PHYSICAL PARTS ARE NOT AVAILABLE FOR ORDERING.	
PART NUMBERS THAT DO NOT HAVE A LINE PRESENT INDICATE THAT PHYSICAL PARTS ARE AVAILABLE FOR ORDERING.	
CONTACT APTIV SALES TO ASSURE AVAILABILITY OF PARTS.	
DWS TYPE	
PART DRAWING	
STYLE	
VOLUME (CM)	
DISTR CODE	
D	
UNLESS OTHERWISE SPECIFIED	
THIS DOCUMENT IS IN ACCORDANCE WITH ASME Y14.5M-1994 AS MODIFIED BY THE 6M GLOBAL DIMENSIONING AND TOLERANCING ADDENDUM-2003. SEPARATE PATTERNING OF FEATURES MAY BE ORDERED SEPARATELY REGARDLESS OF DATUM REFERENCES.	
ALL DIMENSIONS ARE IN MILLIMETERS	
REFERENCE	

• APTIV •	
CONNECTION SYSTEMS	
WARREN, OH	
COPYRIGHT 2012 APTIV. ALL RIGHTS RESERVED.	
THIS DRAWING IS THE PROPERTY OF APTIV AND CONTAINS APTIV CONFIDENTIAL INFORMATION. THE REPRODUCTION, DISTRIBUTION AND UTILIZATION OF THIS DOCUMENT OR ITS RELATED CAD DATA, AS WELL AS COMMUNICATION OF ANY CONTENT TO OTHERS, WITHOUT EXPRESS AUTHORIZATION, IS PROHIBITED.	
DR	DATE
APVD1: MIGUEL DE LEON	19JA12
APVD2: MIGUEL DE LEON	19JA12
APVD3: ROBERT B. SNADER	19JA12
APVD4	
APVDS	
SUBSTANCES OF CONCERN AND RECYCLED CONTENT PER APTIV 10949001	
MATERIAL: SEC CHART	
DRAWING NUMBER	
TAXI TERM F OCS 0.64 IDR	
DRAWING NUMBER	
13919105	
SIZE	SCALE
A0	10:1
FRAME NO	1 OF 1
SHEET NO	2 OF 2
STG	REV
1	15

13919112	03	AB	COPPER ALLOY	III	IV	SILVER	AG	18	0.75 ± 0.8	1.7 ± 1.9	2.52	2.88	2.68	3.31
13919113	03	AB	COPPER ALLOY	III	IV	SILVER	AG	21	0.35 ± 0.5	1.2 ± 1.83	2.04	2.8	2.06	3.17
13919114	03	AB	COPPER ALLOY	III	IV	SILVER	AG	25	0.13 ± 0.22	0.81 ± 1.2	1.54	1.74	1.56	1.77
PART NUMBER	REV	N/P	MATERIAL DESCRIPTION	CONTACT AREA PLATING TYPE (SEE NOTE 8)	CRIMP AREA PLATING TYPE (SEE NOTE 8)	CONTACT PLATING	CONTACT PLATING I.D.	ID	CABLE SIZE (mm ²)	CABLE DIAMETER	B ₁ ± 0.15	B ₂ ± 0.25	(H ₁)	(H ₂)

Mouser Electronics

Authorized Distributor

Click to View Pricing, Inventory, Delivery & Lifecycle Information:

[Aptiv:](#)
[13919113](#)