

MISSING SYMBOLS		DWG STATUS				ZONE		REVISION HISTORY		AUTH	DR	APV	APV2
17		DATE	STG	REV	N/F	CHG							
		19JAI2	R	01	-	-		13919112 - WAS PE201748 AND RELEASED 13919113 - WAS PE201747 AND RELEASED 13919114 - WAS PE201749 AND RELEASED		416783	MAL	MAI	RBS
		02MY12	R	02	-	-		ALL PARTS - UPDATED PERFORMANCE REQUIREMENTS NOTE		417979	JEG	JEG	RBS
		04JN12	R	03	-	-		ALL PARTS - CONTACT AREA PLATING TYPE COLUMN WAS "11" ON TAXI CHART		418431	JAR	JAR	RBS
		07FE13	R	04	-	-		ALL PARTS - ADDED PLATING NOTE IV AND CRIMP AREA COLUMN IV WAS 1		421380	CGD	JW	RBS
		11MR13	R	05	-	-		ALL PARTS - UPDATED PLATING TYPE NOTE		421590	CBG	CBG	RBS
		29JUL14	R	06	-	-		ALL PARTS - 3X 2.25 ± 0.05 WAS 2.25 ± 0.05, ADDED LABEL ON DIM #4, MAX INSULATION CRIMP NOTE, REVISED NOTES*, NUMBERING, PLATING TYPE & PERFORMANCE REQUIREMENT RATINGS NOTES AND UPDATED CRIMP AREA COLUMN CHART		426685	APB	APB	RBS
		27AUI14	R	07	-	-		ALL PARTS - UPDATED PDM ATTRIBUTES		427393	APB	APB	RBS
		21OC14	R	08	-	-		ALL PARTS - UPDATED PART AVAILABILITY, REMOVED DIM #17 AND REVISED MAT'L DESCRIPTION COLUMN CHART		427975	APB	APB	RBS
		23FE15	R	09	-	-		13919113 - 13919114 - REVISED CABLE DIAMETER COLUMN CHART		428888	APB	APB	RBS
		16JUL15	R	10	-	-		13919112 - CABLE SIZE WAS 0.8		430190	APB	APB	RDL
		02JUL15	R	11	-	-		REVISED TERMINAL LEAD-IN FOR ALL PARTS		430058	JHG	JHG	RBS
		14JUL15	R	12	-	-		ALL PARTS - UPDATED PART AVAILABILITY		431036	APB	APB	RBS
		05DE18	R	13	-	-		ALL PARTS; REVISED MATERIAL SPEC; REV LEVELS ADV TO 03		441787	CM	CM	RS
		11DE18	R	14	-	-		TO MATCH QD - CORRECTED TOLERANCE FOR "B2" TO MATCH QD 1±0.25 WAS ±0.31		441895	JGO	JAA	ASH
		05AP19	R	N/F	-	-		ALL PARTS - DIM #10 WAS 0 ± .2" AND ADDED GO&T PROFILE OF LINE CONTROL FRAME & DATUM <u>A</u> OVERALL INFO		441273	DAY	JAA	RBS

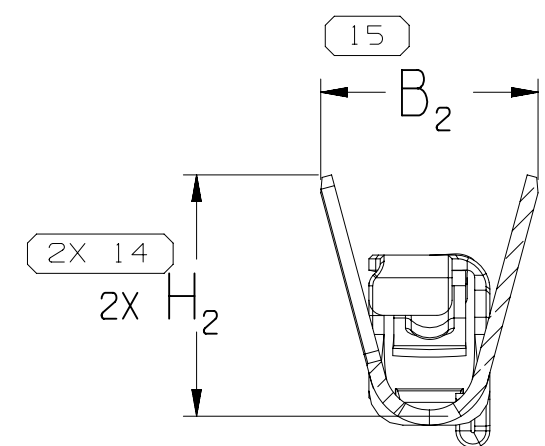

SECTION B-B

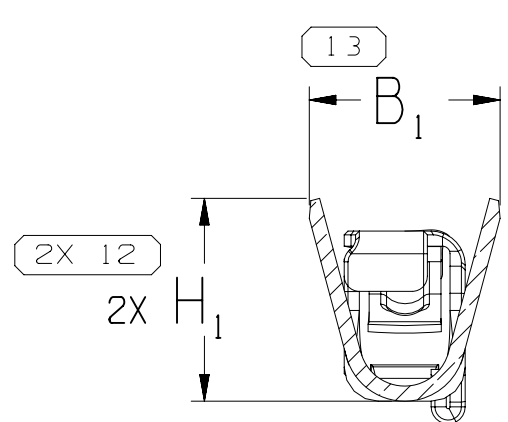
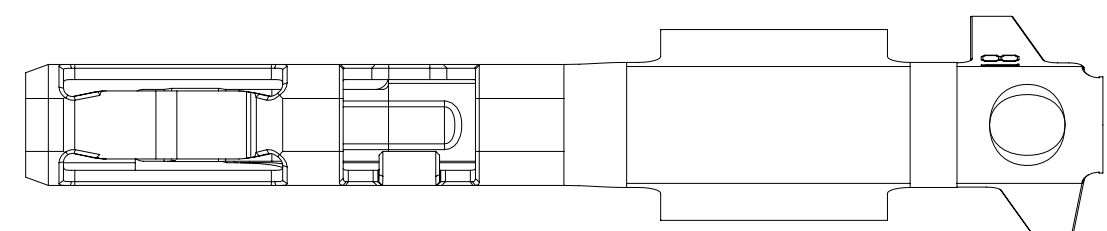
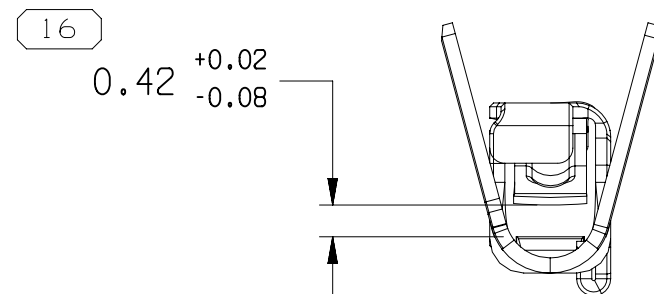
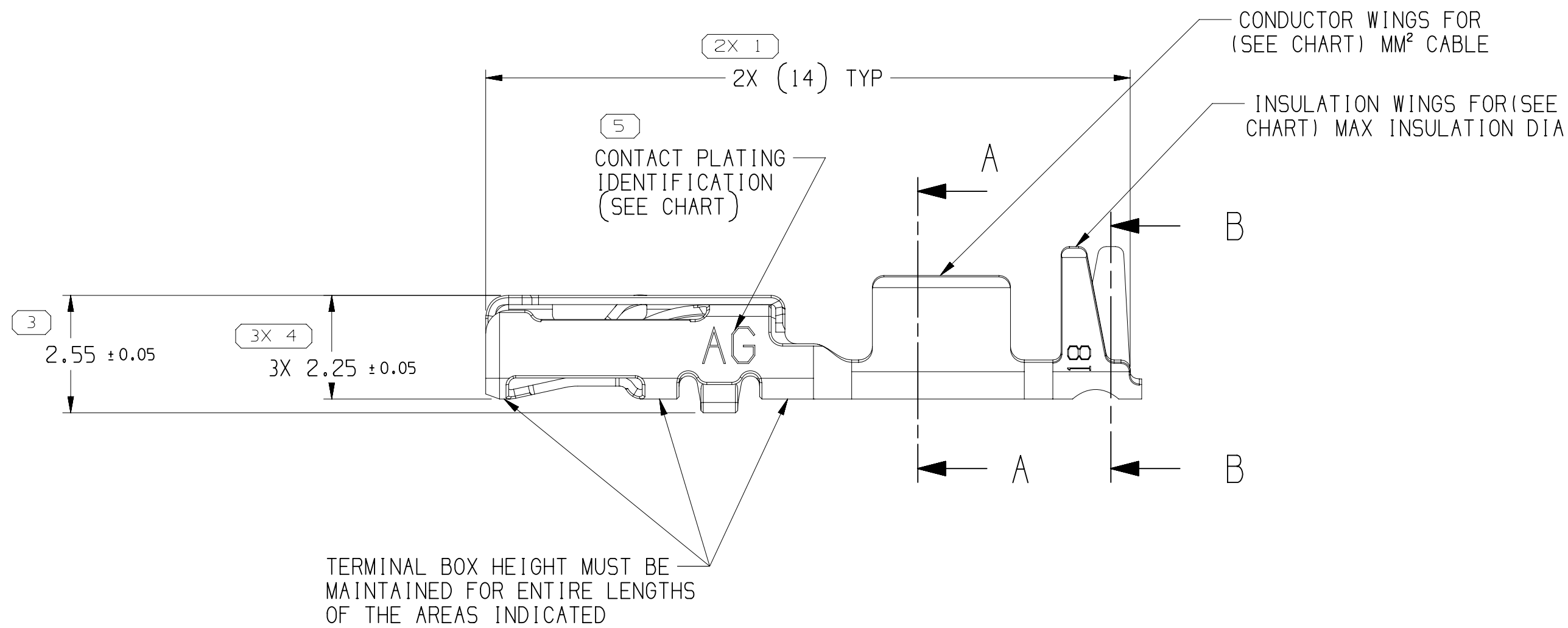
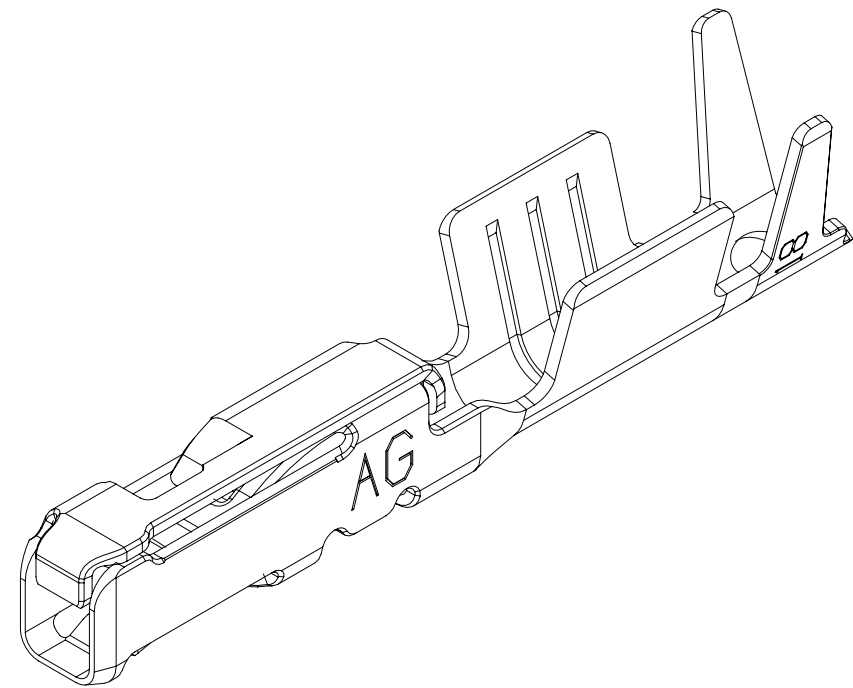
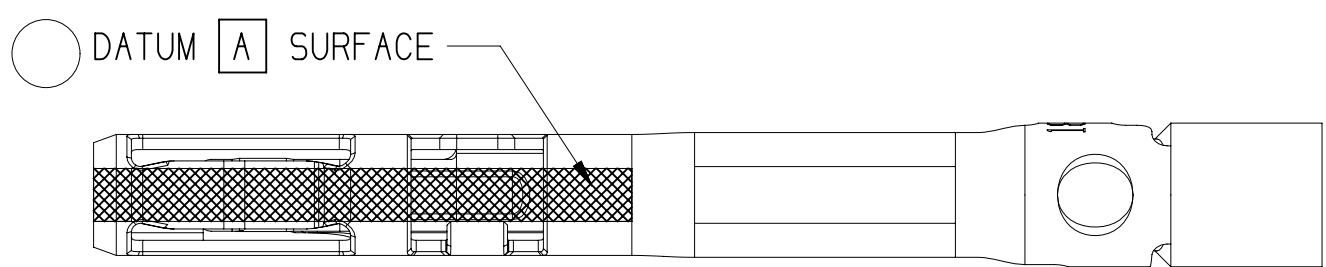
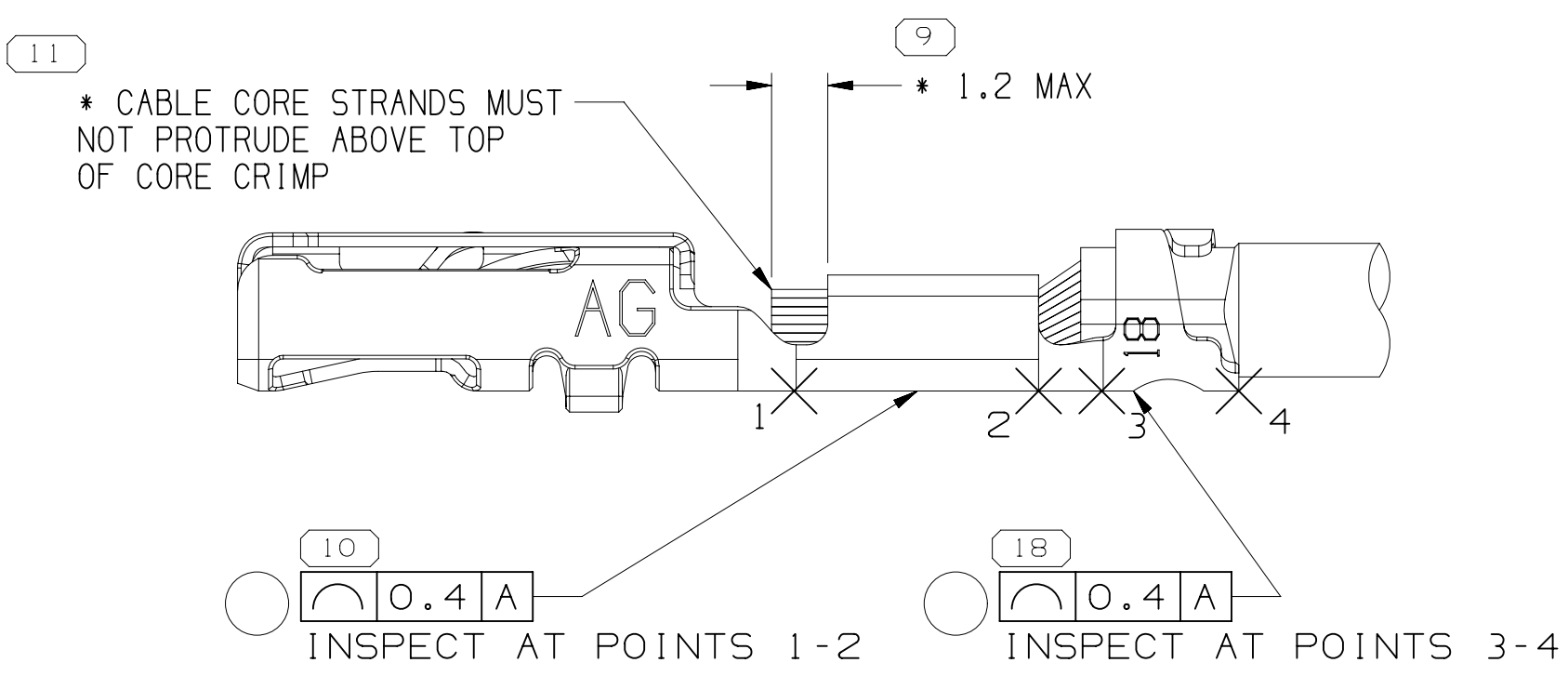
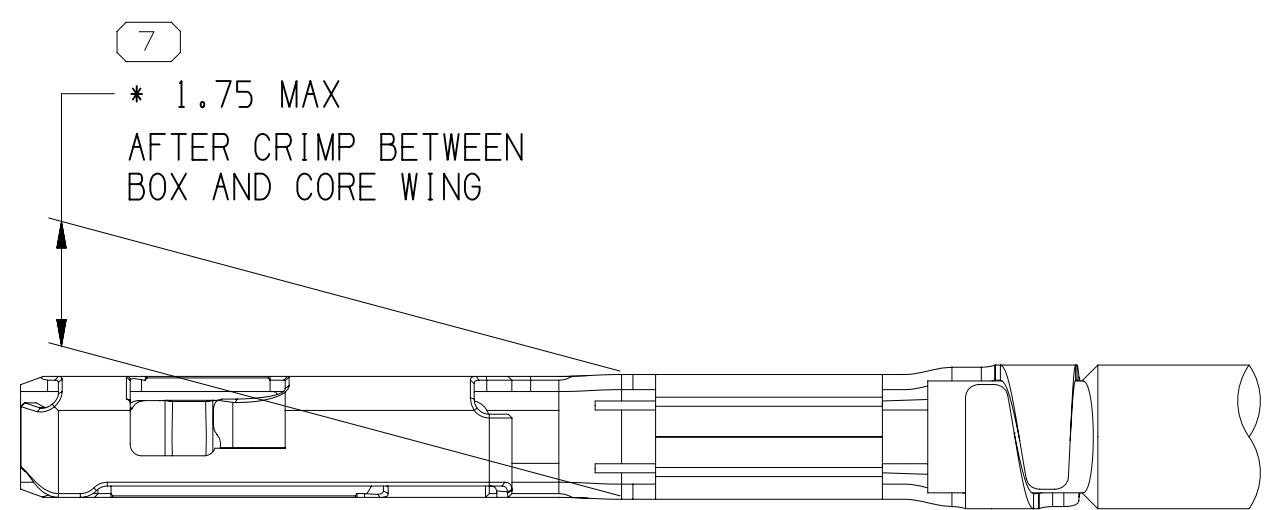

## TERMINAL, CABLE CRIMP ALIGNMENT & POSITION

13919112	03	AB	COPPER ALLOY	III	IV	SILVER	AG	18	0.75 - 0.8	1.7 - 1.9	2.52	2.88	2.68	3.31
13919113	03	AB	COPPER ALLOY	III	IV	SILVER	AG	21	0.35 - 0.5	1.2 - 1.83	2.04	2.8	2.06	3.17
13919114	03	AB	COPPER ALLOY	III	IV	SILVER	AG	25	0.13 - 0.22	0.81 - 1.2	1.54	1.74	1.56	1.77
PART NUMBER	REV	N/P	MATERIAL DESCRIPTION	CONTACT AREA PLATING TYPE (SEE NOTE B)	CRIMP AREA PLATING TYPE (SEE NOTE B)	CONTACT PLATING	CONTACT PLATING I.D.	ID	CABLE SIZE (mm <sup>2</sup> )	CABLE DIAMETER	B <sub>1</sub> ±0.15	B <sub>2</sub> ±0.25	(H <sub>1</sub> )	(H <sub>2</sub> )

- NOTES
1. UNLESS OTHERWISE SPECIFIED AND/OR INDICATED:  
DIMENSIONS ARE TO FACE OF VIEW SHOWN AND AUTOMATICALLY ROUNDED BY COMPUTER FOR INSPECTION (SEE MATH MODEL FOR PRECISE DIMENSIONS). FOR ALL OTHER DIMENSIONS NOT SHOWN BUT REQUIRED FOR TOOL BUILD, SEE MATH MODEL FOR PRECISE TOOL PATH DATA.
  2. RECOMMENDED MATING BLADE THICKNESS 0.64±0.03mm  
RECOMMENDED MATING BLADE WIDTH NOT TO EXCEED 1mm AND NO LESS THAN 0.6mm. SEE USCAR ENCAP-001 DRAWING (0.64 PIN) FOR OTHER MATING BLADE REQUIREMENTS.
  3. MAX INSULATION CRIMP WIDTH 1.77mm AND HEIGHT 2.3mm FOR CABLE SIZE UP TO 1.9mm O.D.  
MAX CORE CRIMP WIDTH 1.67mm
  4. MAXIMUM CURRENT CAPACITY IS 7.5 AMPS WITH 0.8mm<sup>2</sup> COPPER CABLE.
  5. \* DENOTES MEASUREMENTS MADE AT CUT-OFF AND CRIMP DIE
  6. PARTS MEET THE PERFORMANCE REQUIREMENTS OF GWM3191 DEC 2007 AND SAE/USCAR-2 RS REVISION FOR THE FOLLOWING CLASSIFICATIONS:  
TEMPERATURE CLASS 3 (-40° C TO +125° C)  
VIBRATION CLASS 1 (ON BODY OR MOUNTS)  
VIBRATION CLASS 2 (ON ENGINE) FOR SAE/USCAR-2 ONLY  
SEALING CLASS 2 OR 3 (SEALED - CONNECTOR & CABLE SEAL DEPENDENT)
  7. DO NOT PROBE, TEST OR OTHERWISE CONTACT THE INTERIOR REGION (THE SPRING OR ARM MOVING PART) OF THIS TERMINAL. SEVERE DAMAGE CAN OCCUR, COMPROMISING THE PERFORMANCE OF THE ELECTRICAL INTERFACE.
  8. PLATING TYPE:
    - I. REFLOW TIN 1.9-3.3 MICROMETERS THICK OVER NICKEL UNDERPLATE 0.13-0.5 MICROMETERS THICK
    - II. GOLD 0.075-0.127 MICROMETERS THICK OVER PALLADIUM 0.510 - 0.635 MICROMETERS, OVER NICKEL UNDERPLATE 0.127-0.254 MICROMETERS THICK
    - III. SILVER 2.0 - 3.0 MICROMETERS THICK OVER NICKEL UNDERPLATE 0.13 - 0.51 MICROMETERS THICK.
    - IV. MATTE TIN 1.9-7.0 MICROMETERS THICK OVER NICKEL UNDERPLATING 0.13-0.51 MICROMETERS THICK (FOR USE WITH SELECTIVE SILVER PLATING SPECIFICATION)
    - V. MATTE TIN 1.9 - 3.75 MICROMETERS THICK OVER NICKEL UNDERPLATING 0.127 - 0.254 MICROMETERS THICK (FOR USE WITH SELECTIVE GOLD PLATING SPECIFICATION)
- PLATING TYPE INFORMATION SHOWN ABOVE IS REFERENCE ONLY;  
PLATING REQUIREMENTS ARE CONTAINED IN APPLICABLE MATERIAL SPECIFICATION
9. SEE TAXI P/N 13767042 FOR SIMILAR TERMINALS WITH DIFFERENT CONNECTOR CAVITY INDEX.

8		PROCESS SENSITIVE DIMENSION	
DIMENSIONS ENCLOSED IN { } INDICATE REFERENCE DIMENSIONS AND NO TOLERANCE LIMITS ARE ESTABLISHED			
DIMENSIONAL RANGE (MM)		CHART	D
FROM 0			
TO 12		>12	
TOLERANCE UNLESS OTHERWISE SPECIFIED			
+0.1		+0.2	
ANGULAR TOLERANCE		±2°	

INDICATES A LINE DRAWING THROUGH A PART NUMBER.  
INDICATES THAT PHYSICAL PARTS ARE NOT AVAILABLE  
FOR ORDERING.

PART NUMBERS THAT DO NOT HAVE A LINE PRESENT INDICATE  
THAT PHYSICAL PARTS ARE AVAILABLE FOR ORDERING.

CONTACT APPLICS SALES TO ASSURE AVAILABILITY OF PARTS.

ONE TYPE

**PART DRAWING**

STYLE

VOLUME (CM <sup>3</sup> )	DISTR CODE
	D

UNLESS OTHERWISE SPECIFIED

THIS DOCUMENT IS IN ACCORDANCE WITH ASME Y14.5M-1994  
AS AMENDED BY THE 3D GLOBAL DIMENSIONING AND  
TOLERANCING ADDENDUM 2001. SEPARATE PATTERNING OF  
FEATURES MAY BE OGAED SEPARATELY REGARDLESS OF DATUM  
REFERENCES.

ALL DIMENSIONS ARE IN MILLIMETERS

REFERENCE

<h1 style="margin: 0;">• A P T I V •</h1> <p style="margin: 0;">CONNECTION SYSTEMS</p> <p style="margin: 0;">WARREN, OH</p> <p style="margin: 0;">COPYRIGHT 2012 APTIV. ALL RIGHTS RESERVED.</p> <p style="margin: 0;">THIS DRAWING IS THE PROPERTY OF APTIV AND CONTAINS APTIV CONFIDENTIAL INFORMATION. THE REPRODUCTION, DISTRIBUTION AND UTILIZATION OF THIS DOCUMENT OR ITS RELATED CAD DATA, AS WELL AS COMMUNICATION OF ANY CONTENT TO OTHERS, WITHOUT EXPRESS AUTHORIZATION, IS PROHIBITED.</p>					
DR				DATE	
APVD1 <b>MIGUEL DE LEON</b>				19JA12	
APVD2 <b>MIGUEL DE LEON</b>				19JA12	
APVD3 <b>ROBERT B. SNADER</b>				19JA12	
APVD4					
APVD5					
SUBSTANCES OF CONCERN AND RECYCLED CONTENT PER APTIV 10949001					
MATERIAL SEE CHART					
DRAWING NAME  <div style="text-align: center; font-size: 2em; font-weight: bold;">TAXI TERM F OCS 0.64 IDR</div>					
DRAWING NUMBER  <div style="text-align: center; font-size: 4em; font-weight: bold;">13919105</div>					
SIZE	SCALE	FRAME-NO	SHEET NO	SIO	REV/ N/P
A1/2	10:1	1 OF 1	2 OF 2	R	15

# Mouser Electronics

Authorized Distributor

Click to View Pricing, Inventory, Delivery & Lifecycle Information:

[Aptiv:](#)

[13919114](#)