

APN: 35340219

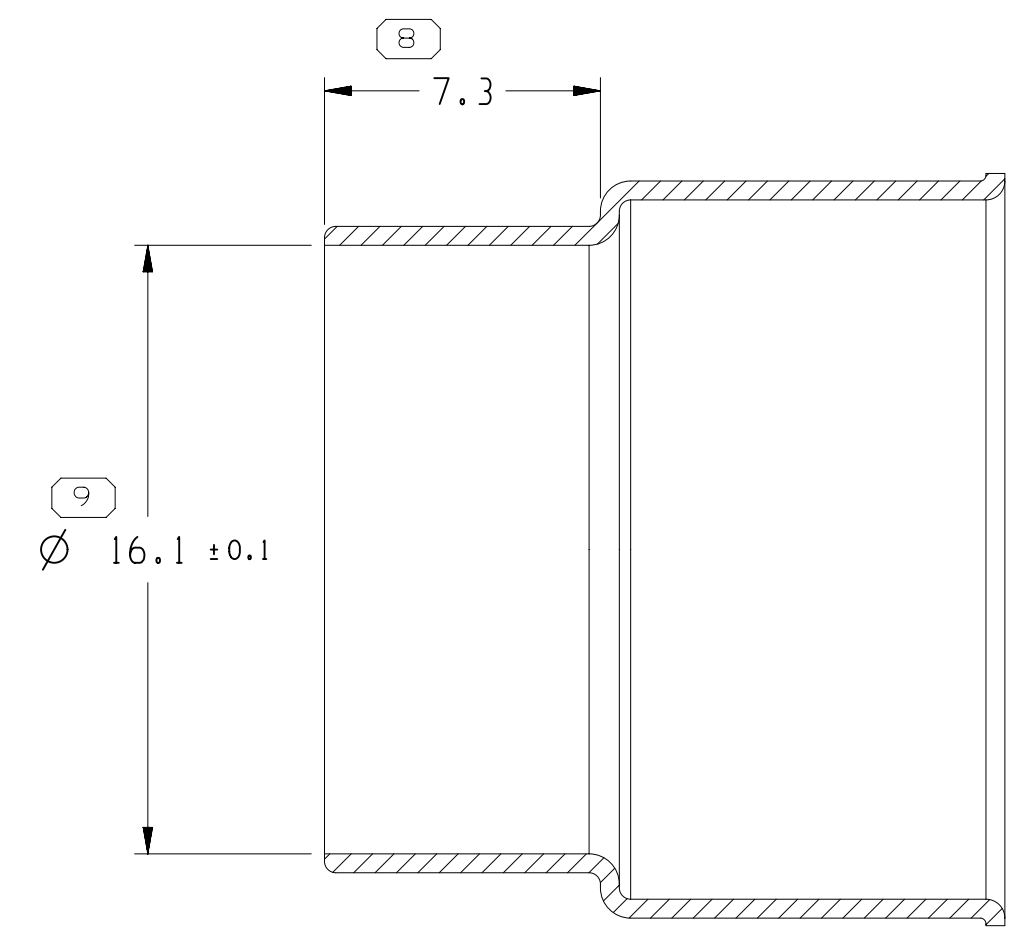

SECTION C-C

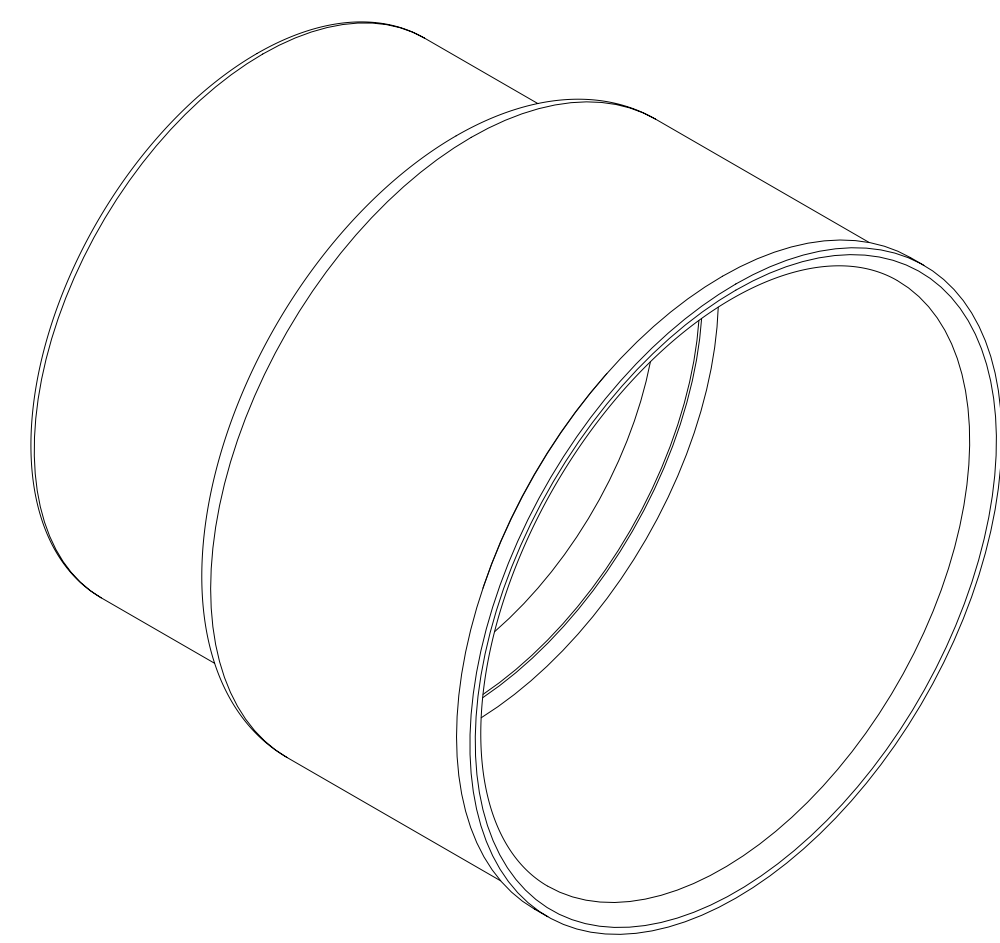
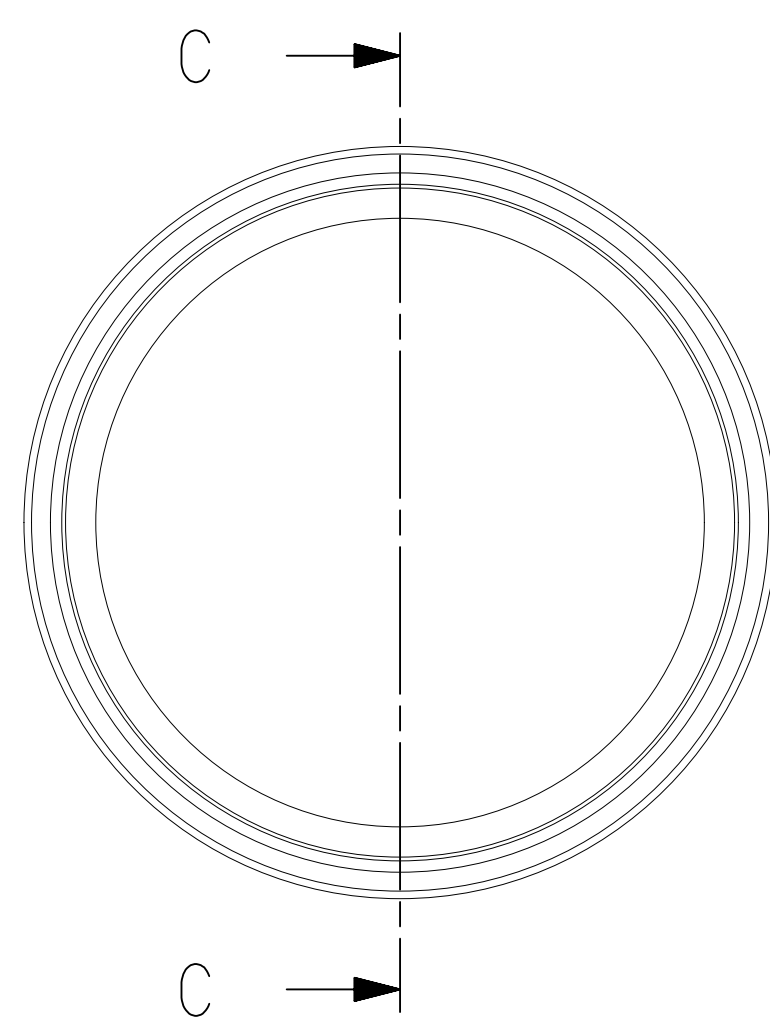

APN: 35434228

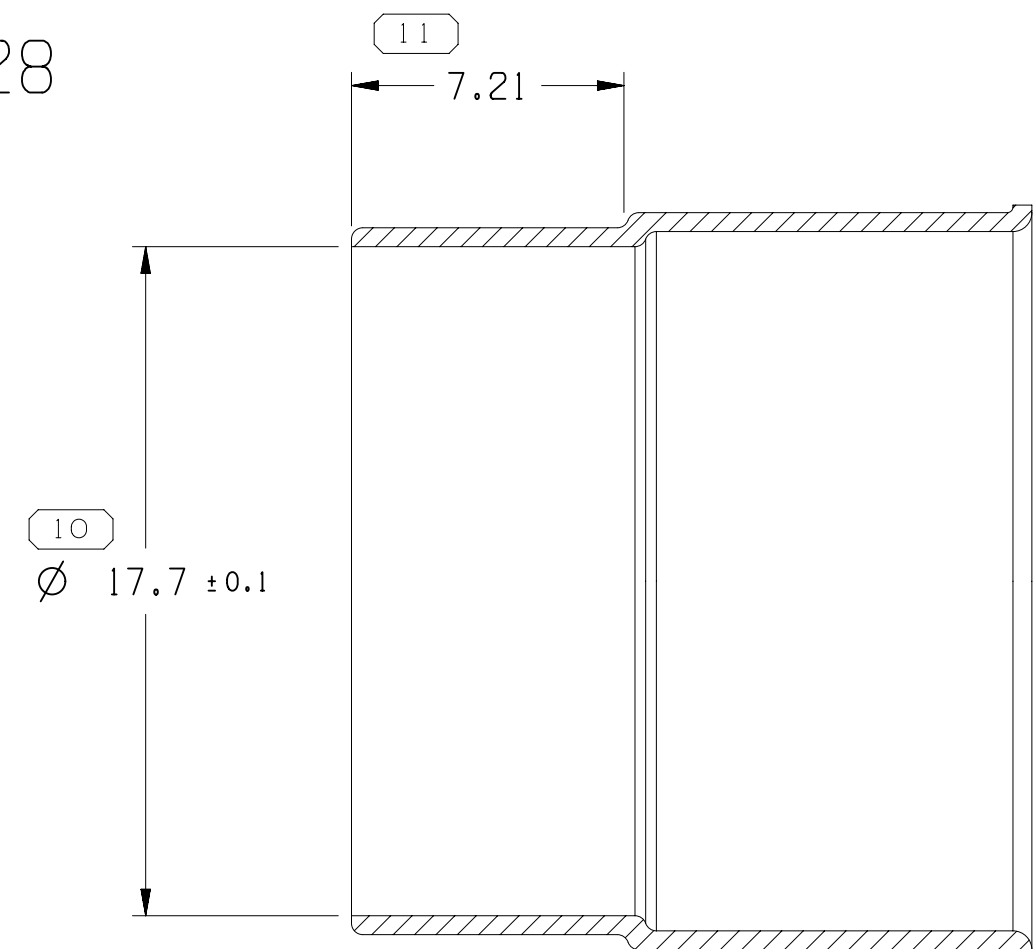

SECTION D-D

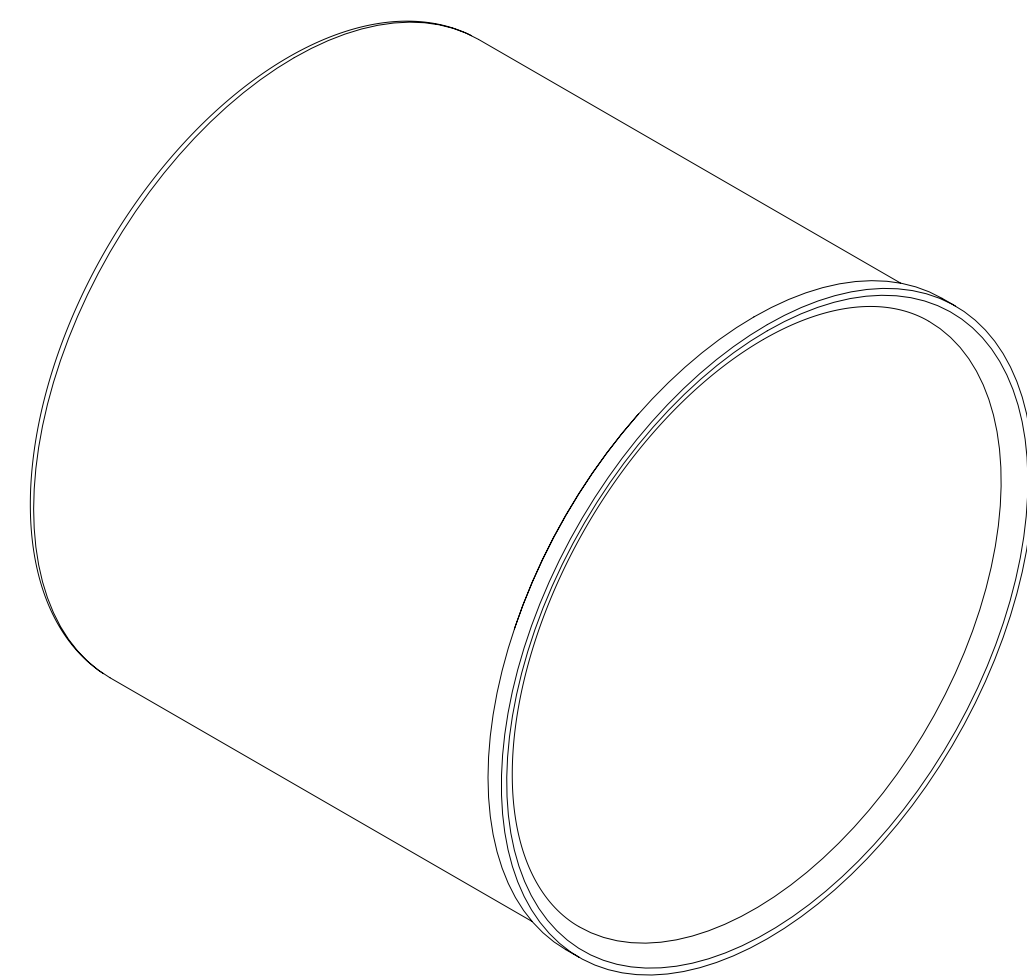
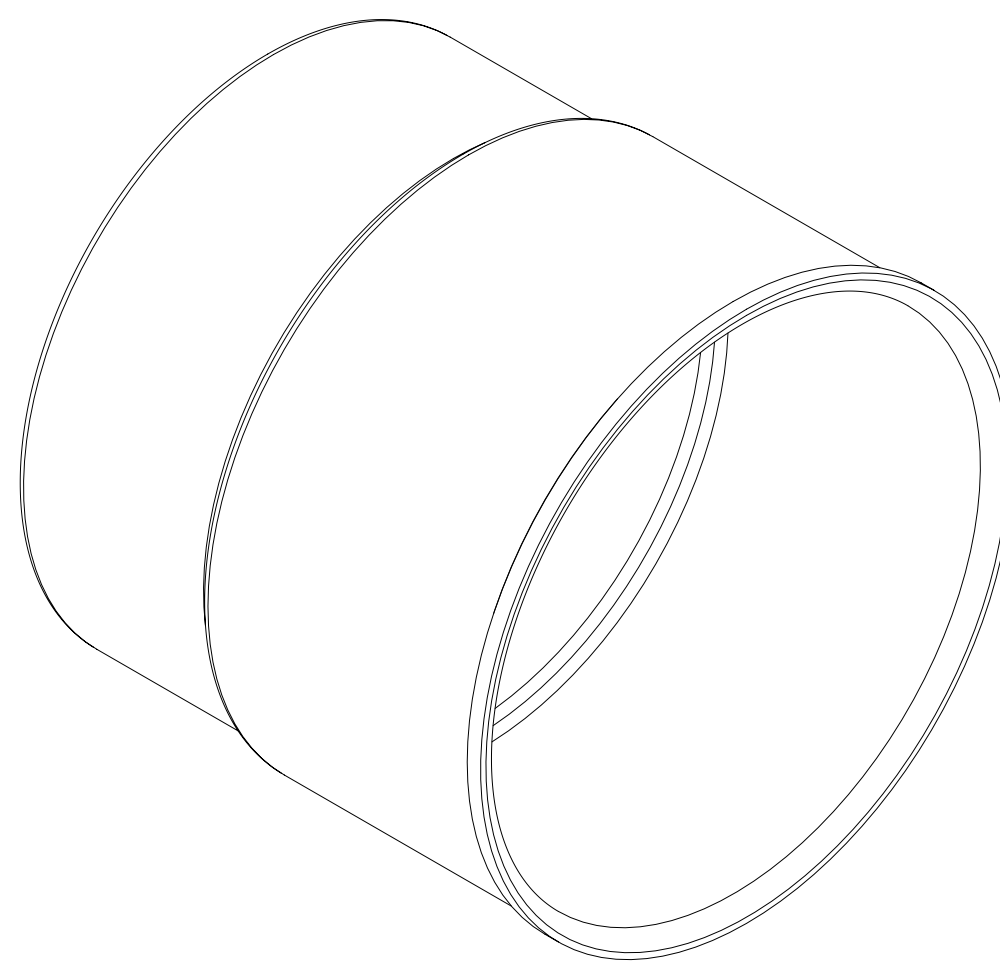
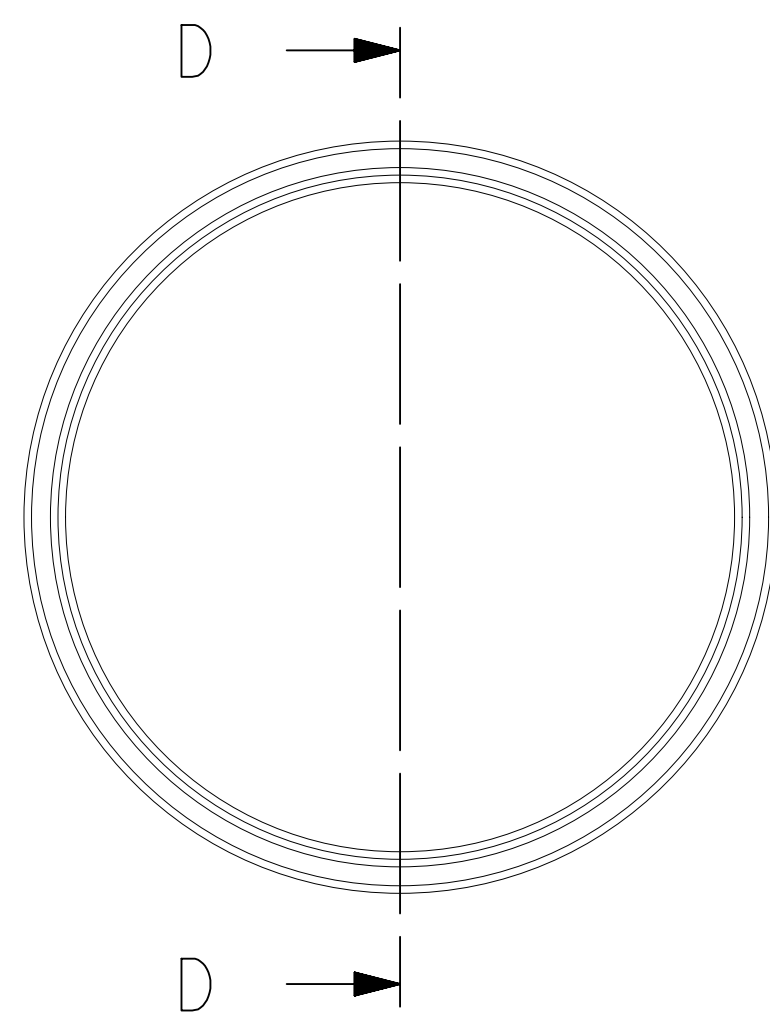

APN: 35197311  
SHOWN

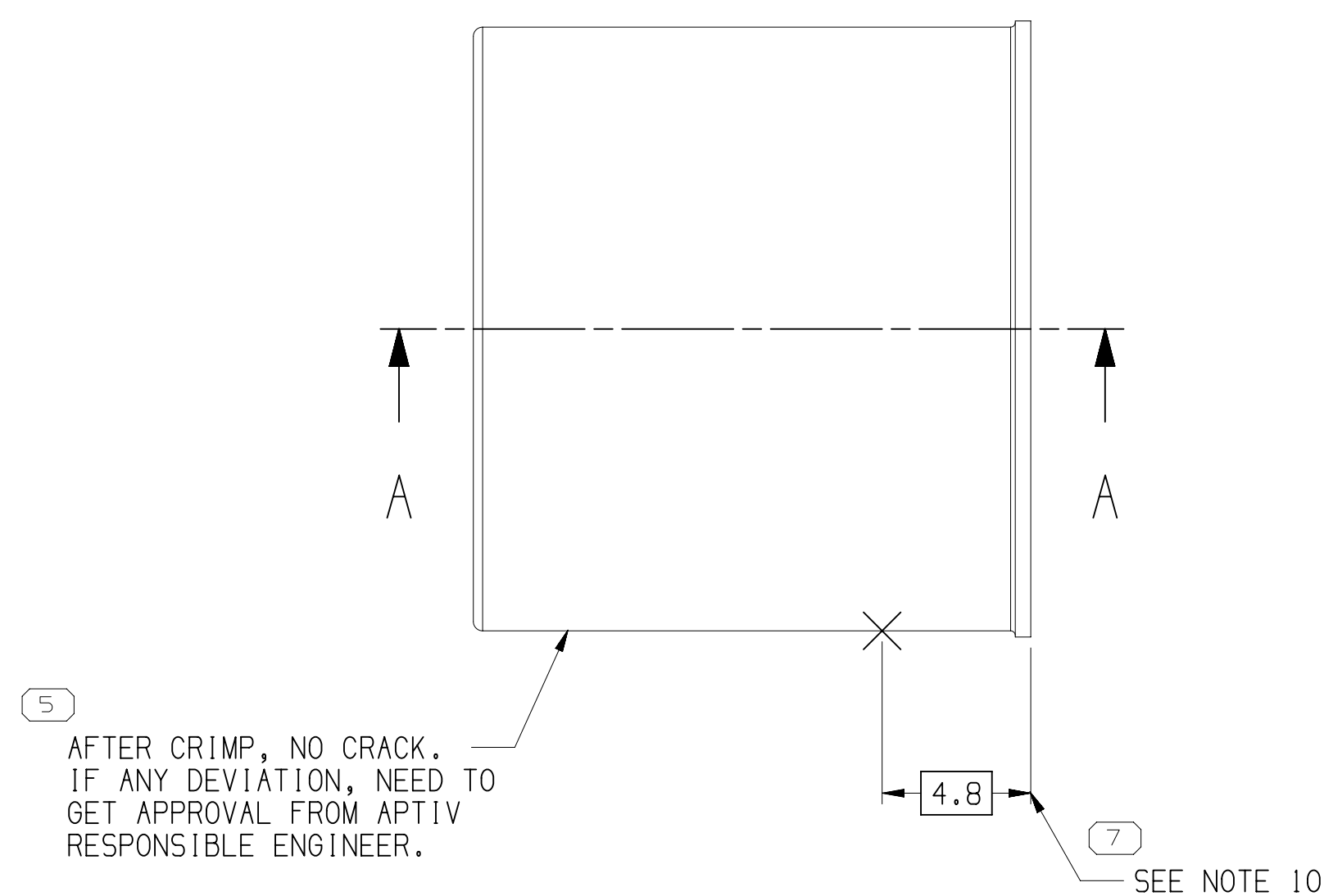

AFTER CRIMP, NO CRACK.  
IF ANY DEVIATION, NEED TO  
GET APPROVAL FROM APTIV  
RESPONSIBLE ENGINEER.

SEE NOTE 10

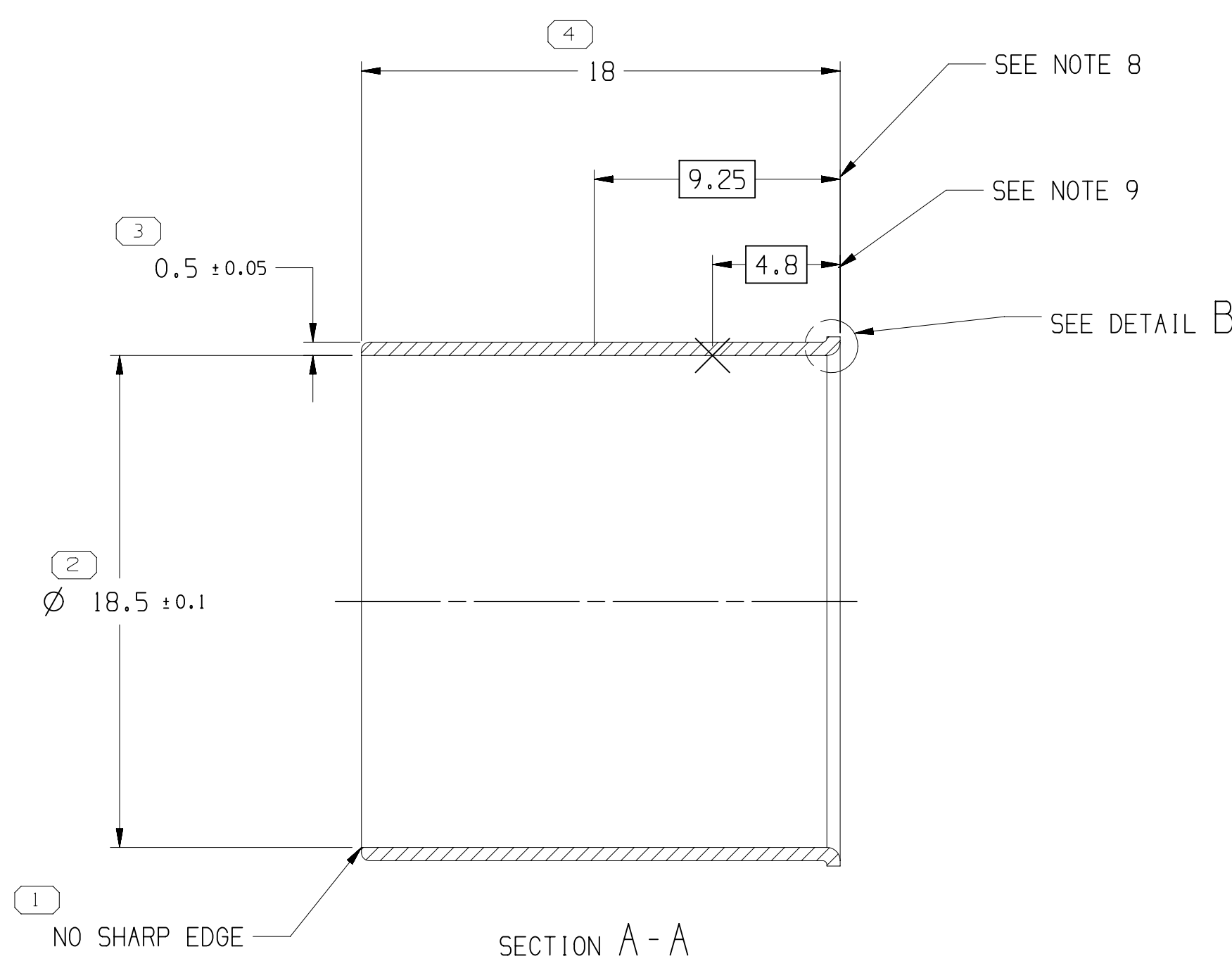

NO SHARP EDGE

SECTION A-A

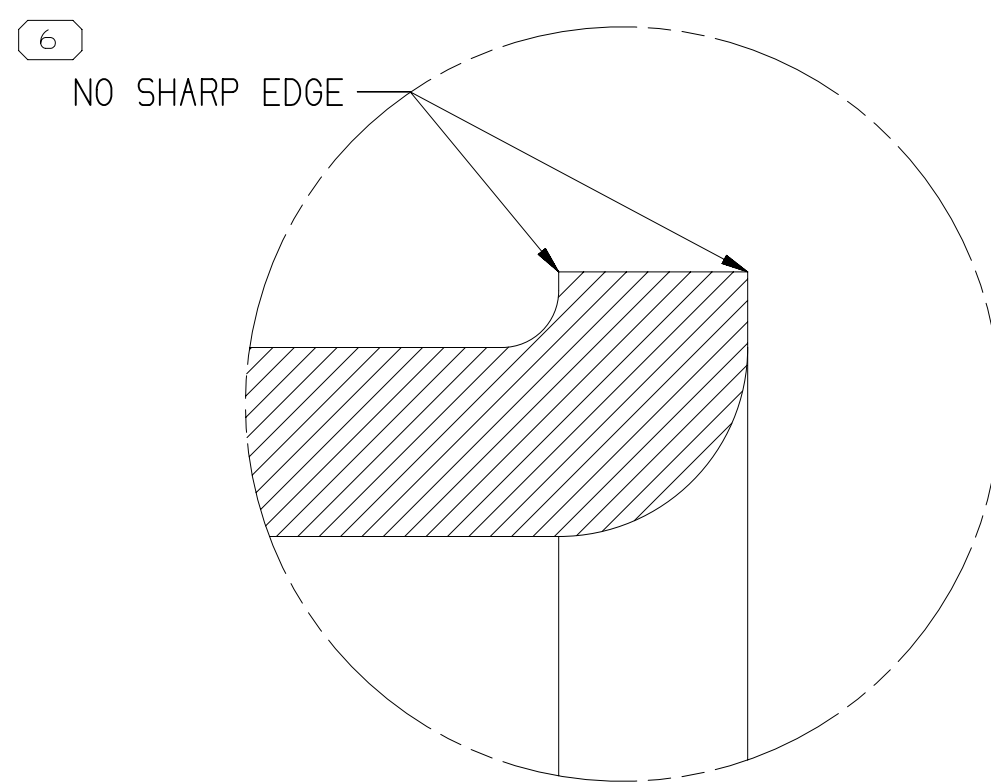

NO SHARP EDGE

DETAIL B  
SCALE 50:1

#### NOTES

- UNLESS OTHERWISE SPECIFIED AND/OR INDICATED:  
DIMENSIONS ARE TO FACE OF VIEW SHOWN AND  
AUTOMATICALLY ROUNDED BY COMPUTER FOR INSPECTION  
(SEE MATH MODEL FOR PRECISE DIMENSIONS). FOR ALL  
OTHER DIMENSIONS NOT SHOWN BUT REQUIRED FOR TOOL  
BUILD, SEE MATH MODEL FOR PRECISE TOOL PATH DATA.
- PARTS SHOWN ON THIS DAWNING USED IN LAYOUTS SHOWN ON  
TAXI 35219981.
- OUTSIDE PLATING: NI, 1.5-4 MICROMETER PER ASTM B689, TYPE I,  
CLASS X.
- PART HAS TO BE DELIVERED DEGREASED.
- PARTS ARE TO BE PACKAGED IN SEALED PLASTIC BAGS.
- PARTS MUST BE FREE OF CRACKS.
- ONLY RECOMMENDED CABLE ACC. TO TABLE.  
ALL OTHER CABLE SUPPLIERS / CABLE SIZES MUST BE VALIDATED.
- PLATING THICKNESS OF INSIDE SURFACE:  
PLATE: THICKNESS OF NICKEL SULFAMATE SHALL BE  
0.3μm - 3μm PER ASTM B-689, TYPE I, CLASS X.
- INSIDE MEASUREMENT POINT FOR PLATING THICKNESS  
FIRST INTERNAL RELEASE.  
BY MEANS OF CONTROL GRID TO FIX THE MEASUREMENT  
RATIO INSIDE TO OUTSIDE MEASUREMENT.  
OUTSIDE MEASUREMENT POINT FOR PLATING THICKNESS  
DURING PRODUCTION.
- OUTSIDE MEASUREMENT POINTS FOR PLATING THICKNESS  
DURING PRODUCTION.

2		PROCESS SENSITIVE DIMENSION	
DIMENSIONS ENCLOSED IN ( ) INDICATE REFERENCE DIMENSIONING AND NO TOLERANCE LIMITS ARE ESTABLISHED		CHART D	
FROM	TO	0	> 12
TOLERANCE UNLESS OTHERWISE SPECIFIED		±0.1	±0.2
ANGULAR TOLERANCE		±2°	

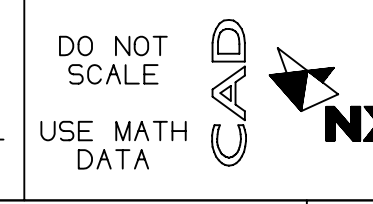
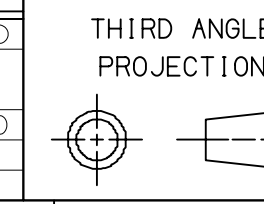

PART DRAWING	
STYLE	DATE
VOLUME (CM)	DISTR CODE
SEE CHART	D
UNLESS OTHERWISE SPECIFIED	
THIS DOCUMENT IS IN ACCORDANCE WITH ASME Y14.5M-1994 AS MODIFIED BY THE 2003 GLOBAL DIMENSIONING AND TOLERANCING ADDENDUM (2003). SEPARATE PATTERNING OF FEATURES MAY BE ISSUED SEPARATELY REGARDLESS OF DATUM REFERENCES.	
ALL DIMENSIONS ARE IN MILLIMETERS	
REFERENCE	

APTIV	
CONNECTION SYSTEMS	
Anling, China	
COPYRIGHT 2019 APTIV, ALL RIGHTS RESERVED.	
THIS DRAWING IS THE PROPERTY OF APTIV AND CONTAINS APTIV CONFIDENTIAL INFORMATION. THE REPRODUCTION, DISTRIBUTION AND UTILIZATION OF THIS DOCUMENT OR ITS RELATED CAD MATH DATA, AS WELL AS COMMUNICATION OF ANY CONTENT TO OTHERS, WITHOUT EXPRESS AUTHORIZATION, IS PROHIBITED.	
DR	DATE
APVD1: LINK GAO	20SE19
APVD2: WENZHEN MA	20SE19
APVD3: TIMON YU	20SE19
APVD4	
APVDS	
SUBSTANCES OF CONCERN AND RECYCLED CONTENT PER APTIV 10949001	
MATERIAL: SEC CHART	
DRAWING NAME: TAXI ASM TERM FERRULE UNKN	
DRAWING NUMBER: 35197334	
SIZE: A0	SCALE: 5:1
FRAME NO: 1	SHEET NO: 1 OF 1
STG: R	REV: 01
W/P: AB	

PART NO	REV	DESCRIPTION	MATERIAL	VOLUME (CM³)	CABLE SPEC	CABLE OD (MM)
35434228	01	SHIELDING OUTER FERRULE FOR 70 MM² CABLE	COPPER ALLOY	0.541	M6488	17.4 ± 0.8
35340219	01	SHIELDING OUTER FERRULE FOR 50 MM² CABLE	COPPER ALLOY	0.537	M6371	15.8 ± 0.6
35197311	01	SHIELDING OUTER FERRULE FOR 70 MM² CABLE	COPPER ALLOY	0.539	M6371	18.2 ± 0.8

# Mouser Electronics

Authorized Distributor

Click to View Pricing, Inventory, Delivery & Lifecycle Information:

[Aptiv:](#)  
[35434228](#)