

MISSING SYMBOLS		DWG STATUS					ZONE	REVISION HISTORY	AUTH	DR	APV	APVC
		DATE	STG	REV	N/P	CHK						
17												
19JAI2	R	01	-	-			13919112 - WAS PE201747 AND RELEASED 13919113 - WAS PE201748 AND RELEASED 13919114 - WAS PE201749 AND RELEASED	416783	MAL	MAI	RBS	
02MY12	R	02	-	-			ALL PARTS - UPDATED PERFORMANCE REQUIREMENTS NOTE	417979	JEG	JEG	RBS	
04JUN12	R	03	-	-			ALL PARTS - CONTACT AREA PLATING TYPE COLUMN WAS "I1" ON TAXI CHART	418431	JAR	JAR	RBS	
07FE13	R	04	-	-			ALL PARTS - ADDED PLATING NOTE IV AND CRIMP AREA COLUMN IV WAS I	421380	CGD	JW	RBS	
11MR13	R	05	-	-			ALL PARTS - UPDATED PLATING TYPE NOTE	421590	CBG	CBG	RBS	
29JUL14	R	06	-	-			ALL PARTS - 3X 2.25 ± 0.05 WAS 2.25 ± 0.05, ADDED LABEL ON DIM #4, MAX INSULATION CRIMP NOTE, REVISED NOTES' NUMBERING, PLATING TYPE & PERFORMANCE REQUIREMENT RATINGS NOTES AND UPDATED CRIMP AREA COLUMN CHART	426685	APB	APB	RBS	
27AUI4	R	07	-	-			ALL PARTS - UPDATED PDM ATTRIBUTES	427393	APB	APB	RBS	
21OC14	R	08	-	-			ALL PARTS - UPDATED PART AVAILABILITY, REMOVED DIM #17 AND REVISED MAT'L DESCRIPTION COLUMN CHART	427975	APB	APB	RBS	
23FE15	R	09	-	-			13919113 - 13919114 - REVISED CABLE DIAMETER COLUMN CHART	428888	APB	APB	RBS	
16JUL15	R	10	-	-			13919112 - CABLE SIZE WAS 0.8	430190	APB	APB	RDL	
02JUL15	R	11	-	-			REVISED TERMINAL LEAD-IN FOR ALL PARTS	430058	JHG	JHG	RBS	
14OC15	R	12	-	-			ALL PARTS - UPDATED PART AVAILABILITY	431036	APB	APB	RBS	
05DE18	R	13	-	-			ALL PARTS - REVISED MATERIAL SPEC; REV LEVELS ADV TO 03	441787	CM	CM	RS	
11DE18	R	14	-	-			ALL PARTS - CORRECTED TOLERANCE FOR "B2" TO MATCH TOD I ± 0.25 WAS ± 0.31	441895	JGO	JAA	ASH	
05AP19	R	N/P	-	-			ALL PARTS - DIM #10 WAS 0 ± .2" AND ADDED G&T PROFILE OF LINE CONTROL FRAME & DATUM A OVERALL INFO	441273	DAY	JAA	RBS	

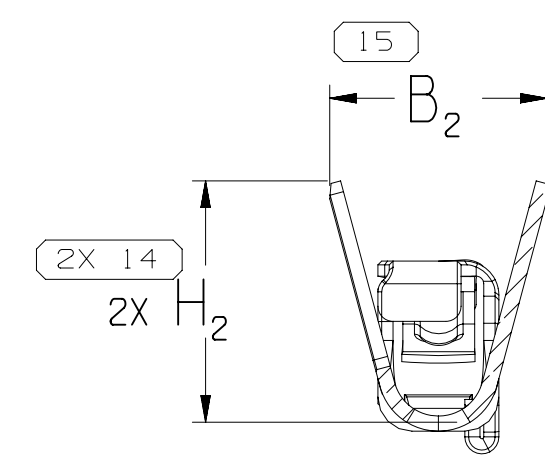

SECTION B-B

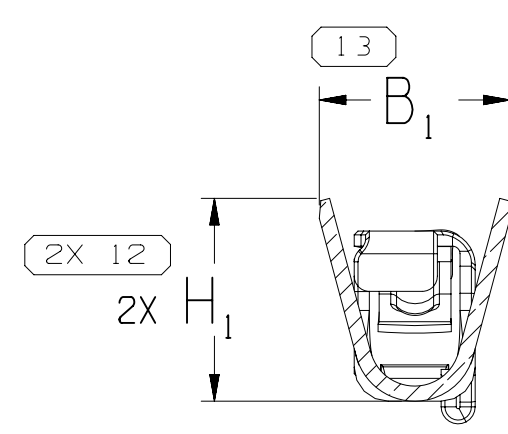
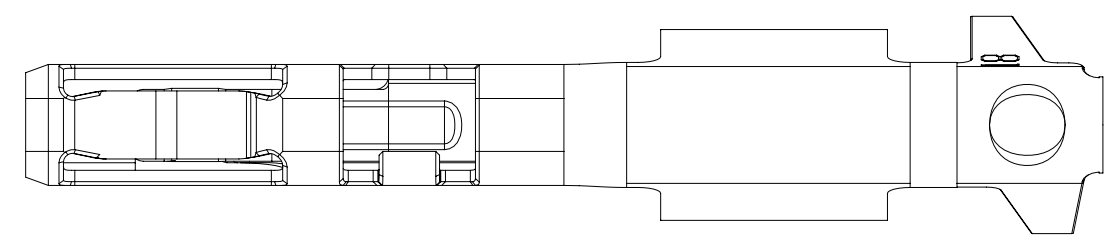
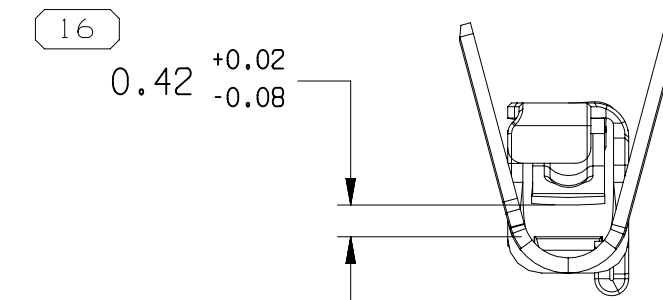
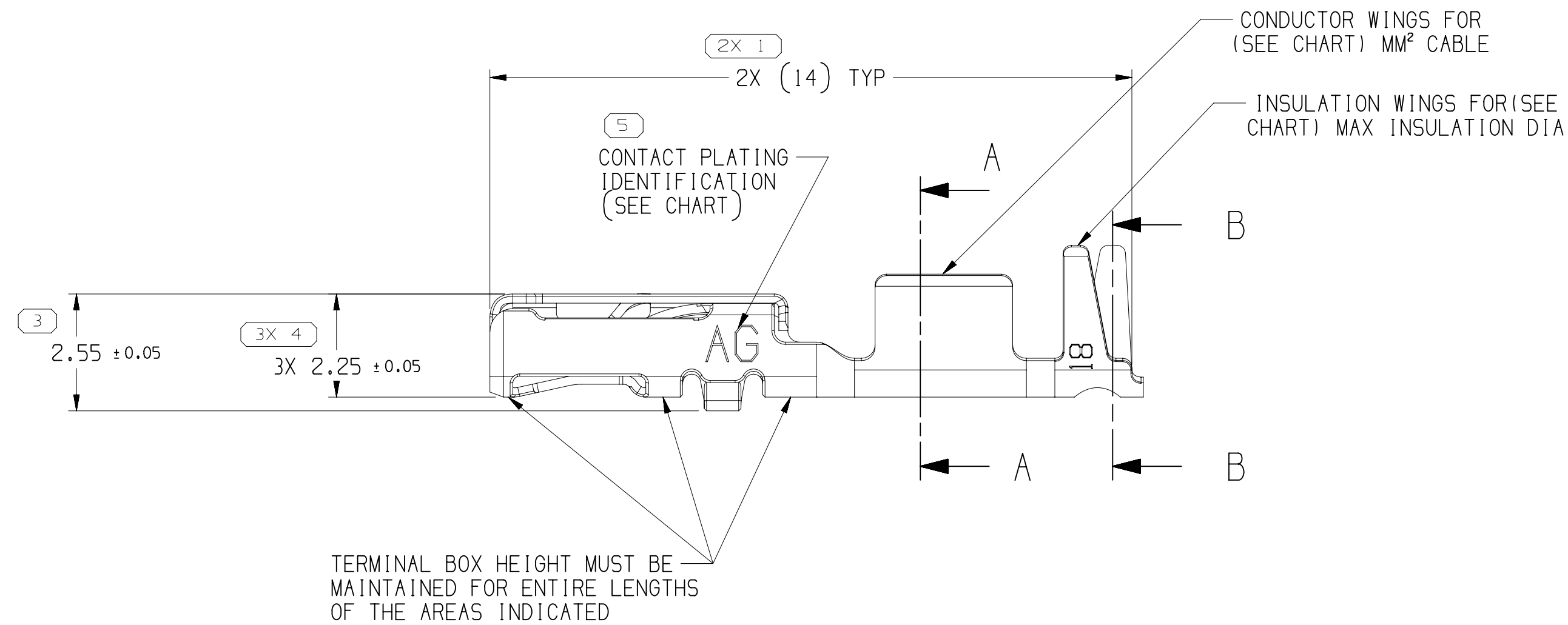
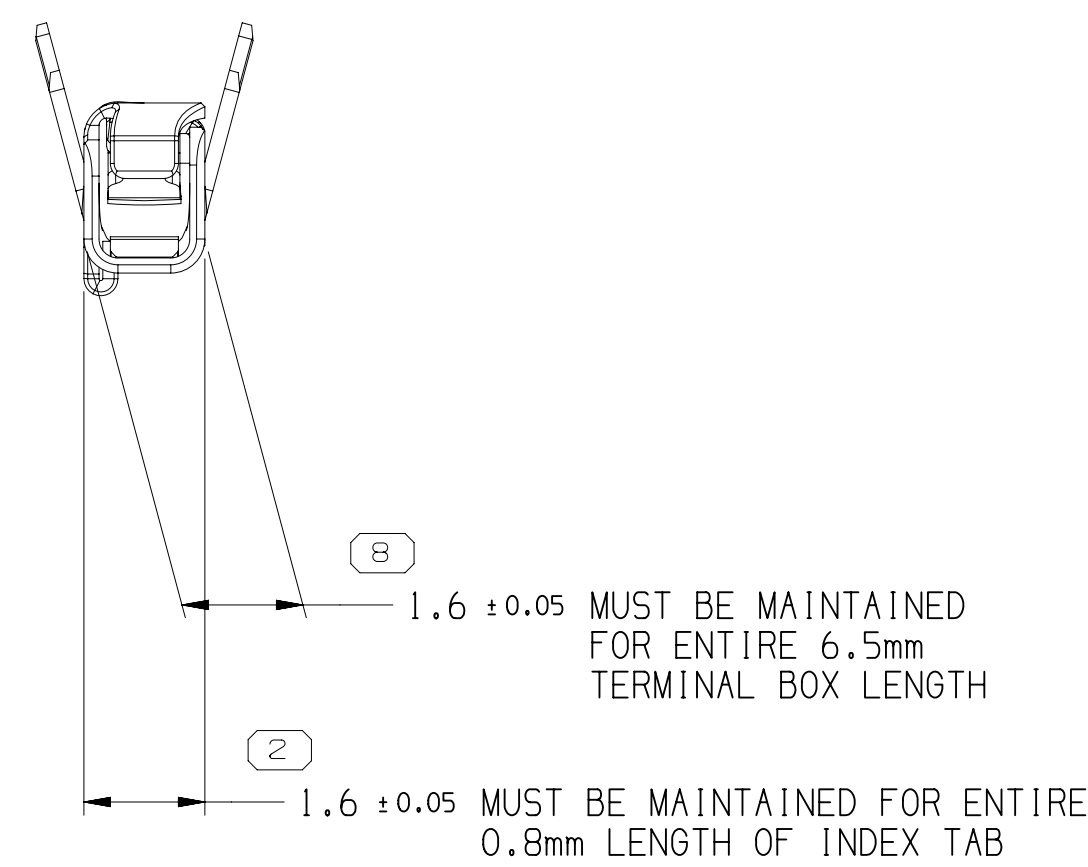
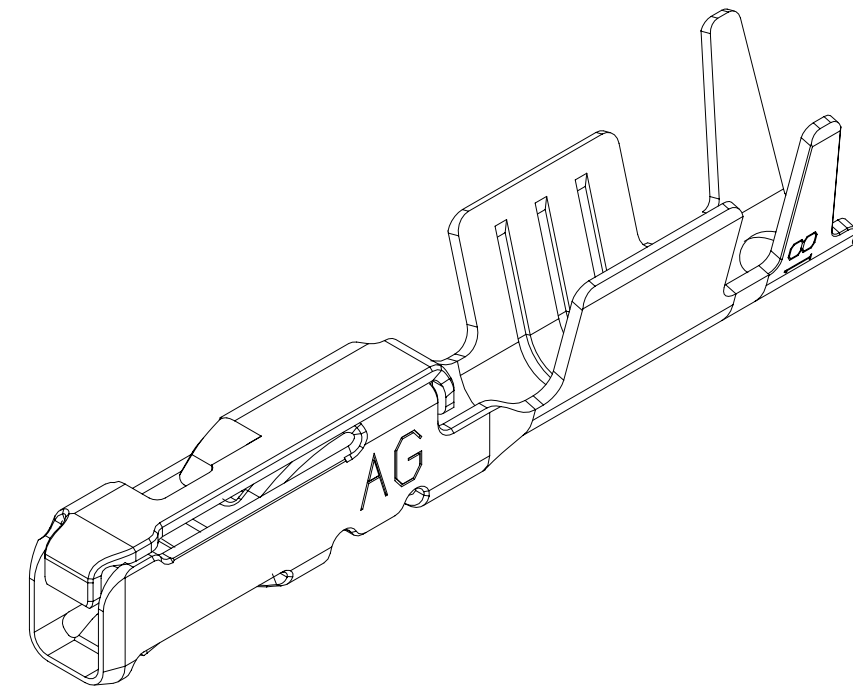
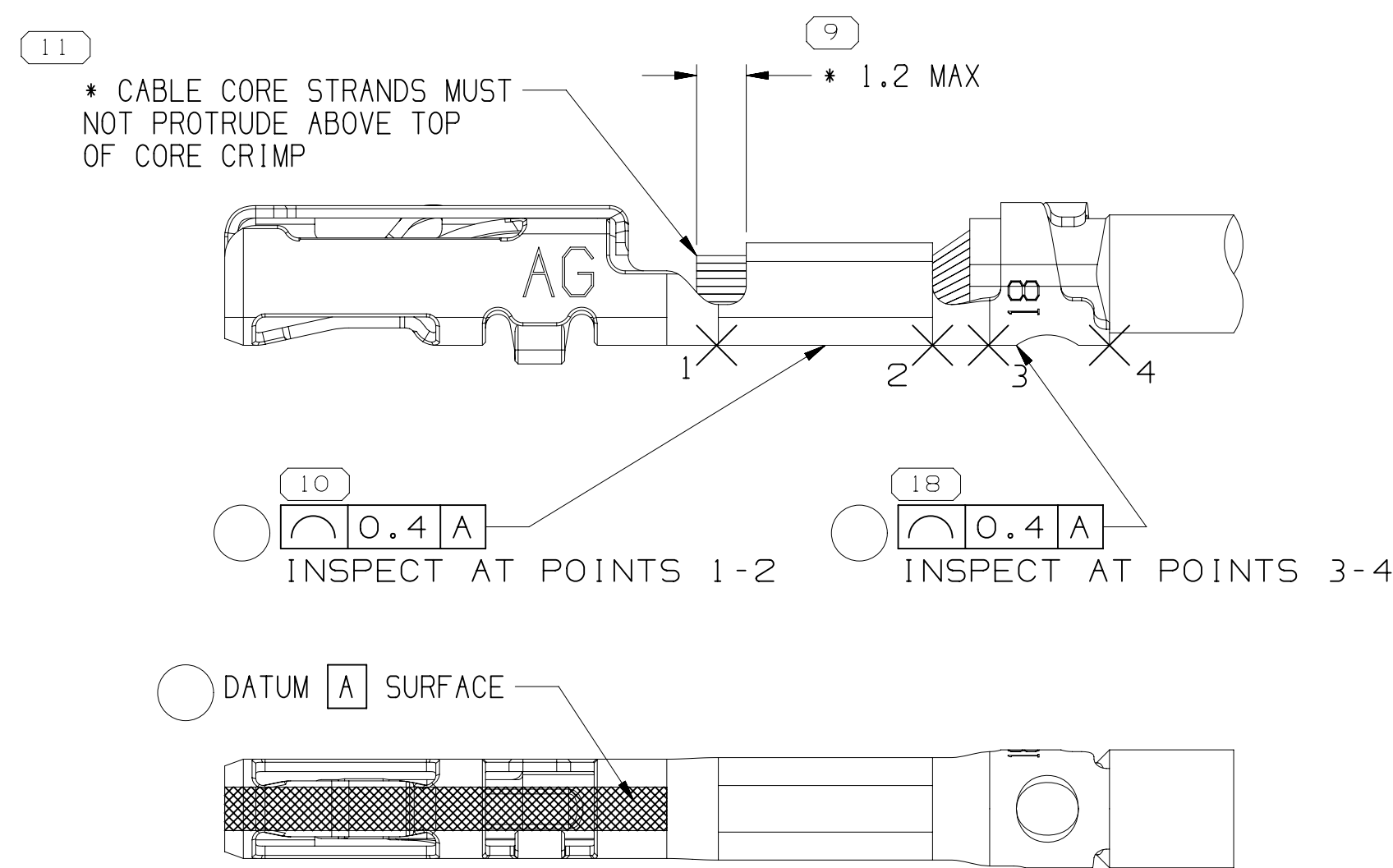
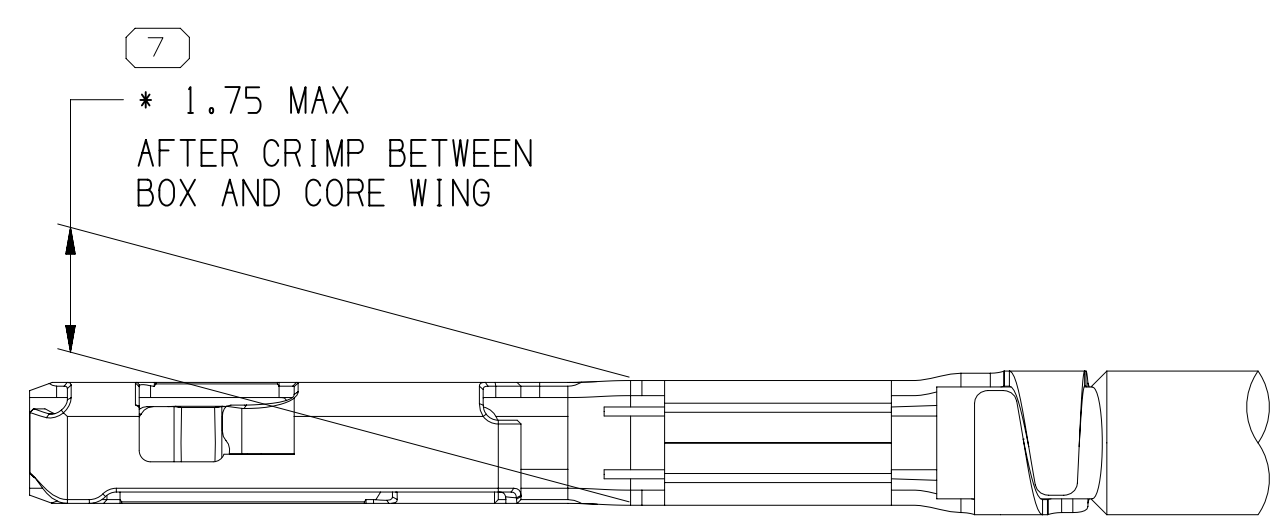

TERMINAL, CABLE CRIMP ALIGNMENT & POSITION

13919112	03	AB	COPPER ALLOY	III	IV	SILVER	AG	18	0.75 - 0.8	1.7 - 1.9	2.52	2.88	2.68	3.31
13919113	03	AB	COPPER ALLOY	III	IV	SILVER	AG	21	0.35 - 0.5	1.2 - 1.83	2.04	2.8	2.06	3.17
13919114	03	AB	COPPER ALLOY	III	IV	SILVER	AG	25	0.13 - 0.22	0.81 - 1.2	1.54	1.74	1.56	1.77
PART NUMBER	REV	N/P	MATERIAL DESCRIPTION	CONTACT AREA PLATING TYPE (SEE NOTE 8)	CRIMP AREA PLATING TYPE (SEE NOTE 8)	CONTACT PLATING	CONTACT PLATING I.D.	ID	CABLE SIZE (mm ²)	CABLE DIAMETER	B ₁ ±0.15	B ₂ ±0.25	(H ₁)	(H ₂)

1. UNLESS OTHERWISE SPECIFIED AND/OR INDICATED:

1. DIMENSIONS ARE TO FACE OF VIEW SHOWN AND AUTOMATICALLY ROUNDED BY COMPUTER FOR INSPECTION (SEE MATH MODEL FOR PRECISE DIMENSIONS). FOR ALL OTHER DIMENSIONS NOT SHOWN BUT REQUIRED FOR TOOL BUILD, SEE MATH MODEL FOR PRECISE TOOL PATH DATA.
 2. RECOMMENDED MATING BLADE THICKNESS 0.64±0.03mm
RECOMMENDED MATING BLADE WIDTH NOT TO EXCEED 1mm
AND NO LESS THAN 0.6mm. SEE USCAR EWCAP-001 DRAWING (0.64 PIN) FOR OTHER MATING BLADE REQUIREMENTS.
 3. MAX INSULATION CRIMP WIDTH 1.77mm AND HEIGHT 2.3mm FOR CABLE SIZE UP TO 1.9mm O.D.
MAX CORE CRIMP WIDTH 1.67mm
 4. MAXIMUM CURRENT CAPACITY IS 7.5 AMPS WITH 0.8mm² COPPER CABLE.
 5. * DENOTES DIMENSIONS MADE AT CUT-OFF AND CRIMP DIE
 6. PARTS MEET THE PERFORMANCE REQUIREMENTS OF GSW3191 DEC 2007 AND SAE/USCAR-2 R5 REVISION FOR THE FOLLOWING CLASSIFICATIONS:

TEMPERATURE CLASS 3 1-40° C TO +125° C)
VIBRATION CLASS 1 (ON BODY OR CHASSIS)
VIBRATION CLASS 2 (ON ENGINE) FOR SAE/USCAR-2 ONLY
SEALING CLASS 2 OR 3 (SEALED - CONNECTOR & CABLE SEAL DEPENDENT)
 7. DO NOT PROBE, TEST OR OTHERWISE CONTACT THE INTERIOR REGION (THE SPRING OR ANY MOVING PART) OF THIS TERMINAL. SEVERE DAMAGE CAN OCCUR, COMPROMISING THE PERFORMANCE OF THE ELECTRICAL INTERFACE.
 8. PLATING TYPE:
 - I. REFLOW TIN 1.9-3.3 MICROMETERS THICK OVER NICKEL UNDERPLATE 0.13-0.5 MICROMETERS THICK
 - II. GOLD 0.075-0.127 MICROMETERS THICK OVER PALLADIUM 0.510 - 0.635 MICROMETERS, OVER NICKEL UNDERPLATE 0.127-0.254 MICROMETERS THICK
 - III. SILVER 2.0 - 3.0 MICROMETERS THICK OVER NICKEL UNDERPLATE 0.13 - 0.51 MICROMETERS THICK.
 - IV. MATTE TIN 1.9-7.0 MICROMETERS THICK OVER NICKEL UNDERPLATING 0.13-0.51 MICROMETERS THICK (FOR USE WITH SELECTIVE SILVER PLATING SPECIFICATION)
 - V. MATTE TIN 1.9 - 3.75 MICROMETERS THICK OVER NICKEL UNDERPLATING 0.127 - 0.254 MICROMETERS THICK (FOR USE WITH SELECTIVE GOLD PLATING SPECIFICATION)
- PLATING TYPE INFORMATION SHOWN ABOVE IS REFERENCE ONLY;
PLATING REQUIREMENTS ARE CONTAINED IN APPLICABLE MATERIAL SPECIFICATION
9. SEE TAXI P/N 13767042 FOR SIMILAR TERMINALS WITH DIFFERENT CONNECTOR CAVITY INDEX.

8		PROCESS SENSITIVE DIMENSION	
DIMENSIONS ENCLOSED IN () INDICATE REFERENCE DIMENSIONS AND NO TOLERANCE LIMITS ARE ESTABLISHED			
DIMENSIONAL RANGE (MM)		CHART D	
FROM	0	> 12	
	12		
TOLERANCE UNLESS OTHERWISE SPECIFIED			
	±0.1	±0.2	
ANGULAR TOLERANCE ±2°			

A LINE DRAWING FROM A PART NUMBER
 INDICATES THAT PHYSICAL PARTS ARE NOT AVAILABLE
 FOR ORDERING.
 PART NUMBERS THAT DO NOT HAVE A LINE PRESENT INDICATE
 THAT PHYSICAL PARTS ARE AVAILABLE FOR ORDERING.
 CONTACT APTI sales TO ASSURE AVAILABILITY OF
 PARTS.
 DWG TYPE **PART DRAWING**
 STYLE
 VOLUME (CM³) **DISTR CODE**
 UNLESS OTHERWISE SPECIFIED
 THIS DOCUMENT IS IN ACCORDANCE WITH ASME Y14.5M-1994
 DIMENSIONS ARE IN MILLIMETERS
 TOLERANCING ADDENDUM 2001. SEPARATE PATTERNS OF
 FEATURES MAY BE GAUGED SEPARATELY REGARDLESS OF DATUM
 REFERENCES.
 ALL DIMENSIONS ARE IN MILLIMETERS
 REFERENCE

<h1 style="margin: 0;">• APTIV •</h1> <p style="margin: 5px 0;">CONNECTION SYSTEMS</p> <p style="margin: 5px 0;">WARREN, OH</p> <p style="margin: 5px 0;">COPYRIGHT 2012 APTIV. ALL RIGHTS RESERVED.</p> <p style="margin: 5px 0;">THIS DRAWING IS THE PROPERTY OF APTIV AND CONTAINS APTIV CONFIDENTIAL INFORMATION. THE REPRODUCTION, DISTRIBUTION AND UTILIZATION OF THIS DOCUMENT OR ITS RELATED CAD DATA, AS WELL AS COMMUNICATION OF ANY CONTENT TO OTHERS, WITHOUT EXPRESS AUTHORIZATION, IS PROHIBITED.</p>							
						DATE	
DIR							
APVD: MIGUEL DE LEON						19JA12	
APVD: MIGUEL DE LEON						19JA12	
APVD: ROBERT B. SNADER						19JA12	
APVD:							
SUBSTANCES OF CONCERN AND RECYCLED CONTENT PER APTIV 10949001							
MATERIAL SEE CHART							
DRAWING NAME:							
TAXI TERM F OCS 0.64 IDR							
DRAWING NUMBER:							
13919105							
SIZE	SCALE	FRAME NO	SHEET NO	STD	REV	N/P	
A0	10:1	1 OF 1	2 OF	1	R15	-	
2				1			

Mouser Electronics

Authorized Distributor

Click to View Pricing, Inventory, Delivery & Lifecycle Information:

[Aptiv:](#)
[13919112](#)