

MATING PANEL HOLE

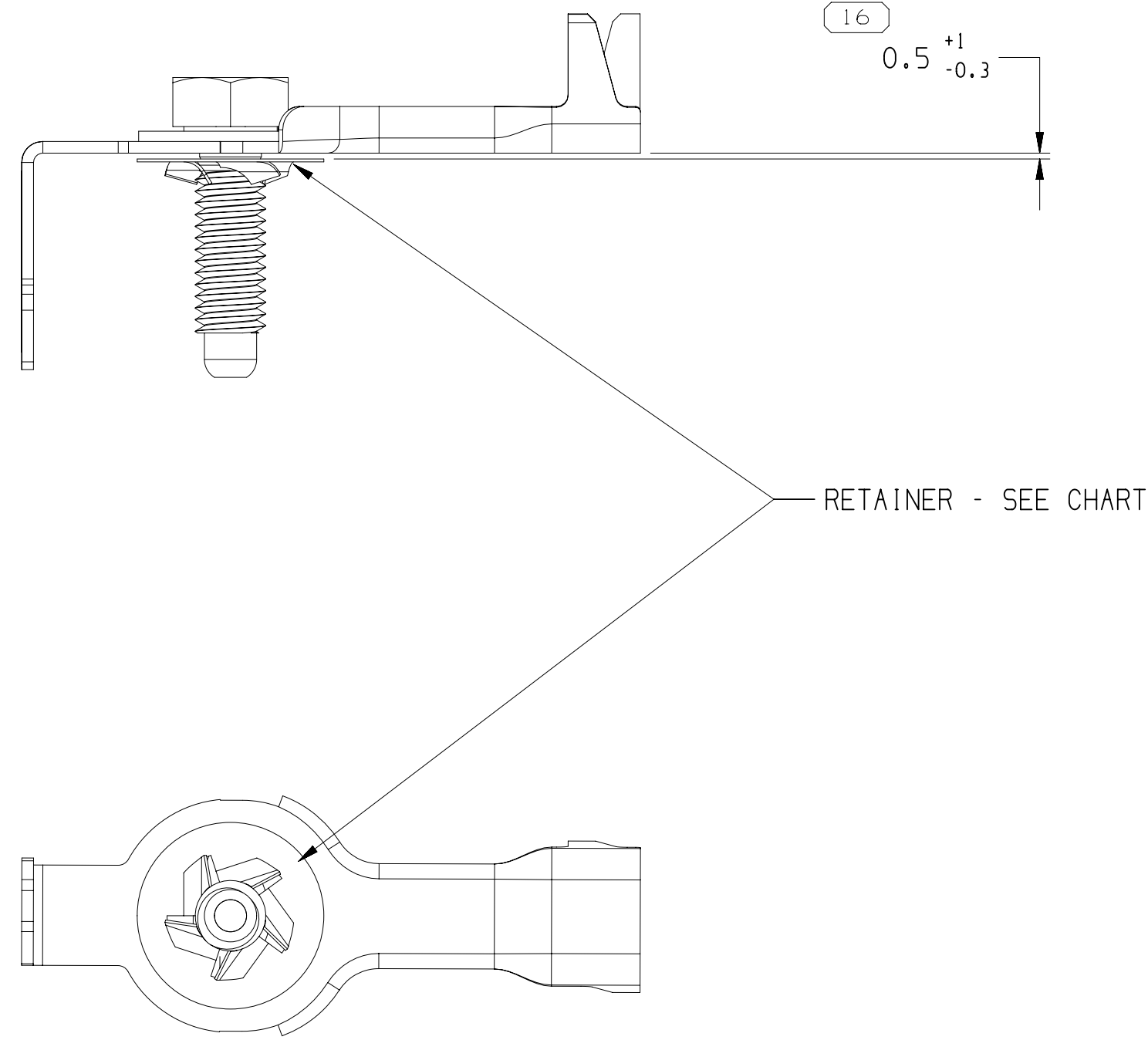

ALL TYPES
OPTIONAL CONSTRUCTION

| | | |
|--|---|----|
| A DIMENSION WITHOUT AN INSPECTION REPORT SYMBOL □ DOES NOT REQUIRE INSPECTION. IT MAY BE CONTROLLED ON THE INDIVIDUAL COMPONENT DRAWING. | TOTAL NO. OF INSPECTIONS REQUIRED | 17 |
| | LAST NO. USED | 16 |

| DWS STATUS | | 3 | | 4 | | 5 | | 6 | | 7 | | 8 | | 9 | | 10 | | 11 | | 12 | | 13 | | 14 | | 15 | | 16 | |
|------------|-----|-----|-----|-----|------|--|--|--------|--|-----|--|------|--|------|--|------|--|------|--|------|--|------|--|------|--|------|--|------|--|
| DATE | STG | REV | N/P | CHG | ZONE | REVISION HISTORY | | AUTH | | DR | | APVD | | APVD | | APVD | | APVD | | APVD | | APVD | | APVD | | APVD | | APVD | |
| 290C07 | R | 01 | - | - | | 13637605 WAS SEPARATE DRAWING AND REVISED. 13667844 WAS PE170780 AND RELEASED | | 402573 | | CJP | | CJP | | CJP | | CJP | | CJP | | CJP | | CJP | | CJP | | CJP | | CJP | |
| 24JN08 | R | 02 | - | - | | 13637605 - TERMINAL WAS 13642071; 13667844 - TERMINAL WAS 13667845 | | 405123 | | BLG | | JAM | | JAM | | JAM | | JAM | | JAM | | JAM | | JAM | | JAM | | JAM | |
| 18SE08 | R | 03 | - | - | | ALL PARTS - RELAXED TOLERANCES DIM #5 WAS 8.6 ± 0.1, DIM #11 WAS 90° ± 2° DIM #12 WAS 18.55 ± 0.2, DIM #13 WAS 25.03 ± 0.2 AND DIM #15 WAS 53.03 ± 0.2 | | 406150 | | EAJ | | FKV | | CJP | | CJP | | CJP | | CJP | | CJP | | CJP | | CJP | | CJP | |
| 25N008 | R | 04 | - | - | | ALL PARTS - ADDED OPTIONAL CONSTRUCTION & REVISED NOTE 2 | | 406882 | | RGC | | RGC | | RGC | | RGC | | RGC | | RGC | | RGC | | RGC | | RGC | | RGC | |
| 24MR10 | R | 05 | - | - | | ALL PARTS - DIM 16 WAS 0.5 ± 0.5/-0.3 | | 410387 | | LHT | | LHT | | RGC | | RGC | | RGC | | RGC | | RGC | | RGC | | RGC | | RGC | |
| 02N010 | R | 06 | - | - | | 13838829 - RELEASED | | 411469 | | ACR | | JAM | | CRD | | CRD | | CRD | | CRD | | CRD | | CRD | | CRD | | CRD | |
| 03MR11 | R | 07 | - | - | | ALL PARTS - 90° ± 6° WAS 90° ± 5° | | 413552 | | AJJ | | JVM | | CRD | | CRD | | CRD | | CRD | | CRD | | CRD | | CRD | | CRD | |
| 210C13 | R | 08 | - | - | | 33119925 - RELEASED | | 424231 | | AHY | | LRS | | LRS | | LRS | | LRS | | LRS | | LRS | | LRS | | LRS | | LRS | |
| 300C13 | R | 09 | - | - | | 13838829 - WAS TYPE 102; 33119925 - WAS TYPE 101 & BUNDLE SIZE 2.5-6.5 AND NO. OF WIRES 1-8 | | 424384 | | AOC | | JVM | | LRS | | LRS | | LRS | | LRS | | LRS | | LRS | | LRS | | LRS | |
| 18FE19 | R | 10 | - | - | | 13838829 & 33119925 - ADDED OPTIONAL CONSTRUCTION; ALL PARTS - MOVED RETAINER PIN FROM OPTIONAL CONSTRUCTION VIEW TO BOM CHART | | 442415 | | LVD | | LB | | LB | | LB | | LB | | LB | | LB | | LB | | LB | | LB | |

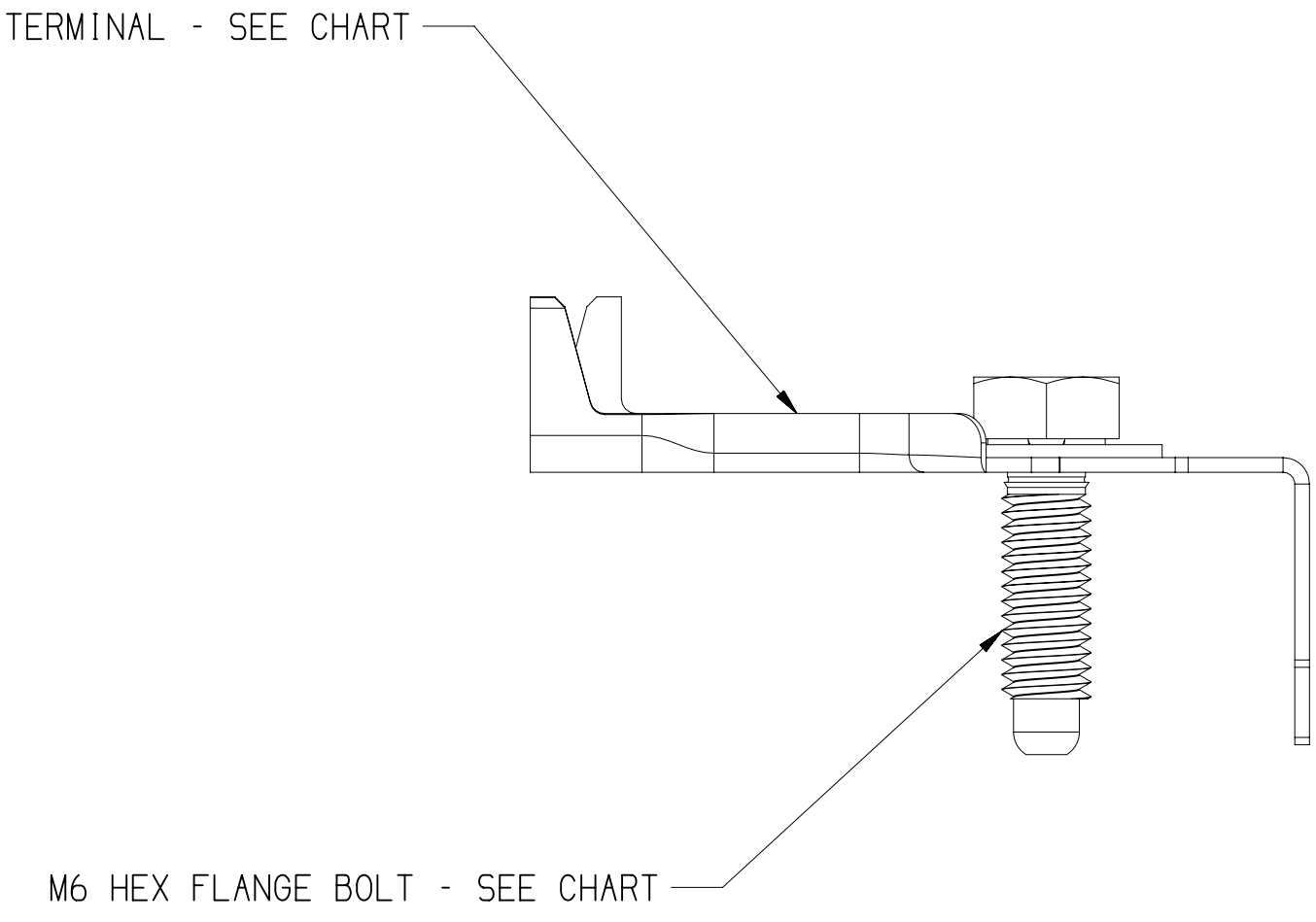
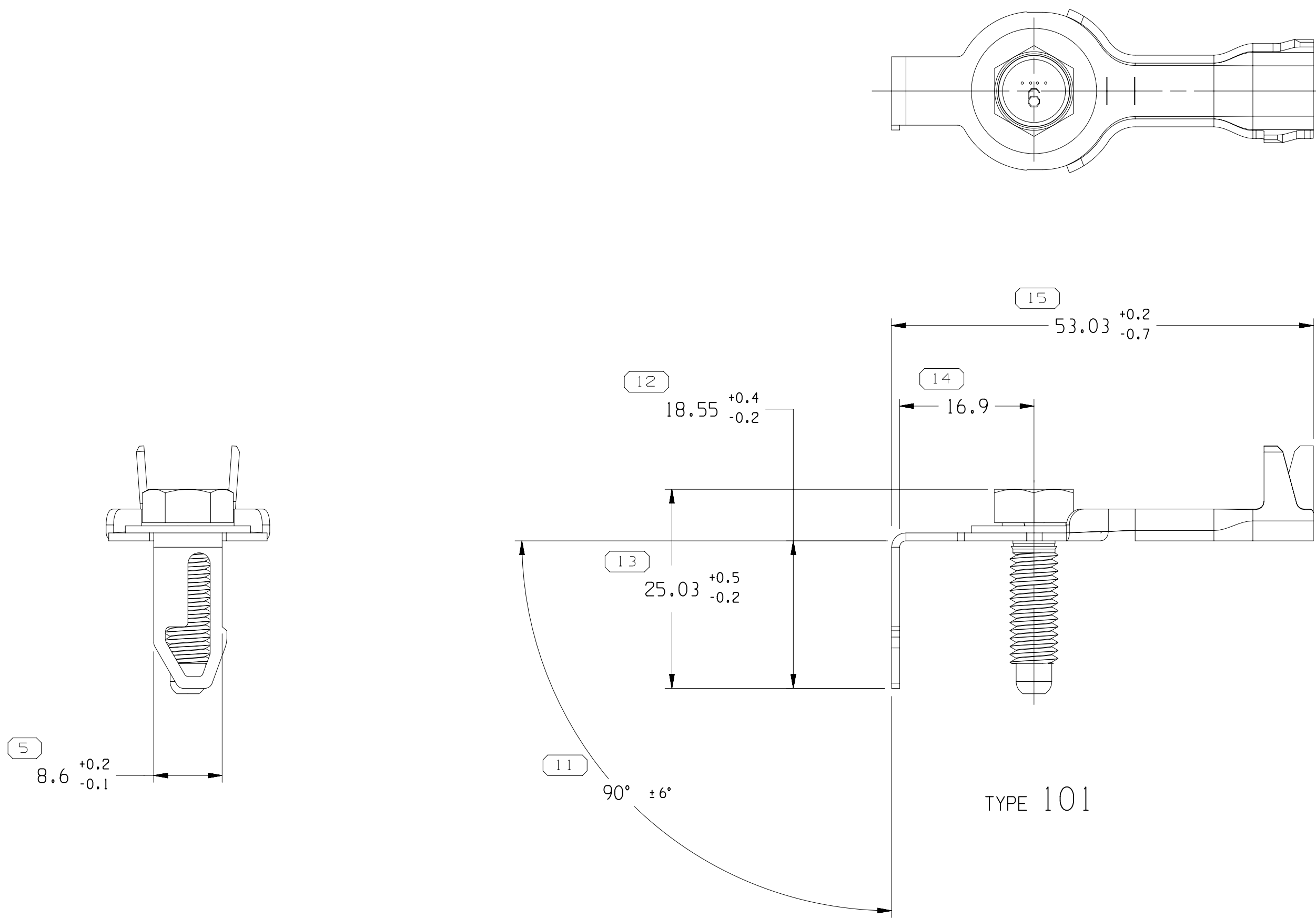

NOTES

1. UNLESS OTHERWISE SPECIFIED AND/OR INDICATED:

DIMENSIONS ARE TO FACE OF VIEW SHOWN AND AUTOMATICALLY ROUNDED BY COMPUTER FOR INSPECTION (SEE MATH MODEL FOR PRECISE DIMENSIONS). FOR ALL OTHER DIMENSIONS NOT SHOWN BUT REQUIRED FOR TOOL BUILD, SEE MATH MODEL FOR PRECISE TOOL PATH DATA.

2. BOLT MUST ROTATE IN ASSEMBLY AT A TORQUE OF LESS THAN 10 LBF-FT (13.5 N-M) BUT WILL NOT COME OUT OF THE TERMINAL.

| | | | | | | | | |
|----------|-----|-----|------|----------|----------|--------------------------------|-------------------|------------------------|
| 33119925 | 02 | AA | 104 | 13711877 | 13838828 | 13509912 | 6.5 - 13.5 | 1 - 12 |
| 13838829 | 01 | AC | 103 | 13711878 | 13838828 | 13509912 | 2.5 - 6.5 | 1 - 8 |
| 13667844 | 03 | AC | 102 | 13711878 | 13509726 | 13509912 | 2.5 - 6.5 | 1 - 8 |
| 13637605 | 05 | AC | 101 | 13711877 | 13509726 | 13509912 | 6.5 - 13.5 | 1 - 12 |
| PART NO | REV | N/P | TYPE | TERMINAL | BOLT | RETAINER | BUNDLE SIZE (MM²) | NO. OF WIRES (MIN-MAX) |
| | | | | | | SEE OPTIONAL CONSTRUCTION VIEW | | |

| | |
|--|---------|
| 5 PROCESS SENSITIVE DIMENSION | |
| DIMENSIONS ENCLOSED IN () INDICATE REFERENCE DIMENSIONS AND NO TOLERANCE LIMITS ARE ESTABLISHED | |
| FROM 0 TO 12 | CHART D |
| TOLERANCE UNLESS OTHERWISE SPECIFIED | |
| ± 0.1 | ± 0.2 |
| ANGULAR TOLERANCE | ± 2° |

| | | | |
|------------------------|--------------|---------------|----|
| THIRD ANGLE PROJECTION | DO NOT SCALE | USE MATH DATA | NX |
|------------------------|--------------|---------------|----|

| | |
|--|----------|
| APTIV | |
| CONNECTION SYSTEMS | |
| WARREN, OH | |
| COPYRIGHT 2007 APTIV, ALL RIGHTS RESERVED. | |
| THIS DRAWING IS THE PROPERTY OF APTIV AND CONTAINS APTIV CONFIDENTIAL INFORMATION. THE REPRODUCTION, DISTRIBUTION AND UTILIZATION OF THIS DOCUMENT OR ITS RELATED CAD DATA, AS WELL AS COMMUNICATION OF ANY CONTENT TO OTHERS, WITHOUT EXPRESS AUTHORIZATION, IS PROHIBITED. | |
| DR | DATE |
| APVD1 C. PAPAS | 290C07 |
| APVD2 C. PAPAS | 290C07 |
| APVD3 CAROL J. FITCH | 06N007 |
| APVD4 | |
| APVD5 | |
| SUBSTANCES OF CONCERN AND RECYCLED CONTENT PER APTIV 10949001 | |
| MATERIAL SEC CHART | |
| DRAWING NAME | |
| TAXI ASM TERM RING SONIC | |
| DRAWING NUMBER | |
| 13669723 | |
| SIZE | SCALE |
| A0 | 2:1 |
| FRAME NO | SHEET NO |
| 1 | 1 OF 1 |
| STG | REV |
| 1 | 10 |

Mouser Electronics

Authorized Distributor

Click to View Pricing, Inventory, Delivery & Lifecycle Information:

[Aptiv:](#)
[13838829](#)