

SYMBOL DEFINITION		
A DIMENSION WITHOUT AN INSPECTION REPORT SYMBOL  DOES NOT REQUIRE INSPECTION. IT MAY BE CONTROLLED ON THE INDIVIDUAL COMPONENT DRAWING.	TOTAL NO OF INSPECTIONS REQUIRED	13
	LAST NO. USED	13

DWG STATUS					ZONE	REVISION HISTORY	AUTH	RD	APVD	APVC
DATE	STG	REV	N/P	CHG						
27FEB18	R	01	-	-	ALL PARTS - RELEASED PART DRAWING	436185	AGC	AGC	TM	
26SEP18	R	02	-	-	ALL PARTS - REVISED GRAPHICS, ADDED "PART PERFORMANCE REQUIREMENTS", "CONNECTOR EXTRACTION FORCE" & "ASSEMBLY ARE MODULAR" NOTES AND REVISED "CHARACTERISTIC GREENPASTE DISTANCE", "ELECTRIC HI-POT TEST" & "PACKAGED" NOTES; 35149737 - UPDATED PART AVAILABILITY	440875	BDH	JAA	JAA	
28NOV18	R	03	-	-	ALL PARTS - REVISED VALIDATION AND CAUTION NOTE.	441703	AHG	AHG	TM	

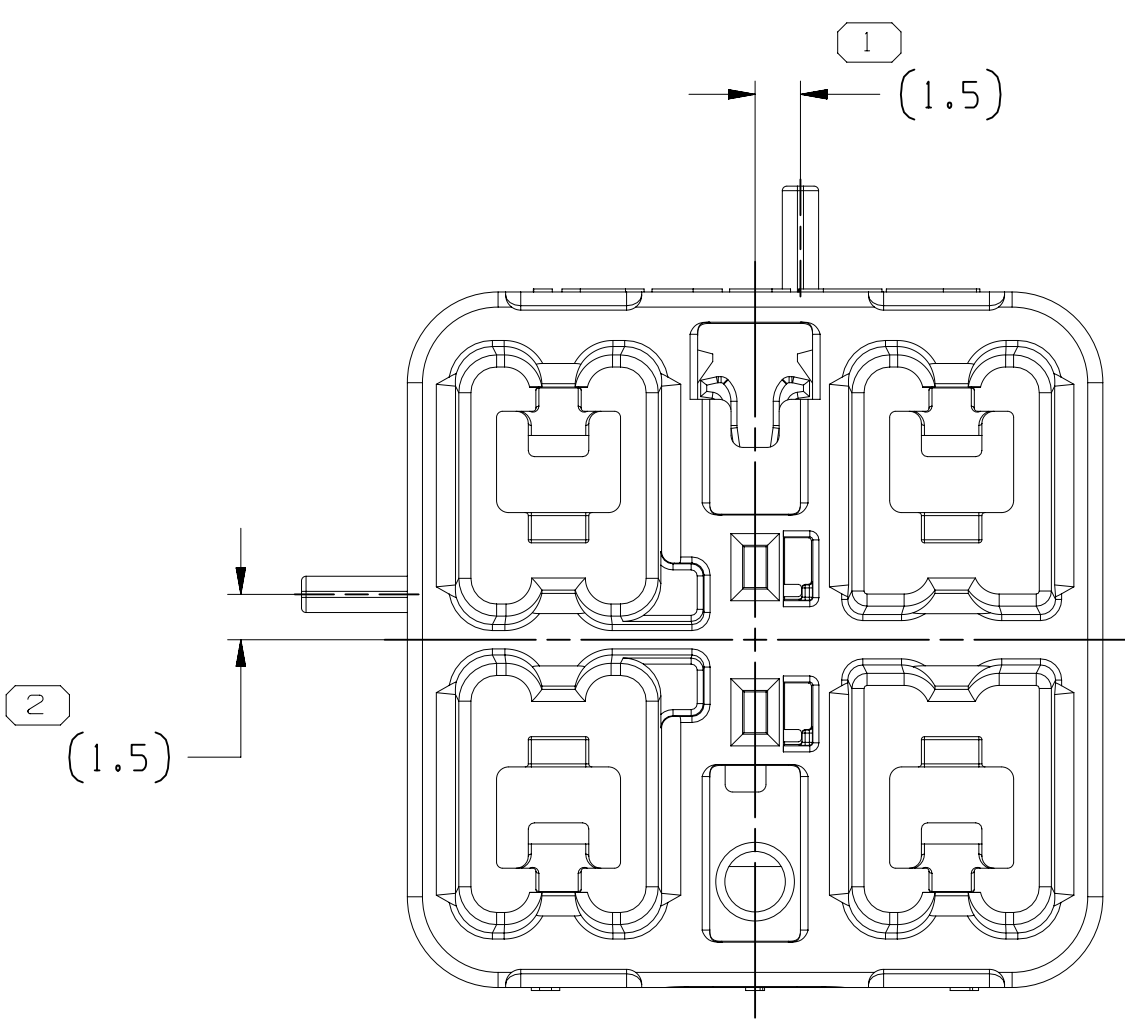

TYPE 102
SAME AS TYPE 101
EXCEPT AS SHOWN

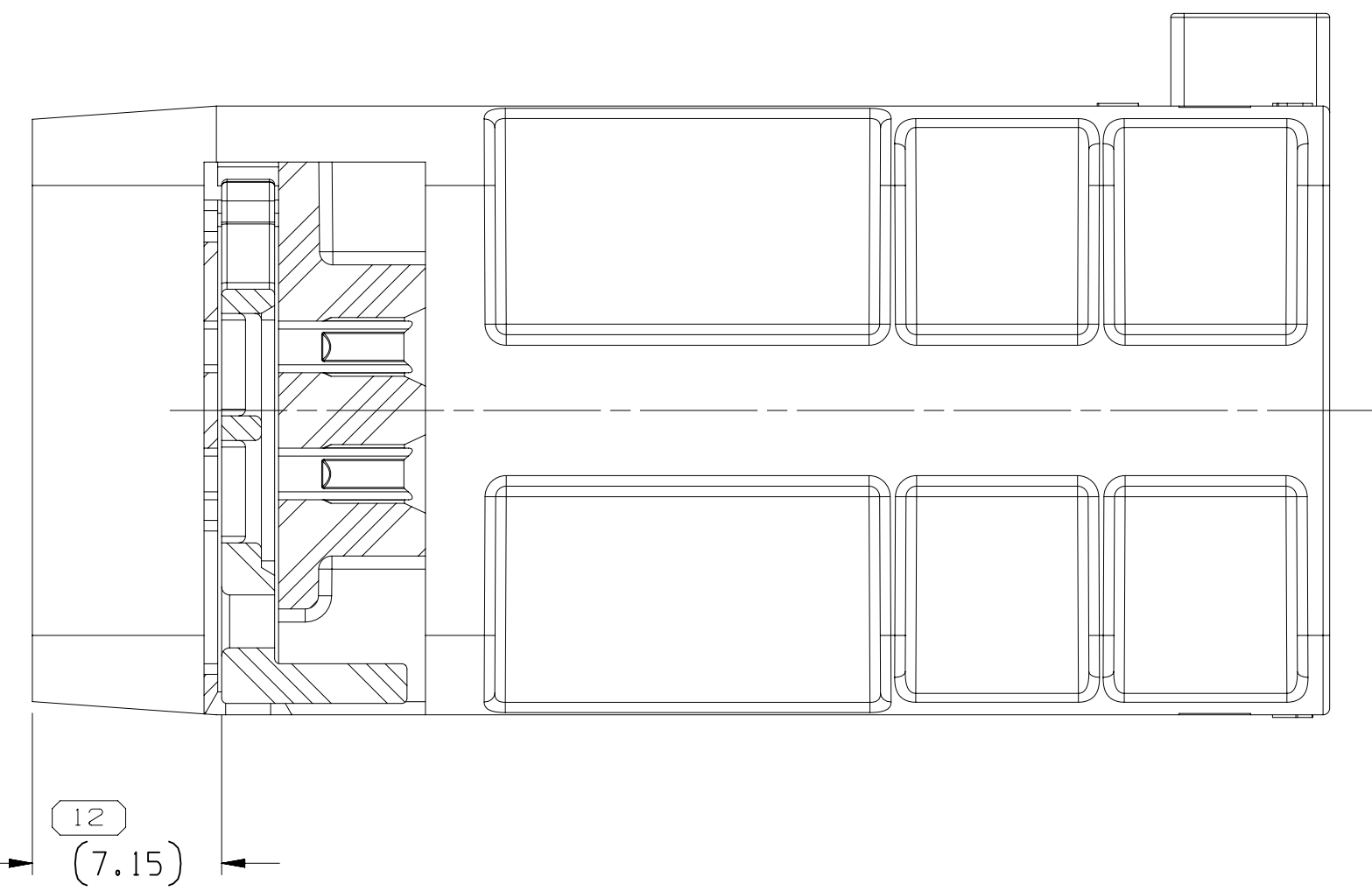
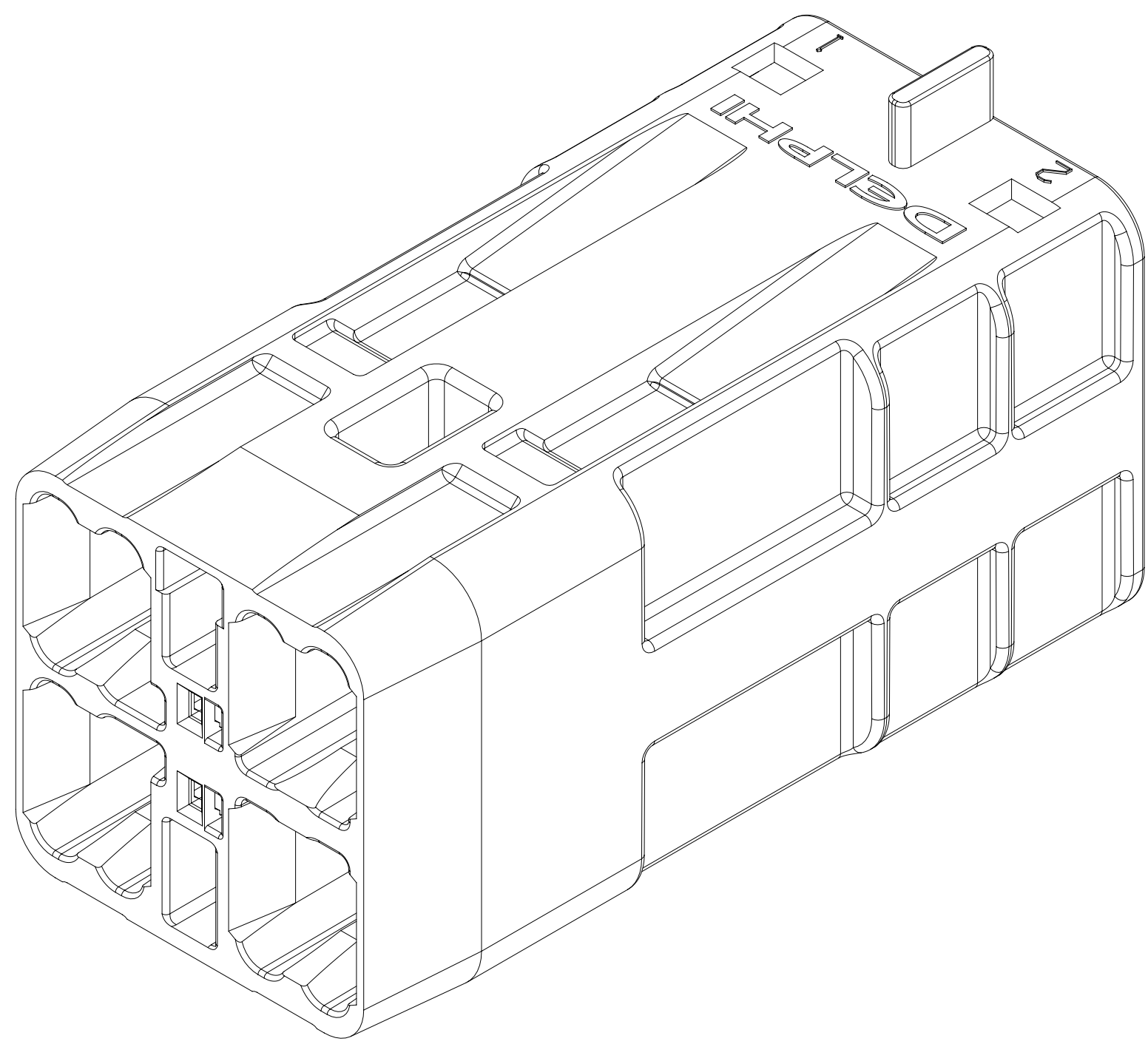
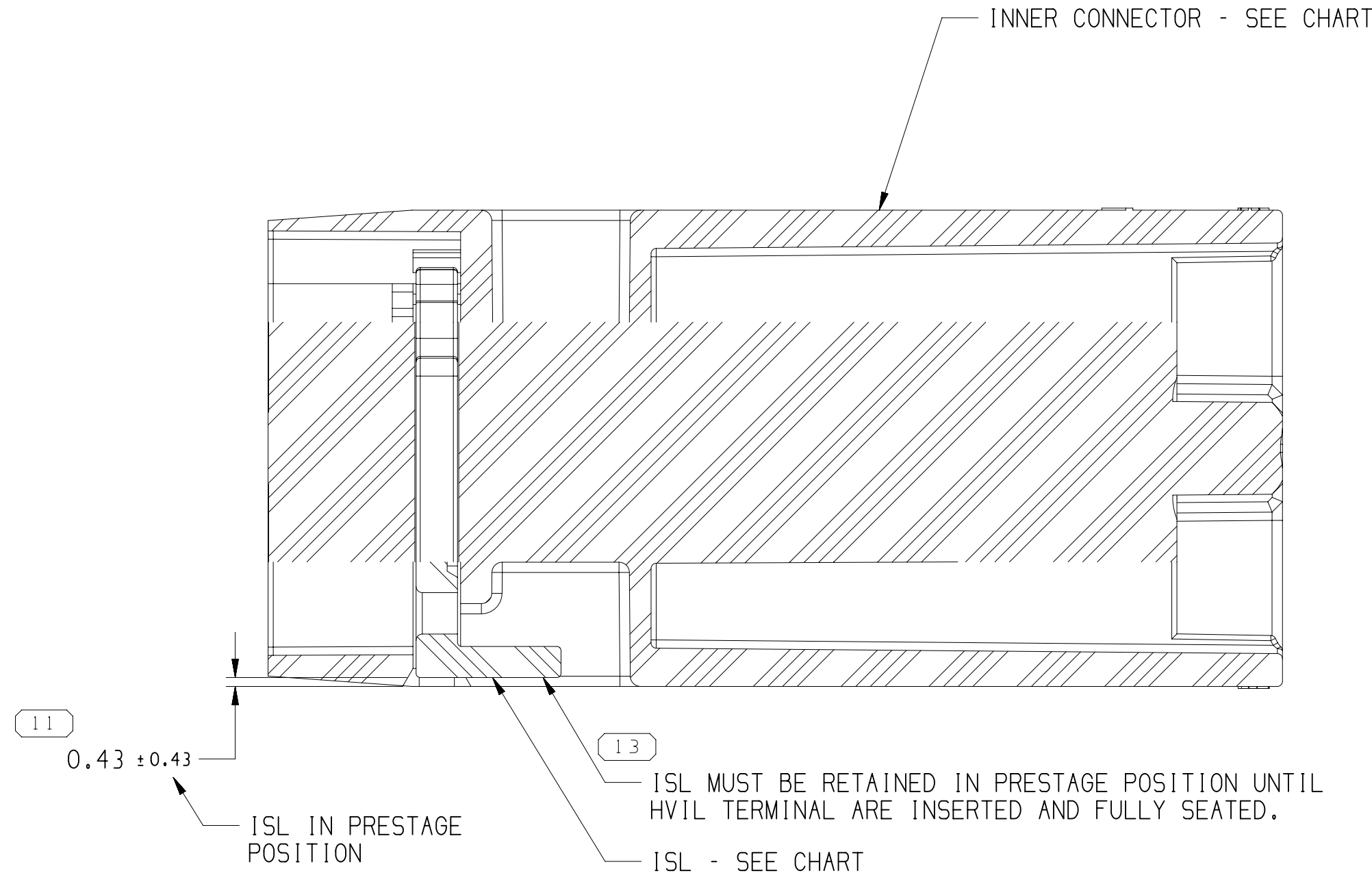

SECTION A - A

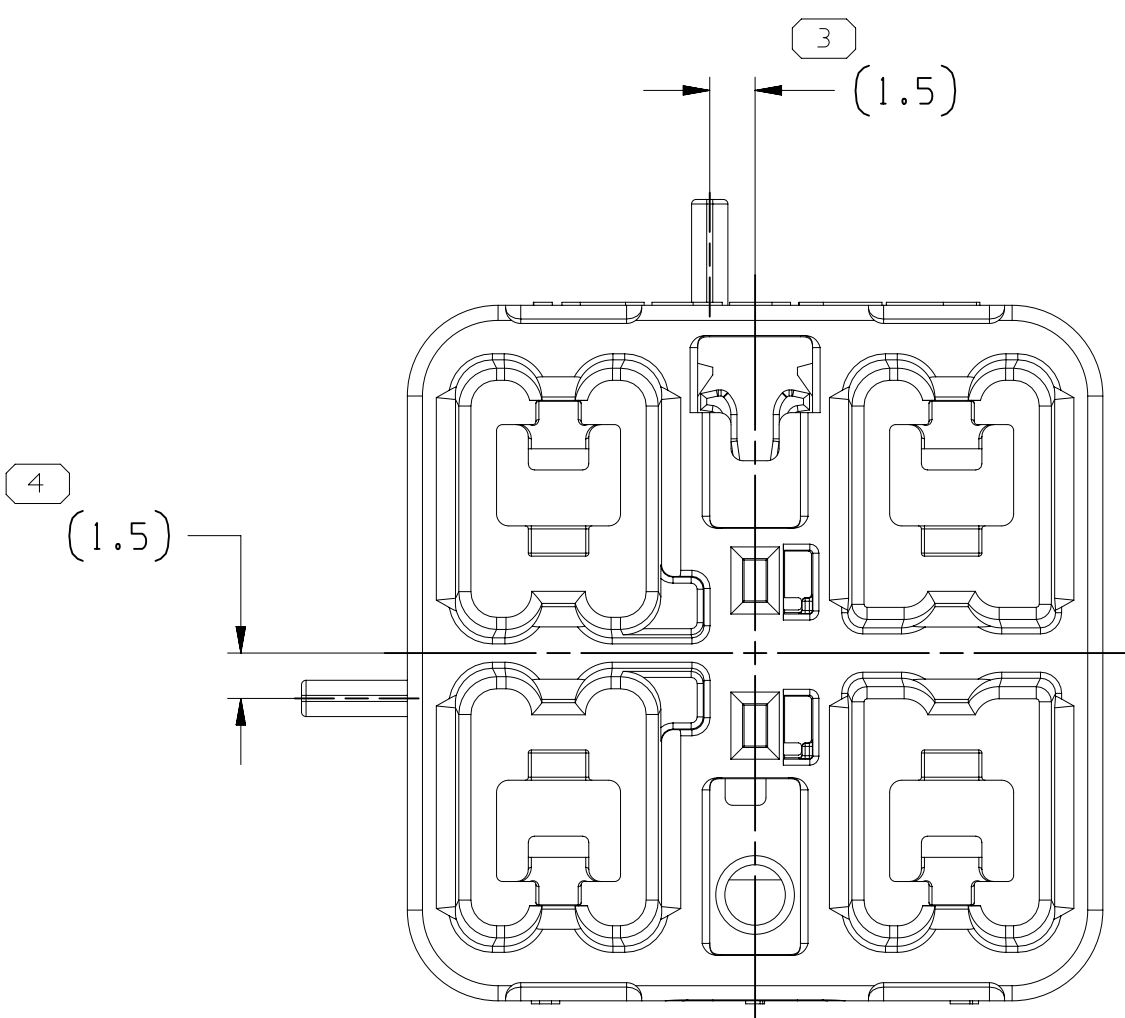

TYPE 103
SAME AS TYPE 101
EXCEPT AS SHOWN

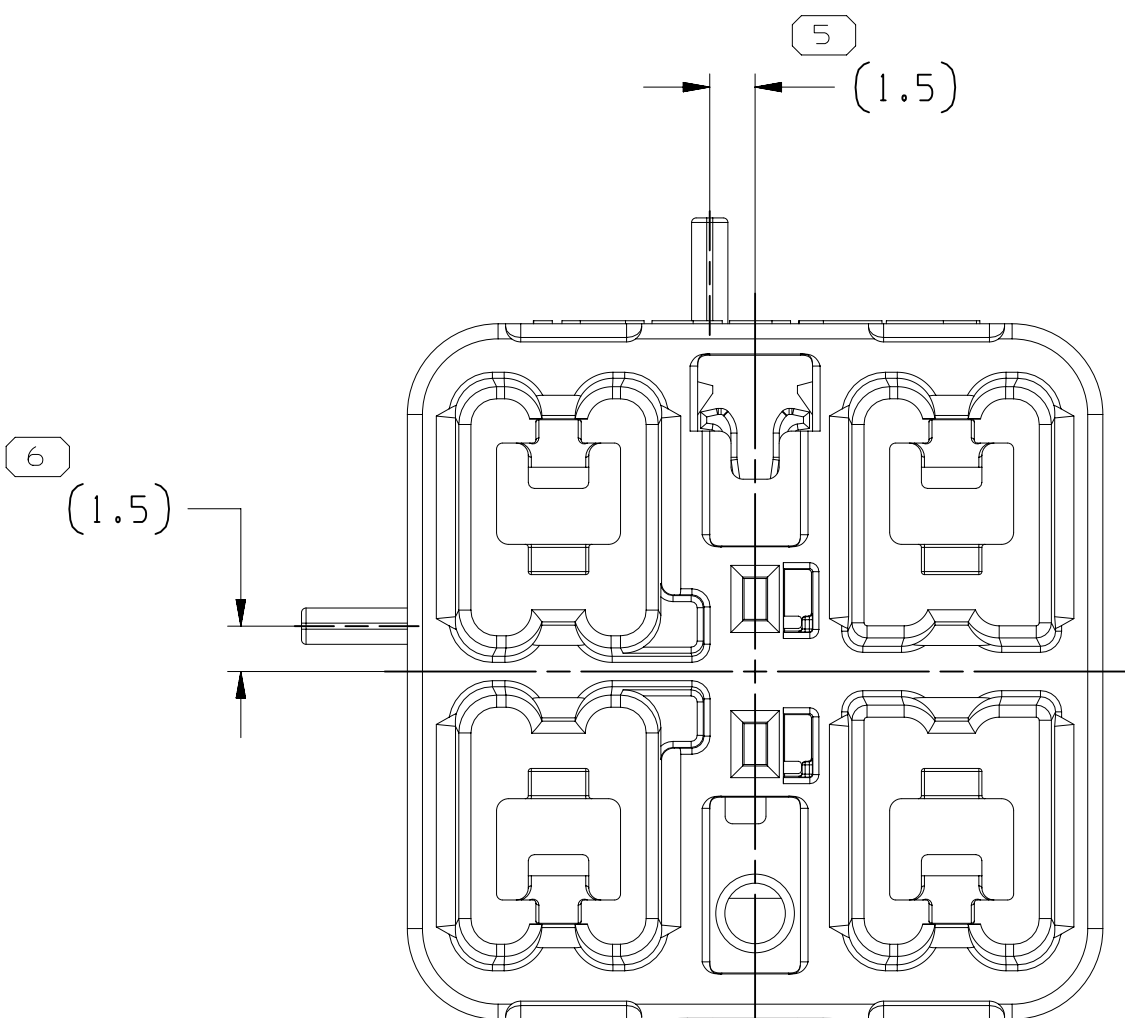
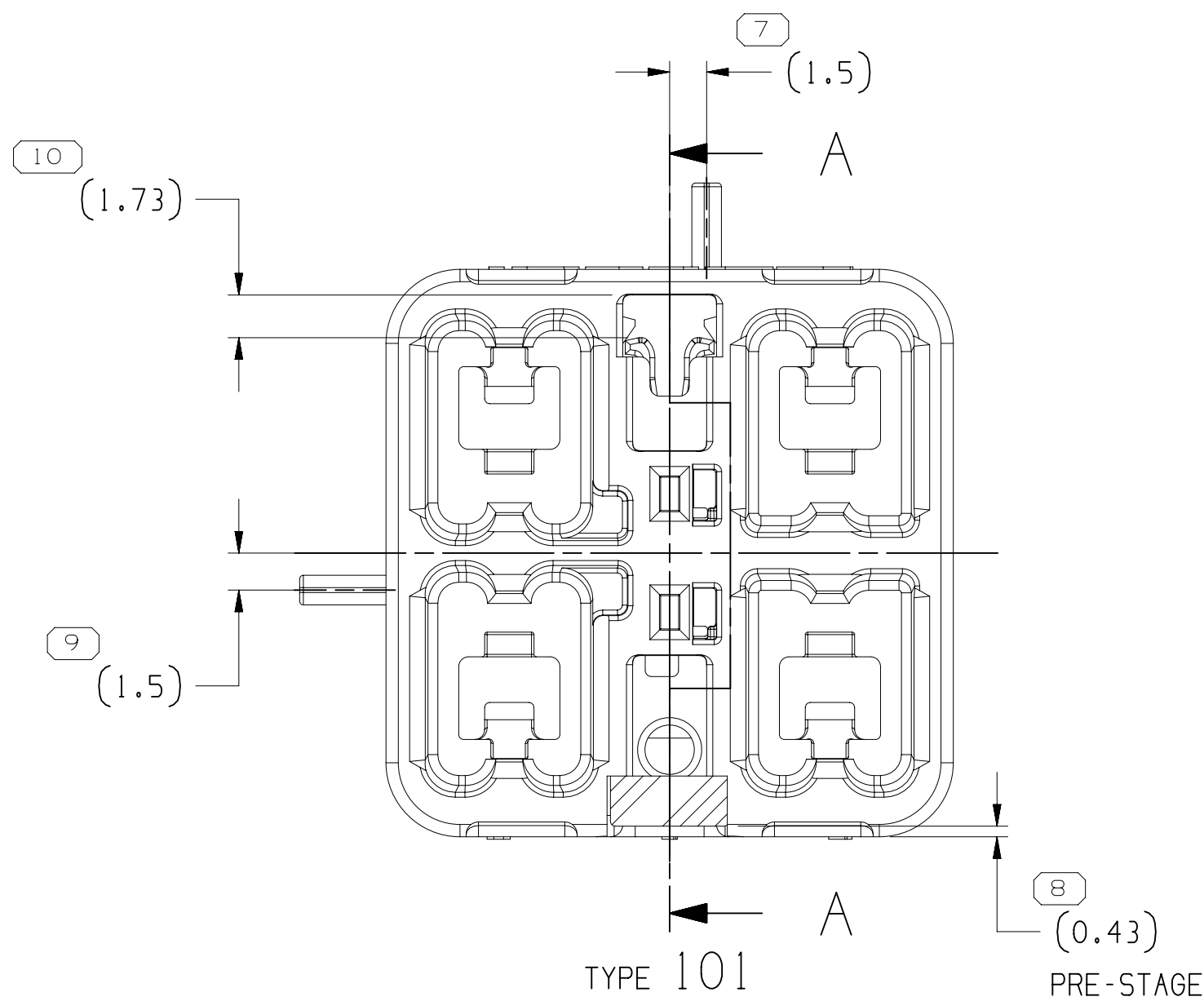

TYPE 104
SAME AS TYPE 101
EXCEPT AS SHOWN

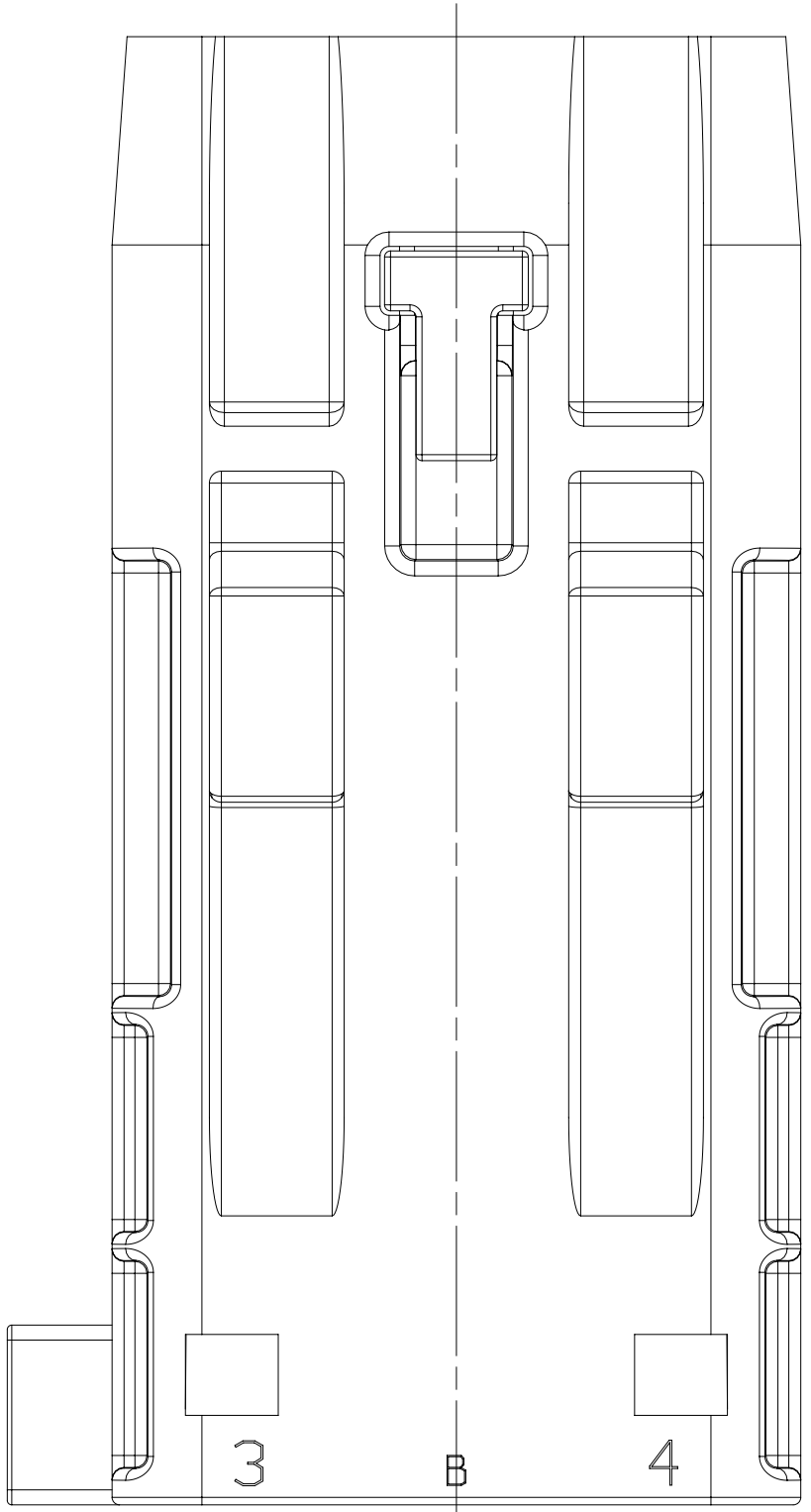

- NOTES
1. UNLESS OTHERWISE SPECIFIED AND/OR INDICATED:

DIMENSIONS ARE TO FACE OF VIEW SHOWN AND AUTOMATICALLY ROUNDED BY COMPUTER FOR INSPECTION (SEE MATH MODEL FOR PRECISE DIMENSIONS). FOR ALL OTHER DIMENSIONS NOT SHOWN BUT REQUIRED FOR TOOL BUILD, SEE MATH MODEL FOR PRECISE TOOL PATH DATA.
 2. THIS PRODUCT IS NOT CATEGORIZED AS AN APPEARANCE ITEM, MINOR IMPERFECTIONS INCLUDING, BUT NOT LIMITED TO, FLOW MARKS, COLOR BLEMISHES, GATE VESTIGE, AND SOFT FLASH THAT DO NOT AFFECT THE FIT, FORM, OR FUNCTION OF THE PART ARE PERMISSIBLE PER DPNP-4.7-CS-01.
 3. WHEN THE MALE INNER CONNECTOR ASSEMBLY IS FULLY POPULATED WITH TERMINALS AND PLUGGED INTO A HEADER OUTER HOUSING ASSEMBLY, THE SYSTEM MUST WITHSTAND AN ELECTRIC HI-POT TEST OF 3000 VOLTS AC FOR 10 SECONDS BETWEEN ADJACENT POWER CIRCUITS AND ALSO BETWEEN THE POWER TERMINALS AND SHIELD.
 4. ELECTRIC VEHICLE CHARGING AND OTHER HEAVY DUTY CYCLE APPLICATIONS CARRYING >25A REQUIRE THE FOLLOWING:
 - MIN. 5.0 MM² COPPER CONDUCTORS.
 - TERMINAL TO CONDUCTOR INTERFACE RESISTANCE <2.0 MILLIOHMS.
 - SOLDERED CRIMPS ARE RECOMMENDED.
 - TERMINAL TEMPERATURES NEED TO BE MEASURED IN THE VEHICLE APPLICATION TO ENSURE T-RISE OVER AMBIENT IS <35°C AT MAX. STEADY STATE CURRENT.
 5. MINIMUM CREEPAGE DISTANCE: 15.68MM
 - ASSESSED PER EC60664 WITH POLLUTION DEGREE: 2 OR 3, WHEN CONNECTOR IS FULLY MATED
 - CREEPAGE PATH: BACK OF MALE POWER TERMINAL IN CAVITY 1 OR 2 TO BACK OF MALE POWER TERMINAL IN CAVITY 3 OR 4 (OR VICE VERSA) IN MALE INNER CONNECTOR
 6. PARTS MUST BE FREE OF DUST, CARDBOARD FIBERS OR ANY PARTICULATE MATTER THAT MAY CAUSE FIT OR FUNCTION CONCERNS.
 7. PARTS MUST BE APPROPRIATELY PACKAGED TO AVOID ANY DAMAGE DURING SHIPPING OR HANDLING. THE SHIPPING CONTAINER MUST BE LINED WITH PLASTIC LINERS. BAGS OR LINERS MUST BE SEALED TO AVOID FOREIGN MATTER.
 8. WIRING SUPPLIER MUST VERIFY AND COMPLETE CABLE ASSEMBLY VALIDATION PER CUSTOMER REQUIREMENTS. THIS WOULD INCLUDE CRIMP VALIDATION STUDIES FOR SELECTED CABLE & TERMINAL COMBINATIONS.
 9. FOR APPLICATION DATA SEE THE INDIVIDUAL APPLICATION DRAWINGS.
 10. PARTS MEET THE PERFORMANCE REQUIREMENTS OF SAE/USCAR-2 R6, SAE/USCAR-37 AUG 2008, FOR THE FOLLOWING CLASSIFICATIONS:

TEMPERATURE CLASS 3 (-40°C TO 125°C)
VIBRATION CLASS I (ON BODY OR CHASSIS)
SEALING CLASS 3 (P/V LEAK/ SUBMERSION/ HIGH PRESSURE SPRAY)
 11. HIGH VOLTAGE 280 TERMINAL-CONNECTOR EXTRACTION FORCE (PRIMARY LOCK ONLY) IS ≥20N (FOR REFERENCE ONLY)
 12. SIGNAL 0.64MM TERMINAL-CONNECTOR EXTRACTION FORCE (PRIMARY LOCK ONLY) IS ≥30N (FOR REFERENCE ONLY)
 13. CAUTION: INNER CONNECTOR ASSEMBLIES ARE MODULAR AND CAN MATE TO MULTIPLE HEADER ASSEMBLIES SHOWN ON TAXI'S 3300187 AND TAXI16786. INDEXING MUST BE VERIFIED WHEN MULTIPLE PARTS WITHIN THIS CONNECTOR FAMILY ARE USED. PLEASE SEE INDIVIDUAL APPLICATION DRAWING FOR MATING PART DETAILS.
 14. REFERENCE MANUAL 33357995 FOR ASSEMBLY/DISASSEMBLY INFORMATION.

35149739	01	AB	104	35132017	33299801
35149738	01	AB	103	35132016	33299801
35149737	01	AB	102	35132015	33299801
35099976	01	AB	101	35132013	33299801
PART NO	REV	N/P	TYPE	INNER CONNECTOR	ISL SECONDARY LOCK

DIMENSIONAL RANGE (MM)		CHART E1	
FROM	TO		
> 0	> 20	> 70	> 100
> 20	> 30	> 100	> 150
> 30	> 70	> 150	> 200
> 70	> 100	> 200	> 250
> 100	> 150	> 250	> 300
> 150	> 200	> 250	> 300
> 200	> 250	> 300	> 400
TOLERANCE UNLESS OTHERWISE SPECIFIED			
±0.15	±0.2	±0.3	±0.4
±0.5	±0.6	±0.8	±1
ANGULAR TOLERANCE ±2°			

A LINE DRAWING THROUGH A PART NUMBER INDICATES THAT PHYSICAL PARTS ARE NOT AVAILABLE FOR ORDERING.

PART NUMBERS THAT DO NOT HAVE A LINE PRESENT INDICATE THAT PHYSICAL PARTS ARE AVAILABLE FOR ORDERING.

CONTACT APPLIC SALES TO ASSURE AVAILABILITY OF PARTS.

DWG TYPE

PART DRAWING

STYLE

VOLUME (CM³)

DISTR CODE

UNLESS OTHERWISE SPECIFIED

THIS DOCUMENT IS IN ACCORDANCE WITH ASME Y14.5M-1994 AS AMENDED BY THE 2M AND 3M DIMENSIONING AND TOLERANCING ADDENDUM 2001. SEPARATE PATTERNS OF DIMENSIONS MAY BE OBTAINED SEPARATELY REGARDLESS OF DATUM REFERENCES.

ALL DIMENSIONS ARE IN MILLIMETERS

REFERENCE

<h1 style="text-align: center;">• A P T I V •</h1> <p style="text-align: center;">CONNECTION SYSTEMS</p> <p style="text-align: center;">WARREN, OH</p> <p style="text-align: center;">COPYRIGHT 2018 ACTIV. ALL RIGHTS RESERVED.</p> <p style="text-align: center;">THIS DRAWING IS THE PROPERTY OF ACTIV AND CONTAINING ACTIV CONFIDENTIAL INFORMATION. THE REPRODUCTION, DISTRIBUTION AND UTILIZATION OF THIS DOCUMENT OR ITS RELATED CAD DATA, AS WELL AS COMMUNICATION OF ANY CONTENT TO OTHERS, WITHOUT EXPRESS AUTHORIZATION, IS PROHIBITED.</p>							
DR						DATE	
APVD1: A. GARCIA CABELLO						27FE18	
APVD2: A. GARCIA CABELLO						27FE18	
APVD3: THOMAS MATHEWS						28FE18	
APVD4							
APVD5							
SUBSTANCES OF CONCERN AND RECYCLED CONTENT PER ACTIV 10949001							
MATERIAL SEE CHART							
DRAWING NAME: TAXI ASM CONN B 0.64 HVIL M/P Z80							
DRAWING NUMBER: 33314144							
A10	SCALE	FRAME	SHEET	N	STO	REV	NP
SZ	4:1	1 OF 1	1 OF 1		R	03	

Mouser Electronics

Authorized Distributor

Click to View Pricing, Inventory, Delivery & Lifecycle Information:

[Aptiv:](#)
[35099976](#)