

TYPE 102
SAME AS TYPE 101
EXCEPT AS SHOWN

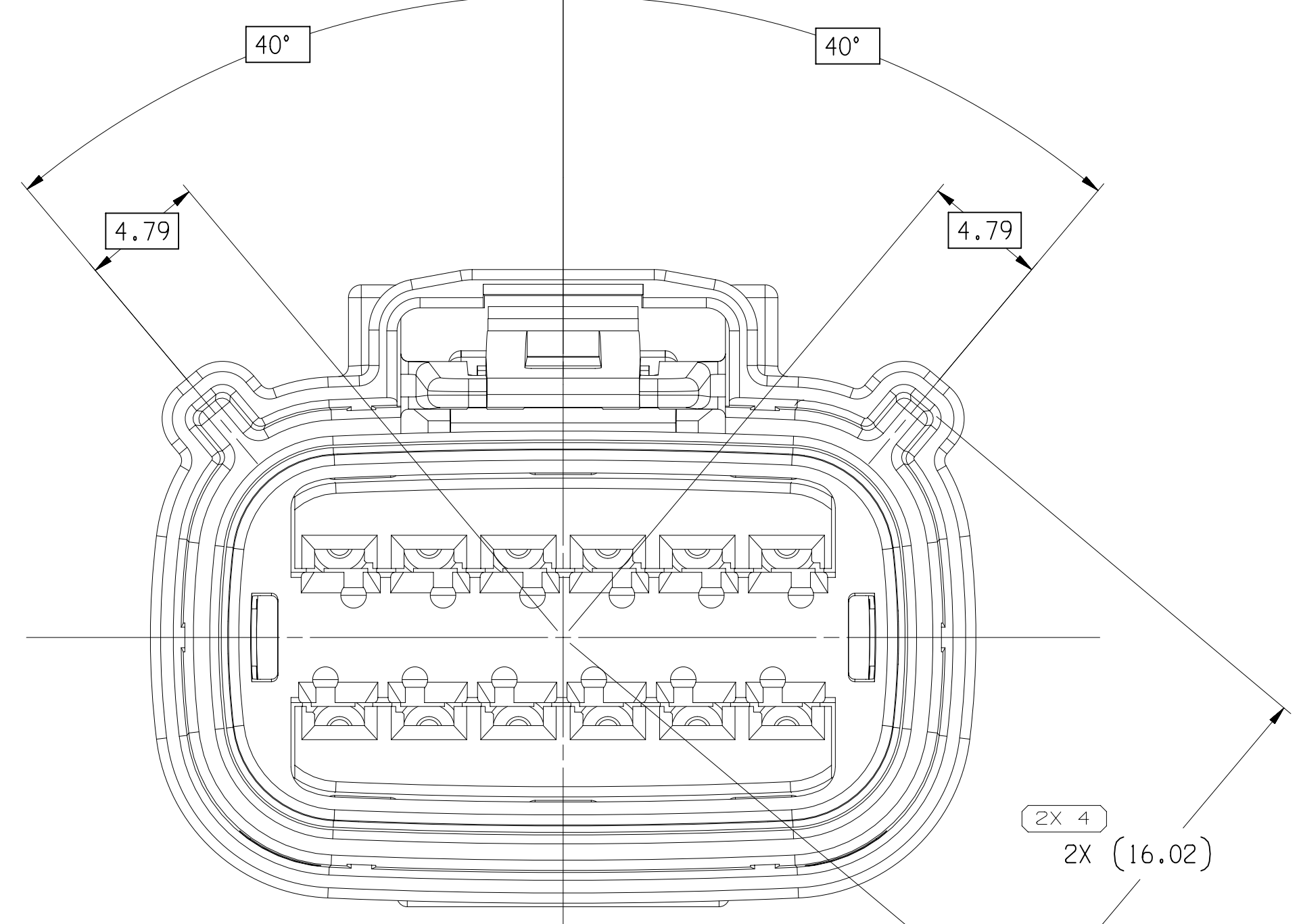

TYPE 105
SAME AS TYPE 101
EXCEPT AS SHOWN

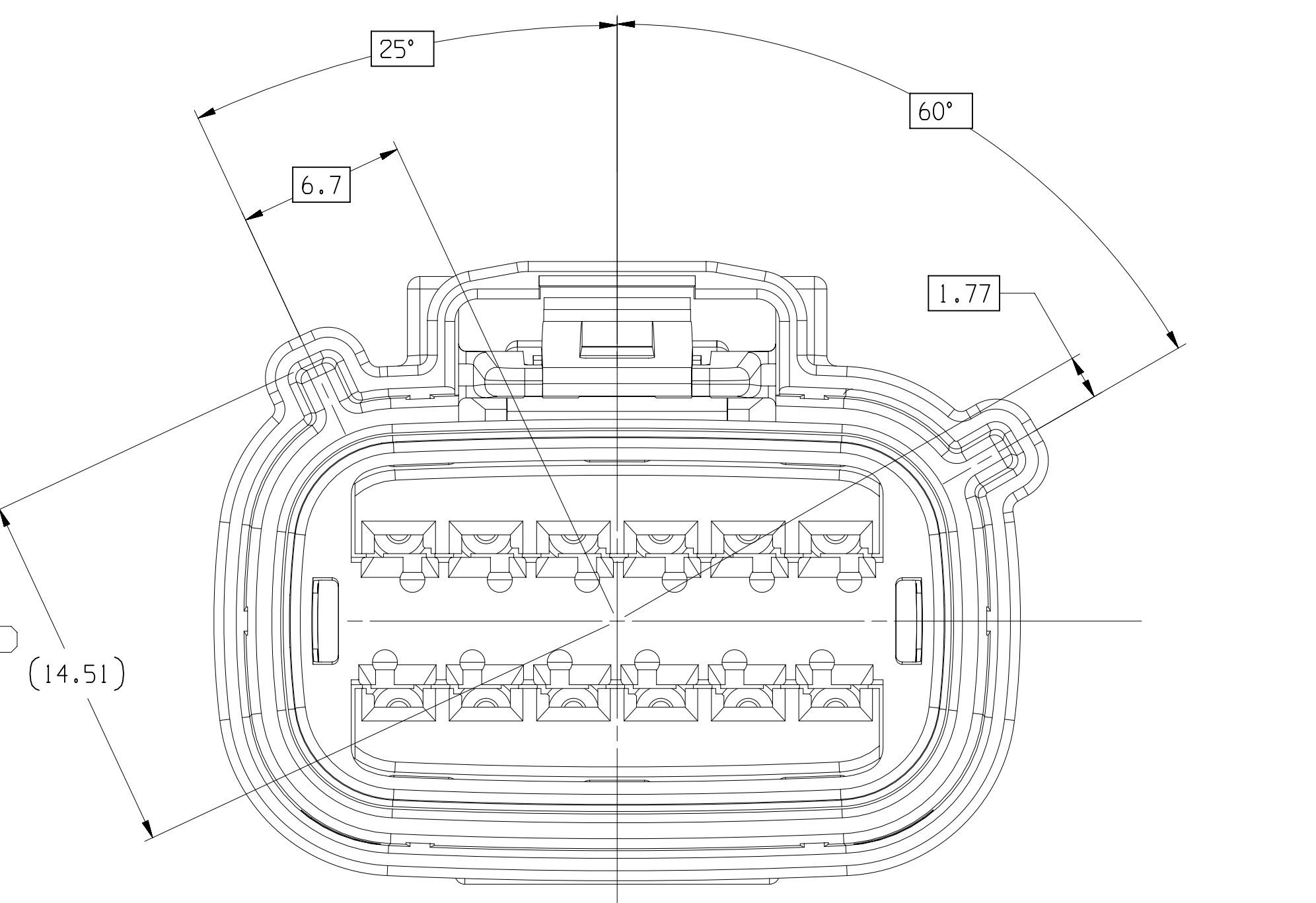

TYPE 103
SAME AS TYPE 101
EXCEPT AS SHOWN

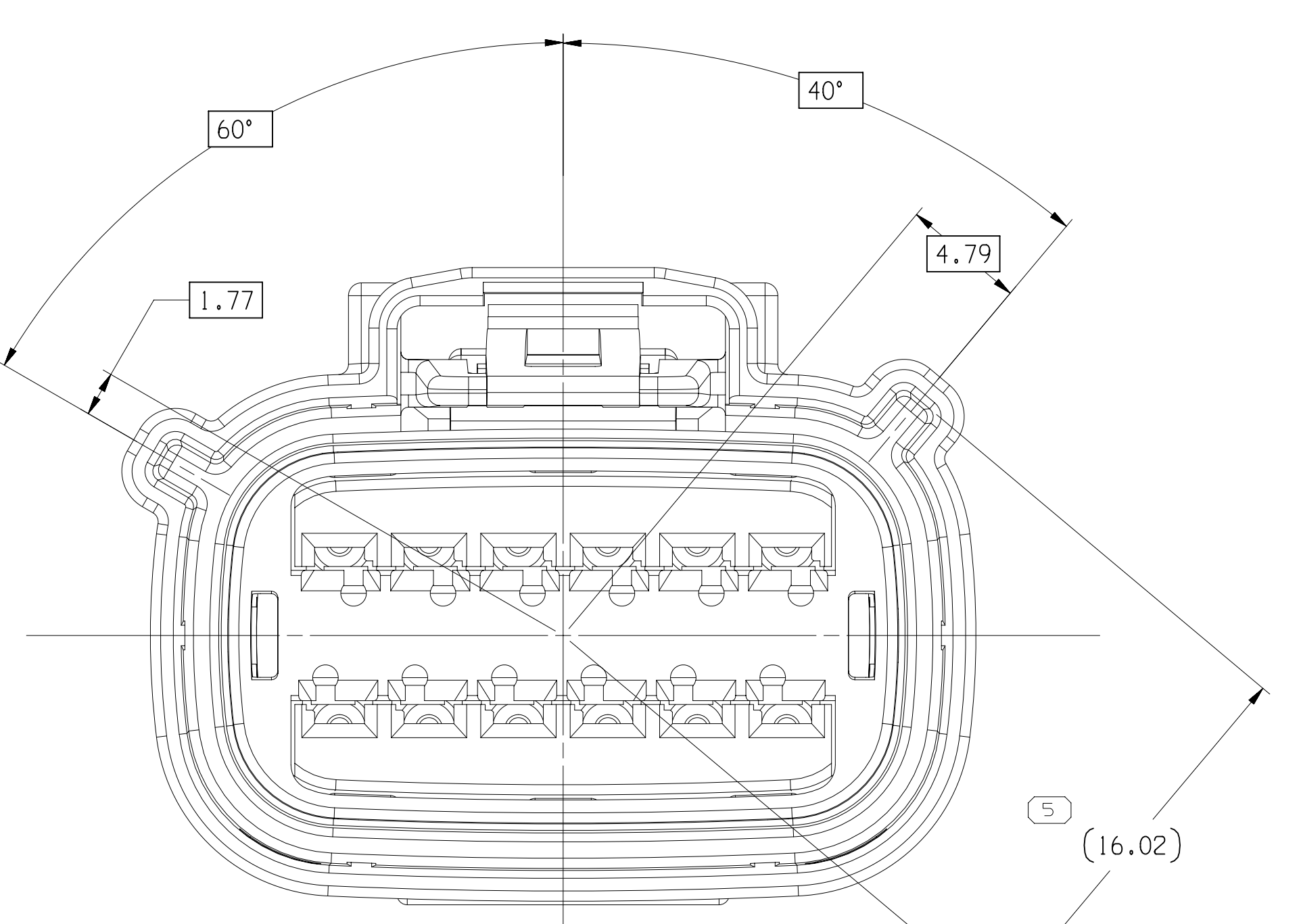

TYPE 106
SAME AS TYPE 101
EXCEPT AS SHOWN

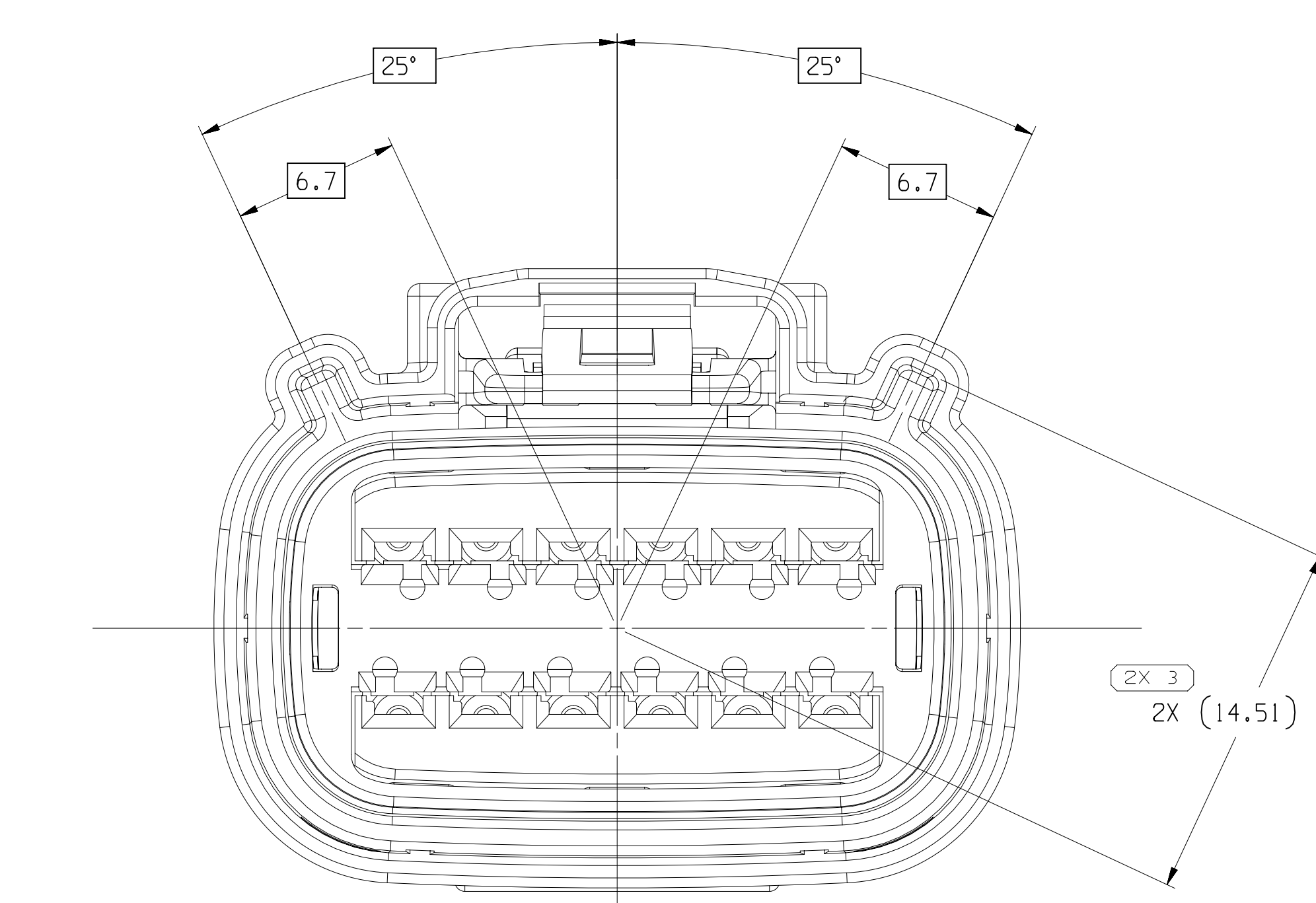

TYPE 104
SAME AS TYPE 101
EXCEPT AS SHOWN

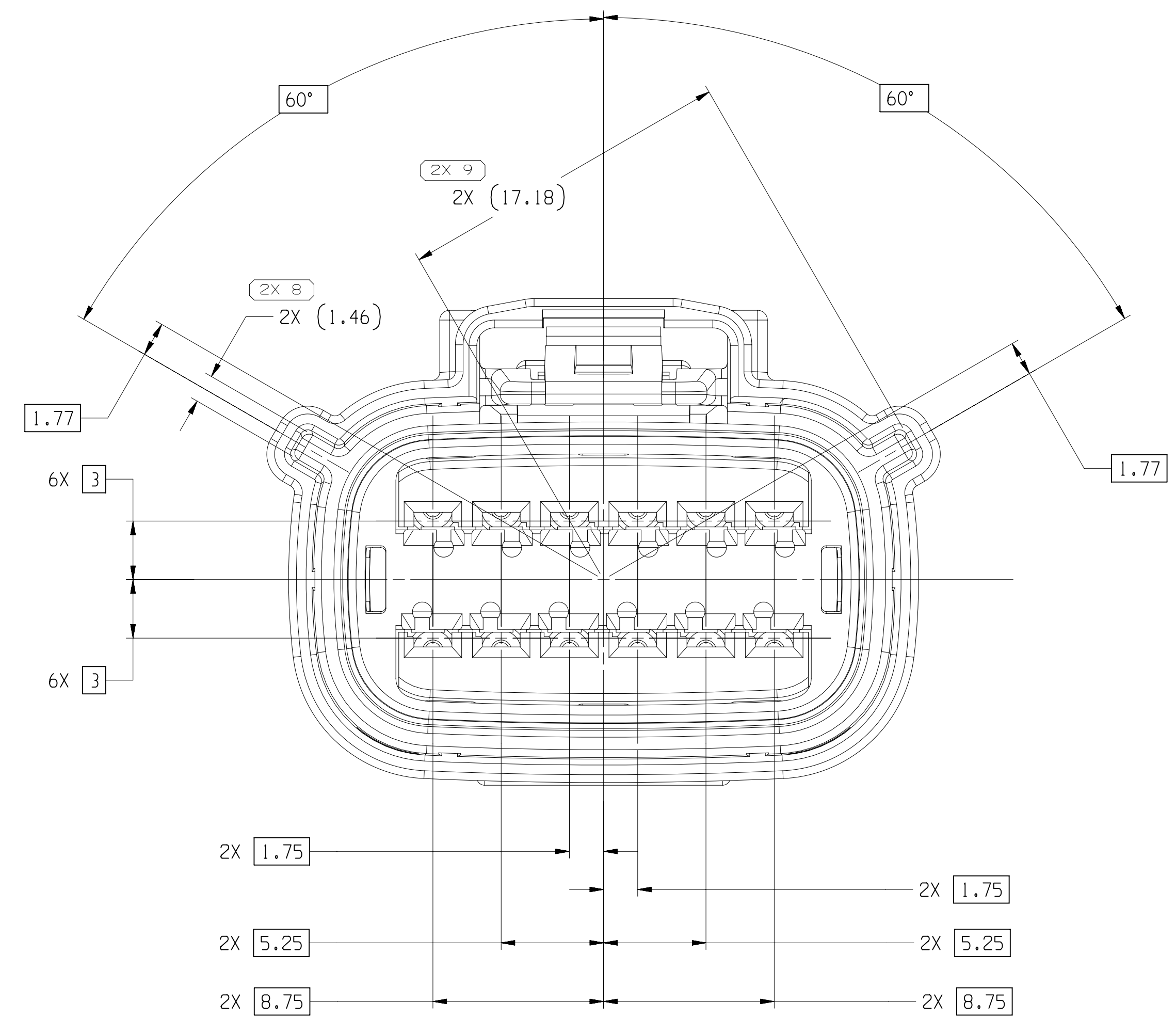
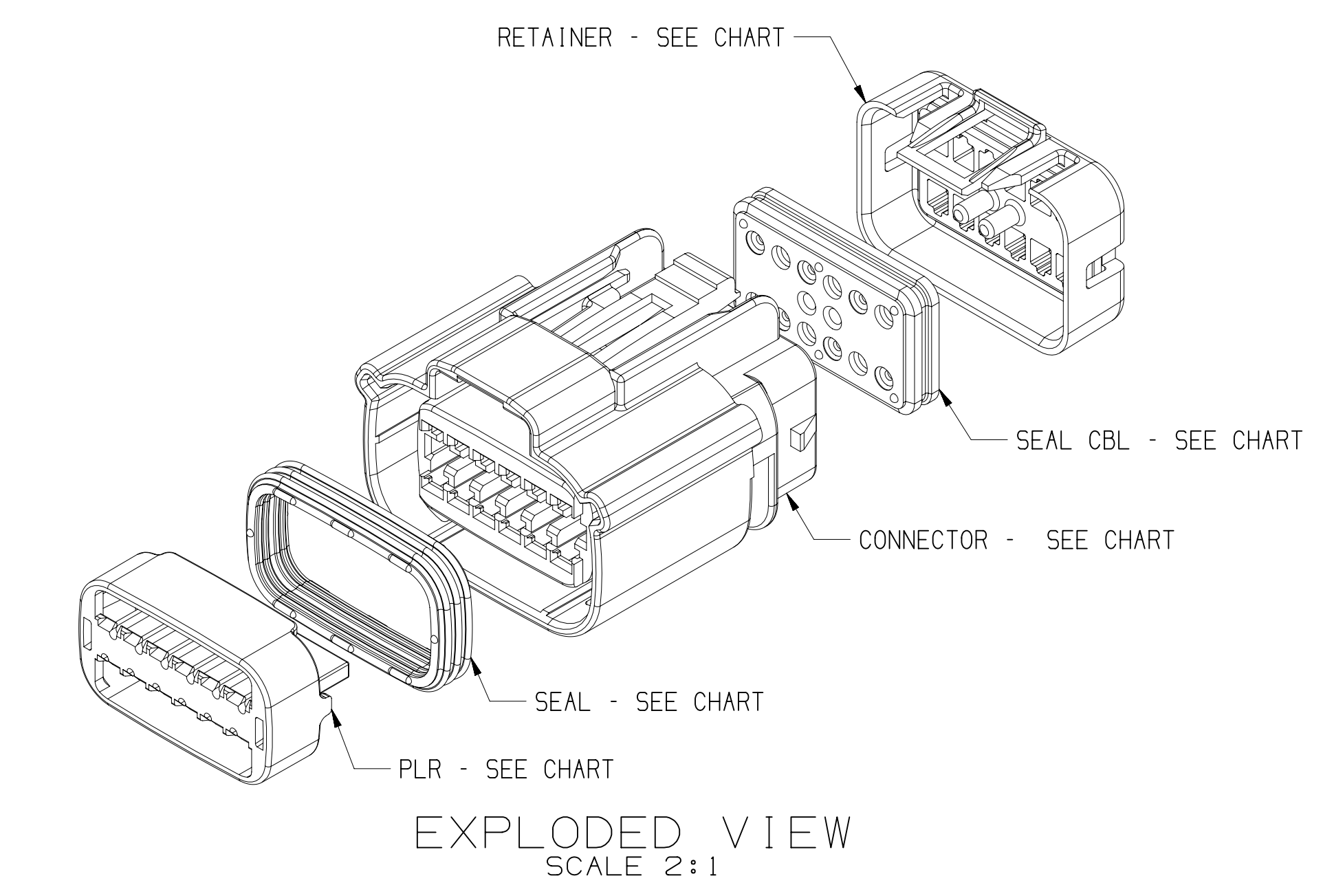
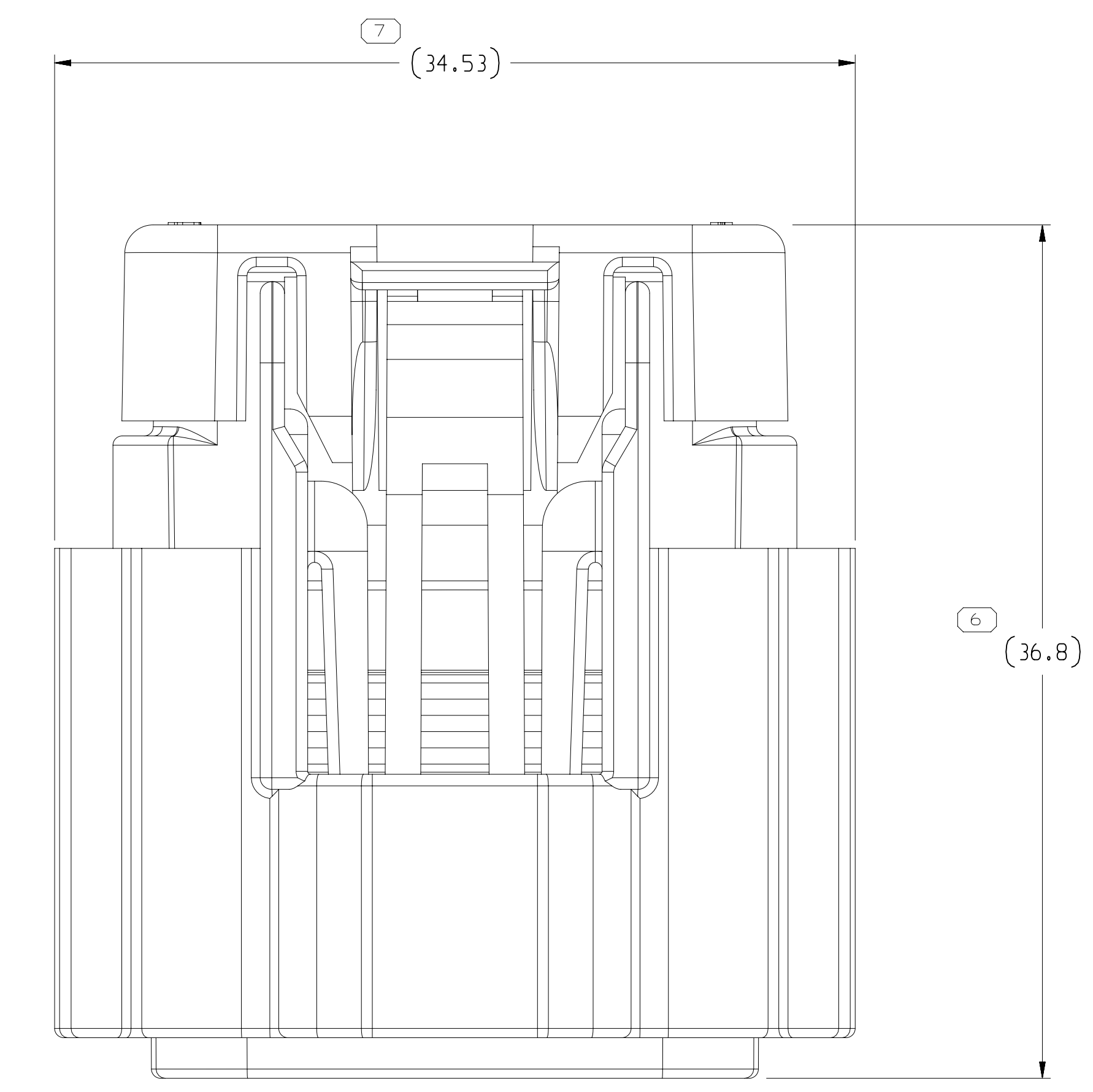

TYPE 101

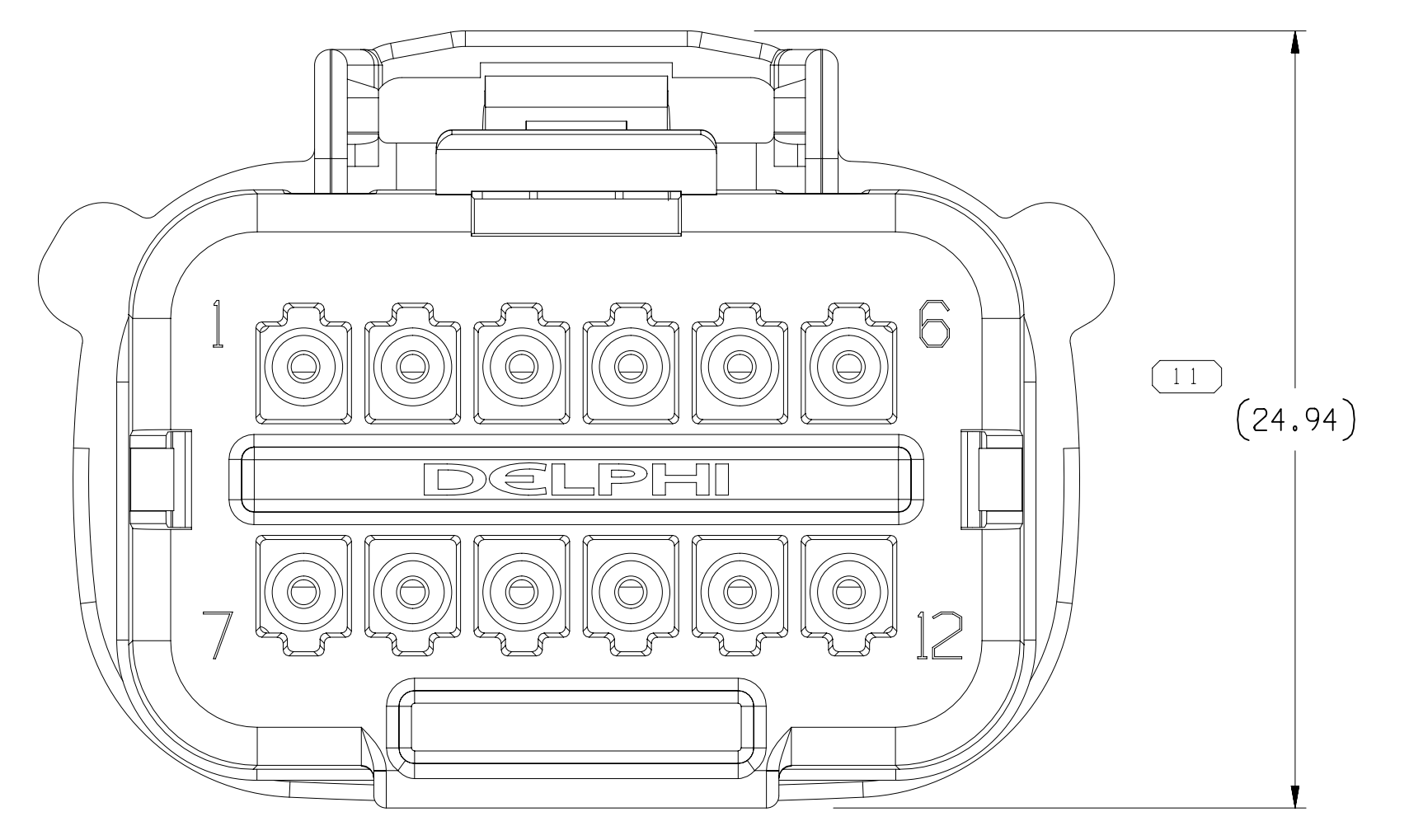
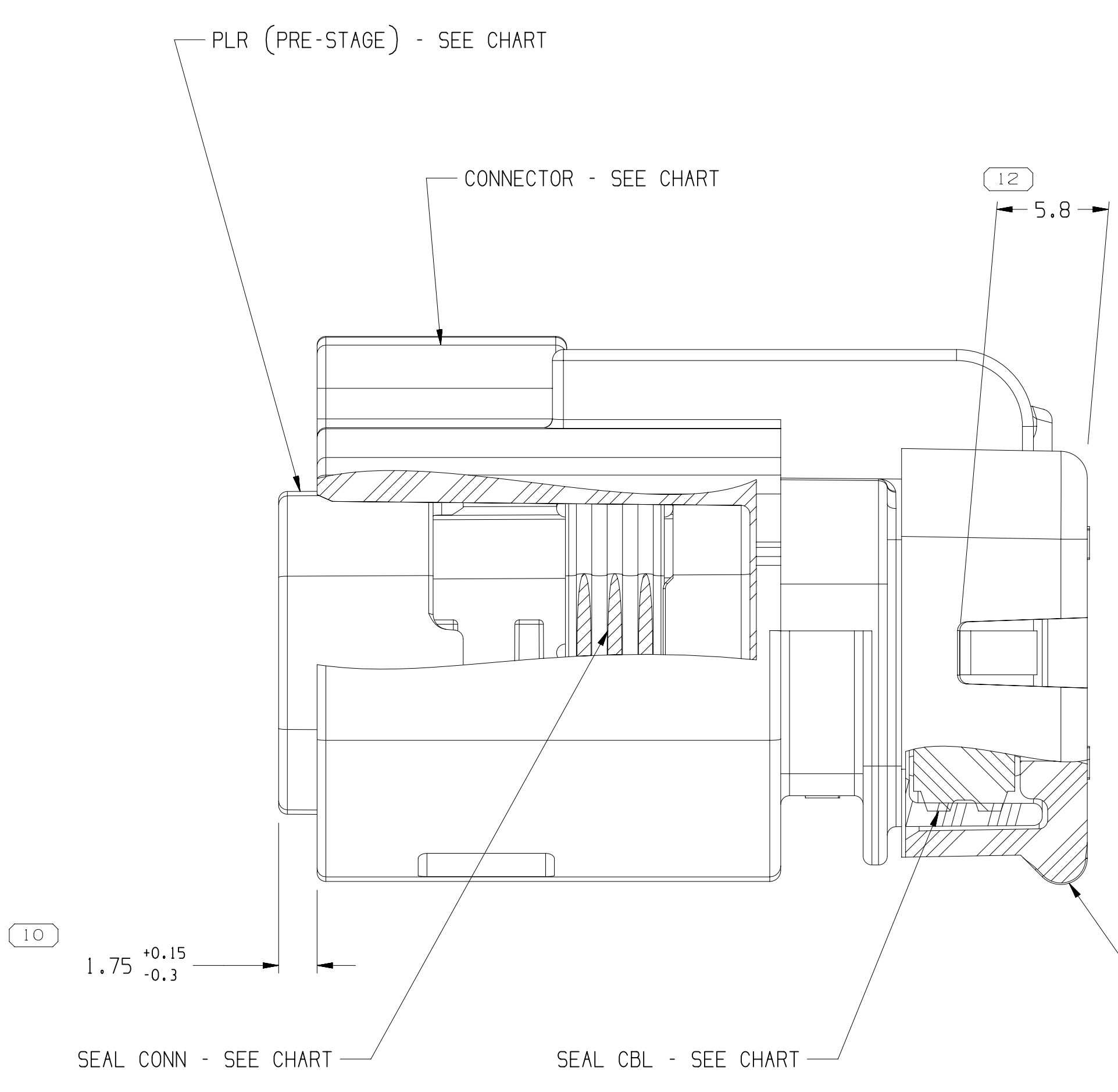

NOTES

- UNLESS OTHERWISE SPECIFIED AND/OR INDICATED:
DIMENSIONS ARE TO FACE OF VIEW SHOWN AND AUTOMATICALLY ROUNDED BY COMPUTER FOR INSPECTION (SEE MATH MODEL FOR PRECISE DIMENSIONS). FOR ALL OTHER DIMENSIONS NOT SHOWN BUT REQUIRED FOR TOOL BUILD, SEE MATH MODEL FOR PRECISE TOOL PATH DATA.
- PART IS MANUFACTURED TO GEOMETRIC TOLERANCES. CENTERLINE DIMENSIONS ARE FOR REFERENCE ONLY.
- SEALING CODE 4 - DESIGN WILL MEET REQUIREMENTS OF SAE/USCAR-2 CONNECTOR SYSTEM ENVIRONMENTAL TEST FLOWCHART (PRESSURE/VACUUM AND SUBMERSION).
- THIS PRODUCT IS NOT CATEGORIZED AS AN APPEARANCE ITEM. MINOR IMPERFECTIONS INCLUDING, BUT NOT LIMITED TO, FLOW MARKS, COLOR BLEMMISHES, DATE VESTIGES, AND SOFT FLASH THAT DO NOT AFFECT THE FIT, FORM, OR FUNCTION OF THE PART ARE PERMISSIBLE PER ENP-4-1.0S.01.EN.
- FOR APPLICATION DATA SEE THE INDIVIDUAL APPLICATION DRAWINGS.
- ASSEMBLY TO BE USED WITH APPROPRIATE APTIV HOLDER DESIGN.
- ASSEMBLY TO BE PROCESSED USING APTIV CONNECTION SYSTEMS BEST PRACTICE METHODS AND/OR CONNECTOR ASSEMBLY INSTRUCTIONS AND APPLICABLE REPAIR PROCEDURES.
- BEFORE TERMINAL ASSEMBLY: VERIFY THAT PLR IS IN THE PRE-STAGE POSITION ON THE CONNECTOR. IF NOT; RETURN PLR TO PRE-STAGE POSITION.
- FOR DIFFERENT PUNCH PATTERNS (IF AVAILABLE) SEE SHEET 2
- FOR ASSEMBLIES WITH CPA SEE DRAWING 155146.32

15532143	03	AC	106	15514618	15514640	13968655	15521155	15514637	F
15532142	03	AC	105	15514615	15514640	13968655	15521155	15514637	E
15532141	03	AC	104	15514613	15514640	13968655	15521155	15514637	D
15532140	03	AC	103	15514610	15514640	13968655	15521155	15514637	C
15532139	03	AC	102	15514608	15514640	13968655	15521155	15514637	B
15532138	03	AC	101	15514606	15514640	13968655	15521155	15514637	A
PART NO	REV	N/P	TYPE	CONNECTOR	PLR	SEAL CONN	SEAL CBL	RETAINER	USCAR

DRAWING NUMBER
15532137

SIZE: A1x3
SCALE: 5:1
FRAME NO: 2 OF 2
SHEET NO: 1 OF 2
REV: 08

SYMBOL DEFINITION			
A DIMENSION WITHOUT AN INSPECTION REPORT SYMBOL DOES NOT REQUIRE INSPECTION. IT MAY BE CONTROLLED ON THE INDIVIDUAL COMPONENT DRAWING.			
TOTAL NO. OF INSPECTIONS REQUIRED	16	MISSING SYMBOLS	
LAST NO. USED	12	NO MISSING SYMBOL NUMBER	

DWG STATUS				ZONE		REVISION HISTORY		AUTH		DR	
DATE	STG	REV	N/P	CHK							
30MY13	R	01	-	-		ALL PARTS - RELEASED PART DRAWING		422469	JTV	JTV	AMS
13AP16	R	02	-	-		ALL PARTS - UPDATED CONN. PLR, SEAL CONN. SEAL CBL & RETAINER TO LATEST REVISION		432697	ABH	DGL	DGL
05MY16	R	03	-	-		ALL PARTS - CORRECTED CBL SEAL 15521155 INSTEAD OF 15521555		432974	ABH	DGL	DGL
21JL16	R	04	-	-		ALL PARTS - PSD WAS 10 AND ADDED DIM#12		433754	EV	EV	DGL
26OC16	R	05	-	-		ALL PARTS - RELOCATED DIM#12 AND DIM#10 WAS 1.75 ±0.15		434727	KYT	DAT	DAT
21FE17	R	06	-	-		15532139 - UPDATED PART AVAILABILITY: ALL PARTS - ADDED ASSEMBLY REQUIREMENT NOTES		435803	NRW	DGL	DGL
19OC17	R	07	-	-		ALL PARTS - ADDED "SHT 1 OF 2"		438050	IMF	IMF	M,N
19JN19	R	08	-	-		ALL PARTS - ADDED "DIFFERENT PUNCH PATTERN CONFIGURATIONS" & "ASSEMBLIES WITH CPA" NOTES		443337	JLL	DSP	DSP

CONNECTION SYSTEMS
WARREN, MI
COPYRIGHT 2013 APTIV. ALL RIGHTS RESERVED.

THIS DRAWING IS THE PROPERTY OF APTIV AND CONTAINS APTIV CONFIDENTIAL INFORMATION. THE REPRODUCTION, DISTRIBUTION AND UTILIZATION OF THIS DOCUMENT OR ITS RELATED CAD DATA, AS WELL AS COMMUNICATION OF ANY CONTENT TO OTHERS, WITHOUT EXPRESS AUTHORIZATION, IS PROHIBITED.

DATE: 11/01/2019
BY: JTV
CHECKED: JTV
APPROVED: JTV

REVISIONS:
REV 01: 30MY13
REV 02: 13AP16
REV 03: 05MY16
REV 04: 21JL16
REV 05: 26OC16
REV 06: 21FE17
REV 07: 19OC17
REV 08: 19JN19

DRAWING NUMBER: 15532137
SCALE: 5:1
FRAME NO: 2 OF 2
SHEET NO: 1 OF 2
REV: 08

12235137

Mouser Electronics

Authorized Distributor

Click to View Pricing, Inventory, Delivery & Lifecycle Information:

[Aptiv:](#)

[15532139](#)