

TYPE B
SAME AS TYPE A
EXCEPT AS SHOWN

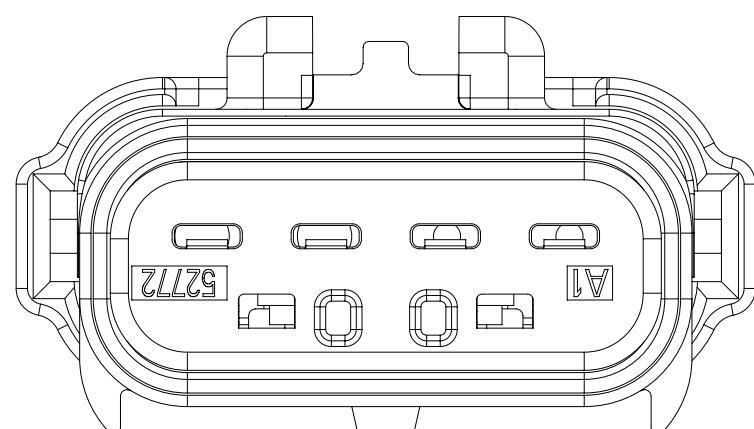

TYPE E
SAME AS TYPE A
EXCEPT AS SHOWN

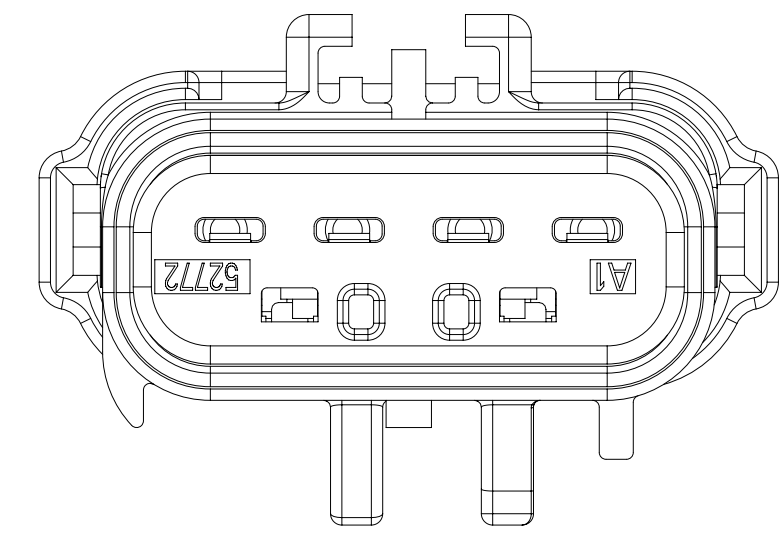

TYPE C
SAME AS TYPE A
EXCEPT AS SHOWN

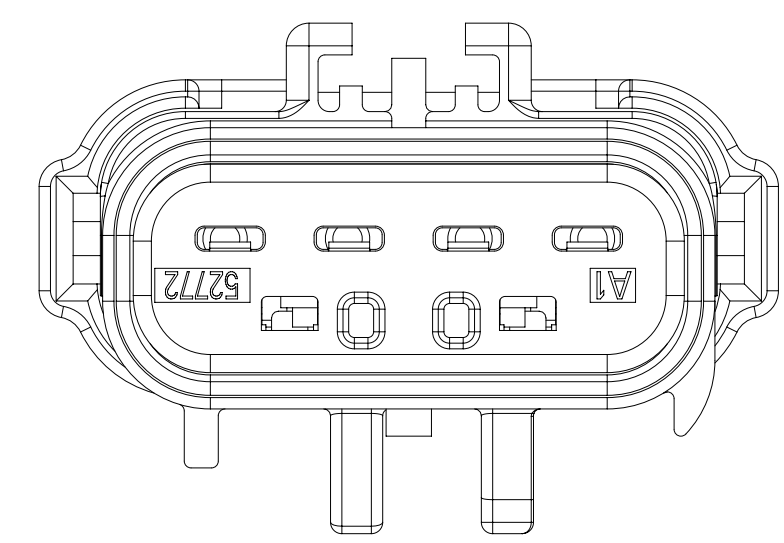

TYPE D
SAME AS TYPE A
EXCEPT AS SHOWN

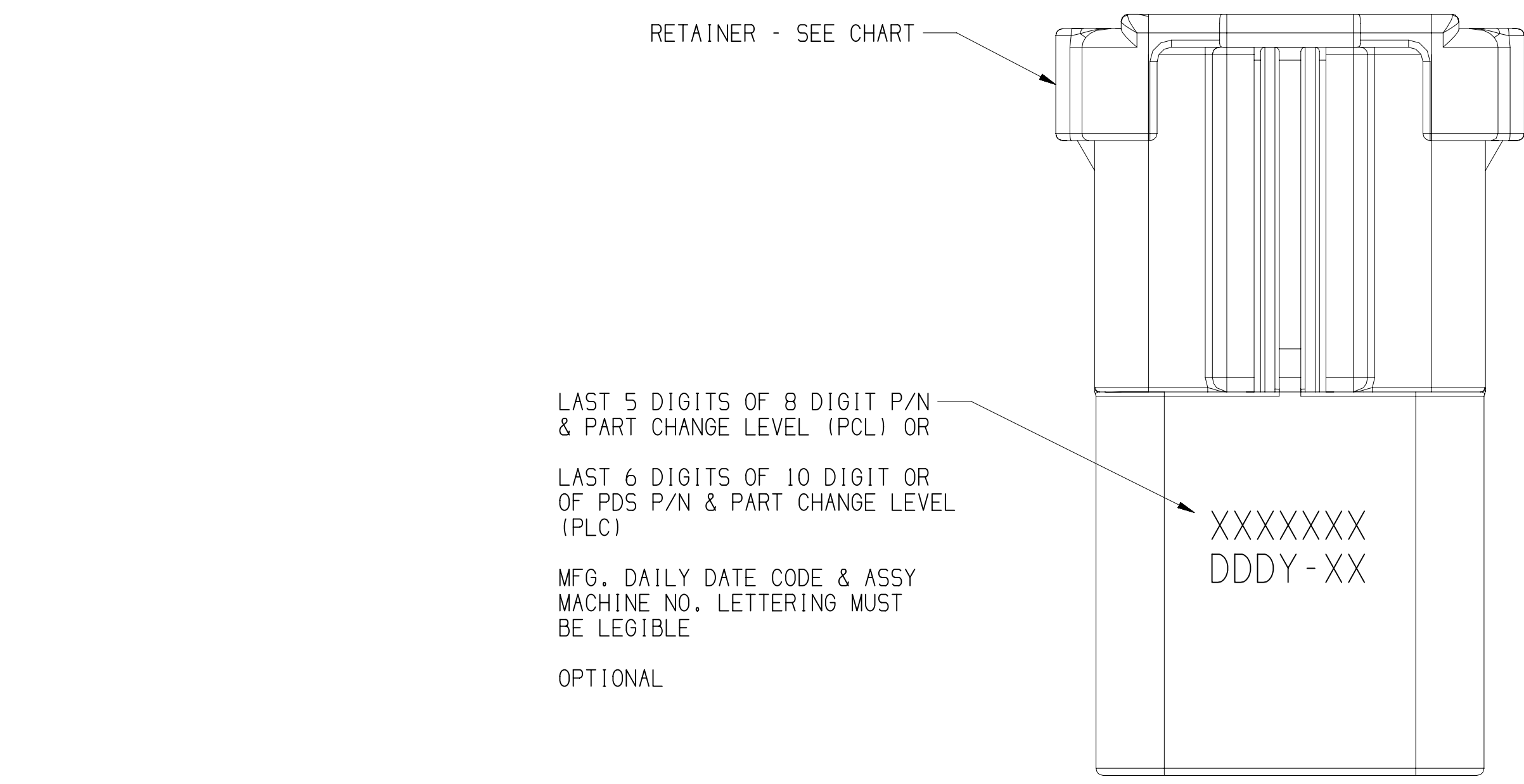

RETAINER - SEE CHART
LAST 5 DIGITS OF 8 DIGIT P/N
& PART CHANGE LEVEL (PLCI) OR
LAST 6 DIGITS OF 10 DIGIT OR
OF PDS P/N & PART CHANGE LEVEL
(PLCI)
MFG. DAILY DATE CODE & ASSY
MACHINE NO. LETTERING MUST
BE LEGIBLE
OPTIONAL

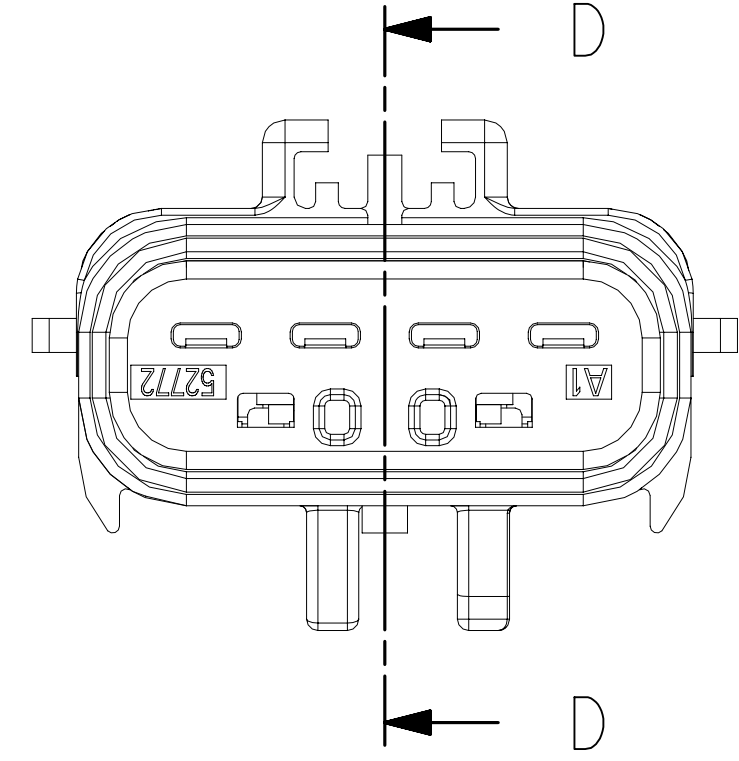

AUXILIAR FRONT VIEW
TYPE A - UNSEALED ASSEMBLY

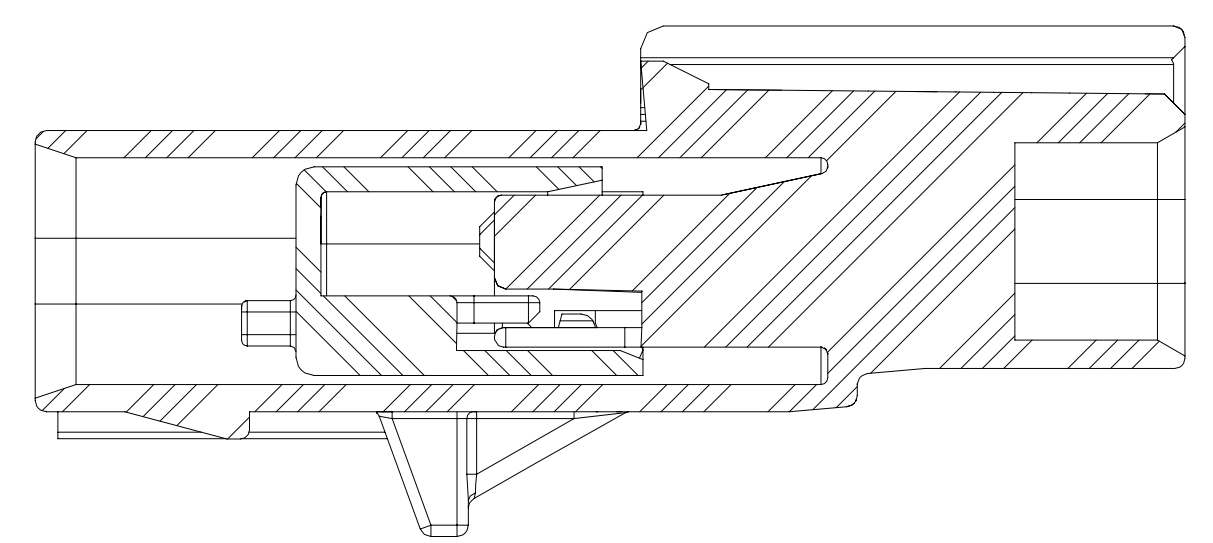

SECTION D-D

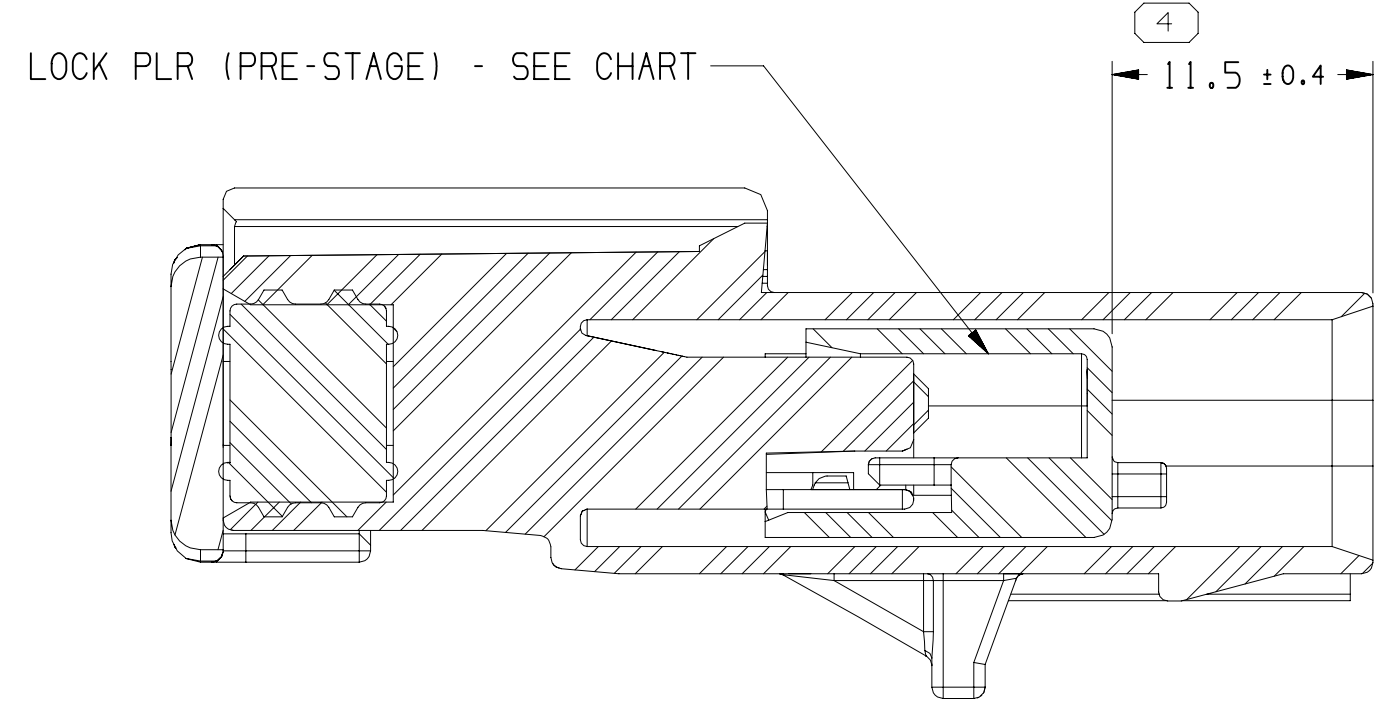
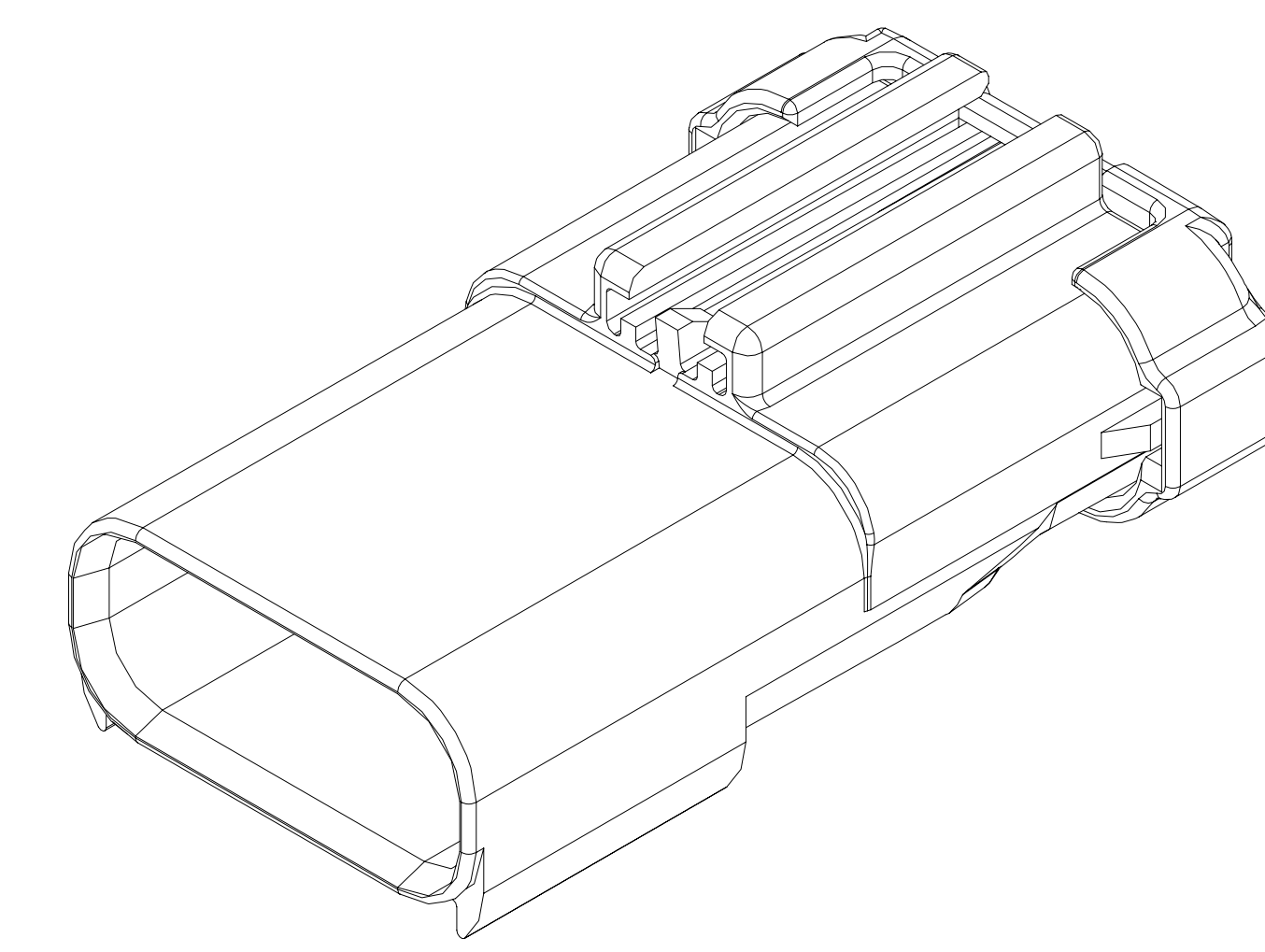

LOCK PLR (PRE-STAGE) - SEE CHART

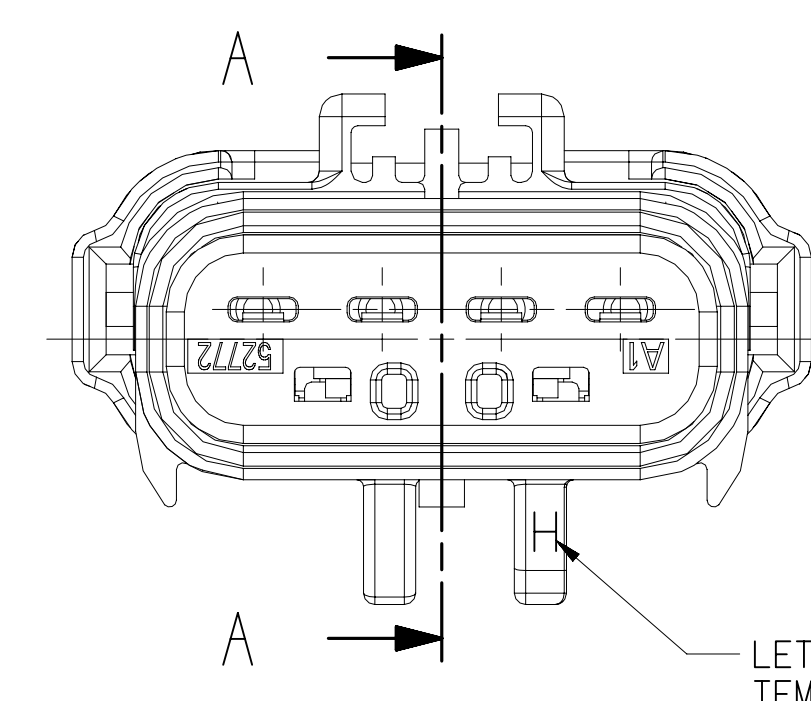

TYPE A - SEALED ASSEMBLY

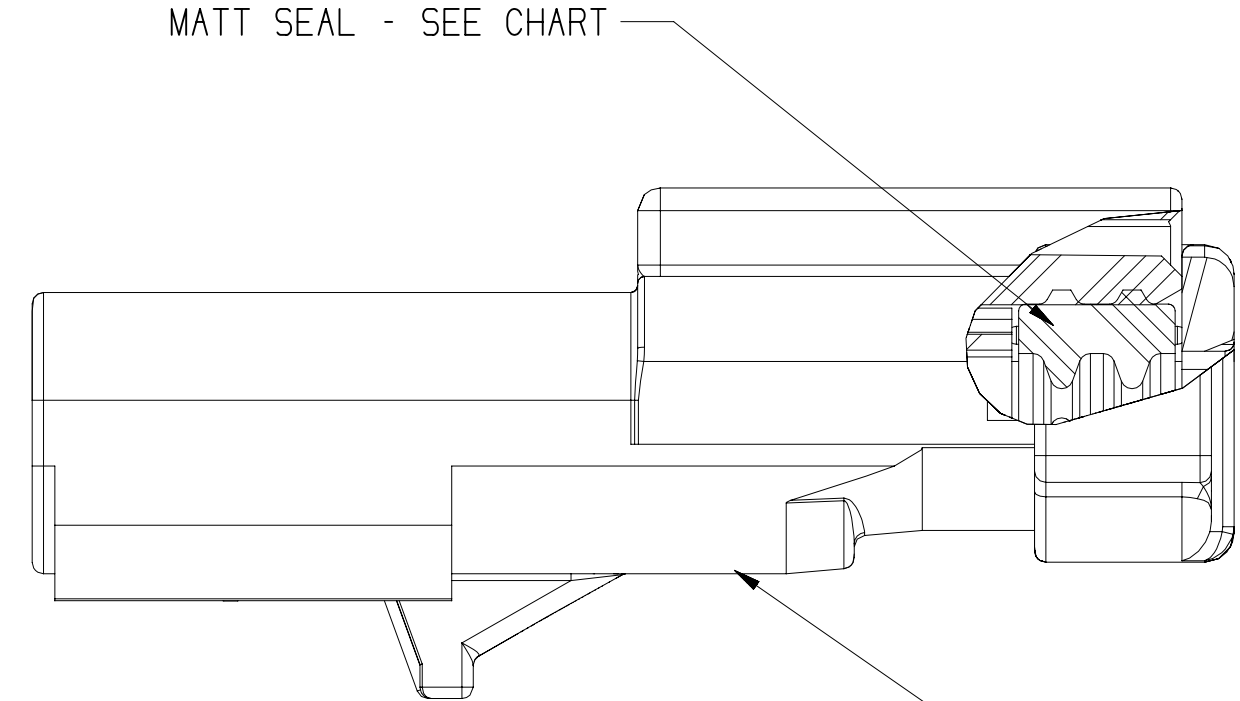

MATT SEAL - SEE CHART

CONNECTOR - SEE CHART

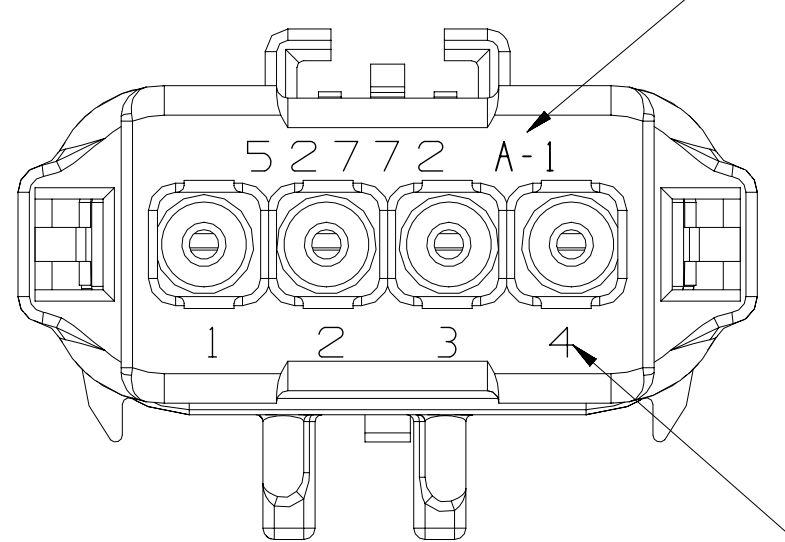

SEE NOTE #8

CIRCUIT NO.'S FOR
REFERENCE ONLY

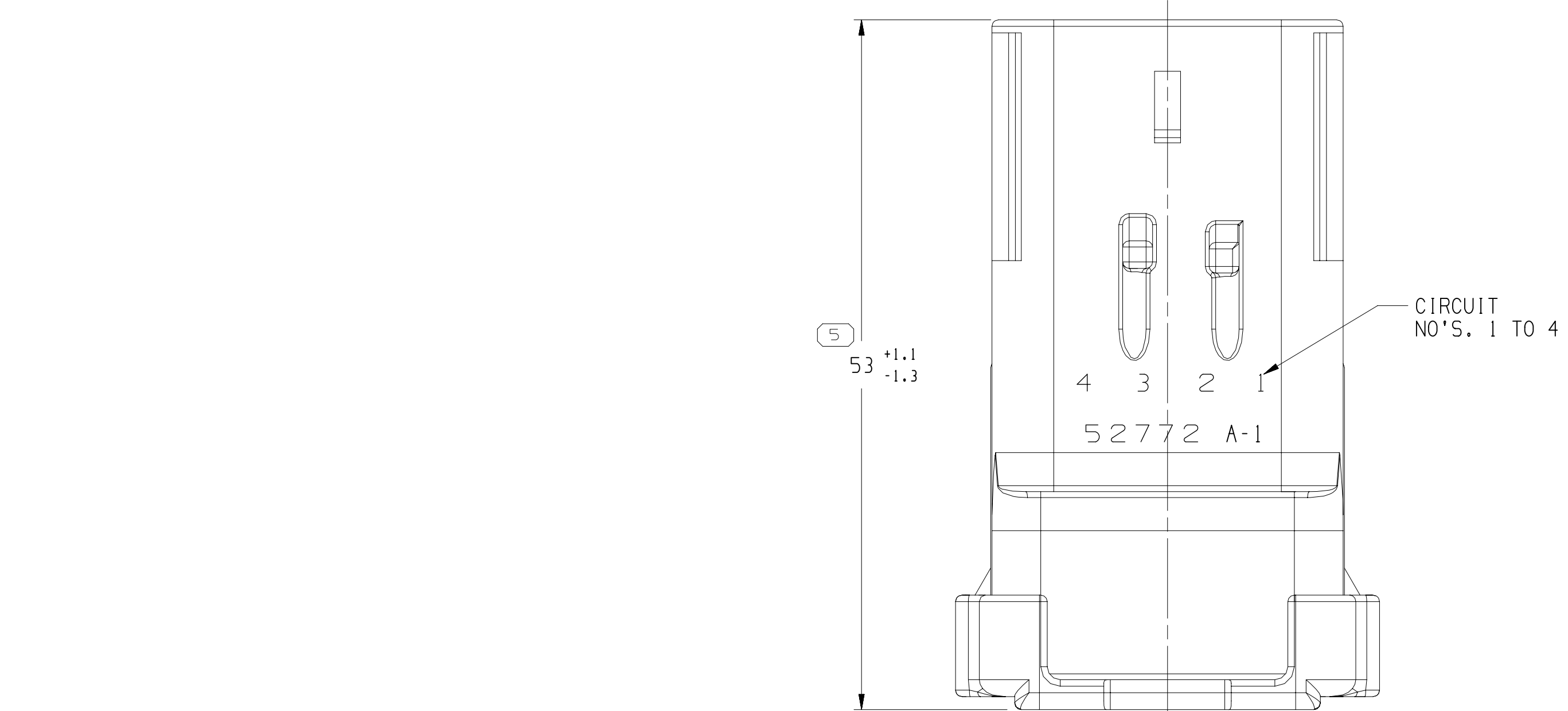

SECTION A-A

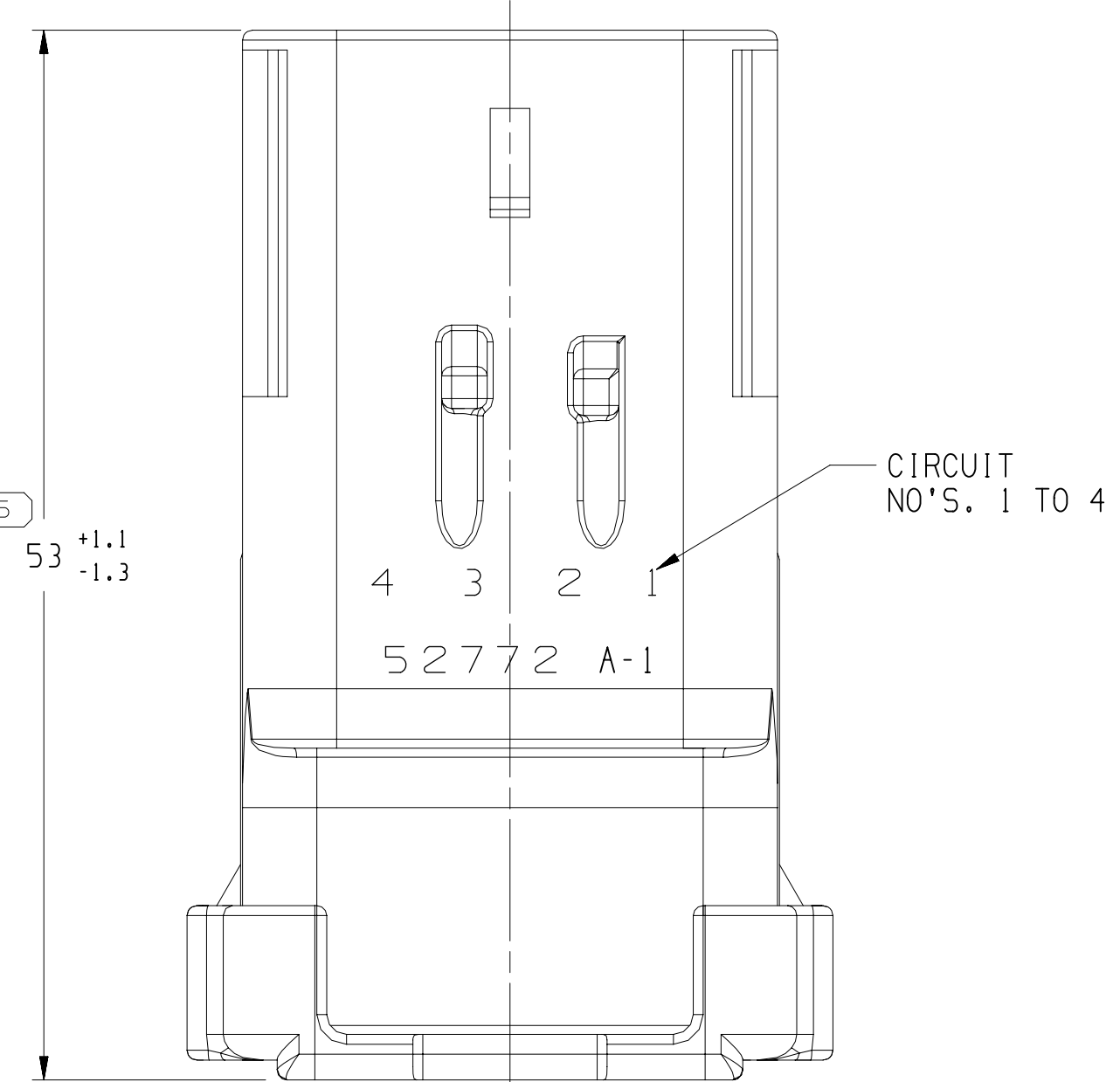

CIRCUIT
NO.'S. 1 TO 4

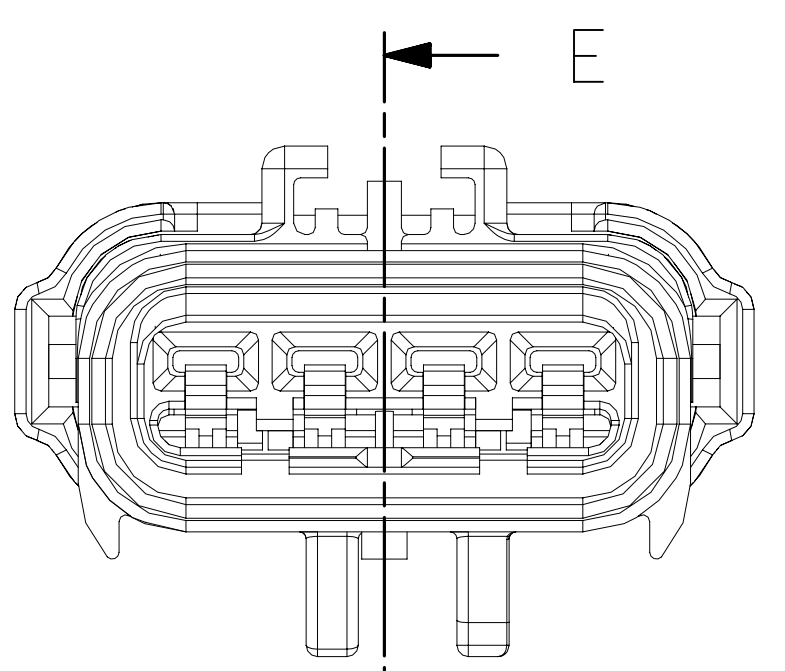

AUXILIAR FRONT VIEW
TYPE A - MATT SEAL W/O HOLES

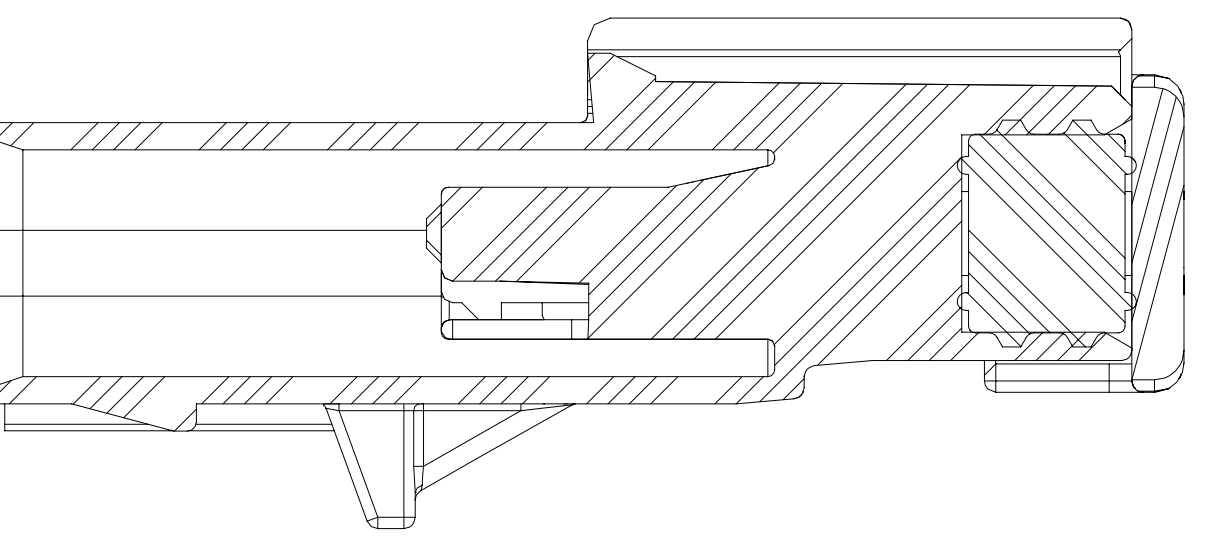

SECTION E-E

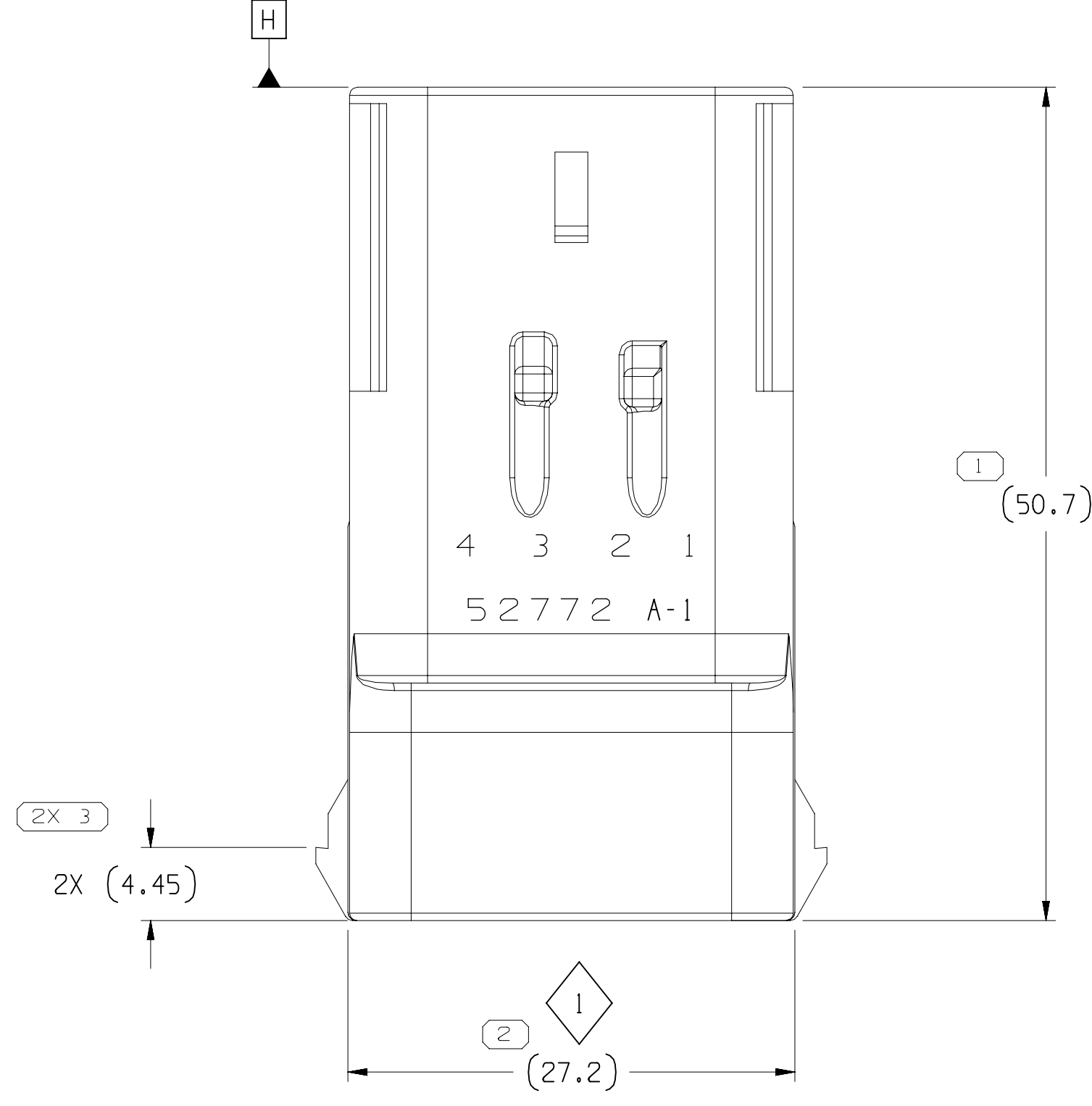

AUXILIAR BOTTOM VIEW

TYPE A - CONNECTOR VIEW
FOR REFERENCE ONLY
(SEE TAXI PART NO
15547327/C17002-MFG1)

DRAWING NUMBER
15498846
APR 15 2011
SCALE 3:1
FRAME NO. 2 OF 2
SHEET NO. 1 OF 1
REV. 1
NO. 04

3524366.3	01	-	E	-	-	-	-	35258904	55200440	15537459	-	35234778	-	15537435	3	O.D. 1.7-3.4	O.D. 3.1-4.09	-	
3504069.3	01	-	C	-	-	-	-	54200438	15537506	54200448	15537511	54200428	15537499	54200440	15537508	3	20,18,16,14,12 OR 10	-	
3504069.2	01	-	A	-	-	-	-	54200436	15537504	54200448	15537511	54200428	15537499	54200440	15537508	3	-	-	
33511426	01	AA	D	F825600	-	-	-	F825600	15537429	55200440	15537459	*55200439	15537433	55200438	15537435	4	-	-	
33511425	01	AA	C	F125600	-	-	-	F725600	15537427	55200440	15537459	*55200439	15537433	55200438	15537435	4	-	-	
33511418	01	AA	B	F25600	-	-	-	54200439	15537425	55200440	15537459	*55200439	15537433	55200438	15537435	4	20 TO 14	-	
33511410	01	AA	A	55200446	-	-	-	55200441	15537423	55200440	15537459	*55200439	15537433	55200438	15537435	4	-	-	
33511450	01	AA	B	F291210	F DU5T-14A594-AA	-	-	54200437	15537505	-	-	54200458	33504637	54200440	15537508	3	-	X	
33511413	01	AA	A	54200468	C 04759236AB	-	-	54200436	15537504	-	-	54200458	33504637	54200440	15537508	3	NO WIRES USED AS A PLUS	X	
33511412	01	AA	A	54200427	C 56042441	-	-	54200436	15537504	-	-	54200458	33504637	54200440	15537508	3	-	X	
33511411	01	AA	A	54200426	C 04759236	-	-	54200436	15537504	-	-	54200458	33504637	54200440	15537508	3	-	X	
33500102	01	AA	D	54200439	15537507	380	-	54200448	15537511	C17019-U	33185280	54200440	15537508	3	-	-	-		
13755836	01	AA	C	54200415	C 04707379	-	-	54200438	15537506	54200448	15537511	C17019-U	33185280	54200440	15537508	3	-	-	
13754761	01	AA	B	54200414	C 04707267	-	-	54200437	15537505	54200448	15537511	C17019-U	33185280	54200440	15537508	3	20,18,16,14,12 OR 10	-	
15489820	01	AA	A	54200413	C 04707266	-	-	54200436	15537504	54200448	15537511	C17019-U	33185280	54200440	15537508	3	-	-	
33511449	01	AA	D	56042424	C 56042179	-	-	54200439	15537507	54200448	15537511	-	-	54200440	15537508	3	-	-	
33500101	01	AA	D	54200408	C 56038055	-	-	54200439	15537507	54200448	15537511	-	-	-	-	3	-	-	
33500100	01	AA	C	54200407	C 56038194	-	-	54200438	15537506	54200448	15537511	-	-	-	-	3	-	-	
33500544	01	AA	B	54200406	N/A	-	-	54200437	15537505	54200448	15537511	-	-	-	-	3	22,20,18,16,14,12 OR 10	-	
33511417	01	AA	A	54200423	C 56042178	-	-	54200436	15537504	54200448	15537511	-	-	54200440	15537508	3	-	-	
33500099	01	AA	A	54200405	C 56038054	-	-	54200436	15537504	54200448	15537511	-	-	-	-	3	-	-	
PART NO. REV. N/P. TYPE																		MVL	
APR 15 2011																		CUSTOMER	
APR 15 2011																		MVL	
APR 15 2011																		APR 15 2011	
APR 15 2011																		MVL	
APR 15 2011																		APR 15 2011	
APR 15 2011																		MVL	
APR 15 2011																		APR 15 2011	
APR 15 2011																		MVL	
APR 15 2011																		APR 15 2011	
APR 15 2011																		MVL	
APR 15 2011																		APR 15 2011	
APR 15 2011																		MVL	
APR 15 2011																		APR 15 2011	
APR 15 2011																		MVL	
APR 15 2011																		APR 15 2011	
APR 15 2011																		MVL	
APR 15 2011																		APR 15 2011	
APR 15 2011																		MVL	
APR 15 2011																		APR 15 2011	
APR 15 2011																		MVL	
APR 15 2011																		APR 15 2011	
APR 15 2011																		MVL	
APR 15 2011																		APR 15 2011	
APR 15 2011																		MVL	
APR 15 2011																		APR 15 2011	
APR 15 2011																		MVL	
APR 15 2011																		APR 15 2011	
APR 15 2011																		MVL	
APR 15 2011																		APR 15 2011	
APR 15 2011																		MVL	
APR 15 2011																		APR 15 2011	
APR 15 2011																		MVL	
APR 15 2011																		APR 15 2011	
APR 15 2011																		MVL	
APR 15 2011																		APR 15 2011	
APR 15 2011																		MVL	
APR 15 2011																		APR 15 2011	
APR 15 2011																		MVL	
APR 15 2011																		APR 15 2011	
APR 15 2011																		MVL	
APR 15 2011																		APR 15 2011	
APR 15 2011																		MVL	
APR 15 2011																		APR 15 2011	
APR 15 2011																		MVL	
APR 15 2011																		APR 15 2011	
APR 15 2011																		MVL	
APR 15 2011																		APR 15 2011	
APR 15 2011																		MVL	
APR 15 2011																		APR 15 2011	
APR 15 2011																		MVL	
APR 15 2011																		APR 15 2011	
APR 15 2011																		MVL	
APR 15 2011																		APR 15 2011	
APR 15 2011																		MVL	
APR 15 2011																		APR 15 2011	
APR 15 2011																		MVL	
APR 15 2011																		APR 15 2011	
APR 15 2011																		MVL	
APR 15 2011																		APR 15 2011	
APR 15 2011																		MVL	
APR 15 2011																		APR 15 2011	
APR 15 2011																		MVL	
APR 15 2011																		APR 15 2011	
APR 15 2011																		MVL	
APR 15 2011																		APR 15 2011	
APR 15 2011																		MVL	
APR 15 2011																		APR 15 2011	
APR 15 2011																		MVL	
APR 15 2011																		APR 15 2011	
APR 15 2011																		MVL	
APR 15 2011																		APR 15 2011	
APR 15 2011																		MVL	
APR 15 2011																		APR 15 2011	
APR 15 2011																		MVL	
APR 15 2011																		APR 15 2011	
APR 15 2011																		MVL	
APR 15 2011																		APR 15 2011	
APR 15 2011																		MVL	
APR 15 2011																		APR 15 2011	
APR 15 2011																		MVL	
APR 15 2011																		APR 15 2011	
APR 15 2011																		MVL	
APR 15 2011																		APR 15 2011	
APR 15 2011																		MVL	
APR 15 2011																		APR 15 2011	
APR 15 2011																		MVL	
APR 15 2011																		APR 15 2011	
APR 15 2011																		MVL	
APR 15 2011																		APR 15 2011	
APR 15 2011																		MVL	
APR 15 2011																		APR 15 2011	
APR 15 2011																		MVL	
APR 15 2011																		APR 15 2011	
APR 15 2011																		MVL	
APR 15 2011																		APR 15 2011	
APR 15 2011																		MVL	
APR 15 2011																		APR 15 2011	
APR 15 2011																		MVL	
APR 15 2011																		APR 15 2011	
APR 15 2011																		MVL	
APR 15 2011																		APR 15 2011	
APR 15 2011																		MVL	
APR 15 2011																		APR 15 2011	
APR 15 2011																			

Mouser Electronics

Authorized Distributor

Click to View Pricing, Inventory, Delivery & Lifecycle Information:

[Aptiv:](#)
[33511418](#)