

TYPE 202
SAME AS TYPE 201
EXCEPT AS SHOWN

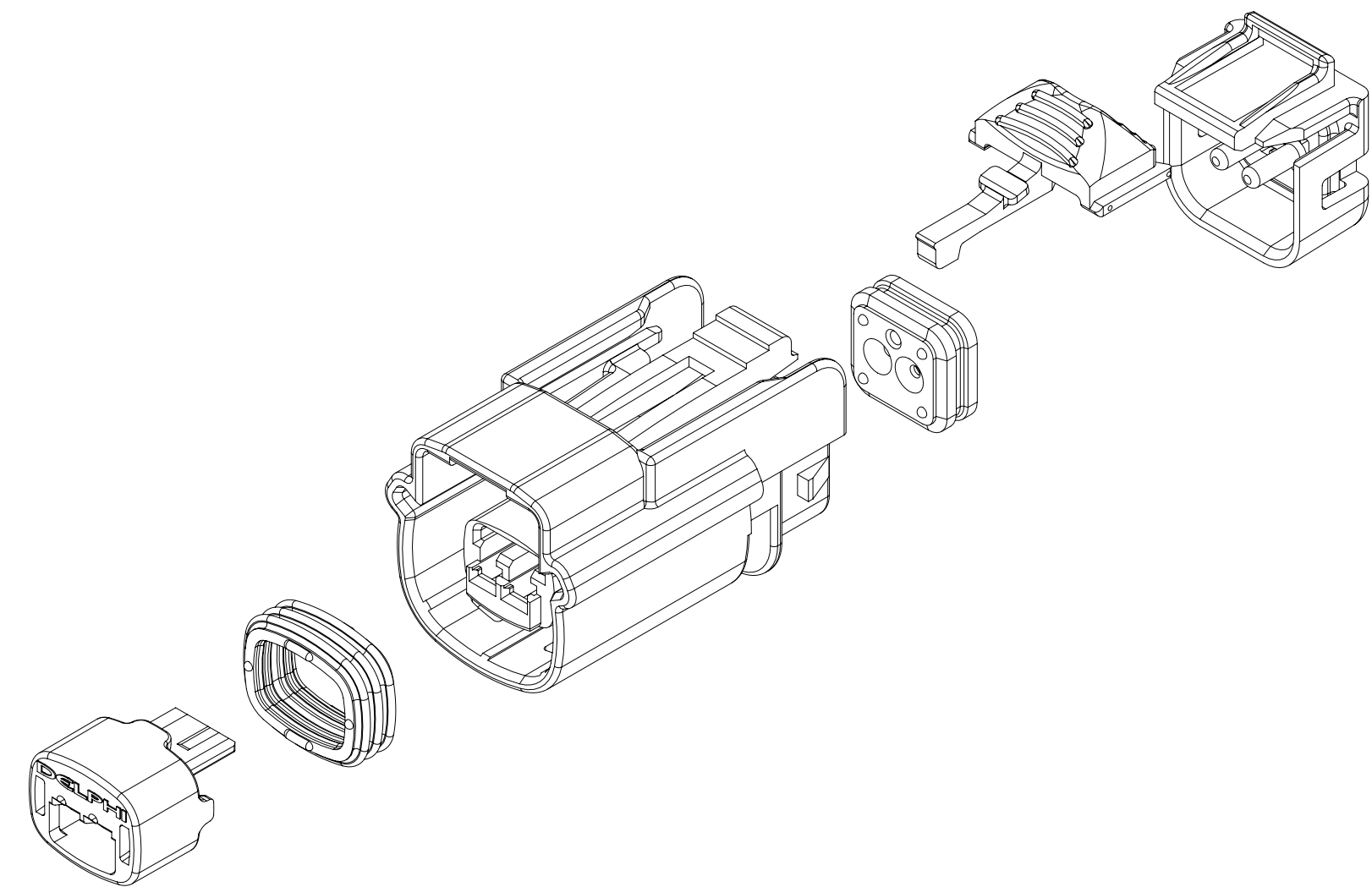

EXPLODED VIEW
SCALE 2:1

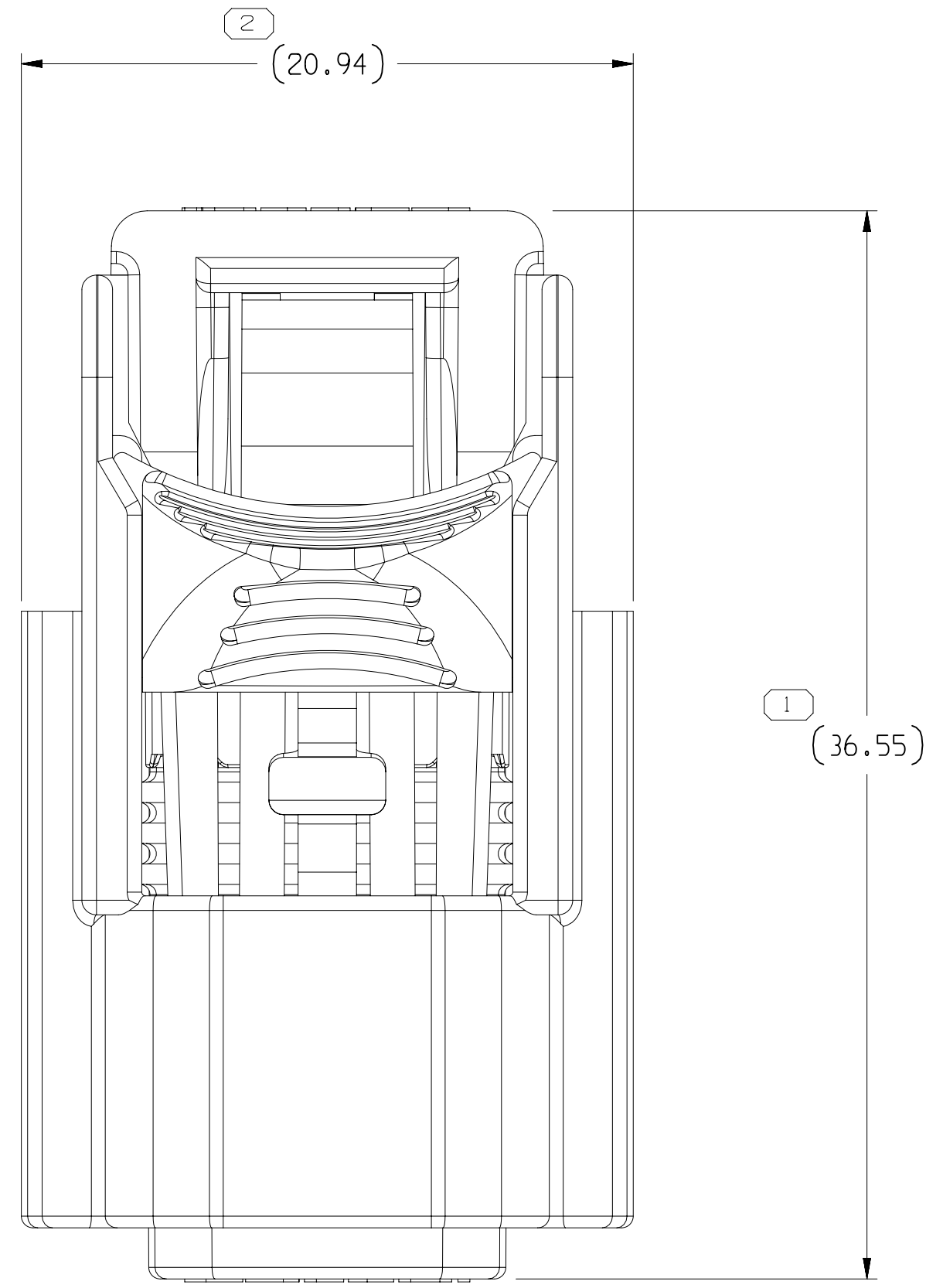
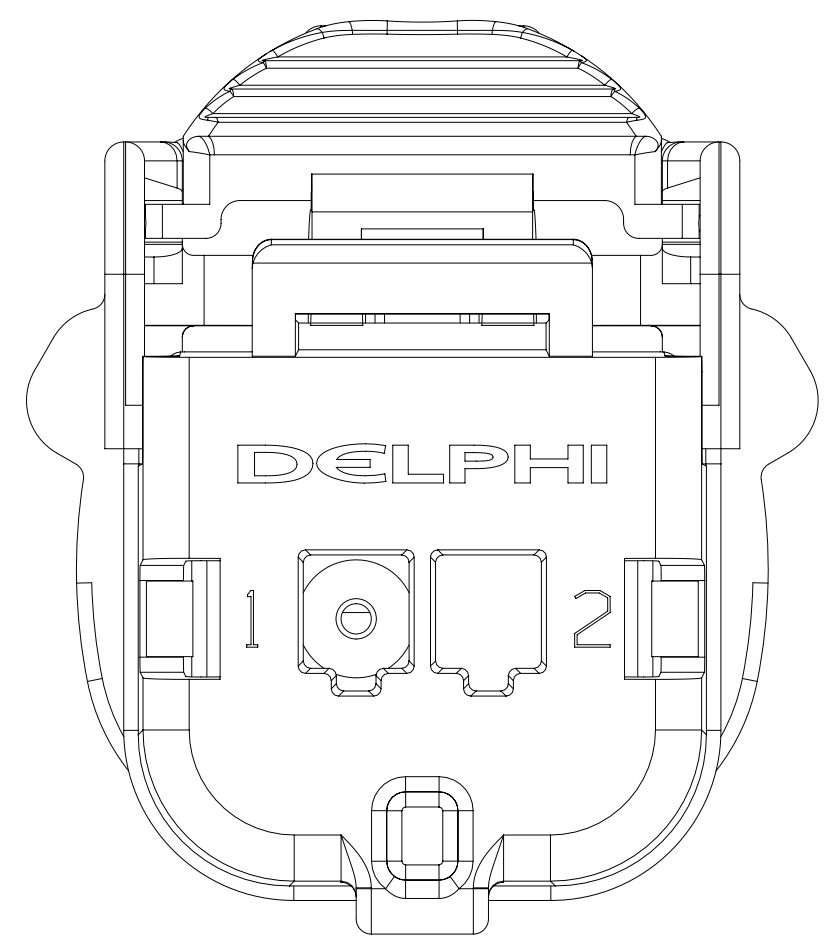
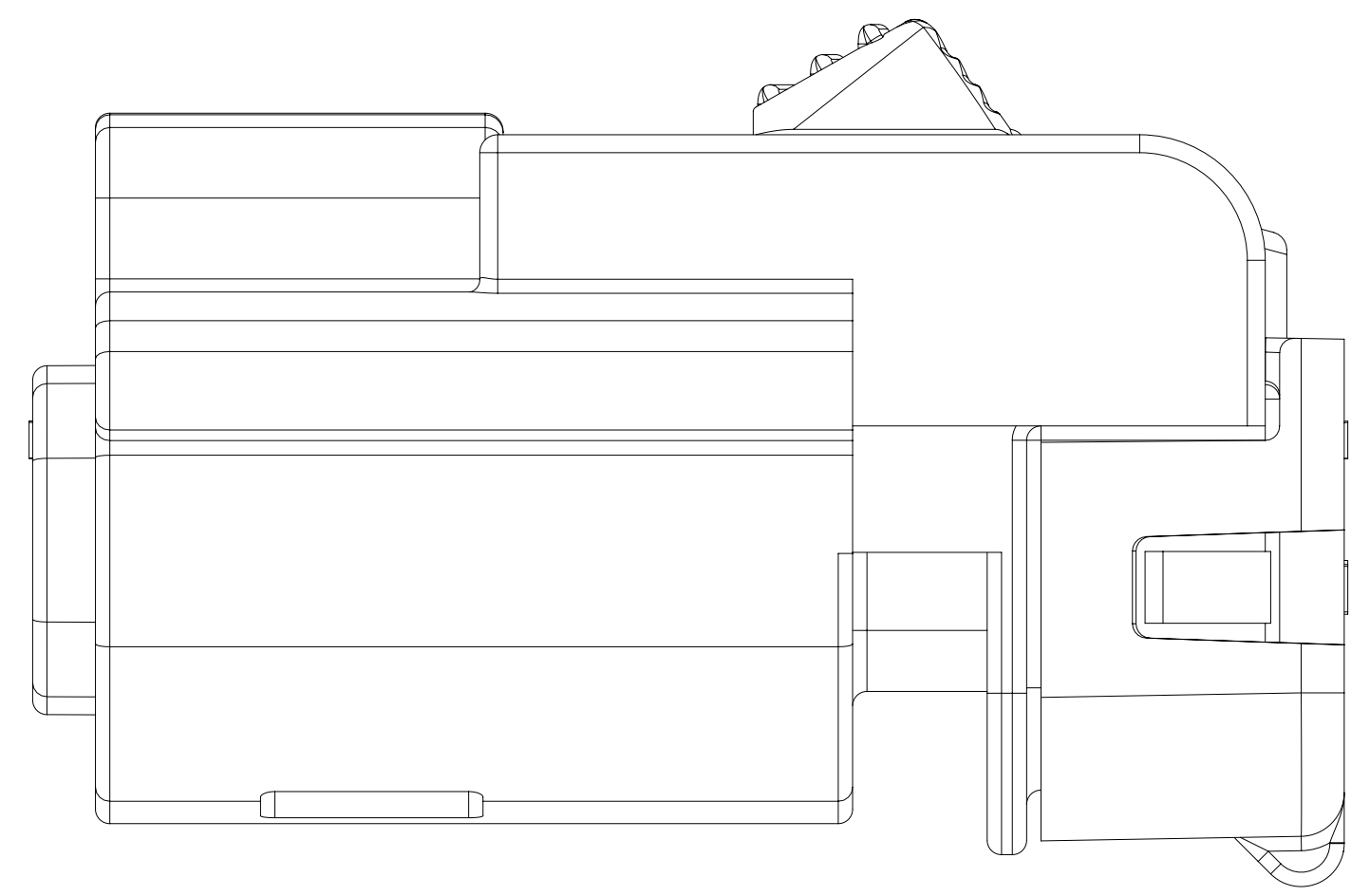
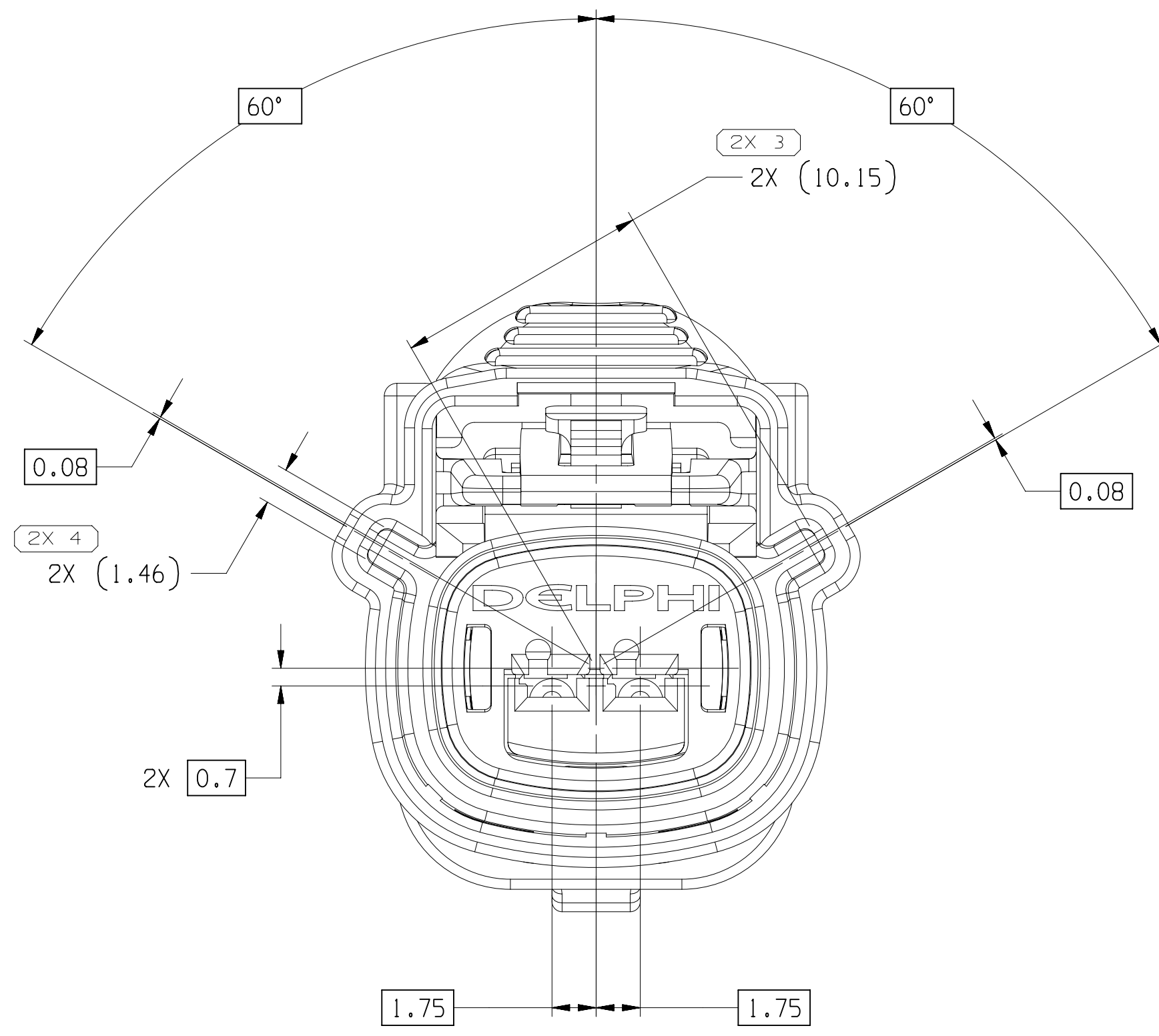
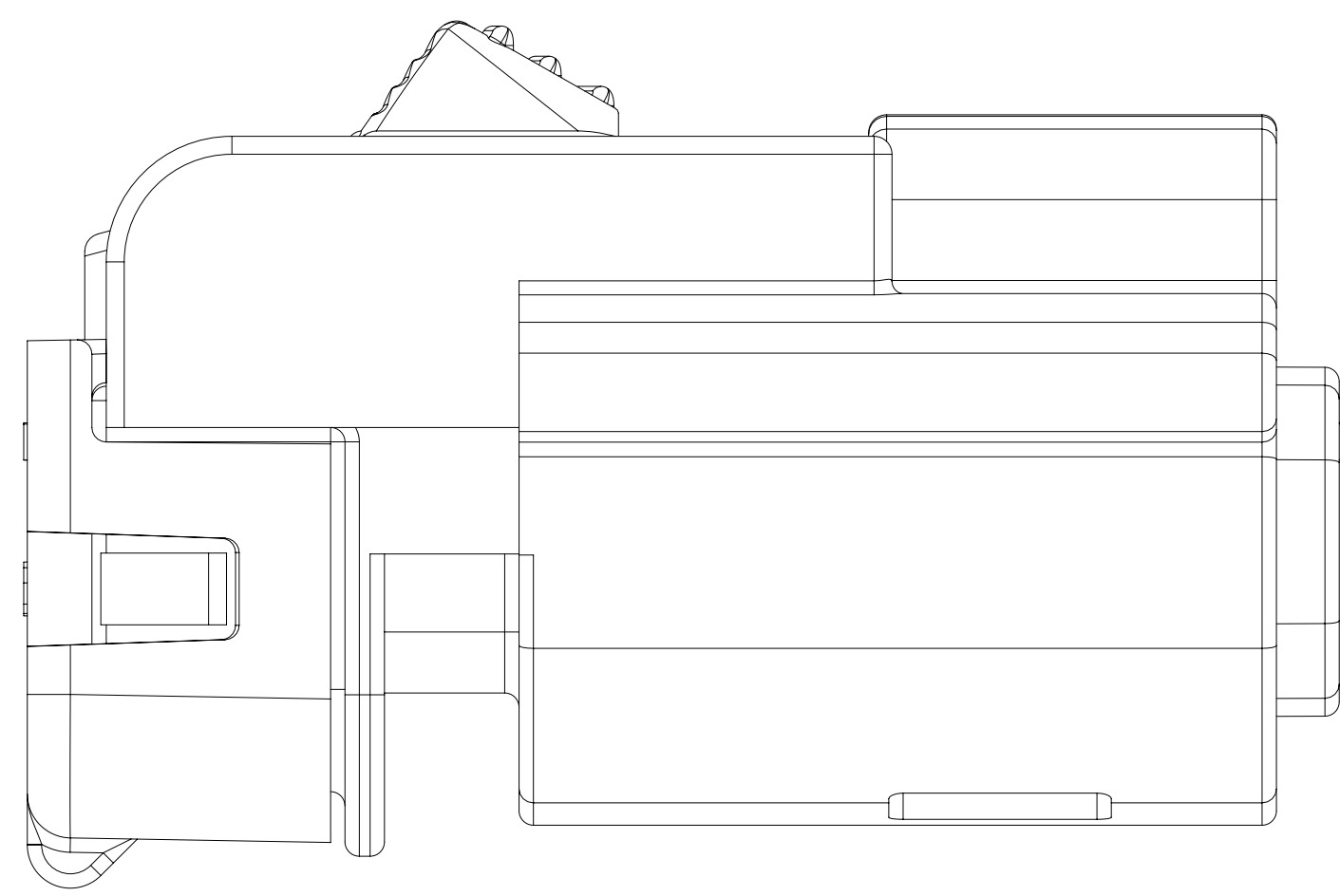
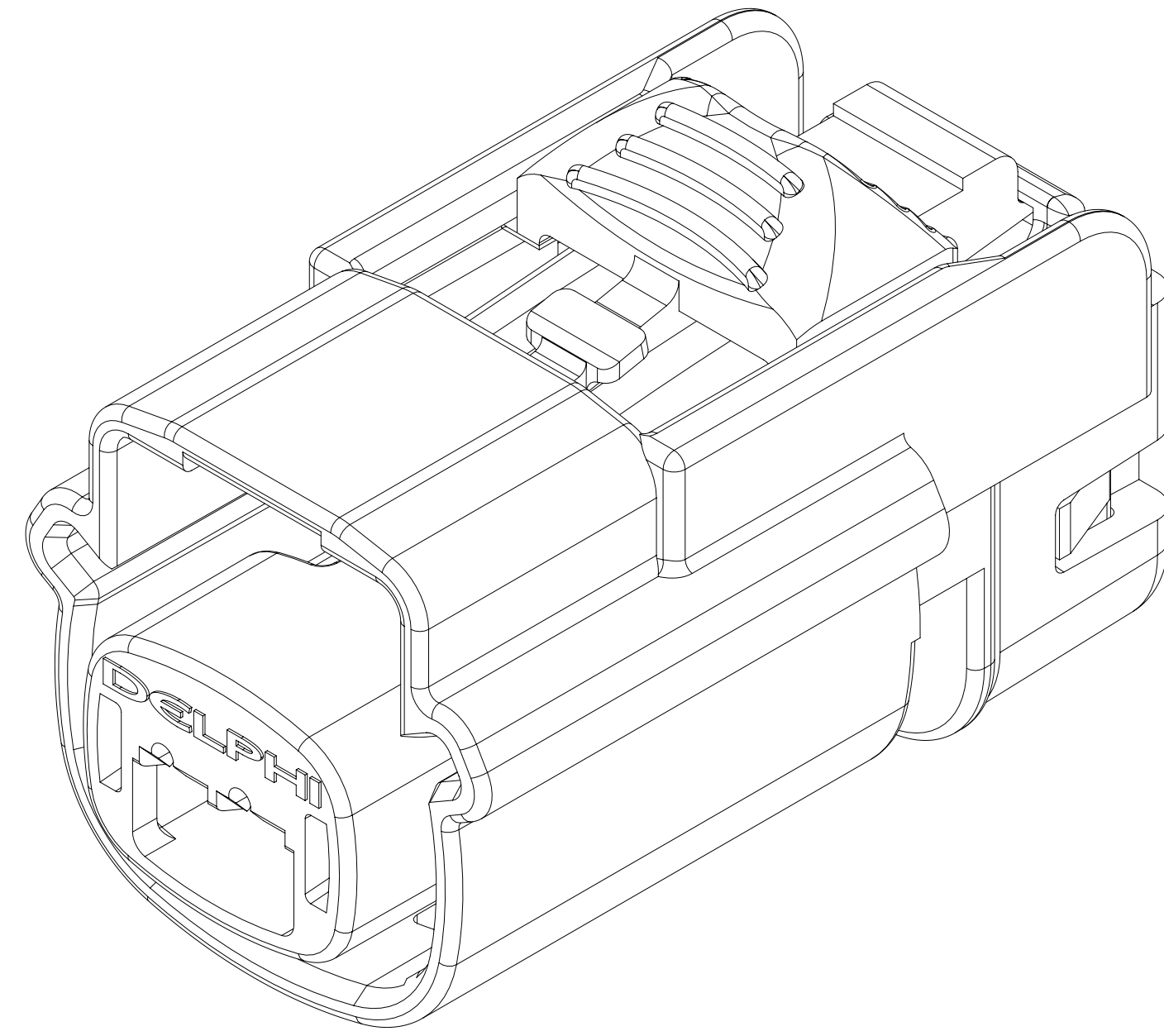

TYPE 201

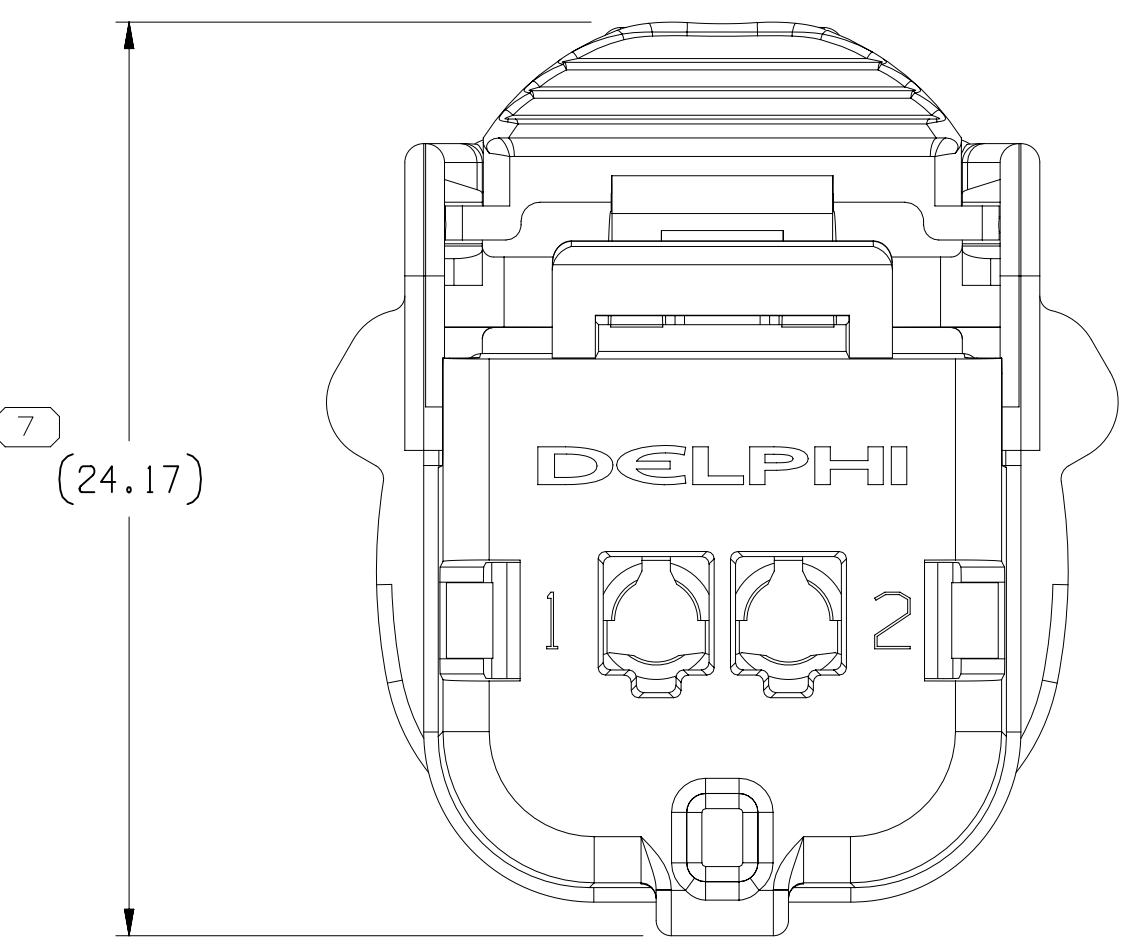
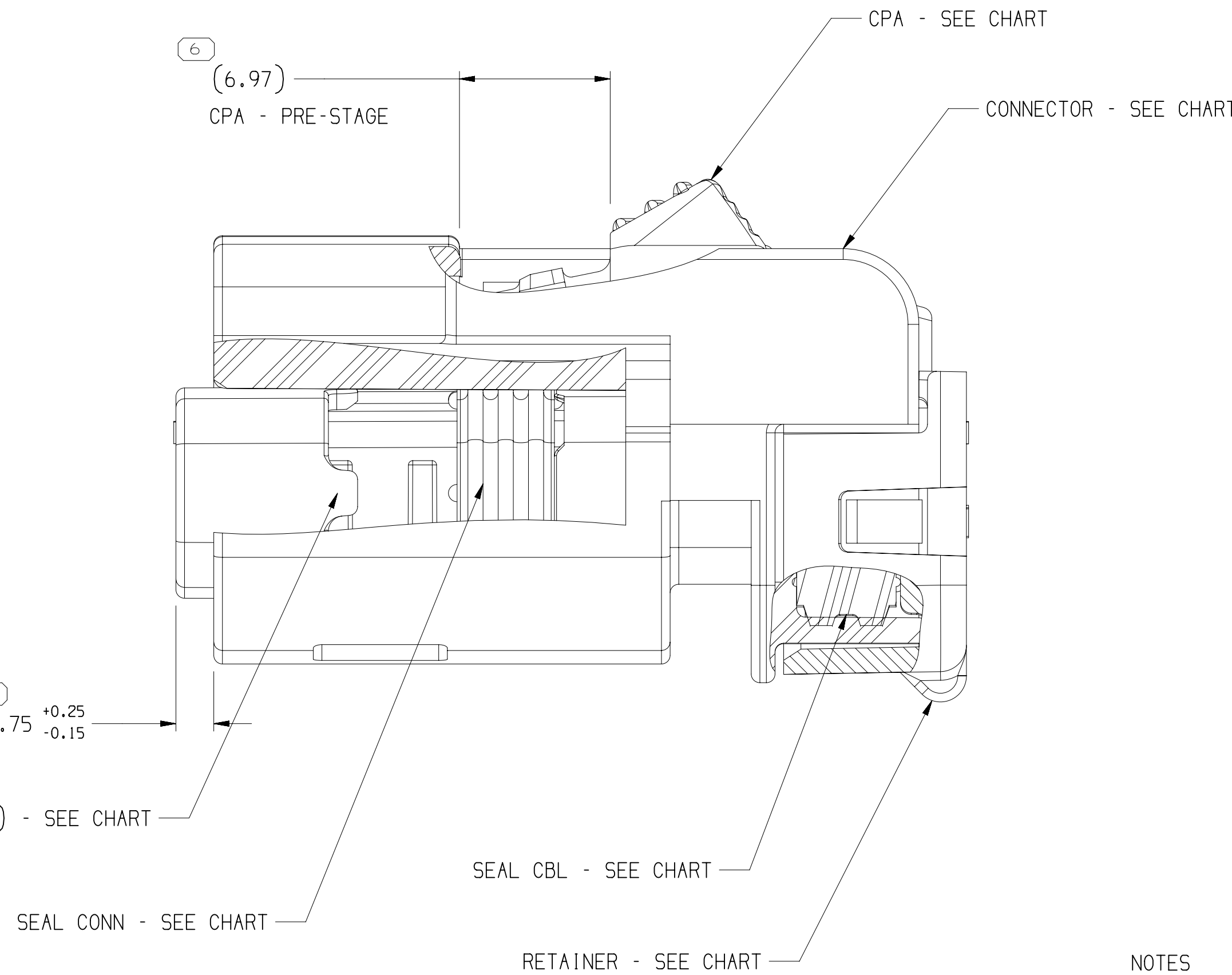

NOTES

- UNLESS OTHERWISE SPECIFIED AND/OR INDICATED:
DIMENSIONS ARE TO FACE OF VIEW SHOWN AND AUTOMATICALLY ROUNDED BY COMPUTER FOR INSPECTION (SEE MATH MODEL FOR PRECISE DIMENSIONS). FOR ALL OTHER DIMENSIONS NOT SHOWN BUT REQUIRED FOR TOOL BUILD, SEE MATH MODEL FOR PRECISE TOOL PATH DATA.
- PART IS MANUFACTURED TO GEOMETRIC TOLERANCES. CENTERLINE DIMENSIONS ARE FOR REFERENCE ONLY.
- SEALING CODE 4 - DESIGN WILL MEET REQUIREMENTS OF SAE/USCAR-2 CONNECTOR SYSTEM ENVIRONMENTAL TEST FLOWCHART (PRESSURE/VACUUM AND SUBMERSION).
- THIS PRODUCT IS NOT CATEGORIZED AS AN APPEARANCE ITEM. MINOR IMPERFECTIONS INCLUDING, BUT NOT LIMITED TO, FLOW MARKS, COLOR BLEMISHES, GATE VESTIGE, AND SOFT FLASH THAT DO NOT AFFECT THE FIT, FORM, OR FUNCTION OF THE PART ARE PERMISSIBLE PER EAMP-4-3-CS-01-EN.
- FOR APPLICATION DATA SEE THE INDIVIDUAL APPLICATION DRAWINGS.
- FOR ALL OPEN CAVITY VERSIONS SEE SHEET 1.
- FOR ASSEMBLIES WITHOUT CPA SEE DRAWING 15532339.

DRAWING NUMBER		15514580	
SIZE	SCALE	FRAME NO	SHEET NO
A1x3	5:1	2 OF 2	2 OF 2
18	17	16	15

33314786	02	AB	202	15514565	15514587	15514588	15514563	15535367	15519096	A	X	1
35151169	02	AB	201	15514565	15514587	15514588	15514563	15514581	15519096	A	X	2
PART NO	REV	N/P	TYPE	CONNECTOR	PLR	SEAL CONN	SEAL CBL	RETAINER	CPA	USCAR OPTION	PLUGGED/BLOCKED CIRCUITS POSITIONS	BLOCKED CAVITIES

DIMENSIONAL TOLERANCE (MM)										CHART	
FROM	> 0	> 30	> 70	> 100	> 150	> 200	> 250	> 300	> 400		
TO	30	70	100	150	200	250	300	400			
TOLERANCE UNLESS OTHERWISE SPECIFIED											
+0.15 +0.2 +0.3 +0.4 +0.5 +0.6 +0.8 +1 +1.6											
ANGULAR TOLERANCE ±2°											
5						4					

Mouser Electronics

Authorized Distributor

Click to View Pricing, Inventory, Delivery & Lifecycle Information:

[Aptiv:](#)

[33314786](#)