

TYPE B
SAME AS TYPE A
EXCEPT AS SHOWN

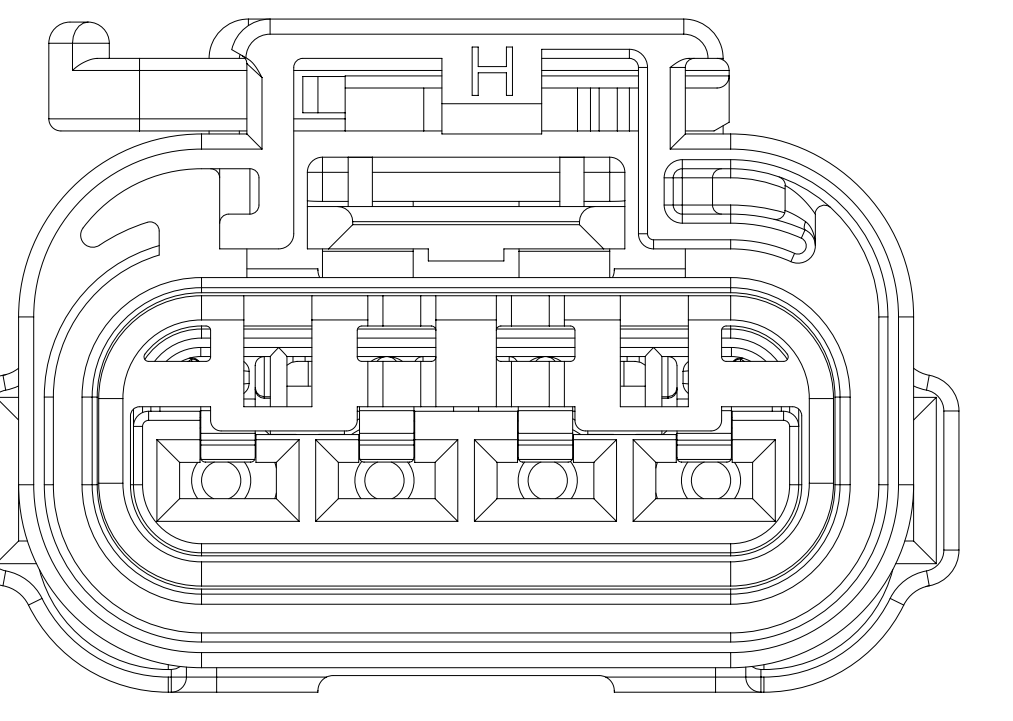

TYPE D
SAME AS TYPE A
EXCEPT AS SHOWN

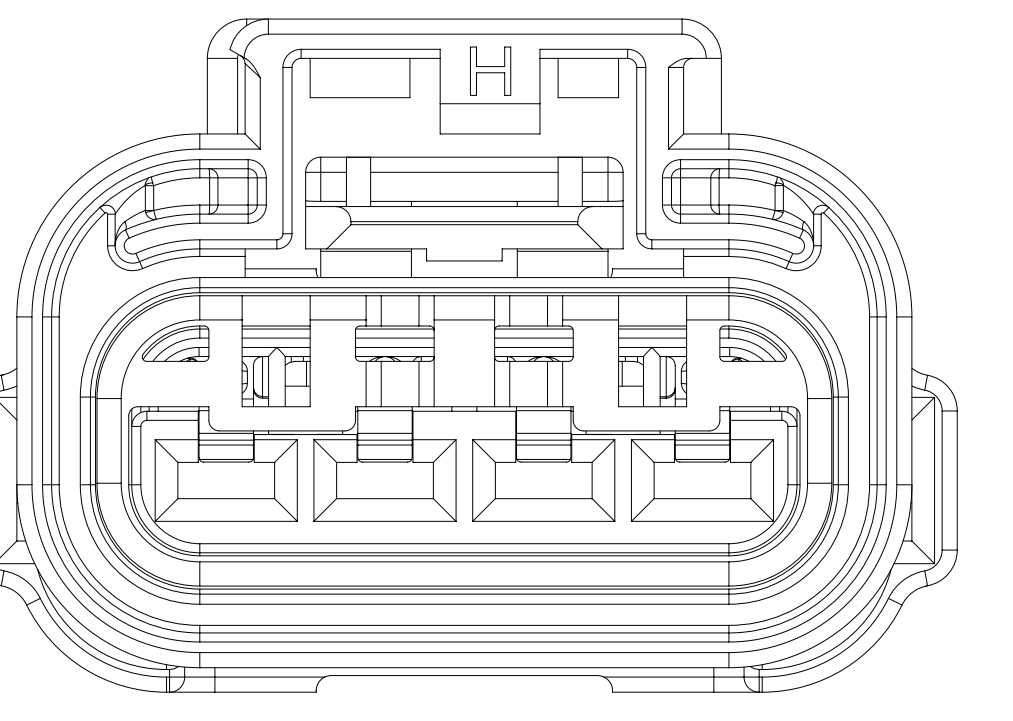

AUXILIARY FRONT VIEW
TYPE A - MATT SEAL W/O HOLES

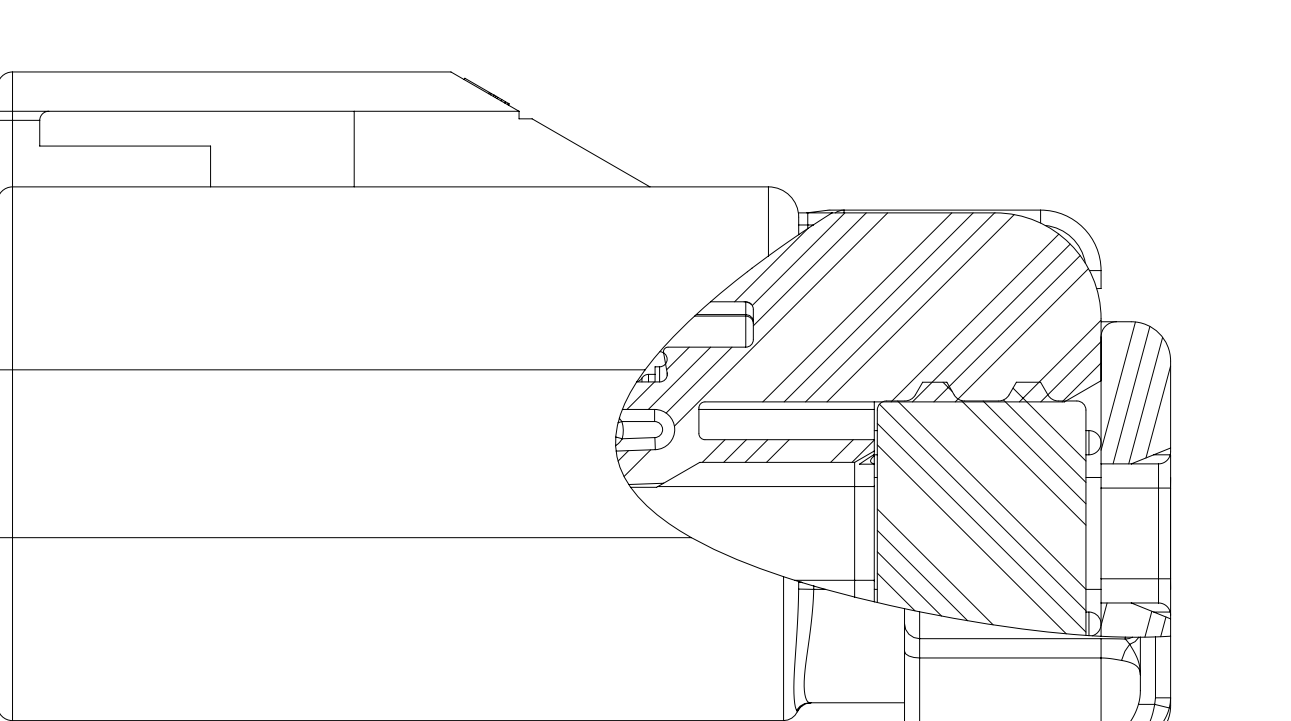

SECTION A-A

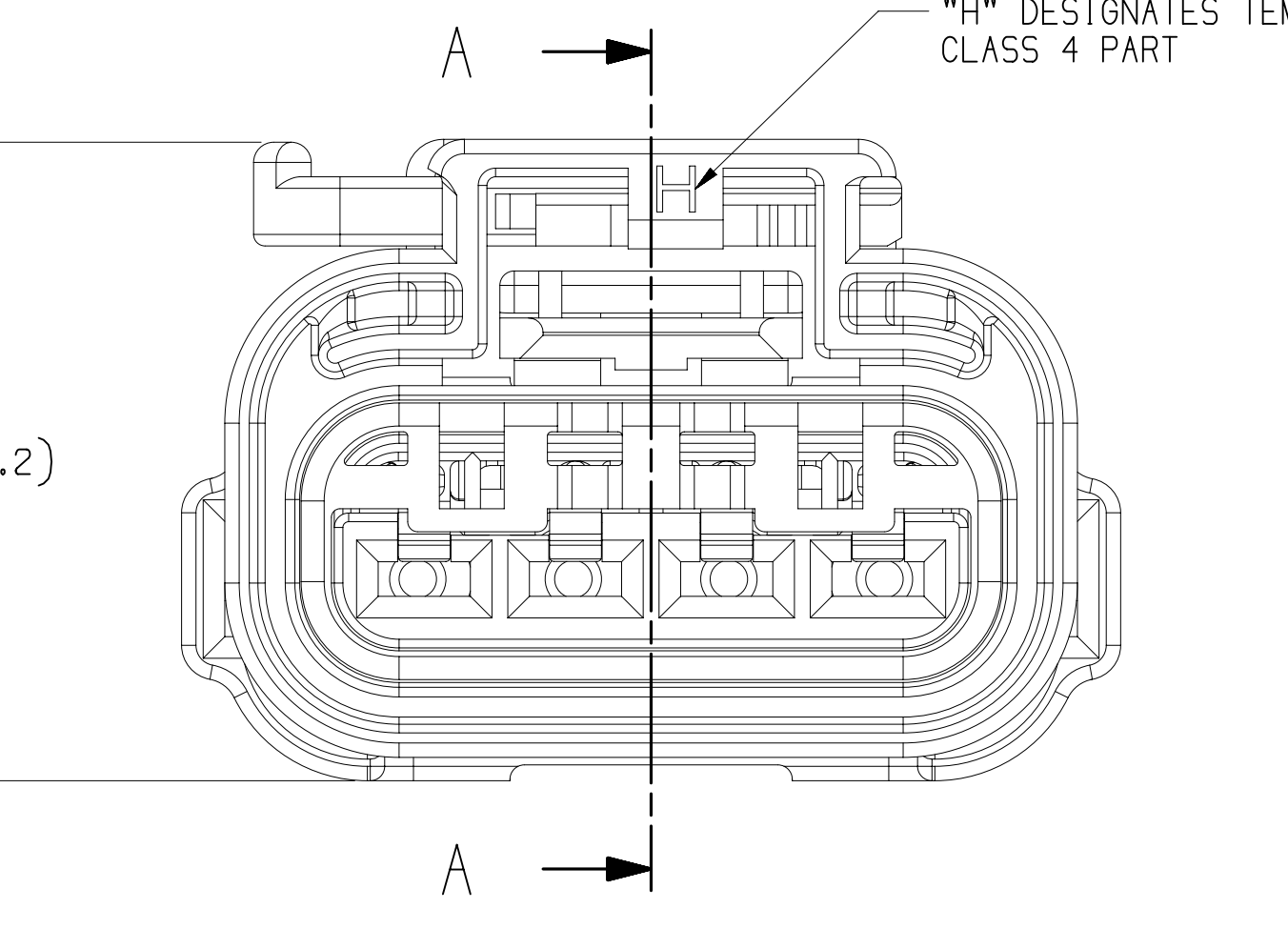
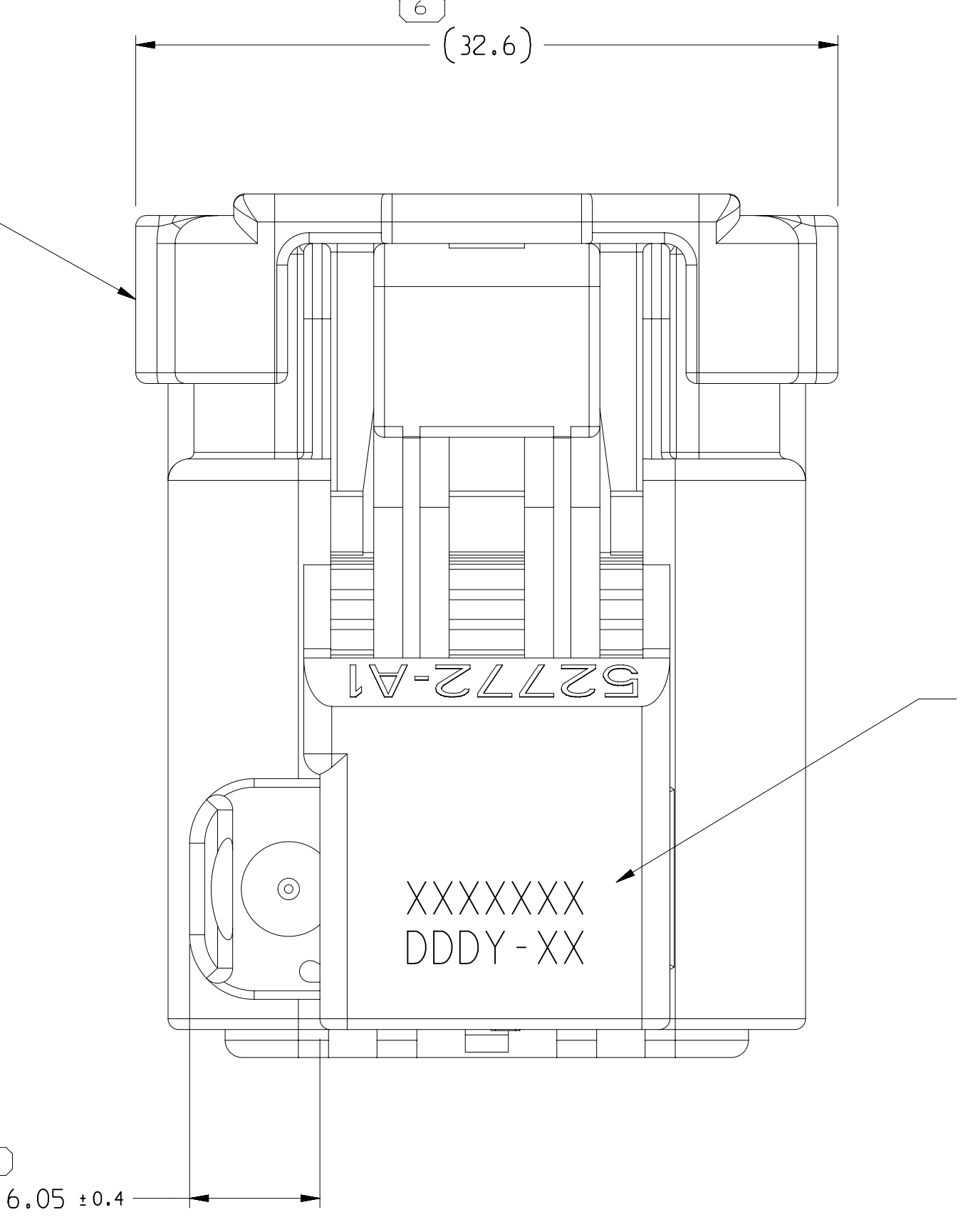

TYPE A - SEALED ASSEMBLY

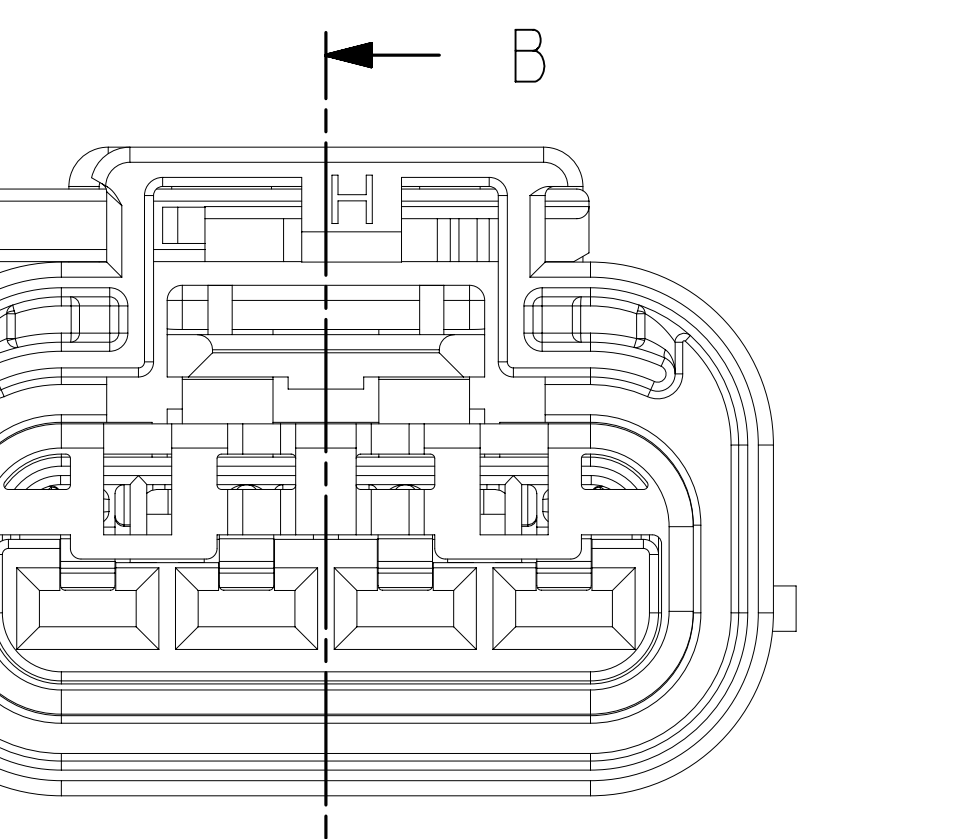

AUXILIARY FRONT VIEW
TYPE A - UNSEALED ASSEMBLY

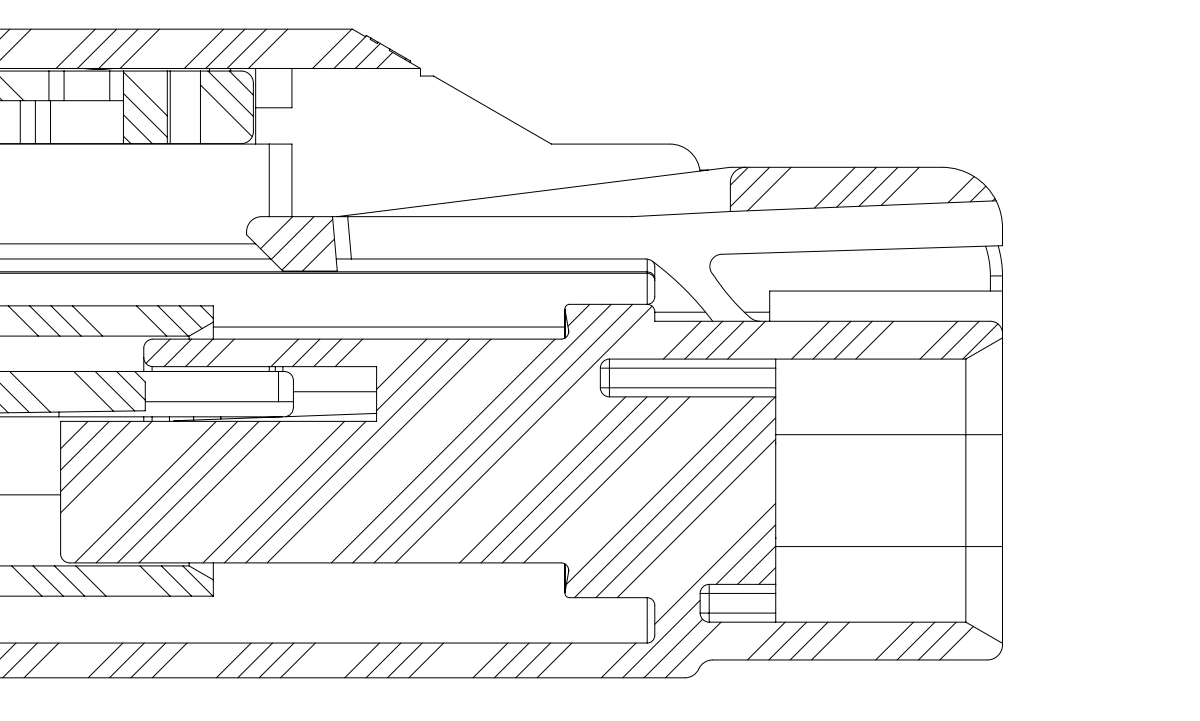

SECTION B-B

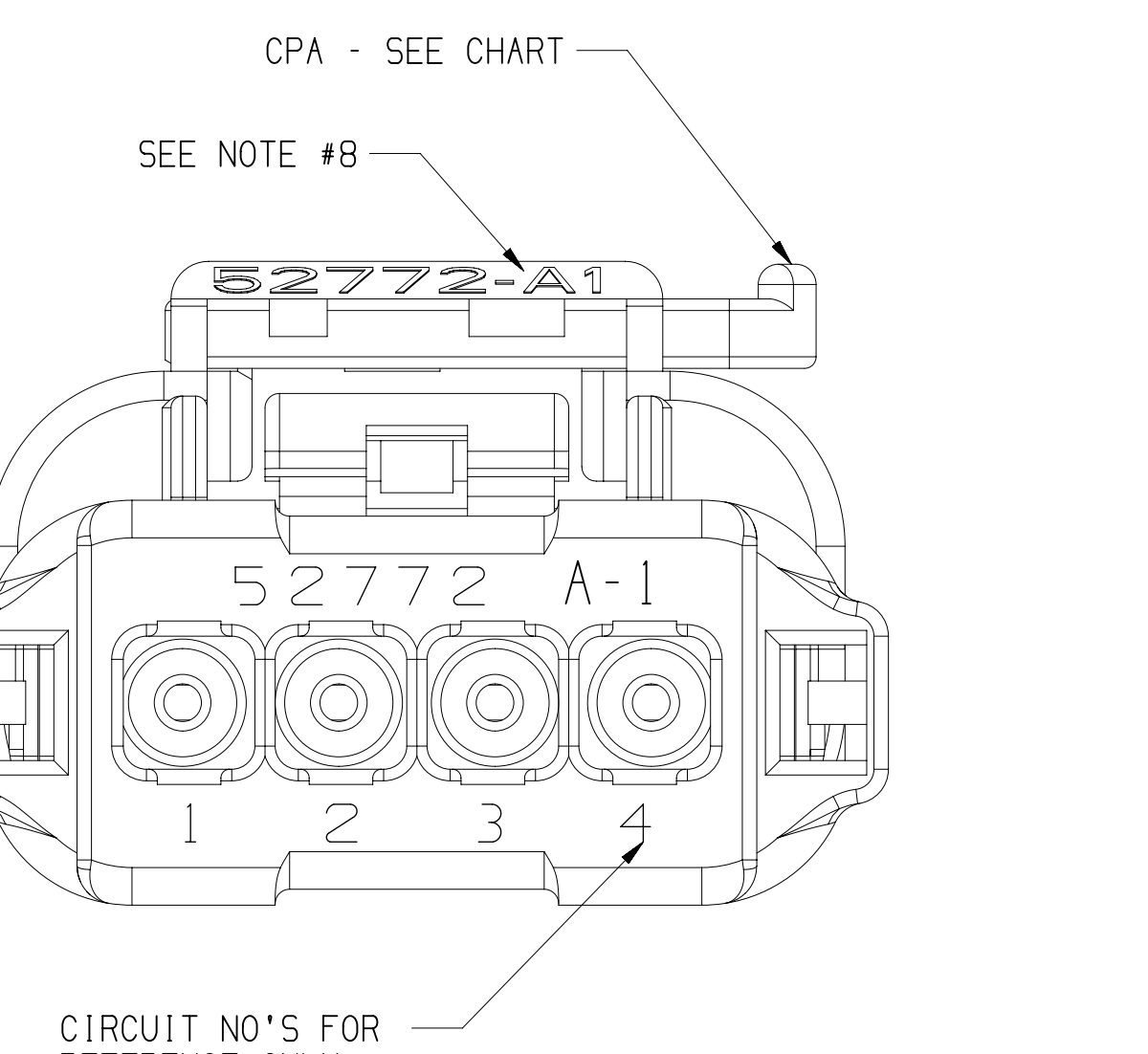
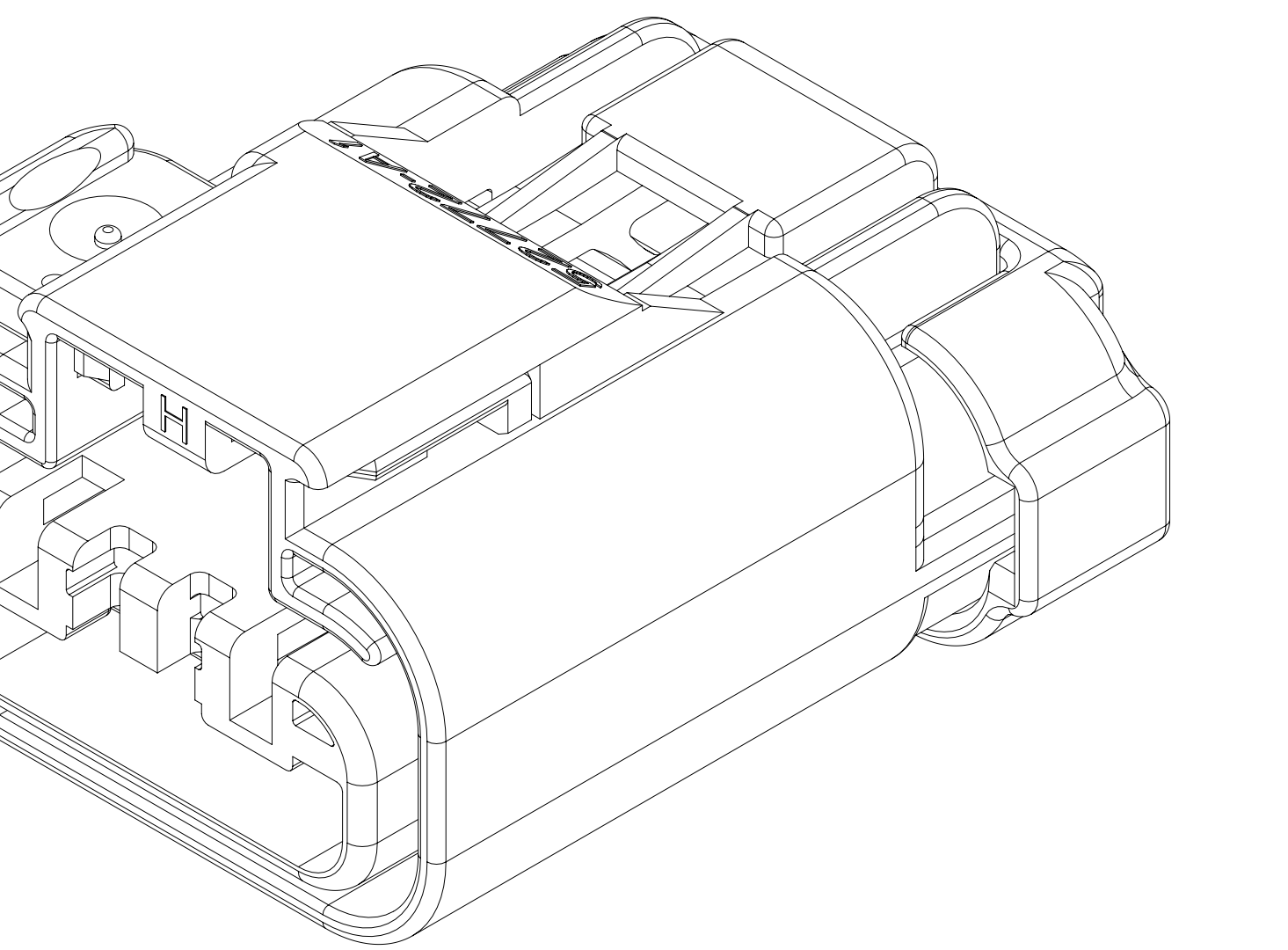

CIRCUIT NO'S FOR
REFERENCE ONLY
ENGRAVED

NOTES

- UNLESS OTHERWISE SPECIFIED AND/OR INDICATED:
DIMENSIONS ARE TO FACE OF VIEW SHOWN AND
AUTOMATICALLY ROUNDED BY COMPUTER FOR INSPECTION
(SEE MATH MODEL FOR PRECISE DIMENSIONS). FOR ALL
OTHER DIMENSIONS NOT SHOWN BUT REQUIRED FOR TOOL
BUILD, SEE MATH MODEL FOR PRECISE TOOL PATH DATA.
- ENGINEERING APPROVAL OF SUPPLIER SAMPLES IS REQUIRED
PRIOR TO AUTHORIZATION OF PART PRODUCTION.
- CHANGES IN DESIGN COMPOSITION OR PROCESSING FROM THE PART
PREVIOUSLY APPROVED FOR PART PRODUCTION REQUIRES PRIOR
ENGINEERING APPROVAL.
- WIRING FABRICATORS MUST PURCHASE FROM SOURCES SHOWN.
- MUST BE USED WITH FLUOROSILICONE END SEAL W/ 54200430/ DPN 15537508
RETAINER & PROPER GAGE TEFLON WIRES FOR METHANOL OR DIESEL
FUEL APPLICATION.
- TEST METHOD PER SAE/USCAR-2 REV. 6, CONNECTOR ENGAGE & DISENGAGE
WITH LATCH DEPRESSION FORCE NOT TO EXCEED 75N FOR THIS SYSTEM.
CPA SEATING FORCES - 40N MAX
PLR SEATING FORCES - 100N MAX
- SUPPLIER, MOLD & CAVITY I.D. MUST BE LEGIBLE
- ANNUAL QUALITY REQUIREMENTS:
IT IS PERMISSIBLE TO PERFORM CONTINUOUS CONFORMANCE PER MVL
SPECIFICATION #AQA-001 INSTEAD OF ANNUAL LAYOUT & ANNUAL PV
REQUIREMENTS OF QS-9000 SECTION 2 & PF-9600.
ALL NON-REFERENCE DIMENSIONS ARE REQUIRED
-USE INDEX A, BLACK SEALED AND UNSEALED FOR ALL AFFECTED
INSULATOR CAVITIES.
-CURRENT PRODUCTION TOOLING.
-POINT OF LAST RUN.
SERVICE TOOLING GUIDE PER APEX TRAINING MANUAL.
- MUST CONFORM TO THE FOLLOWING CHRYSLER / YNA STANDARDS:
PF-9600 PERFORMANCE (CHRYSLER) EXCEPT AS NOTED ABOVE
PS-7300 QUALITY ASSURANCE (CHRYSLER)
PS-4480-DEX-4 (CHRYSLER) PART 1-D, (G-009-2 YNA)
PS-9005 REBOND (CHRYSLER), (G-009-3 YNA)
PS-9227 DATA EXCHANGE (CHRYSLER), (G-009-7 YNA)
PS-10052 INFORMATION SECURITY (CHRYSLER)
10. THIS DRAWING (MVL PN #59003 / DPN 15324795) REPLACES CHRYSLER DRAWING NUMBER
0470254 LEVEL "R" CHRYSLER DRAWING IS FOR REFERENCE ONLY.
- MVL P/N WITH SURFIX "NM" DESIGNATES ASSEMBLIES WITHOUT CPA.
- SEALS BAKED AT 400° F FOR 5 HOURS DURING CONTINUOUSLY INTRODUCED FRESH AIR
TO DRIVE OFF VOLATILES.
- FORD PART NUMBER ARE LISTED FOR REFERENCE, PARTS ARE PPAP'D TO
FORD 4L3T-14A464-AA DWS.
- MVL SUPPLIER CODE: 5272 OR 5272H.
- THIS PRODUCT IS NOT CATEGORIZED AS AN APPEARANCE ITEM, MINOR
IMPERFECTIONS INCLUDING, BUT NOT LIMITED TO, FLOW MARKS, COLOR
BLOOMING, GATE VESTIGES, AND SOFT FLASH THAT DO NOT AFFECT THE
FIT, FORM, OR FUNCTION OF THE PART ARE PERMISSIBLE PER ENP-4.3.CS.01.EN.
- FOR APPLICATION DATA SEE THE INDIVIDUAL APPLICATION DRAWINGS.
- ALL THE SEALED CONNECTOR APPLICATIONS MUST BE USED WITH CHRYSLER WIRE SPEC.
MS-8288 OR MS-9502 THIN WALL X-LINK 20,18,16,14,12 & 10 GAGE WIRES ONLY
UNLESS OTHERWISE SPECIFIED IN CHART (WIRE INSULATIONS Ø1.70 TO Ø2.4,0.9)
METRIC EQUIVALENTS PERMISSIBLE.
- ALL NON-SEALED APPLICATIONS MAY BE USED WITH ANY WIRE INSULATION 22 GAGE
THROUGH 10 GAGE (EXCEPT AS NOTED) PROVIDING THAT A TERMINAL GRIP FOR THAT
CODE/INSULATION COMBINATION IS SHOWN ON THE FEMALE TERMINAL DRAWINGS.
- QUALITY ASSURANCE REQUIREMENTS PER CHRYSLER PS-7300: 1
SPC DATA REQUIRED

01	AB	-	X	-	N/A	54200431	33503579	54200442	33511959	54200459	33511960	54200461	15537512	54200440	15537508	-	-	-	3	12 - 10	20 - 14	-
01	AB	-	-	-	N/A	54200435	13545750	54200442	33511959	54200459	33511960	54200461	15537512	54200440	15537508	54200003	15537297	3	20 - 10	ANY CIRCUITS	-	
01	AB	D	F915600	W	N/A	54200431	33503579	54200442	33511959	54200459	33511960	54200461	15537512	54200440	15537508	54200003	15537297	3	-	-	-	
01	AB	C	F815600	W	N/A	F525600	33503584	54200443	33503747	55200444	33504656	55200439	15537433	55200438	15537435	-	-	-	4	-	-	-
01	AB	C	F815600	W	N/A	F425600	33503585	54200443	33503747	55200444	33504656	55200439	15537433	55200438	15537435	-	-	-	4	-	-	-
01	AB	B	F715600	W	N/A	F325600	33503583	54200443	33503747	55200444	33504656	55200439	15537433	55200438	15537435	-	-	-	4	-	-	-
01	AB	-	55200445	-	N/A	55200442	33503582	54200443	33503747	55200444	33504656	55200439	15537433	55200438	15537435	-	-	-	4	-	-	-
02	AB	-	-	-	N/A	54200434	33503581	54200442	33511959	54200459	33511960	54200458	33504637	54200440	15537508	-	-	-	3	-	-	-
02	AB	C	54200411N	X	N/A	54200433	33503580	54200442	33511959	54200459	33511960	54200458	33504637	54200440	15537508	-	-	-	3	-	-	-
02	AB	B	54200410N	X	N/A	54200435	13545750	54200442	33511959	54200459	33511960	54200458	33504637	54200440	15537508	-	-	-	3	20 - 10	ANY CIRCUIT	-
01	AC	A	-	-	GM 13507647	54200431	33503579	54200442	33511959	54200459	33511960	C17019-U	33185280	54200440	15537508	-	-	-	3	-	-	-
02	AB	A	54200409N	X	N/A	54200431	33503579	54200442	33511959	54200459	33511960	54200458	33504637	54200440	15537508	-	-	-	3	-	-	-
02	AB	A	F512310	X	N/A	54200431	33503579	54200442	33511959	54200459	33511960	54200458	33504637	54200440	15537508	-	-	-	3	-	-	-
02	AB	B	54200450N	X	N/A	54200435	13545750	54200442	33511959	54200459	33511960	54200458	33504637	54200440	15537508	-	-	-	3	-	-	-
02	AB	B	54200447N	X	C 04801217AA	54200435	13545750	54200442	33511959	54200449	33504636	-	-	-	-	-	-	3	-	-	-	
01	AC	A	F333900	X	N/A	54200431	33503579	54200442	33511959	54200459	33511960	54200461	15537512	54200440	15537508	54200003	15537297	3	12 - 10	20 - 14	-	
01	AC	A	-	-	GM 13507648	54200431	33503579	54200442	33511959	54200459	33511960	C17019-U	33185280	54200440	15537508	54200006	15543047	3	-	-	-	
02	AA	D	54200412	X	C 04707264	54200434	33503581	54200442	33511959	54200459	33511960	C17019-U	33185280	54200440	15537508	54200003	15537297	3	-	-	-	
02	AA	C	542004211	X	C 04707263	54200433	33503580	54200442	33511959	54200459	33511960	C17019-U	33185280	54200440	15537508	54200003	15537297	3	-	-	-	
01	AB	B	-	-	F 4L3T-14A464-AB	54200435	13545750	54200442	33511959	54200459	33511960	C17019-U	33185280	54200440	15537508	54200003	15537297	3	-	-	-	
01	AB	A	54200410	X	C 04707256	54200435	13545750	54200442	33511959	54200459	33511960	C17019-U	33185280	54200440	15537508	54200003	15537297	3	-	-	-	
01	AB	A	-	-	F FU5T-14A464-AB / GM 13507649	54200431	33503579	54200442	33511959	54200459	33511960	C17019-U	33185280	54200440	15537508	54200003	15537297	3	-	20, 18, 16 OR 14	-	
02	AB	A	54200409	U	C 04707262	54200431	33503579	54200442	33511959	54200459	33511960	C17019-U	33185280	54200440	15537508	54200003	15537297	3	-	-	-	
01	AA	B	54200450	U	C 04707510	54200435	13545750	54200442	33511959	54200459	33511960	54200458	33504637	54200440	15537508	54200003	15537297	3	-	-	-	
01	AA	D	54200403	U	C 56038053	54200434	33503581	54200442	33511959	-	-	-	-	-	-	54200003	15537297	3	-	-	-	
01	AA	C	56038193	U	C 56038052	54200433	33503580	54200442	33511959	-	-	-	-	-	-	54200003	15537297	3	-	-	-	
01	AA	A	54200400	U	C 56038052	54200431	33503579	54200442	33511959	-	-	-	-	-	-	54200003	15537297	3	-	-	-	
01	AA	B	54200402N	U	C 046888849	54200435	13545750	54200442	33511959	-	-	-	-	-	-	54200003	15537297	3	-	20 - 10	ANY CIRCUIT	
01	AA	D	54200404N	U	N/A	54200434	33503581	54200442	33511959	-	-	-	-	-	-	-	-	-	-	-	-	
01	AA	C	54200403N	U	N/A	54200433	33503580	54200442	33511959	-	-	-	-	-	-	-	-	-	-	-	-	
01	AA	A	54200400N	U	N/A	54200431	33503579	54200442	33511959	-	-	-	-	-	-	-	-	-	-	-	-	
01	AA	A	54200400N	U	N/A	54200431	33503579	54200442	33511959	-	-	-	-	-	-	-	-	-	-	-	-	
01	AA	A	54200400N	U	N/A	54200431	33503579	54200442	33511959	-	-	-	-	-	-	-	-	-	-	-	-	
01	AA	A	54200400N	U	N/A	54200431	33503579	54200442	33511959	-	-	-	-	-	-	-	-	-	-	-	-	
01	AA	A	54200400N	U	N/A	54200431	33503579	54200442	33511959	-	-	-	-	-	-	-	-	-	-	-	-	
01	AA	A	54200400N	U	N/A	54200431	33503579	54200442	33511959	-	-	-	-	-	-	-	-	-	-	-	-	
01	AA	A	54200400N	U	N/A	54200431	33503579	54200442	33511959	-	-	-	-	-	-	-	-	-	-	-	-	
01	AA	A	54200400N	U	N/A	54200431	33503579	54200442	33511959	-	-	-	-	-	-	-	-	-	-	-	-	
01	AA	A	54200400N	U	N/A	54200431	33503579	54200442	33511959	-	-	-	-	-	-	-	-	-	-	-	-	
01	AA	A	54200400N	U	N/A	54200431	33503579	54200442	33511959	-	-	-	-	-	-	-	-	-	-	-	-	
01	AA	A	54200400N	U	N/A	54200431	33503579	54200442	33511959	-	-	-	-	-	-	-	-	-	-	-	-	
01	AA	A	54200400N	U	N/A	54200431	33503579	54200442	33511959	-	-	-	-	-	-	-	-	-	-	-	-	
01	AA	A	54200400N	U	N/A	54200431	33503579	54200442	33511959	-	-	-	-	-	-	-	-	-	-	-	-	
01	AA	A	54200400N	U	N/A	54200431	33503579	54200442	33511959	-	-	-	-	-	-	-	-	-	-	-	-	
01	AA	A	54200400N	U	N/A	54200431	33503579	54200442	33511959	-	-	-	-	-	-	-	-	-	-	-	-	
01	AA	A	54200400N	U	N/A	54200431	33503579	54200442	33511959	-	-	-	-	-	-	-	-	-	-	-	-	
01	AA	A	54200400N	U	N/A	54200431	33503579	54200442	33511959	-	-	-	-	-	-	-	-	-	-	-	-	
01	AA	A	54200400N	U	N/A	54200431	33503579	54200442	33511959	-	-	-	-	-	-	-	-	-	-	-	-	
01	AA	A	54200400N	U	N/A	54200431	33503579	54200442	33511959	-	-	-	-	-	-	-	-	-	-	-	-	
01	AA	A	54200400N	U	N/A	54200431	33503579	54200442	33511959	-	-	-	-	-	-	-	-	-	-	-	-	
01	AA	A	54200400N	U	N/A	54200431	33503579	54200442	33511959	-	-	-	-	-	-	-	-	-	-	-	-	
01	AA	A	54200400N	U	N/A	54200431	33503579	54200442	33511959	-	-	-	-	-	-	-	-	-	-	-	-	
01	AA	A	54200400N	U	N/A	54200431	33503579	54200442	33511959	-	-	-	-	-	-	-	-	-	-	-	-	
01	AA	A	54200400N	U	N/A	54200431	33503579	54200442	33511959	-	-	-	-	-	-	-	-	-	-	-	-	
01	AA	A	54200400N	U	N/A	54200431	33503579	54200442	33511959	-	-	-	-	-	-	-	-	-	-	-	-	
01	AA	A	54200400N	U	N/A	54200431	33503579	54200442	33511959	-	-	-	-	-	-	-	-	-	-	-	-	
01	AA	A	54200400N	U	N/A	54200431	33503579	54200442	33511959	-	-	-	-	-	-	-	-	-	-	-	-	
01	AA	A	54200400N	U	N/A	54200431	33503579	54200442	33511959	-	-	-	-	-	-	-	-	-	-	-	-	
01	AA	A	54200400N	U	N/A	54200431	33503579	54200442	33511959	-	-	-	-	-	-	-	-	-	-	-	-	
01	AA	A	54200400N	U	N/A	54200431	33503579	54200442	33511959	-	-	-	-	-	-	-	-	-	-	-	-	
01	AA	A	54200400N	U	N/A	54200431	33503579	54200442	33511959	-	-	-	-	-	-	-	-	-	-	-	-	
01	AA	A	54200400N	U	N/A	54200431	33503579	54200442	33511959	-	-	-	-	-	-	-	-	-	-	-	-	
01	AA	A	54200400N	U	N/A	54200431	33503579	54200442	33511959	-	-	-	-	-	-	-	-	-	-	-	-	
01	AA	A	54200400N	U	N/A	54200431	33503579	54200442	33511959	-	-	-	-	-	-	-	-	-	-	-	-	
01	AA	A	54200400N	U	N/A	54200431	33503579	54200442	33511959	-	-	-	-	-	-	-	-	-	-	-	-	
01	AA	A	54200400N	U	N/A	54200431	33503579	54200442	33511959	-	-	-	-	-	-	-	-	-	-	-	-	
01	AA	A	54200400N	U	N/A	54200431	33503579	54200442	33511959	-	-	-	-	-	-	-	-	-	-	-	-	
01	AA	A	54200400N	U	N/A	54200431	33503579	54200442	33511959	-	-	-	-	-	-	-	-	-				

DRAWING NUMBER
5324795

CLASS
A1x4 4:1 2 OF 2 1 OF 1 R 11 -

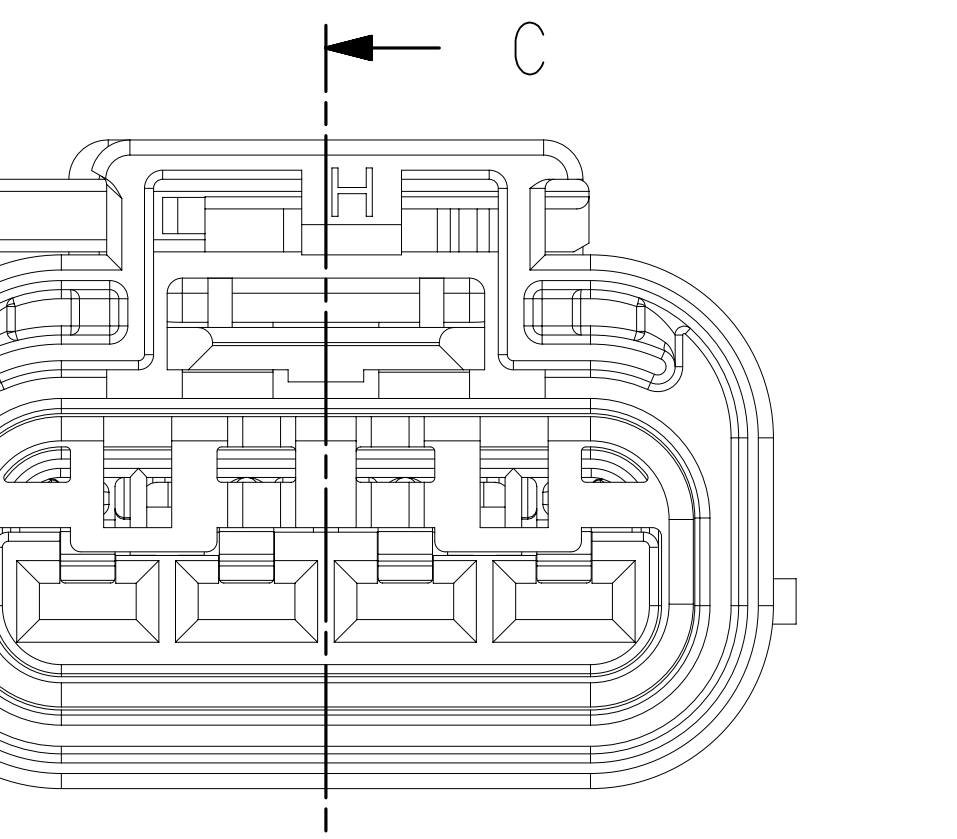

AUXILIARY FRONT VIEW
TYPE B - SEALED (PARTIAL) ASSEMBLY
SEE NOTE #5 - SHIPPED WITHOUT MATT SEAL AND RETAINER

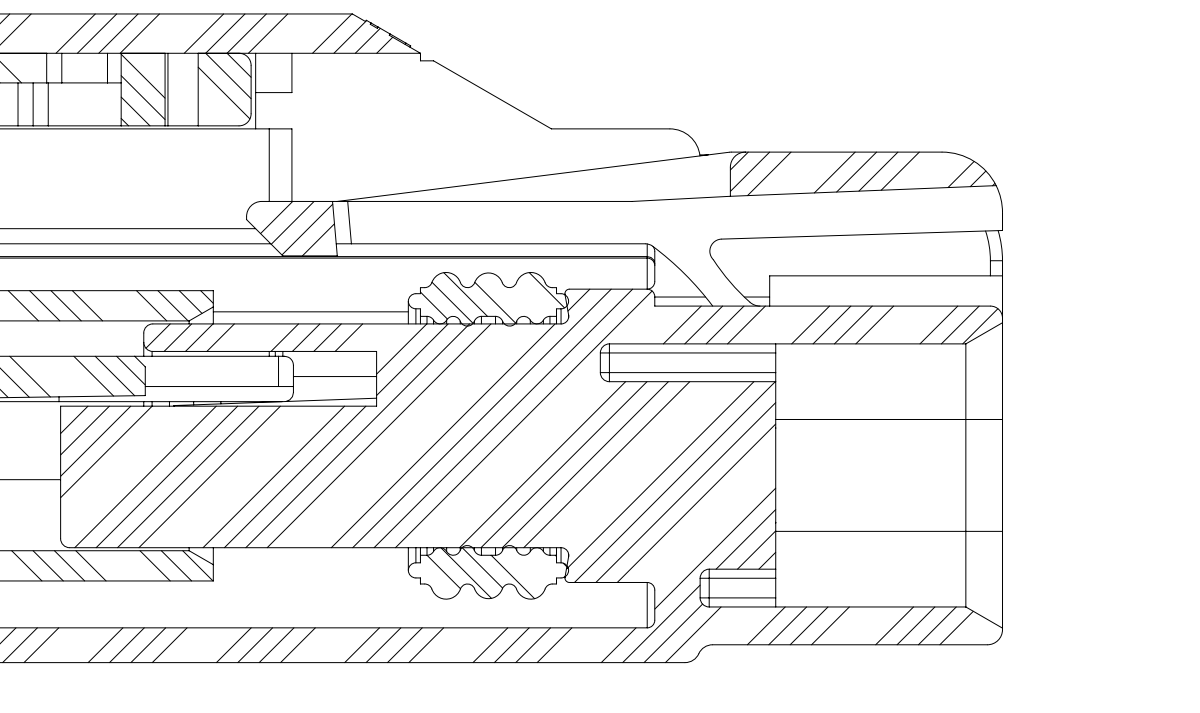

SECTION C-C

APLIV	
CONNECTION SYSTEMS	
PART NAME: TAXI ASM CONN 4 F APEX 2.8	
DRAWING NUMBER: 15324795	
DATE: 25M05	
BY: RAJUMAR	
CHKD: MATT MAJOR	
APP'D: SUDHA SIAN	
REV: 1	
REV: 2	
REV: 3	
REV: 4	
REV: 5	
REV: 6	
REV: 7	
REV: 8	
REV: 9	
REV: 10	
REV: 11	
REV: 12	
REV: 13	
REV: 14	
REV: 15	
REV: 16	
REV: 17	
REV: 18	
REV: 19	
REV: 20	
REV: 21	
REV: 22	
REV: 23	
REV: 24	
REV: 25	
REV: 26	
REV: 27	
REV: 28	
REV: 29	
REV: 30	
REV: 31	
REV: 32	
REV: 33	
REV: 34	
REV: 35	
REV: 36	
REV: 37	
REV: 38	
REV: 39	
REV: 40	
REV: 41	
REV: 42	
REV: 43	
REV: 44	
REV: 45	
REV: 46	
REV: 47	
REV: 48	
REV: 49	
REV: 50	
REV: 51	
REV: 52	
REV: 53	
REV: 54	
REV: 55	
REV: 56	
REV: 57	
REV: 58	
REV: 59	
REV: 60	
REV: 61	
REV: 62	
REV: 63	
REV: 64	
REV: 65	
REV: 66	
REV: 67	
REV: 68	
REV: 69	
REV: 70	
REV: 71	
REV: 72	
REV: 73	
REV: 74	
REV: 75	
REV: 76	
REV: 77	
REV: 78	
REV: 79	
REV: 80	
REV: 81	
REV: 82	
REV: 83	
REV: 84	
REV: 85	
REV: 86	
REV: 87	
REV: 88	
REV: 89	
REV: 90	
REV: 91	
REV: 92	
REV: 93	
REV: 94	
REV: 95	
REV: 96	
REV: 97	
REV: 98	
REV: 99	
REV: 100	
REV: 101	
REV: 102	
REV: 103	
REV: 104	
REV: 105	
REV: 106	
REV: 107	
REV: 108	
REV: 109	
REV: 110	
REV: 111	
REV: 112	
REV: 113	
REV: 114	
REV: 115	
REV: 116	
REV: 117	
REV: 118	
REV: 119	
REV: 120	
REV: 121	
REV: 122	
REV: 123	
REV: 124	
REV: 125	
REV: 126	
REV: 127	
REV: 128	
REV: 129	
REV: 130	
REV: 131	
REV: 132	
REV: 133	
REV: 134	
REV: 135	
REV: 136	
REV: 137	
REV: 138	
REV: 139	
REV: 140	
REV: 141	
REV: 142	
REV: 143	
REV: 144	
REV: 145	
REV: 1	

Mouser Electronics

Authorized Distributor

Click to View Pricing, Inventory, Delivery & Lifecycle Information:

[Aptiv:](#)

[33511446](#)