

TYPE 102
SAME AS TYPE 101
EXCEPT AS SHOWN

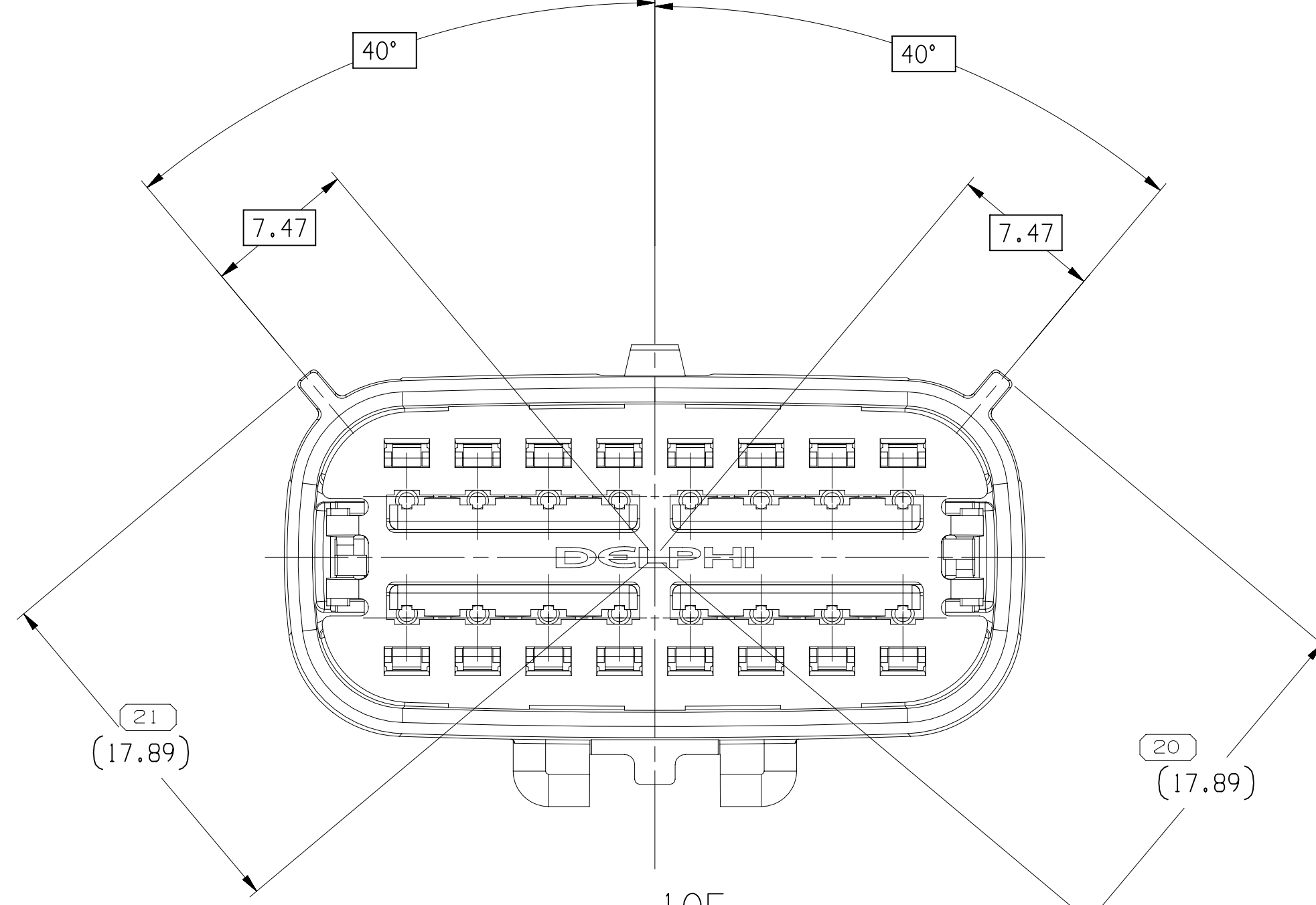

TYPE 105
SAME AS TYPE 101
EXCEPT AS SHOWN

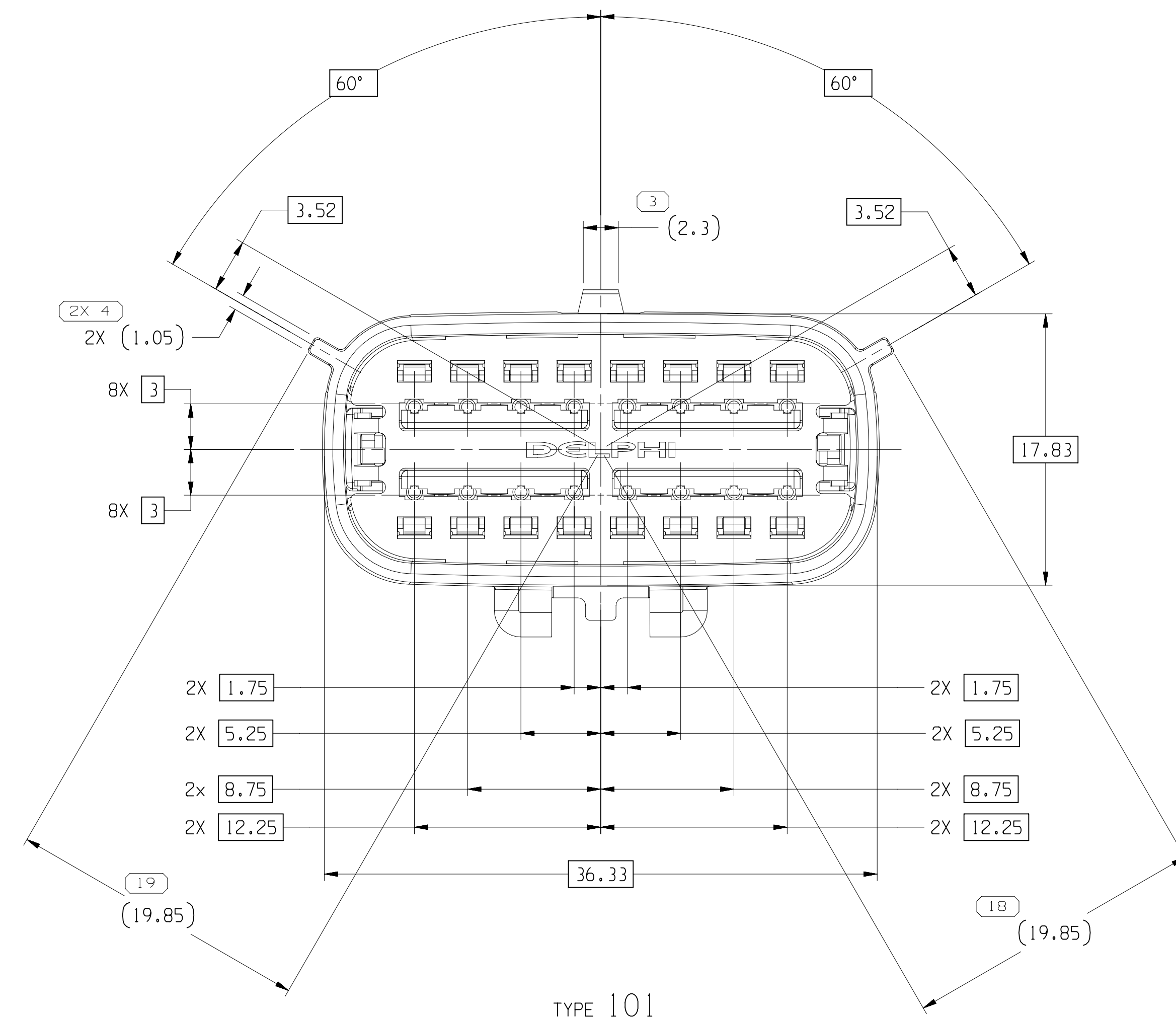
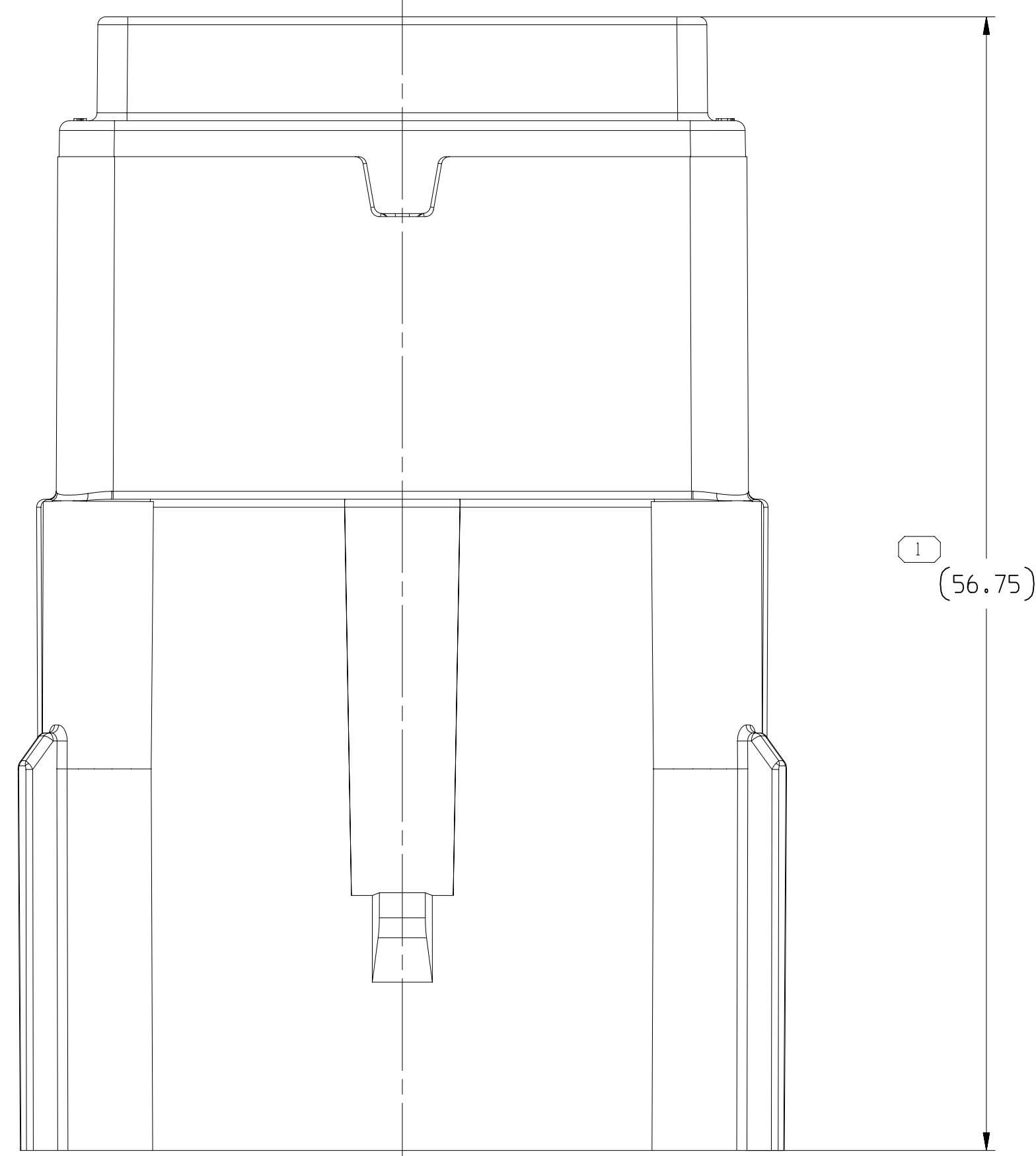

TYPE 101

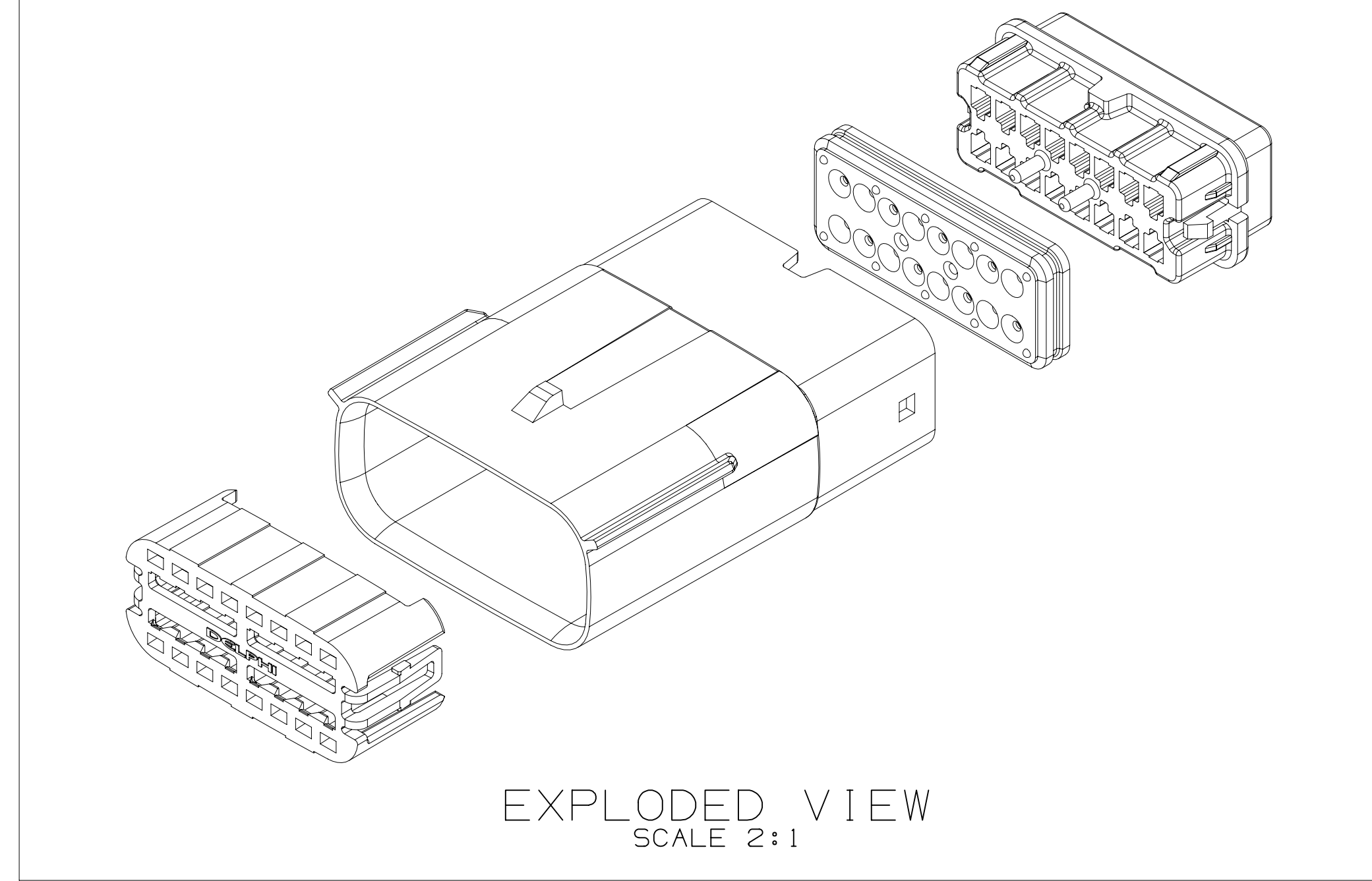

A DIMENSION WITHOUT AN INSPECTION REPORT SYMBOL
○ DOES NOT REQUIRE INSPECTION. IT MAY BE
CONTROLLED ON THE INDIVIDUAL COMPONENT DRAWING.

SYMBOL DEFINITION
TOTAL NO. OF
INSPECTIONS
REQUIRED
LAST NO.
USED

MISSING SYMBOLS
NO MISSING SYMBOL
NUMBER

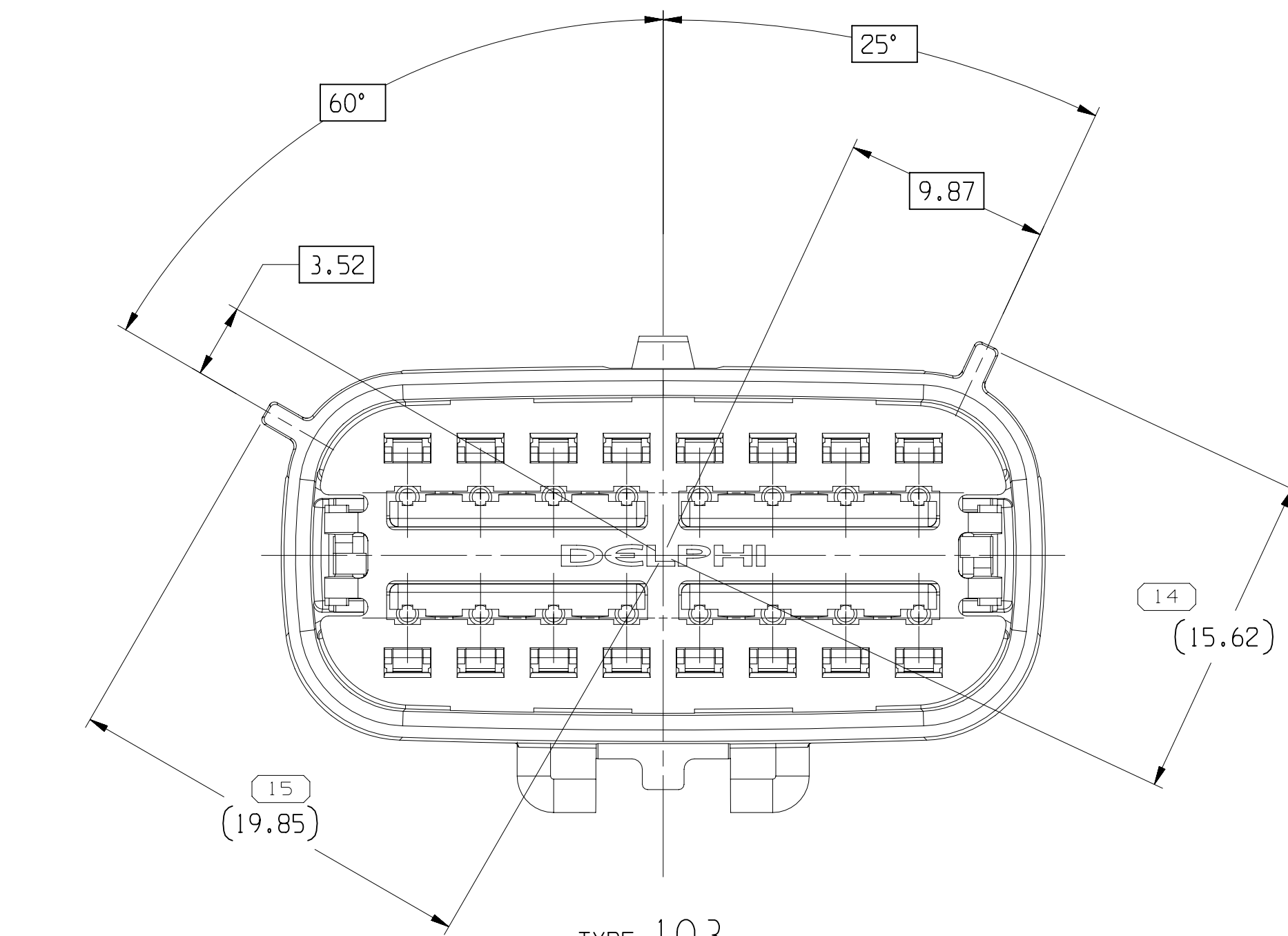
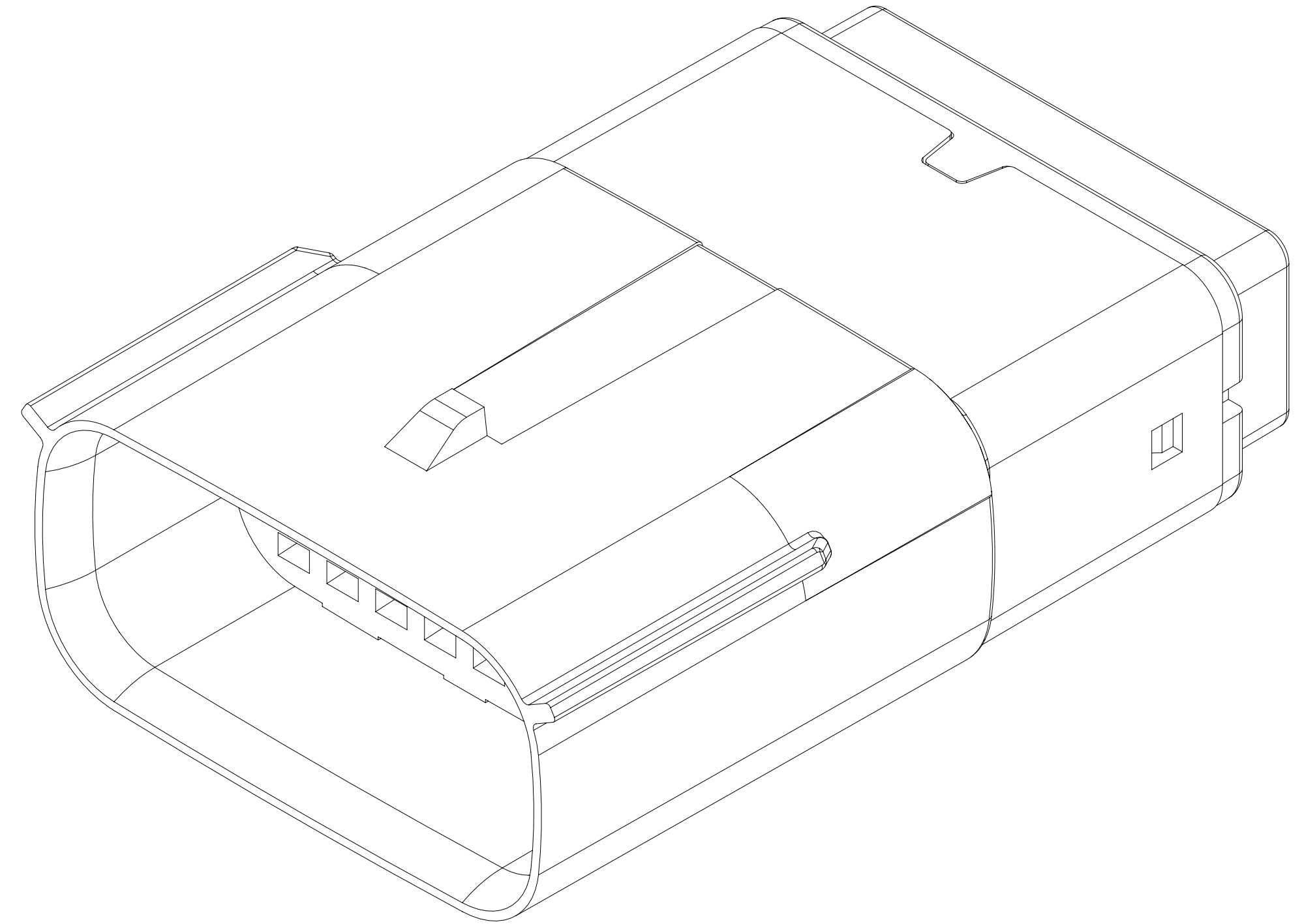

TYPE 103
SAME AS TYPE 101
EXCEPT AS SHOWN

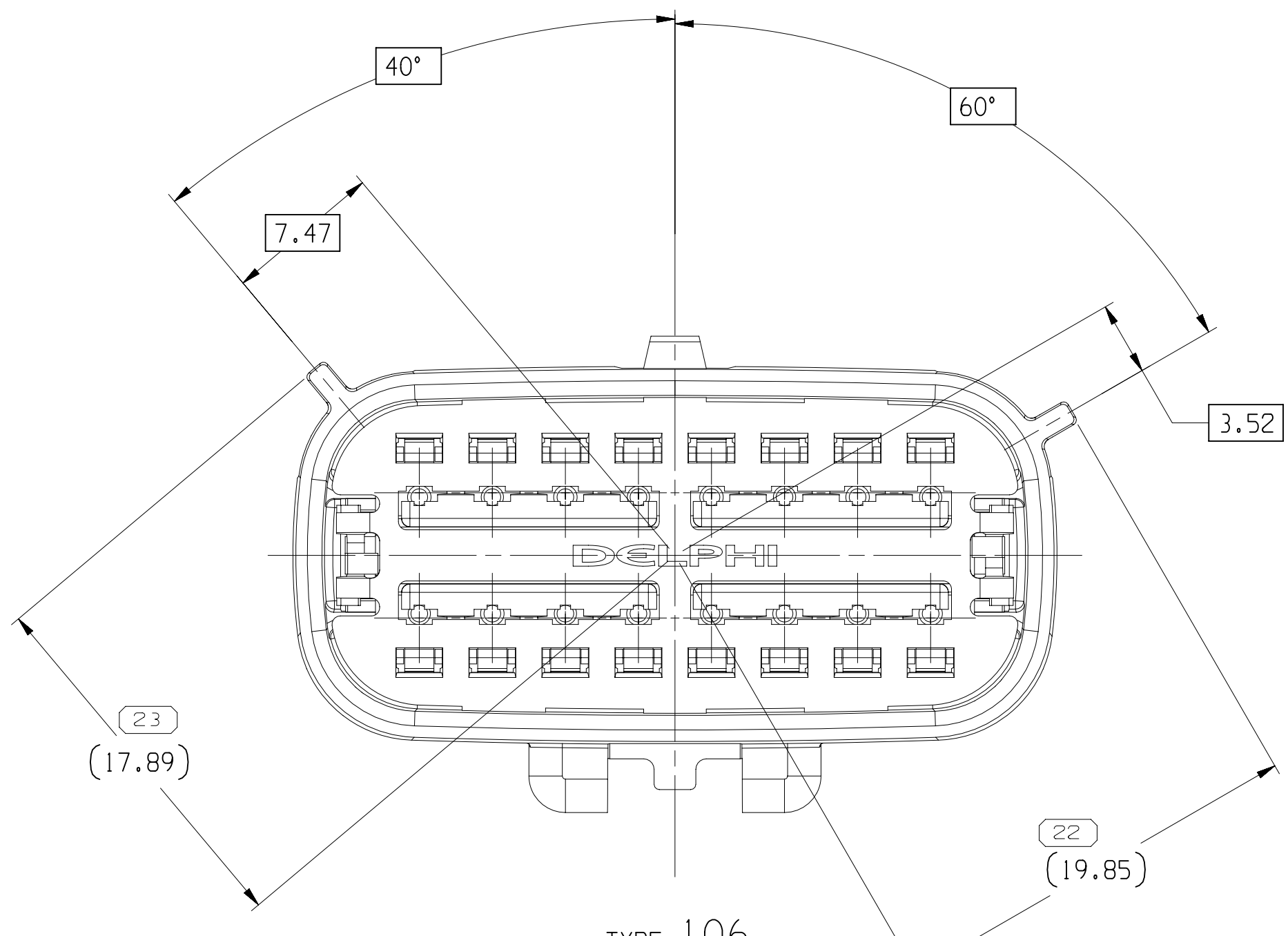

TYPE 106
SAME AS TYPE 101
EXCEPT AS SHOWN

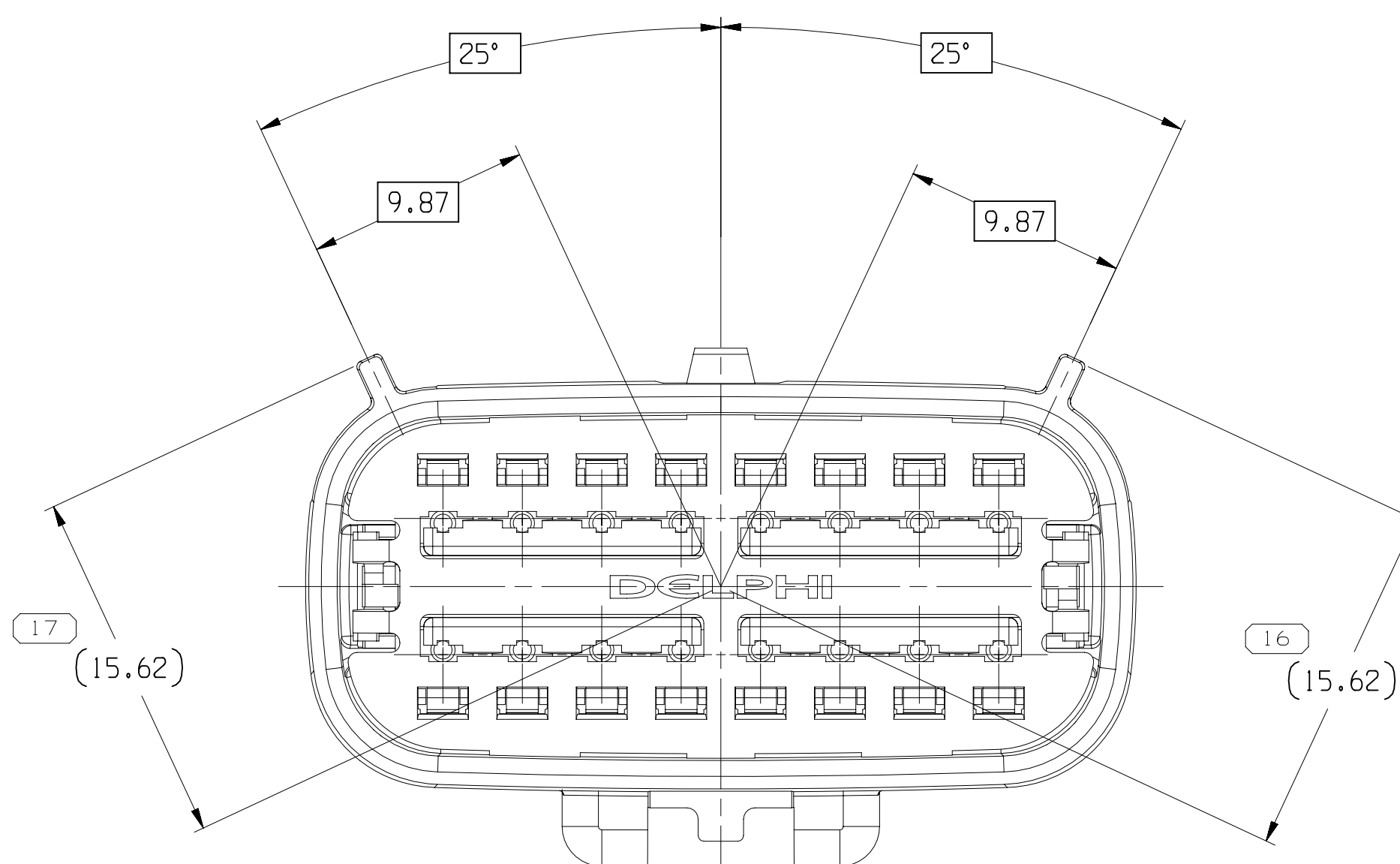
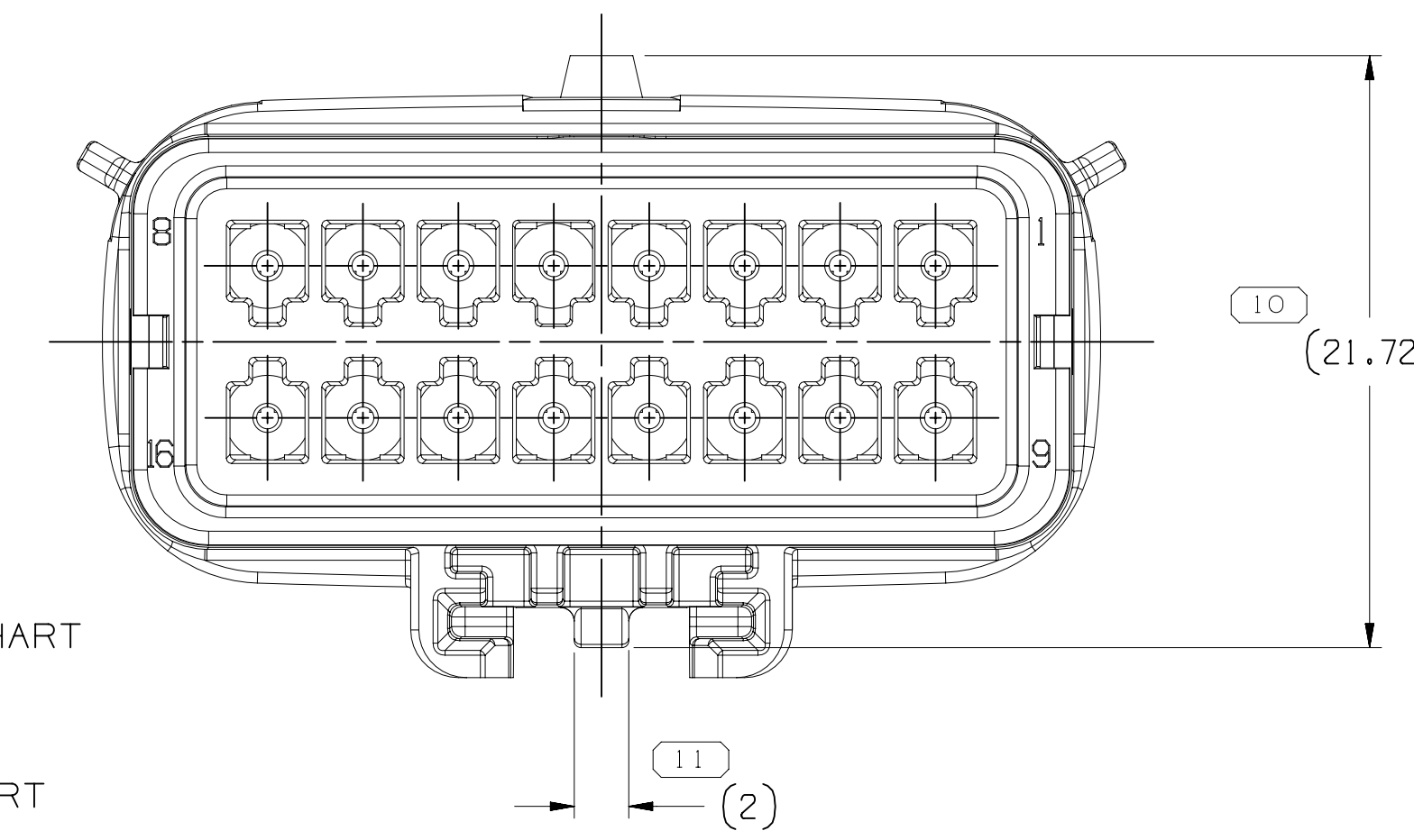
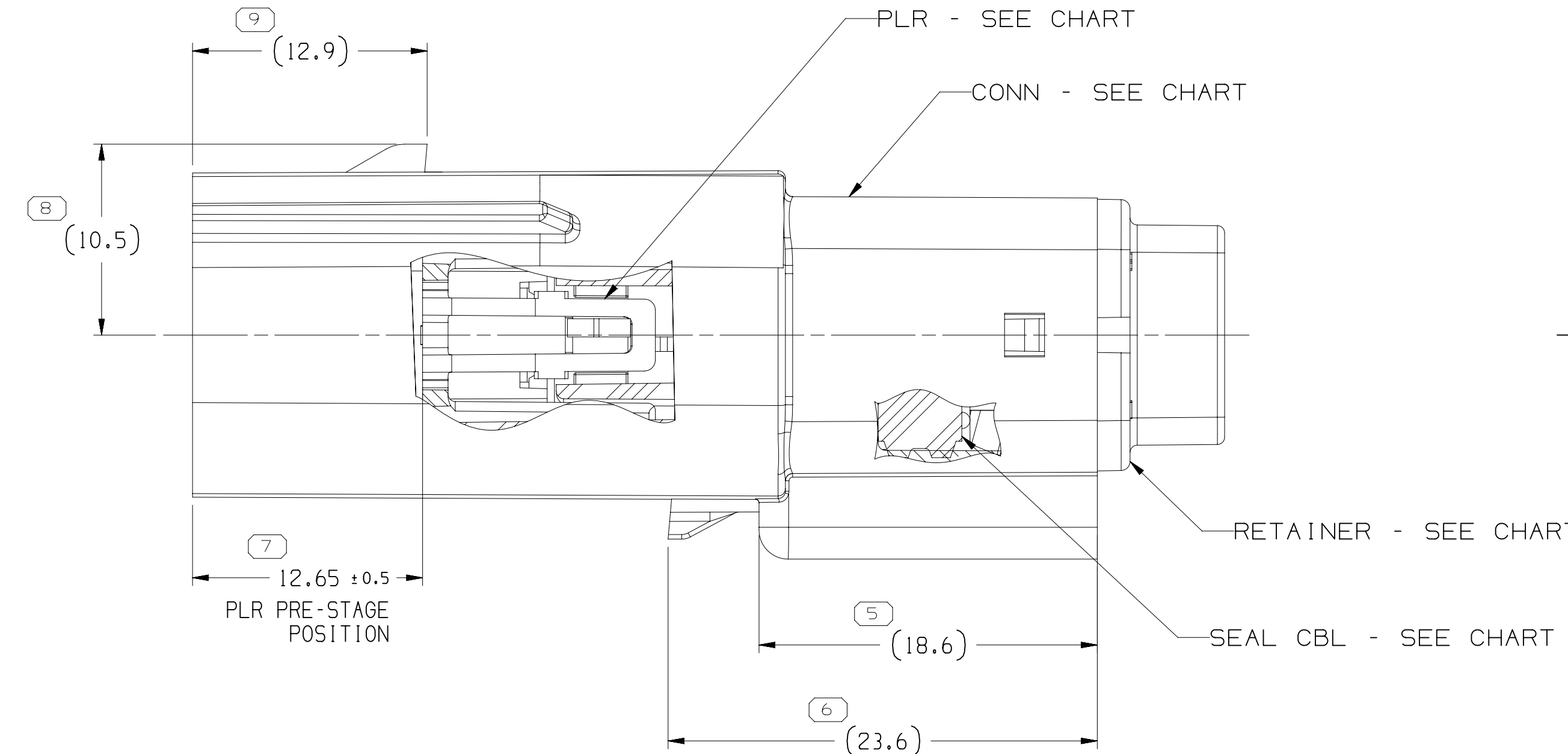

TYPE 104
SAME AS TYPE 101
EXCEPT AS SHOWN

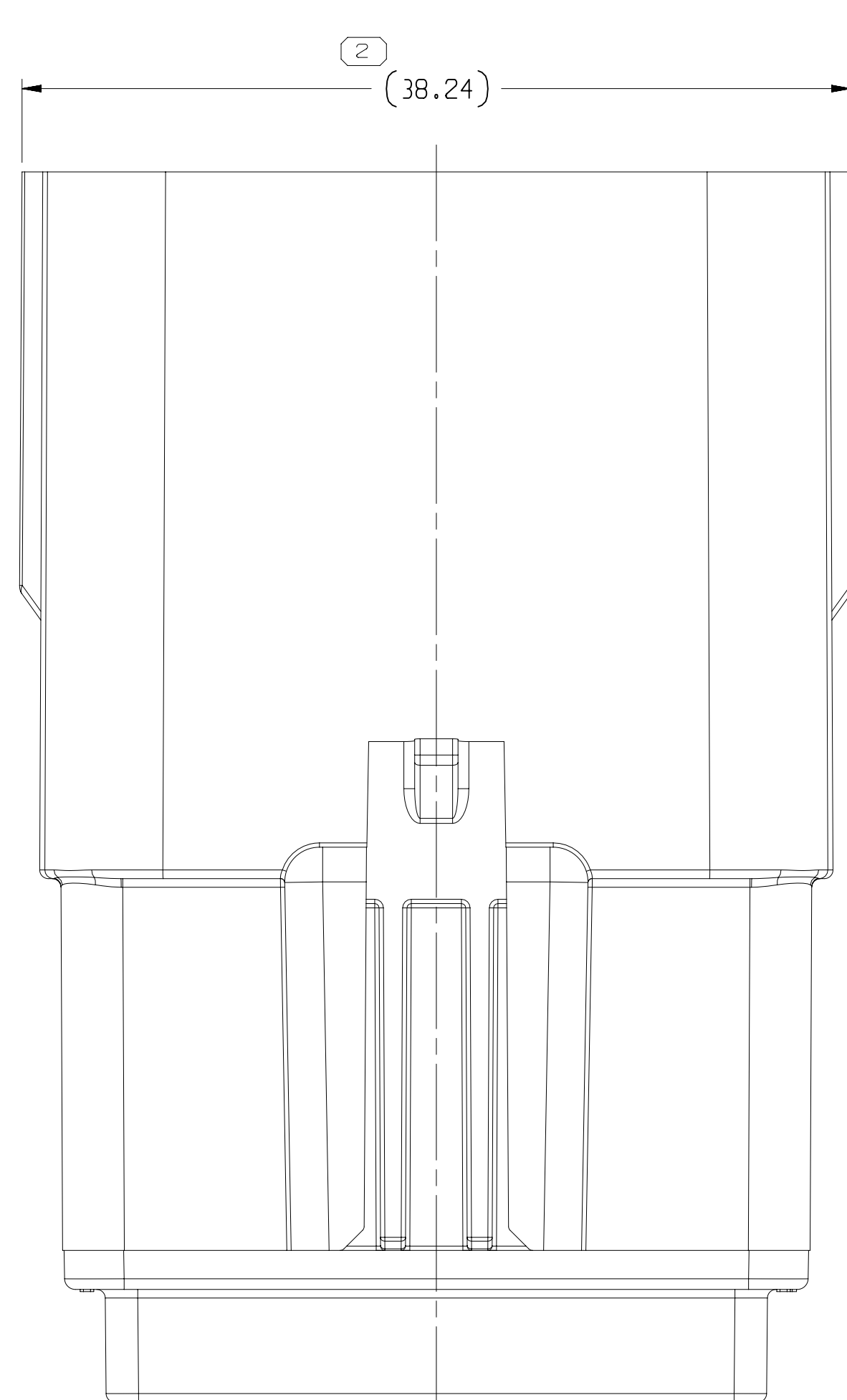

NOTES

- UNLESS OTHERWISE SPECIFIED AND/OR INDICATED:
DIMENSIONS ARE TO FACE OF VIEW SHOWN AND
AUTOMATICALLY ROUNDED BY COMPUTER FOR INSPECTION
(SEE MATH MODEL FOR PRECISE DIMENSIONS). FOR ALL
OTHER DIMENSIONS NOT SHOWN BUT REQUIRED FOR TOOL
BUILD, SEE MATH MODEL FOR PRECISE TOOL PATH DATA.
- THIS PRODUCT IS NOT CATEGORIZED AS AN APPEARANCE ITEM. MINOR
IMPERFECTIONS INCLUDING, BUT NOT LIMITED TO, FLOW MARKS, COLOR
BLEMISHES, GATE VESTIGE, AND SOFT FLASH THAT DO NOT AFFECT THE
FIT, FORM, OR FUNCTION OF THE PART ARE PERMISSIBLE PER ENP-4-3.CS.01-EN.
- PART IS MANUFACTURED TO GEOMETRIC TOLERANCES. CENTERLINE
DIMENSIONS ARE FOR REFERENCE ONLY.
- SEALING CODE 4 - DESIGN WILL MEET REQUIREMENTS OF SAE/USCAR-2
CONNECTOR SYSTEM ENVIRONMENTAL TEST FLOWCHART
(PRESSURE/VACUUM AND SUBMERSION).
- FOR APPLICATION DATA SEE THE INDIVIDUAL APPLICATION DRAWINGS.
- FOR DIFFERENT PUNCH PATTERN CONFIGURATIONS (IF AVAILABLE) SEE SHEET 2.
- FOR ASSEMBLIES WITH 7MM CLIP SLOT SEE DRAWING 15521026.
- MINIMUM RETAINER DISENGAGE FORCE: 60N.

35021692	01	AC	106	35021695	15521010	15514457	15521007	F
35021691	01	AC	105	35021684	15521010	15514457	15521007	E
35021690	01	AC	104	35021683	15521010	15514457	15521007	D
35021689	01	AC	103	35021682	15521010	15514457	15521007	C
35021688	01	AD	102	35021681	15521010	15514457	15521007	B
35021687	01	AC	101	35021680	15521010	15514457	15521007	A
PART NO	REV	N/P	TYPE	MALE CONN	PLR	RETAINER	SEAL CBL	USCAR KEY OPTION

UNLESS OTHERWISE SPECIFIED	PROCESS SENSITIVE DIMENSION
DIMENSIONS ENCLOSED IN [] INDICATE REFERENCE DIMENSIONS AND NO TOLERANCE LIMITS ARE ESTABLISHED	
THIRD ANGLE PROJECTION	DO NOT SCALE
USE MATH DATA	

THIRD ANGLE PROJECTION	DO NOT SCALE
USE MATH DATA	

•APTIV•	
CONNECTION SYSTEMS	
COPYRIGHT 2017 APTIV. ALL RIGHTS RESERVED.	
THIS DRAWING IS THE PROPERTY OF APTIV AND CONTAINS APTIV CONFIDENTIAL INFORMATION. THE REPRODUCTION, DISTRIBUTION AND UTILIZATION OF THIS DOCUMENT OR ITS RELATED CAD DATA, AS WELL AS COMMUNICATION OF ANY CONTENT TO OTHERS, WITHOUT EXPRESS AUTHORIZATION, IS PROHIBITED.	
DATE	DATE
DR	DR
APPROV1 ARMANDO HERNANDEZ	15FE17
APPROV2 ARMANDO HERNANDEZ	15FE17
APPROV3 JORGE ESCAMILLA	15FE17
APPROV4	
APPROV5	
SUBSTANCES OF CONCERN AND RECYCLED CONTENT: P001 APTIV13 (10/24/2013)	
PROPERTY SEE CHART	
DRAWING NAME TAXI1 ASM CONN 16 1.5	
DRAWING NUMBER 35021693	
SIZE A1x3	SCALE 4:1
PAGE NO 2 OF 2	SHEET NO 1 OF 2
REV 05	REV 05

35021693

Mouser Electronics

Authorized Distributor

Click to View Pricing, Inventory, Delivery & Lifecycle Information:

[Aptiv:](#)

[35021688](#)