

6.4	1/4	M6
Ø A ±0.15/0	STANDARD	METRIC
CLOSE FIT HOLE	SCREW/STUD SIZE	

35387462	01	AB	301	0.813 X 66.40	TIN PLATED COPPER ALLOY	0.75 - 1.00	18	-	X	-	5.1	6.45	4.9	5.32	13.6	9.45	1.5	4.8	2.7
PART NO	REV	N/P	TYPE	MAT'L SIZE	MAT'L SPEC	SIZE (mm²)	ID	M5	M6	M8	B1 ±0.3	B2 ±0.3	(H1)	(H2)	Ø J	K	L	L1 ±0.15	L2 ±0.15
						CABLE	SCREW/STUD SIZE												

SYMBOL DEFINITION		MISSING SYMBOLS	
A DIMENSION WITHOUT AN INSPECTION REPORT SYMBOL DOES NOT REQUIRE INSPECTION. IT MAY BE CONTROLLED ON THE INDIVIDUAL COMPONENT DRAWING.		NO MISSING SYMBOL NUMBER	
		TOTAL NO OF INSPECTIONS REQUIRED	23
		LAST NO. USED	17

DWG STATUS		ZONE		REVISION HISTORY		AUTH		DR		APVD	
DATE	STG	REV	N/P	CHG							
150C19	R	01	-	-	35387462 - WAS LIMITED & SEPARATE DWG. "BEFORE COIN" WAS "BELOW COIN" ON DIMS #1-3, MAT'L SIZE WAS 0.813 X 66.44, DIM #5 WAS (5.72), DIM #7 WAS 17, DIM #8 WAS 27.55 & DIM #9 WAS 3.16, ADDED L1 & L2 TO CHART, DIMENSIONS #14-15 & INSPECTION SYMBOLS #16-17 AND REMOVED TAB POSITION INFO	444564	LXA	JAA	AGH		
15SE20	R	02	-	-	35387462 - UPDATED PART AVAILABILITY	552448	JLL	CBD	AGH		

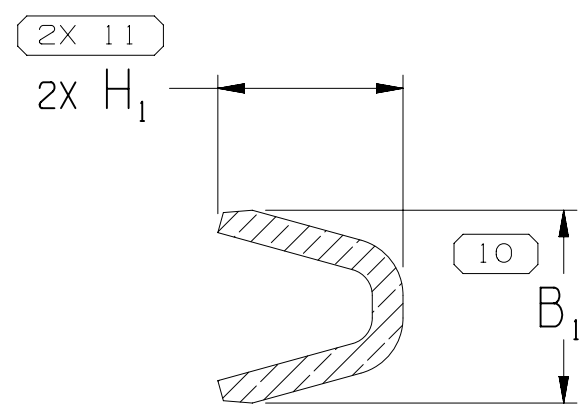
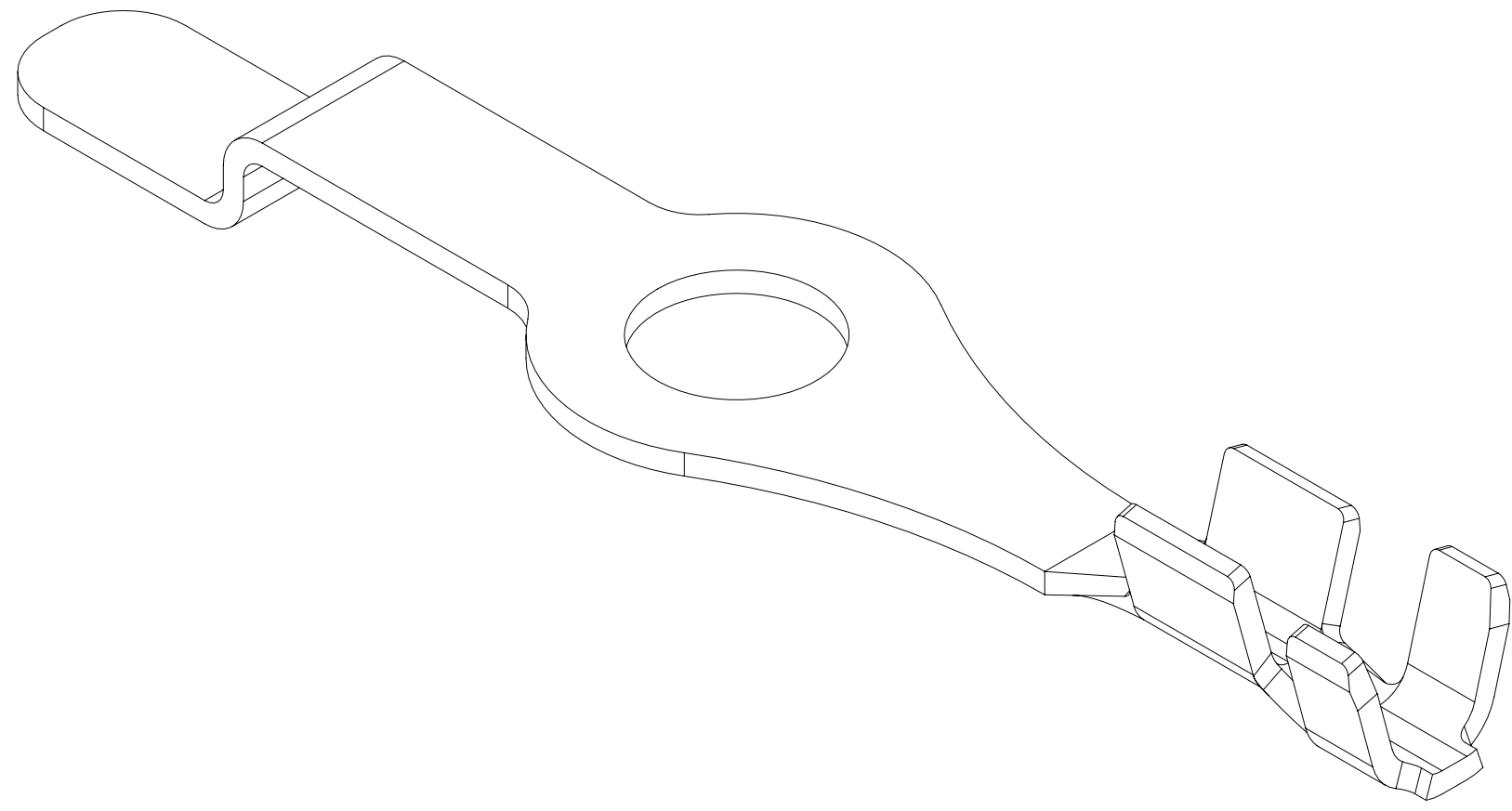

SECTION A-A
CORE WINGS
VIEW

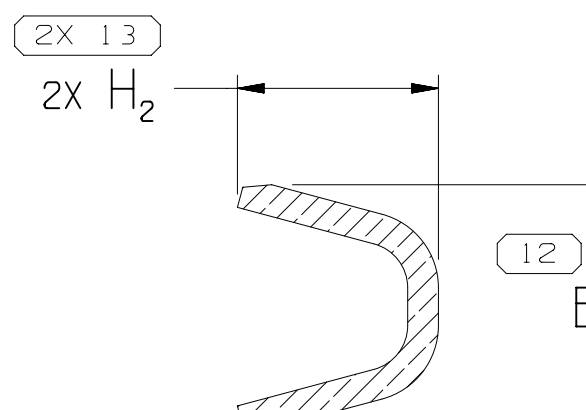

SECTION C-C
INSULATION WINGS
VIEW

NOTES

- UNLESS OTHERWISE SPECIFIED AND/OR INDICATED:
 - DIMENSIONS ARE TO FACE OF VIEW SHOWN AND AUTOMATICALLY ROUNDED BY COMPUTER FOR INSPECTION (SEE MATH MODEL FOR PRECISE DIMENSIONS). FOR ALL OTHER DIMENSIONS NOT SHOWN BUT REQUIRED FOR TOOL BUILD, SEE MATH MODEL FOR PRECISE TOOL PATH DATA.
- VISIBLE CRACKS ARE NOT PERMISSIBLE.
- R 0.4 PERMISSIBLE ON ALL "SHARP" CORNERS.
- "PXX" INDICATES "P" PLUS LAST TWO DIGITS OF MAKE DIE SERIES NUMBER (P01, P02, P03, ETC.).
- PARTS ARE SYMMETRICAL ABOUT CENTERLINE.
- TERMINAL SHALL BE FREE DEBRIS, RESIDUAL ABRASIVE MATERIALS, CORROSION PRODUCTS AND ANY EXTERNAL RESIDUES, NO LUBE EXCESS IS PERMISSIBLE.
- PARTS MUST BE FREE OF BURRS, OR OTHER IMPERFECTIONS THAT AFFECT FUNCTION OR FIT OF PARTS.

A LINE DRAWN THROUGH A PART NUMBER INDICATES THAT PHYSICAL PARTS ARE NOT AVAILABLE FOR ORDERING.	
PART NUMBERS THAT DO NOT HAVE A LINE PRESENT INDICATE THAT PHYSICAL PARTS ARE AVAILABLE FOR ORDERING.	
CONTACT APTIV SALES TO ASSURE AVAILABILITY OF PARTS.	
DWG TYPE	PART DRAWING
STYLE	
VOLUME (CM³)	DISTR CODE
UNLESS OTHERWISE SPECIFIED	
THIS DOCUMENT IS IN ACCORDANCE WITH ASME Y14.5-2009, SEE APTIV ENGINEERING DESIGN STANDARD 06 2017 FOR ISO 1101:2004 RECONCILIATION REQUIREMENTS.	
ALL DIMENSIONS ARE IN MILLIMETERS	
REFERENCE	

THIRD ANGLE PROJECTION	DO NOT SCALE	USE MATH DATA
------------------------	--------------	---------------

• APTIV •	
CONNECTION SYSTEMS	
WARREN, OH	
COPYRIGHT 2019 APTIV. ALL RIGHTS RESERVED.	
THIS DRAWING IS THE PROPERTY OF APTIV AND CONTAINS APTIV CONFIDENTIAL INFORMATION. THE REPRODUCTION, DISTRIBUTION AND UTILIZATION OF THIS DOCUMENT OR ITS RELATED CAD DATA, AS WELL AS COMMUNICATION OF ANY CONTENT TO OTHERS, WITHOUT EXPRESS AUTHORIZATION, IS PROHIBITED.	
DR	DATE
APVD1: XAVIER ALEJANDRO	150C19
APVD2: J.S. ALVARADO	160C19
APVD3: ANGELES GALLEGOS	170C19
APVD4	
APVD5	
SUBSTANCES OF CONCERN AND RECYCLED CONTENT PER APTIV (094900)	
MATERIAL SEE CHART	
DRAWING NAME	
TAXI TERM RING SN	
DRAWING NUMBER	
35201848	
SIZE	SCALE
A0	5:1
FRAME NO	1 OF 1
SHEET NO	3 OF 3
STG	REV
R	02

Mouser Electronics

Authorized Distributor

Click to View Pricing, Inventory, Delivery & Lifecycle Information:

[Aptiv:](#)
[35387462](#)