

SECTION A-A

TPA IN PRE LOCK POSITION

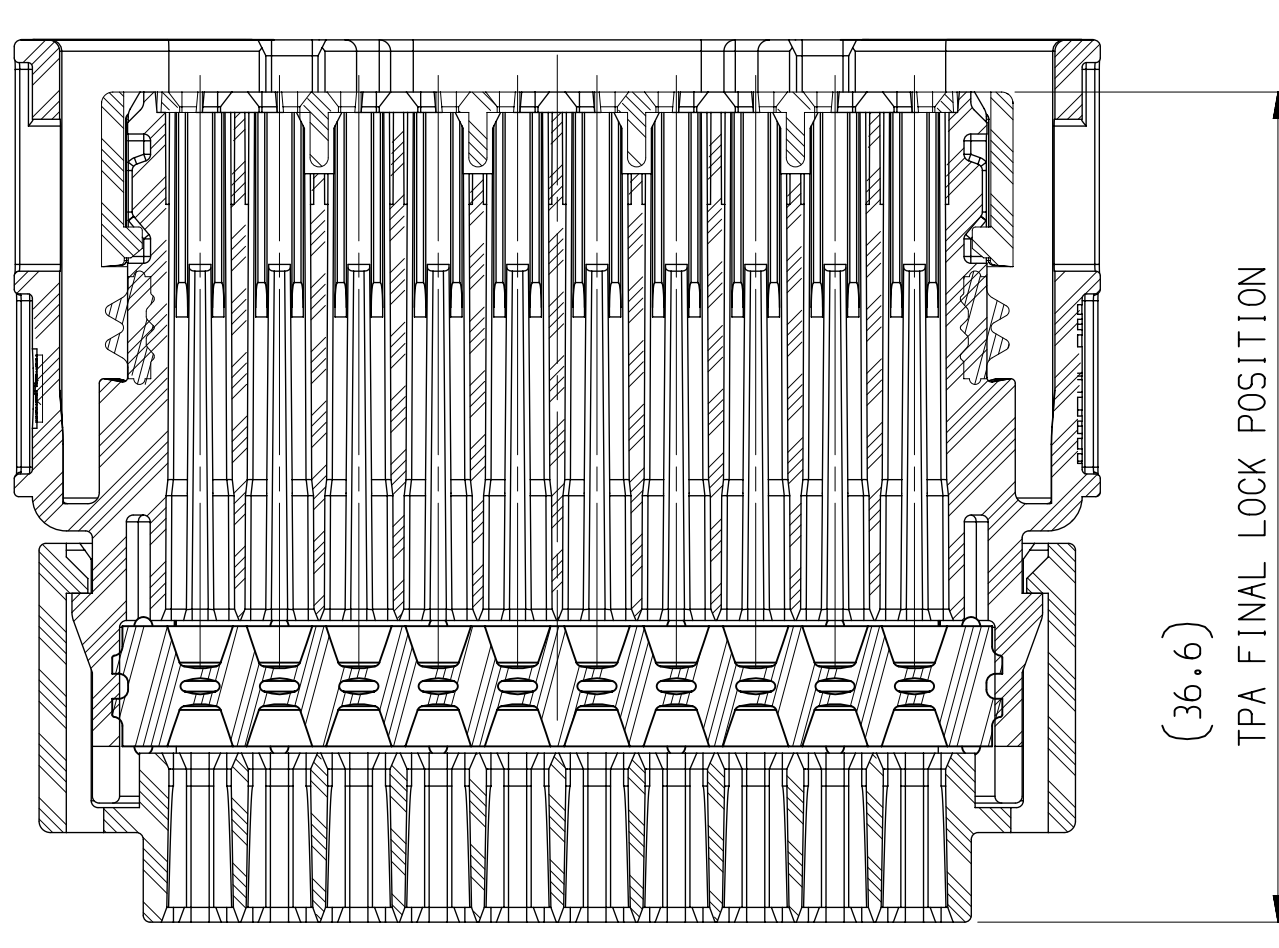
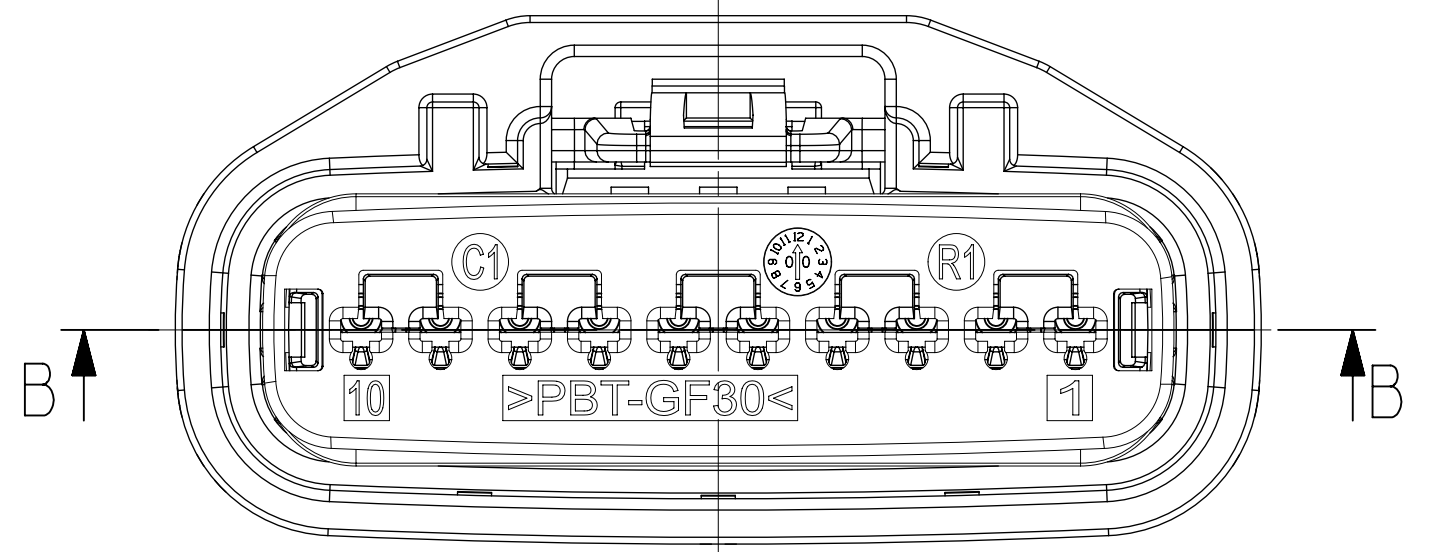

SECTION B-B

TPA IN FINAL LOCK POSITION

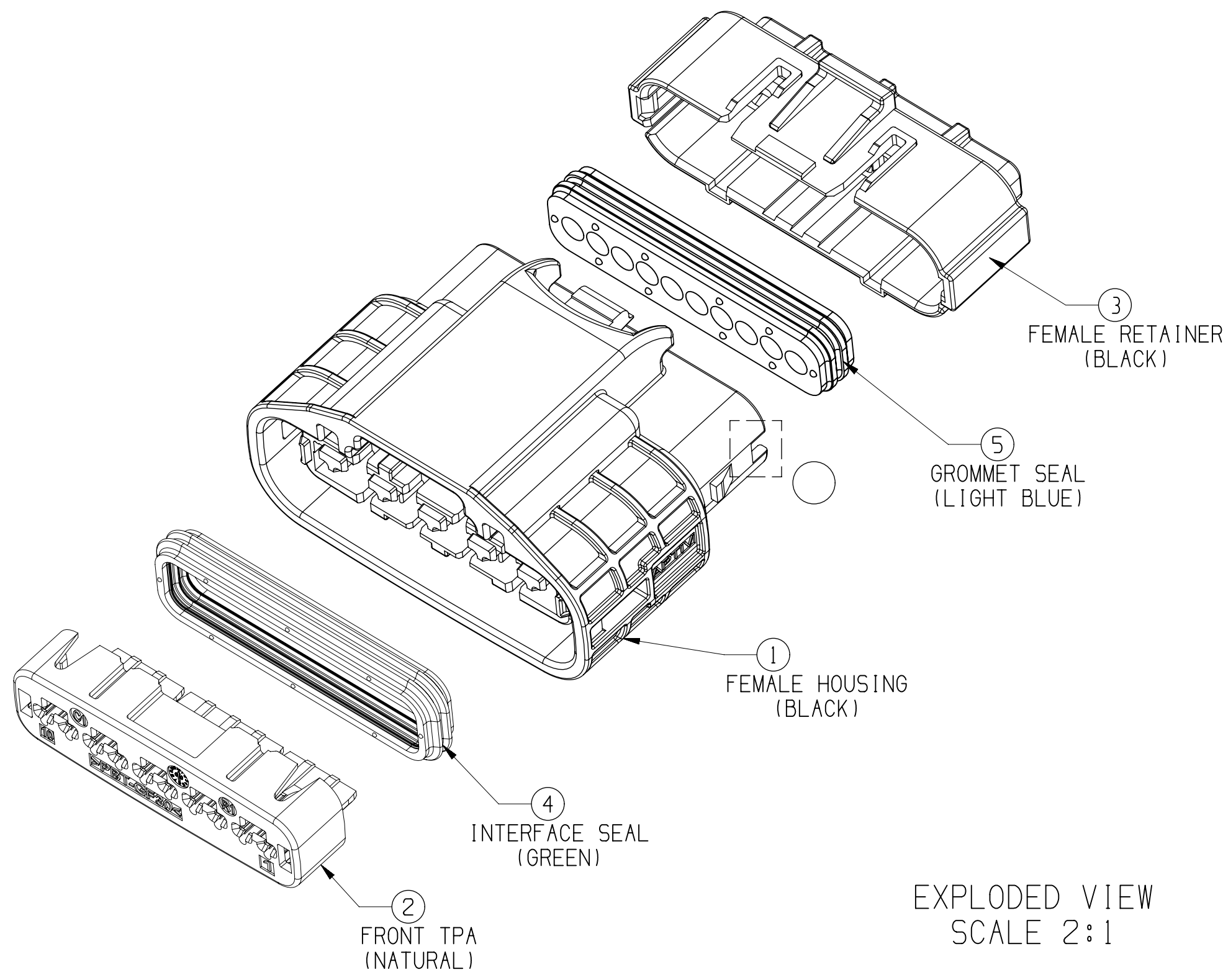

EXPLODED VIEW
SCALE 2:1

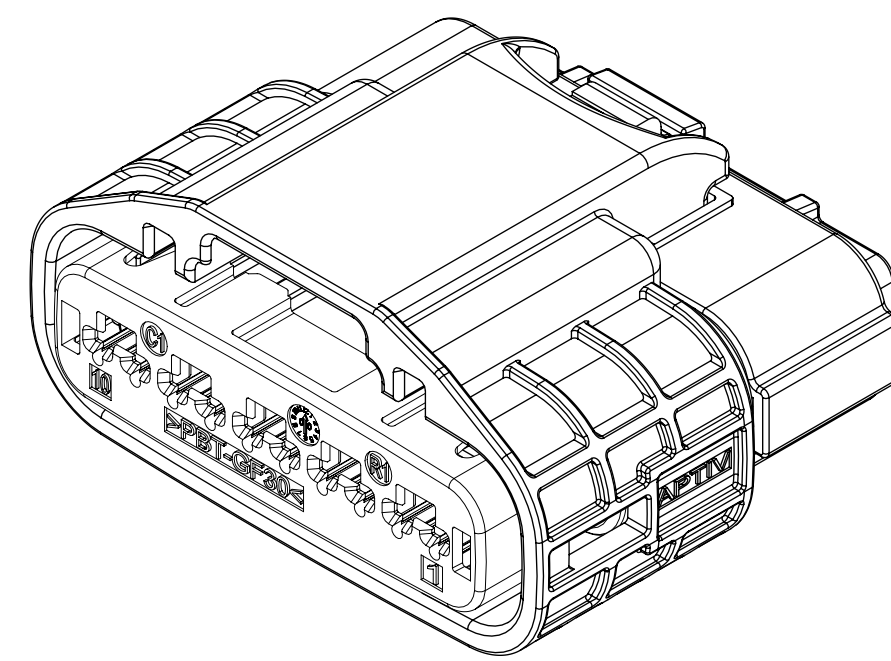

ISOMETRIC VIEW
SCALE 2:1

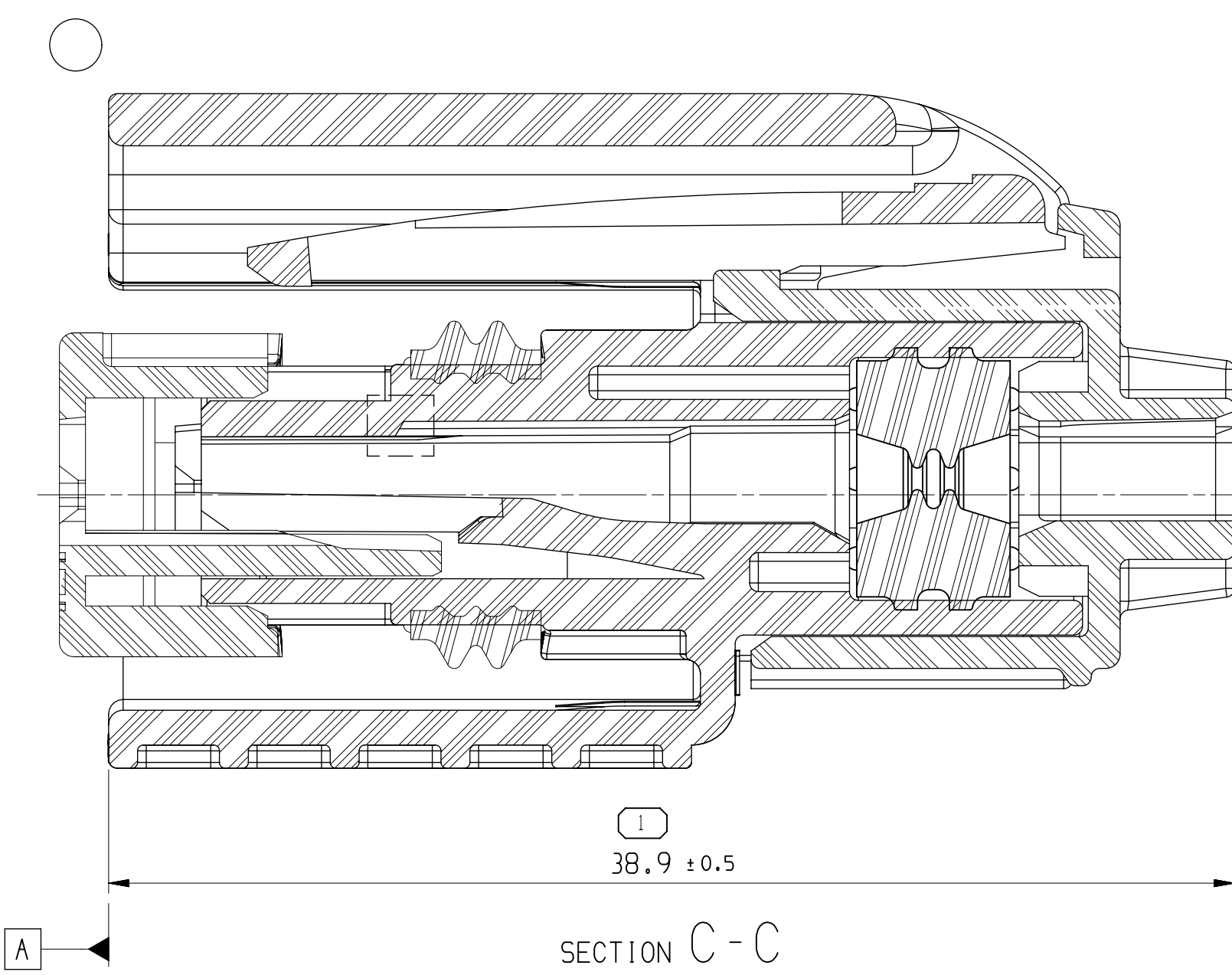
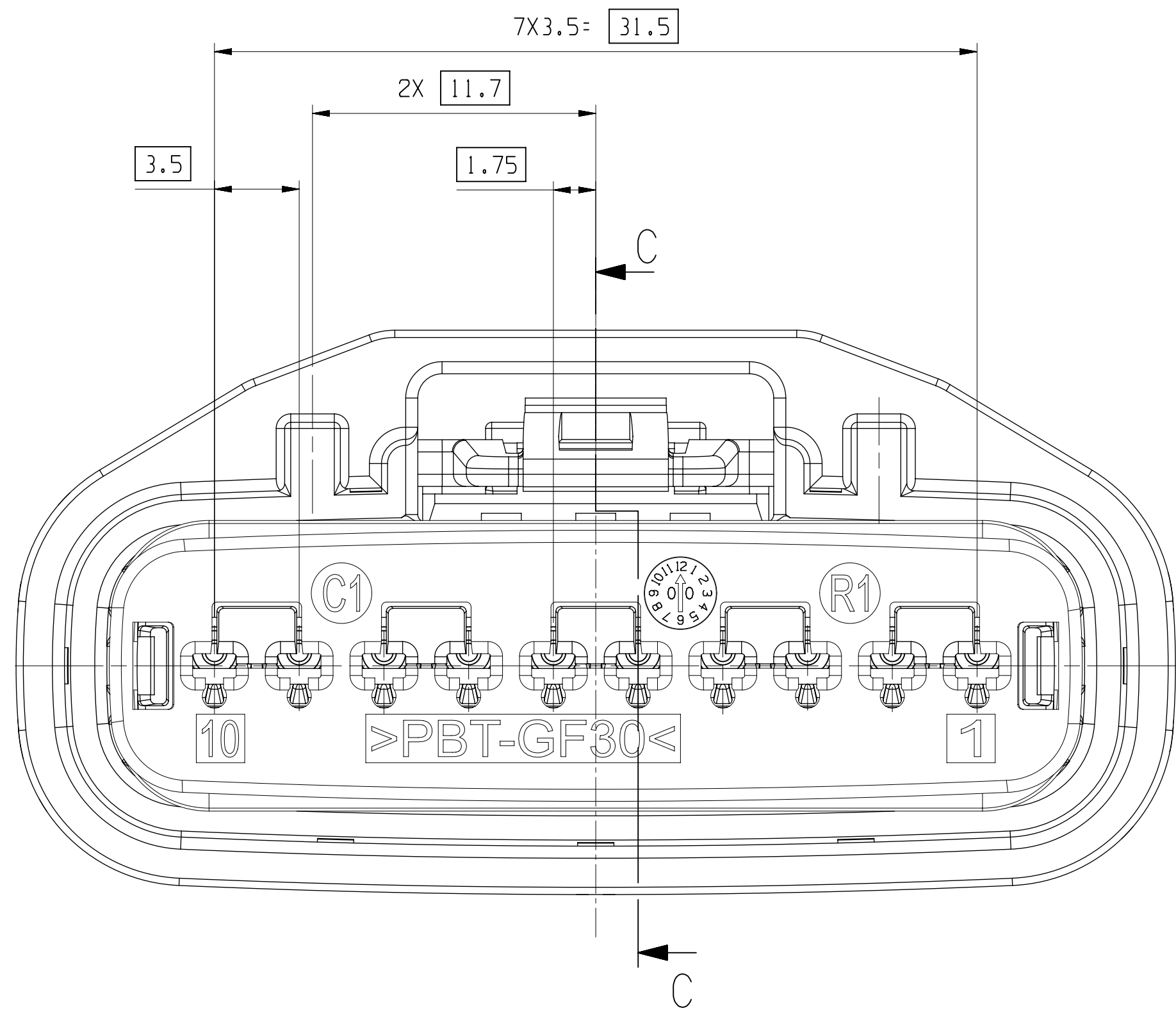

SECTION C-C

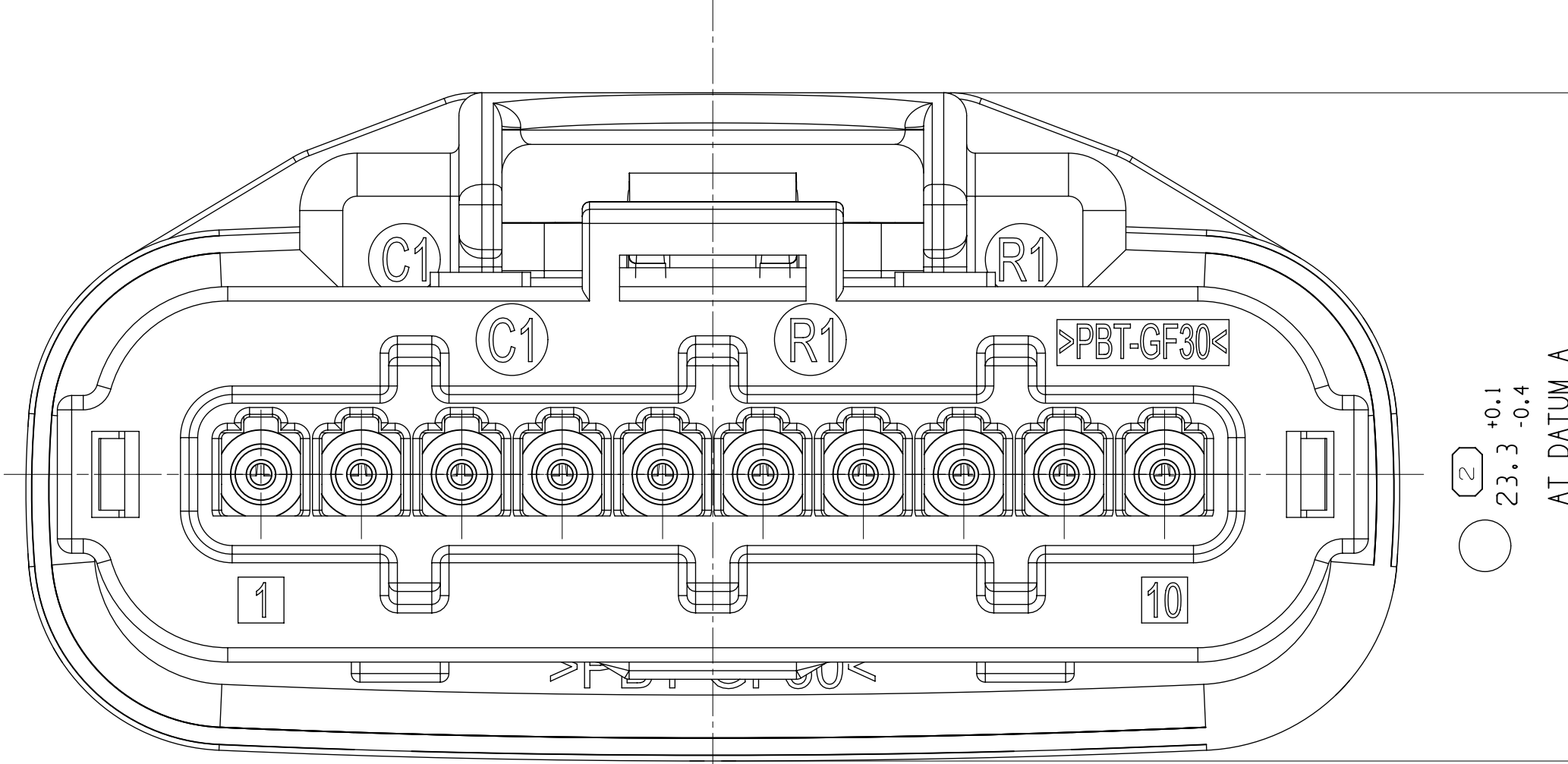

35190401	5	1	GROMMET SEAL	SILICONE RUBBER	LIGHT BLUE	35190410
	4	1	INTERFACE SEAL	SILICONE RUBBER	GREEN	35190408
	3	1	FEMALE RETAINER	PBT GF 30	BLACK	35190406
	2	1	FEMALE TPA	PBT GF 30	NATURAL (WHITE)	35190405
	1	1	FEMALE HOUSING	PBT GF 30	BLACK	35190402
ASSEMBLY P/N	REP.	QTY.	DESCRIPTION	MATERIAL	COLOR	APTIV P/N

ASSOCIATED PARTS					
FEMALE TERMINALS		PART NUMBER		WIRE SIZE (mm ²)	TYPE
Apex150	Sn PLATING	54002000	13624983	0.3 - 0.5	0.8 X 1.5
	Au PLATING	54002002	13725913		
	Sn PLATING	54001625	13613157	0.75 - 1.25	0.8 X 1.5
	Au PLATING	54001627	13779834		
CAVITY PLUG FOR Apex150		54241629	13613164	CAVITY	PLUG
DESCRIPTION		MVL PART NUMBER	APTIV PART NUMBER		

DIN ISO 2768		Tolerance Class Medium (m)						
Linear Dimensions except for broken edges	Permissible deviations for basic size range (mm)							
	0.5 *1 up to 3	over 3 up to 6	over 6 up to 30	over 30 up to 120	over 120 up to 400	over 400 up to 1000	over 1000 up to 2000	
	±0.1	±0.1	±0.2	±0.3	±0.5	±0.8	±1.2	
Broken edges (radii, chamfers)	Permissible deviations for basic size range (mm)							
	0.5 *1 up to 3	over 3 up to 6			over 6			
	±0.2	±0.5			±1			
	Permissible deviations for ranges of lengths, in mm, of the shorter side of the angle concerned							
Angular dimensions	up to 10	over 10 up to 50	over 50 up to 120		over 120 up to 400		over 400	
	±1°	±0° 30'	±0° 20'		±0° 10'		±0° 5'	
	*) For nominal sizes below 0.5mm, the deviations shall be indicated adjacent to the relevant nominal size(s).							

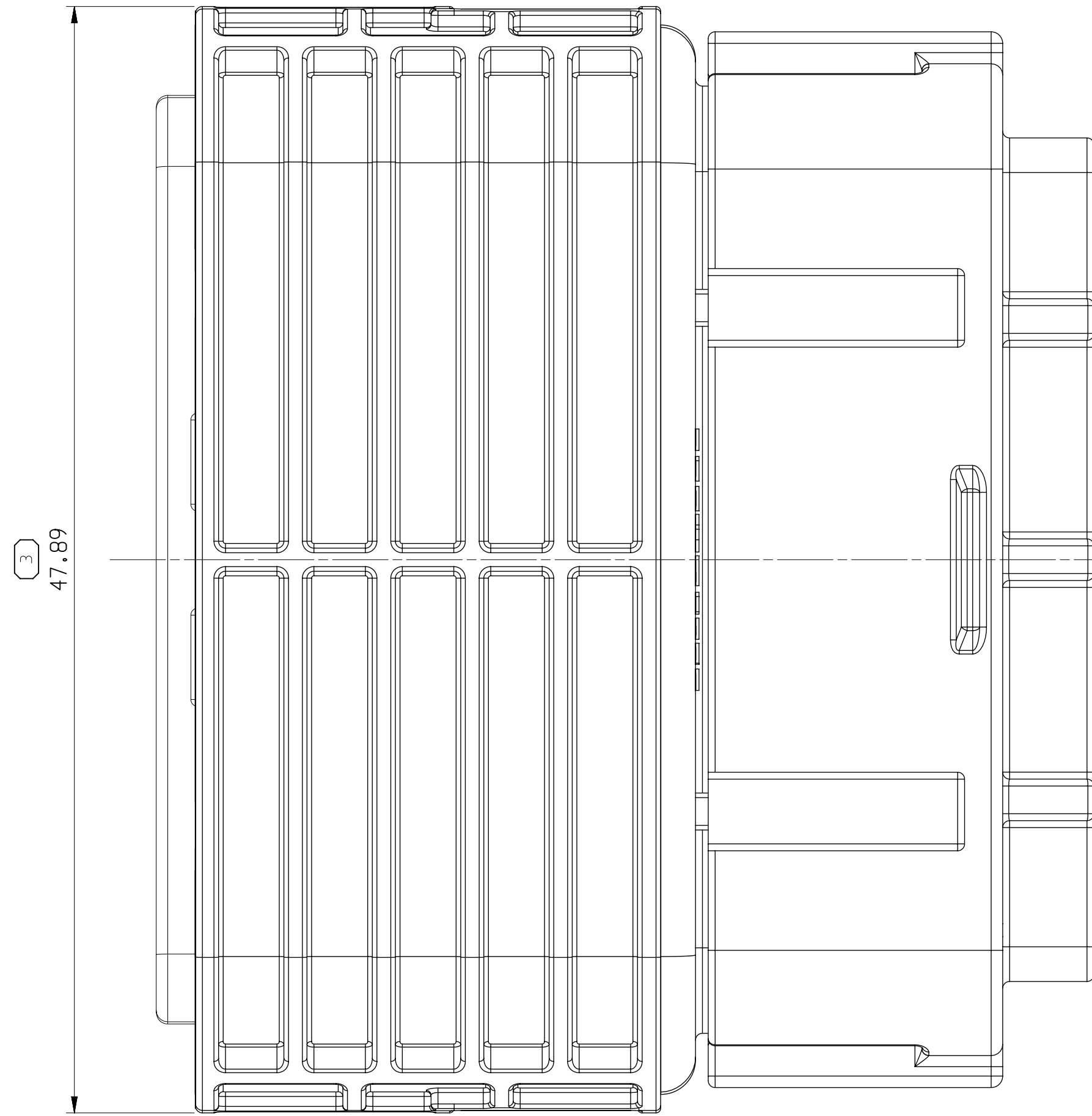

NOTES:

- 1.MAXIMUM TEMPERATURE CLASS: CLASS 111 (125° C)
- 2.TEST METHOD PER: ES91500-00
- 3.ALLOWED WIRE SIZE RANGE: 0.3mm² TO 1.25MM² (JASO WIRE)
- 4.CONNECTOR MAY BE USED WITH THE FOLLOWING TERMINALS: APTIV APEX150 WITH WIRE SIZES DEFINED IN NOTE 3:
- 5.ANNUAL QUALITY REQUIREMENTS: IT IS PERMISSIBLE TO PERFORM CONTINUOUS CONFORMANCE PER APTIV SPECIFICATION.
- 6.MATING MALE INTERFACE DRAWING NO.:35179818

		PROCESS SENSITIVE DIMENSION	
		DIMENSIONS ENCLOSED IN () INDICATE REFERENCE DIMENSIONS AND NO TOLERANCE LIMITS ARE ESTABLISHED	
DIMENSIONAL RANGE (MM)		CHART 1	
FROM	TO	FROM	TO
0	> 0	> 0	> 300
> 0	> 25	> 30	> 400
> 25	> 30	> 40	> 500
> 30	> 40	> 50	> 600
> 40	> 50	> 60	> 700
> 50	> 60	> 70	> 800
> 60	> 70	> 80	> 900
> 70	> 80	> 90	> 1000
> 80	> 90	> 100	> 1250
> 90	> 100	> 125	> 1500
> 100	> 125	> 150	> 2000
> 125	> 150	> 200	> 2500
> 150	> 200	> 250	> 3000
> 200	> 250	> 300	> 4000
> 250	> 300	> 400	> 5000
> 300	> 400	> 500	> 6000
> 400	> 500	> 600	> 7000
> 500	> 600	> 700	> 8000
> 600	> 700	> 800	> 9000
> 700	> 800	> 900	> 10000
> 800	> 900	> 1000	> 12500
> 900	> 1000	> 1250	> 15000
> 1000	> 1250	> 1500	> 20000
> 1250	> 1500	> 2000	> 25000
> 1500	> 2000	> 2500	> 30000
> 2000	> 2500	> 3000	> 40000
> 2500	> 3000	> 4000	> 50000
> 3000	> 4000	> 5000	> 60000
> 4000	> 5000	> 6000	> 70000
> 5000	> 6000	> 7000	> 80000
> 6000	> 7000	> 8000	> 90000
> 7000	> 8000	> 9000	> 100000
> 8000	> 9000	> 10000	> 125000
> 9000	> 10000	> 12500	> 150000
> 10000	> 12500	> 15000	> 200000
> 12500	> 15000	> 20000	> 250000
> 15000	> 20000	> 25000	> 300000
> 20000	> 25000	> 30000	> 400000
> 25000	> 30000	> 40000	> 500000
> 30000	> 40000	> 50000	> 600000
> 40000	> 50000	> 60000	> 700000
> 50000	> 60000	> 70000	> 800000
> 60000	> 70000	> 80000	> 900000
> 70000	> 80000	> 90000	> 1000000
> 80000	> 90000	> 100000	> 1250000
> 90000	> 100000	> 125000	> 1500000
> 100000	> 125000	> 150000	> 2000000
> 125000	> 150000	> 200000	> 2500000
> 150000	> 200000	> 250000	> 3000000
> 200000	> 250000	> 300000	> 4000000
> 250000	> 300000	> 400000	> 5000000
> 300000	> 400000	> 500000	> 6000000
> 400000	> 500000	> 600000	> 7000000
> 500000	> 600000	> 700000	> 8000000
> 600000	> 700000	> 800000	> 9000000
> 700000	> 800000	> 900000	> 10000000
> 800000	> 900000	> 1000000	> 12500000
> 900000	> 1000000	> 1250000	> 15000000
> 1000000	> 1250000	> 1500000	> 20000000
> 1250000	> 1500000	> 2000000	> 25000000
> 1500000	> 2000000	> 2500000	> 30000000
> 2000000	> 2500000	> 3000000	> 40000000
> 2500000	> 3000000	> 4000000	> 50000000
> 3000000	> 4000000	> 5000000	> 60000000
> 4000000	> 5000000	> 6000000	> 70000000
> 5000000	> 6000000	> 7000000	> 80000000
> 6000000	> 7000000	> 8000000	> 90000000
> 7000000	> 8000000	> 9000000	> 100000000
> 8000000	> 9000000	> 10000000	> 125000000
> 9000000	> 10000000	> 12500000	> 150000000
> 10000000	> 12500000	> 15000000	> 200000000
> 12500000	> 15000000	> 20000000	> 250000000
> 15000000	> 20000000	> 25000000	> 300000000
> 20000000	> 25000000	> 30000000	> 400000000
> 25000000	> 30000000	> 40000000	> 500000000
> 30000000	> 40000000	> 50000000	> 600000000
> 40000000	> 50000000	> 60000000	> 700000000
> 50000000	> 60000000	> 70000000	> 800000000
> 60000000	> 70000000	> 80000000	> 900000000
> 70000000	> 80000000	> 90000000	> 1000000000
> 80000000	> 90000000	> 100000000	> 1250000000
> 90000000	> 100000000	> 125000000	> 1500000000
> 100000000	> 125000000	> 150000000	> 2000000000
> 125000000	> 150000000	> 200000000	> 2500000000
> 150000000	> 200000000	> 250000000	> 3000000000
> 200000000	> 250000000	> 300000000	> 4000000000
> 250000000	> 300000000	> 400000000	> 5000000000
> 300000000	> 400000000	> 500000000	> 6000000000
> 400000000	> 500000000	> 600000000	> 7000000000
> 500000000	> 600000000	> 700000000	> 8000000000
> 600000000	> 700000000	> 800000000	> 9000000000
> 700000000	> 800000000	> 900000000	> 10000000000
> 800000000	> 900000000	> 1000000000	> 12500000000
> 900000000	> 1000000000	> 1250000000	> 15000000000
> 1000000000	> 1250000000	> 1500000000	> 20000000000
> 1250000000	> 1500000000	> 2000000000	> 25000000000
> 1500000000	> 2000000000	> 2500000000	> 30000000000
> 2000000000	> 2500000000	> 3000000000	> 40000000000
> 2500000000	> 3000000000	> 4000000000	> 50000000000
> 3000000000	> 4000000000	> 5000000000	> 60000000000
> 4000000000	> 5000000000	> 6000000000	> 70000000000
> 5000000000	> 6000000000	> 7000000000	> 80000000000
> 6000000000	> 7000000000	> 8000000000	> 90000000000
> 7000000000	> 8000000000	> 9000000000	> 100000000000
> 8000000000	> 9000000000	> 10000000000	> 125000000000
> 9000000000	> 10000000000	> 12500000000	> 150000000000
> 10000000000	> 12500000000	> 15000000000	> 200000000000
> 12500000000	> 15000000000	> 20000000000	> 250000000000
> 15000000000	> 20000000000	> 25000000000	> 300000000000
> 20000000000	> 25000000000	> 30000000000	> 400000000000
> 25000000000	> 30000000000	> 40000000000	> 500000000000
> 30000000000	> 40000000000	> 50000000000	> 600000000000
> 40000000000	> 50000000000	> 60000000000	> 700000000000
> 50000000000	> 60000000000	> 70000000000	> 800000000000
> 60000000000	> 70000000000	> 80000000000	> 900000000000
> 70000000000	> 80000000000	> 90000000000	> 1000000000000
> 80000000000	> 90000000000	> 100000000000	> 1250000000000
> 90000000000	> 100000000000	> 125000000000	> 1500000000000
> 100000000000	> 125000000000	> 150000000000	> 2000000000000
> 125000000000	> 150000000000	> 200000000000	> 2500000000000
> 150000000000	> 200000000000	> 250000000000	> 3000000000000
> 200000000000	> 250000000000	> 300000000000	> 4000000000000
> 250000000000	> 300000000000	> 400000000000	> 5000000000000
> 300000000000	> 400000000000	> 500000000000	> 6000000000000
> 400000000000	> 500000000000	> 600000000000	> 7000000000000
> 500000000000	> 600000000000	> 700000000000	> 8000000000000
> 600000000000	> 700000000000	> 800000000000	> 9000000000000
> 700000000000	> 800000000000	> 900000000000	> 10000000000000
> 800000000000	> 900000000000	> 1000000000000	> 12500000000000
> 900000000000	> 1000000000000	> 1250000000000	> 15000000000000
> 1000000000000	> 1250000000000	> 1500000000000	> 20000000000000
> 1250000000000	> 1500000000000	> 2000000000000	> 25000000000000
> 1500000000000	> 2000000000000	> 2500000000000	> 30000000000000
> 2000000000000	> 2500000000000	> 3000000000000	> 40000000000000
> 2500000000000	> 3000000000000	> 4000000000000	> 50000000000000
> 3000000000000	> 4000000000000	> 5000000000000	> 60000000000000
> 4000000000000	> 5000000000000	> 6000000000000	> 70000000000000
> 5000000000000	> 6000000000000	> 7000000000000	> 80000000000000
> 6000000000000	> 7000000000000	> 8000000000000	> 90000000000000
> 7000000000000	> 8000000000000	> 9000000000000	> 100000000000000
> 8000000000000	> 9000000000000	> 10000000000000	> 125000000000000
> 9000000000000	> 10000000000000	> 12500000000000	> 150000000000000
> 10000000000000	> 12500000000000	> 15000000000000	> 200000000000000
> 12500000000000	> 15000000000000	> 20000000000000	> 250000000000000
> 15000000000000	> 20000000000000	> 25000000000000	> 300000000000000
> 20000000000000	> 25000000000000	> 30000000000000	> 400000000000000
> 25000000000000	> 30000000000000	> 40000000000000	> 500000000000000
> 30000000000000	> 40000000000000	> 50000000000000	> 600000000000000
> 40000000000000	> 50000000000000	> 60000000000000	> 700000000000000
> 50000000000000	> 60000000000000	> 70000000000000	> 800000000000000
> 60000000000000	> 70000000000000	> 80000000000000	> 900000000000000
> 70000000000000	> 80000000000000	> 90000000000000	> 1000000000000000
> 80000000000000	> 90000000000000	> 100000000000000	> 1250000000000000
> 90000000000000	> 100000000000000	> 125000000000000	> 1500000000000000
> 100000000000000	> 125000000000000	> 150000000000000	> 2000000000000000
> 125000000000000	> 150000000000000	> 200000000000000	> 2500000000000000
> 150000000000000	> 200000000000000	> 250000000000000	> 3000000000000000
> 200000000000000	> 250000000000000	> 300000000000000	> 4000000000000000
> 250000000000000	> 300000000000000	> 400000000000000	> 5000000000000000
> 300000000000000	> 400000000000000	> 500000000000000	> 6000000000000000
> 400000000000000	> 500000000000000	> 600000000000000	> 7000000000000000
> 500000000000000	> 600000000000000	> 700000000000000	> 8000000000000000
> 600000000000000	> 700000000000000	> 800000000000000	> 9000000000000000
> 700000000000000	> 800000000000000	> 900000000000000	> 10000000000000000
> 800000000000000	> 900000000000000	> 1000000000000000	> 12500000000000000
> 900000000000000	> 1000000000000000	> 1250000000000000	> 15000000000000000
> 1000000000000000	> 1250000000000000	> 1500000000000000	> 20000000000000000
> 1250000000000000	> 1500000000000000	> 2000000000000000	> 25000000000000000
> 1500000000000000	> 2000000000000000	> 2500000000000000	> 30000000000000000
> 2000000000000000	> 25		

Mouser Electronics

Authorized Distributor

Click to View Pricing, Inventory, Delivery & Lifecycle Information:

[Aptiv:](#)

[35190401](#)