

TYPE B  
SAME AS TYPE A  
EXCEPT AS SHOWN

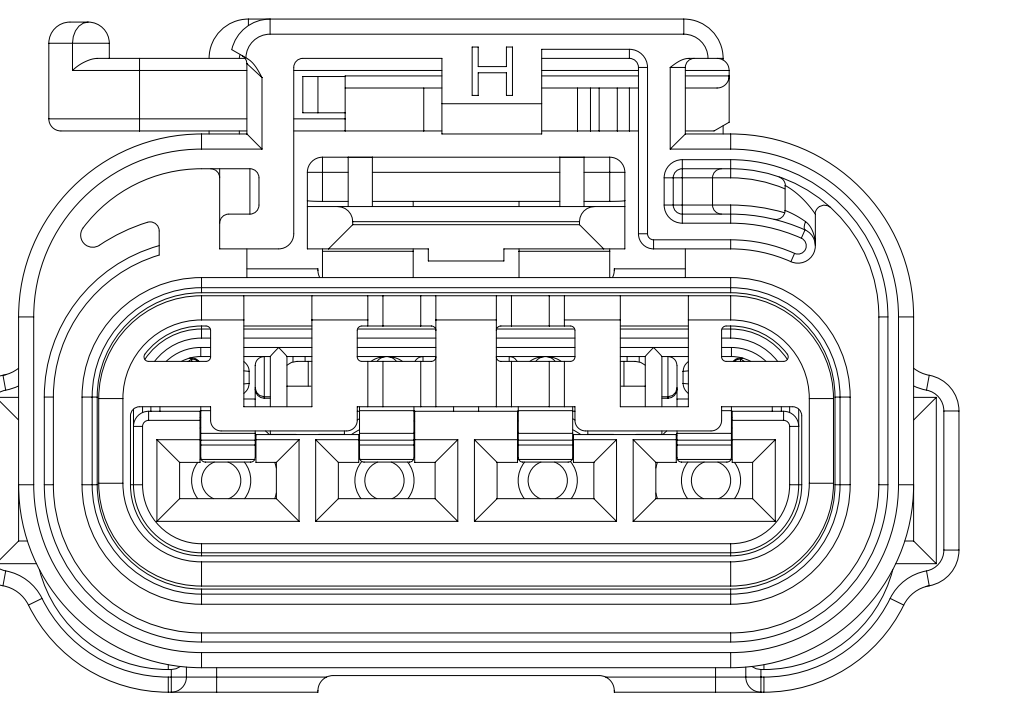

TYPE D  
SAME AS TYPE A  
EXCEPT AS SHOWN

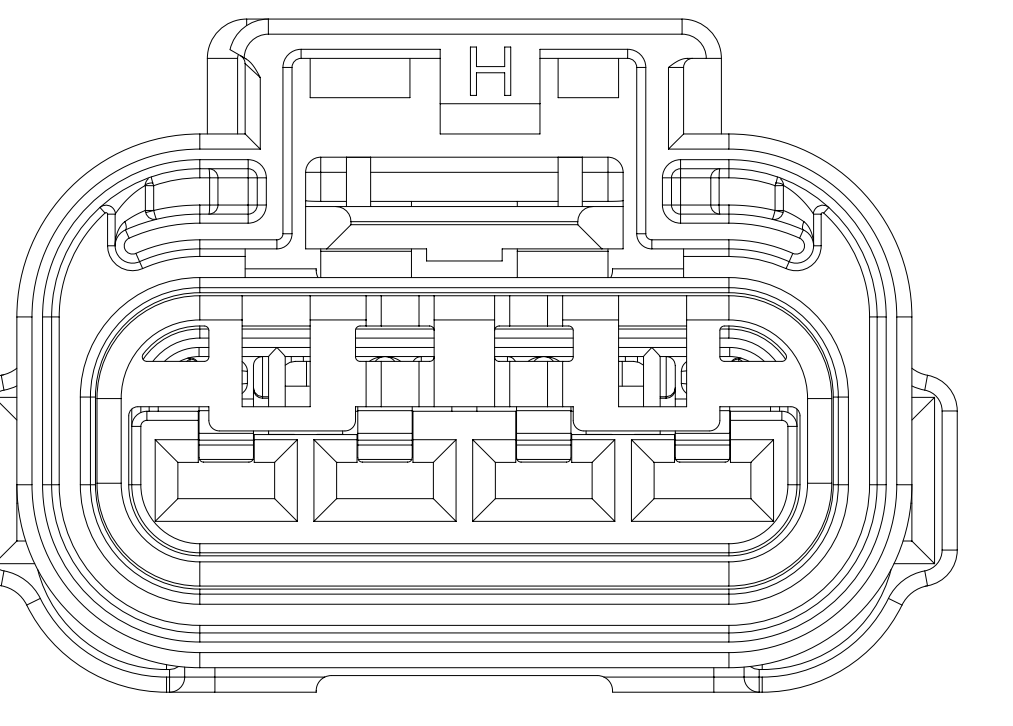

AUXILIARY FRONT VIEW  
TYPE A - MATT SEAL W/O HOLES

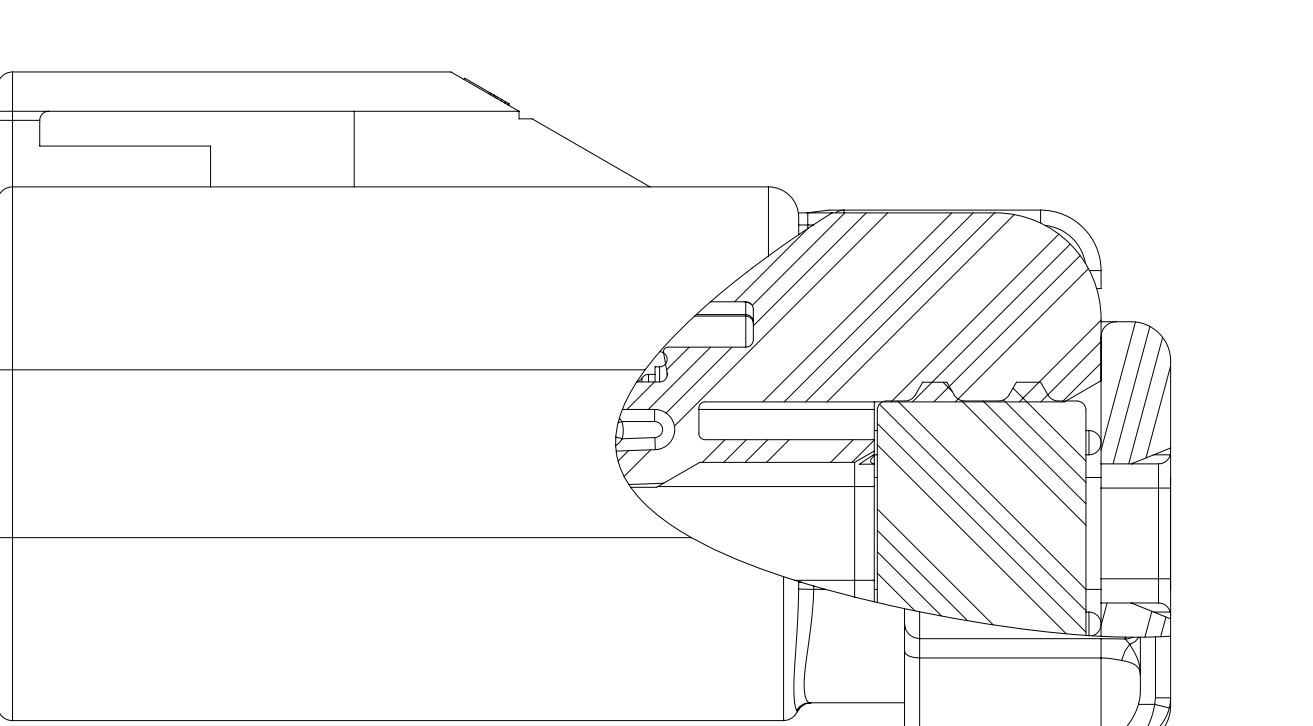

SECTION A-A

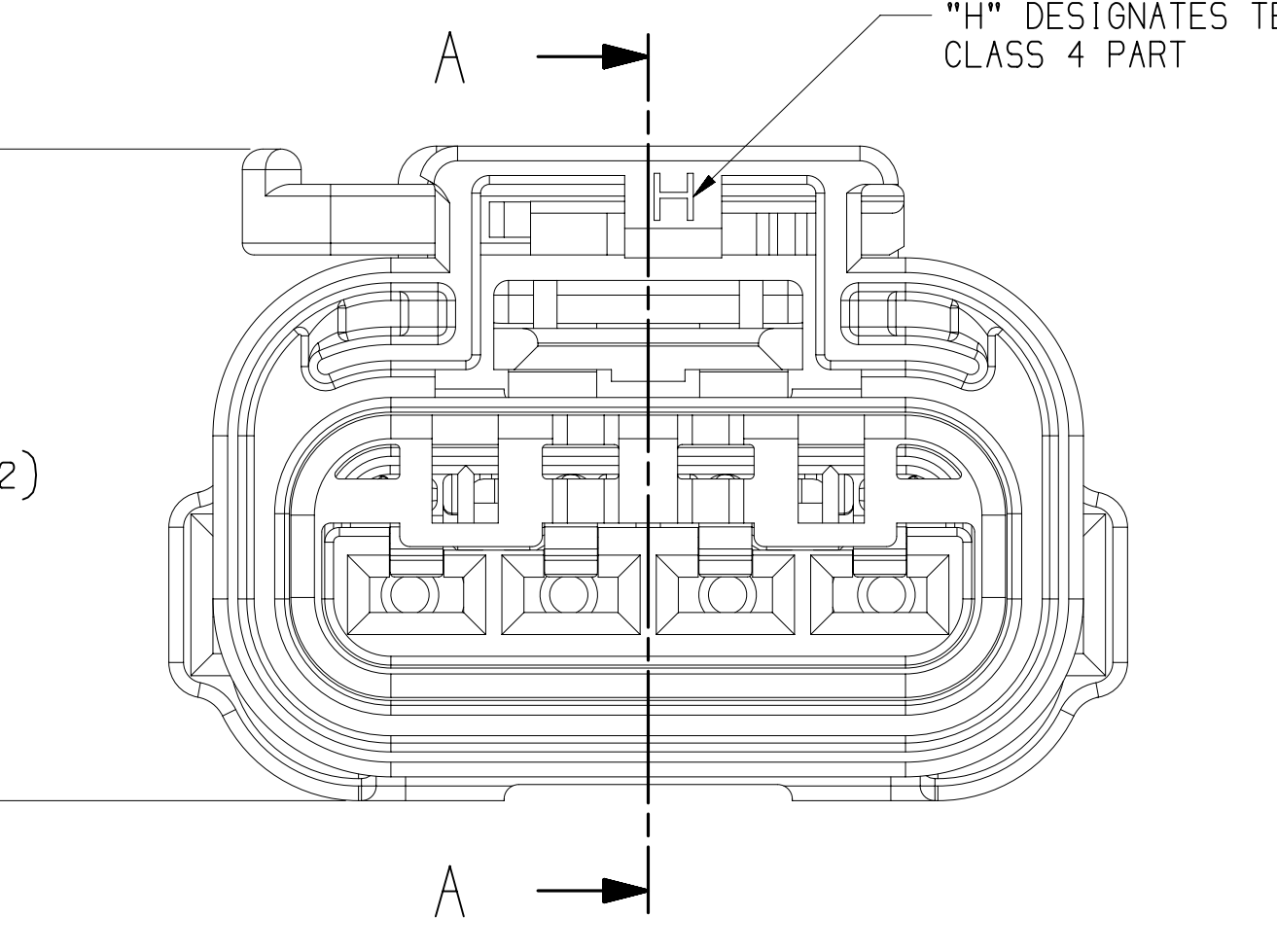
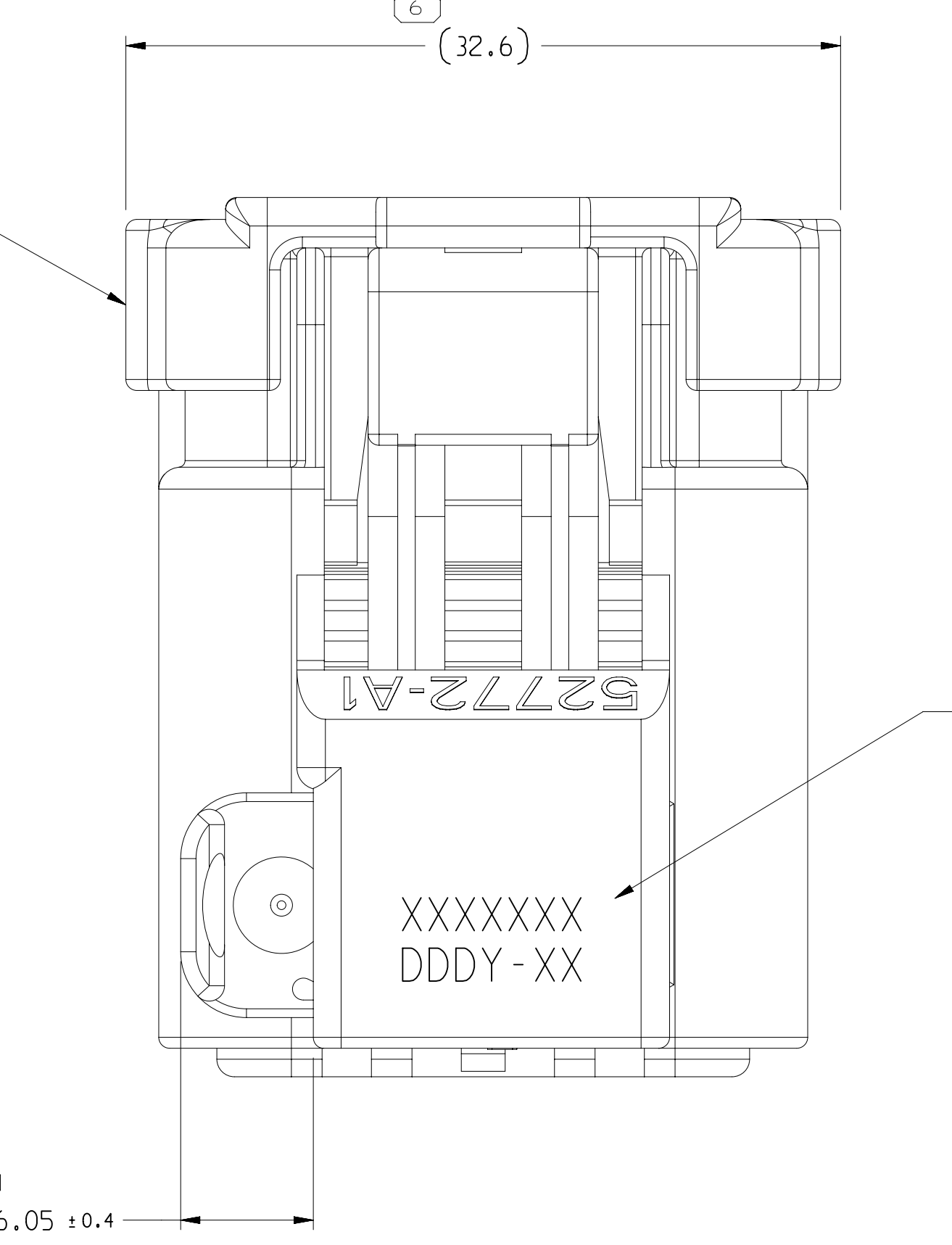

TYPE A - SEALED ASSEMBLY

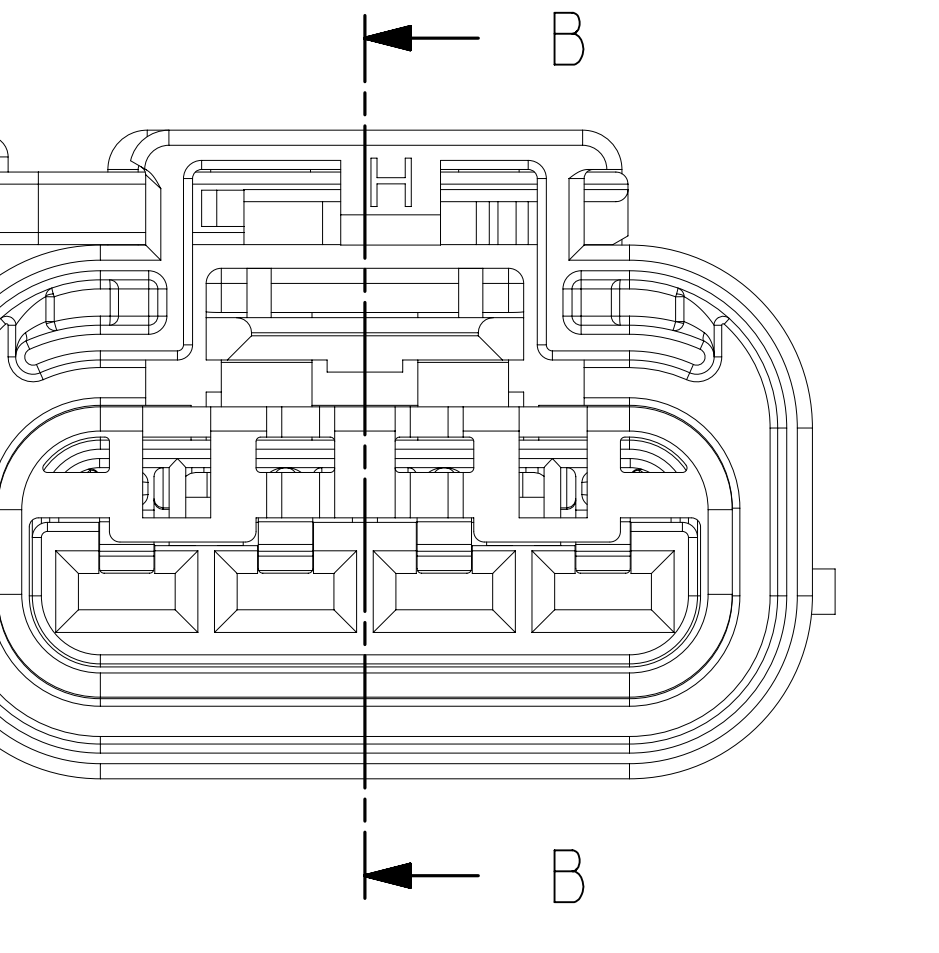

AUXILIARY FRONT VIEW  
TYPE A - UNSEALED ASSEMBLY

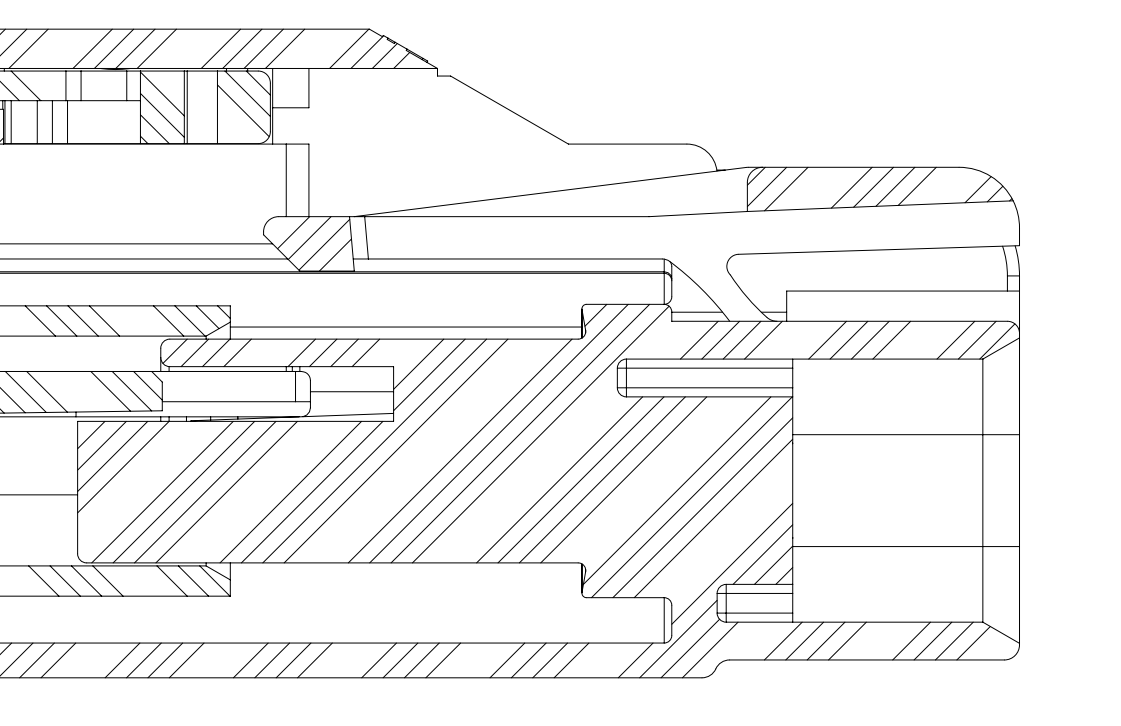

SECTION B-B

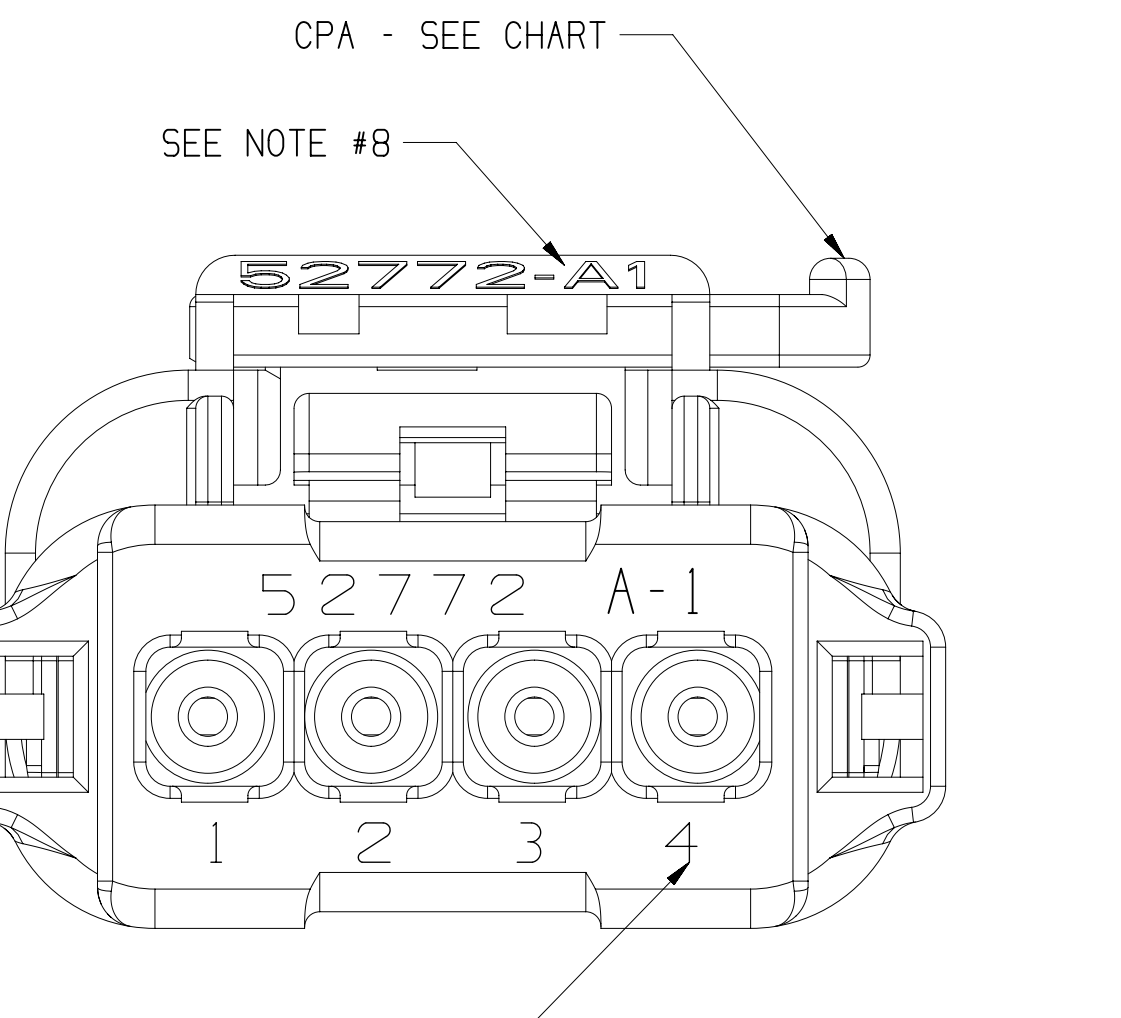
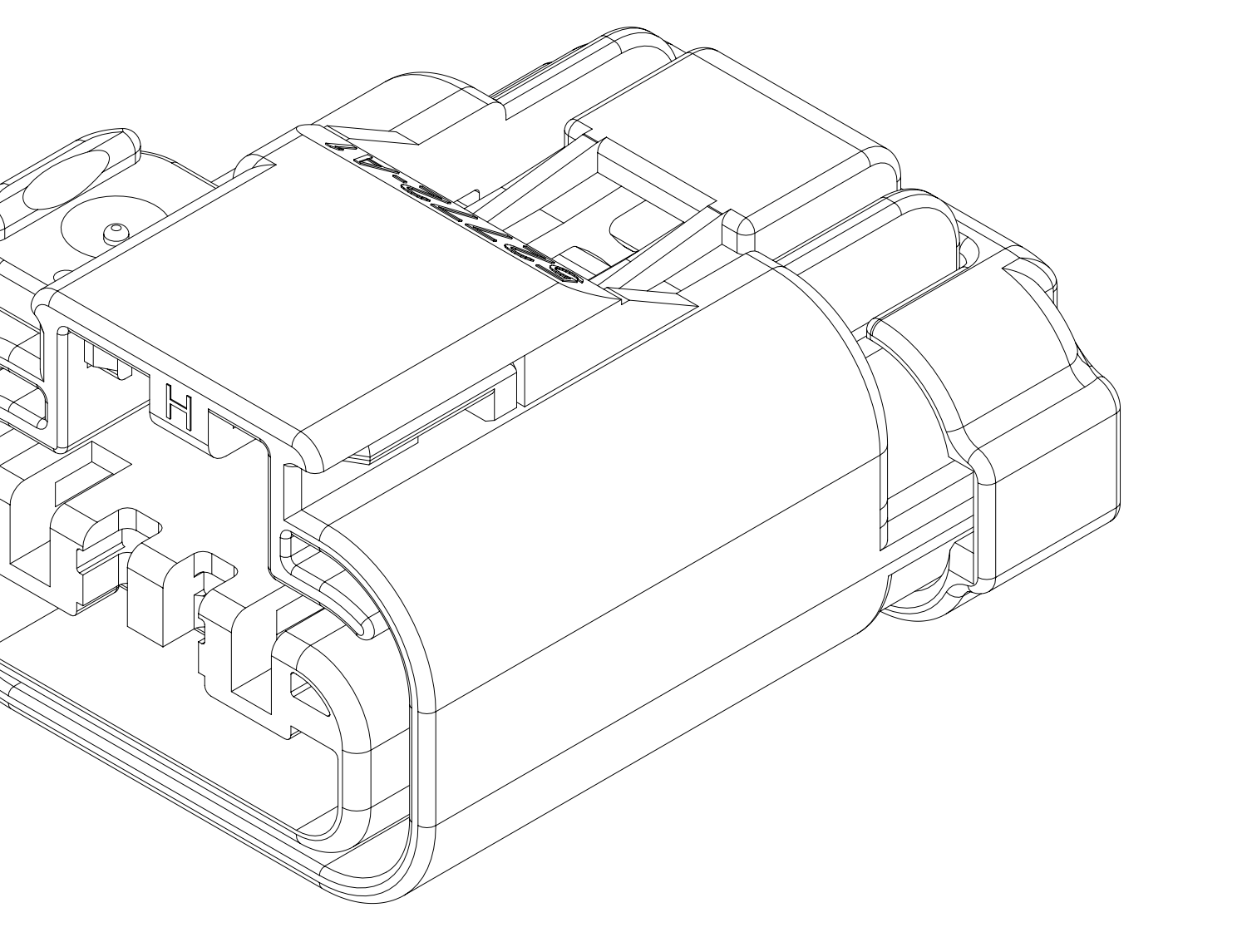

CIRCUIT NO'S FOR  
REFERENCE ONLY  
ENGRAVED

NOTES

- UNLESS OTHERWISE SPECIFIED AND/OR INDICATED:  
DIMENSIONS ARE TO FACE OF VIEW SHOWN AND  
AUTOMATICALLY ROUNDED BY COMPUTER FOR INSPECTION  
(SEE MATH MODEL FOR PRECISE DIMENSIONS). FOR ALL  
OTHER DIMENSIONS NOT SHOWN BUT REQUIRED FOR TOOL  
BUILD, SEE MATH MODEL FOR PRECISE TOOL PATH DATA.
- ENGINEERING APPROVAL OF SUPPLIER SAMPLES IS REQUIRED  
PRIOR TO AUTHORIZATION OF PART PRODUCTION.
- CHANGES IN DESIGN COMPOSITION OR PROCESSING FROM THE PART  
PREVIOUSLY APPROVED FOR PART PRODUCTION REQUIRES PRIOR  
ENGINEERING APPROVAL.
- WIRING FABRICATORS MUST PURCHASE FROM SOURCES SHOWN.
- MUST BE USED WITH FLUOROSILICONE END SEAL W/ 54200430/ DPN 15537508  
RETAINER & PROPER GAGE TEFLON WIRES FOR METHANOL OR DIESEL  
FUEL APPLICATION.
- TEST METHOD PER SAE/USCAR-2 REV. 6, CONNECTOR ENGAGE & DISENGAGE  
WITH LATCH DEPRESSION FORCE NOT TO EXCEED 75N FOR THIS SYSTEM.  
CPA SEATING FORCES - 40N MAX  
PLR SEATING FORCES - 100N MAX
- SUPPLIER, MOLD & CAVITY I.D. MUST BE LEGIBLE
- ANNUAL QUALITY REQUIREMENTS:  
IT IS PERMISSIBLE TO PERFORM CONTINUOUS CONFORMANCE PER MVL  
SPECIFICATION #AQA-001 INSTEAD OF ANNUAL LAYOUT & ANNUAL PV  
REQUIREMENTS OF QS-9000 SECTION 2 & PF-9600.  
ALL NON-REFERENCE DIMENSIONS ARE REQUIRED  
-USE INDEX A, BLACK SEALED AND UNSEALED FOR ALL AFFECTED  
INSULATOR CAVITIES.  
-CURRENT PRODUCTION TOOLING.  
-POINT OF LAST RUN.  
SERVICE TOOLING GUIDE PER APEX TRAINING MANUAL.

- MUST CONFORM TO THE FOLLOWING CHRYSLER / YNA STANDARDS:  
PF-9600 PERFORMANCE (CHRYSLER) EXCEPT AS NOTED ABOVE  
PS-7300 QUALITY ASSURANCE (CHRYSLER)  
PS-4480-DEX-4 (CHRYSLER) PART 1-D, (G-009-2 YNA)  
PS-9005 REBOND (CHRYSLER), (G-009-3 YNA)  
PS-9227 DATA EXCHANGE (CHRYSLER), (G-009-7 YNA)  
PS-10052 INFORMATION SECURITY (CHRYSLER)
- THIS DRAWING (MVL PN H59003 / DPN 15324795) REPLACES CHRYSLER DRAWING NUMBER  
0470254 LEVEL "R" CHRYSLER DRAWING IS FOR REFERENCE ONLY.
- MVL P/N WITH SURFIX "NM" DESIGNATES ASSEMBLIES WITHOUT CPA.
- SEALS BAKED AT 400° F FOR 5 HOURS DURING CONTINUOUSLY INTRODUCED FRESH AIR  
TO DRIVE OFF VOLATILES.
- FORD PART NUMBER ARE LISTED FOR REFERENCE, PARTS ARE PPAP'D TO  
FORD 4L3T-14A464-AA DWS.
- MVL SUPPLIER CODE: 5272 OR 5272H.
- THIS PRODUCT IS NOT CATEGORIZED AS AN APPEARANCE ITEM, MINOR  
IMPERFECTIONS INCLUDING, BUT NOT LIMITED TO, FLOW MARKS, COLOR  
BLOOMING, GATE VESTIGES, AND SOFT FLASH THAT DO NOT AFFECT THE  
FIT, FORM, OR FUNCTION OF THE PART ARE PERMISSIBLE PER ENP-4.3.CS.01.EN.
- FOR APPLICATION DATA SEE THE INDIVIDUAL APPLICATION DRAWINGS.
- ALL THE SEALED CONNECTOR APPLICATIONS MUST BE USED WITH CHRYSLER WIRE SPEC.  
MS-8288 OR MS-9502 THIN WALL X-LINK 20,18,16,14,12 & 10 GAGE WIRES ONLY  
UNLESS OTHERWISE SPECIFIED IN CHART (WIRE INSULATIONS Ø1.70 TO Ø2.40)  
METRIC EQUIVALENTS PERMISSIBLE.
- ALL NON-SEALED APPLICATIONS MAY BE USED WITH ANY WIRE INSULATION 22 GAGE  
THROUGH 10 GAGE (EXCEPT AS NOTED) PROVIDING THAT A TERMINAL GRIP FOR THAT  
CODE/INSULATION COMBINATION IS SHOWN ON THE FEMALE TERMINAL DRAWINGS.
- QUALITY ASSURANCE REQUIREMENTS PER CHRYSLER PS-7300: 1  
SPC DATA REQUIRED

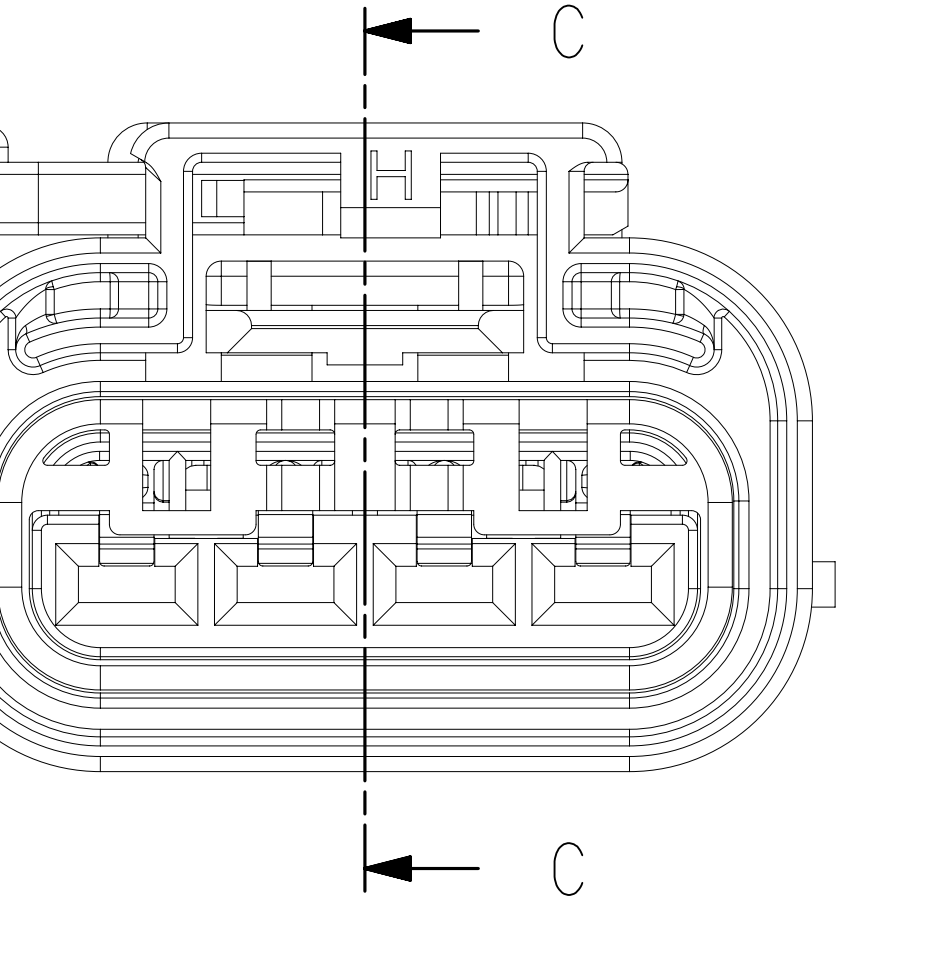

AUXILIARY FRONT VIEW  
TYPE B - SEALED (PARTIAL) ASSEMBLY  
SEE NOTE #5 - SHIPPED WITHOUT MATT SEAL AND RETAINER

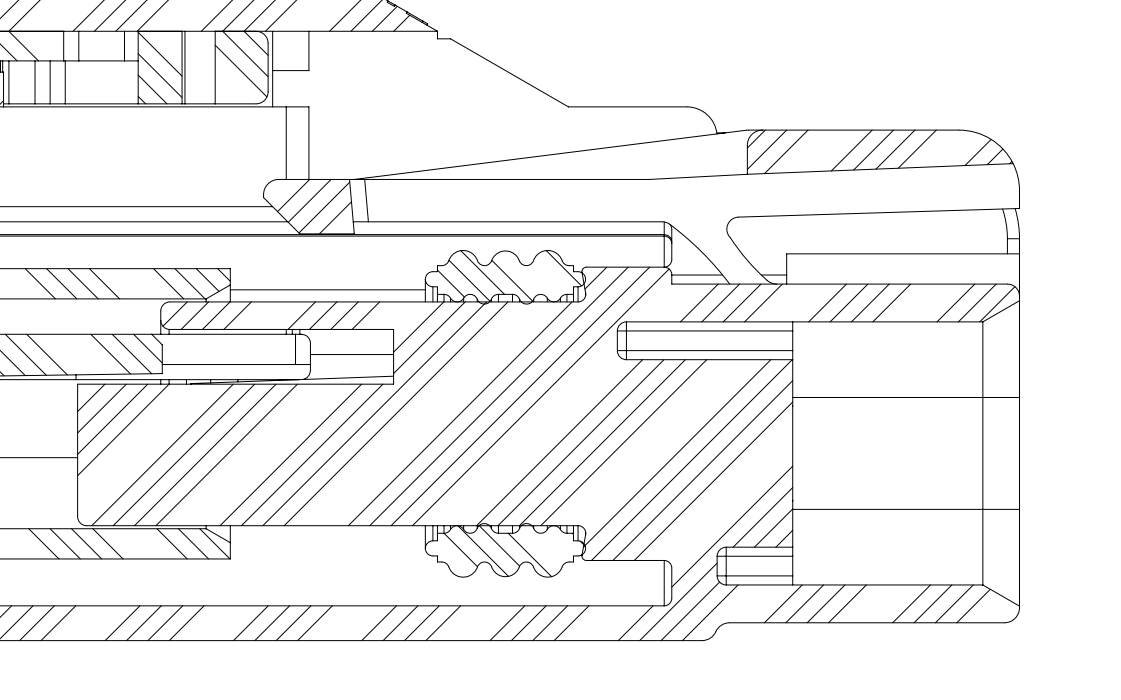

SECTION C-C

REV	DATE	BY	CHKD	APP'D	DESCRIPTION	REV	DATE	BY	CHKD	APP'D	DESCRIPTION
1	19890843	O1	AB	A	F030110	X					N/A
2	19904061	O1	AA	B	-						N/A
3	19904060	O1	AA	A	-						N/A
4	19911446	O1	AB	D	F915600	W					N/A
5	19911442	O1	AB	C	F815600	W					N/A
6	19979448	O1	AB	D	F715600	W					N/A
7	19911428	O1	AB	B	54200415	W					N/A
8	19911447	O2	AB	C	54200412N	X					N/A
9	19911444	O2	AB	C	54200411N	X					N/A
10	19911437	O2	AB	B	54200410N	X					N/A
11	19911432	O1	AC	A	54200411N	X					GM 13507647
12	19911447	O2	AB	A	54200409N	X					N/A
13	19911509	O2	AA	A	F512310	X					N/A
14	19911441	O2	AA	B	54200405N	X					N/A
15	19911439	O2	AA	B	54200407N	X					C 04801217AA
16	19902048	O1	AC	A	F333900	X					N/A
17	19911446	O1	AA	B	-						GM 13507648
18	19911442	O1	AA	B	-						C 04707264
19	19911442	O1	AA	B	-						C 04707263
20	19911442	O1	AA	B	-						F 4L3T-14A464-AB
21	19911447	O2	AB	B	54200410	X					C 04707256
22	19911447	O2	AB	A	-						F FUST-14A464-AB / GM 13507649
23	19911447	O2	AB	A	54200409	U					C 04707262
24	19911447	O2	AB	A	54200450	U					C 04707510
25	19911447	O2	AB	A	54200450	U					C 56038053
26	19911447	O2	AB	A	54200403	U					C 56038193
27	19911447	O2	AB	A	54200400	U					C 56038052
28	19911447	O2	AB	A	54200402N	U					C 046888849
29	19911448	O1	AA	D	54200404N	U					N/A
30	19911445	O1	AA	C	54200403N	U					N/A
31	19911433	O1	AA	C	54200400N	U					N/A
32	19911433	O1	AA	C	54200400N	U					N/A

5324795  
18 17 16 15 14 13 12 11 10 9 8 7 6 5 4 3 2 1

APLIV	
CONNECTION SYSTEMS	
PART NAME: TAXI ASM CONN 4 F APEX 2.8	
DRAWING NUMBER: 15324795	
DATE: 25M05	
BY: RAJAKUMAR	
CHKD: MATT MAJOR	
APP'D: SUDHA SIAN	
REV: 1	
REV: 2	
REV: 3	
REV: 4	
REV: 5	
REV: 6	
REV: 7	
REV: 8	
REV: 9	
REV: 10	
REV: 11	
REV: 12	
REV: 13	
REV: 14	
REV: 15	
REV: 16	
REV: 17	
REV: 18	
REV: 19	
REV: 20	
REV: 21	
REV: 22	
REV: 23	
REV: 24	
REV: 25	
REV: 26	
REV: 27	
REV: 28	
REV: 29	
REV: 30	
REV: 31	
REV: 32	

# Mouser Electronics

Authorized Distributor

Click to View Pricing, Inventory, Delivery & Lifecycle Information:

[Aptiv:](#)

[13854439](#)