

18-13475	02-02-2018	C	4E SH2	Added new colours	FG		GI
14-06120	03-06-2014	B	-	UPDATED FORMAT AND ADDED DELPHI PART NUMBERS	FG		MC
14-03142	05-03-2014	A	A5 SH1	Added pn 33403915-33403916-33403917	GB	FG	MC
21-2006	13-03-2006	13	-	Added new PN	FG		MC
02-2006	13-01-2006	12	-	Changed the raw material housing	FG	EC	MC
ECN-NO. NUMERO ECN	DATE DD/ MM / YY DATA	REVISION REVISIONE	POSITION POSIZIONE	CHANGE DESCRIPTION DESCRIZIONE MODIFICA	DRAWN BY DISEGNATORE	CHK. BY CONTROLLATO	APPR. BY APPROVATO
PRODUCT SPEC. SPEC. DI PRODOTTO	PACKAGING SPEC. SPEC. DI IMBALLAGGIO	APPLICATION SPEC. SPEC. DI APPLICAZIONE	COPYRIGHT APTIV CORPORATION AND/OR ITS AFFILIATES. ALL RIGHTS RESERVED. REVISED THIS DRAWING IS THE PROPERTY OF APTIV CORPORATION. THE REPRODUCTION, DISTRIBUTION AND UTILIZATION OF THIS DOCUMENT OR ITS RELATED CAD MATH DATA, AS WELL AS COMMUNICATION OF ANY CONTENT TO OTHERS, WITHOUT EXPRESS AUTHORIZATION IS PROHIBITED.				
TOLERANCES TOLLERANZE	± 0.3mm / ± 0.1"		MATERIAL : MATERIALE :	SURFACE FINISH FINITURA SUPERFICIALE		CAD SYSTEM	
COUNTERPART Nr. CONTROPARTE Nr.	PBT GF 15%		COLOUR : COLORE :	SEE TABLE		pro / eng.	
DO NOT SCALE DRAWING DISEGNO FUORI SCALA	DATE DATA	NAME NOME	TITLE DESCRIZIONE	LOC. CODE NAZIONALITA'	IT	DIMENSION IN MILLIMETERS DIMENSIONI IN MILLIMETRI	
DRAWN BY DISEGNATORE	13-01-06	GIRARD	24 WAY REAR DOOR TO BODY (PBT VERSION)				DWG SIZE FORMATO
CHECKED BY CONTROLLATO	13-01-06	CINI					SHEET FOGLIO
APPROVED BY APPROVATO	13-01-06	COLOMBO	ESR NO. NUMERO ESR	CAT. NO. NUMERO CAT.	SEE TABLE	FILE NAME NOME FILE	SCALE SCALA
				FSC 309133		FSC 309133	
						2:1	

D

This diagram shows the battery pack assembly. It consists of a rectangular battery pack with a handle on top, mounted on a base. The battery pack has a series of small rectangular cells on its top surface. The base has a slot for the battery pack and a small rectangular opening on the side.

[illegible]UNSEALED VERSION
NO CLOSED WAYS

SEALED VERSION
NO CLOSED WAYS

SEALED VERSION
12 CLOSED WAYS:
A2, A3, A4, A5, A6, A7
C2, C3, C4, C5, C6, C7

CAR FLOOR

SECTION F-F

7/10
ness)

DETAIL J
SCALE 5:1

CONNECTOR INSERTION SIDE —

No burrs allowed along all the cut perimeter

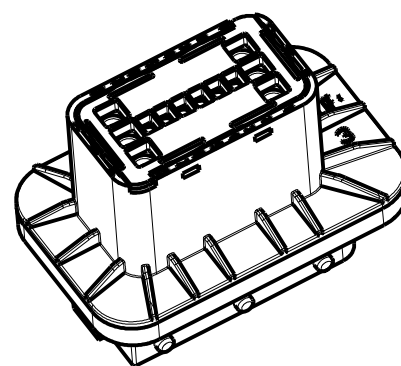
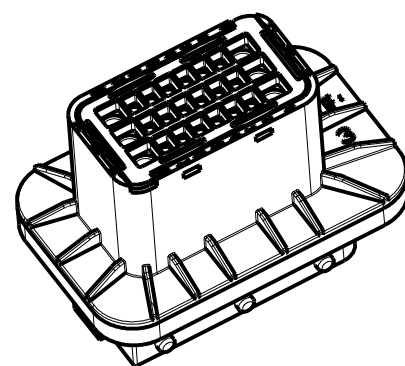
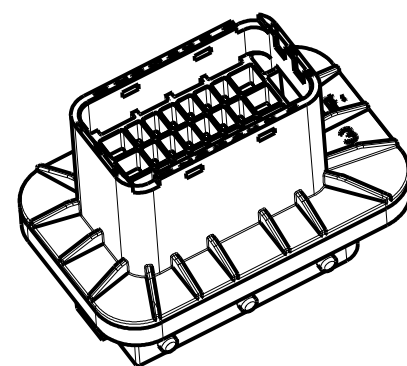

DESIGNATED CHARACTERISTICS							QCI	KPC
		LAST NO USED					⦶ CI	⦶ FF
	1	TOTAL ON DRAWING	SAFETY/COMPLIANCE					⦶ SC
QCI	KCP							

18-13475	02-02-2018	C	4E SH2	Added new colours			FG		GI
14-06120	03-06-2014	B	-	UPDATED FORMAT AND ADDED DELPHI PART NUMBERS			FG		MC
14-03142	05-03-2014	A	A5 SH1	Added pn 33403915-33403916-33403917			GB	FG	MC
21-2006	13-03-2006	13	-	Added new PN			FG		MC
02-2006	13-01-2006	12	-	Changed the raw material housing			FG	EC	MC
ECN-NO. NUMERO. ECN	DATE DD / MM / YY DATA	REVISION REVISIONE	POSITION POSIZIONE	CHANGE DESCRIPTION DESCRIZIONE MODIFICA			DRAWN BY DISEGNATORE	CHK. BY CONTROLLATO	APPR. B APPROVATO
PRODUCT SPEC. SPEC. DI PRODOTTO	PACKAGING SPEC. SPEC. DI IMBALLAGGIO	APPLICATION SPEC. SPEC. DI APPLICAZIONE	COPYRIGHT APTIV CORPORATION AND/OR ITS AFFILIATES. ALL RIGHTS RESERVED. REVISED THIS DRAWING IS THE PROPERTY OF APTIV CORPORATION. THE REPRODUCTION, DISTRIBUTION AND UTILIZATION OF THIS DOCUMENT OR ITS RELATED CAD MATH DATA, AS WELL AS COMMUNICATION OF ANY CONTENT TO OTHERS, WITHOUT EXPRESS AUTHORIZATION IS PROHIBITED. QUESTO DISEGNO E' PROPRIETA' DI APTIV CORPORATION E CONTIENE INFORMAZIONI CONFIDENZIALI. LA RIPRODUZIONE, DISTRIBUZIONE E UTILIZZAZIONE DI QUESTO DOCUMENTO O DELLE SUE RELATIVE MATEMATICHE CAD, NONCHE LA COMUNICAZIONE DI QUALSIASI CONTENUTO AD ALTRI, SENZA ESPLICITA AUTORIZZAZIONE, E PROIBITA						
TOLERANCES TOLLERANZE ± 0.3mm / ±2'		MATERIAL : MATERIALE : PBT GF 15% SEE TABLE		SURFACE FINISH FINITURA SUPERFICIALE -		• APTIV •			CAD SYSTEM pro / eng
COUNTERPART Nr. CONTROPARTE Nr.		COLOUR : COLORE :		LOC. CODE NAZIONALITA' IT		C		ISO PROJECTION PROIEZIONE ISO	DIMENSION IN MILLIMETERS DIMENSIONI IN MILLIMETRI
DO NOT SCALE DRAWING DISEGNO FUORI SCALA		TOOL NO. -		DRAWING NUMBER NUMERO DISEGNO		FSC 309133			DWG SIZE FORMATO A3
DRAWN BY DISEGNATORE	13-01-06	GIRARD	24 WAY REAR DOOR TO BODY (PBT VERSION)			FSC 309133			SHEET FOGLIO 2 of 2
CHECKED BY CONTROLLATO	13-01-06	CINI	SEE TABLE			FSC 309133			SCALE SCALA 2:1
APPROVED BY APPROVATO	13-01-06	COLOMBO	ESR NO. NUMERO ESR	CAT. NO. NUMERO CAT	FSC 309133				

Mouser Electronics

Authorized Distributor

Click to View Pricing, Inventory, Delivery & Lifecycle Information:

[Aptiv:](#)
[35163354](#)