

Counters

Miniature electromechanical pulse counter

Types E1CT4

CARLO GAVAZZI



E1CT4

- 6/7 digit miniature pulse counter
- Long operating life
- 50mW consumption (on request)
- Without reset
- All AC and DC voltages
- Types to fit DIN 24x48
- IP41

Product Description

This range of very reliable and durable counters is indicated for applications where small dimensions and low power

consumption is a must: self powered devices, vending machines, automatic message systems.

Ordering Key

E1CT4 6 000 013

Type _____
 Digits _____
 Housing type _____
 Voltages _____

Stock items: E1CT46200013 E1CT46200054
 E1CT46200051 E1CT46200056

Approvals



Digits

| | |
|---|----------|
| 6 | 6 digits |
| 7 | 7 digits |

Measuring Specifications

| | |
|-----------------|------------|
| Counting mode | adding |
| Max pulse speed | 10 pulse/s |
| On time | 50ms |
| Pulse interval | 50ms |

General Data

| | |
|-------------------------|------------------------------------|
| Dimensions of digits | 1.7x4mm/0.066"x0.158" |
| Colour of digit figures | White on Black |
| Figures shaft | Stainless steel |
| Power consumption | |
| AC | 0.75VA ≤(115V) 1.5VA (230V) |
| DC | 0.5W (50mW available) |
| Operating temperature | -10...+50°C/14...122°F |
| Operating life | >50x10 ⁶ pulses |
| Mounting position | Any |
| Connections | |
| Panel and surface mount | Flying leads AWG22 150mm length |
| PCB | Round Ø1.66mm/0.065" pins |
| Degree of protection | IP41 |

Housing Type

| | |
|-----|--|
| 000 | Grey RAL 7038, without front bezel rear pins (fig.1) |
| 200 | Grey RAL 7038, flush mount with clip rear pins (fig.2) |
| 250 | Grey RAL 7038, flush mount with clip rear pins (fig.3) |
| 260 | Grey RAL 7038, flush mount with clip rear pins (fig.4) |
| 401 | Black RAL 9005, flush mount with 2 holes rear pins (fig.5) |
| 500 | Anthracite RAL 7021, DIN 24x48 with rear pins (fig.6) |
| 601 | Metal blue, PCB pinning steel enclosure (fig.7) |
| 701 | Metal blue, PCB pinning steel enclosure (fig.8) |
| 900 | Grey RAL 7038, flush mount with clip rear pins (fig.9) |
| 800 | Grey RAL 7038, without bezel rear PCB mount (fig.10) |
| 001 | Black RAL 9005, back plate mounting (fig.11) |

Voltages

| Housing Type | 12 VDC | 24 VDC | 24 VAC | 115 VAC | 230 VAC |
|--------------|--------|--------|--------|---------|---------|
| 000 | 012 | 013 | 051 | 054 | 056 |
| 200 | 012 | 013 | 051 | 054 | 056 |
| 250 | 012 | 013 | 051 | 054 | 056 |
| 260 | 012 | 013 | 051 | 054 | 056 |
| 401 | 012 | 013 | 051 | 054 | 056 |
| 500 | 012 | 013 | 051 | 054 | 056 |
| 601 | 012 | 013 | - | - | - |
| 701 | 012 | 013 | - | - | - |
| 900 | 012 | 013 | - | 054 | 056 |
| 800 | 012 | 013 | 051 | 054 | 056 |
| 001 | 012 | 013 | 051 | 054 | 056 |

Dimensions mm/inches

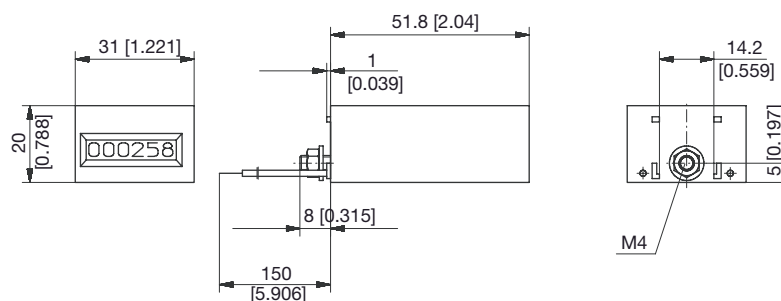

Fig. 1 housing type 000

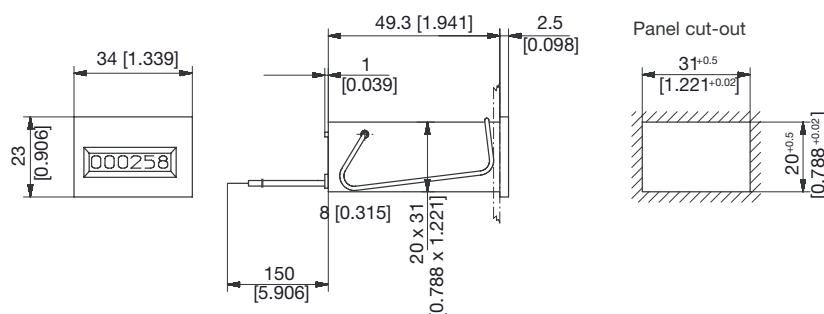

Fig. 2 housing type 200

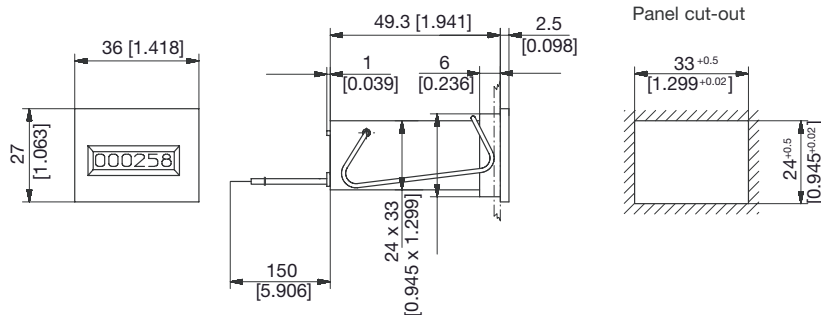

Fig. 3 housing type 250

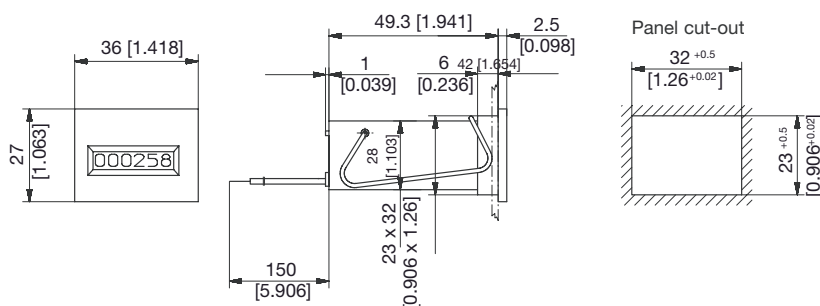

Fig. 4 housing type 260

Dimensions mm/inches

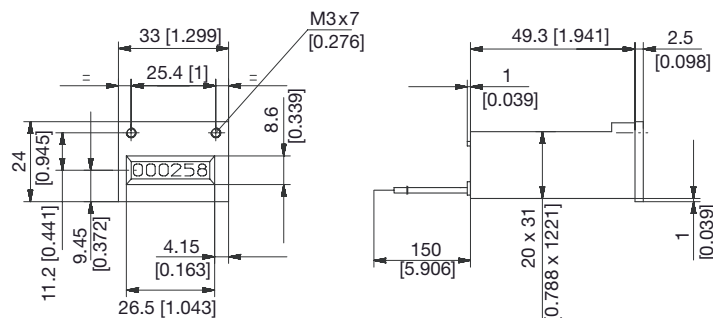

Fig. 5 housing type 401

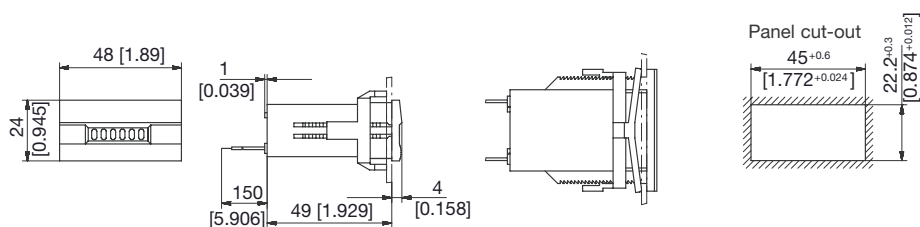
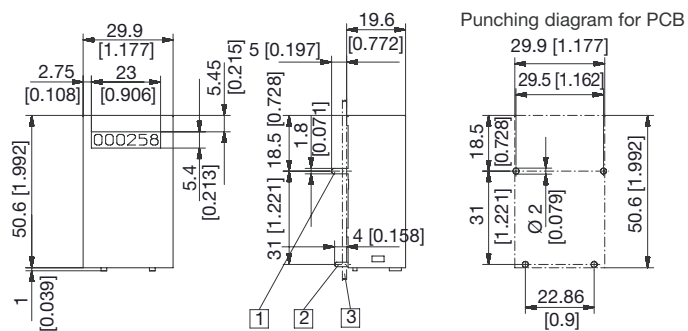

Fig. 6 housing type 500



Punching diagram for PCB

Fig. 7 housing type 601

[1] Mounting pins 1.8 x 0.4 mm [0.071 x 0.016"] [2] Coil connections \varnothing 0.16 [0.006"] [3] PCB

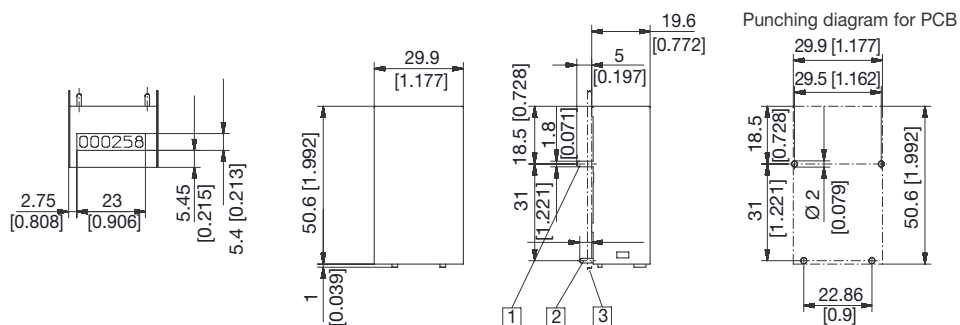

Punching diagram for PCB

Fig. 8 housing type 701

[1] Mounting pins 1.8 x 0.4 mm [0.071 x 0.016"] [2] Coil connections \varnothing 0.15 [0.006"] [3] PCB

Dimensions mm/inches

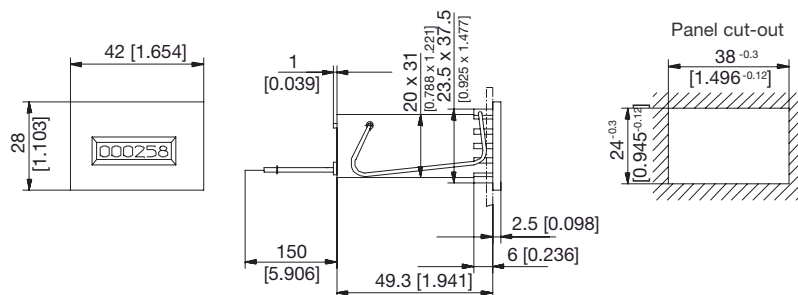

Fig. 9 housing type 900

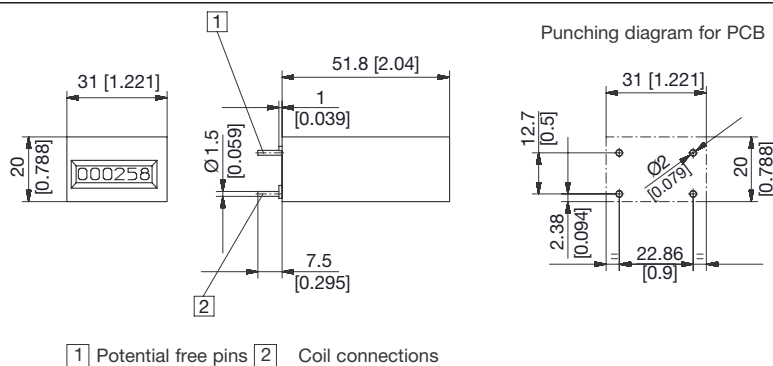

Fig. 10 housing type 800

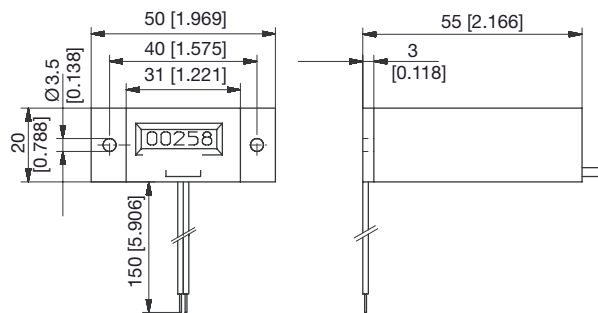

Fig. 11 housing type 001

Mouser Electronics

Authorized Distributor

Click to View Pricing, Inventory, Delivery & Lifecycle Information:

[Carlo Gavazzi:](#)

[E1CT46200051](#) [E1CT46200013](#) [E1CT46200054](#) [E1CT46200056](#)