

# Coaxial Low Pass Filter

## ZX75LP-900-S+

50Ω

DC to 900 MHz

### The Big Deal

- High rejection
- Low Insertion loss, 0.9 dB typical in passband
- Fast roll-off
- Good VSWR
- Connectorized package



Generic photo used for illustration purposes only

CASE STYLE: KE1467

### Product Overview

ZX75LP-900-S+ is a 50Ω low pass filter built in a connectorized package. Covering DC-900 MHz bandwidth, these units offer good matching within the passband and high rejection in stopband. This will find its applications in receivers and transmitters to suppress spurious emission and harmonics. It has repeatable performance across production lots and consistent performance across temperature.

### Key Features

Feature	Advantages
Low passband insertion loss	Suitable for high performance application
Fast roll-off	Provides very good adjacent band rejection
Connectorized package	The connectorized package is easy to interface with other devices and well suited for test setups
Good VSWR	Provides good interface when used with other devices.

#### Notes

- A. Performance and quality attributes and conditions not expressly stated in this specification document are intended to be excluded and do not form a part of this specification document.  
B. Electrical specifications and performance data contained in this specification document are based on Mini-Circuit's applicable established test performance criteria and measurement instructions.  
C. The parts covered by this specification document are subject to Mini-Circuits standard limited warranty and terms and conditions (collectively, "Standard Terms"); Purchasers of this part are entitled to the rights and benefits contained therein. For a full statement of the Standard Terms and the exclusive rights and remedies thereunder, please visit Mini-Circuits' website at [www.minicircuits.com/MCLStore/terms.jsp](http://www.minicircuits.com/MCLStore/terms.jsp)



[www.minicircuits.com](http://www.minicircuits.com) P.O. Box 350166, Brooklyn, NY 11235-0003 (718) 934-4500 [sales@minicircuits.com](mailto:sales@minicircuits.com)

# Low Pass Filter

50Ω

DC to 900 MHz

ZX75LP-900-S+



Generic photo used for illustration purposes only

## Features

- High rejection
- Low Insertion loss
- Fast roll-off
- Good VSWR
- Connectorized package

## Applications

- Satellite
- Wireless communications
- Receivers / Transmitters

CASE STYLE: KE1467

Connectors	Model
SMA-MF	ZX75LP-900-S+

## Electrical Specifications at 25°C

Parameter	F#	Frequency (MHz)	Min.	Typ.	Max.	Unit
Pass Band	Insertion Loss	DC-F1	DC-900	—	0.9	dB
	Freq. Cut-Off	F2	1000	—	3.0	dB
	VSWR	DC-F1	DC-900	—	1.3	:1
Stop Band	Rejection Loss	F3-F4	1300-2900	20	30	dB
	VSWR	F3-F4	1300-2900	—	16	:1

## Maximum Ratings

Operating Temperature	-40°C to 85°C
Storage Temperature	-55°C to 100°C
RF Power Input	0.5W max.

Permanent damage may occur if any of these limits are exceeded.

## Functional Schematic

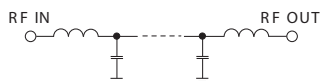

## Typical Performance Data at 25°C

Frequency (MHz)	Insertion Loss (dB)	VSWR (:1)	Frequency (MHz)	Group Delay (nsec)
1	0.02	1.01	1	1.05
20	0.04	1.01	10	0.96
80	0.08	1.01	25	0.86
200	0.16	1.03	60	0.86
490	0.32	1.15	140	0.86
810	0.64	1.26	220	0.87
900	0.81	1.24	285	0.88
930	0.91	1.13	350	0.91
950	1.06	1.22	425	0.94
980	1.62	1.73	500	0.99
1000	2.48	2.40	550	1.03
1200	21.30	82.73	580	1.06
1300	29.68	193.02	600	1.08
1400	36.32	157.93	640	1.12
1500	41.09	102.19	700	1.20
1600	44.20	69.49	750	1.31
1800	47.72	39.49	800	1.37
2000	48.94	27.16	850	1.58
2500	49.52	17.39	880	1.67
2900	61.93	15.81	900	1.77

## Typical Frequency Response

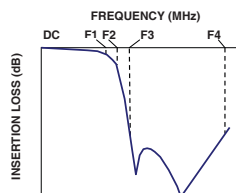

### +RoHS Compliant

The +Suffix identifies RoHS Compliance. See our web site for RoHS Compliance methodologies and qualifications

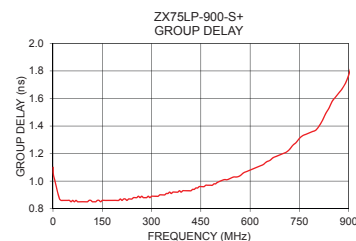
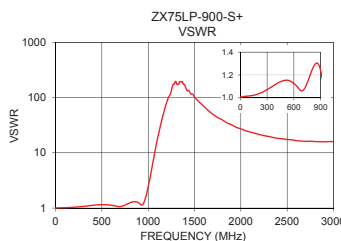
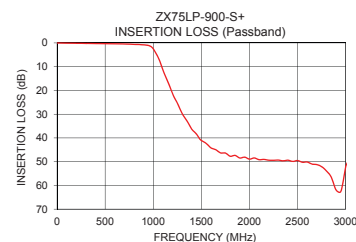
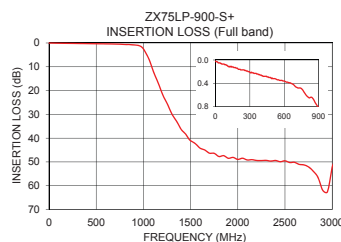

### Notes

- A. Performance and quality attributes and conditions not expressly stated in this specification document are intended to be excluded and do not form a part of this specification document.  
 B. Electrical specifications and performance data contained in this specification document are based on Mini-Circuits' applicable established test performance criteria and measurement instructions.  
 C. The parts covered by this specification document are subject to Mini-Circuits standard limited warranty and terms and conditions (collectively, "Standard Terms"); Purchasers of this part are entitled to the rights and benefits contained therein. For a full statement of the Standard Terms and the exclusive rights and remedies thereunder, please visit Mini-Circuits' website at [www.minicircuits.com/MCLStore/terms.jsp](http://www.minicircuits.com/MCLStore/terms.jsp)



[www.minicircuits.com](http://www.minicircuits.com) P.O. Box 350166, Brooklyn, NY 11235-0003 (718) 934-4500 sales@minicircuits.com

REV. C  
 ECO-004400  
 ZX75LP-900-S+  
 EDR10350U  
 URJ  
 201008  
 Page 2 of 3

Coaxial Connections

INPUT	SMA-Male
OUTPUT	SMA-Female

Outline Drawing

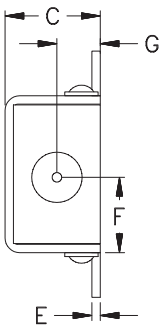
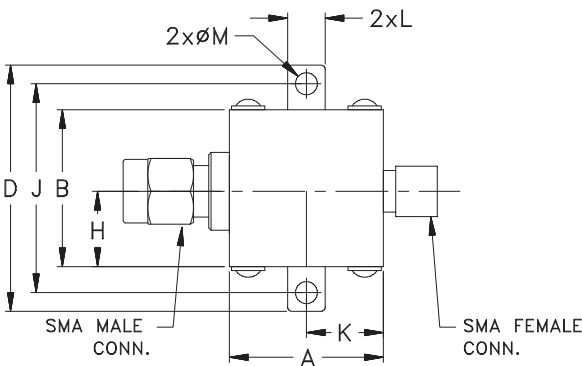

Outline Dimensions ( inch mm )

A	B	C	D	E	F	G
.74	.75	.46	1.18	.04	.362	.21
18.80	19.05	11.68	29.97	1.02	9.19	5.33
H	J	K	L	M		Wt.
.362	1.00	.37	.18	.11		grams
9.19	25.40	9.40	4.57	2.79		24.4

Note: Please refer to case style drawing for details

Notes  
A. Performance and quality attributes and conditions not expressly stated in this specification document are intended to be excluded and do not form a part of this specification document.  
B. Electrical specifications and performance data contained in this specification document are based on Mini-Circuit's applicable established test performance criteria and measurement instructions.  
C. The parts covered by this specification document are subject to Mini-Circuits standard limited warranty and terms and conditions (collectively, "Standard Terms"); Purchasers of this part are entitled to the rights and benefits contained therein. For a full statement of the Standard Terms and the exclusive rights and remedies thereunder, please visit Mini-Circuits' website at [www.minicircuits.com/MCLStore/terms.jsp](http://www.minicircuits.com/MCLStore/terms.jsp)

# Mouser Electronics

Authorized Distributor

Click to View Pricing, Inventory, Delivery & Lifecycle Information:

[Mini-Circuits:](#)

[ZX75LP-900-S+](#)