



Mini-Circuits

(LTCC) COAXIAL

## High Pass Filter

ZHFW-K5000+

50Ω 5.5 to 20 GHz 2.92mm Female

## KEY FEATURES

- Low Insertion Loss, 1.4 dB Typ.
- Return Loss, 12 dB Typ.
- Stop Band Rejection, 45 dB Typ.
- Broadband Connectorized Package.
- Power Handling: 1.75 Watts

## APPLICATIONS

- Test and Measurement Equipment
- Military Applications.
- Telecommunications and Broadband Wireless Systems.



Generic photo used for illustration purposes only

## PRODUCT OVERVIEW

ZHFW-K5000+ is a 50ohm high pass filter built in broad band connectorized package. Covering 5.5-20 GHz bandwidth, these units offer good matching within the passband and good rejection in stopband. ZHFW-K5000+ offer low insertion loss, and excellent power handling capability. It handles up to 1.75W RF input power and provides a wide operating temperature range from -55°C to 125°C.

## FUNCTIONAL DIAGRAM

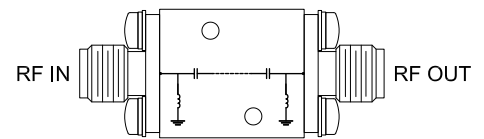
ELECTRICAL SPECIFICATIONS<sup>1,2</sup> AT +25°C

Parameter		F#	Frequency (GHz)	Min.	Typ.	Max.	Units
Pass Band	Insertion Loss	F3-F4	5.5 - 7	—	2.4	—	dB
		F4-F5	7- 13.5	—	1.4	1.8	
		F5-F6	13.5 - 20	—	2	—	
Stop Band	Return Loss	F3-F4	5.5 - 20	—	12	—	dB
		F3-F4	5.5 - 20	—	12	—	
	Rejection	DC-F1	DC - 3	39	45	—	dB
		F1-F2	3 - 4	20	40	—	
	Freq. Cut-Off <sup>3</sup>	F <sub>c</sub> <sup>3</sup>	5	—	3	—	dB

1. This filter is bi-directional, RF1 and RF2 ports may be interchanged, see S-Parameters for actual performance.

2. This component should not be used as a DC-block. In applications where DC voltage and/or current is present at either the input or output ports, external DC blocking capacitors are required.

3. Typical variation ± 5%

ABSOLUTE MAXIMUM RATINGS<sup>4</sup>

Parameter	Ratings
Operating Temperature	-55 °C to +125 °C
Storage Temperature	-55 °C to +125 °C
Input Power <sup>5</sup>	1.75 W @25°C

4. Permanent damage may occur if any of these limits are exceeded.

5. Power rating applies only to signals within the passband. Power rating above +25°C operating temperature decreases linearly to 0.5W at +125°C.

## TYPICAL FREQUENCY RESPONSE

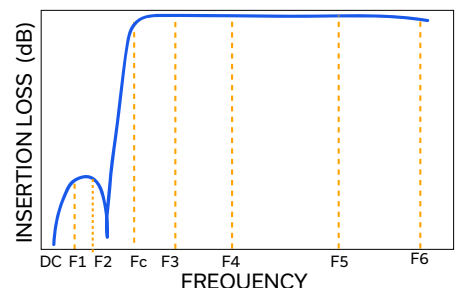

Mini-Circuits

[www.minicircuits.com](http://www.minicircuits.com) P.O. Box 350166, Brooklyn, NY 11235-0003 (718) 934-4500 sales@minicircuits.com

REV. A  
ECO-020923  
ZHFW-K5000+  
EDU4755  
URJ  
240219

PAGE 1 OF 4



Mini-Circuits

(LTCC) COAXIAL

# High Pass Filter

**ZHFW-K5000+**

50Ω 5.5 to 20 GHz 2.92mm Female

## TYPICAL PERFORMANCE GRAPHS

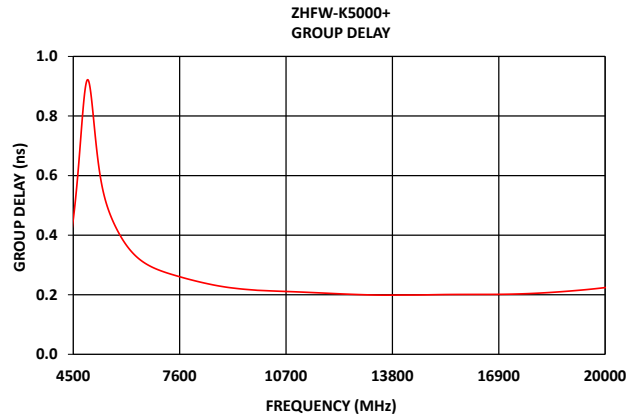
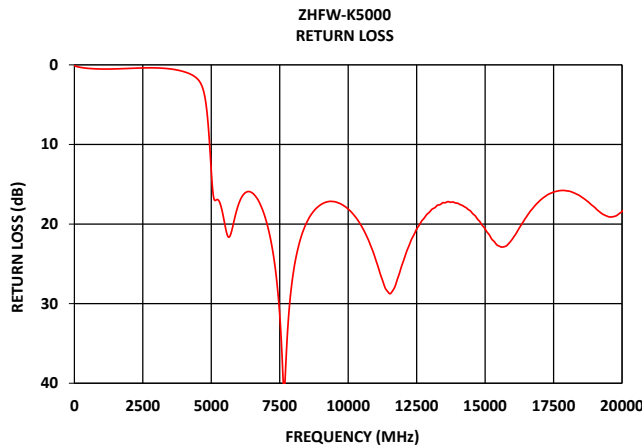
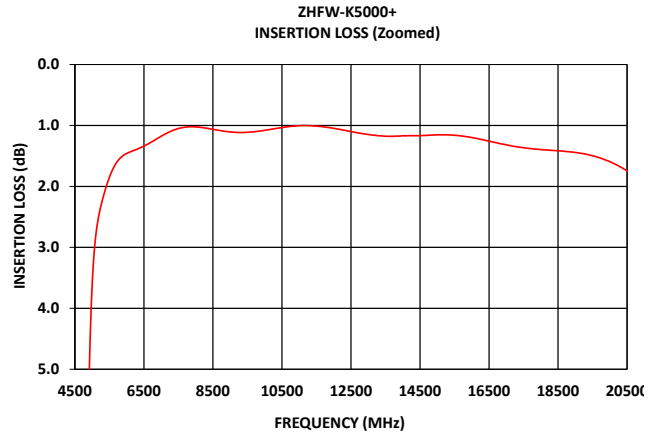
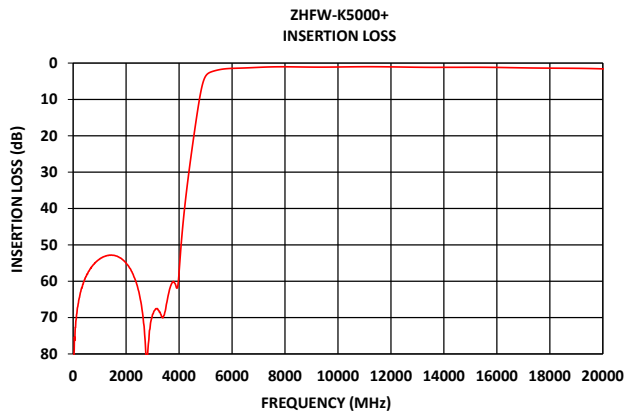



(LTCC) COAXIAL

# High Pass Filter

**ZHFW-K5000+**

50Ω 5.5 to 20 GHz 2.92mm Female

## CONNECTOR DESCRIPTION

Function	Marking on Unit	Connector
RF1 <sup>1</sup>	1	2.92mm Female
RF2 <sup>1</sup>	2	2.92mm Female

## CASE STYLE DRAWING

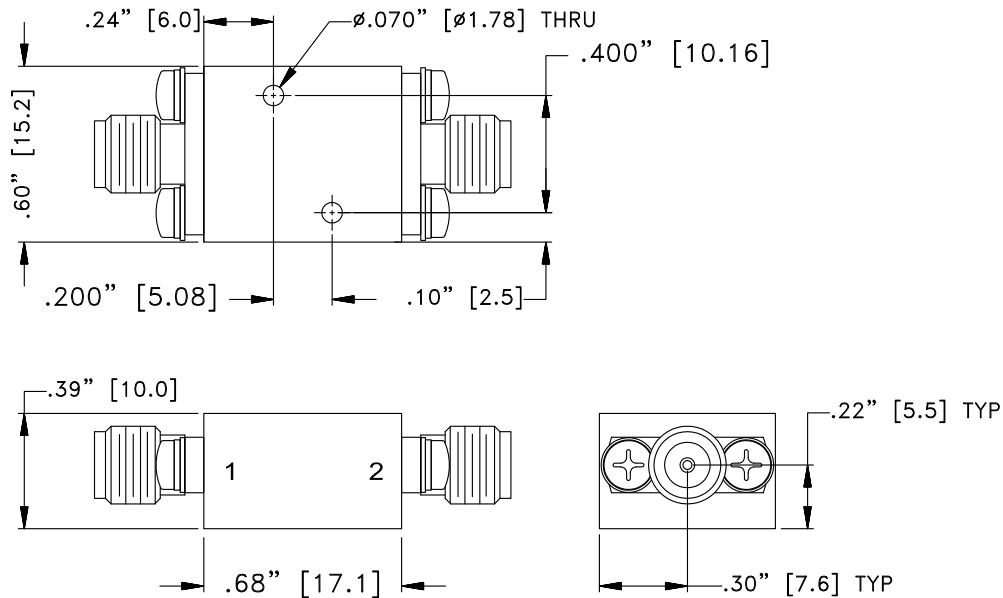

Unit weight: 24grams

Dimensions are in inches (mm). Tolerances: 2 Pl.  $\pm .050$ "; 3 Pl.  $\pm .015$ "

## PRODUCT MARKING\*: ZHFW-K5000+

\*Marking may contain other features or characters for internal lot control.



(LTCC) COAXIAL

# High Pass Filter

**ZHFW-K5000+**

50Ω 5.5 to 20 GHz 2.92mm Female

ADDITIONAL INFORMATION IS AVAILABLE ON OUR DASHBOARD

[CLICK HERE](#)

Performance Data & Graphs	Data
	Graphs
	S-Parameter (S2P Files) Data Set (.zip file)
Case Style	UK3042
RoHS Status	Compliant
Environmental Ratings	ENV124

## NOTES

- A. Performance and quality attributes and conditions not expressly stated in this specification document are intended to be excluded and do not form a part of this specification document.
- B. Electrical specifications and performance data contained in this specification document are based on Mini-Circuits' applicable established test performance criteria and measurement instructions.
- C. The parts covered by this specification document are subject to Mini-Circuits' standard limited warranty and terms and conditions (collectively, "Standard Terms"); Purchasers of this part are entitled to the rights and benefits contained therein. For a full statement of the standard terms and the exclusive rights and remedies thereunder, please visit Mini-Circuits' website at [www.minicircuits.com/terms/viewterm.html](http://www.minicircuits.com/terms/viewterm.html)



# Mouser Electronics

Authorized Distributor

Click to View Pricing, Inventory, Delivery & Lifecycle Information:

[Mini-Circuits:](#)

[ZHFW-K5000+](#)