

PART NAME: KNOB SCALE: 1:1 DATE: 9/10/97 DR. BY HD

THIS DRAWING IS THE PROPERTY OF DAVIES MOLDING COMPANY, IS SUBMITTED SOLELY AS A DESIGN OR ENGINEERING PROJECT. WE ACCEPT NO RESPONSIBILITY WHATSOEVER FOR THE PRACTICAL APPLICATION OF THE PIECES MADE TO THIS DESIGN.



DESIGNERS & MANUFACTURERS  
OF KNOBS, HANDLES, CASES &  
CUSTOM PLASTIC COMPONENTS

P/N 2750-R

M NO. # 69

CAVITY	2750
CORE	2750
SLEEVE	2750
PIN	2750-C
INSERT	10870

# ROTARY TABLE SETUP

UNIT IN PRESS	DH1 OR 2
F NO TOP	IR-69
F NO BOTTOM	IR-69
CAVITY	2750
CORE	2750
SLEEVE	IR-2750
PIN	IR-2750-D
INSERT	10870

AKRON METAL ETCHING  
PATTERN NO. # A-276

# 1 POLISH

ø0.81

ø1.00

R 1.40

0.25

(A) 0.795±.015

0.47

0.75

0.63

1/4-20 UNC-2 THREAD.  
10870, STAINLESS STEEL

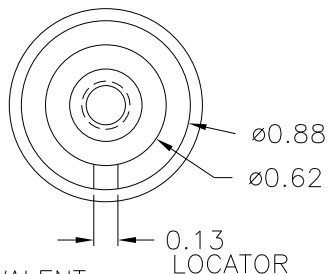

(C) MATERIAL: NYLON 6/6 (ZY2), (ZY6)  
OR ENGINEERING APPROVED EQUIVALENT  
COLOR: BLACK

(B)

TOLERANCES: UNLESS OTHERWISE SPECIFIED	DO NOT SCALE DRAWING			
DECIMALS: X.XXX ± .005 X.XX ± .015	MM: X.XX ± 0.15MM X.X ± 0.4MM	C	WAS CLC ADDED ZY6	JAM 6/25/12
		B	ADDED MAT. CODE	DS 1/8/07
		A	WAS .81 HGT.	HD 12/17/97
FRACTIONS ± 1/64	ANG. ± 1°	CHANGES		

# Mouser Electronics

Authorized Distributor

Click to View Pricing, Inventory, Delivery & Lifecycle Information:

[Davies Molding:](#)

[2750-R](#)