

## LOW VOLTAGE AUTO FUSE (FAST-BLADE TYPE)

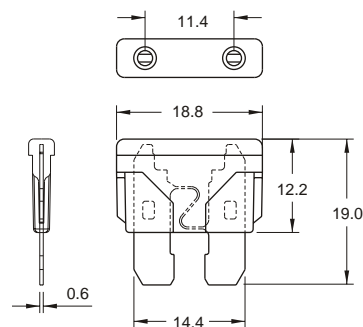

TERMINAL MATERIAL: ZINC  
INSULATION MATERIAL: POLY SULFONE(PSU)  
COLOR-CODING: FUSES ARE COLOR-CODED FOR EASY AMPERAGE IDENTIFICATION.

ITEM NO.	AMPERE RATING	VOLTAGE RATING	BODY COLOR	FIGURE	Q'TY BOX
FATC-1A-BLACK ©	1A	32V	BLACK		1000
FATC-2A-GREY	2A	32V	GREY		1000
FATC-3A-VIOLET	3A	32V	VIOLET		1000
FATC-4A-PINK	4A	32V	PINK		1000
FATC-5A-TAN	5A	32V	TAN		1000
FATC-7.5A-BROWN	7.5A	32V	BROWN		1000
FATC-10A-RED	10A	32V	RED		1000

UL ALL LISTED  
©: NOT UL LISTED

TEST SPECIFICATION LOAD OPENING TIME.  
RATING      BLOW TIME  
110%      4 HOURS, MINIMUM  
135%      0.75 TO 1800 SECONDS.  
200%      0.15 TO 5 SECONDS.  
350%      0.08 SECONDS, MAXIMUM

# Mouser Electronics

Authorized Distributor

Click to View Pricing, Inventory, Delivery & Lifecycle Information:

## KS Terminals:

[FATC-10A-RED](#) [FATC-1A-BLACK](#) [FATC-2A-GREY](#) [FATC-3A-VIOLET](#) [FATC-4A-PINK](#) [FATC-5A-TAN](#) [FATC-7.5A-BROWN](#)