

Cell Type CR-1/3N Specifications

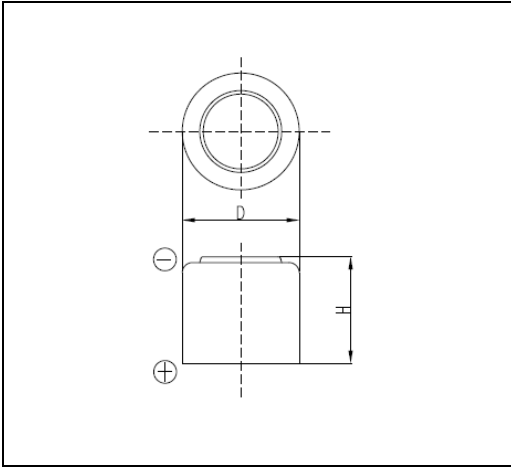

Nominal Voltage (V)		3
Nominal Capacity (mAh) *1		160
Standard Discharge Current (mA)		2.7
Operating Temperature Range (°C)		-20 ~ +60
Dimensions (mm)	Diameter (D)	11.6
	Height (H)	10.8
Approx. Weight (g)		3.3

- * Expected life is 5 years at room temperature.
- * Consult with FDK when considering multiple-cell construction.
- *1 Nominal capacity is determined at an end voltage of 2.0V when the battery is allowed to discharge at a standard current level at +23°C.

Note) Battery Handling Precautions

English) http://www.fdk.co.jp/battery/lithium_e/handling_precaution.html
 Japanese) http://www.fdk.co.jp/battery/lithium/handling_precaution.html

Typical Characteristics

Temperature Discharge Characteristics

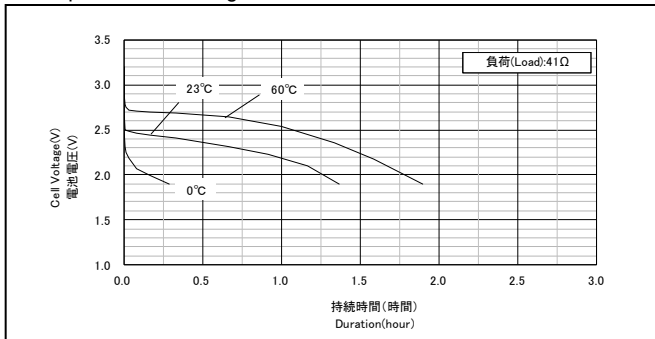

Temperature Discharge Characteristics

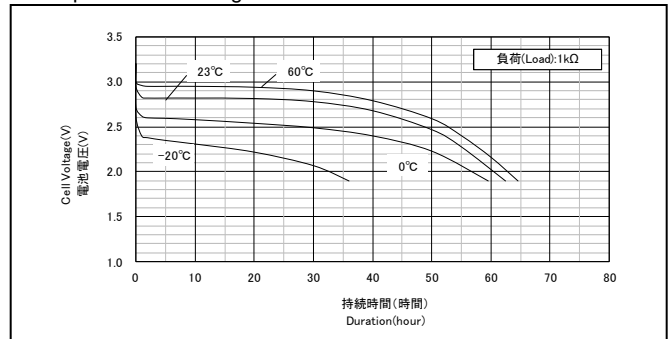

Temperature Discharge Characteristics

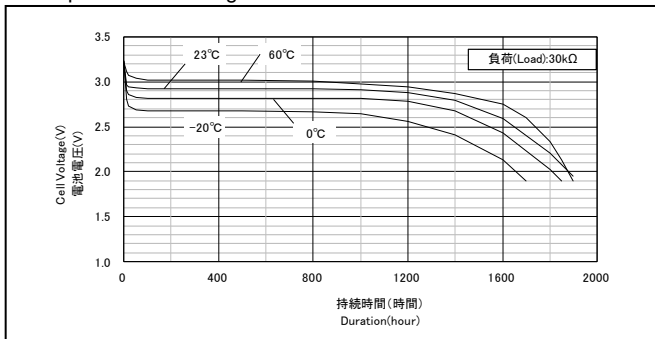

Discharge Characteristics after Storage

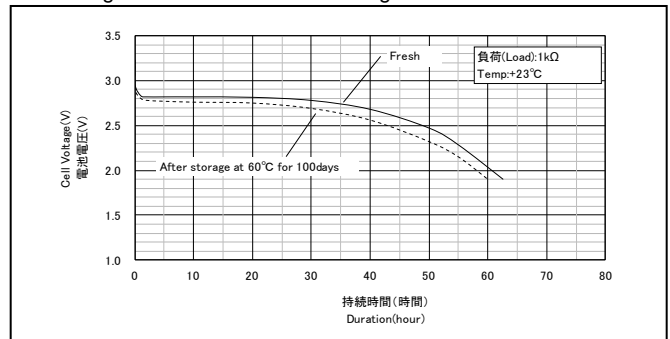

Discharge Load vs. Capacity

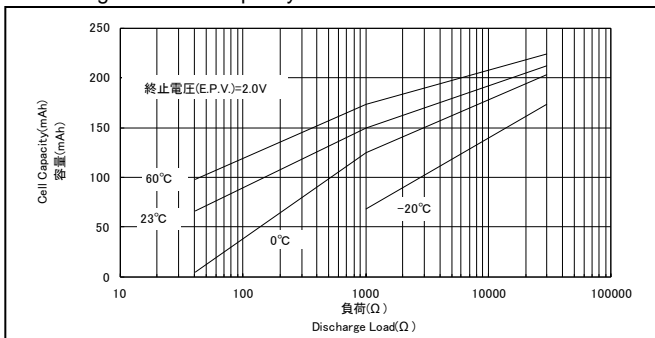

Discharge Load vs. Operating Voltage

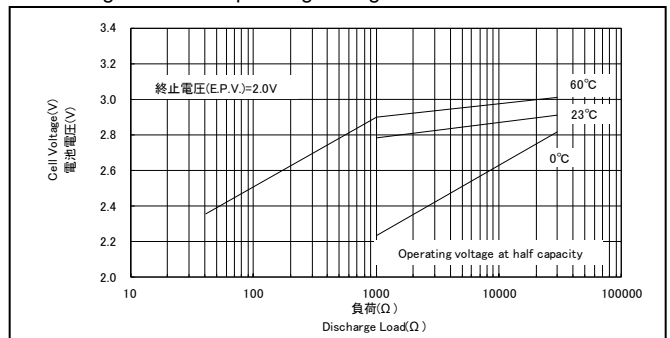

Mouser Electronics

Authorized Distributor

Click to View Pricing, Inventory, Delivery & Lifecycle Information:

Unspecified:

[CR1-3N](#)