

VERTICAL, RIGHT ANGLE, SOLDER TAIL OR PRESS-FIT TERMINATION

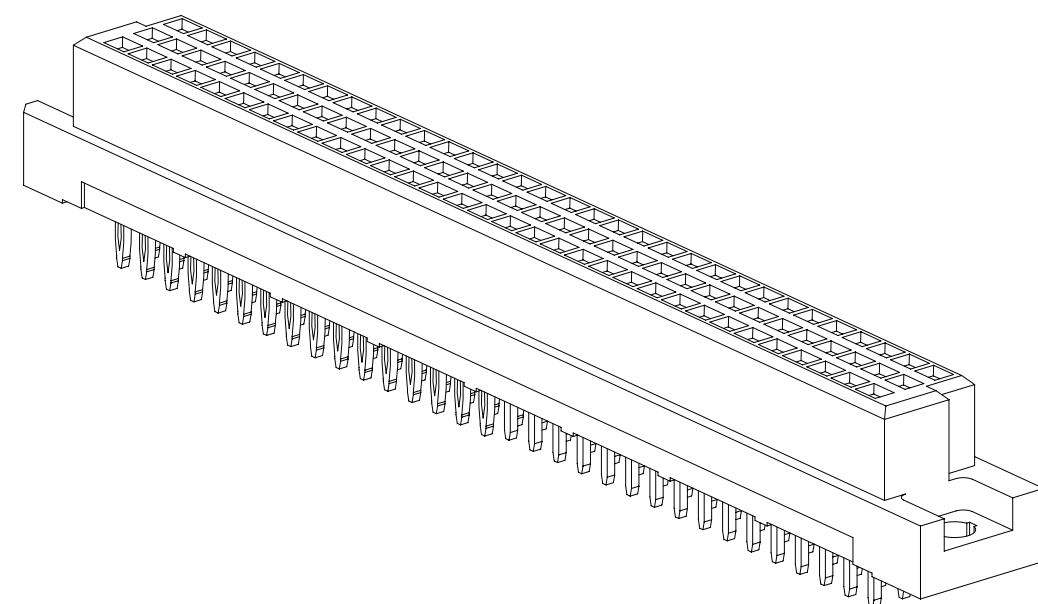

DIN-XXXXCSX-XXX
VERTICAL VERSION

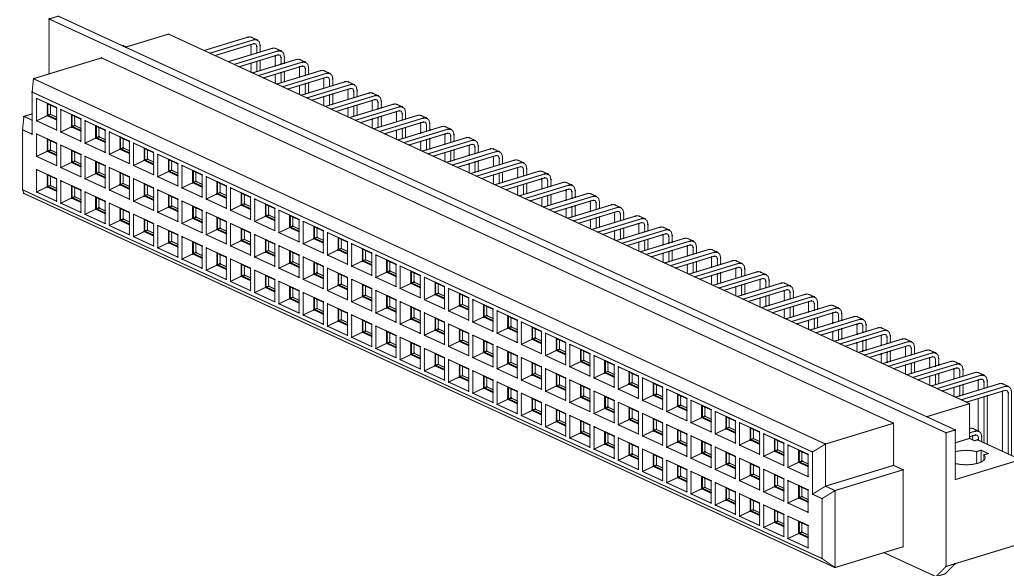

DIN-XXXRSX-XXX
RIGHT ANGLE VERSION

2 PHYSICAL : 0

```

INSULATOR:
MATERIAL: GLASS FILLED POLYESTER (PBT)
FLAMMABILITY: UL94V-0
COLOR: GRAY
CONTACT:
MATERIAL: COPPER ALLOY
PLATING:
UNDER PLATING: 50μ" MIN. NICKEL
WIPING AREA: SEE ORDERING INFORMATION
TERMINATION AREA: SEE ORDERING INFORMATION

```

2 ELECTRICAL :

CURRENT RATING: 3.0A AT 30°C T-RISE ABOVE AMBIENT
CONTACT RESISTANCE: $\leq 20\text{m}\Omega$
INSULATION RESISTANCE: $\geq 1,000\text{ M}\Omega$, 100 V_{DC}
WITHSTANDING VOLTAGE: 1,000V_{AC} FOR 1 MINUTE

2 ENVIRONMENTAL :

TEMPERATURE RATING: -55°C TO 125°C
PROCESS TEMPERATURE RATING: MAX. INSULATOR TEMPERATURE 191°C
(SOLDER WAVE PROCESS ONLY)

MM [INCH]			
TOLERANCE - UNLESS NOTED			
	X.	.X	.XX
MM	±.50	±.25	±.15
[INCH]	±.020	±.010	±.006
[] = DIM. FOR REFERENCE ONLY			



UL FILE NO: E68080

B		73823	MAY 30, 2017		JNC	WL
A		72454	FEB 24, 2017		JNC	WL
REV		ECO	ISSUE DATE AND DESCRIPTION		DRFT	CHKD
CASTIGLIONE		DATE	FEB 20, 2017		APPR	DATE
CHKD		DATE			W. LEE	FEB 20, 2017
DIVISION		DIVISION CODE		© 3M COPYRIGHT 2017		
DO NOT SCALE DRAWING		SCALE		<p>3M Center St. Paul, MN 55144</p> <p>This document and the information it contains are 3M property and may not be reproduced or further distributed without the express permission, or used or disclosed other than for 3M authorized purposes. All rights reserved.</p>		
TOLERANCES EXCEPT AS NOTED		INCHES		TITLE		
		.0 .00 .000 /0000		DIN C & R-FORM SKT, RA, VERT, SOLDER TAIL OR PRESS-FIT		
THIRD ANGLE PROJECTION		MILLIMETERS		CAGE NUMBER		
INTERPRET PER ASME Y14.5 - 2009		.0 .00 .000		SIZE		DRAWING NO.
MAX SURFACE ROUGHNESS		.0 .00 .000		B		578-5100-2670-7
<input checked="" type="checkbox"/> FLAT SURFACES <input type="checkbox"/> MARKED ONLY		ANGLE		DET		YES <input checked="" type="checkbox"/> NO <input type="checkbox"/>
				MODEL		SHT. 1 OF 6

Imaged: B.1 Central Standard Time5/30/2017UTC Offset

VERTICAL, RIGHT ANGLE, SOLDER TAIL OR PRESS-FIT TERMINATION

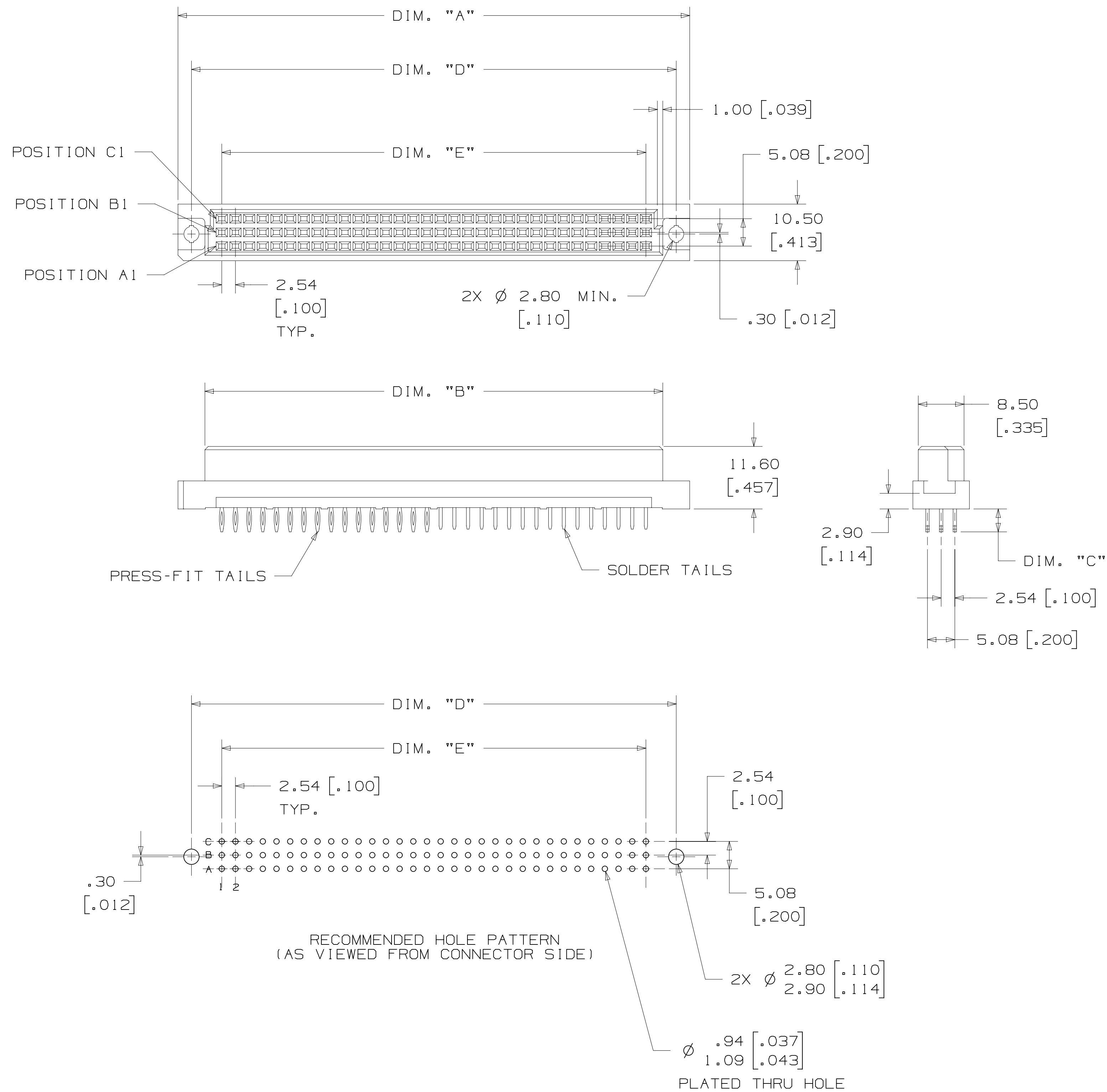

TABLE 1						
CONTACT QTY.	PART NUMBER	DIM. "A"	DIM. "B"	DIM. "D"	DIM. "E"	CONTACT QTY.
16	DIN-016CSA-XXX-XXXX	54.40 [2.142]	44.40 [1.748]	50.00 [1.969]	38.10 [1.500]	16
32	DIN-032CSB-XXX-XXXX	54.40 [2.142]	44.40 [1.748]	50.00 [1.969]	38.10 [1.500]	32
48	DIN-048CSC-XXX-XXXX	54.40 [2.142]	44.40 [1.748]	50.00 [1.969]	38.10 [1.500]	48
32	DIN-032CSD-XXX-XXXX	54.40 [2.142]	44.40 [1.748]	50.00 [1.969]	38.10 [1.500]	32
16	DIN-016CSE-XXX-XXXX	54.40 [2.142]	44.40 [1.748]	50.00 [1.969]	38.10 [1.500]	16
32	DIN-032CSA-XXX-XXXX	95.00 [3.740]	85.00 [3.346]	90.00 [3.543]	78.74 [3.100]	32
64	DIN-064CSB-XXX-XXXX	95.00 [3.740]	85.00 [3.346]	90.00 [3.543]	78.74 [3.100]	64
96	DIN-096CSC-XXX-XXXX	95.00 [3.740]	85.00 [3.346]	90.00 [3.543]	78.74 [3.100]	96
64	DIN-064CSD-XXX-XXXX	95.00 [3.740]	85.00 [3.346]	90.00 [3.543]	78.74 [3.100]	64
32	DIN-032CSE-XXX-XXXX	95.00 [3.740]	85.00 [3.346]	90.00 [3.543]	78.74 [3.100]	32

DIN-XXXXCSX-XXXX-XX

- PLATING:

KR = 30-40 μ " GOLD ON CONTACT AREA
120-200 μ " MATTE TIN ON TERMINAL
HM = 3 μ " GOLD ON CONTACT AREA, 7 μ " MIN. PdNi
120-200 μ " MATTE TIN ON TERMINAL
KV = 30 μ " GOLD ON CONTACT AREA, 1-3 μ " GOLD
ON BOARD TERMINATION

TERMINATION OPTIONS:
SEE TABLE 2

NOTE:
1) A AND E OPTIONS ARE CURRENTLY NOT COVERED IN UL FILE NO. E68080.
2) MATES WITH C-FORM AND R-FORM PLUGS.

TABLE 2		
SOLDER TERMINATION OPTION NO.	DIM. "C"	COMMENTS
R1L	3.75 [.148]	WITH RETENTION CLIP
R3L	2.29 [.090]	WITH RETENTION CLIP
S1L	3.75 [.148]	NO RETENTION CLIP
S3L	2.29 [.090]	NO RETENTION CLIP
W	14.70 [.579]	NO RETENTION CLIP
PRESS-FIT TERMINATION OPTION NO.	DIM. "C"	COMMENTS
PS	5.99 [.236]	
PSL	4.25 [.167]	
PW1	12.90 [.508]	

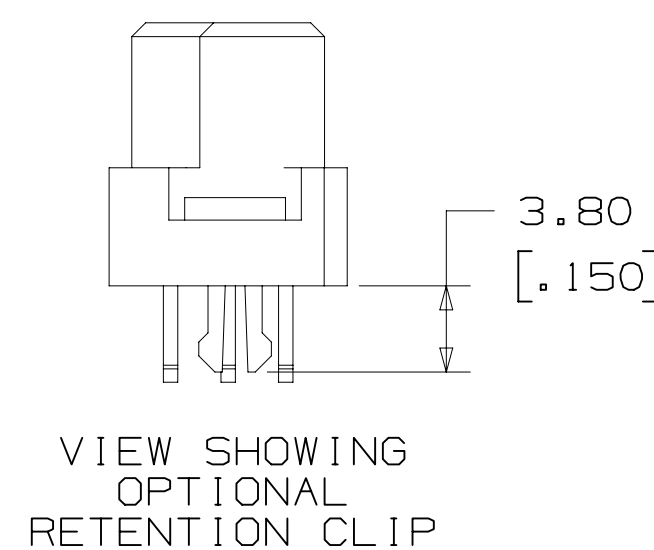

B		73823	MAY 20, 2017		JNC	WL
A		72454	FEB 24, 2017		JNC	WL
PRODUCTION RELEASE						
REV		ECO	ISSUE DATE AND DESCRIPTION		DRFT	CHKD
DRFT		CASTIGLIONE		DATE	FEB 20, 2017	
CHKD				DATE	FEB 20, 2017	
APPR.		W. LEE				
DIVISION		DIVISION CODE		© 3M COPYRIGHT 2017		
MSD		MSD		<p>3M Center St. Paul, MN 55144</p> <p>This document and the information it contains are 3M property and may not be reproduced or further distributed without the written 3M permission, or used or disclosed other than for 3M authorized purposes. All rights reserved.</p>		
DO NOT SCALE DRAWING		SCALE		TITLE		
1		TOLERANCES EXCEPT AS NOTED		DIN C & R-FORM SKT,		
THIRD ANGLE PROJECTION		INCHES		RA, VERT, SOLDER TAIL		
INTERPRET PER ASME Y14.5 - 2009		MILLIMETERS		OR PRESS-FIT		
MAX SURFACE ROUGHNESS		INCHES		CAGE NUMBER		
MAX SURFACES		MILLIMETERS		SIZE		
MARKED ONLY		ANGLES		DRAWING NO.		
				D 78-5100-2670-7		
				REV.		
				B		
				MODEL		
				DET. SHTS		
				YES YES NO		
				SHT 2 OF 4		

3M™ DIN C-FORM & R-FORM SOCKET, DIN 41612 SERIES

VERTICAL, RIGHT ANGLE, SOLDER TAIL OR PRESS-FIT TERMINATION

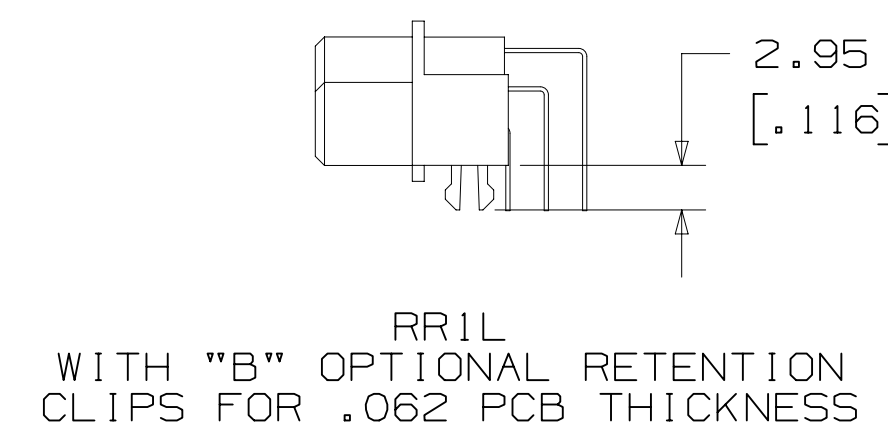
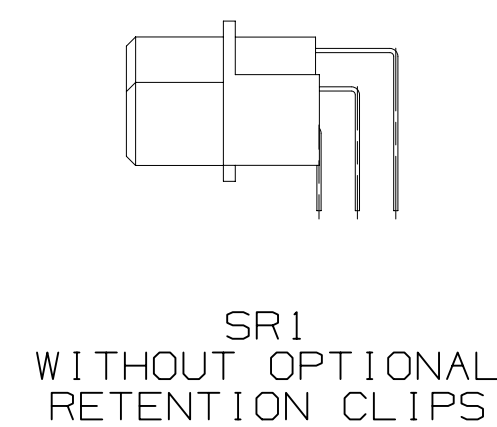
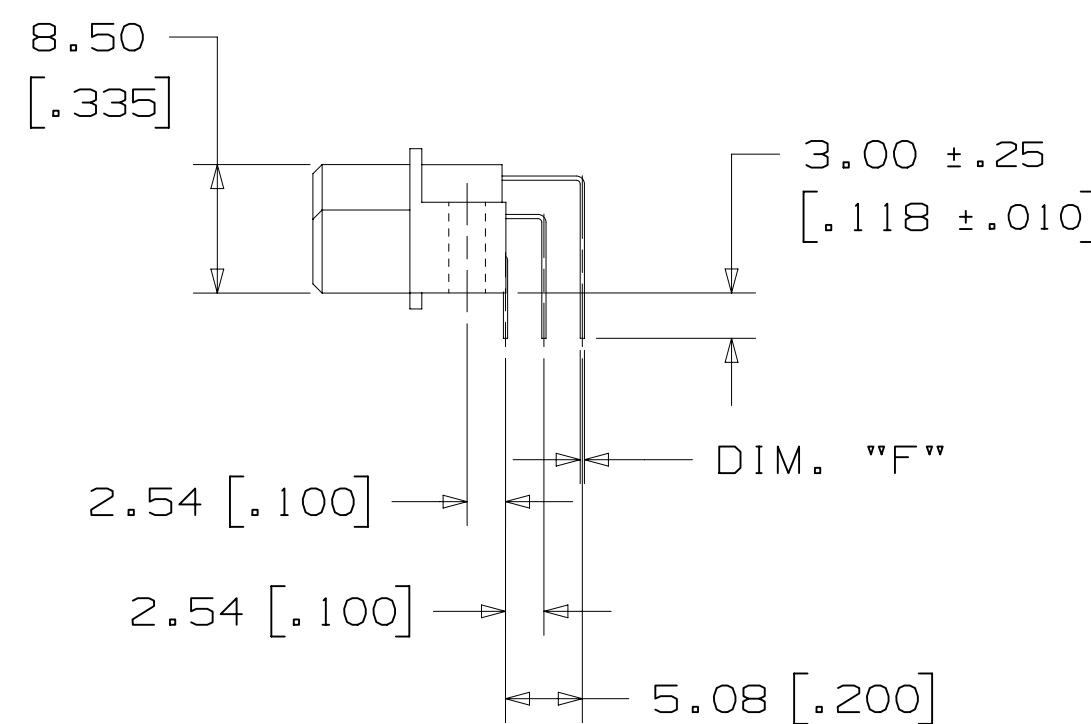
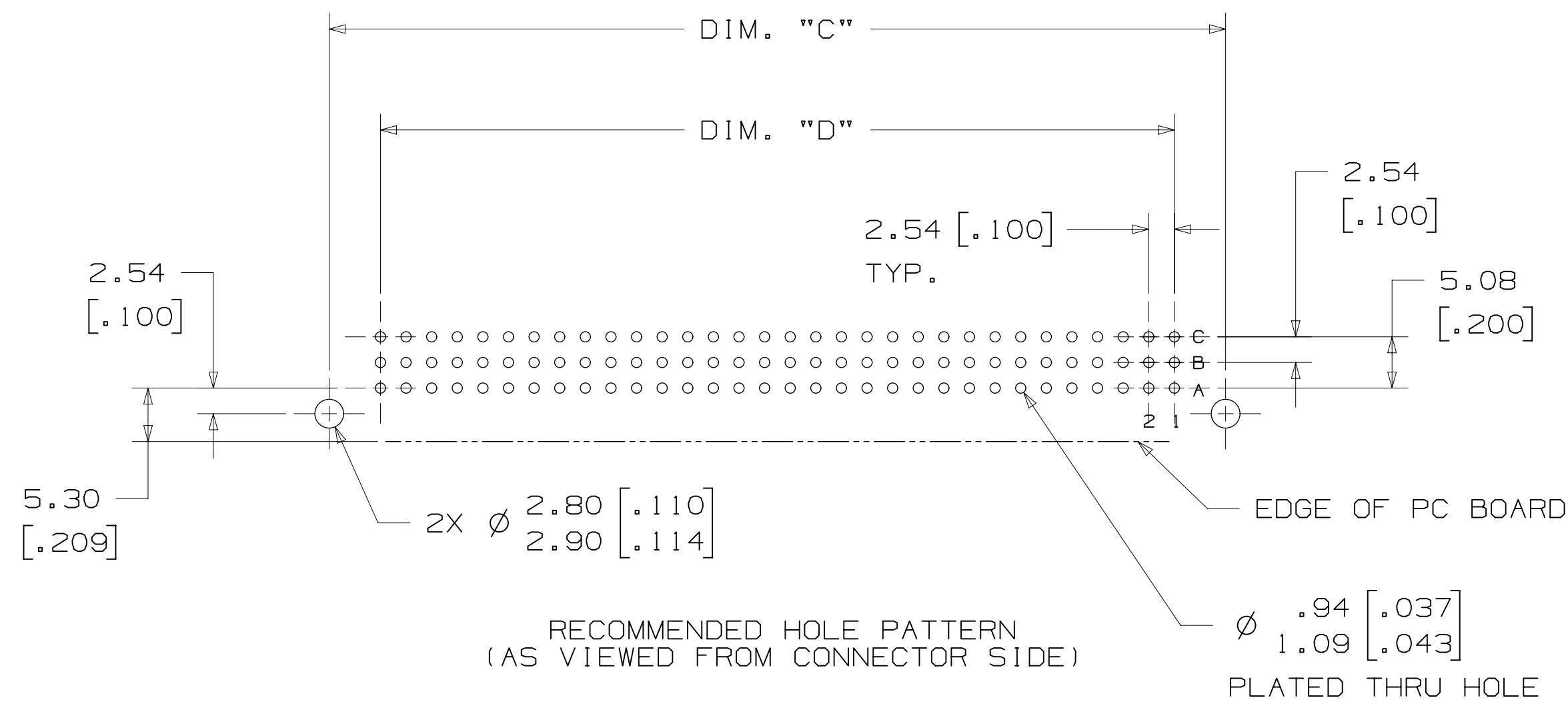
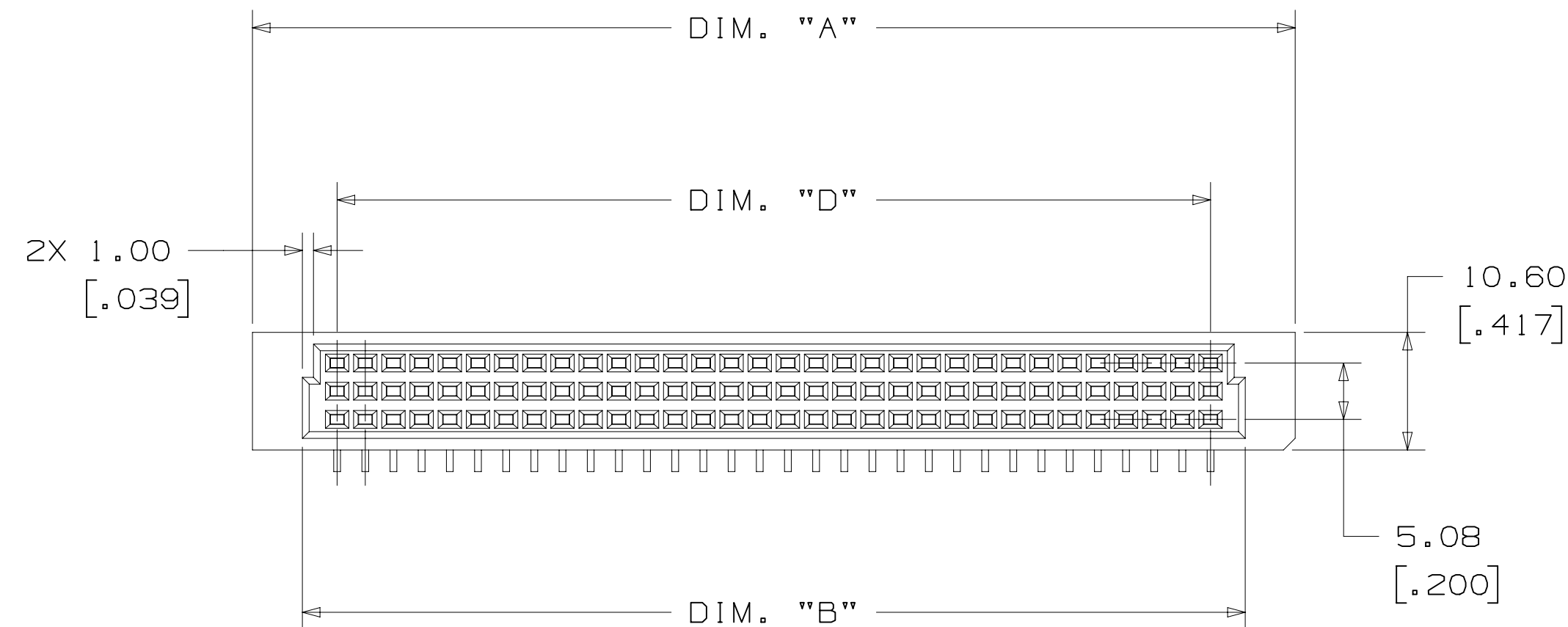
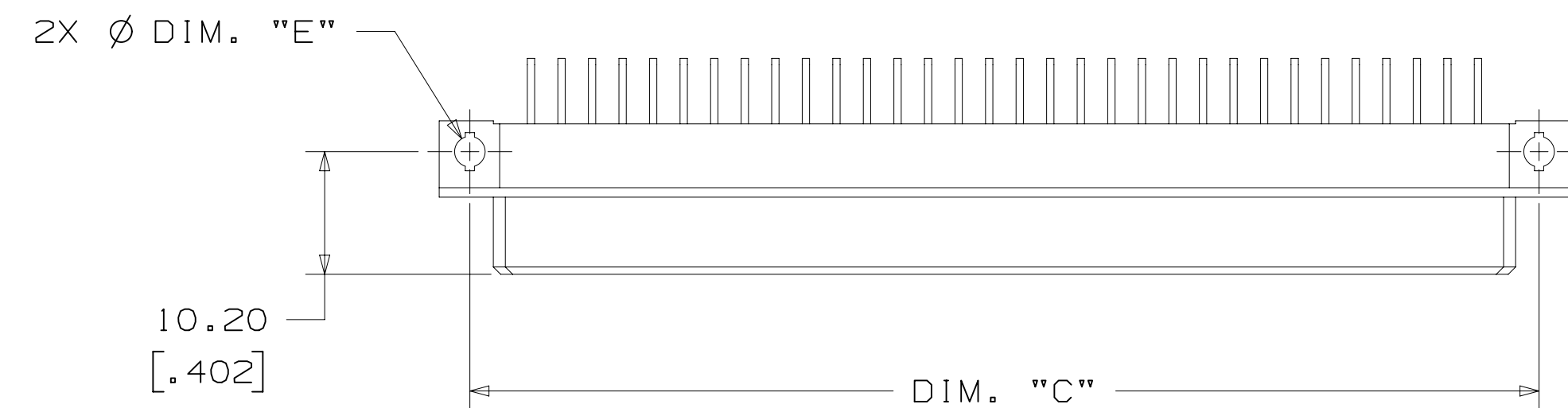

TABLE 1								
CONTACT QTY.	PART NUMBER	DIM. "A"	DIM. "B"	DIM. "C"	DIM. "D"	DIM. "E"	DIM. "F"	CONTACT QTY.
16	D1N-016RSA-XXX-XXXX	53.40 [2.102]	44.40 [1.748]	48.26 [1.900]	38.10 [1.500]	Ø 2.60 [.102]	.25 [.010]	16
32	D1N-032RSB-XXX-XXXX	53.40 [2.102]	44.40 [1.748]	48.26 [1.900]	38.10 [1.500]	Ø 2.60 [.102]	.25 [.010]	32
48	D1N-048RSC-XXX-XXXX	53.40 [2.102]	44.40 [1.748]	48.26 [1.900]	38.10 [1.500]	Ø 2.60 [.102]	.25 [.010]	48
32	D1N-032RSD-XXX-XXXX	53.40 [2.102]	44.40 [1.748]	48.26 [1.900]	38.10 [1.500]	Ø 2.60 [.102]	.25 [.010]	32
16	D1N-016RSE-XXX-XXXX	53.40 [2.102]	44.40 [1.748]	48.26 [1.900]	38.10 [1.500]	Ø 2.60 [.102]	.25 [.010]	16
32	D1N-032RSA-XXX-XXXX	94.00 [3.701]	85.00 [3.346]	88.90 [3.500]	78.74 [3.100]	Ø 2.60 [.102]	.25 [.010]	32
64	D1N-064RSB-XXX-XXXX	94.00 [3.701]	85.00 [3.346]	88.90 [3.500]	78.74 [3.100]	Ø 2.60 [.102]	.25 [.010]	64
96	D1N-096RSC-XXX-XXXX	94.00 [3.701]	85.00 [3.346]	88.90 [3.500]	78.74 [3.100]	Ø 2.60 [.102]	.25 [.010]	96
64	D1N-064RSD-XXX-XXXX	94.00 [3.701]	85.00 [3.346]	88.90 [3.500]	78.74 [3.100]	Ø 2.60 [.102]	.25 [.010]	64
32	D1N-032RSE-XXX-XXXX	94.00 [3.701]	85.00 [3.346]	88.90 [3.500]	78.74 [3.100]	Ø 2.60 [.102]	.25 [.010]	32
40	D1N-040RSA-XXX-XXXX	114.32 [4.501]	105.32 [4.146]	109.22 [4.300]	99.06 [3.900]	Ø 2.80 [.110]	.60 [.024]	40
80	D1N-080RSB-XXX-XXXX	114.32 [4.501]	105.32 [4.146]	109.22 [4.300]	99.06 [3.900]	Ø 2.80 [.110]	.60 [.024]	80
120	D1N-120RSC-XXX-XXXX	114.32 [4.501]	105.32 [4.146]	109.22 [4.300]	99.06 [3.900]	Ø 2.80 [.110]	.60 [.024]	120
80	D1N-080RSD-XXX-XXXX	114.32 [4.501]	105.32 [4.146]	109.22 [4.300]	99.06 [3.900]	Ø 2.80 [.110]	.60 [.024]	80
40	D1N-040RSE-XXX-XXXX	114.32 [4.501]	105.32 [4.146]	109.22 [4.300]	99.06 [3.900]	Ø 2.80 [.110]	.60 [.024]	40

ORDERING INFORMATION
R-FORM VERSION

DIN-XXXXRSX-XXX-XX

CONTACT QUANTITY :
(SEE TABLE 1)

— PLATING:

KR = 30-40 μ " GOLD ON CONTACT AREA
120-200 μ " MATTE TIN ON TERMINAL
HM = 3 μ " GOLD ON CONTACT AREA, 7 μ " MIN. PdNi
120-200 μ " MATTE TIN ON TERMINAL

TERMINATION OPTIONS:

```
SR1 = 3.00 [ .118 ]
RR1L = 3.00 [ .118 ] WITH 'B' RETENTION CLIPS
```

NOTE :

2) MATES WITH C-FORM AND R-FORM PLUGS.

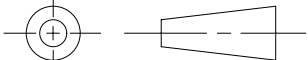
DESIGN REFERENCE						NEXT ASSEMBLY						PRODUCT RELEASE						REV.		CHKD.			
ACCESS CODES																DATE		DATE					
												REV. CASTIGLIONE		FEB 20, 2017		MFG							
												CHKD				DATE		FEB 20, 2017					
DIVISION						DIVISION CODE						© 3M COPYRIGHT 2017											
DO NOT SCALE DRAWING						EMSD TOLERANCES EXCEPT AS NOTED						3M St. Paul, MN 55144						This document and the information it contains are 3M property and may not be reproduced or further distributed without 3M permission, or used or disclosed other than for 3M authorized purposes. All rights reserved.					
						INCHES .0000 ±						TITLE DIN C & R-FORM SKT, RA, VERT, SOLDER TAIL OR PRESS-FIT											
THIRD ANGLE PROJECTION						MILLIMETERS .000 ±						CAGE NUMBER						SIZE					
INTERPRET PER ASME Y14.5 - 2009						.000 ±						DRAWING NO.						REV.					
MAX SURFACE ROUGHNESS						.000 ±						D 78-5100-2670-7						B					
MIN SURFACES						.000 ±																	
MARKED ONLY						ANGLE						MODEL						DET. SHTS YES X NO SHT 3 OF 4					

3M™ DIN C-FORM & R-FORM SOCKET, DIN 41612 SERIES

VERTICAL, RIGHT ANGLE, SOLDER TAIL OR PRESS-FIT TERMINATION

Technical Information: The technical information, recommendations and other statements contained in this document are based upon tests or experience that 3M believes are reliable, but the accuracy or completeness of such information is not guaranteed.

Product Use: Many factors beyond 3M's control and uniquely within user's knowledge and control can affect the use and performance of a 3M product in a particular application. Given the variety of factors that can affect the use and performance of a 3M product, user is solely responsible for evaluating the 3M product and determining whether it is fit for a particular purpose and suitable for user's method of application.

Warranty, Limited Remedy, and Disclaimer: Unless an additional warranty is specifically stated on the applicable 3M product packaging or product literature, 3M warrants that each 3M product meets the applicable 3M product specification at the time 3M ships the product. 3M MAKES NO OTHER WARRANTIES OR CONDITIONS, EXPRESS OR IMPLIED, INCLUDING, BUT NOT LIMITED TO, ANY IMPLIED WARRANTY OR CONDITION OF MERCHANTABILITY OR FITNESS FOR A PARTICULAR PURPOSE OR ANY IMPLIED WARRANTY OR CONDITION ARISING OUT OF A COURSE OF DEALING, CUSTOM OR USAGE OF TRADE. If the 3M product does not conform to this warranty, then the sole and exclusive remedy is, at 3M's option, replacement of the 3M product or refund of the purchase price.

Limitation of Liability: Except where prohibited by law, 3M will not be liable for any loss or damage arising from the 3M product, whether direct, indirect, special, incidental or consequential, regardless of the legal theory asserted, including warranty, contract, negligence or strict liability.

Unless otherwise noted, references to indrustry specifications are intended to indicate substantial compliance to the material elements of the specification. Such references should not be construed as a guarantee of compliance to all requirements in a given specification.

DESIGN REFERENCE		NEXT ASSEMBLY		REV	ECO	ISSUE DATE AND DESCRIPTION		DRFT	CHKD
XREF CODES				DRP	CASTIGLIONE		DATE	MFG	DATE
				CHKD			DATE	APPRVL	DATE
						FEB 20,2017		W. LEE	FEB 20,2017
DIVISION		DIVISION CODE		© 3M COPYR[IGHT] 2017					
DO NOT SCALE DRAWING		SCALE 2 1		TOLERANCES EXCEPT AS NOTED		3M 3M Center St. Paul, MN 55144 This document and the information it contains are 3M property and may not be reproduced or further distributed without 3M permission, or used or disclosed other than for 3M authorized purposes. All rights reserved.			
THIRD ANGLE PROJECTION		INCHES		TITLE					
INTERPRET PER ASME Y14.5 - 2009		MILLIMETERS		DIN C & R-FORM SKT, RA, VERT, SOLDER TAIL OR PRESS-FIT					
MAX SURFACE ROUGHNESS		SURFACES		CAGE NUMBER		SIZE	DRAWING NO.	REV.	
MARKED ONLY		ANGLES		D		78-5100-2670-7	B		
				MODEL		DET		SHT 4 OF 4	

Mouser Electronics

Authorized Distributor

Click to View Pricing, Inventory, Delivery & Lifecycle Information:

3M:

[DIN-096CSC-S1L-HM](#) [DIN-064CSB-S1L-HM](#) [DIN-096CSC-PSL-HM](#) [DIN-096RSC-RR1L-HM](#) [DIN-032CSB-PW1-HM](#)
[DIN-032CSB-S1L-HM](#) [DIN-048CSC-S1L-KR](#) [DIN-048CSC-S3L-HM](#)