

# SBP Series

[RoHS Compliant]



- Tape and Reel Dimensions (see page 36)
- Precautions (see page 35)

Model	Rated voltage DC (V)	Rated current DC (A)	Impedance (at 100MHz) (Ω) min.	DC resistance (mΩ/Line) max.	Operating temperature range (°C)
<b>SBP-5001T</b>	50	5.0	500	7	-25~+70

- Withstanding voltage: 200V DC for one minute between lines
- Insulation resistance: More than 10MΩ (100V DC, between lines)

## Shape and Dimensions

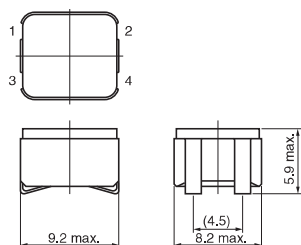

[mm]

## Circuit Diagram

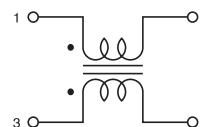

## Recommended Land Pattern

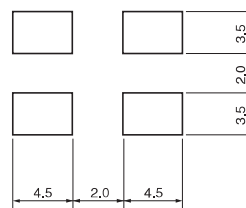

[mm]

## Impedance vs. Frequency

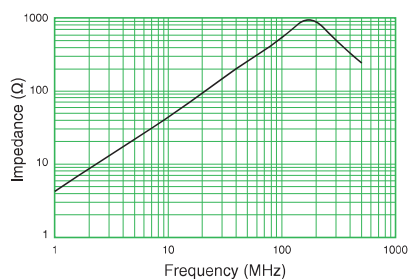

- All specifications in this catalog and production status of products are subject to change without notice. Prior to the purchase, please contact TOKIN for updated product data.
- Please request for a specification sheet for detailed product data prior to the purchase.
- Before using the product in this catalog, please read "Precautions" and other safety precautions listed in the printed version catalog.