

PAGE 1/2

ISSUE **2007A**

SERIES **SMA-S**

PART NUMBER **R126417220**

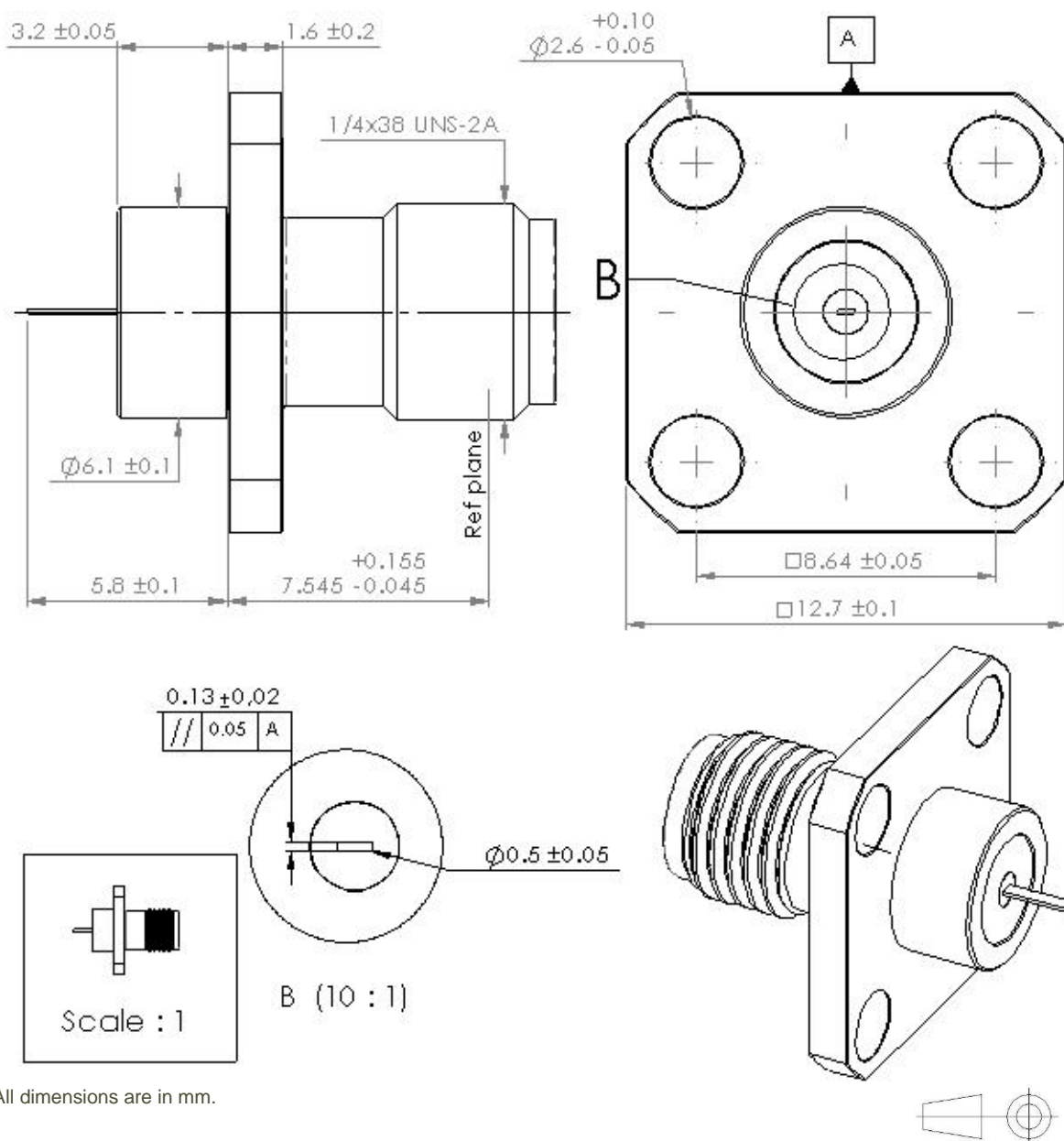

All dimensions are in mm.

COMPONENTS	MATERIALS	PLATING (µm)
Body	BERYLLIUM COPPER	GOLD 1.3 OVER NICKEL2
Center contact	BERYLLIUM COPPER	GOLD 1.3 OVER NICKEL2
Outer contact	BERYLLIUM COPPER	GOLD 1.3 OVER NICKEL2
Insulator	PTFE	
Gasket		
Others parts		
-	-	-
-	-	-

PAGE 2/2

ISSUE **2007A**

SERIES **SMA-S**

PART NUMBER **R126417220**

PACKAGING

Standard	Unit	Other
1	-	Contact us

ELECTRICAL CHARACTERISTICS

Impedance		50	Ω
Frequency		DC -18	GHz
VSWR	1.1*	+	0,0010 x F(GHz) Maxi
Insertion loss		0.05	√F(GHz) dB Maxi
RF leakage	- (120	- F(GHz) dB Maxi
Voltage rating		335	Vrms Maxi
Dielectric withstanding voltage		1000	Vrms mini
Insulation resistance		5000	MΩ mini

MECHANICAL CHARACTERISTICS

Center contact retention			
Axial force – Mating End		27	N mini
Axial force – Opposite end		27	N mini
Torque		2.8	N.cm mini
Recommended torque			
Mating		80-120	N.cm
Panel nut		NA	N.cm
Mating life		500	Cycles Maxi
Weight		3.5	g Maxi

ENVIRONMENTAL

Operating temperature	-65/+105	°C
Hermetic seal	NA	Atm.cm3/s
Panel leakage	NA	

SPECIFICATION

According to ESCC 3402 /002
According to SAC-CPUR-2018E0540001 specification

OTHER CHARACTERISTICS

Others:

* **COAXIAL TRANSMISSION LINE ONLY**