

6

5

4

3

2

1

D

D

C

C

B

B

A

A

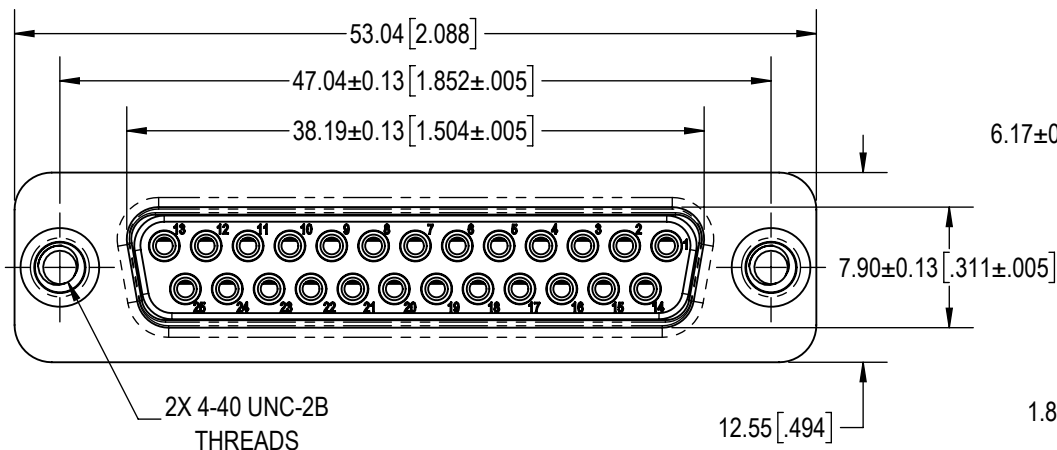

6.17±0.13 [.243±.005]

1.85±0.13 [.073±.005]

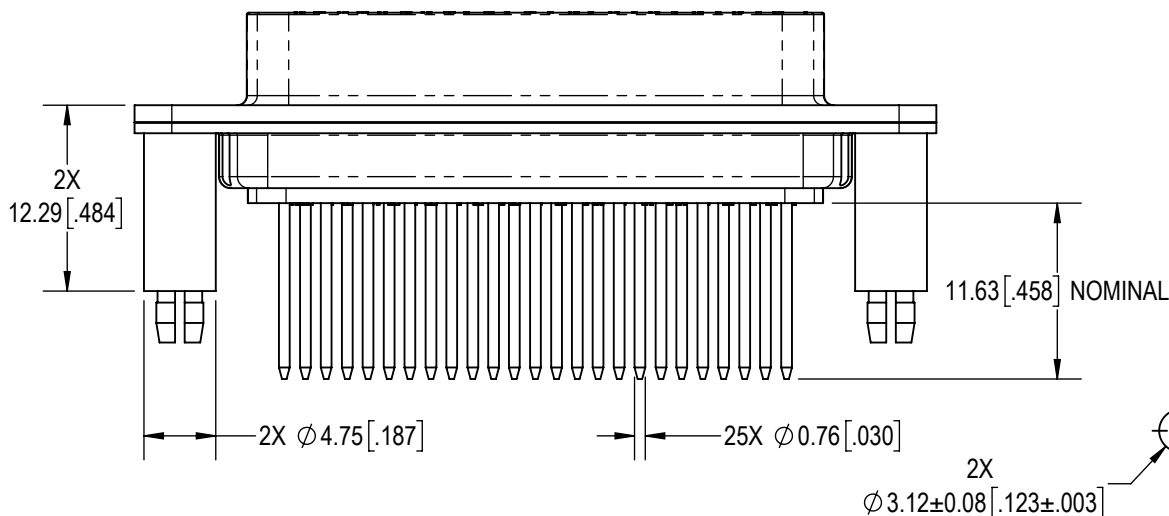
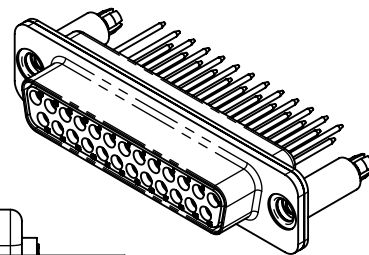

SYM.

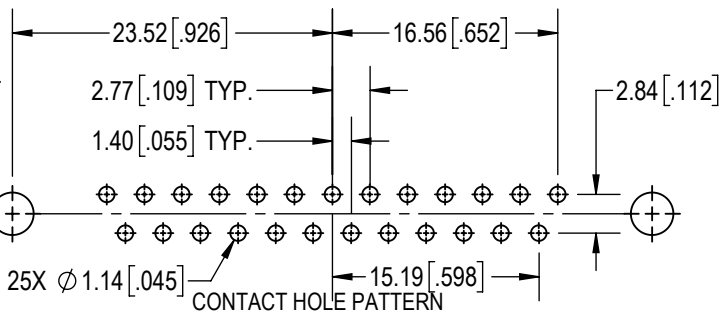

## NOTES:

## 1. MATERIAL AND FINISHES:

INSULATOR: GLASS-FILLED POLYESTER PER ASTM D5927, UL 94V-0, COLOR: BLUE  
CONTACTS: PRECISION MACHINED COPPER ALLOY, 1.27μ [.000050] GOLD OVER NICKEL PLATE.  
SHELLS: PRECISION-MACHINED ALUMINUM, ELECTROLESS NICKEL PLATE.  
PUSH FASTENERS: PHOSPHOR BRONZE, 1.27μ [.000050] GOLD OVER NICKEL PLATE.

## 2. DETAILED PRODUCT, ELECTRICAL AND MECHANICAL INFORMATION IS AVAILABLE IN THE LATEST STANDARD DENSITY MACH-D PRODUCT PUBLICATION AT CONNECTPOSITRONIC.COM.

## 3. CONNECTOR IS COMPLIANT TO CURRENT RoHS DIRECTIVES.

BY SB	CHK AP	3RD ANGLE 	POSITRONIC BELIEVES THE DATA ON THE DRAWING TO BE RELIABLE. THE USER EMPLOYS SUCH INFORMATION AT HIS OWN DISCRETION AND RISK. POSITRONIC ASSUMES NO RESPONSIBILITY FOR RESULTS OBTAINED OR DAMAGES INCURRED FROM USE OF SUCH INFORMATION IN WHOLE OR IN PART.	
APR SS	RELEASED DATE: 2024-08-02	SCALE NTS	PART NUMBER MCD25S39S600K/AA-15	SERIES MACH-D
TOLERANCES ±0.03mm [.001 INCHES] FOR MALE CONTACT MATING DIAMETERS ±0.08mm [.003 INCHES] FOR CONTACT TERMINATION DIAMETERS ±0.13mm [.005 INCHES] FOR ALL OTHER DIAMETERS ±0.38mm [.015 INCHES] FOR ALL OTHER DIMENSIONS ±5° FOR ALL ANGLES DIMENSION ARE IN MILLIMETERS [INCHES]				
TITLE MCD25S39S600K/AA-15				
CREATED ON: 2024-08-02		SHEET SHEET 1 OF 1		REV A