

6

5

4

3

2

1

D

D

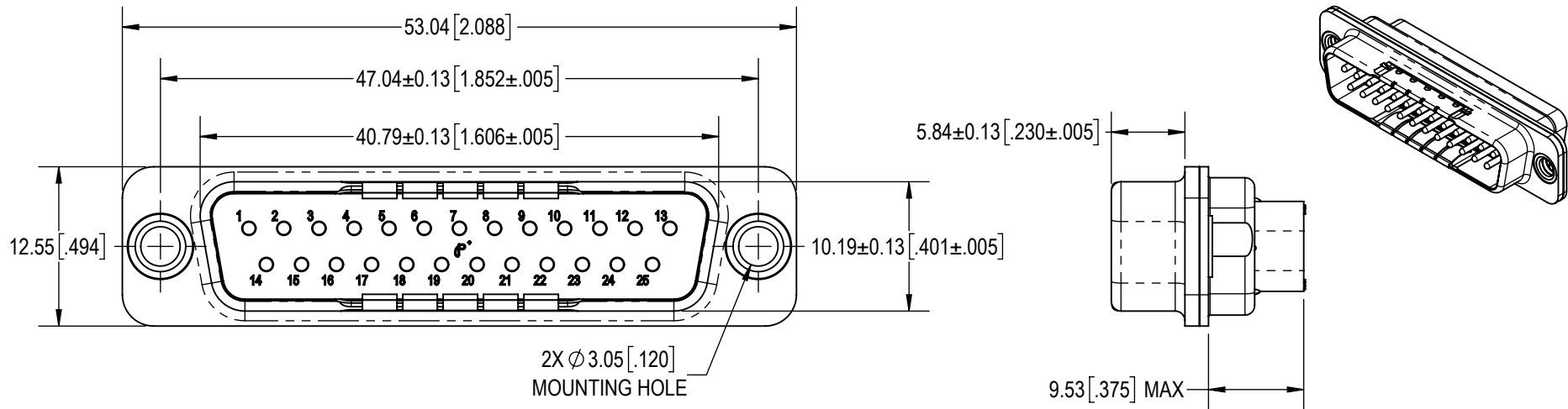

C

C

B

B

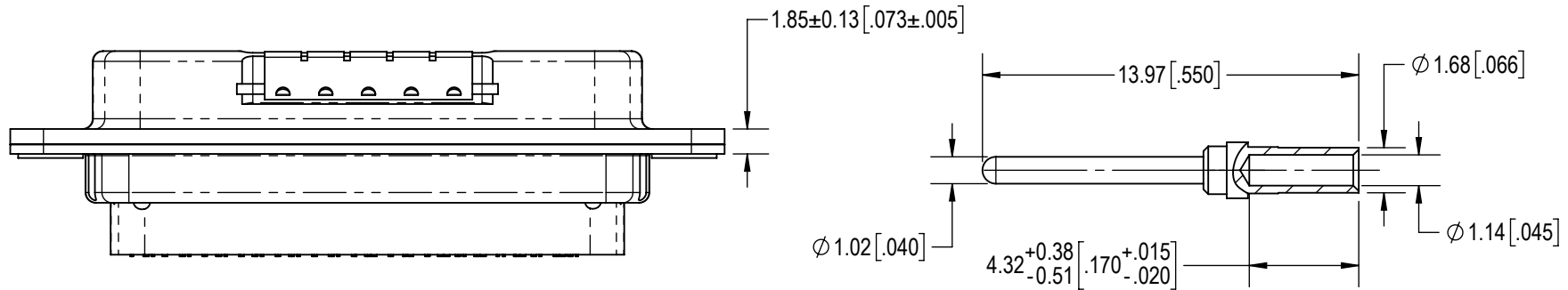



25X MALE CONTACT (ENLARGED)

NOTES:

- MATERIAL AND FINISHES:**
INSULATOR: GLASS FILLED DAP PER ASTM-D-5948, SDG-F, UL 94V-0, COLOR: GREEN.
CONTACTS: PRECISION MACHINED COPPER ALLOY, 1.27µ [0.000050] GOLD OVER NICKEL PLATE.
SHELLS: PRECISION-MACHINED ALUMINUM, ELECTROLESS NICKEL FINISH.
RIVETS : STAINLESS STEEL, PASSIVATED.
EMI CLIPS: BERYLLIUM COPPER.
- DETAILED PRODUCT, MECHANICAL AND ELECTRICAL INFORMATION IS AVAILABLE IN THE LATEST STANDARD DENSITY MACH-D PRODUCT PUBLICATION AT CONNECTPOSITRONIC.COM.
- CONNECTORS ARE COMPLIANT TO THE CURRENT RoHS DIRECTIVE.
- CRIMPING TOOL INFORMATION IS AVAILABLE AT WWW.CONNECTPOSITRONIC.COM/CrimpToolCrosslist.

A

A

BY AB		CHK AP		3RD ANGLE 		<p>POSITRONIC BELIEVES THE DATA ON THE DRAWING TO BE RELIABLE. THE USER EMPLOYS SUCH INFORMATION AT HIS OWN DISCRETION AND RISK. POSITRONIC ASSUMES NO RESPONSIBILITY FOR RESULTS OBTAINED OR DAMAGES INCURRED FROM USE OF SUCH INFORMATION IN WHOLE OR IN PART.</p>  Positronic®									
APR AB		RELEASED DATE: 2022-10-14		SCALE NTS											
TOLERANCES						PART NUMBER		SERIES							
±0.03mm [.001 INCHES] FOR MALE CONTACT MATING DIAMETERS ±0.08mm [.003 INCHES] FOR CONTACT TERMINATION DIAMETERS ±0.13mm [.005 INCHES] FOR ALL OTHER DIAMETERS ±0.38mm [.015 INCHES] FOR ALL OTHER DIMENSIONS ±5° FOR ALL ANGLES DIMENSION ARE IN MILLIMETERS [INCHES]						MCD25MG1000K/AA-15				MACH-D					
						TITLE						MCD25MG1000K/AA-15			
						CREATED ON: 2022-10-14				SHEET SHEET 1 OF 1		REV A			

6

5

4

3

2

1