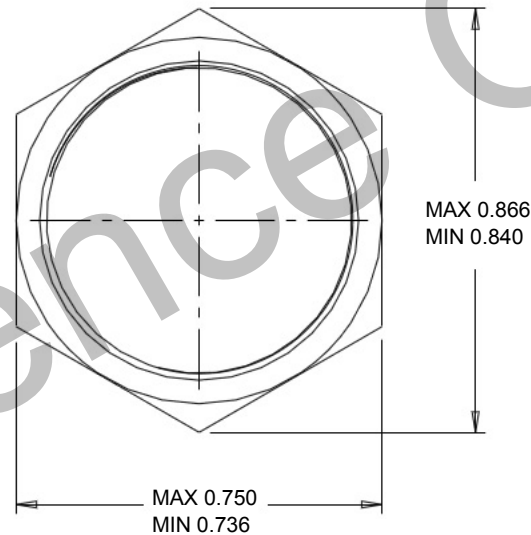

715037

REV	ECN #	DATE
AV	079197	06 JULY 15

NOTES:

1. CHANGE OF MATERIAL IS NOT PERMITTED UNLESS APPROVED IN WRITING BY OTTO ENGINEERING PERSONNEL.
2. DRAWING TO BE INTERPRETED IN ACCORDANCE WITH THE CURRENT REVISION OF ASME Y14.5.
3. TSI TO BE INTERPRETED AS THEORETICAL SHARP INTERSECTION.
4. THIS PART/PRODUCT IS TO BE MANUFACTURED WITH THE LATEST APPLICABLE REGULATIONS OF EC DIRECTIVES FOR THE RESTRICTION OF THE USE OF HAZARDOUS SUBSTANCES IN ELECTRICAL AND ELECTRONIC EQUIPMENT (ROHS), WASTE ELECTRICAL AND ELECTRONIC EQUIPMENT (WEEE) AND REGISTRATION, EVALUATION, AUTHORIZATION AND RESTRICTION OF CHEMICALS (REACH). IF APPLICABLE, SEE ADDITIONAL INFORMATION.
5. ADDITIONAL INFORMATION:
RoHS COMPLIANCE APPLICABLE: YES

MAX 0.866
MIN 0.840

20° TYP. BOTH SIDES

5/8-32 UN-2B

MAX 0.109
MIN 0.099MAX 0.750
MIN 0.736

KEY CHARACTERISTICS



SPECIAL REQUIREMENTS

PROCESS:
RoHS COMPLIANT
NICKEL PLATEDMATERIAL:
BRASS**OTTO**
CARPENTERSVILLE, ILLINOIS USA

DESCRIPTION

HEX NUT

UNLESS OTHERWISE SPECIFIED:
DIMENSIONS ARE IN INCHES.
TOLERANCES ARE AS LISTED.
MUST BE FREE FROM BURRS
AND SHARP EDGES.TOLERANCES
.XX ± .01
.XXX ± .005
ANGLES ± 1°
SURFACES 64 MICROINCH
DO NOT SCALE DRAWING.THIS DOCUMENT IS THE CONFIDENTIAL
PROPERTY OF OTTO ENGINEERING, INC..
IT IS NOT TO BE USED IN ANY WAY
DETRIMENTAL TO THE INTERESTS
OF OTTO ENGINEERING, INC..

WT.

SIZE
AFSCM NO
21649DRAWING NO.
715037REV.
AVTHIRD ANGLE
PROJECTION

Sheet 1 OF 1