

**DIMENSIONS: mm**

**Date Last Revised:01/10/22**

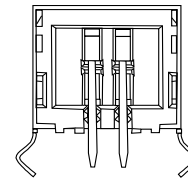

Section A-A

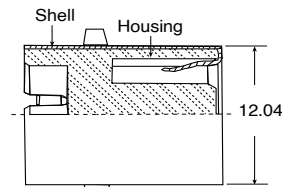
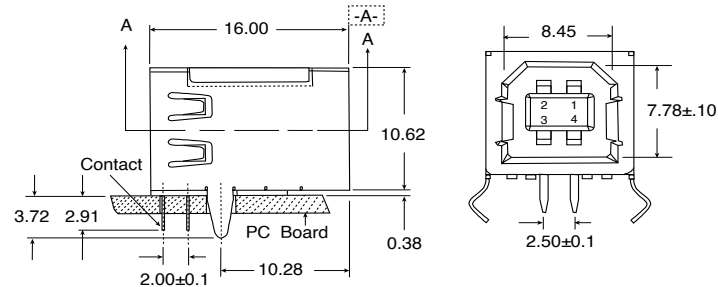
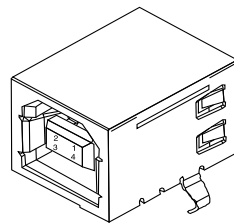
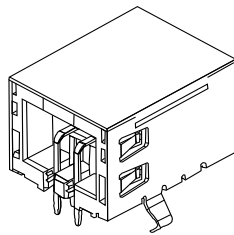
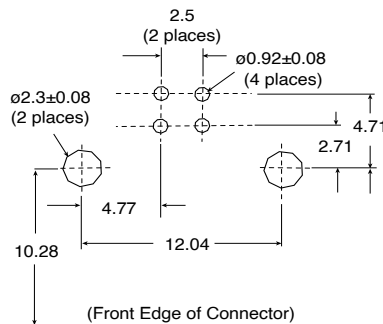

**PCB Footprint: Receptacle (Thru-hole)**

## SPECIFICATIONS

<b>Rating:</b>	1A/250VAC
<b>Temperature:</b>	-55°C to +85°C
<b>Contact Resistance:</b>	30 Milliohms Maximum Initial
<b>Insulation Resistance:</b>	1,000 M ohms Minimum
<b>Dielectric Withstanding Voltage:</b>	500 VAC
<b>Capacitance:</b>	2 Picofarads Maximum at 1KHZ
<b>Insulator:</b>	White Color
<b>Recommended PC Board Thickness:</b>	1.57mm
<b>Recommended Panel Thickness:</b>	2.67mm Maximum
<b>RoHS Compliant</b>	

**Available from Mouser Electronics**  
**1-800-346-6873 / [www.mouser.com](http://www.mouser.com)**

KC-301511

Specifications are subject to change without notice. No liability or warranty implied by this information. Environmental compliance based on producer documentation.